

# PERMIT

## SEWAGE DISPOSAL SYSTEM

### DEPARTMENT OF HEALTH AND MENTAL HYGIENE

Collins  
(Check #1428) P 50333  
A Repair

10/12/94  
1:00 P.M.  
10/13/94  
10:00  
10/14/94

HOWARD COUNTY HEALTH DEPARTMENT

BUREAU OF ENVIRONMENTAL HEALTH

461-9933

DISTRICT \_\_\_\_\_

DATE 10/12/94

DATE SYSTEM APPROVED 10/14/94

INSPECTOR CB

INDEXED

Collins Utility IS PERMITTED TO INSTALL \_\_\_\_\_ ALTER \_\_\_\_\_

ADDRESS for 14597 Mac Clintock Road PHONE \_\_\_\_\_

SUBDIVISION The Woodlands LOT 27 ROAD \_\_\_\_\_

PROPERTY OWNER \_\_\_\_\_

ADDRESS 14597 Mac Clintock Road

SEPTIC TANK CAPACITY Eight GALLONS

NUMBER OF BEDROOMS 5

125 SQUARE FEET PER BEDROOM

125  
5  
625

LINEAR FEET OF TRENCH REQUIRED 105'

(1) trench - 45' to 11' long = 105', inlet 4 1/2" 5' of stone, and to come off existing dry well 630 sq ft effective arch; run trench on contour, CB

\* Plus old dry well; CB

PLANS APPROVED BY CB in field for C.W. DATE 10/12/94

COVER NO WORK UNTIL INSPECTED AND APPROVED

NEITHER THE HOWARD COUNTY COUNCIL NOR THE HEALTH DEPARTMENT IS RESPONSIBLE FOR THE SUCCESSFUL OPERATION OF ANY SYSTEM

NOTE: CLEANOUT REQUIRED EVERY 70 FEET OF SEWER LINE AND/OR AT 90° SWEEPS IN LINES FROM HOUSE TO DRAIN FIELDS, 90° ELBOWS NOT ACCEPTABLE.

NOTE: ALL PARTS OF SEPTIC SYSTEMS (I.E. TANK, DISTRIBUTION BOX TRENCHES) TO BE 100 FEET FROM WELL (UNLESS OTHERWISE SPECIFICALLY AUTHORIZED)

NOTE: IF DEEP TRENCH(ES) ARE USED CALL FOR INSPECTION BEFORE AND AFTER PLACING GRAVEL IN TRENCH(ES)

NOTE: NO DRY WELL SHALL EXCEED 15 FOOT IN DIAMETER NO ABSORPTION TRENCH TO EXCEED 100 FEET IN LENGTH

NOTE: ALL PIPE FROM HOUSE TO SEPTIC TANK MUST BE CAST IRON OR SCHEDULE 35/40 PVC OR ABS

PERMIT VOID AFTER TWO YEARS

NOTE: INSTALL STAND PIPE ON SEPTIC TANK AND DRY WELL STAND PIPES MUST BE 6 INCHES IN DIAMETER CAST IRON, CONCRETE OR TERRA COTTA OR PVA OR ABS ACCEPTED. IF TOP OF SEPTIC TANK IS DEEPER THAN 3 FEET, MANHOLE TO GRADE REQUIRED.

NOTE: DISTRIBUTION BOXES MUST HAVE BAFFLES

\*INSTALLER IS RESPONSIBLE FOR OBTAINING FINAL APPROVAL ON THIS PERMIT

50333

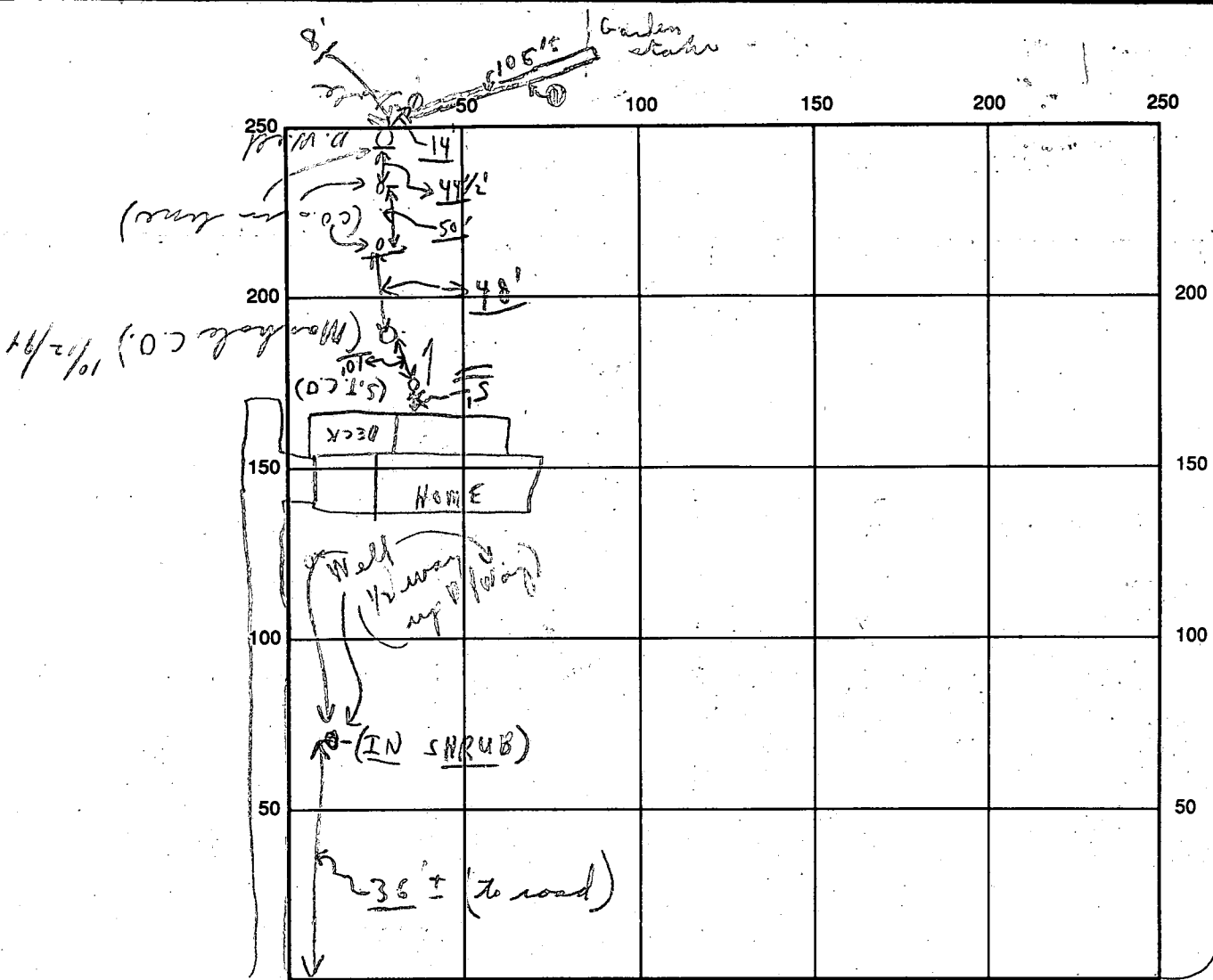

INDICATE NORTH - NAME ADJOINING ROADWAY AS BASE LINE

Mac clinton road

K897

SEPTIC TANK LEVEL Existing CLEANOUTS Existing  
 DISTRIBUTION BOX LEVEL Using old dry well - as D. Box  
 DRAIN FIELD/TITLE DEPTH 11' + wrap TRENCH WIDTH 2 FT. INLET DEPTH 5 FT.  
 EFFECTIVE GRAVEL DEPTH 6 FT. TOTAL LENGTH 106' FT.  
 NUMBER OF TRENCHES 1 ONE SIDEWALL/BOTTOM AREA 636 SQ. FT. (Plus old system)  
 DRYWALL INSIDE DIAMETER --- FT. EFFECTIVE DEPTH BELOW INLET --- FT.  
 ABSORBENT AREA 636 (plus old system) SQ. FT.

REMARKS: Partial P.M. 10/12/94 Left yellow card with spec on 10/12/94  
(HOLD FOR A CALL); 10/13/94 A.M. - no one arpt. no work this A.M. CBS  
10/14/94 Final - old covers as finish, material on site / CBS

DATE SYSTEM APPROVED 10/14/94 INSPECTOR Charles Bryan Street