

PERMIT

SEWAGE DISPOSAL SYSTEM

MARYLAND STATE DEPARTMENT OF HEALTH

HOWARD COUNTY

ELLICOTT CITY

DISTRICT 5

DATE 3/24/70

INDEXED

373077

*4/27/70
alter 1 PM
possible on 4/8/70*

A 50407-B
P 15140
A _____

Thomas B. Woodall IS PERMITTED TO INSTALL _____ ALTER

ADDRESS Lime Kiln Road, Fulton, Maryland PHONE 725-3788

A SEWAGE DISPOSAL SYSTEM LOCATED AT _____

SUBDIVISION Holly House ROAD 12546 Lime Kiln Road lot Parcel 11

PROPERTY OWNER same as above pass Reservoir Rd. - 1st house on right - back about 300 ft. from road

ADDRESS _____

SPECIFICATIONS

DRAIN FIELD _____ DEPTH _____ FEET, BOTTOM AREA _____ SQ. FT.

SEEPAGE PITS _____ ABSORBENT SIDE-WALL AREA _____ SQ. FT.

RELOCATING -- SEPTIC TANK CAPACITY 1,000 GALLONS

FOR GARBAGE GRINDER, INCREASE DISPOSAL AREA 22% & TANK CAPACITY 50%.

OTHER REPAIR - Dry wells - When hole is dug call for inspection so Sanitarian can recommend system to be used.

*2 drywells 100 Sq. Ft. each
Mr. Seck - digging*

*Trench 100ft long - 4ft wide with 4 to 5ft of gravel
trench is to be deep enough take about 6 inches into water table
call for inspection of trench before gravel is installed. DW m*

PLANS APPROVED BY F. Frommelt DATE 3/24/70

FILL SEPTIC TANK AND DISTRIBUTION BOX WITH WATER BEFORE CALLING FOR AN INSPECTION. COVER NO WORK UNTIL INSPECTED AND APPROVED.

NEITHER THE HOWARD COUNTY COMMISSIONERS NOR THE HEALTH DEPARTMENT IS RESPONSIBLE FOR THE SUCCESSFUL OPERATION OF ANY SYSTEM.

4/27/70 - Mr. Wenz gave permission to put in a couple loads of gravel to keep trench from falling in.

NOTIFY THE HEALTH DEPARTMENT 48 HOURS BEFORE EXCAVATIONS ARE TO BE BACK FILLED.

A 50407-B
P 15140

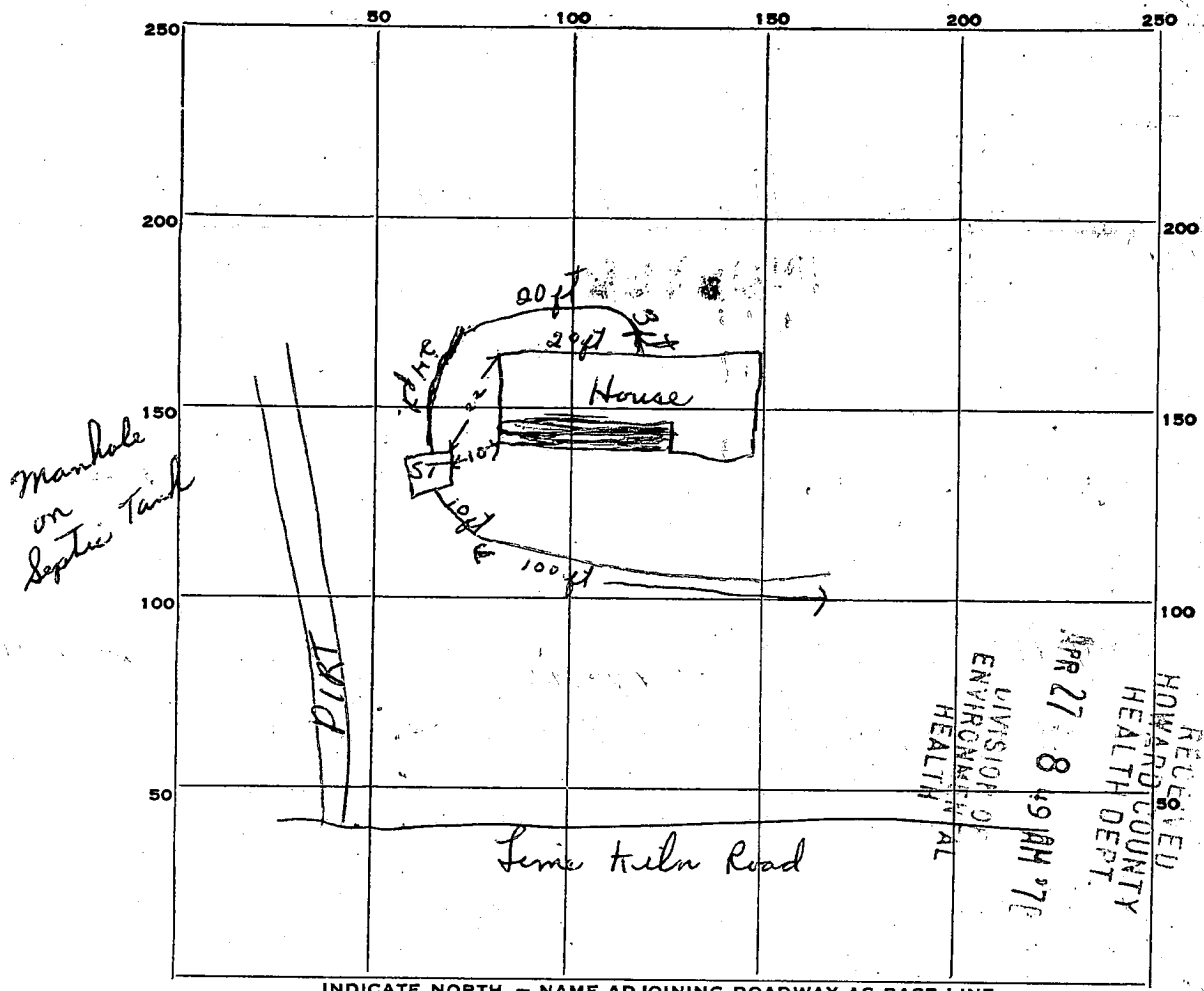

INDICATE NORTH. - NAME ADJOINING ROADWAY AS BASE LINE.

PERMIT CARD Signed

SEPTIC TANK, LEVEL 1000 gal. CLEANOUTS OK

DISTRIBUTION BOX, LEVEL _____

Trench
 TILE FIELD, DEPTH 8 1/2 FT. TRENCH WIDTH 4 FT.

GRAVEL DEPTH 48-60 IN. TOTAL LENGTH 100 FT.
 NUMBER OF TRENCHES 1 Sidewalk Area 800 sq. ft.
~~TOTAL AREA _____ sq. ft.~~

SEEPAGE PITS, INSIDE DIAMETER _____ FT. DEPTH BELOW INLET _____ FT.

ABSORBENT AREA _____ SQ. FT.

REMARKS System put into benches of water tables
4/28/70 - Sept instructions to leave manhole uncovered until
approved. OK to back-fill all of system.

DATE SYSTEM APPROVED 4/28/70 INSPECTOR Robert V. Torre

PERMIT

SEWAGE DISPOSAL SYSTEM

MARYLAND STATE DEPARTMENT OF HEALTH

HOWARD COUNTY

INDEXED

P 01187

A 00537

ELLICOTT CITY

DISTRICT 5

DATE 6-25-59

C. W. Ricketts

IS PERMITTED TO INSTALL ALTER

ADDRESS Ednor, Md.

PHONE Walker 4-3777

A SEWAGE DISPOSAL SYSTEM LOCATED AT Line Kiln Rd., Fulton - Rt. 29 to Seaggsville

R. at Seaggsville go to Fulton - left wing to Fulton.

SUBDIVISION _____ ROAD _____ LOT _____

PROPERTY OWNER Thomas A. Woodall - Phone - Juniper 9-0729

ADDRESS _____

SPECIFICATIONS

DRAIN FIELD _____ DEPTH _____ FEET, BOTTOM AREA _____ SQ. FT.

SEEPAGE PITS _____ ABSORBENT SIDE-WALL AREA _____ SQ. FT.

SEPTIC TANK CAPACITY 750 GALLONS

FOR GARBAGE GRINDER, INCREASE DISPOSAL AREA 22% & TANK CAPACITY 50%.

OTHER 9' x 12' dry well in absorbent ground.

PLANS APPROVED BY Palmer Wine

DATE 3-18-59
~~6-25-59~~

FILL SEPTIC TANK AND DISTRIBUTION BOX WITH WATER BEFORE CALLING FOR AN INSPECTION. COVER NO WORK UNTIL INSPECTED AND APPROVED.

NEITHER THE HOWARD COUNTY COMMISSIONERS NOR THE HEALTH DEPARTMENT IS RESPONSIBLE FOR THE SUCCESSFUL OPERATION OF ANY SYSTEM.

A 00537

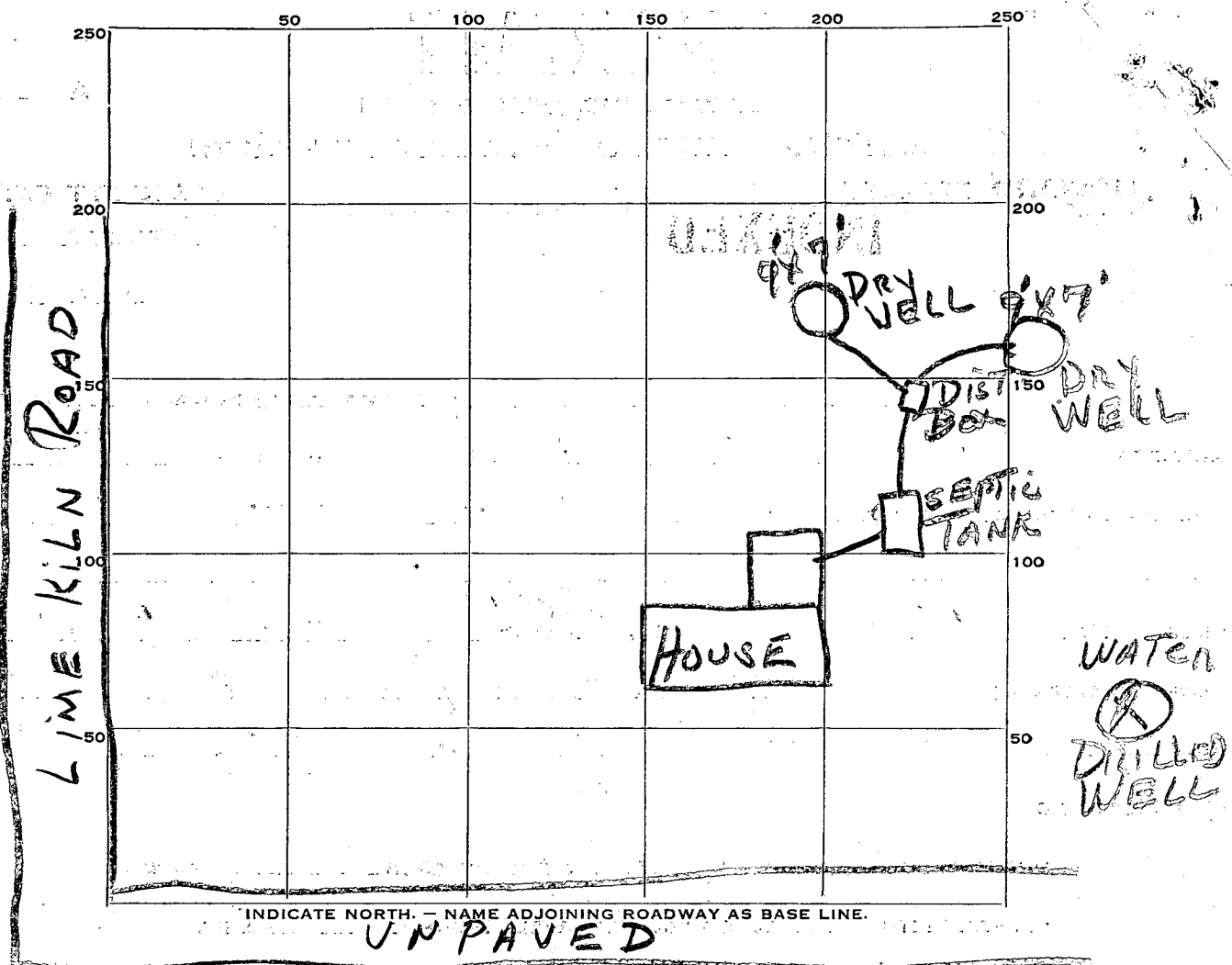

PERMIT CARD _____

SEPTIC TANK, LEVEL OK CLEANOUTS Cover - No stoppage

DISTRIBUTION BOX, LEVEL OK

TILE FIELD, DEPTH _____ FT. TRENCH WIDTH _____ FT.

GRAVEL DEPTH _____ IN. TOTAL LENGTH _____ FT.

NUMBER OF TRENCHES _____ TOTAL BOTTOM AREA _____

2 SEEPAGE PITS, INSIDE DIAMETER 9 FT. DEPTH BELOW INLET 6 FT.

ABSORBENT AREA _____ SQ. FT.

REMARKS Both dry wells in water at 7 ft.

This was surface run off water not ground water according to Mr. Ricketts. Dry wells were dry when dug.

DATE SYSTEM APPROVED 7-28-59 INSPECTOR J. Hennigan

Will call about test on bed

APPLICATION

00537
A
P 01187

SEWAGE DISPOSAL TESTING

MARYLAND STATE DEPARTMENT OF HEALTH

HOWARD COUNTY

11:00 - 3/18/59

ELLICOTT CITY

DISTRICT 3-2 59
DATE

750 Tanks

9x12 dry well in absorbent ground

TO: THE COUNTY HEALTH OFFICER
ELLICOTT CITY, MARYLAND

I, HEREBY, APPLY FOR THE NECESSARY TESTS IN ORDER TO CONSTRUCT (OR RECONSTRUCT) A SEWAGE DISPOSAL SYSTEM.

PROPERTY OWNER Mrs. Thomas A. Woodall
ADDRESS _____ PHONE Juniper 9-0729

PROPERTY LOCATION:

SUBDIVISION _____ LOT NO. _____

ROAD AND DESCRIPTION Lume Kiln Rd. Fulton
Rt 29 to Seagroveville R at ~~Seagrove~~ Seagrove. go to Fulton left wing at Fulton

OCCUPANT _____ PHONE _____

PERSON TO CONSTRUCT SYSTEM _____

ADDRESS 2 acres plus _____ PHONE 3

SIZE OF LOT _____ TYPE BLDG. _____ NUMBER OF BEDROOMS _____

IF NOT SINGLE RESIDENCE DESCRIBE _____

SIGNATURE OF APPLICANT C. W. Ricketts

APPROVED BY P. W. FOR dry well DATE 3/18/59

REJECTED BY _____ FOR _____ DATE _____

HOLD PENDING FURTHER TESTS _____ DATE _____

REASONS FOR REJECTION OR HOLDING _____

THIS IS NOT A PERMIT

00537

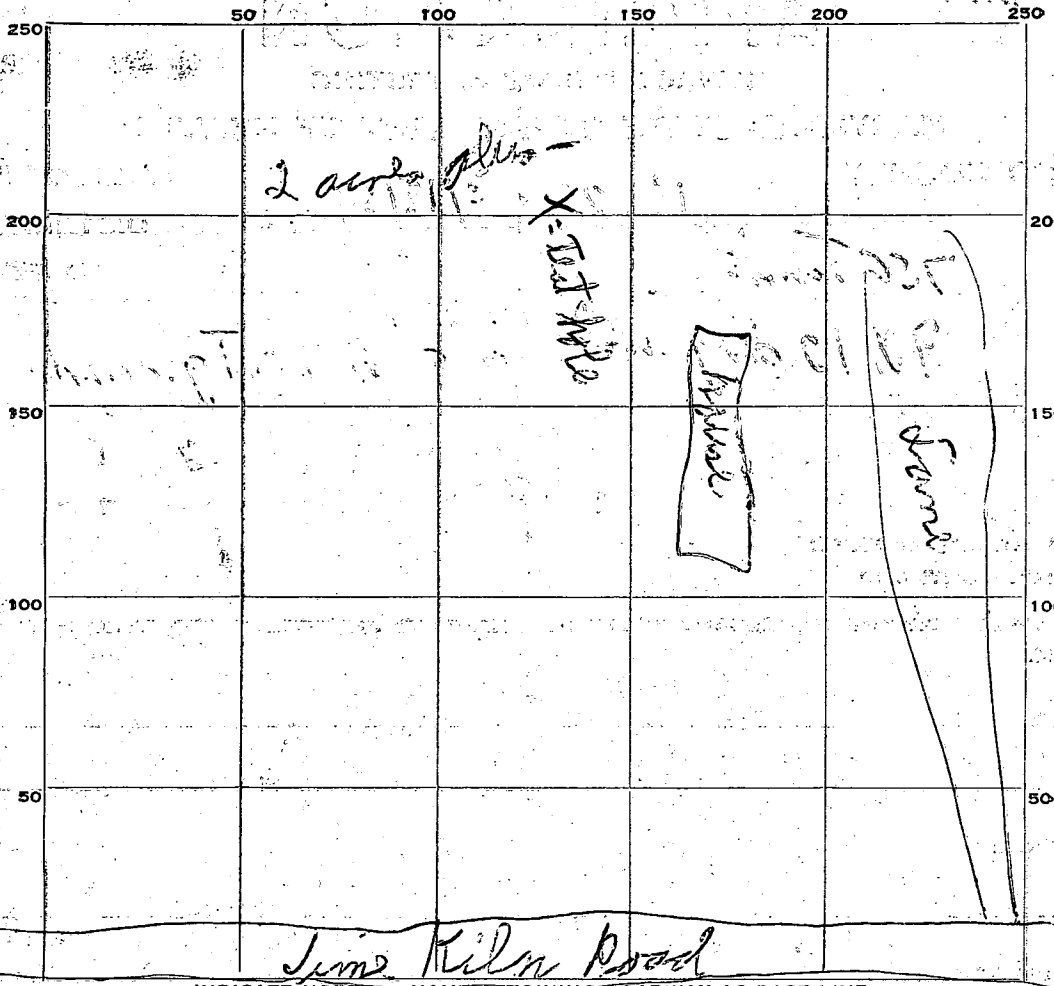

INDICATE NORTH. — NAME ADJOINING ROADWAY AS BASE LINE.

DATE	TEST NO.	DEPTH	PRE-WET		TEST - 1" DROP		TIME
			START	STOP	START	STOP	
3/18/59	1	10	11:38	11:42	11:42	11:47	5

SOIL AUGER FINDING _____

TESTED BY P. W.

REMARKS _____

ALSO PRESENT C. W. Richetto LOT NO. 2