

2/8/83
around 11:30 AM

approved
2-8-83
C. Williams

PERMIT

P 32461
A Repair

SEWAGE DISPOSAL SYSTEM MARYLAND STATE DEPARTMENT OF HEALTH

HOWARD COUNTY
BUREAU OF ENVIRONMENTAL HEALTH
992-2330

ELLICOTT CITY
DISTRICT 1st
DATE 2/7/83

INDEX
01-176986

Jenkins Brothers IS PERMITTED TO INSTALL _____ ALTER X
ADDRESS 10439 Frederick Road, Ellicott City, Md. 21043 PHONE 465-8646

SUBDIVISION _____ ROAD 5233 Kerger Road LOT _____

PROPERTY OWNER Mr. Joe Putgenter
ADDRESS 5233 Kerger Road, Ellicott City, Md. 21043 Phone: 744-5867

IF GARBAGE GRINDER IS USED INCREASE SEPTIC TANK CAPACITY BY 50% AND ABSORPTION AREA BY 22%.

GARBAGE GRINDER? YES _____ NO _____

SEPTIC TANK CAPACITY _____ GALLONS NUMBER OF BEDROOMS _____

REPAIR - Call for an appointment when ground is opened up and Sanitarian will recommend the repair area.

REPLACE STEEL SEPTIC TANK WITH CONCRETE TANK.
2-8-83 C. Williams

BLDG. PERMIT SIGNED AND RETURNED 4/1/90
Serial # 30842
BLDG. PERMIT SIGNED AND RETURNED 12/23/85
Serial # 68294 - Storm Door

PLANS APPROVED BY Palmer F. Wine extend existing septic DATE 2/7/83

- COVER NO WORK UNTIL INSPECTED AND APPROVED.
- NEITHER THE HOWARD COUNTY COUNCIL NOR THE HEALTH DEPARTMENT IS RESPONSIBLE FOR THE SUCCESSFUL OPERATION OF ANY SYSTEM.
- NOTE: IF TRENCH IS USED CALL FOR INSPECTION BEFORE AND AFTER PLACING GRAVEL IN TRENCH.
- NOTE: NO DRY WELL SHALL EXCEED 15 FOOT IN DIAMETER. NO ABSORPTION TRENCH TO EXCEED 100 FEET IN LENGTH.
- NOTE: ALL PIPE FROM HOUSE TO SEPTIC TANK MUST BE CAST IRON OR SCHEDULE 40 PVC OR ABS.
- PERMIT VOID AFTER THREE YEARS.
- NOTE: INSTALL STAND PIPE ON SEPTIC TANK AND DRY WELL. STAND PIPES MUST BE 6 INCHES IN DIAMETER. CAST IRON, CONCRETE OR TERRA COTTA, OR PVC OR ABS ACCEPTED. IF TOP OF SEPTIC TANK IS DEEPER THAN 3 FEET MANHOLE TO GRADE REQUIRED.

***INSTALLER IS RESPONSIBLE FOR OBTAINING FINAL APROVAL ON THIS PERMIT**

X
32461

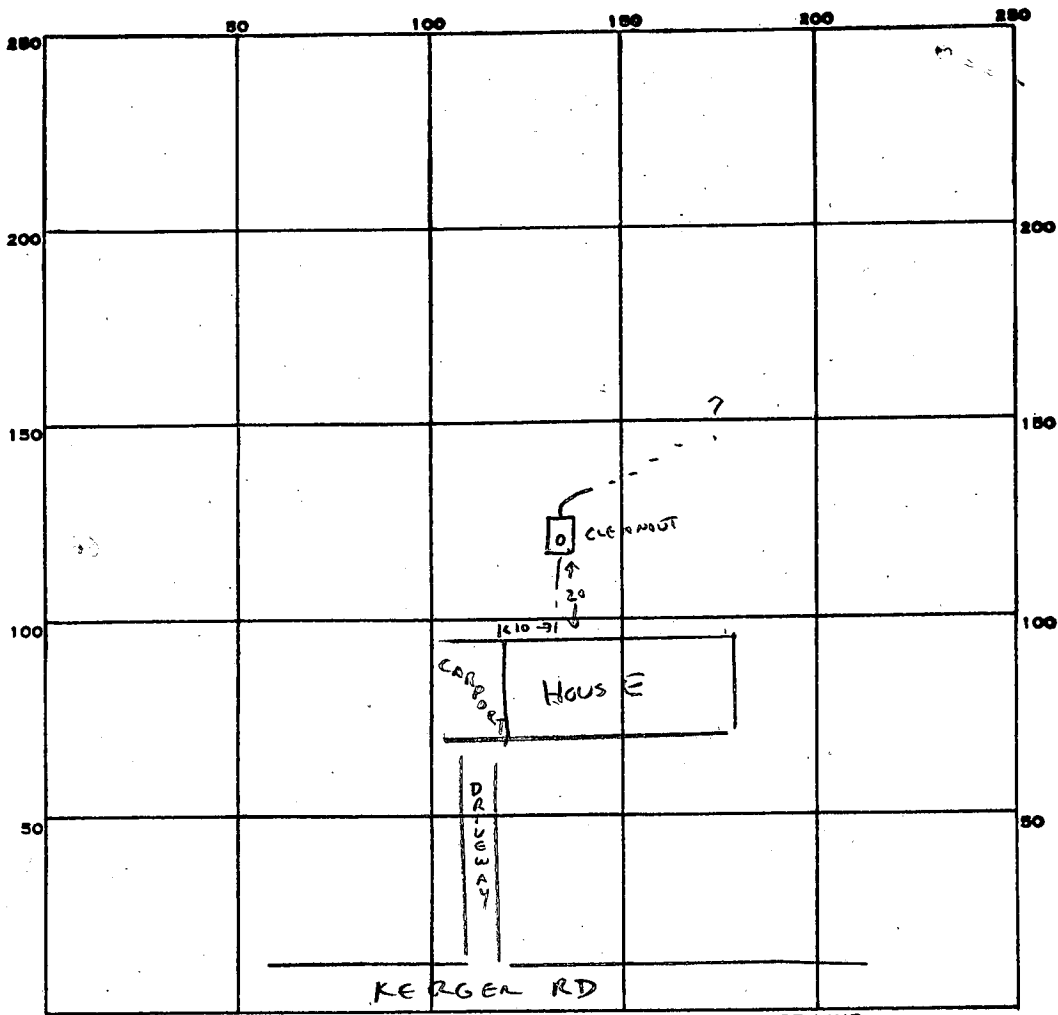

INDICATE NORTH. - NAME ADJOINING ROADWAY AS BASE LINE.

PERMIT CARD

SEPTIC TANK, LEVEL

CLEANOUTS ST

DISTRIBUTION BOX, LEVEL _____

TILE FIELD, DEPTH _____ FT. TRENCH WIDTH _____ FT.

GRAVEL DEPTH _____ IN. TOTAL LENGTH _____ FT.

NUMBER OF TRENCHES _____ TOTAL BOTTOM AREA _____

SEEPAGE PITS, INSIDE DIAMETER _____ FT. DEPTH BELOW INLET _____ FT.

ABSORBENT AREA _____ SQ. FT.

REMARKS INSTALLED REPLACEMENT SEPTIC TANK.

RUNNING
WATER TEST - NO EVIDENCE OF CLOGGING OR OVERFLOW IN DIRECTION
OF DISPOSAL AREA.

BRING CLEANOUT UP TO GRADE. 2-8-83 C. William

DATE SYSTEM APPROVED 2-8-83

INSPECTOR C. William

~~PROPOSED~~ SEPTIC TANK
□

NO IMPACT
ON WELL OR SEPTIC
12/23/85 CWL

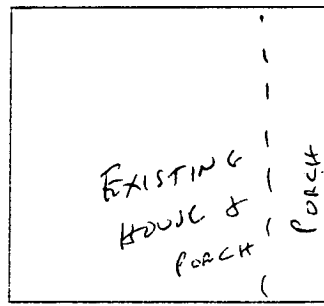

80' APPROX.

KERRER RD



MARTIN J. NIESSNER CONST. INC.
CONTRACTOR

MR + MRS. JOSEPH PUTGENTER
5233 KERGER ROAD
ELLICOTT CITY, MD. 21043

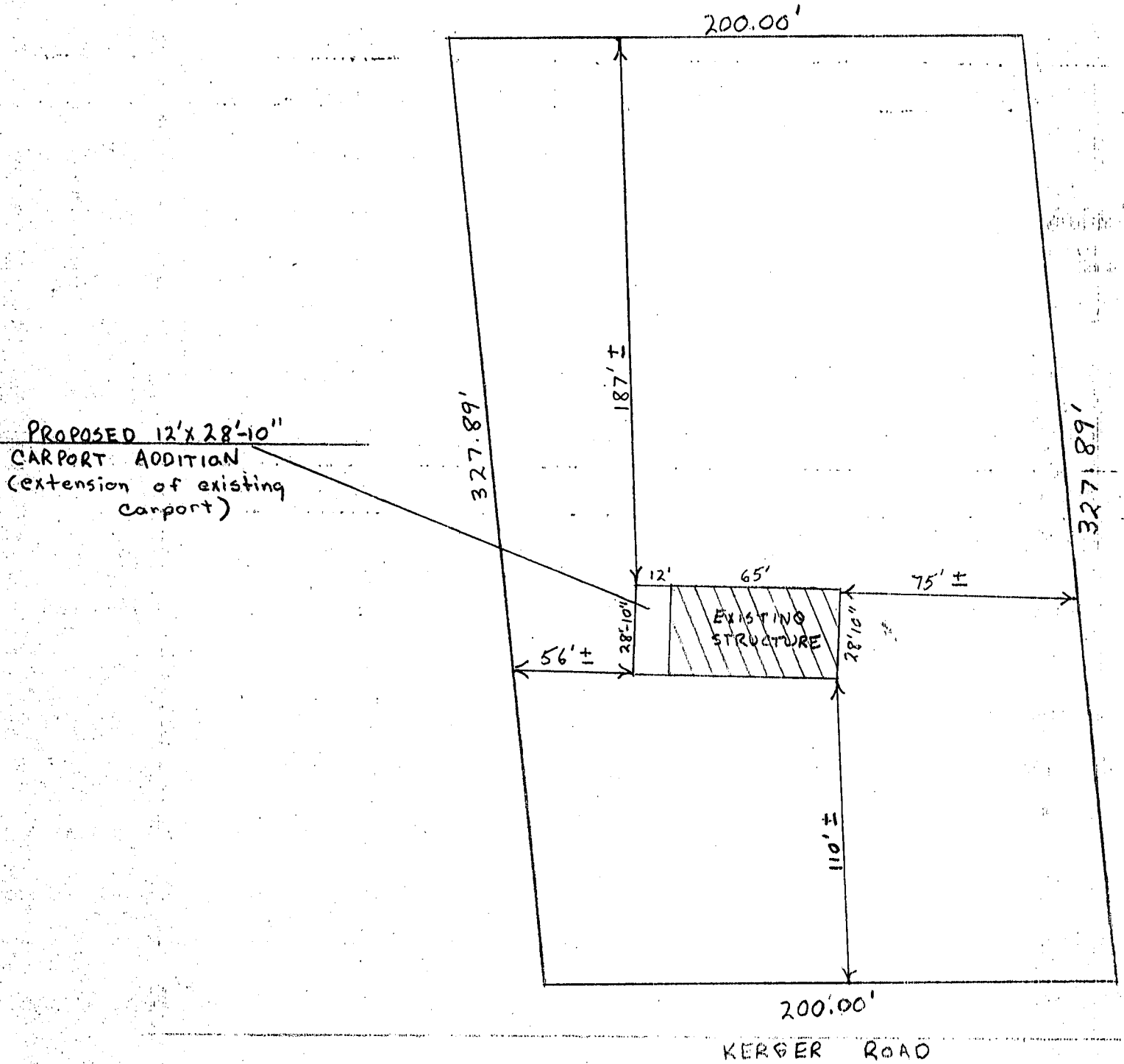

PLOT PLAN Lots 9+10
scale: 1" = 50'