

12/3/82  
Around 10 or 11 A.M.

01-61881

APPROVED  
12/3/82 RH

# PERMIT

SEWAGE DISPOSAL SYSTEM

MARYLAND STATE DEPARTMENT OF HEALTH\*

P 32343

A Repair

HOWARD COUNTY

ELLICOTT CITY

BUREAU OF ENVIRONMENTAL HEALTH  
992-2330

DISTRICT 2nd

INDEX

DATE 12/1/82

Jenkins Brothers IS PERMITTED TO INSTALL \_\_\_\_\_ ALTER X

ADDRESS 10439 Frederick Road, Ellicott City, Md. 21043 PHONE 465-6646

SUBDIVISION \_\_\_\_\_ ROAD 7925 James Avenue LOT \_\_\_\_\_

PROPERTY OWNER Mrs. Marion N. Clark

ADDRESS 7925 James Avenue, Ellicott City, Maryland 21043

IF GARBAGE GRINDER IS USED INCREASE SEPTIC TANK CAPACITY BY 50% AND ABSORPTION AREA BY 22%.

GARBAGE GRINDER? YES \_\_\_\_\_ NO \_\_\_\_\_

SEPTIC TANK CAPACITY 1000 GALLONS concrete NUMBER OF BEDROOMS \_\_\_\_\_

REPAIR - Replace existing septic tank with new septic tank.

PLANS APPROVED BY Palmer F. Wine DATE 12/1/82

COVER NO WORK UNTIL INSPECTED AND APPROVED.

NEITHER THE HOWARD COUNTY COUNCIL NOR THE HEALTH DEPARTMENT IS RESPONSIBLE FOR THE SUCCESSFUL OPERATION OF ANY SYSTEM.

NOTE: IF TRENCH IS USED CALL FOR INSPECTION BEFORE AND AFTER PLACING GRAVEL IN TRENCH.

NOTE: NO DRY WELL SHALL EXCEED 15 FOOT IN DIAMETER. NO ABSORPTION TRENCH TO EXCEED 100 FEET IN LENGTH.

NOTE: ALL PIPE FROM HOUSE TO SEPTIC TANK MUST BE CAST IRON OR SCHEDULE 40 PVC OR ABS.

PERMIT VOID AFTER THREE YEARS.

NOTE: INSTALL STAND PIPE ON SEPTIC TANK AND DRY WELL. STAND PIPES MUST BE 6 INCHES IN DIAMETER. CAST IRON, CONCRETE OR TERRA COTTA, OR PVC OR ABS ACCEPTED. IF TOP OF SEPTIC TANK IS DEEPER THAN 3 FEET MANHOLE TO GRADE REQUIRED.

**\*INSTALLER IS RESPONSIBLE FOR OBTAINING FINAL APPROVAL ON THIS PERMIT**

\*CALL 992-2330 FOR INSPECTION OF SEPTIC SYSTEMS.

EH - 2-1082

X  
32343

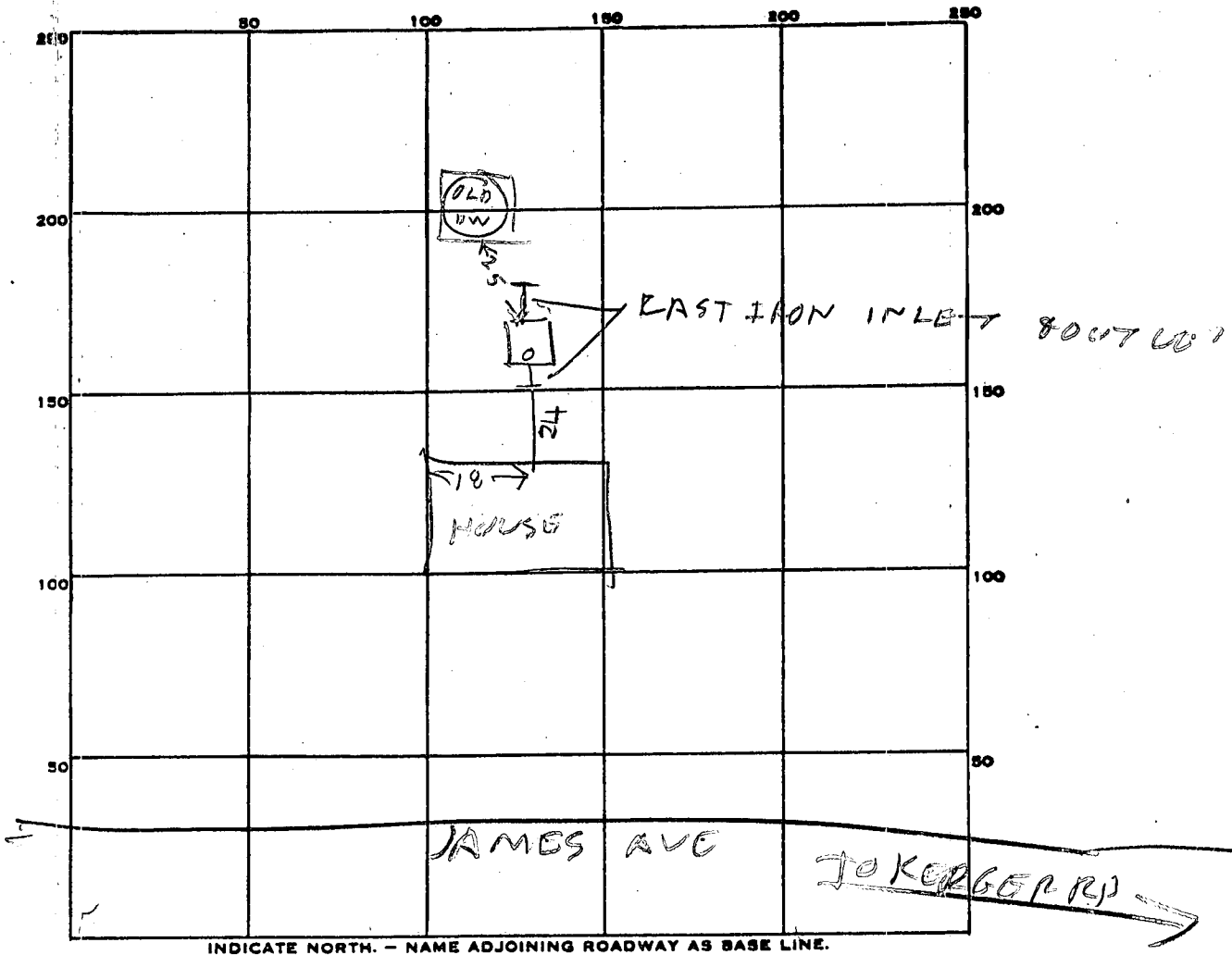

PERMIT CARD YES

SEPTIC TANK, LEVEL OK CONCRETE 1000 CLEANOUTS OK

DISTRIBUTION BOX, LEVEL \_\_\_\_\_

TILE FIELD, DEPTH \_\_\_\_\_ FT. TRENCH WIDTH \_\_\_\_\_ FT.

GRAVEL DEPTH \_\_\_\_\_ IN. TOTAL LENGTH \_\_\_\_\_ FT.

NUMBER OF TRENCHES \_\_\_\_\_ TOTAL BOTTOM AREA \_\_\_\_\_

SEEPAGE PITS, INSIDE DIAMETER \_\_\_\_\_ FT. DEPTH BELOW INLET \_\_\_\_\_ FT.

ABSORBENT AREA \_\_\_\_\_ SQ. FT.

REMARKS

12/3/82 OLD STEEL TANK RUSTED OUT  
AFTER 27 YEARS RIT  
CITY WATER HERE

DATE SYSTEM APPROVED

12/3/82

INSPECTOR

Raymond Dodge