

5/1/85

03-296741

approved
5/1/85 CWilhelm

PERMIT

P 35360

A Repair

SEWAGE DISPOSAL SYSTEM

MARYLAND STATE DEPARTMENT OF HEALTH*

HOWARD COUNTY

ELLICOTT CITY

BUREAU OF ENVIRONMENTAL HEALTH

DISTRICT _____

~~992-2330~~

461-9933

INDEXED

DATE 4/26/85

Carroll County Septic Service IS PERMITTED TO INSTALL _____ ALTER X

ADDRESS Rte 199, Marvotsville PHONE 442-2235

SUBDIVISION Indian Hills Estates ROAD 12585 Indian Hill Drive LOT 3

PROPERTY OWNER Blader

ADDRESS 12585 Indian Hill Drive

IF GARBAGE GRINDER IS USED INCREASE SEPTIC TANK CAPACITY BY 50% AND ABSORPTION AREA BY 22%.

GARBAGE GRINDER? YES _____ NO _____

SEPTIC TANK CAPACITY _____ GALLONS NUMBER OF BEDROOMS _____

Call for inspection before starting work for specifications for repair job

PLANS APPROVED BY F. Skinner DATE 4/26/85

COVER NO WORK UNTIL INSPECTED AND APPROVED.

NEITHER THE HOWARD COUNTY COUNCIL NOR THE HEALTH DEPARTMENT IS RESPONSIBLE FOR THE SUCCESSFUL OPERATION OF ANY SYSTEM.

NOTE: IF TRENCH IS USED CALL FOR INSPECTION BEFORE AND AFTER PLACING GRAVEL IN TRENCH.

NOTE: NO DRY WELL SHALL EXCEED 15 FOOT IN DIAMETER. NO ABSORPTION TRENCH TO EXCEED 100 FEET IN LENGTH.

NOTE: ALL PIPE FROM HOUSE TO SEPTIC TANK MUST BE CAST IRON OR SCHEDULE 40 PVC OR ABS.

PERMIT VOID AFTER THREE YEARS.

NOTE: INSTALL STAND PIPE ON SEPTIC TANK AND DRY WELL. STAND PIPES MUST BE 6 INCHES IN DIAMETER. CAST IRON, CONCRETE OR TERRA COTTA, OR PVC OR ABS ACCEPTED. IF TOP OF SEPTIC TANK IS DEEPER THAN 3 FEET MANHOLE TO GRADE REQUIRED.

***INSTALLER IS RESPONSIBLE FOR OBTAINING FINAL APPROVAL ON THIS PERMIT**

*CALL 992-2330 FOR INSPECTION OF SEPTIC SYSTEMS.

EH - 2-1082

A 35360
Repair

12585 INDIAN HILL DRIVE

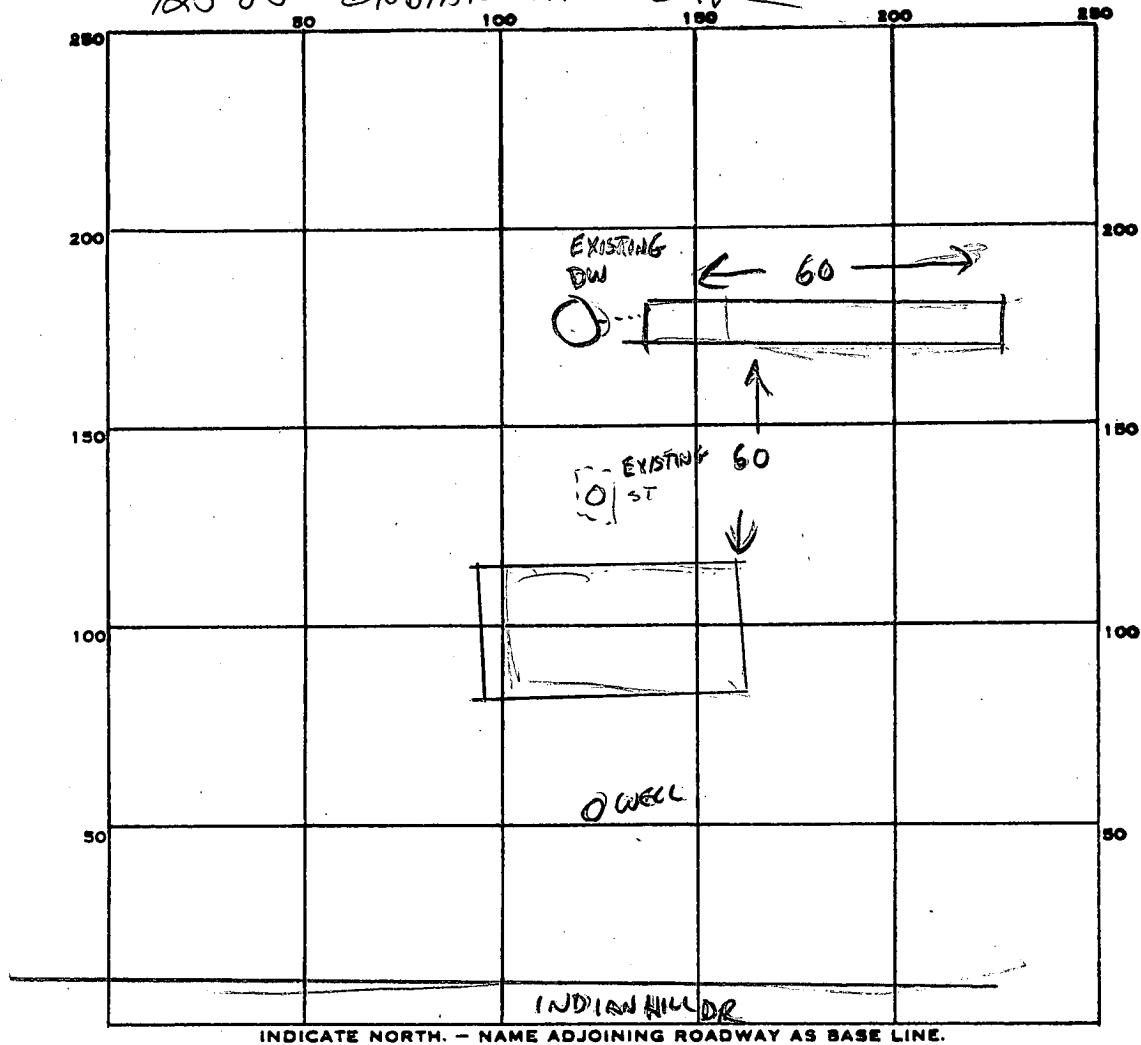

PERMIT CARD ✓

SEPTIC TANK, LEVEL EXISTING

CLEANOUTS DW ✓ ST ✓

DISTRIBUTION BOX, LEVEL _____

TILE FIELD, DEPTH 10 FT. TRENCH WIDTH 2 FT.

GRAVEL DEPTH 6 FT IN. TOTAL LENGTH 60 FT.

NUMBER OF TRENCHES 1 ONBSIDEWALL TOTAL BOTTOM AREA 360

Drywell SEEPAGE PITS, INSIDE DIAMETER EXISTING FT. DEPTH BELOW INLET _____ FT.

ABSORBENT AREA 360 + EXISTING DRYWELL SQ. FT.

REMARKS MICA LUAM SOIL, 4'-10'

DATE SYSTEM APPROVED

05/11/85

INSPECTOR

C. Waller