

TaxID 06 431690

10-2-87

~~10-1-87~~

DATE  
AAA

# PERMIT

SEWAGE DISPOSAL SYSTEM

MARYLAND STATE DEPARTMENT OF HEALTH

HOWARD COUNTY  
BUREAU OF ENVIRONMENTAL HEALTH  
461-9933

INDEXED

P 40226

A 36289

DISTRICT 6th

DATE 10/2/87

DATE SYSTEM APPROVED 10/2/87

INSPECTOR S. Abel

Herman Sirk

IS PERMITTED TO INSTALL X ALTER

ADDRESS 2555 Jennings Chapel Road, Woodbine, Maryland PHONE 489-4724

SUBDIVISION Kindler ROAD 7681 Kindler Road LOT A

PROPERTY OWNER Paul Callender

ADDRESS \_\_\_\_\_

IF GARBAGE GRINDER IS USED INCREASE SEPTIC TANK CAPACITY BY 50% AND ABSORPTION AREA BY 22%.

GARBAGE GRINDER? YES \_\_\_\_\_ NO X

SEPTIC TANK CAPACITY 1000 GALLONS NUMBER OF BEDROOMS 3

TRENCHES - 180 ~~210~~ sq. ft. per bedroom. Trench to be 2 feet wide. Inlet 4 feet below original grade. Bottom maximum depth 9 feet below original grade. Effective area begins at 4 feet below original grade. 5 feet of stone below distribution pipe.

LOCATION - Place the distribution box 110 feet from the front (130') lot line and 45 feet from the right (252.71') lot line as seen when facing the lot from Kindler Road. Run trenches on contour toward left lot line.

NOTE - No trench to exceed 100 feet in length. Provide 6" - 8" diameter cleanout and cap to grade or above on septic tank.

04/5N

PLANS APPROVED BY S. Abel DATE 3/13/87

COVER NO WORK UNTIL INSPECTED AND APPROVED.

NEITHER THE HOWARD COUNTY COUNCIL NOR THE HEALTH DEPARTMENT IS RESPONSIBLE FOR THE SUCCESSFUL OPERATION OF ANY SYSTEM.

NOTE: CLEANOUT REQUIRED EVERY 70 FEET OF SEWER LINE AND/OR AT 90° SWEEPS IN LINES FROM HOUSE TO DRAIN FIELDS.

NOTE: ALL PARTS OF SEPTIC SYSTEMS (I.E., TANK, DISTRIBUTION BOX, TRENCHES) TO BE 100 FEET FROM WELL. (UNLESS OTHERWISE SPECIFICALLY AUTHORIZED)

NOTE: IF DEEP TRENCHES ARE USED CALL FOR INSPECTION BEFORE AND AFTER PLACING GRAVEL IN TRENCHES.

NOTE: NO DRY WELL SHALL EXCEED 15 FOOT IN DIAMETER. NO ABSORPTION TRENCH TO EXCEED 100 FEET IN LENGTH.

NOTE: ALL PIPE FROM HOUSE TO SEPTIC TANK MUST BE CAST IRON OR SCHEDULE 40 PVC OR ABS.

PERMIT VOID AFTER TWO YEARS.

NOTE: INSTALL STAND PIPE ON SEPTIC TANK AND DRY WELL. STAND PIPES MUST BE 6 INCHES IN DIAMETER. CAST IRON, CONCRETE OR TERRA COTTA OR PVC OR ABS ACCEPTED. IF TOP OF SEPTIC TANK IS DEEPER THAN 3 FEET, MANHOLE TO GRADE REQUIRED.

NOTE: DISTRIBUTION BOXES MUST HAVE BAFFLES.

**\*INSTALLER IS RESPONSIBLE FOR OBTAINING FINAL APPROVAL ON THIS PERMIT**

\*CALL 461-9933 FOR INSPECTION OF SEPTIC SYSTEMS.

EH - 2-1186

A 36289

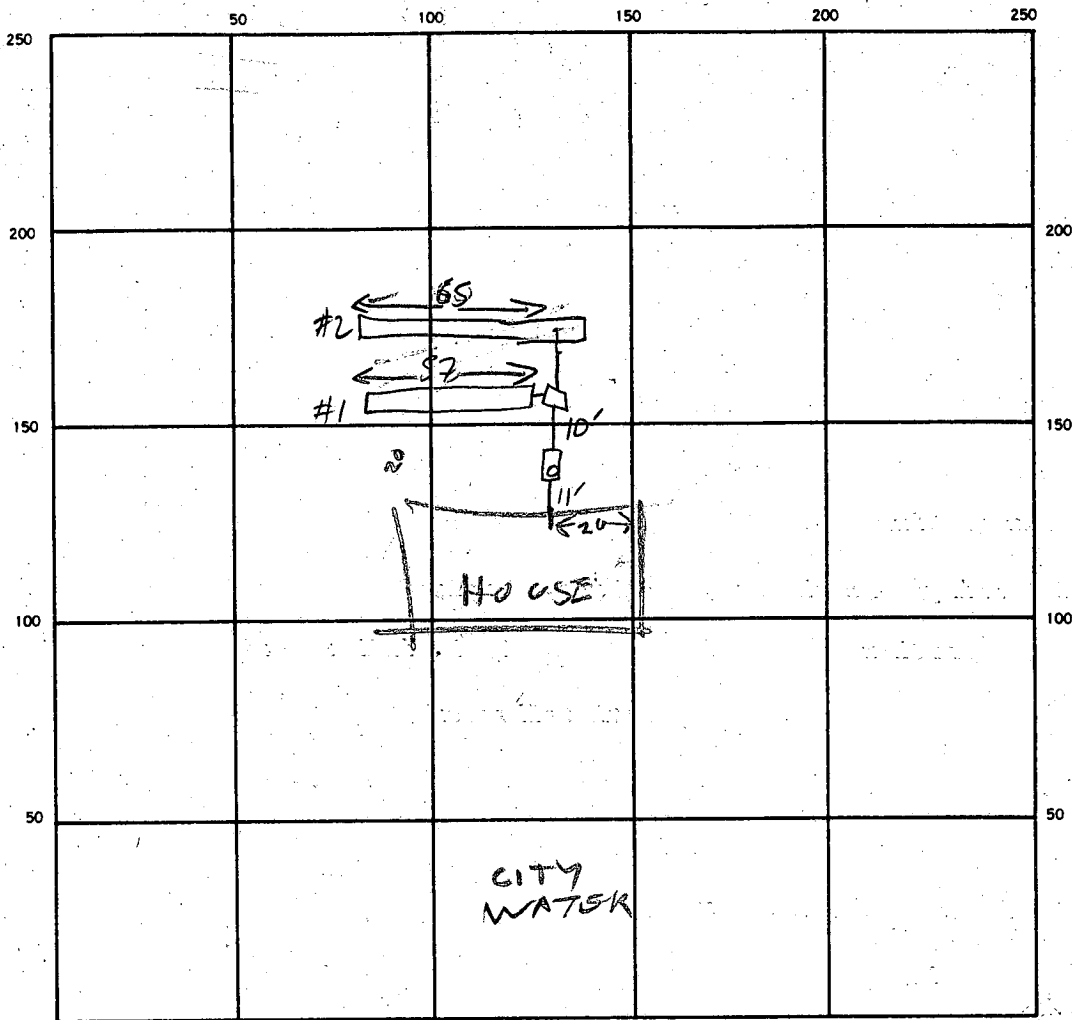

2 1803/40  
 5 40  
 6 108/540

INDICATE NORTH - NAME ADJOINING ROADWAY AS BASE LINE

KINDER RD

SEPTIC TANK LEVEL ✓ 100641 CLEANOUTS ✓

DISTRIBUTION BOX LEVEL ✓

DRAIN FIELD/TILE FIELD. DEPTH 9 FT. TRENCH WIDTH 2 FT. INLET DEPTH 4 FT.

EFFECTIVE GRAVEL DEPTH 5 5 FT. TOTAL LENGTH 57 65 FT. TLF 122

NUMBER OF TRENCHES 2 ONE SIDEWALL/BOTTOM AREA 610 SQ. FT.

DRYWELL INSIDE DIAMETER — FT. EFFECTIVE DEPTH BELOW INLET — FT.

ABSORBENT AREA 610 SQ. FT.

REMARKS 10/1/87 - TRENCH #1 DUG LOCATION OK  
ADD STONE TO TRENCH #1 DIG TRENCH #2 & ADD PART  
OF STONE INSTALL TANK & BOX & CALL RA

DATE SYSTEM APPROVED 10-2-87 INSPECTOR S. Abel

# APPLICATION

SEWAGE DISPOSAL TESTING

STATE OF MARYLAND - DEPARTMENT OF HEALTH AND MENTAL HYGIENE

A 36289  
P \_\_\_\_\_

HOWARD COUNTY HEALTH DEPARTMENT  
ENVIRONMENTAL HEALTH SERVICES  
P. O. BOX 476 ELLICOTT CITY, MARYLAND 21043  
TELEPHONE: 992-2330

DISTRICT \_\_\_\_\_  
DATE 12/2/85

TO: THE COUNTY HEALTH OFFICER  
ELLICOTT CITY, MARYLAND

I HEREBY APPLY FOR THE NECESSARY TEST IN ORDER TO CONSTRUCT (OR RECONSTRUCT) A SEWAGE DISPOSAL SYSTEM.

PROPERTY OWNER HAZEL L. Templeton

ADDRESS 7687 Kindler Rd. LAUREL, Md. 20707 PHONE 725-6679

PROPERTY LOCATION:

SUBDIVISION \_\_\_\_\_ LOT NO. Lot A

ROAD AND DESCRIPTION Kindler Road

SIZE OF LOT 43,130<sup>sq</sup> TYPE BLDG. Res. Home  
(NUMBER OF BEDROOMS)

THE SYSTEM INSTALLED UNDER THIS APPLICATION IS ACCEPTABLE ONLY UNTIL PUBLIC FACILITIES BECOME AVAILABLE. I FULLY UNDERSTAND THE FEE CONNECTED WITH THE FILING OF THIS PERC TEST APPLICATION IS NON-REFUNDABLE UNDER ANY CIRCUMSTANCES. I ALSO AGREE TO COMPLY WITH ALL M.O.S.H.A. REQUIREMENTS IN TESTING THIS LOT.

Hazel L. Templeton  
(SIGNATURE OF APPLICANT)

APPROVED BY \_\_\_\_\_ FOR \_\_\_\_\_ DATE \_\_\_\_\_

REJECTED BY \_\_\_\_\_ FOR \_\_\_\_\_ DATE \_\_\_\_\_

HOLD PENDING FURTHER TESTS \_\_\_\_\_ DATE \_\_\_\_\_

REASONS FOR REJECTION OR HOLDING \_\_\_\_\_

## THIS IS NOT A PERMIT

SEE PLOT

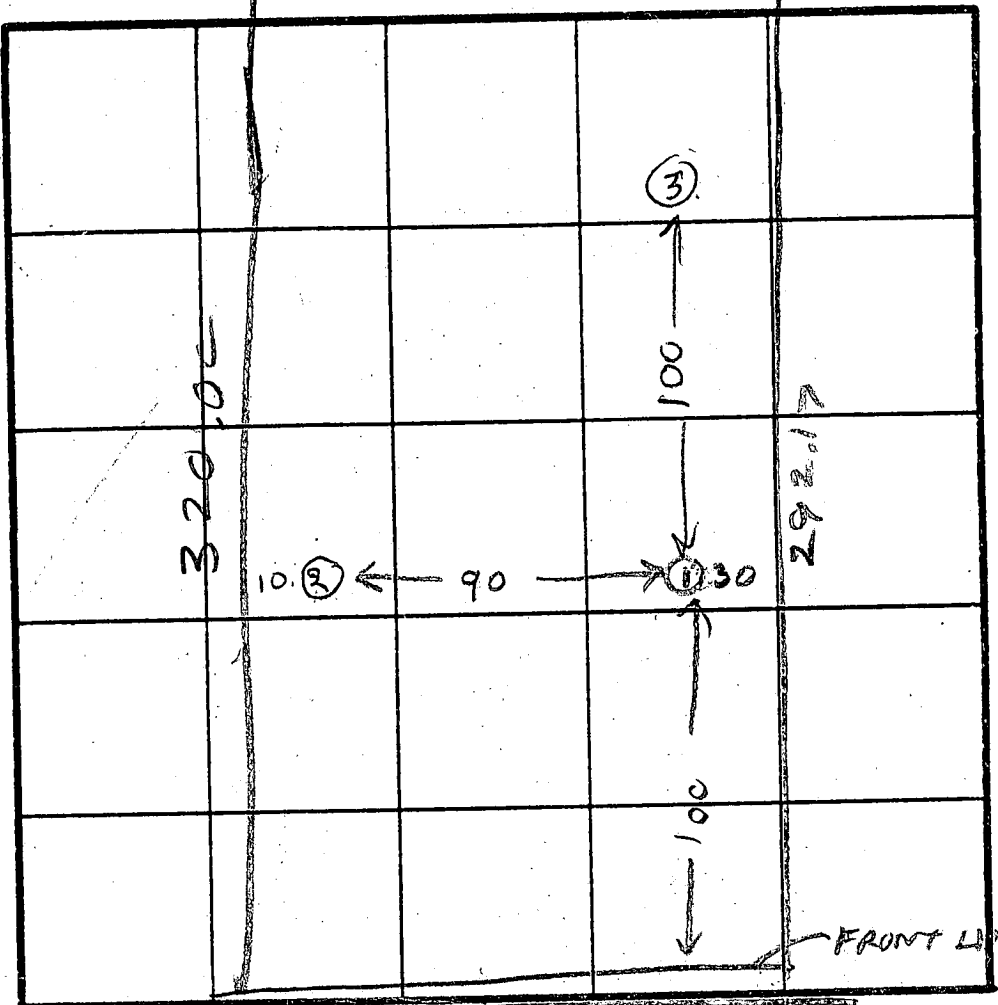

HOLE ELEVATION  
 ①② = HIGH  
 ③ = LOW

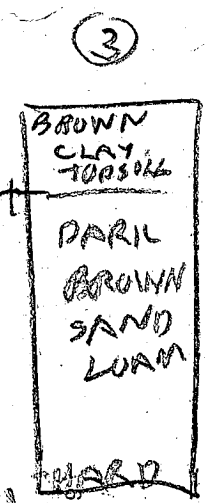
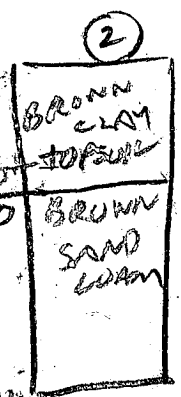
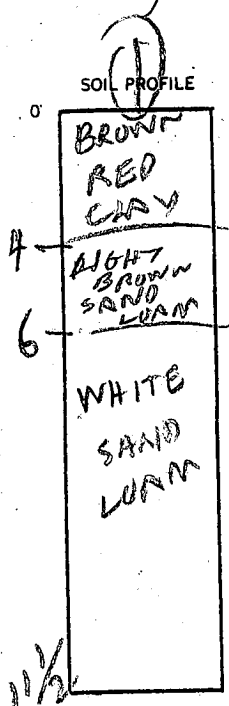

KINDLER RD

DATE	TEST NO.	DEPTH	PRE-WET		TEST - 1" DROP		TIME
			START	STOP	START	STOP	
3/29/86	1 S	5.5	258	306	306	325	19
	1 D	8.5	257	301	301	305	4
3/27/86	IV	11.5	LOOKS OK		OK BELOW 5 FT		
	2P	8.5	315	317	317	320	3
	2S	5	315	344	OK BELOW 6 FT		
	2V	11.5	LOOKS OK		BELOW 6 FT		
	2M	7	400	405	405	410	5
	3 S	5	350	353	353	356	3
	3 D	8	350	356	356	400	14
	3V	11	LOOKS OK		BELOW 4 FT		

REMARKS LOT ON RECORD MAY HAVE BEEN PERCED UNDER OLD REGULATIONS

TYPE OF SOIL \_\_\_\_\_ HAZEL TEMPLETON OWNER

TESTED BY B HODGES ALSO PRESENT H. SIRK & JR

