

5/12/86
Lunchtime

5/12/86
OK +
completed

TAX# 368650
0534650

PERMIT

P 37016
A REPAIR

SEWAGE DISPOSAL SYSTEM

MARYLAND STATE DEPARTMENT OF HEALTH*

HOWARD COUNTY
BUREAU OF ENVIRONMENTAL HEALTH
~~X 992-2330X~~
461-9933

INDEXED

ELLICOTT CITY
DISTRICT _____
DATE 5/22/86

Jack Fuock IS PERMITTED TO INSTALL _____ ALTER X

ADDRESS _____ PHONE 988-9270

SUBDIVISION LOT 14 P. 195 MAP 41 BLK 15. ROAD 11501 John Hopkins LOT _____

PROPERTY OWNER STEPHANIE Nagurny STRAB
ADDRESS 11501 John Hopkins Road

IF GARBAGE GRINDER IS USED INCREASE SEPTIC TANK CAPACITY BY 50% AND ABSORPTION AREA BY 22%.

GARBAGE GRINDER? YES _____ NO X

SEPTIC TANK CAPACITY _____ GALLONS NUMBER OF BEDROOMS 3 presently
4 or 5

TRENCHES - CALL FOR INSPECTION WHEN GROUND IS OPENED UP SO SANITARIAN CAN RECOMMEND

REPAIR.

BP # 69984 (2 story slab on grade adding 4th bedroom, 2 full baths
(4/25/86 signed off) (+ maybe 5th))

Replace 1000 gal tank w/ 1500 gal (1000 ^{to be} filled in + left)
add extra trench off existing trench + d.w. to get ↑ #
"Y" off existing trench / D.W. to get new trench. soils silty/sandy
near lawn

PLANS APPROVED BY C. Williams DATE 5/09/86

COVER NO WORK UNTIL INSPECTED AND APPROVED.

NEITHER THE HOWARD COUNTY COUNCIL NOR THE HEALTH DEPARTMENT IS RESPONSIBLE FOR THE SUCCESSFUL OPERATION OF ANY SYSTEM.

NOTE: IF TRENCH IS USED CALL FOR INSPECTION BEFORE AND AFTER PLACING GRAVEL IN TRENCH.

NOTE: NO DRY WELL SHALL EXCEED 15 FOOT IN DIAMETER. NO ABSORPTION TRENCH TO EXCEED 100 FEET IN LENGTH.

NOTE: ALL PIPE FROM HOUSE TO SEPTIC TANK MUST BE CAST IRON OR SCHEDULE 40 PVC OR ABS.

PERMIT VOID AFTER THREE YEARS.

NOTE: INSTALL STAND PIPE ON SEPTIC TANK AND DRY WELL. STAND PIPES MUST BE 6 INCHES IN DIAMETER. CAST IRON, CONCRETE OR TERRA COTTA, OR PVC OR ABS ACCEPTED. IF TOP OF SEPTIC TANK IS DEEPER THAN 3 FEET MANHOLE TO GRADE REQUIRED.

*INSTALLER IS RESPONSIBLE FOR OBTAINING FINAL APROVAL ON THIS PERMIT

*CALL 992-2330 FOR INSPECTION OF SEPTIC SYSTEMS.

EH - 2-1082

37016
A Repair

OAK CREST RD

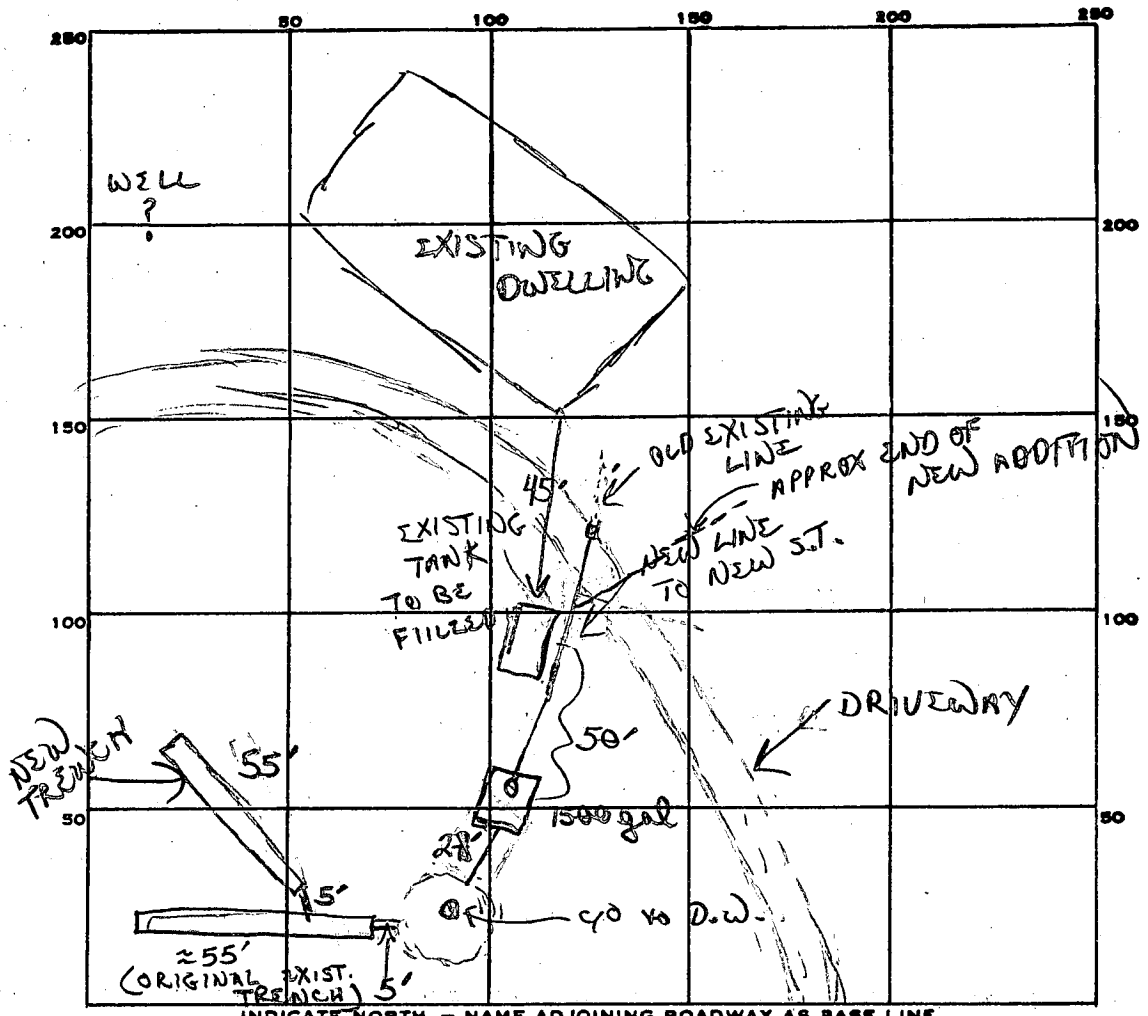

INDICATE NORTH. - NAME ADJOINING ROADWAY AS BASE LINE.

JOHNS NEPRINS RD

PERMIT CARD _____

SEPTIC TANK, LEVEL 1500 gal (replacing orig 1000 gal) CLEANOUTS 1 S.T. existing on D.W.

DISTRIBUTION BOX, LEVEL _____

TILE FIELD, DEPTH 11 FT. TRENCH WIDTH 2 FT.

GRAVEL DEPTH 7 1/2 FT. TOTAL LENGTH 50 FT.

NUMBER OF TRENCHES 1 TOTAL BOTTOM AREA 385

55
7.0
385
385

SEEPAGE PITS, INSIDE DIAMETER ? FT. DEPTH BELOW INLET ? FT.

ABSORBENT AREA 385 SQ. FT.

existing D.W.

REMARKS OK to fill in 1000 gal existing tank + replace w/ 1500 gal
OK to add new trench off existing DW/trench to accommodate
↑ # of bedrooms
OK to add stone pipe paper to trench, OK to cover trench
& all work

DATE SYSTEM APPROVED 5/12/86 INSPECTOR B. N. Nipon