

12/28/94
2 PM
12/29/94
12:00

05 - 411254

PERMIT

SEWAGE DISPOSAL SYSTEM

DEPARTMENT OF HEALTH AND MENTAL HYGIENE

INDEXED

P 50454

A 37072

DISTRICT 5th

DATE 12/20/94

DATE SYSTEM APPROVED 12/29/94

INSPECTOR Am

HOWARD COUNTY HEALTH DEPARTMENT
BUREAU OF ENVIRONMENTAL HEALTH
~~XXXX-XXXX~~ 313-2640

Alan Whitworth ? IS PERMITTED TO INSTALL X ALTER

ADDRESS Whitworth excavating? PHONE 410-531-6038

SUBDIVISION Highland Meadows LOT 9 ROAD 13317 Long Leaf Drive

PROPERTY OWNER Mark G and Cheryl Nitz **BUILDING PERMIT SIGNED**

AND RETURNED

713-05 B 00 154947-DECK

SEPTIC TANK CAPACITY 1250 GALLONS

NUMBER OF BEDROOMS 4

3
180
720

180 SQUARE FEET PER BEDROOM

LINEAR FEET OF TRENCH REQUIRED 180

TRENCHES - Trench to be 2 feet wide. Inlet 4 feet below original grade. Bottom maximum depth 8 feet below original grade. Effective area begins at 4 feet below original grade. 4 feet of stone below distribution pipe.

LOCATION - Place the distribution box 160 feet from the front lot line and 140 feet from the left side of the lot as seen when facing the lot from Long Leaf Court.

Run the trenches along contour toward Long Leaf Court. MAINTAIN A MINIMUM OF 100 FEET TO ALL WELLS. Maintain 25 Ft minimum between septic trenches and bedding cuts

NOTES - No trench to exceed 100 feet in length. Provide 6" - 8" diameter cleanout and cap to grade or above on septic tank.

Maintain 25 FT trench to cut distance, topseamed s.t. can be 10-15 FT from cut
Use a topseam tank preferably, and begin first trench on contour at as high an elevation as possible.

PLANS APPROVED BY Raymond Hodges/Jane E. Nadeau REVISED DATE 02/08/94

COVER NO WORK UNTIL INSPECTED AND APPROVED

NEITHER THE HOWARD COUNTY COUNCIL NOR THE HEALTH DEPARTMENT IS RESPONSIBLE FOR THE SUCCESSFUL OPERATION OF ANY SYSTEM

NOTE: CLEANOUT REQUIRED EVERY 70 FEET OF SEWER LINE AND/OR AT 90° SWEEPS IN LINES FROM HOUSE TO DRAIN FIELDS, 90° ELBOWS NOT ACCEPTABLE.

NOTE: ALL PARTS OF SEPTIC SYSTEMS (I.E. TANK, DISTRIBUTION BOX TRENCHES) TO BE 100 FEET FROM WELL (UNLESS OTHERWISE SPECIFICALLY AUTHORIZED)

NOTE: IF DEEP TRENCH(ES) ARE USED CALL FOR INSPECTION BEFORE AND AFTER PLACING GRAVEL IN TRENCH(ES)

NOTE: NO DRY WELL SHALL EXCEED 15 FOOT IN DIAMETER NO ABSORPTION TRENCH TO EXCEED 100 FEET IN LENGTH

NOTE: ALL PIPE FROM HOUSE TO SEPTIC TANK MUST BE CAST IRON OR SCHEDULE 35/40 PVC OR ABS

PERMIT VOID AFTER TWO YEARS

NOTE: INSTALL STAND PIPE ON SEPTIC TANK AND DRY WELL STAND PIPES MUST BE 6 INCHES IN DIAMETER CAST IRON. CONCRETE OR TERRA COTTA OR PVA OR ABS ACCEPTED. IF TOP OF SEPTIC TANK IS DEEPER THAN 3 FEET. MANHOLE TO GRADE REQUIRED.

NOTE: DISTRIBUTION BOXES MUST HAVE BAFFLES

***INSTALLER IS RESPONSIBLE FOR OBTAINING FINAL APPROVAL ON THIS PERMIT**

A 37072

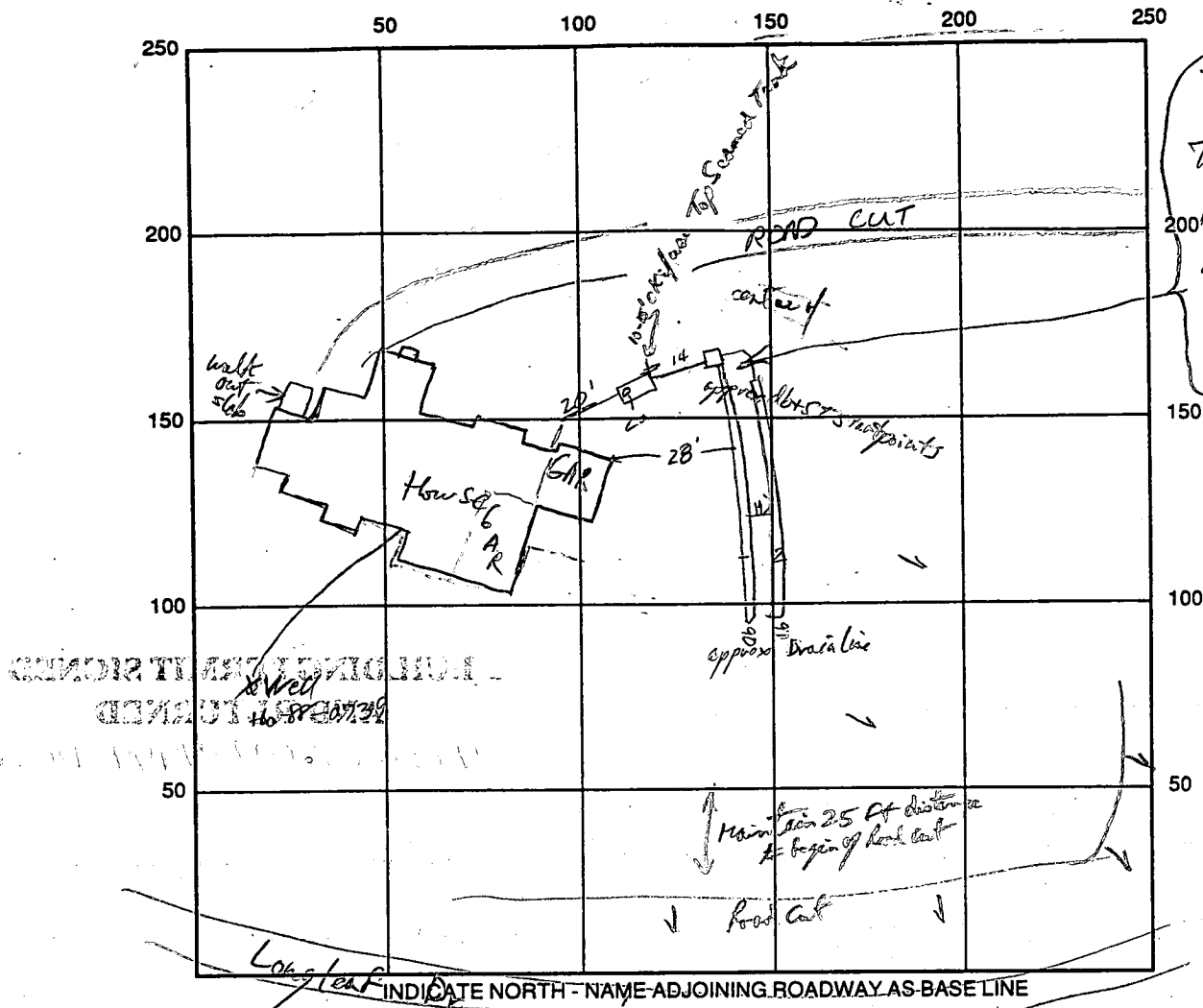

INDICATE NORTH - NAME ADJOINING ROADWAY AS BASE LINE

SEPTIC TANK LEVEL OK 1500 top seam CLEANOUTS OK

DISTRIBUTION BOX LEVEL OK baffle

DRAIN FIELD/TITLE DEPTH 8 FT. TRENCH WIDTH 2' FT. INLET DEPTH 4' FT.

EFFECTIVE GRAVEL DEPTH 4 FT. TOTAL LENGTH 91 FT. = 181

NUMBER OF TRENCHES 2 ONE SIDEWALL/BOTTOM AREA 77.4 SQ. FT. $\frac{90}{15} \frac{91}{4} = \frac{824}{400}$

DRYWALL INSIDE DIAMETER _____ FT. EFFECTIVE DEPTH BELOW INLET _____ FT.

ABSORBENT AREA _____ SQ. FT.

REMARKS: 12/29/94 OK to stone trenches 1 & 2 Call for imp Au

12/29/94 OK to cover all work final Au

DATE SYSTEM APPROVED 12/29/94 INSPECTOR Amy McMullen

APPLICATION

PERCOLATION TESTING.

A 37073

P _____

HOWARD COUNTY HEALTH DEPARTMENT
BUREAU OF ENVIRONMENTAL HEALTH
P.O. BOX 476 ELLICOTT CITY, MARYLAND 21043
TELEPHONE: 461-9933

DISTRICT _____

DATE _____

TO: THE COUNTY HEALTH OFFICER
ELLICOTT CITY, MARYLAND

I, HEREBY, APPLY FOR THE NECESSARY TEST IN ORDER TO CONSTRUCT (OR RECONSTRUCT) A SEWAGE DISPOSAL SYSTEM.

PROPERTY OWNER MARK G and Cheryl Nitz Brighton Dam Limited Partnership Highland Meadows Estates - 428 - 0200
6228 Clearwood Road
ADDRESS Bethesda, MD 20817 PHONE 301-229-8838

PROSPECTIVE BUYER Celta Corp.
101 Chestnut Street, Suite 125
ADDRESS Gaithersburg, MD 20877 PHONE 301-948-2918

PROPERTY LOCATION:

SUBDIVISION Highland Meadows LOT NO. 13
ROAD AND DESCRIPTION Highland Road at Brighton Dam Road 13917 LONG LEAF DR

TAX MAP 34 PARCEL # 169

SIZE OF LOT 3 AC + TYPE BLDG. SFD
(SINGLE FAMILY DWELLING OR COMMERCIAL)

BLDG. PERMIT SIGNED AND RETURNED 10/17/89 EXPIRED 2-94
Serial # 30795 - SFD - 4 Bedroom

THE SYSTEM INSTALLED UNDER THIS APPLICATION IS ACCEPTABLE ONLY UNTIL PUBLIC FACILITIES BECOME AVAILABLE. I FULLY UNDERSTAND THE FEE CONNECTED WITH THE FILING OF THIS PERC TEST APPLICATION IS NON-REFUNDABLE UNDER ANY CIRCUMSTANCES. I ALSO AGREE TO COMPLY WITH ALL M.O.S.H.A. REQUIREMENTS IN TESTING THIS LOT.

APPROVED BY BH FOR TRENCH DATE 10/17/89
(SIGNATURE OF APPLICANT)

REJECTED BY _____ FOR _____ DATE _____

HOLD PENDING FURTHER TESTS _____ DATE _____

REASONS FOR REJECTION OR HOLDING 6/3/86 Perc OK Hold for Plat
10/17/89 TRENCH SPECS WRITTEN

BLDG. PERMIT SIGNED AND RETURNED 7/28/94
Serial # 52173 - SFD - 4 Bdrm

THIS IS NOT A PERMIT

A37072

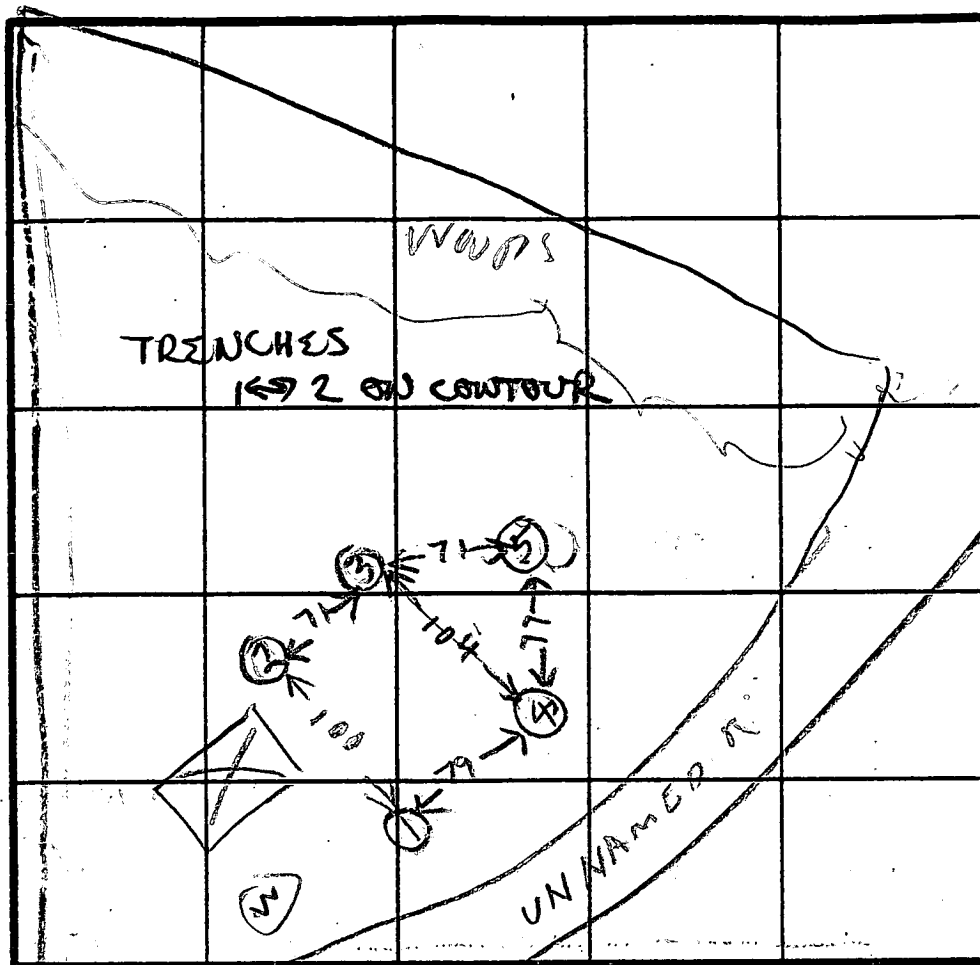
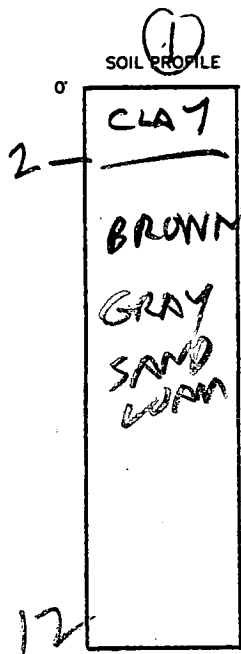

INDICATE NORTH - NAME ADJOINING ROADWAY AS BASE LINE.

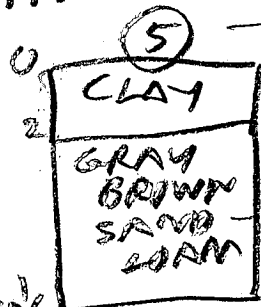
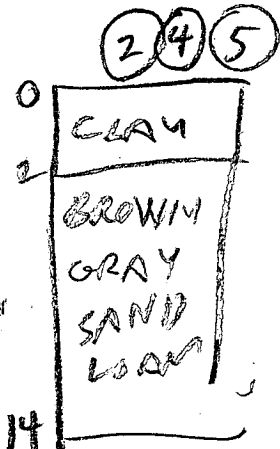

DATE	TEST NO.	DEPTH	PRE-WET		TEST - 1" DROP		TIME
			START	STOP	START	STOP	
6/3/86	1S	4	1055	1056	1056	1058	2
	1D	8 1/2	1055	1056	1056	1058	2
	1V	12	LOOKS OK				
	2S	4	1103	1107	1107	1111	4
	2D	10	1103	1105	1105	1111	6
	2V	14	LOOKS OK				
	3S	3	1116	1118	1118	1121	3
	3V	10.5	LOOKS OK				
	4S	4	1123	1123	1125	1128	3
	4V	14	LOOKS OK		OK		
6/3/86	5V	14	LOOKS OK				

REMARKS EXTRA VISUAL HOLE DUG TO OBTAIN 10000 SPT

TYPE OF SOIL

TESTED BY R. HODGES

ALSO PRESENT BUD ARNOLD CO

LOT B
HIGHLAND
MEADOWS

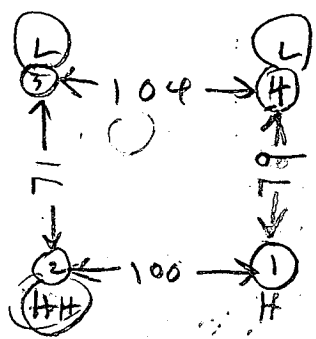
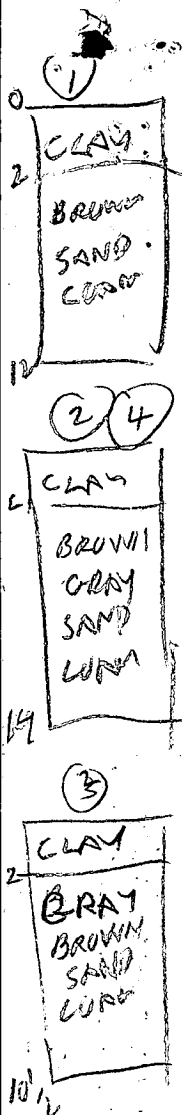

HOLE ELEVATION
 ② = HIGHEST
 ① HIGH
 ③④ LOW
 site almost level

BRIGHTON DAM

$\bar{x} = 4 \text{ min}$
 Inlet 3'
 Bottom 5'

6/2/88	19	4	1055	1056	1056	1058	2
	12	8.5	1055	1056	1056	1050	2
	14	12	LOOKS OK				
	29	4	1103	1107	1107	1111	4
	20	10	1103	1108	1105	1111	6
	24	14	LOOKS OK				
	35	3	1116	1118	1118	1121	3
	38	10.5	LOOKS OK				
	45	4	1123	1125	1125	1128	3
6/3/00	44	1.4	LOOKS OK				

Holes dug at survey on stake but not 10000 SFF
 Need Extra Visual for RH

Highland Meadows
Lot 9
13317 Longleaf Drive

12/14/94 - I met with owners, Mark and Cheryl (Nitz), on lot site to discuss the proximity of septic area to a grading cut that provides basement access to the house (will not be paved). We agreed they would contact their septic contractor (Alan Whitworth) who would arrange to meet me at site to field locate the distribution box, septic tank and trench placement points to minimize any further complications. The location septic permit specs are obsolete because of previously approved house encroachment toward the original septic area. Enough area appear to be remaining but trench may not be more than 90 ft long and uppermost two trenches could be short (ie 130 and 50 ft long respectively). They should be contacting us in a day or two to schedule this appointment. RPP 12/14/94

12/15/94 Met with contractor to check suitable start point for dist box, ST. + Trenches. Agreed upon sites shown on back of septic permit, generally as close to house as possible. RPP 12/15/94

B 1 9146 SEQUENCE NO. (DP USE ONLY)
(THIS NUMBER IS TO BE PUNCHED IN COLS. 3-6 ON ALL CARDS)

STATE OF MARYLAND PERMIT TO DRILL WELL

please print or-type

STATE PERMIT NUMBER

HD-88-0739
fill in this form completely

Date Received (APA)

050889

OWNER INFORMATION

KERWIN HOMES INC

24024 FREDERICK RD

CLARKSBURG MD 20871

DRILLER INFORMATION

George F. Easterday 40

L. Franklin Easterday, Inc. 77 License No. 80

9265 Brown Church Rd., Mt. Airy, Md. 21771
George F. Easterday 5/4/89

WELL INFORMATION

APPROX. PUMPING RATE (GAL. PER MIN.) 5

AVERAGE DAILY QUANTITY NEEDED (GAL. PER DAY) 500

USE FOR WATER (CIRCLE APPROPRIATE BOX)

- D HOME (SINGLE OR DOUBLE HOUSEHOLD UNIT ONLY)
F FARMING (LIVESTOCK WATERING & AGRICULTURAL IRRIGATION)
I INDUSTRIAL, COMMERCIAL, STATE AND FEDERAL GOV. OTHER (REQUIRES APPROPRIATION PERMIT)
P PUBLIC OR PRIVATE WATER COMPANY (REQUIRES APPROPRIATION PERMIT AND STATE HEALTH DEPARTMENT APPROVAL)
T TEST, OBSERVATION, MONITORING (MAY REQUIRE APPROPRIATION PERMIT)

APPROXIMATE DEPTH OF WELL 200 FEET

APPROXIMATE DIAMETER OF WELL 6 NEAREST INCH

METHOD OF DRILLING (circle one)

- BORED (or Augered) JETTED Jetted & DRIVEN
AIR-ROTARY AIR-PERCussion ROTARY (Hydraulic Rotary)
CABLE REVerse-ROTary Drive-POINT

REPLACEMENT OR DEEPEMED WELLS

(CIRCLE APPROPRIATE BOX)

- N THIS WELL WILL NOT REPLACE AN EXISTING WELL
Y THIS WELL WILL REPLACE A WELL THAT WILL BE ABANDONED AND SEALED
S THIS WELL WILL REPLACE A WELL THAT WILL BE USED AS A STANDBY
D THIS WELL WILL DEEPEM AN EXISTING WELL

PERMIT NUMBER OF WELL TO BE REPLACED OR DEEPEMED (IF AVAILABLE)

Not to be filled in by driller (OEP USE ONLY)

APPROP. PERMIT NUMBER 0111 GAP

FORCE HR PERMIT No. HD-88-0739

SPECIAL CONDITIONS

B 3

LOCATION OF WELL R-44205

HOWARD COUNTY

HIGHLAND MEADOWS

SECTION 44 46 LOT 9 48 50

CLARKSVILLE

MILES FROM TOWN (enter 0 if in town) 2 MI

B 4

DIRECTION OF WELL FROM TOWN (CIRCLE BOX)

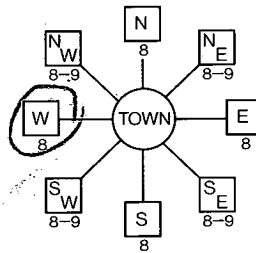

BRIGHTON DAM RD

LONG LEAF DR

ON WHICH SIDE OF ROAD (CIRCLE APPROPRIATE BOX)

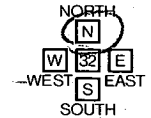

40 1150

DISTANCE FROM ROAD

ENTER FT or MI FT

NOT TO BE FILLED IN BY DRILLER HEALTH DEPARTMENT APPROVAL

HOWARD A37072 COUNTY NAME COUNTY NO.

STATE SIGNATURE DATE ISSUED 060989 Mark E. Pflkin 12/9/89

NORTH GRID 498 000 EAST GRID 0805 000

SHOW MAJOR FEATURES OF BOX & LOCATE WELL WITH AN X

SOURCES OF DRILLING WATER

1. WELL

2.

3.

WRITE THE BOX NUMBER FROM THE MAP HERE

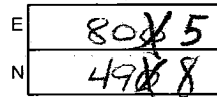

DRAW A SKETCH BELOW, SHOWING LOCATION OF WELL IN RELATION TO NEARBY TOWNS AND ROADS AND GIVE DISTANCE FROM WELL TO NEAREST ROAD JUNCTION

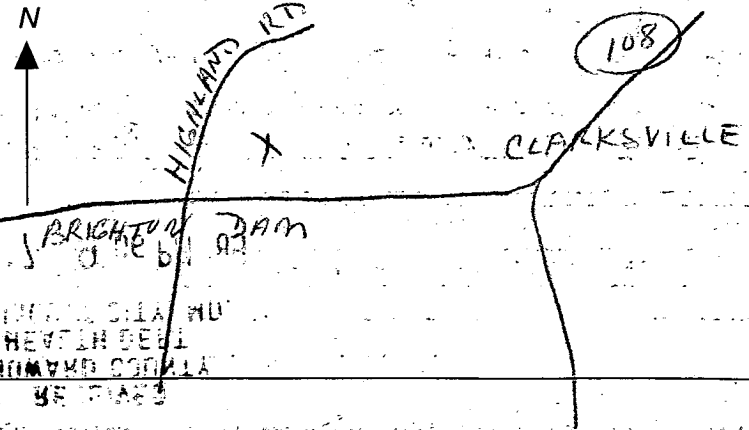

C1 2453

SEQUENCE NO. (DENV USE ONLY)

STATE OF MARYLAND WELL COMPLETION REPORT

THIS REPORT MUST BE SUBMITTED WITHIN 45 DAYS AFTER WELL IS COMPLETED.

(THIS NUMBER IS TO BE PUNCHED IN COLS. 3-6 ON ALL CARDS)

COUNTY NUMBER A37072

DATE RECEIVED

DATE WELL COMPLETED

DEPTH OF WELL

PERMIT NO. FROM "PERMIT TO DRILL WELL"

DATE RECEIVED grid

DATE WELL COMPLETED grid

DEPTH OF WELL grid

PERMIT NO. grid

OWNER R R WIN HOMES INC

STREET OR RFD BRIGHTON DAM RD

TOWN CLARKSVILLE

SUBDIVISION HIGHLAND MEADOWS

SECTION 1

LOT 9

WELL LOG Not required for driven wells STATE THE KIND OF FORMATIONS PENETRATED, THEIR COLOR, DEPTH, THICKNESS AND IF WATER BEARING

Table with columns: DESCRIPTION, FEET FROM, FEET TO, Check if water bearing. Rows include Top soil, Shale, Brown Mica, Green Mica, etc.

GROUTING RECORD WELL HAS BEEN GROUTED (Circle Appropriate Box) TYPE OF GROUTING MATERIAL CEMENT CM BENTONITE CLAY BC

CASING RECORD casing types insert appropriate code below MAIN Nominal diameter Total depth CASING top (main) casing of main casing TYPE (nearest inch) (nearest foot)

OTHER CASING (if used) diameter inch depth (feet) from to

SCREEN RECORD screen type or open hole insert appropriate code below STEEL BRASS OPEN HOLE BRONZE HOLE PLASTIC OTHER

DEPTH (nearest ft.) grid

A A WELL WAS ABANDONED AND SEALED WHEN THIS WELL WAS COMPLETED E ELECTRIC LOG OBTAINED P TEST WELL CONVERTED TO PRODUCTION WELL

I HEREBY CERTIFY THAT THIS WELL HAS BEEN CONSTRUCTED IN ACCORDANCE WITH COMAR 10.17.13 "WELL CONSTRUCTION" AND IN CONFORMANCE WITH ALL CONDITIONS STATED IN THE ABOVE CAPTIONED PERMIT...

DRILLERS IDENT. NO. 46

DRILLERS SIGNATURE (MUST MATCH SIGNATURE ON APPLICATION)

SITE SUPERVISOR (sign. of driller or journeyman responsible for sitework if different from permittee)

SLOT SIZE 1 2 3 DIAMETER OF SCREEN (NEAREST INCH) grid

GRAVEL PACK IF WELL DRILLED WAS FLOWING WELL INSERT F IN BOX 68

OEP USE ONLY (NOT TO BE FILLED IN BY DRILLER) T (E.R.O.S.) WQ TELESCOPE CASING LOG INDICATOR OTHER DATA

PUMPING TEST HOURS PUMPED (nearest hour) PUMPING RATE (gal. per min. to nearest gal.) METHOD USED TO MEASURE PUMPING RATE WATER LEVEL (distance from land surface) BEFORE PUMPING WHEN PUMPING TYPE OF PUMP USED (for test) air piston turbine centrifugal rotary other jet submersible

PUMP INSTALLED DRILLER WILL INSTALL PUMP (CIRCLE) (YES or NO) IF DRILLER INSTALLS PUMP, THIS SECTION MUST BE COMPLETED FOR ALL WELLS EXCEPT HOME USE TYPE OF PUMP INSTALLED PLACE (A,C,J,P,R,S,T,O) IN BOX - SEE ABOVE: CAPACITY: GALLONS PER MINUTE (to nearest gallon) PUMP HORSE POWER PUMP COLUMN LENGTH (nearest ft.) CASING HEIGHT (circle appropriate box and enter casing height) LAND SURFACE (nearest foot)

LOCATION OF WELL ON LOT SHOW PERMANENT STRUCTURE SUCH AS BUILDING, SEPTIC TANKS, AND/OR LANDMARKS AND INDICATE NOT LESS THAN TWO DISTANCES (MEASUREMENTS TO WELL)

12/6/94
A-SAP

HOWARD COUNTY HEALTH DEPARTMENT
Bureau of Environmental Health
3525-H Ellicott Mills Drive
Ellicott City, MD 21043
461-9933

APPLICATION FOR PITLESS ADAPTER, WELL PUMP AND PRESSURE TANK INSTALLATION

New Installation
Replacement

Receipt # _____
Date 11-29-94

Name of Installer B.W.T. INC.

Telephone 301-498-6138

License Number _____
Certified Well Pump Installer Well Driller _____ Registered Plumber _____

Name of Property Owner Mark Nitz Telephone ^{4P} 997-0647
Subdivision Highland Medway Lot # 9 Well Tag # 110-88-0739
Site Address 13317 Longleaf Dr

Pump	Motor	Pitless Adapter
1. Type	1. Horsepower <u>3/4</u>	1. Make _____
a. Deep well jet _____	2. RPM _____	2. Model # _____
b. Shallow well jet _____	3. Voltage _____	3. Depth <u>42"</u>
c. Submersible <input checked="" type="checkbox"/>	a. 110 _____	
2. Make <u>Shur-Sun Small Head</u>	b. 220 <input checked="" type="checkbox"/>	
3. Model # _____		
4. Capacity <u>10</u> GPM		
5. Pump exceeds well capacity Yes <input checked="" type="checkbox"/> No _____		
6. If Yes, is low pressure cutoff switch installed? Yes <input checked="" type="checkbox"/> No _____		
7. What methods are used to protect the pump and electrical wiring from vibrations? Torque arrestors <input checked="" type="checkbox"/> Cable guards <input checked="" type="checkbox"/> Other _____		

Tank	Piping	Well data
1. Capacity _____	1. Type <u>Cold Jet</u>	1. Depth <u>240</u> ft.
2. Pressure relief valve? <input checked="" type="checkbox"/>	2. Size <u>1"</u>	2. Yield <u>15</u> GPM
	3. NSF and/or BOCA Code approved _____	3. Static water level _____ ft.
	4. Depth of supply line <u>42"</u>	4. Will water supply be disinfected by installer? <input checked="" type="checkbox"/>

*Pitless Adapter + water line
OK @ 3 1/2 ft R/Pentley
OK to use 12/6/94*

I understand that it is my responsibility to notify the Howard County Health Department when the installation is ready for inspection (otherwise this permit is null and void).

All information given above is true to the best of my knowledge.

Signature of Applicant: *Paul W. [Signature]*

Date: 11/29/94

Note: A sticker indicating approval/status of the installation will be placed on the well casing at the time of the inspection.

NITZ

Lot 9 Highland Meadows Clarksville, Md. 21029
13317 Long Leaf Drive

BP 52173

Trench spacing: whichever is greater 10' or (2) x gravel depth

Trench area: Trench width x trench length OR if trench depth is greater than trench width, use trench depth
→ Trench depth x trench length

2-28-94

Review of trench placement is satisfactory. SCALE 1" = 50'
Inlet depth at 4 feet is acceptable.
JENadeau

--- topography
— trench

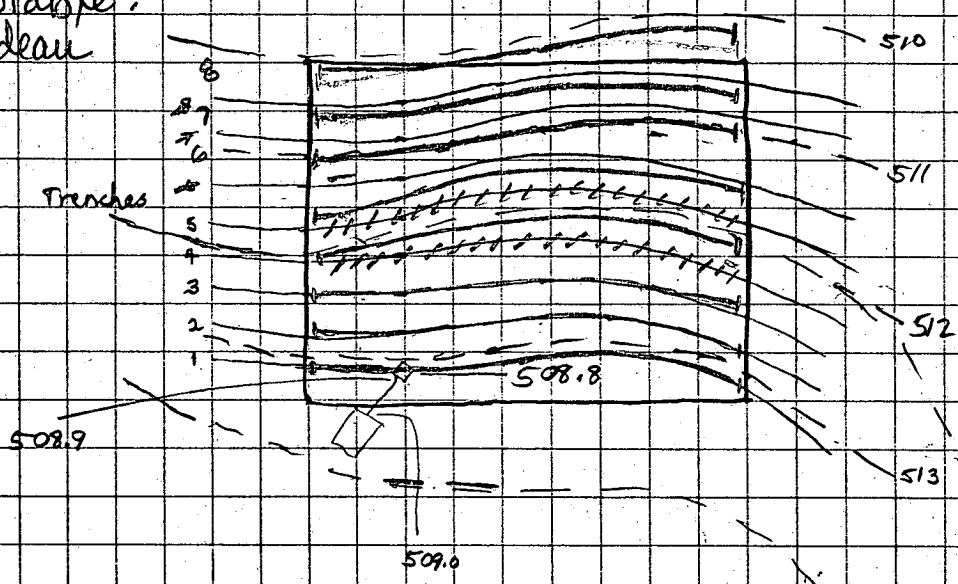

Inv. elev. out of tank	509.0	Existing elev. at tank	513.5
Inv. elev. into dist. box	508.9	Existing elev. at box	513.1
Inv. elev. into trench	508.8 509.1	Existing elev. at trench	513.1

Trench depth 8.0'
 Trench width 2.0'
 trench spacing 10.0'
 trench length 100.0'
 Trench area $100.0' \times \frac{4.0'}{2} = 370 \text{ ft}^2$
 Area required 2 trenches = 740 ft²

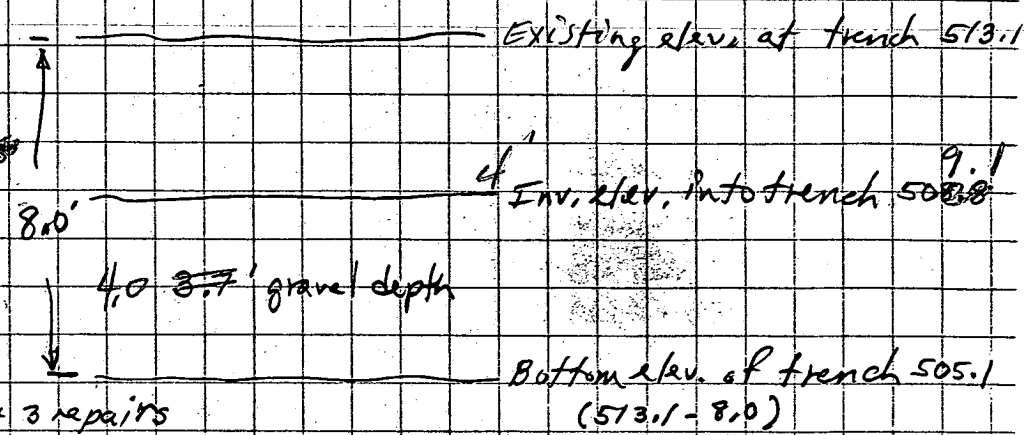

8 trenches available = original + 3 repairs

I certify that the above measurements are actual and correct for this property
mbh/niz

