

6/13/91 9:30
2:00
5/30/91
C.W. / C.B.D.
Hold for another appointment

PERMIT

File

SEWAGE DISPOSAL SYSTEM

DEPARTMENT OF HEALTH AND MENTAL HYGIENE

P 47186

A REPAIR

DISTRICT _____

DATE _____

HOWARD COUNTY HEALTH DEPARTMENT

BUREAU OF ENVIRONMENTAL HEALTH

461-9933

AP# 293122?

INDEXED

DATE SYSTEM APPROVED 6/17/91

INSPECTOR C.B.D.

Zepp Plumbing & Heating, Inc. IS PERMITTED TO INSTALL _____ ALTER

ADDRESS 12447 Route 108, Clarksville, Maryland 21029 PHONE 531-6712 Existing

SUBDIVISION _____ LOT _____ ROAD 1825 McKendree Road {Smaller Home}

PROPERTY OWNER Lester Weir

ADDRESS 1825 McKendree Road West Friendship, Maryland {Mr. Michael ROCHE son of Mr. Weir}

SEPTIC TANK CAPACITY 1000 GALLONS For Small House {21794 1-3 Bedroom 1000 gallon}

NUMBER OF BEDROOMS 3 (Hold for) Shallow (?) maybe trenches

125 SQUARE FEET PER BEDROOM

LINEAR FEET OF TRENCH REQUIRED 125 Existing home

REPAIR - PURPOSE - FAILING SEPTIC SYSTEM. Call for inspection when ground is opened so sanitarian can recommend repair

Discussed only with Mr. Zepp & Mr. & Mrs. Roche
5/31/91 HOLD FOR PERC OR VISUAL (3) HOLES = 7 C.B.D. 5/31/91 Trench

3' wide; Maximum depth 5' to 6' below original grade
at least 4' at deepest. 2" of stone under pipe
(100' to 150' from Sewer) Run trenches on contour in area of Grand Hole -> C.B.D. for 6/13/91

PLANS APPROVED BY C. Williams DATE 5/31/91

- COVER NO WORK UNTIL INSPECTED AND APPROVED
- NEITHER THE HOWARD COUNTY COUNCIL NOR THE HEALTH DEPARTMENT IS RESPONSIBLE FOR THE SUCCESSFUL OPERATION OF ANY SYSTEM
- NOTE: CLEANOUT REQUIRED EVERY 70 FEET OF SEWER LINE AND/OR AT 90° SWEEPS IN LINES FROM HOUSE TO DRAIN FIELDS, 90° ELBOWS NOT ACCEPTABLE.
- NOTE: ALL PARTS OF SEPTIC SYSTEMS (I.E. TANK, DISTRIBUTION BOX TRENCHES) TO BE 100 FEET FROM WELL (UNLESS OTHERWISE SPECIFICALLY AUTHORIZED)
- NOTE: IF DEEP TRENCH(ES) ARE USED CALL FOR INSPECTION BEFORE AND AFTER PLACING GRAVEL IN TRENCH(ES)
- NOTE: NO DRY WELL SHALL EXCEED 15 FOOT IN DIAMETER NO ABSORPTION TRENCH TO EXCEED 100 FEET IN LENGTH
- NOTE: ALL PIPE FROM HOUSE TO SEPTIC TANK MUST BE CAST IRON OR SCHEDULE 35/40 PVC OR ABS
- PERMIT VOID AFTER TWO YEARS:
- NOTE: INSTALL STAND PIPE ON SEPTIC TANK AND DRY WELL STAND PIPES MUST BE 6 INCHES IN DIAMETER CAST IRON. CONCRETE OR TERRA COTTA OR PVA OR ABS ACCEPTED. IF TOP OF SEPTIC TANK IS DEEPER THAN 3 FEET. MANHOLE TO GRADE REQUIRED.
- NOTE: DISTRIBUTION BOXES MUST HAVE BAFFLES

*INSTALLER IS RESPONSIBLE FOR OBTAINING FINAL APPROVAL ON THIS PERMIT

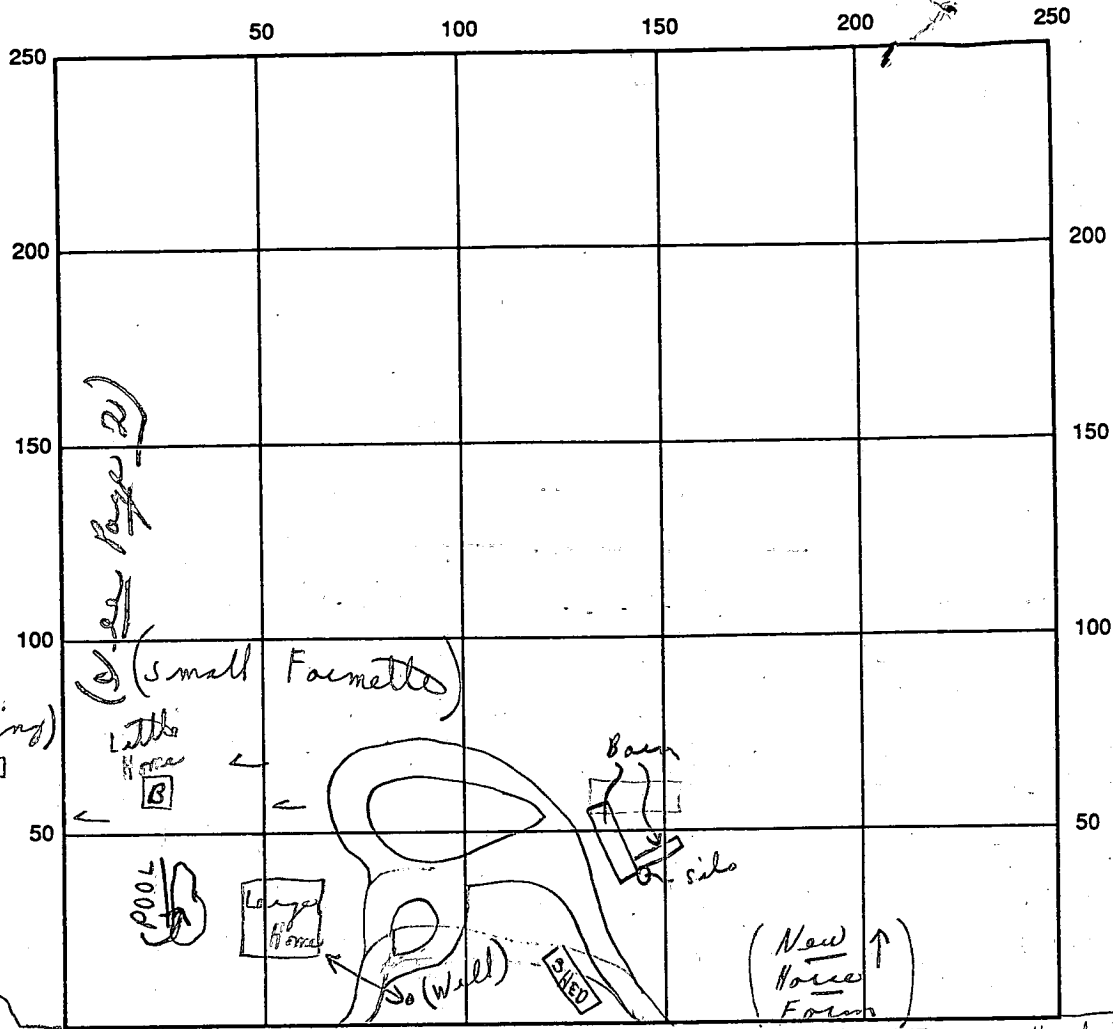

SEPTIC TANK LEVEL _____ CLEANOUTS (0m both sides)

DISTRIBUTION BOX LEVEL _____

DRAIN FIELD/TITLE DEPTH _____ FT. TRENCH WIDTH _____ FT. INLET DEPTH _____ FT.

EFFECTIVE GRAVEL DEPTH _____ FT. TOTAL LENGTH _____ FT.

NUMBER OF TRENCHES _____ ONE SIDEWALL/BOTTOM AREA _____ SQ. FT.

DRYWALL INSIDE DIAMETER _____ FT. EFFECTIVE DEPTH BELOW INLET _____ FT.

ABSORBENT AREA _____ SQ. FT. (1825-B)

REMARKS: 5/31/91 For small house - need 10,000 sqft. sewage
easement area for pump to other sewage easement area
on upper level. also to have new water well on
a line from dist. new water well. NO LP for
pressure tests - existing plumbing in home per Mr. Zegg
and Mr. Michael Roche (Tests to be done 6/91)

DATE SYSTEM APPROVED 6/17/91 INSPECTOR Charles Bryan V. [Signature]
 (See page 2)

PERMIT

SEWAGE DISPOSAL SYSTEM

DEPARTMENT OF HEALTH AND MENTAL HYGIENE

P 47186

A Repair

DISTRICT _____

DATE _____

HOWARD COUNTY HEALTH DEPARTMENT

BUREAU OF ENVIRONMENTAL HEALTH

461-9933

DATE SYSTEM APPROVED 6/17/91

INSPECTOR C. B. Williams

Zegg P. & H. Inc. IS PERMITTED TO INSTALL _____ ALTER

ADDRESS _____ PHONE _____

SUBDIVISION _____ LOT _____ ROAD 1825 B Mc Kendrick Road

PROPERTY OWNER Lester Weis For small home.

ADDRESS 1825 Mc Kendrick Road

SEPTIC TANK CAPACITY _____ GALLONS W. Friendship, Md. 21794

NUMBER OF BEDROOMS _____

_____ SQUARE FEET PER BEDROOM

LINEAR FEET OF TRENCH REQUIRED _____

Repair - Purpose - Fixing Septic System. Call for inspection when ground is opened so sanitation can recommend repairs.

PLANS APPROVED BY C. B. Williams for C. WILLIAMS DATE 5/31/91

COVER NO WORK UNTIL INSPECTED AND APPROVED

NEITHER THE HOWARD COUNTY COUNCIL NOR THE HEALTH DEPARTMENT IS RESPONSIBLE FOR THE SUCCESSFUL OPERATION OF ANY SYSTEM

NOTE: CLEANOUT REQUIRED EVERY 70 FEET OF SEWER LINE AND/OR AT 90° SWEEPS IN LINES FROM HOUSE TO DRAIN FIELDS, 90° ELBOWS NOT ACCEPTABLE.

NOTE: ALL PARTS OF SEPTIC SYSTEMS (I.E. TANK, DISTRIBUTION BOX TRENCHES) TO BE 100 FEET FROM WELL (UNLESS OTHERWISE SPECIFICALLY AUTHORIZED)

NOTE: IF DEEP TRENCH(ES) ARE USED CALL FOR INSPECTION BEFORE AND AFTER PLACING GRAVEL IN TRENCH(ES)

NOTE: NO DRY WELL SHALL EXCEED 15 FOOT IN DIAMETER NO ABSORPTION TRENCH TO EXCEED 100 FEET IN LENGTH

NOTE: ALL PIPE FROM HOUSE TO SEPTIC TANK MUST BE CAST IRON OR SCHEDULE 35/40 PVC OR ABS

PERMIT VOID AFTER TWO YEARS

NOTE: INSTALL STAND PIPE ON SEPTIC TANK AND DRY WELL STAND PIPES MUST BE 6 INCHES IN DIAMETER CAST IRON. CONCRETE OR TERRA COTTA OR PVA OR ABS ACCEPTED. IF TOP OF SEPTIC TANK IS DEEPER THAN 3 FEET. MANHOLE TO GRADE REQUIRED.

NOTE: DISTRIBUTION BOXES MUST HAVE BAFFLES

***INSTALLER IS RESPONSIBLE FOR OBTAINING FINAL APPROVAL ON THIS PERMIT**

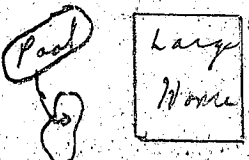
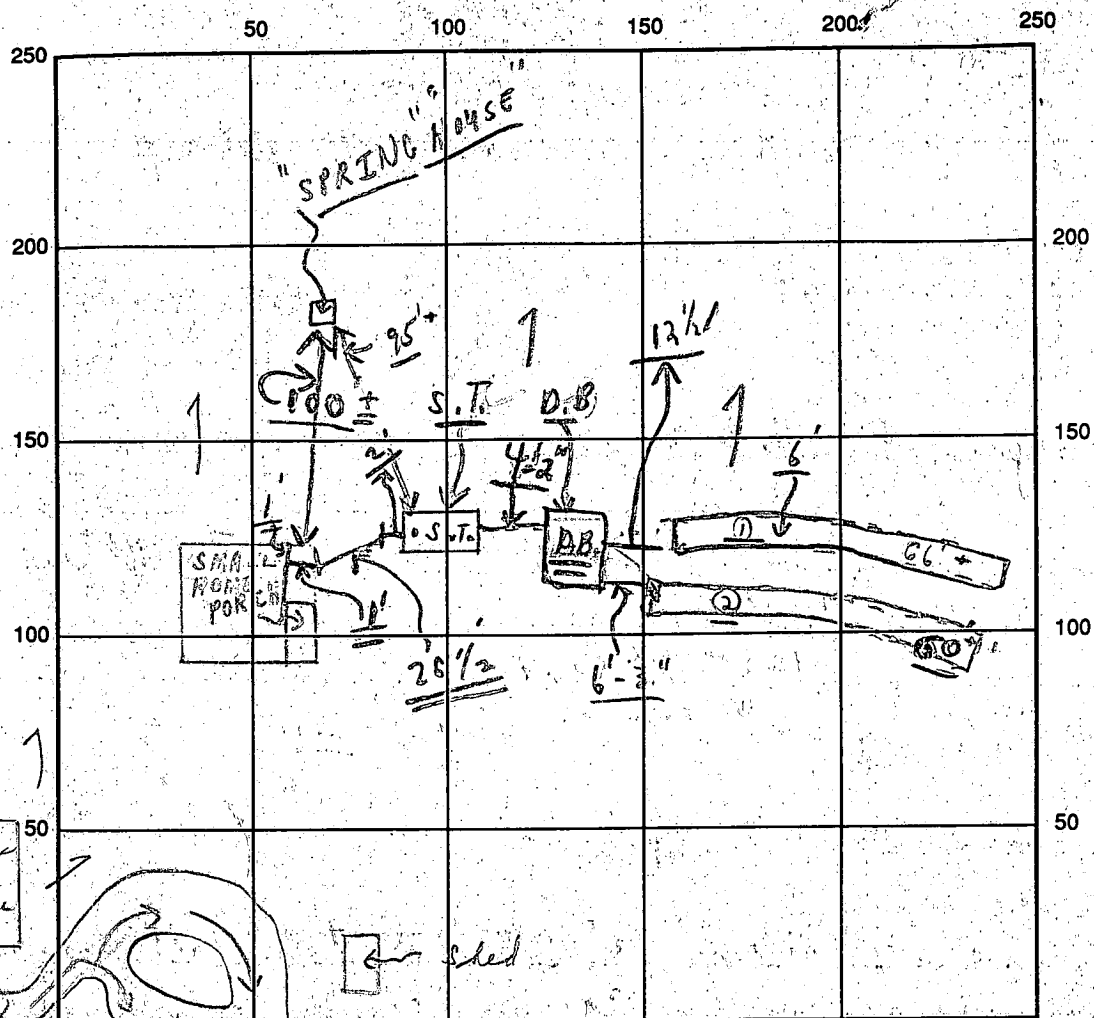

INDICATE NORTH - NAME ADJOINING ROADWAY AS BASE LINE
 SEPTIC TANK LEVEL OK CLEANOUTS OK

DISTRIBUTION BOX LEVEL OK (Baffles in)
 DRAIN FIELD/TITLE DEPTH 5'-6" FT. TRENCH WIDTH 3 FT. INLET DEPTH 3 3/4 FT.
 EFFECTIVE GRAVEL DEPTH 2+ FT. TOTAL LENGTH 0 56 FT. 3120 ±
 NUMBER OF TRENCHES 2 ONE SIDEWALL/BOTTOM AREA 378 ± SQ. FT.
 DRYWALL INSIDE DIAMETER FT. EFFECTIVE DEPTH BELOW INLET FT.
 ABSORBENT AREA 378 ± SQ. FT.

REMARKS: 6/13/91 Partial - ok to continue; Hold for a call, C.B.D. (Excavation) is small house repair of old system by us - grading. Mr. [unclear] up at site and to call when ready.
 6/14/91 A.M. - Partial - ok to cover from house to 1' of distribution box and all of (2) trench only; HOLD FOR A CALL - MONDAY.
 6/17/91 MONDAY - OK TO COVER AS FINISH. (Material on site) C.B.D.

DATE SYSTEM APPROVED 6/17/91 INSPECTOR Charles Bryan, [unclear]