

05-368235

PERMIT

SEWAGE DISPOSAL SYSTEM
MARYLAND STATE DEPARTMENT OF HEALTH

HOWARD COUNTY
BUREAU OF ENVIRONMENTAL HEALTH
461-9933

P 44607

A REPAIR

DISTRICT _____

DATE 4/28/89

5.9.89

DATE SYSTEM APPROVED _____

INSPECTOR SAW

INDEXED

Jack Fyock IS PERMITTED TO INSTALL _____ ALTER

ADDRESS _____ PHONE _____

SUBDIVISION _____ ROAD _____ LOT _____

PROPERTY OWNER Constance Stiller

ADDRESS 11851 Lime Kiln Rd.

IF GARBAGE GRINDER IS USED INCREASE SEPTIC TANK CAPACITY BY 50% AND ABSORPTION AREA BY 22%.

GARBAGE GRINDER? YES _____ NO _____

SEPTIC TANK CAPACITY _____ GALLONS NUMBER OF BEDROOMS _____

PURPOSE: To replace collapsed metal septic tank.

PLANS APPROVED BY C. Williams DATE May 9, 1989

COVER NO WORK UNTIL INSPECTED AND APPROVED

NEITHER THE HOWARD COUNTY COUNCIL NOR THE HEALTH DEPARTMENT IS RESPONSIBLE FOR THE SUCCESSFUL OPERATION OF ANY SYSTEM.

NOTE: CLEANOUT REQUIRED EVERY 70 FEET OF SEWER LINE AND/OR AT 90° SWEEPS IN LINES FROM HOUSE TO DRAIN FIELDS

NOTE: ALL PARTS OF SEPTIC SYSTEMS (I.E. TANK, DISTRIBUTION BOX, TRENCHES) TO BE 100 FEET FROM WELL (UNLESS OTHERWISE SPECIFICALLY AUTHORIZED)

NOTE: IF DEEP TRENCHES ARE USED CALL FOR INSPECTION BEFORE AND AFTER PLACING GRAVEL IN TRENCHES

NOTE: NO DRY WELL SHALL EXCEED 15 FOOT IN DIAMETER NO ABSORPTION TRENCH TO EXCEED 100 FEET IN LENGTH.

NOTE: ALL PIPE FROM HOUSE TO SEPTIC TANK MUST BE CAST IRON OR SCHEDULE 40 PVC OR ABS

PERMIT VOID AFTER TWO YEARS

NOTE: INSTALL STAND PIPE ON SEPTIC TANK AND DRY WELL. STAND PIPES MUST BE 6 INCHES IN DIAMETER. CAST IRON, CONCRETE OR TERRA COTTA OR PVC OR ABS ACCEPTED. IF TOP OF SEPTIC TANK IS DEEPER THAN 3 FEET, MANHOLE TO GRADE REQUIRED

NOTE: DISTRIBUTION BOXES MUST HAVE BAFFLES

***INSTALLER IS RESPONSIBLE FOR OBTAINING FINAL APROVAL ON THIS PERMIT**

CALL 461-9933 FOR INSPECTION OF SEPTIC SYSTEMS.

P 44607

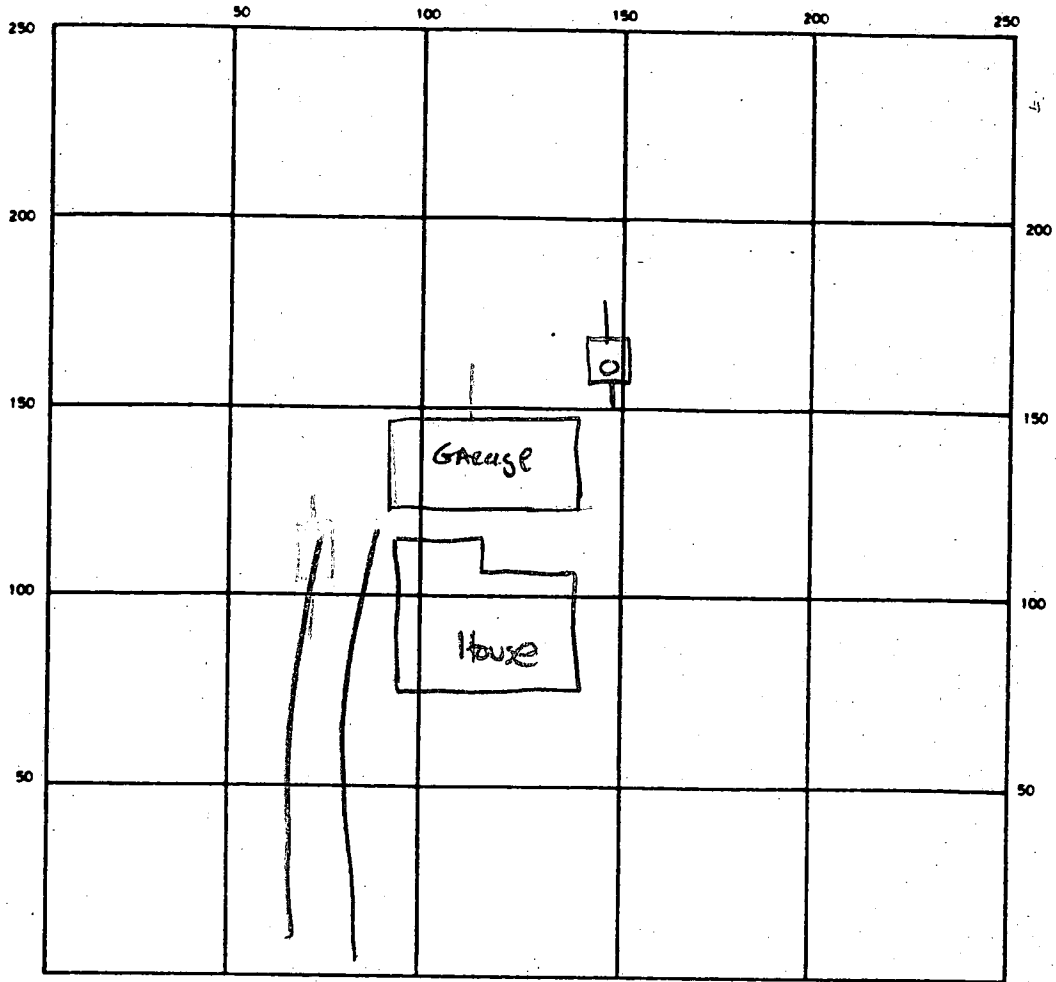

INDICATE NORTH — NAME ADJOINING ROADWAY AS BASE LINE
 Lime Kiln Rd.

SEPTIC TANK. LEVEL ✓ 1000 CLEANOUTS ✓

DISTRIBUTION BOX. LEVEL _____

DRAIN FIELD/TILE FIELD. DEPTH _____ FT. TRENCH WIDTH _____ FT. INLET DEPTH _____ FT.

EFFECTIVE GRAVEL DEPTH _____ FT. TOTAL LENGTH _____ FT.

NUMBER OF TRENCHES _____ ONE SIDEWALL/BOTTOM AREA _____ SQ. FT.

DRYWELL INSIDE DIAMETER _____ FT. EFFECTIVE DEPTH BELOW INLET _____ FT.

ABSORBENT AREA _____ SQ. FT.

REMARKS _____

DATE SYSTEM APPROVED 5-9-89 INSPECTOR S. Abel