

9/28/95  
ASAP c/o

Permit ID - 03-315622  
**PERMIT**

**SEWAGE DISPOSAL SYSTEM**

**DEPARTMENT OF HEALTH AND MENTAL HYGIENE**

P 50970

A 42204

DISTRICT 3rd

DATE 11-13-95

**HOWARD COUNTY HEALTH DEPARTMENT**  
**BUREAU OF ENVIRONMENTAL HEALTH**  
~~XXXX-9933X~~ 313-2640

**INDEXED**

DATE SYSTEM APPROVED 9/29/95

INSPECTOR M. Rifkin

Olen Ketterman IS PERMITTED TO INSTALL  ALTER

ADDRESS 14960 Route 144, Woodbine, MD 21797 PHONE 442-1336

SUBDIVISION Second Discovery LOT 14 ROAD 12719 Maryvale Court

PROPERTY OWNER Richard L. & Linda A. Mostyn

ADDRESS \_\_\_\_\_

SEPTIC TANK CAPACITY 1250 GALLONS

NUMBER OF BEDROOMS 4

180 SQUARE FEET PER BEDROOM

LINEAR FEET OF TRENCH REQUIRED 180 275'

TRENCHES - Trench to be 2 feet wide. Inlet 2.0 feet below original grade. Bottom maximum depth 5.0 feet below original grade. Effective area begins at 2.5 feet below original grade. 3.0 feet of stone below distribution pipe.

LOCATION - Place distribution box 155 feet down the left lot line (515.64') and 80 feet off that same lot line when facing the lot from Maryvale Court. Run trenches on contour in both directions.

NOTES - No trench to exceed 100 feet in length. Provide 6" - 8" diameter cleanout and cap to grade or above on septic tank. OK 9/23/95 DKS

SPECS ADJUSTED FOR SOILS (AS PER CW NOTE 9/8/88) MR 9/28/95

PLANS APPROVED BY Amy McMillen DATE 11/28/94

COVER NO WORK UNTIL INSPECTED AND APPROVED

NEITHER THE HOWARD COUNTY COUNCIL NOR THE HEALTH DEPARTMENT IS RESPONSIBLE FOR THE SUCCESSFUL OPERATION OF ANY SYSTEM

NOTE: CLEANOUT REQUIRED EVERY 70 FEET OF SEWER LINE AND/OR AT 90° SWEEPS IN LINES FROM HOUSE TO DRAIN FIELDS, 90° ELBOWS NOT ACCEPTABLE.

NOTE: ALL PARTS OF SEPTIC SYSTEMS (I.E. TANK, DISTRIBUTION BOX TRENCHES) TO BE 100 FEET FROM WELL (UNLESS OTHERWISE SPECIFICALLY AUTHORIZED)

NOTE: IF DEEP TRENCH(ES) ARE USED CALL FOR INSPECTION BEFORE AND AFTER PLACING GRAVEL IN TRENCH(ES)

NOTE: NO DRY WELL SHALL EXCEED 15 FOOT IN DIAMETER NO ABSORPTION TRENCH TO EXCEED 100 FEET IN LENGTH

NOTE: ALL PIPE FROM HOUSE TO SEPTIC TANK MUST BE CAST IRON OR SCHEDULE 35/40 PVC OR ABS

PERMIT VOID AFTER TWO YEARS

NOTE: INSTALL STAND PIPE ON SEPTIC TANK AND DRY WELL STAND PIPES MUST BE 6 INCHES IN DIAMETER CAST IRON. CONCRETE OR TERRA COTTA OR PVA OR ABS ACCEPTED. IF TOP OF SEPTIC TANK IS DEEPER THAN 3 FEET. MANHOLE TO GRADE REQUIRED.

NOTE: DISTRIBUTION BOXES MUST HAVE BAFFLES

**\*INSTALLER IS RESPONSIBLE FOR OBTAINING FINAL APPROVAL ON THIS PERMIT**

A  
42204

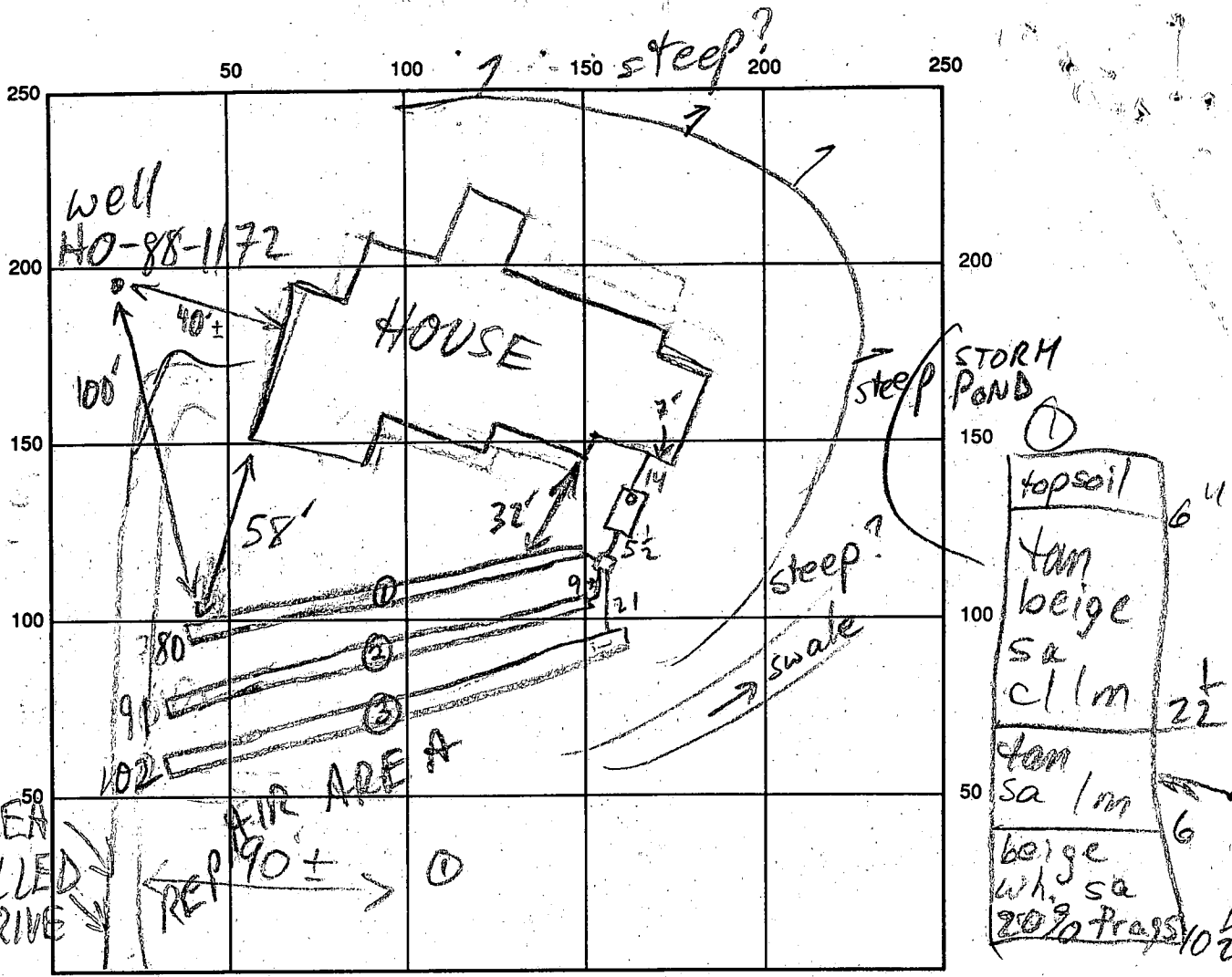

INDICATE NORTH - NAME ADJOINING ROADWAY AS BASE LINE

SEPTIC TANK LEVEL 1500 GAL - OK CLEANOUTS S.T. - OK  
 DISTRIBUTION BOX LEVEL OK - BAFFLE IN  
 DRAIN FIELD/TITLE DEPTH  $\frac{1}{6} \frac{2}{5} \frac{3}{5} \pm 5$  FT. TRENCH WIDTH 2 FT. INLET DEPTH  $\frac{1}{25} \frac{2}{2} \frac{3}{2}$  FT.  
 EFFECTIVE GRAVEL DEPTH  $\frac{1}{4} \frac{2}{3} \frac{3}{3}$  FT. TOTAL LENGTH  $\textcircled{1} 78 \textcircled{2} 102 \textcircled{3} 91$  FT.  
 NUMBER OF TRENCHES 3 ONE SIDEWALL/BOTTOM AREA  $\textcircled{1} 370 \textcircled{2} 273 \textcircled{3} 306$  SQ. FT.  
 DRYWALL INSIDE DIAMETER      FT. EFFECTIVE DEPTH BELOW INLET      FT.  
 ABSORBENT AREA 900 SQ. FT. (FOR ROCKY SOILS)

REMARKS: 9/28/95 REQUEST FOR SHALLOW SYSTEM BY CW (9/8/88)  
NOT DESIGN ON SPEC SHEET; DESIGN ADJUSTED IN FIELD:  
TWO REMAINING TRENCHES 2' WIDE, 3' STONE TOTAL 190'; MR  
CONTINUE MR 9/29/95 OK TO FINISH & COVER; REPAIR  
AREA MAY BE SOMEWHAT LIMITED; TRENCH DEPTH ON  
② & ③ VARIES SLIGHTLY (5-6') DUE TO TOPO MR

DATE SYSTEM APPROVED 9/29/95 INSPECTOR M. Ripkin

# APPLICATION

PERCOLATION TESTING

A 42204

P \_\_\_\_\_

HOWARD COUNTY HEALTH DEPARTMENT  
BUREAU OF ENVIRONMENTAL HEALTH  
P.O. BOX 476 ELLICOTT CITY, MARYLAND 21043  
TELEPHONE: 461-9933

DISTRICT Third

DATE Feb. 26, 1988

TO: THE COUNTY HEALTH OFFICER  
ELLICOTT CITY, MARYLAND

I, HEREBY, APPLY FOR THE NECESSARY TEST IN ORDER TO CONSTRUCT (OR RECONSTRUCT) A SEWAGE DISPOSAL SYSTEM.

PROPERTY OWNER William W. Aitcheson (Richard L + Linda A. Mastya)

ADDRESS 12706 Folly Quarter Rd. Clarksville, Md. 21029 PHONE 301 596 9208

PROSPECTIVE BUYER \_\_\_\_\_

ADDRESS \_\_\_\_\_ PHONE \_\_\_\_\_

PROPERTY LOCATION:

SUBDIVISION Aitcheson Property "Second Discovery" LOT NO. 14 LOT 11 Preliminary 14 FINAL

ROAD AND DESCRIPTION End of Court 'A'

TAX MAP 22 Blk23 PARCEL # 45

SIZE OF LOT 3.70 acres TYPE BLDG Single Family Dwg  
(SINGLE FAMILY DWELLING OR COMMERCIAL)

BLDG. PERMIT SIGNED  
AND RETURNED 2/2/95  
Sealth # 57271-4B

THE SYSTEM INSTALLED UNDER THIS APPLICATION IS ACCEPTABLE ONLY UNTIL PUBLIC FACILITIES BECOME AVAILABLE. I FULLY UNDERSTAND THE FEE CONNECTED WITH THE FILING OF THIS PERC TEST APPLICATION IS NON-REFUNDABLE UNDER ANY CIRCUMSTANCES. I ALSO AGREE TO COMPLY WITH ALL M.O.S.H.A. REQUIREMENTS IN TESTING THIS LOT. W<sup>W</sup> - W. Aitcheson  
(SIGNATURE OF APPLICANT)

APPROVED BY \_\_\_\_\_ FOR \_\_\_\_\_ DATE \_\_\_\_\_

REJECTED BY \_\_\_\_\_ FOR \_\_\_\_\_ DATE \_\_\_\_\_

HOLD PENDING FURTHER TESTS \_\_\_\_\_ DATE \_\_\_\_\_

REASONS FOR REJECTION OR HOLDING \* DEEP SYSTEM FOR PORTION OF SEPTIC AREA NEAREST TO ROAD ONLY. FAR SIDE OF SEPTIC AREA SUITABLE FOR SHALLOW SYSTEM ONLY DUE TO SHALLOW DEPTH TO ROCK, 9/8/88 SEPTIC SPECS MUST BE REVIEWED BY PROGRAM DIRECTOR. CW

# THIS IS NOT A PERMIT

HD-216



# APPLICATION

PERCOLATION TESTING

A 42204  
P \_\_\_\_\_

HOWARD COUNTY HEALTH DEPARTMENT  
BUREAU OF ENVIRONMENTAL HEALTH  
P.O. BOX 476 ELLICOTT CITY, MARYLAND 21043  
TELEPHONE: 461-9933

DISTRICT Third

DATE Feb. 26, 1988

TO: THE COUNTY HEALTH OFFICER  
ELLICOTT CITY, MARYLAND

I HEREBY APPLY FOR THE NECESSARY TEST IN ORDER TO CONSTRUCT (OR RECONSTRUCT) A SEWAGE DISPOSAL SYSTEM.

PROPERTY OWNER William W. Aitcheson

ADDRESS 12706 Folly Quarter Rd, Clarksville, Md. 21029 PHONE 301 596 9208

PROSPECTIVE BUYER \_\_\_\_\_

ADDRESS \_\_\_\_\_ PHONE \_\_\_\_\_

PROPERTY LOCATION:

SUBDIVISION Aitcheson Property "Second Discovery" LOT NO. 14

ROAD AND DESCRIPTION End of Court 'A'

TAX MAP 22 Blk 23 PARCEL # 45

SIZE OF LOT 3.70 acres TYPE BLDG Single Family Dwg  
(SINGLE FAMILY DWELLING OR COMMERCIAL)

THE SYSTEM INSTALLED UNDER THIS APPLICATION IS ACCEPTABLE ONLY UNTIL PUBLIC FACILITIES BECOME AVAILABLE. I FULLY UNDERSTAND THE FEE CONNECTED WITH THE FILING OF THIS PERC TEST APPLICATION IS NON-REFUNDABLE UNDER ANY CIRCUMSTANCES. I ALSO AGREE TO COMPLY WITH ALL M.O.S.H.A. REQUIREMENTS IN TESTING THIS LOT.

Wm W. Aitcheson

(SIGNATURE OF APPLICANT)

APPROVED BY \_\_\_\_\_ FOR \_\_\_\_\_ DATE \_\_\_\_\_

REJECTED BY \_\_\_\_\_ FOR \_\_\_\_\_ DATE \_\_\_\_\_

HOLD PENDING FURTHER TESTS \_\_\_\_\_ DATE \_\_\_\_\_

REASONS FOR REJECTION OR HOLDING \* D66P SYSTEM APPROPRIATE FOR PORTION OF SEPTIC AREA

CLOSEST TO ROAD ONLY, FAR SIDE OF SEPTIC AREA SUITABLE FOR SHALLOW

SYSTEM ONLY DUE TO DEPTH TO ROCK. SEPTIC SPECS MUST BE REVIEWED

BY PROGRAM DIRECTOR. 9/8/88

# THIS IS NOT A PERMIT

HD-216

A42204

320'

#14

SOIL PROFILE

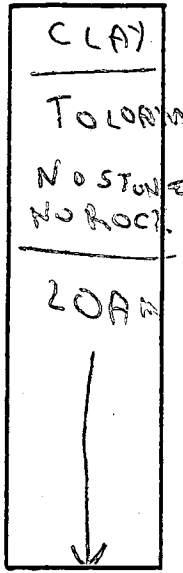

- ②
- ④
- ⑤

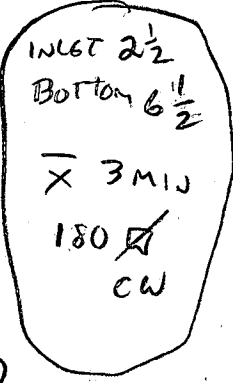
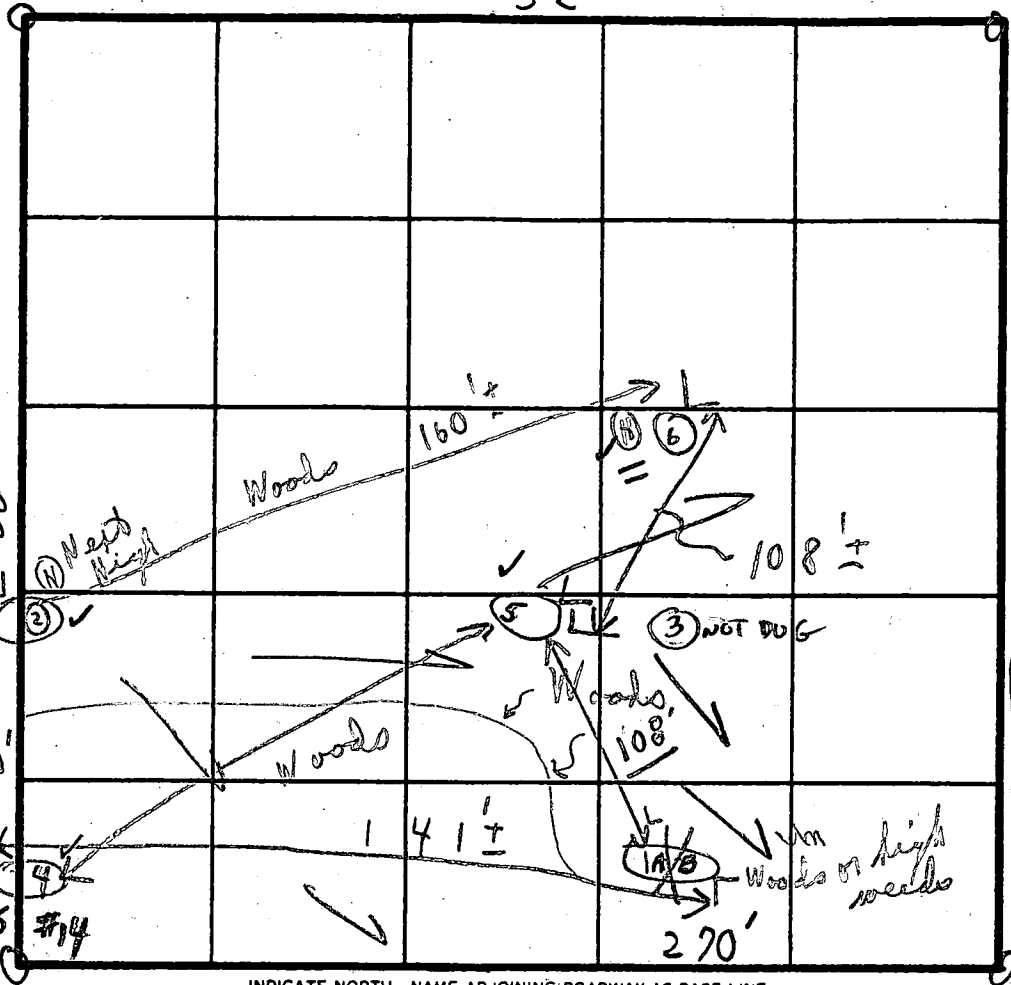

Note  
 ⑥ Sandstone  
 5 1/2' to 10'

- ② 12'
- ④ 14 1/2'
- ⑤ 10'
- ⑥ 10'

INDICATE NORTH - NAME ADJOINING ROADWAY AS BASE LINE.  
 COURT "A"

SOIL PROFILE

	DATE	TEST NO.	DEPTH	PRE-WET		TEST - 1' DROP		TIME	
				START	STOP	START	STOP		
1'-	8/3/88	1A	'	(No need to test)				Noted	
1'-	8/3/88	④ 1B	14' white	9:54	9:54	Gray soil	X	X	Per Piro's stake
1'- Same as #15		2A	'						
1'- No hole		B	'						(of lot see #15)
1'- Same as #15		3A	'						
1'- Same as #15		④ 3B	'						
1'- Same as #15		4A	'						
1'- Same as #15		4B	'						(of lot see #15)
1'- 2 Clayish brownish		5A	2'	2:54	2:56	2:56	2:59	3 min	
1'- 4 1/2' Sandstone		5B	10'	2:54	2:56	whole sand	2:59	2 min	
1'- 4 1/2' - 10'		6A	2'	3:13	3:14	Bin in woods	3:16	2 min	
1'- 4 1/2' - 10'		6B	4 1/2'	3:17	3:18	Bin in woods	3:18	2 min	

REMARKS  
 + Sandstone  
 4 1/2' - 10'

TYPE OF SOIL  
 TESTED BY C. [Signature]  
 ALSO PRESENT (2) Fyock men  
 1 owner



**ENGINEER'S CERTIFICATE**

I HEREBY CERTIFY THAT THIS PLAN FOR EROSION AND SEDIMENT CONTROL REPRESENTS A PRACTICAL AND WORKABLE PLAN BASED ON MY PERSONAL KNOWLEDGE OF THE SITE CONDITION AND THAT IT WAS PREPARED IN ACCORDANCE WITH THE REQUIREMENTS OF THE HOWARD SOIL CONSERVATION DISTRICT.

*[Signature]*  
 SIGNATURE OF ENGINEER  
 11/15/94  
 DATE

**DEVELOPER'S CERTIFICATE**

"I/WE CERTIFY THAT ALL DEVELOPMENT AND CONSTRUCTION WILL BE DONE ACCORDING TO THIS PLAN OF DEVELOPMENT AND PLAN FOR EROSION AND SEDIMENT CONTROL AND THAT ALL RESPONSIBLE PERSONNEL INVOLVED IN THE CONSTRUCTION PROJECT WILL HAVE A CERTIFICATE OF ATTENDANCE AT A DEPARTMENT OF NATURAL RESOURCES APPROVED TRAINING PROGRAM FOR THE CONTROL OF SEDIMENT AND EROSION BEFORE BEGINNING THE PROJECT. I ALSO AUTHORIZE PERIODIC ON-SITE INSPECTION BY THE HOWARD SOIL CONSERVATION DISTRICT OR ITS AUTHORIZED AGENTS, AS ARE DEEMED NECESSARY."

\_\_\_\_\_  
 SIGNATURE OF DEVELOPER  
 DATE

REVIEWED FOR HOWARD COUNTY SOIL CONSERVATION DISTRICT AND MEETS TECHNICAL REQUIREMENTS.

\_\_\_\_\_  
 U.S. SOIL CONSERVATION DISTRICT  
 DATE

THIS DEVELOPMENT IS APPROVED FOR EROSION AND SEDIMENT CONTROL BY THE HOWARD SOIL CONSERVATION DISTRICT.

\_\_\_\_\_  
 DISTRICT HOWARD SOIL CONSERVATION DIST.  
 DATE

**SEQUENCE OF CONSTRUCTION**

1. OBTAIN GRADING PERMIT.
2. INSTALL SEDIMENT CONTROLS AS SHOWN ON PLAN.
3. PERFORM NECESSARY GRADING AND STABILIZE THE SITE.
4. AFTER THE SITE IS STABILIZED AND PERMISSION IS GRANTED FROM THE SEDIMENT CONTROL INSPECTOR, REMOVE SEDIMENT CONTROLS AND STABILIZE ANY REMAINING DISTURBED AREAS.

**TEMPORARY SEEDING NOTES**

APPLY TO GRADED OR CLEARED AREAS LIKELY TO BE REDISTURBED WHERE A SHORT-TERM VEGETATIVE COVER IS NEEDED.

**SEEDING PREPARATION**

LOOSEN UPPER THREE INCHES OF SOIL BY RAKING, DISCING OR OTHER ACCEPTABLE MEANS BEFORE SEEDING. IF NOT PREVIOUSLY LOOSENED.

**SOIL AMENDMENTS**

APPLY 500 LBS. PER ACRE 10-10-10 FERTILIZER (4 LBS./1000 SQ. FT.)

**SEEDING**

FOR THE PERIODS MARCH 1 THROUGH APRIL 30, AND AUGUST 15 THROUGH NOVEMBER 15, SEED WITH 1 1/2 BUSHEL PER ANNUAL RYE (3.2 LBS./1000 SQ.FT.) FOR THE PERIOD MAY 1 THRU AUGUST 14, SEED WITH 3 LBS./ACRE OF WEEPING LOVEGRASS (07 LBS./1000SQ.FT.) FOR THE PERIOD NOVEMBER 15 THRU FEBRUARY 28. PROTECT SITE BY APPLYING 2 TONS PER ACRE OF WELL ANCHORED STRAW MULCH AND SEED AS SOON AS POSSIBLE IN THE SPRING OR USE SOD.

**MULCHING**

APPLY 1 1/2 TO 2 TONS PER ACRE (70 TO 90 LBS./1000 SQ.FT.) OF UNROTTED SMALL GRAIN STRAW IMMEDIATELY AFTER SEEDING. ANCHOR MULCH IMMEDIATELY AFTER APPLICATION USING MULCH ANCHORING TOOL OR 218 GALLONS PER ACRE (5 GAL./1000 SQ.FT.) OF EMULSIFIED ASPHALT ON FLAT ACRES, ON SLOPES 0 FEET OR HIGHER, USE 340 GALLONS PER ACRE (8 GAL./1000 SQ.FT.) FOR ANCHORING.

REFER TO THE 1986 MARYLAND STANDARDS AND SPECIFICATION FOR SOIL EROSION AND SEDIMENT CONTROL FOR RATE AND METHODS NOT COVERED.

**PERMANENT SEEDING NOTES**

ALL DISTURBED AREAS SHALL BE STABILIZED AS FOLLOWS:

**SEEDING PREPARATION**  
 LOOSEN UPPER THREE INCHES OF SOIL BY RAKING, DISCING OR OTHER ACCEPTABLE MEANS BEFORE SEEDING.

**SOIL AMENDMENTS**

APPLY TWO TONS PER ACRE DOLOMITIC LIMESTONE (92 LBS./1000 SQ.FT.) AND 600 LBS. PER ACRE 0-20-20 FERTILIZER (4 LBS./1000 SQ.FT.) BEFORE SEEDING HARROW OR DISC INTO UPPER THREE INCHES OF SOIL. AT TIME OF SEEDING, APPLY 400 LBS. PER ACRE 36-0-0 URZAFORM FERTILIZER (9 LBS./1000 SQ.FT.) AND 500 LBS. PER ACRE (11.5 LBS./1000 SQ.FT.) OF 10-20-20 FERTILIZER.

**SEEDING**

FOR THE PERIODS MARCH 1 THROUGH APRIL 30, AND AUGUST 1 THROUGH OCTOBER 15, SEED WITH 100 LBS. PER ACRE (23 LBS./1000 SQ.FT.) OF KENTUCKY 31 TALL FESCUE. FOR THE PERIOD MAY 1 THROUGH JULY 31, SEED WITH 60 LBS./ACRE (1.4 LBS./1000 SQ.FT.) KENTUCKY 31 TALL FESCUE AND 2 LBS. PER ACRE (0.05 LBS./1000 SQ.FT.) OF WEEPING LOVEGRASS. DURING THE PERIOD OF OCTOBER 16 THROUGH FEBRUARY 28, PROJECT SITE BY: OPTION (D) - TWO TONS PER ACRE OF WELL ANCHORED STRAW MULCH AND SEED AS SOON AS POSSIBLE IN THE SPRING; OPTION (E) - USE SOD; OPTION (F) - SEED WITH 100 LBS./ACRE KENTUCKY 31 TALL FESCUE AND MULCH WITH TWO TONS/ACRE WELL ANCHORED STRAW. ALL SLOPES SHOULD BE HYDROSEEDED.

**MULCHING**

APPLY 1 1/2 TO 2 TONS PER ACRE (80 TO 90 LBS./1000 SQ.FT.) OF UNROTTED SMALL GRAIN STRAW IMMEDIATELY AFTER SEEDING. ANCHOR MULCH IMMEDIATELY AFTER APPLICATION USING 200 GALLONS PER ACRE (5 GAL./1000 SQ.FT.) OF EMULSIFIED ASPHALT ON FLAT ACRES, ON SLOPES 0 FEET OR HIGHER USE 340 GALLONS PER ACRE (8 GAL./1000 SQ.FT.) FOR ANCHORING.

**MAINTENANCE**

INSPECT ALL SEEDED AREAS AND MAKE NEEDED REPAIRS, REPLACEMENTS AND RESEEDINGS.  
 \* FOR PUBLIC PONDS SUBSTITUTE CHEMUNG CROWNWEED AT 15 LBS./ACRE AND KENTUCKY 31 TALL FESCUE AT 40 LBS./ACRE AS THE SEEDING REQUIREMENT. OPTIMUM SEEDING DATE FOR THIS MIXTURE IS MARCH 1 TO APRIL 30.

**SEDIMENT CONTROL NOTES**

1. A MINIMUM OF 24 HOURS NOTICE MUST BE GIVEN TO THE HOWARD COUNTY OFFICE OF INSPECTIONS AND PERMITS PRIOR TO THE START OF ANY CONSTRUCTION (992-2437).
2. ALL VEGETATIVE AND STRUCTURAL PRACTICES ARE TO BE INSTALLED ACCORDING TO THE PROVISIONS OF THIS PLAN AND ARE TO BE IN CONFORMANCE WITH THE 1983 MARYLAND STANDARDS AND SPECIFICATIONS FOR SOIL EROSION AND SEDIMENT CONTROL.
3. FOLLOWING INITIAL SOIL DISTURBANCE OR REDISTURBANCE, PERMANENT OR TEMPORARY STABILIZATION SHALL BE COMPLETED WITHIN: A) 7 CALENDAR DAYS FOR ALL PERIMETER SEDIMENT CONTROL STRUCTURES, DIKES, PERIMETER SLOPES AND ALL GREATER THAN 3:1 TO 14 DAYS AS TO ALL OTHER DISTURBED AREAS ON THE PROJECT SITE.
4. ALL SEDIMENT TRAPS/BASINS SHOWN MUST BE FENCED AND WARNING SIGNS POSTED AROUND THEIR PERIMETER IN ACCORDANCE WITH VOL. 1, CHAPTER 12 OF THE HOWARD COUNTY DESIGN MANUAL, STORM DRAINAGE.
5. ALL DISTURBED AREAS MUST BE STABILIZED WITHIN THE TIME PERIOD SPECIFIED ABOVE IN ACCORDANCE WITH THE 1983 MARYLAND STANDARDS AND SPECIFICATIONS FOR SOIL EROSION AND SEDIMENT CONTROL FOR PERMANENT SEEDINGS (SEC. 50 SOD (SEC. 54), TEMPORARY SEEDING (SEC. 50) AND MULCHING (SEC. 52). TEMPORARY STABILIZATION WITH MULCH ALONE CAN ONLY BE DONE WHEN RECOMMENDED SEEDING DATES DO NOT ALLOW FOR PROPER GERMINATION AND ESTABLISHMENT OF GRASSES.
6. ALL SEDIMENT CONTROL STRUCTURES ARE TO REMAIN IN PLACE AND ARE TO BE MAINTAINED IN OPERATIVE CONDITION UNTIL PERMISSION FOR THEIR REMOVAL HAS BEEN OBTAINED FROM THE HOWARD COUNTY SEDIMENT CONTROL INSPECTOR.
7. SITE ANALYSIS:  
 TOTAL AREA OF SITE 3.910 ACRES  
 AREA DISTURBED 0.53 ACRES  
 AREA TO BE ROOFED OR PAVED 0.71 ACRES  
 AREA TO BE VEGETATIVELY STABILIZED 0.32 ACRES  
 TOTAL CUT CU.YDS.  
 TOTAL FILL CU.YDS.  
 OFFSITE WASTE/BORROW AREA LOCATION CU.YDS.
8. ANY SEDIMENT CONTROL PRACTICE WHICH IS DISTURBED BY GRADING ACTIVITY FOR PLACEMENT OF UTILITIES MUST BE REPAIRED ON THE SAME DAY OF DISTURBANCE.
9. ADDITIONAL SEDIMENT CONTROLS MUST BE PROVIDED, IF DEEMED NECESSARY BY THE HOWARD COUNTY DPW SEDIMENT CONTROL INSPECTOR, ON ALL SITES WITH DISTURBED AREAS IN EXCESS OF 2 ACRES. APPROVAL OF THE INSPECTION AGENCY SHALL BE REQUESTED UPON COMPLETION OF INSTALLATION OF PERIMETER EROSION AND SEDIMENT CONTROLS, BUT BEFORE PROCEEDING WITH ANY OTHER EARTH DISTURBANCE OR GRADING. OTHER BUILDING OR GRADING INSPECTION APPROVALS MAY NOT BE AUTHORIZED UNTIL THIS INITIAL APPROVAL BY THE INSPECTION AGENCY IS MADE.
10. APPROVAL OF THE INSPECTION AGENCY SHALL BE REQUESTED UPON COMPLETION OF INSTALLATION OF PERIMETER EROSION AND SEDIMENT CONTROLS, BUT BEFORE PROCEEDING WITH ANY OTHER EARTH DISTURBANCE OR GRADING. OTHER BUILDING OR GRADING INSPECTION APPROVALS MAY NOT BE AUTHORIZED UNTIL THIS INITIAL APPROVAL BY THE INSPECTION AGENCY IS MADE.

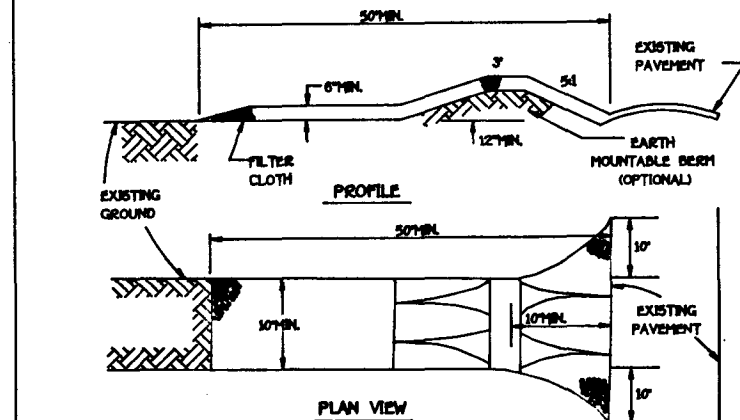

**CONSTRUCTION SPECIFICATIONS**

1. STONE SIZE - USE #1 STONE OR RECLAIMED OR RECYCLED CONCRETE EQUIVALENT.
2. LENGTH - AS REQUIRED, BUT NOT LESS THAN 50 FEET EXCEPT ON A SINGLE RESIDENCE LOT WHERE A 30 FOOT MINIMUM LENGTH WOULD APPLY.
3. THICKNESS - NOT LESS THE SIX (6) INCHES.
4. WIDTH - TEN (10) FOOT MINIMUM BUT NOT LESS THAN THE FULL WIDTH AT POINTS WHERE INGRESS OR EGRESS OCCURS.
5. FILTER CLOTH - WILL BE PLACED OVER THE ENTIRE AREA PRIOR TO PLACING OF STONE. FILTER WILL NOT BE REQUIRED ON A SINGLE FAMILY RESIDENCE LOT.
6. SURFACE WATER - ALL SURFACE WATER FLOWING OR DIVERTED TOWARD CONSTRUCTION ENTRANCES SHALL BE PIPED ACROSS THE ENTRANCE. IF PIPING IS IMPRACTICAL, A MOUNTABLE BERTH WITH 5:1 SLOPES WILL BE PROVIDED.
7. MAINTENANCE - THE ENTRANCE SHALL BE MAINTAINED IN A CONDITION WHICH WILL PREVENT TRACKING OR FLOWING OF SEDIMENT ONTO PUBLIC RIGHTS-OF-WAY. THIS MAY REQUIRE PERIODIC TOP DRESSING WITH ADDITIONAL STONE AS CONDITIONS DEMAND AND REPAIR AND JOB CLEAROUT OF ANY WEARERS USED TO TRAP SEDIMENT. ALL SEDIMENT SPILLED, DISPOSED, WASHED OR TRACKED ONTO PUBLIC RIGHTS-OF-WAY MUST BE REMOVED IMMEDIATELY.
8. WASHING - WHEELS SHALL BE CLEARED TO REMOVE SEDIMENT PRIOR TO ENTRANCE ONTO PUBLIC RIGHTS-OF-WAY. WHEN WASHING IS REQUIRED, IT SHALL BE DONE ON AN AREA STABILIZED WITH STONE AND WHICH DRAINS INTO AN APPROVED SEDIMENT TRAPPING DEVICE.
9. PERIODIC INSPECTION AND NEEDED MAINTENANCE SHALL BE PROVIDED AFTER EACH RAIN.

**STABILIZED CONSTRUCTION ENTRANCE - 2**

NOT TO SCALE

**FISHER, COLLINS & CARTER, INC.**  
 CIVIL ENGINEERING CONSULTANTS & LAND SURVEYORS  
 9171 BALTIMORE NATIONAL PIKE, SUITE 100  
 ELLICOTT CITY, MARYLAND 21114  
 (410) 461-2855

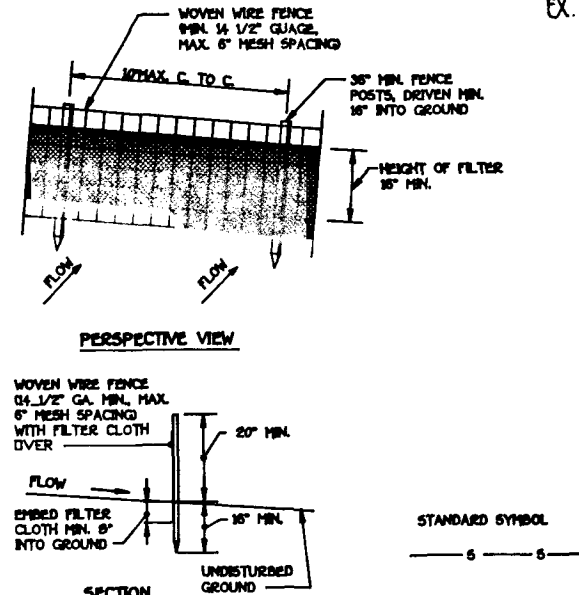

**CONSTRUCTION NOTES FOR FABRICATED SILT FENCE**

1. MOVING WIRE FENCE TO BE FASTENED SECURELY TO FENCE POSTS WITH WIRE TIES OF STAPLES.
2. FILTER CLOTH TO BE FASTENED SECURELY TO MOVING WIRE FENCE WITH TIES SPACED EVERY 24" AT TOP AND MID SECTION.
3. WHEN TWO SECTIONS OF FILTER CLOTH ADJOIN EACH OTHER THEY SHALL BE OVERLAPPED BY SIX INCHES AND FOLDED.
4. MAINTENANCE SHALL BE PERFORMED AS NEEDED AND MATERIAL REMOVED WHEN "BULGES" DEVELOP IN THE SILT FENCE.

**SILT FENCE**

NOT TO SCALE

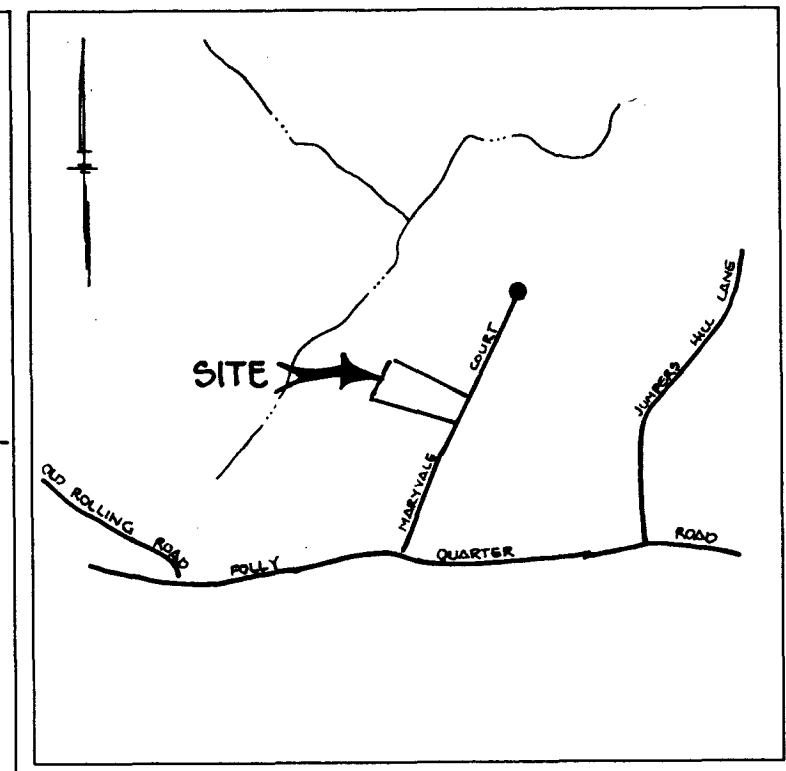
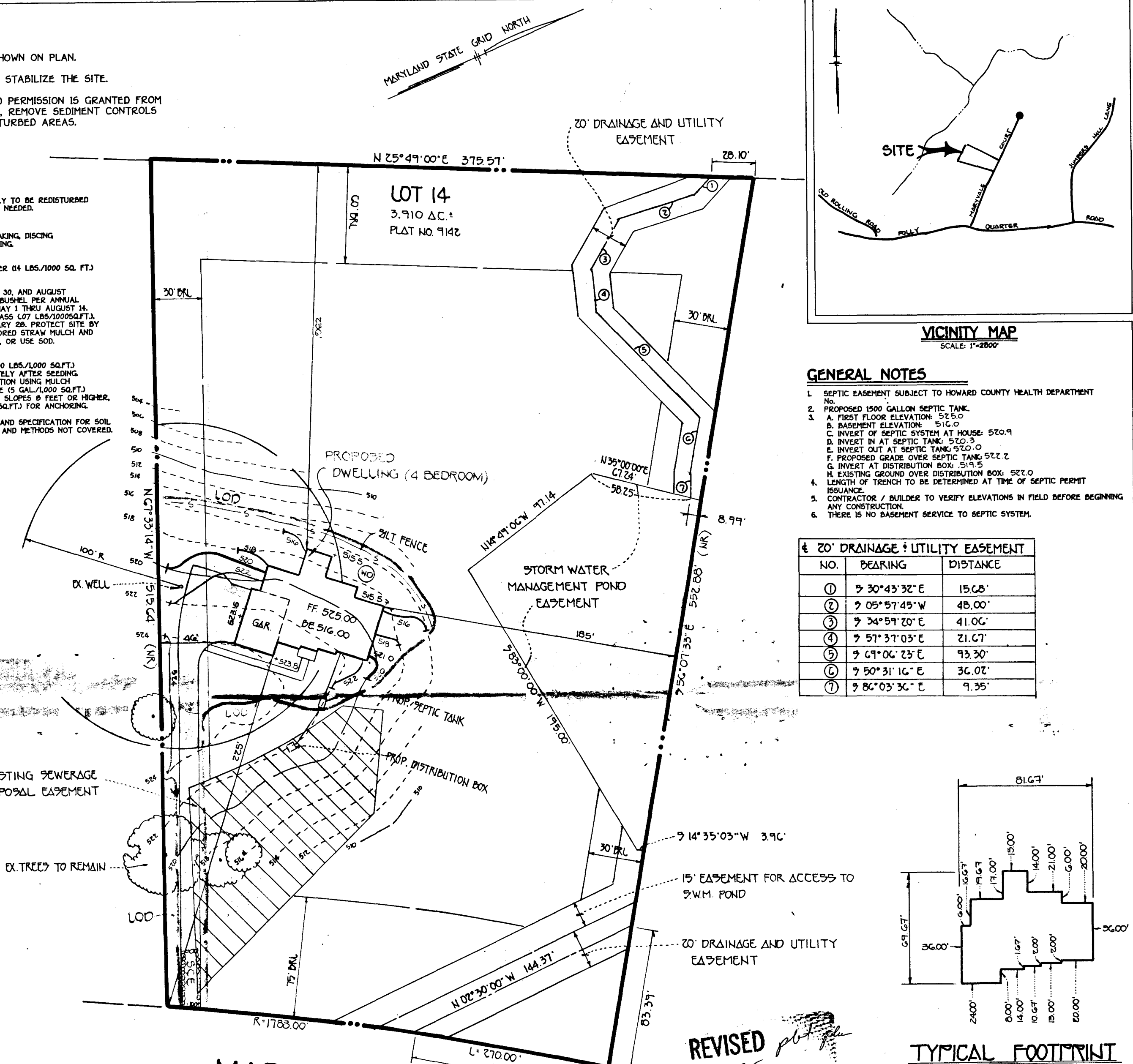

**VICINITY MAP**  
 SCALE: 1"=200'

**GENERAL NOTES**

1. SEPTIC EASEMENT SUBJECT TO HOWARD COUNTY HEALTH DEPARTMENT
2. PROPOSED 1500 GALLON SEPTIC TANK
3. A. FIRST FLOOR ELEVATION: 525.0  
 B. BASEMENT ELEVATION: 516.0  
 C. INVERT OF SEPTIC SYSTEM AT HOUSE: 520.9  
 D. INVERT IN AT SEPTIC TANK: 520.3  
 E. INVERT OUT AT SEPTIC TANK: 520.0  
 F. PROPOSED GRADE OVER SEPTIC TANK: 522.2  
 G. INVERT AT DISTRIBUTION BOX: 519.5  
 H. EXISTING GROUND OVER DISTRIBUTION BOX: 522.0
4. LENGTH OF TRENCH TO BE DETERMINED AT TIME OF SEPTIC PERMIT ISSUANCE.
5. CONTRACTOR / BUILDER TO VERIFY ELEVATIONS IN FIELD BEFORE BEGINNING ANY CONSTRUCTION.
6. THERE IS NO BASEMENT SERVICE TO SEPTIC SYSTEM.

20' DRAINAGE & UTILITY EASEMENT		
NO.	BEARING	DISTANCE
1	S 30°43'32" E	15.08'
2	S 05°57'45" W	48.00'
3	S 34°59'20" E	41.06'
4	S 57°37'03" E	21.67'
5	S 69°06'23" E	93.30'
6	S 50°31'16" E	36.02'
7	S 86°03'36" E	9.35'

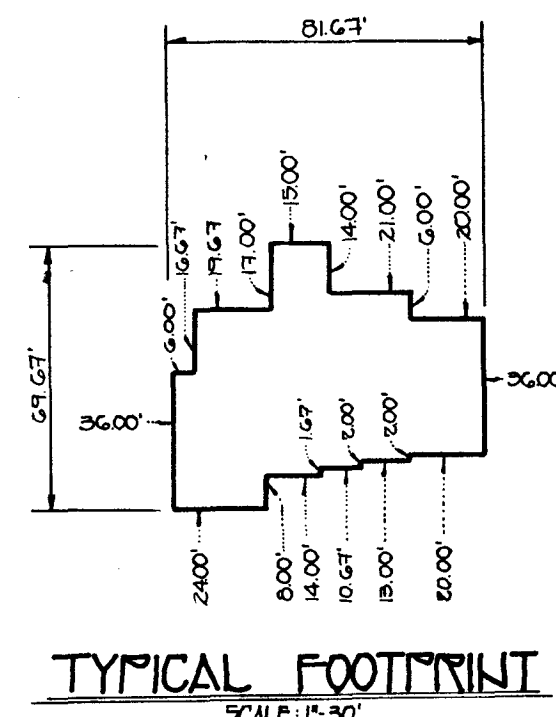

**TYPICAL FOOTPRINT**  
 SCALE: 1"=30'

Approved Septic System Plan  
 Howard County Health Department

*Amy McMullen* 3-18-95  
 Signature Date



REVISED  
 Date: 3/13/95  
 Comments: 12719 Maryvale Ct  
 57271  
 Change base type

PLAN TO ACCOMPANY APPLICATION  
 FOR BUILDING PERMIT  
**SECOND DISCOVERY**

LOT 14  
 TAX MAP 22 ZONED R P/O PARCELS 44145  
 THIRD ELECTION DIST. HOWARD COUNTY, MARYLAND  
 SCALE: 1" = 50' DATE: MARCH 1, 1995

60278

B 1 6362

SEQUENCE NO. (DP USE ONLY)

STATE OF MARYLAND PERMIT TO DRILL WELL

STATE PERMIT NUMBER

40-88-1172

please print or type

fill in this form completely

(THIS NUMBER IS TO BE PUNCHED IN COLS. 3-6 ON ALL CARDS)

Date Received (APA)

122889

OWNER INFORMATION

Fee Dis-Ltd Partner

8307 Main Street

Ellicott City Md 21043

DRILLER INFORMATION

Frank Delph 453

Frank Delph Well Drillers Inc

18234 Penn Shop Rd Mt Airy Md

Signature Date 12/19/89

B 3

LOCATION OF WELL

Howard

Second Discovery

SECTION 1 LOT 14

Steneig

MILES FROM TOWN (enter 0 if in town) 1 MI

B 4

DIRECTION OF WELL FROM TOWN (CIRCLE BOX)

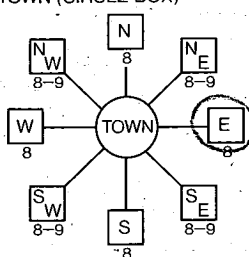

Maryvale Court

ON WHICH SIDE OF ROAD (CIRCLE APPROPRIATE BOX)



250 DISTANCE FROM ROAD

ENTER FT OR MI FT

B 2

WELL INFORMATION

APPROX. PUMPING RATE (GAL. PER MIN.) 5

AVERAGE DAILY QUANTITY NEEDED (GAL. PER DAY) 500

USE FOR WATER (CIRCLE APPROPRIATE BOX)

- Home (single or double household unit only)
Farming (livestock watering & agricultural irrigation)
Industrial, commercial, state and federal gov. other (requires appropriation permit)
Public or private water company (requires appropriation permit and state health department approval)
Test, observation, monitoring (may require appropriation permit)

NOT TO BE FILLED IN BY DRILLER HEALTH DEPARTMENT APPROVAL

Howard A42204

STATE SIGNATURE DATE ISSUED

012590 Mark E. Poffin 7/25/90

NORTH GRID 520000 EAST GRID 0812000

APPROXIMATE DEPTH OF WELL 200 FEET

APPROXIMATE DIAMETER OF WELL 6 INCH

METHOD OF DRILLING (circle one)

- Bored (or Augered) Jetted Jetted & Driven
Air-ROtary Air-PERcussion ROTARY (Hydraulic Rotary)
CABLE REVerse-ROtary Drive-POINT

SHOW MAJOR FEATURES OF BOX & LOCATE WELL WITH AN X

SOURCES OF DRILLING WATER 1. Well

WRITE THE BOX NUMBER FROM THE MAP HERE

812 5X20

Handwritten notes: 5/19/90 no in sp, 5/20/90 well already cased, 353, 25050, 5100

DRAW A SKETCH BELOW SHOWING LOCATION OF WELL IN RELATION TO NEARBY TOWNS AND ROADS AND GIVE DISTANCE FROM WELL TO NEAREST ROAD JUNCTION.

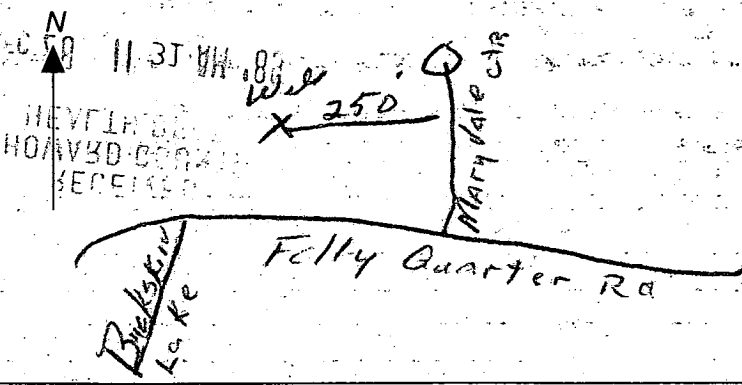

REPLACEMENT OR DEEPEMED WELLS (CIRCLE APPROPRIATE BOX)

- N THIS WELL WILL NOT REPLACE AN EXISTING WELL
Y THIS WELL WILL REPLACE A WELL THAT WILL BE ABANDONED AND SEALED
S THIS WELL WILL REPLACE A WELL THAT WILL BE USED AS A STANDBY
D THIS WELL WILL DEEPEM AN EXISTING WELL

PERMIT NUMBER OF WELL TO BE REPLACED OR DEEPEMED (IF AVAILABLE)

Not to be filled in by driller (OEP USE ONLY)

APPROP. PERMIT NUMBER GAP

FORCE MI PERMIT No. 40-88-1172

SPECIAL CONDITIONS

5/21/90

- ① 22 ft casing
  - ② 19 ft open hole
  - ③ 5 bags
  - ④ Well Grouted Sat May 19  
Got information at time  
of pump test May 4, 1990
  - ⑤ Well OK
- R D

C1 1314

SEQUENCE NO. (DENY USE ONLY)

STATE OF MARYLAND WELL COMPLETION REPORT

THIS REPORT MUST BE SUBMITTED WITHIN 45 DAYS AFTER WELL IS COMPLETED.

(THIS NUMBER IS TO BE PUNCHED IN COLS. 3-6 ON ALL CARDS)

COUNTY NUMBER A42204

ST/CO USE ONLY DATE RECEIVED

DATE WELL COMPLETED

Depth of Well (TO NEAREST FOOT) 165

PERMIT NO. FROM "PERMIT TO DRILL WELL" 41-88-1172

OWNER SECOND DISCOVERY LTD. Partnership last name first name STREET OR RFD TOWN Glenelia SUBDIVISION SEABOARD DISCOVERY SECTION LOT 14

WELL LOG Not required for driven wells STATE THE KIND OF FORMATIONS PENETRATED, THEIR COLOR, DEPTH, THICKNESS AND IF WATER BEARING

Table with columns: DESCRIPTION (Use additional sheets if needed), FEET (FROM, TO), Check if water bearing. Rows include Top Soil, Shale, MIKA, Sandstone, MIKA, Sandstone, MIKA.

GROUTING RECORD WELL HAS BEEN GROUTED (Y/N) TYPE OF GROUTING MATERIAL CEMENT BENTONITE CLAY NO. OF BAGS NO. OF POUNDS GALLONS OF WATER DEPTH OF GROUT SEAL

CASING RECORD casing types insert appropriate code below ST CO PL OT STEEL CONCRETE PLASTIC OTHER

MAIN CASING TYPE Nominal diameter top (main) casing (nearest inch) Total depth of main casing (nearest foot)

OTHER CASING (if used) diameter inch depth (feet) from to

SCREEN RECORD screen type or open hole insert appropriate code below ST BR HO PL OT STEEL BRASS OPEN HOLE PLASTIC OTHER

Table with columns: E A C H S C R E E N, DEPTH (nearest ft.), SLOT SIZE, DIAMETER OF SCREEN

CIRCLE APPROPRIATE LETTER. A A WELL WAS ABANDONED AND SEALED WHEN THIS WELL WAS COMPLETED. E ELECTRIC LOG OBTAINED. P TEST WELL CONVERTED TO PRODUCTION WELL.

I HEREBY CERTIFY THAT THIS WELL HAS BEEN CONSTRUCTED IN ACCORDANCE WITH COMAR, 26.04.04 "WELL CONSTRUCTION" AND IN CONFORMANCE WITH ALL CONDITIONS STATED IN THE ABOVE CAPTIONED PERMIT, AND THAT THE INFORMATION PRESENTED HEREIN IS ACCURATE AND COMPLETE TO THE BEST OF MY KNOWLEDGE.

DRILLERS IDENT. NO. 453 DRILLERS SIGNATURE SITE SUPERVISOR (sign of driller or journeyman responsible for sitework if different from permittee)

GRAVEL PACK IF WELL DRILLED WAS FLOWING WELL INSERT F IN BOX 68

OEP USE ONLY (NOT TO BE FILLED IN BY DRILLER) T (E.R.O.S.) W Q TELESCOPE CASING LOG INDICATOR OTHER DATA

PUMPING TEST HOURS PUMPED (nearest hour) PUMPING RATE (gal. per min. to nearest gal.) METHOD USED TO MEASURE PUMPING RATE WATER LEVEL (distance from land surface) BEFORE PUMPING WHEN PUMPING TYPE OF PUMP USED (for test) A air P piston T turbine C centrifugal R rotary O other (describe below) J jet S submersible

PUMP INSTALLED DRILLER WILL INSTALL PUMP YES NO (CIRCLE) (YES or NO) IF DRILLER INSTALLS PUMP, THIS SECTION MUST BE COMPLETED FOR ALL WELLS EXCEPT HOME USE TYPE OF PUMP INSTALLED PLACE (A,C,J,P,R,S,T,O) IN BOX - SEE ABOVE: CAPACITY: GALLONS PER MINUTE (to nearest gallon) PUMP HORSE POWER PUMP COLUMN LENGTH (nearest ft.) CASING HEIGHT (circle appropriate box and enter casing height) LAND SURFACE

