

SEPTIC SYSTEM INSTALLED PRIOR TO ISSUANCE OF BUILDING PERMIT.

3/30/89 ASAP

05-386829

Hours connection REQ'D

3/31/89 12/13/89

# PERMIT

File

N

P 43676

SEWAGE DISPOSAL SYSTEM

A 41692

MARYLAND STATE DEPARTMENT OF HEALTH DISTRICT 5th

HOWARD COUNTY  
BUREAU OF ENVIRONMENTAL HEALTH  
461-9933

## INDEXED

DATE 2/28/89

DATE SYSTEM APPROVED 12/13/89

INSPECTOR C.B.D.

(DENNIS FENGA)

John F. McMahon Construction Company, Inc.

IS PERMITTED TO INSTALL  ALTER

ADDRESS 8600 Snowden Loop, Laurel, Maryland 20708 PHONE 490-4084

SUBDIVISION Kalmia Farms ROAD 520<sup>8</sup> Kalmia Drive LOT 33

PROPERTY OWNER Thomas Tanton

ADDRESS

IF GARBAGE GRINDER IS USED INCREASE SEPTIC TANK CAPACITY BY 50% AND ABSORPTION AREA BY 22%.

GARBAGE GRINDER? YES \_\_\_\_\_ NO

SEPTIC TANK CAPACITY 1750 GALLONS NUMBER OF BEDROOMS 6

TRENCHES - 210 sq. ft. per bedroom. Trench to be 2 feet wide. Inlet 4.0 feet below original grade. Bottom maximum depth 9.0 feet below original grade. Effective area begins at 4.0 feet below original grade. 5 feet of stone below distribution pipe.

LOCATION - Beginning at the front right lot corner when facing the property from Kalmia Drive, place the distribution box 280 feet down the front lot line (331.8/57.47') and 15 feet off the front lot line (331.8/57.47'). Run trenches on contour toward the right (115.0/326.15 ft) lot line.

NOTE - No trench to exceed 100 feet in length. Provide 6" - 8" diameter cleanout and cap to grade or above on septic tank. ok/cw

PLANS APPROVED BY Jane Nadeau DATE 1/23/89

COVER NO WORK UNTIL INSPECTED AND APPROVED

NEITHER THE HOWARD COUNTY COUNCIL NOR THE HEALTH DEPARTMENT IS RESPONSIBLE FOR THE SUCCESSFUL OPERATION OF ANY SYSTEM.

NOTE: CLEANOUT REQUIRED EVERY 70 FEET OF SEWER LINE AND/OR AT 90° SWEEPS IN LINES FROM HOUSE TO DRAIN FIELDS

NOTE: ALL PARTS OF SEPTIC SYSTEMS (I.E. TANK, DISTRIBUTION BOX, TRENCHES) TO BE 100 FEET FROM WELL (UNLESS OTHERWISE SPECIFICALLY AUTHORIZED)

NOTE: IF DEEP TRENCHES ARE USED CALL FOR INSPECTION BEFORE AND AFTER PLACING GRAVEL IN TRENCHES

NOTE: NO DRY WELL SHALL EXCEED 15 FOOT IN DIAMETER NO ABSORPTION TRENCH TO EXCEED 100 FEET IN LENGTH.

NOTE: ALL PIPE FROM HOUSE TO SEPTIC TANK MUST BE CAST IRON OR SCHEDULE 40 PVC OR ABS

PERMIT VOID AFTER TWO YEARS

NOTE: INSTALL STAND PIPE ON SEPTIC TANK AND DRY WELL. STAND PIPES MUST BE 6 INCHES IN DIAMETER. CAST IRON, CONCRETE OR TERRA COTTA OR PVC OR ABS ACCEPTED. IF TOP OF SEPTIC TANK IS DEEPER THAN 3 FEET, MANHOLE TO GRADE REQUIRED

NOTE: DISTRIBUTION BOXES MUST HAVE BAFFLES

**\*INSTALLER IS RESPONSIBLE FOR OBTAINING FINAL APPROVAL ON THIS PERMIT**

\*CALL 461-9933 FOR INSPECTION OF SEPTIC SYSTEMS.

A 41692

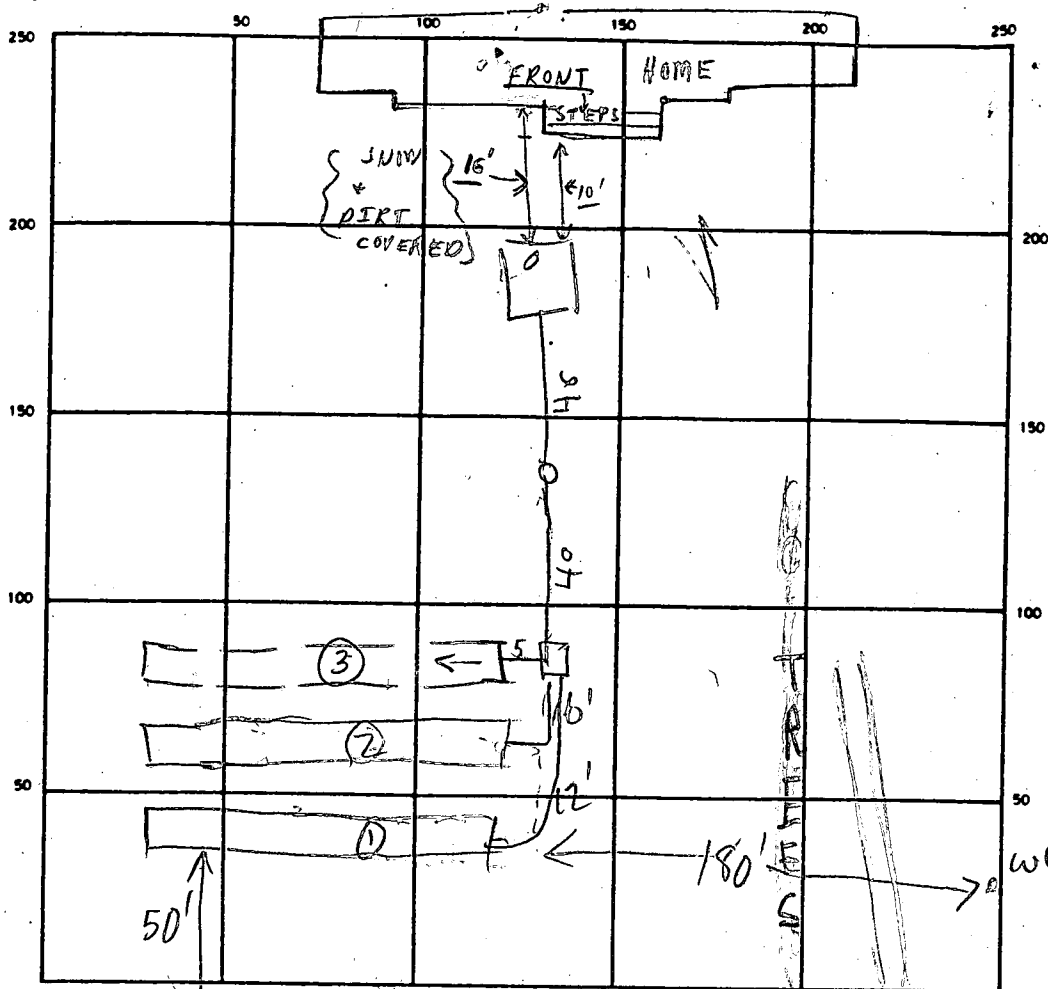

well HO-88-0390

INDICATE-NORTH - NAME ADJOINING ROADWAY AS BASE LINE  
KALMIA DR

SEPTIC TANK. LEVEL 2000 CLEANOUTS 

ST	HS
OK	OK

DISTRIBUTION BOX. LEVEL \_\_\_\_\_

DRAIN FIELD/TILE FIELD. DEPTH 9 FT. TRENCH WIDTH 2 FT. INLET DEPTH 4 FT.

EFFECTIVE GRAVEL DEPTH 5 FT. TOTAL LENGTH 286 FT. 286 } 260 FT. 26 FT.

NUMBER OF TRENCHES 3 ONE SIDEWALL/BOTTOM AREA 1300 SQ. FT.

DRYWELL INSIDE DIAMETER \_\_\_\_\_ FT. EFFECTIVE DEPTH BELOW INLET \_\_\_\_\_ FT.

ABSORBENT AREA \_\_\_\_\_ SQ. FT.

REMARKS 3/30/89 OK TO ADD STONE TO TRENCHES (AS NEEDED FOR WORK ACCESS, CU)  
3/30/89<sup>A</sup> TRENCH 1 DUG, STONE IN PROCESS, TRENCH 2  
IN PROCESS w/3' DUG MR; 3/30<sup>B</sup> TRENCH 2 DUG TO 67' MR;  
3/30/89<sup>C</sup> 1 2 TRENCHES COMPLETE, 3 DUG, READY FOR STONE MR  
3/31/89 - STONE ADDED TO TRENCH #3 TANK & PIPE TO BOX OK TOP OF TANK  
IS 3 FT ABOVE GRADE BUT WILL BE COVERED LATER, COVER WORK R/A  
12/13/89 HOUSE CONNECTION APPEARS-OK; WATER TEST-OK.  
 DATE SYSTEM APPROVED 12/13/89 INSPECTOR Charles Bryan Stecker

July 8<sup>th</sup> 1988  
1:30 PM  
Appl

# APPLICATION

PERCOLATION TESTING

A 41692

P \_\_\_\_\_

HOWARD COUNTY HEALTH DEPARTMENT  
BUREAU OF ENVIRONMENTAL HEALTH  
P.O. BOX 476 ELLICOTT CITY, MARYLAND 21043  
TELEPHONE: 461-9933

*Cancelled  
by owner  
Mr. Hill  
9/22/88  
S/81*

DISTRICT \_\_\_\_\_

DATE \_\_\_\_\_

TO: THE COUNTY HEALTH OFFICER  
ELLICOTT CITY, MARYLAND

I HEREBY APPLY FOR THE NECESSARY TEST IN ORDER TO CONSTRUCT (OR RECONSTRUCT) A SEWAGE DISPOSAL SYSTEM.

PROPERTY OWNER ~~George W Hill~~ DR & MRS. THOMAS TANTON

ADDRESS 605 NOTLEY RD Silver Spring PHONE \_\_\_\_\_

PROSPECTIVE BUYER George W. Hill

ADDRESS 9117 Flamepool Way, Columbia, MD PHONE 301/596-6104

PROPERTY LOCATION: W-731-9070

SUBDIVISION KALMIA FARMS LOT NO. 33

ROAD AND DESCRIPTION 5204 KALMIA DRIVE DAYTON

TAX MAP \_\_\_\_\_ PARCEL # \_\_\_\_\_

SIZE OF LOT 9.40 ACRES TYPE BLDG SINGLE FAMILY  
(SINGLE FAMILY DWELLING OR COMMERCIAL)

THE SYSTEM INSTALLED UNDER THIS APPLICATION IS ACCEPTABLE ONLY UNTIL PUBLIC FACILITIES BECOME AVAILABLE. I FULLY UNDERSTAND THE FEE CONNECTED WITH THE FILING OF THIS PERC TEST APPLICATION IS NON-REFUNDABLE UNDER ANY CIRCUMSTANCES. I ALSO AGREE TO COMPLY WITH ALL M.O.S.H.A. REQUIREMENTS IN TESTING THIS LOT.

Sandra E. Hill  
(SIGNATURE OF APPLICANT)

APPROVED BY S. Alue FOR Deep trench DATE 3-21-89

REJECTED BY \_\_\_\_\_ FOR \_\_\_\_\_ DATE \_\_\_\_\_

HOLD PENDING FURTHER TESTS \_\_\_\_\_ DATE \_\_\_\_\_

REASONS FOR REJECTION OR HOLDING \_\_\_\_\_

#24206

BLDG. PERMIT SIGNED  
AND RETURNED 4/5/89 SA

HD-216

# THIS IS NOT A PERMIT

SOIL PROFILE

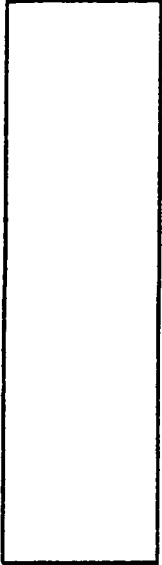
0' 

INDICATE NORTH - NAME ADJOINING ROADWAY AS BASE LINE.

DATE	TEST NO.	DEPTH	PRE-WET		TEST - 1" DROP		TIME
			START	STOP	START	STOP	

REMARKS \_\_\_\_\_

TYPE OF SOIL \_\_\_\_\_

TESTED BY \_\_\_\_\_ ALSO PRESENT \_\_\_\_\_





# Final  
33

System  
Final  
per  
supervisor  
KALMIA SEC I

Hold + check, hope location  
Final  
#33  
2/16/78  
Field copy  
New per area

Inlet 4'  
Muddy 9'

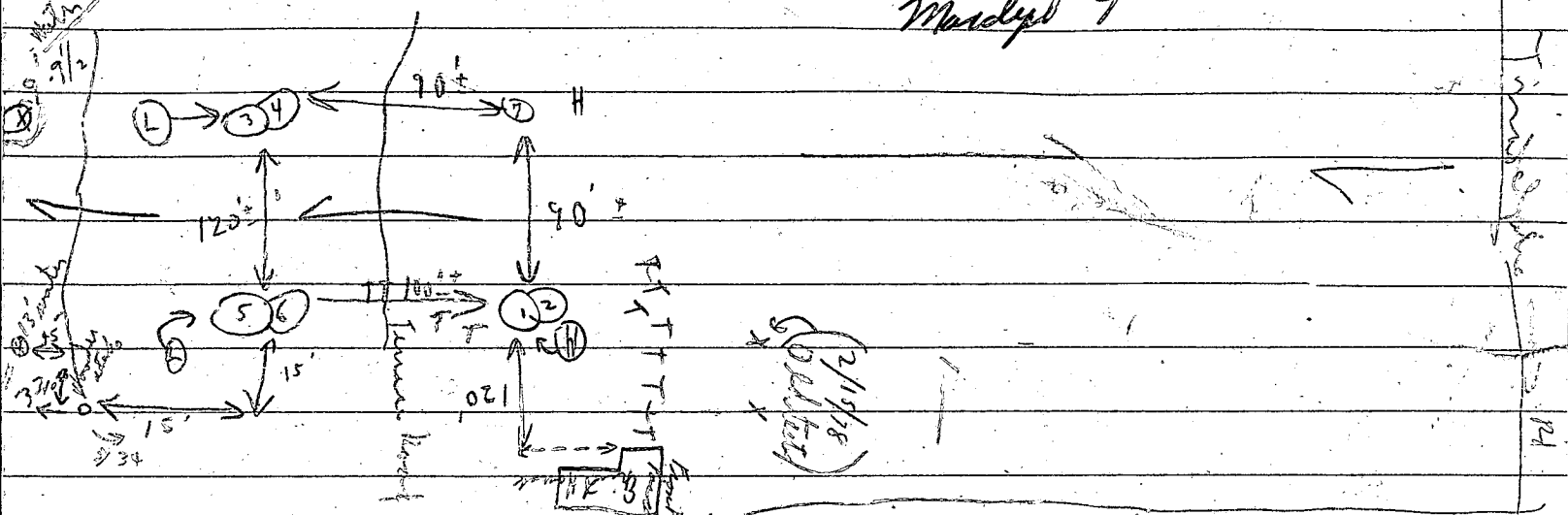

#	Soil	Depth	1st start	2nd start	Final	Total
1	(34)	4 1/2'	1:10	1:26	1:38	18m
2	Profile	13'	1:10	1:24	1:52	28m
3		5'	1:00	1:05	1:12	7m
4	Below	14'	1:00	1:16 out	1:35	20m
5	sand	3'	12:57	1:01 out	1:06	5m
6	below clay	13 1/2'	12:58	1:01	1:04	3m
7	loam	13'	Visual	to (1+2)	6:81	

14mm avg  
Soil 4 1/2'

C.B.D

Mostly open area total

1 of Boenders Men  
2 of Fyorko

Light snow started snowing 1:10

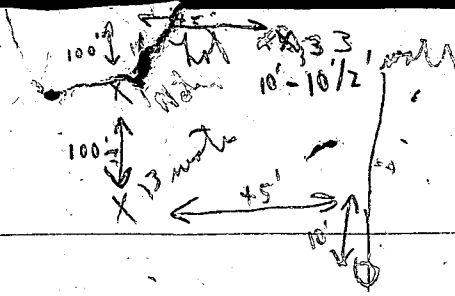

2/16/78

	depth	1	2	Final	Total
Soil Profile	4'	2:31	2:35	2:42	2 mi
Clayish Thin brown	10'	2:48	2:53	3:03	10 mi
	13'	skates	X X	X X	

CBE

Revised lot + new  
 ↓ lot #33

Combine  
 with  
 #34  
 apparently

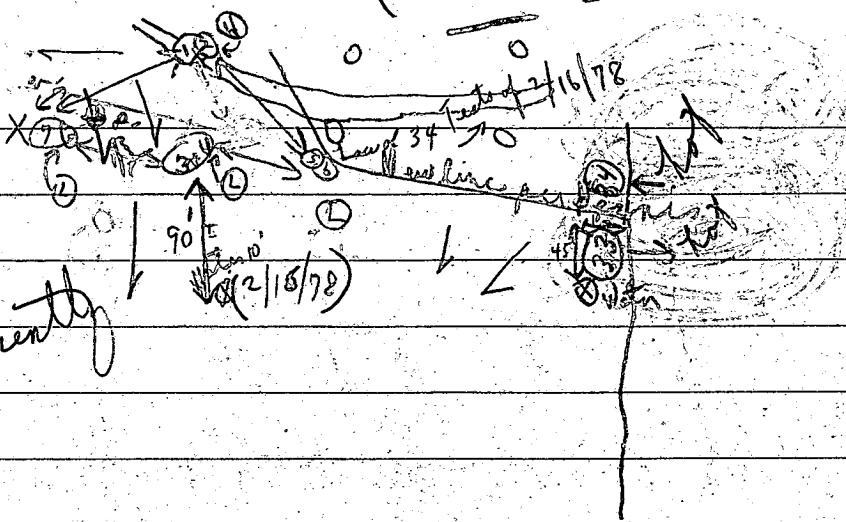

Calage

lot 33  
 2/17/78  
 still  
 not  
 approved

lot 33

Soil Profile	# Holes	Depth	1st start	2nd start	End	Total
Below 2/17/78					3/4"	XX
clay	①	5 1/2'	10:38	10:50	11:22	X 32"
	②	13'	10:38	11:08 1/2"	X: X	XX/
(loamy consistency)	③	3 3'	10:56	10:59	11:02	3m
	④	4 12 1/2'	10:57	11:01	11:12	11m
	⑤					
	⑥					
	⑦					
	⑧	2 1/2'	11:23	11:54	12:08	1/2" x max
	⑨	12 1/2'	11:23	11:36	12:08	X X X X X X X X (1/8" x max)
	2 B	12	Not marked			what did it pass

(Runch 19:15-13:09) Tests → No open area soil too may traces  
 C. B. S. 2 of Fyochs men  
 Dennis Kirk & Craig

Weather - Sunny

# APPLICATION

27475

A \_\_\_\_\_  
P \_\_\_\_\_

## SEWAGE DISPOSAL TESTING

STATE OF MARYLAND - DEPARTMENT OF HEALTH AND MENTAL HYGIENE

HOWARD COUNTY HEALTH DEPARTMENT  
ENVIRONMENTAL HEALTH SERVICES  
P. O. BOX 476, ELLICOTT CITY, MARYLAND 21043  
TELEPHONE: 465-5000, EXT. 356

DISTRICT \_\_\_\_\_

DATE \_\_\_\_\_

TO: THE COUNTY HEALTH OFFICER  
ELLICOTT CITY, MARYLAND

I, HEREBY, APPLY FOR THE NECESSARY TEST IN ORDER TO CONSTRUCT (OR RECONSTRUCT) A SEWAGE DISPOSAL SYSTEM.

PROPERTY OWNER \_\_\_\_\_

ADDRESS \_\_\_\_\_ PHONE \_\_\_\_\_

PROPERTY LOCATION:

SUBDIVISION Kathmia Farms LOT NO. lot 33

ROAD AND DESCRIPTION off Tridelphia Mill Rd.

SIZE OF LOT \_\_\_\_\_ TYPE BLDG. \_\_\_\_\_ NUMBER OF BEDROOMS \_\_\_\_\_

IF NOT SINGLE RESIDENCE DESCRIBE \_\_\_\_\_

THE SYSTEM INSTALLED UNDER THIS APPLICATION IS ACCEPTABLE ONLY UNTIL PUBLIC FACILITIES BECOME AVAILABLE.

SIGNATURE OF APPLICANT \_\_\_\_\_

APPROVED BY \_\_\_\_\_ FOR \_\_\_\_\_ DATE \_\_\_\_\_  
(KIND OF SYSTEM)

REJECTED BY \_\_\_\_\_ FOR \_\_\_\_\_ DATE \_\_\_\_\_  
(KIND OF SYSTEM)

HOLD PENDING FURTHER TESTS \_\_\_\_\_ DATE \_\_\_\_\_

REASONS FOR REJECTION OR HOLDING \_\_\_\_\_

# THIS IS NOT A PERMIT

Lot 33

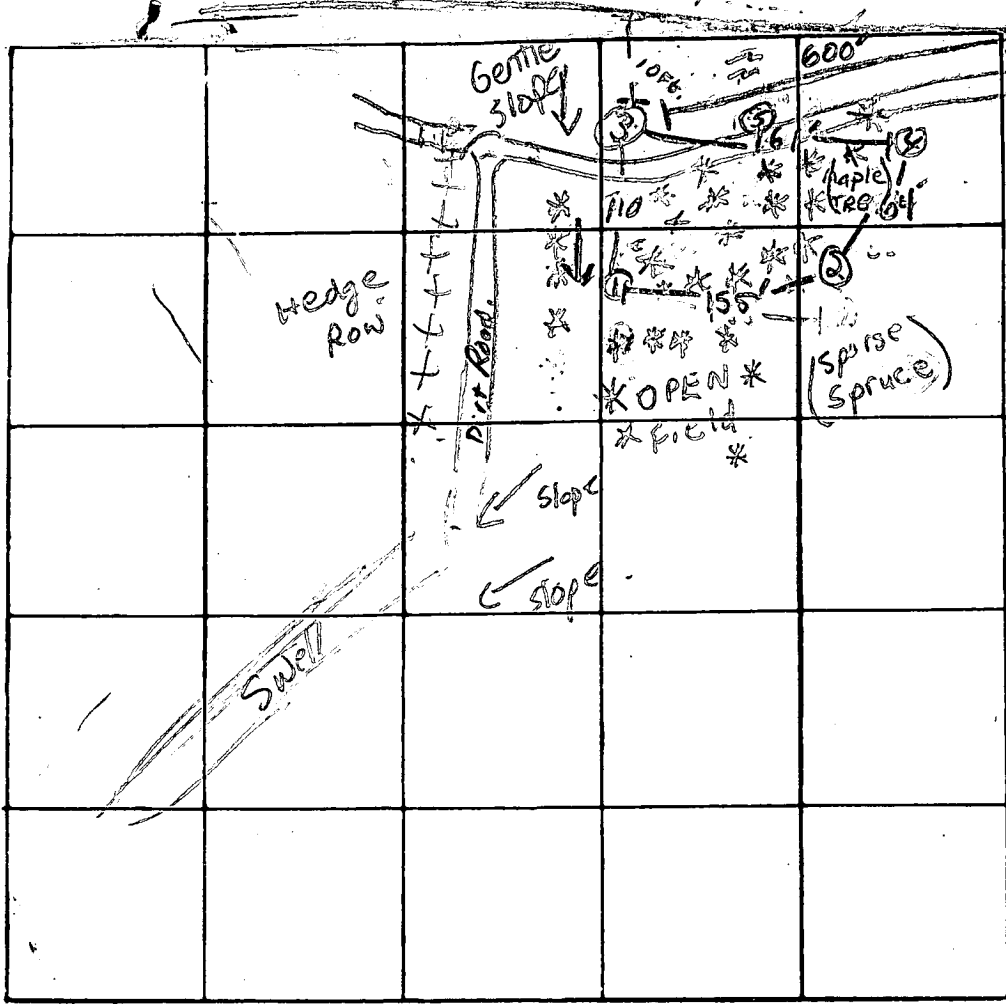

House  
 \* = Tree  
 Soil Profile  
 Red clay  
 5' Rotten and intact Sandstone, silty loam  
 9' water  
 11'

- ③ + 11ft
- ⑤ 7ft.
- ① water 12 1/2 - 13ft
- ② water 9ft.

INDICATE NORTH. - NAME ADJOINING ROADWAY AS BASE LINE

DATE	TEST NO.	DEPTH	PRE-WET		TEST - 1" DROP		TIME
			START	STOP	START	STOP	
3/17/78	① S	4'	12:09	12:27	12:27	pulled at 12:40	water at 12 1/2 - 13ft.
	D						
	② S						water at 9ft.
	D						
	③ S	3.5'	12:22	Failed to make 1 1/2" Mes		pulled at 12:37	
	D						
3/17/78	④ S	4'	12:00	Failed to make 1" Mes			hole has failed water at 11ft.
	D	11ft.					

REMARKS - Hole marked ⑤ has rock at 7ft. Test Aborted at request of Engineer  
 TYPE OF SOIL - Rotten and intact Sandstone, silty loam  
 TESTED BY - Mark Brown 3/17/78  
 Rejected by Mr. Monahan  
 ALSO PRESENT: - Wm. O'Neil, Dennis Rush  
 D. Russ

3/17/78 MR. Monahan, this top copy  
is the perk pedone on Friday - 3/17/78  
by David O'Neil and Myself. The originals  
are in the Kalmia Farms Folder. The bottom  
copy is the original that MR. Streaker did.  
These lots need to be approved  
or disapproved by yourself.

Mark Roggen 3/17/78

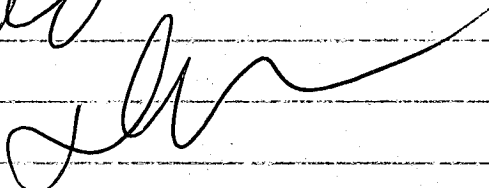
replied  

Revised lot + new  
 ↓ lot #33

Combine  
 with  
 #34  
 apparently

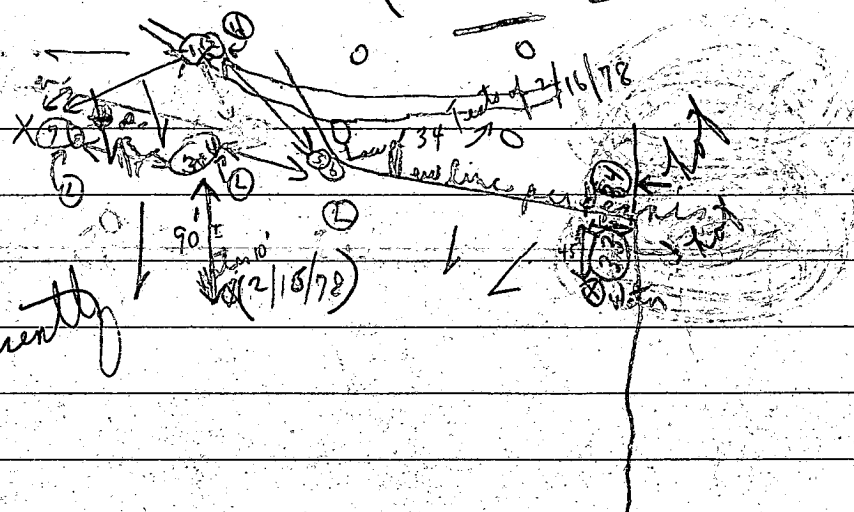

Calgo

lot 33  
 2/17/78  
 still  
 not  
 approved

lot #33

Soil Profile	# Holes	Depth	1st	2nd	End	Total
Below clay (loamy consistency)					3/4"	
	①	5 1/2'	10:38	10:50	11:22	X 32
	②	13'	10:38	11:08 1/2"	X: X	X X /
	③	3 3'	10:56	10:59	11:02	3 m
	④	4 12 1/2'	10:59	11:01	11:12	11 m
	⑤					
	⑥					
	⑦	2 1/2'	11:23	11:54	1/2" X mark	X X X X
	⑧	12 1/2'	11:23	11:36	12:08	X X X X X (1/8" X mark)
	2 B	12	Not marked			

(Punch 19:15-13:09) Tests → In open area not too many traces  
 C. B. 2 of Fyochs men  
 Remain back & stage

North - Eggs

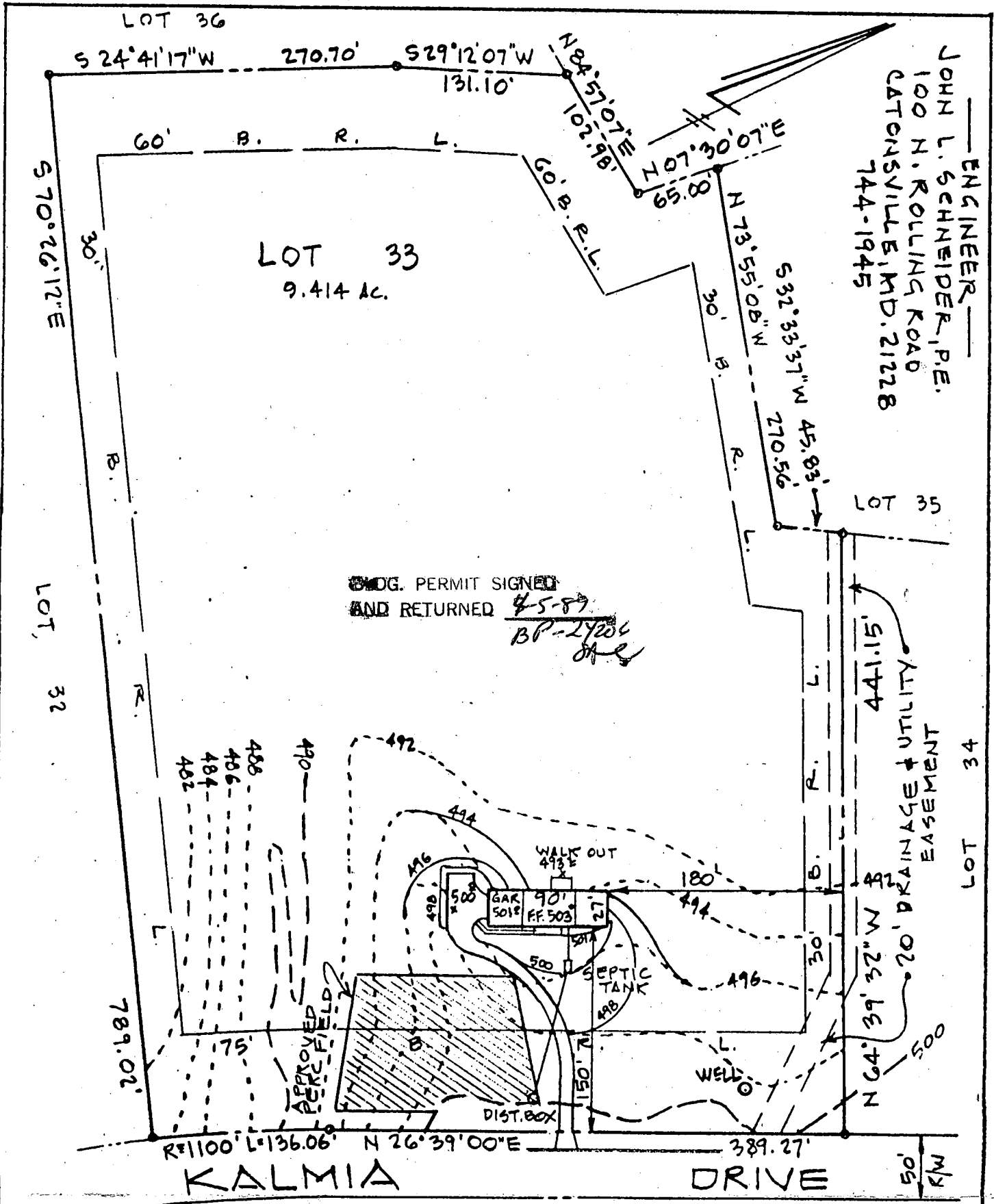

MOG. PERMIT SIGNED  
 AND RETURNED 4-5-89  
 BP-27206  
*[Signature]*

ENGINEER  
 JOHN L. SCHNEIDER, P.E.  
 100 N. ROLLING ROAD  
 CATONSVILLE, MD. 21228  
 744-1945

ELEVATIONS REVIEWED OK  
 "NO ROOM FOR 1 RAIL"  
 SEPTIC SYSTEM TO BE INSTALLED  
 PRIOR TO BUILDING PERMIT  
 APPROVAL

HOUSE FIN. FL.	503.0
" BSMT	494.0
" SEWER INV.	498.7
SEPTIC INV. IN	498.3
TANK INV. OUT	498.0
" FIN. GR.	500.0
DIST. INV. IN	496.0
BOX INV. OUT	495.0
" FIN. GR.	500.0

PLACE TRENCHES AS PER HEALTH DEPT. DESIGN

RECORD PLAT NO 4174

2/25/89  
*[Signature]*

GRADING STUDY  
 LOT 33 - SECTION 1 "KALMIA FARMS"  
 5th ELECTION DISTRICT





B 1 **2210** SEQUENCE NO. (DP USE ONLY)  
 (THIS NUMBER IS TO BE PUNCHED IN COLS. 3-6 ON ALL CARDS)

STATE OF MARYLAND  
 PERMIT TO DRILL WELL  
 please print or type

STATE PERMIT NUMBER  
**H0-88-0390**  
 fill in this form completely

Date Received (APA) **011789**  
 OWNER INFORMATION  
 Last Name **McMAHON** Owner **JOHN** First Name  
 Street or RFD **PO BOX 2747**  
 Town **LAUREL** State **MD** Zip **20708**

B 3 LOCATION OF WELL  
 COUNTY **HOWARD**  
 SUBDIVISION **KALMIA FARM**  
 SECTION **44** LOT **33**  
 NEAREST TOWN **DAYTON**  
 MILES FROM TOWN (enter 0 if in town) **3** MI

DRILLER INFORMATION  
 Driller's Name **Joseph L. Mayne** License No. **238**  
 Firm Name **Joseph L. Mayne WELL DRILLING**  
 Address **5512 Ridge Rd. Mt. Airy, Md. 21771**  
 Signature **Joseph L. Mayne** Date **1/16/89**

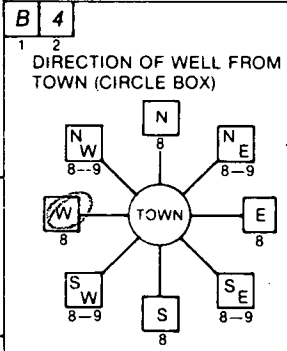

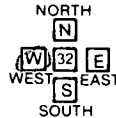
**Kalmia Drive**  
 NEAR WHAT ROAD  
 ON WHICH SIDE OF ROAD (CIRCLE APPROPRIATE BOX)  
  
 DISTANCE FROM ROAD **5** FT or MI **FT**

B 2 WELL INFORMATION  
 APPROX. PUMPING RATE (GAL. PER MIN.) **5**  
 AVERAGE DAILY QUANTITY NEEDED (GAL. PER DAY) **500**

NOT TO BE FILLED IN BY DRILLER HEALTH DEPARTMENT APPROVAL  
 COUNTY NAME **HOWARD** COUNTY NO. **A# 41692**  
 STATE SIGNATURE \_\_\_\_\_ INSERT S \_\_\_\_\_  
 DATE ISSUED **012389** x **Jane E. Hadean** 7/23/89  
 NORTH GRID **507000** EAST GRID **0795000**

USE FOR WATER (CIRCLE APPROPRIATE BOX)  
 HOME (SINGLE OR DOUBLE HOUSEHOLD UNIT ONLY)  
 FARMING (LIVESTOCK WATERING & AGRICULTURAL IRRIGATION)  
 INDUSTRIAL, COMMERCIAL, STATE AND FEDERAL GOV. OTHER (REQUIRES APPROPRIATION PERMIT)  
 PUBLIC OR PRIVATE WATER COMPANY (REQUIRES APPROPRIATION PERMIT AND STATE HEALTH DEPARTMENT APPROVAL)  
 TEST, OBSERVATION, MONITORING (MAY REQUIRE APPROPRIATION PERMIT)

APPROXIMATE DEPTH OF WELL **300** FEET  
 APPROXIMATE DIAMETER OF WELL **6** INCH NEAREST

SHOW MAJOR FEATURES OF BOX & LOCATE WELL WITH AN X  
 SOURCES OF DRILLING WATER  
 1. **WELL**  
 2.  
 3.  
 WRITE THE BOX NUMBER FROM THE MAP HERE  
 N **796**  
 S **500**  
 1-27-89  
 9:30  
**10 BAGS**  
**95 FT CASING**  
**45' OPEN**  
**1' CASING A.G.**  
**MR JTAG OK 1/27/89**

METHOD OF DRILLING (circle one)  
 BORED (or Augered)  JETTED  Jetted & DRIVEN  
 AIR-ROTARY  AIR-PERCussion  ROTARY (Hydraulic Rotary)  
 CABLE  REVERSE-ROTARY  Drive-POINT  
 other \_\_\_\_\_

REPLACEMENT OR DEEPEMED WELLS (CIRCLE APPROPRIATE BOX)  
 THIS WELL WILL NOT REPLACE AN EXISTING WELL  
 THIS WELL WILL REPLACE A WELL THAT WILL BE ABANDONED AND SEALED  
 THIS WELL WILL REPLACE A WELL THAT WILL BE USED AS A STANDBY  
 THIS WELL WILL DEEPEM AN EXISTING WELL  
 PERMIT NUMBER OF WELL TO BE REPLACED OR DEEPEMED (IF AVAILABLE) \_\_\_\_\_

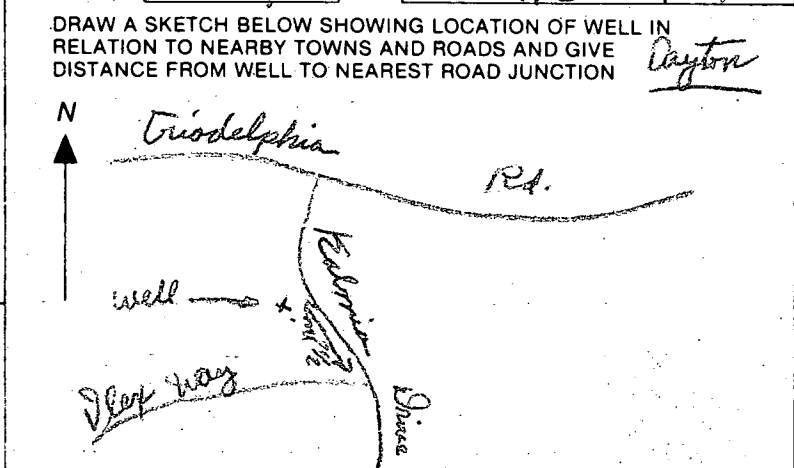

Not to be filled in by driller (OEP USE ONLY)  
 APPROP. PERMIT NUMBER \_\_\_\_\_ GAP \_\_\_\_\_  
 FORCE **JN** WRITE INITIALS IN BOX PERMIT No. **H0-88-0390**

SPECIAL CONDITIONS \_\_\_\_\_  
 COUNTY \_\_\_\_\_

C1 6779

SEQUENCE NO. (DENV. USE ONLY)

STATE OF MARYLAND WELL COMPLETION REPORT

THIS REPORT MUST BE SUBMITTED WITHIN 45 DAYS AFTER WELL IS COMPLETED.

(THIS NUMBER IS TO BE PUNCHED IN COLUMNS 3-6 ON ALL CARDS)

COUNTY NUMBER A 41692

DATE RECEIVED

DATE WELL COMPLETED 012789

DEPTH OF WELL 205 (TO NEAREST FOOT)

PERMIT NO. FROM "PERMIT TO DRILL WELL" 40-88-0390

OWNER M MAHON JOHN

STREET OR RFD KALMIA DRIVE TOWN DAYTON

SUBDIVISION KALMIA FARMS SECTION LOT 33

WELL LOG Not required for driven wells STATE THE KIND OF FORMATIONS PENETRATED, THEIR COLOR, DEPTH, THICKNESS AND IF WATER BEARING

Table with columns: DESCRIPTION (Use additional sheets if needed), FEET (FROM, TO), Check if water bearing. Includes entries for Sandstone and Gray mica rock.

GROUTING RECORD WELL HAS BEEN GROUTED (Y) (N) TYPE OF GROUTING MATERIAL CEMENT (CM) BENTONITE CLAY (BC) NO. OF BAGS 10 NO. OF POUNDS 940

CASING RECORD casing types insert appropriate code below MAIN CASING TYPE (S) Nominal diameter (6) Total depth (25)

OTHER CASING (if used) diameter inch depth (feet) from to

SCREEN RECORD screen type or open hole insert appropriate code below (H) (O) (S) (B) (P) (L) (T)

Table for screen depth: DEPTH (nearest ft.) with columns for each foot from 8 to 51.

CIRCLE APPROPRIATE LETTER A WELL WAS ABANDONED AND SEALED WHEN THIS WELL WAS COMPLETED E ELECTRIC LOG OBTAINED P TEST WELL CONVERTED TO PRODUCTION WELL

I HEREBY CERTIFY THAT THIS WELL HAS BEEN CONSTRUCTED IN ACCORDANCE WITH COMAR 10.17.13 "WELL CONSTRUCTION" AND IN CONFORMANCE WITH ALL CONDITIONS STATED IN THE ABOVE CAPTIONED PERMIT...

DRILLERS IDENT. NO. 938

DRILLERS SIGNATURE (MUST MATCH SIGNATURE ON APPLICATION)

SITE SUPERVISOR (sign. of driller or journeyman responsible for sitework if different from permittee)

SLOT SIZE 1 2 3 DIAMETER OF SCREEN (NEAREST INCH)

GRAVEL PACK from to IF WELL DRILLED WAS FLOWING WELL INSERT F IN BOX 68

OEP USE ONLY (NOT TO BE FILLED IN BY DRILLER) T (E.R.O.S.) WQ 70 72 74 75 76 TELESCOPE CASING LOG INDICATOR OTHER DATA

PUMPING TEST HOURS PUMPED (nearest hour) 3 PUMPING RATE (gal. per min. to nearest gal.) 9.5 METHOD USED TO MEASURE PUMPING RATE Bucket WATER LEVEL (distance from land surface) BEFORE PUMPING 23 WHEN PUMPING 98 TYPE OF PUMP USED (for test) (A) air (P) piston (T) turbine (C) centrifugal (R) rotary (O) other (describe below) (J) jet (S) submersible

PUMP INSTALLED DRILLER WILL INSTALL PUMP (YES/NO) IF DRILLER INSTALLS PUMP, THIS SECTION MUST BE COMPLETED FOR ALL WELLS EXCEPT HOME USE TYPE OF PUMP INSTALLED PLACE (A,C,J,P,R,S,T,O) IN BOX - SEE ABOVE: CAPACITY: GALLONS PER MINUTE (to nearest gallon) PUMP HORSE POWER PUMP COLUMN LENGTH (nearest ft.) CASING HEIGHT (circle appropriate box and enter casing height) (+) above ( ) below LAND SURFACE ( ) (nearest foot)

LOCATION OF WELL ON LOT SHOW PERMANENT STRUCTURE SUCH AS BUILDING, SEPTIC TANKS, AND/OR LANDMARKS AND INDICATE NOT LESS THAN TWO DISTANCES (MEASUREMENTS TO WELL)

