

Tap ID - 05 - 366240

# PERMIT

SEWAGE DISPOSAL SYSTEM

MARYLAND STATE DEPARTMENT OF HEALTH

P 39737

A REPAIR

DISTRICT \_\_\_\_\_

DATE 7/28/87

DATE SYSTEM APPROVED 6-15-87

INSPECTOR S. Hall

**HOWARD COUNTY**  
BUREAU OF ENVIRONMENTAL HEALTH  
461-9933

INDEXED

Jack Fyock IS PERMITTED TO INSTALL \_\_\_\_\_ ALTER

ADDRESS \_\_\_\_\_ PHONE 988-9270

SUBDIVISION \_\_\_\_\_ ROAD 6025 Jerry's Drive LOT 12

PROPERTY OWNER Mr. Sealock  
6025 Jerry's Drive

ADDRESS \_\_\_\_\_

IF GARBAGE GRINDER IS USED INCREASE SEPTIC TANK CAPACITY BY 50% AND ABSORPTION AREA BY 22%.

GARBAGE GRINDER? YES \_\_\_\_\_ NO \_\_\_\_\_

SEPTIC TANK CAPACITY \_\_\_\_\_ GALLONS NUMBER OF BEDROOMS \_\_\_\_\_

REPAIR - CALL FOR INSPECTION WHEN GROUNDS IS OPENED UP SANITARIAN CAN RECOMMEND REPAIR.

PLANS APPROVED BY C. Williams DATE 6/11/87

COVER NO WORK UNTIL INSPECTED AND APPROVED.

NEITHER THE HOWARD COUNTY COUNCIL NOR THE HEALTH DEPARTMENT IS RESPONSIBLE FOR THE SUCCESSFUL OPERATION OF ANY SYSTEM.

NOTE: CLEANOUT REQUIRED EVERY 70 FEET OF SEWER LINE AND/OR AT 90° SWEEPS IN LINES FROM HOUSE TO DRAIN FIELDS.

NOTE: ALL PARTS OF SEPTIC SYSTEMS (I.E., TANK, DISTRIBUTION BOX, TRENCHES) TO BE 100 FEET FROM WELL. (UNLESS OTHERWISE SPECIFICALLY AUTHORIZED)

NOTE: IF DEEP TRENCHES ARE USED CALL FOR INSPECTION BEFORE AND AFTER PLACING GRAVEL IN TRENCHES.

NOTE: NO DRY WELL SHALL EXCEED 15 FOOT IN DIAMETER. NO ABSORPTION TRENCH TO EXCEED 100 FEET IN LENGTH.

NOTE: ALL PIPE FROM HOUSE TO SEPTIC TANK MUST BE CAST IRON OR SCHEDULE 40 PVC OR ABS.

PERMIT VOID AFTER TWO YEARS.

NOTE: INSTALL STAND PIPE ON SEPTIC TANK AND DRY WELL. STAND PIPES MUST BE 6 INCHES IN DIAMETER. CAST IRON, CONCRETE OR TERRA COTTA OR PVC OR ABS ACCEPTED. IF TOP OF SEPTIC TANK IS DEEPER THAN 3 FEET, MANHOLE TO GRADE REQUIRED.

NOTE: DISTRIBUTION BOXES MUST HAVE BAFFLES.

**\*INSTALLER IS RESPONSIBLE FOR OBTAINING FINAL APROVAL ON THIS PERMIT**

\*CALL 461-9933 FOR INSPECTION OF SEPTIC SYSTEMS.

EH - 2-1186

P 39737

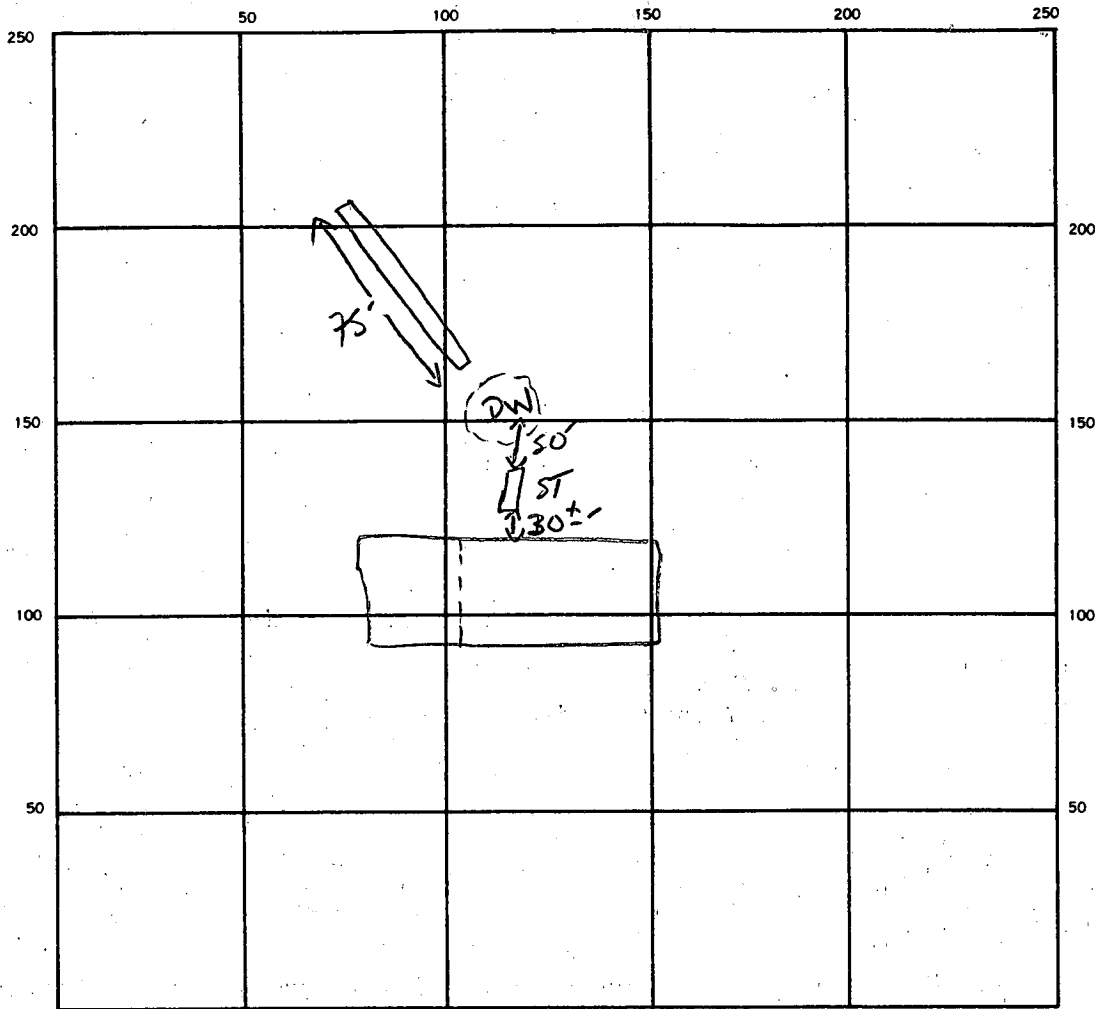

INDICATE NORTH. — NAME ADJOINING ROADWAY AS BASE LINE.

SEPTIC TANK. LEVEL EXISTING CLEANOUTS EXISTING

DISTRIBUTION BOX. LEVEL N/A

DRAIN FIELD TILE FIELD. DEPTH 11 FT. TRENCH WIDTH 2 FT. INLET DEPTH 3 FT.

EFFECTIVE GRAVEL DEPTH 8' FT. TOTAL LENGTH 75 FT.

NUMBER OF TRENCHES 1 ONE SIDEWALL/BOTTOM AREA 600 SQ. FT.

DRYWELL INSIDE DIAMETER EXISTING FT. EFFECTIVE DEPTH BELOW INLET — FT.

ABSORBENT AREA 600 SQ. FT.

REMARKS \_\_\_\_\_

\_\_\_\_\_  
 \_\_\_\_\_  
 \_\_\_\_\_  
 \_\_\_\_\_

DATE SYSTEM APPROVED 6-15-87 INSPECTOR S. AM

6/29/66  
6/24/66  
after

6/24/66 - Not ready - JHK  
6-29-66. ok. J. J. 7.20

# PERMIT

SEWAGE DISPOSAL SYSTEM

MARYLAND STATE DEPARTMENT OF HEALTH

HOWARD COUNTY

INDEXED

P 11936

A 10157

ELLICOTT CITY  
DISTRICT 5

DATE 6/22/66

Pasadena Builders SPALOCK IS PERMITTED TO INSTALL  ALTER

ADDRESS 4 Ritchie Highway, Pasadena, Md. PHONE 647-6974

A SEWAGE DISPOSAL SYSTEM LOCATED AT

SUBDIVISION Bassler Bassler ROAD Jerrys' Drive LOT 12, Blk. B

PROPERTY OWNER Frances Zainer

ADDRESS

SPECIFICATIONS - 3 bedrooms

DRAIN FIELD \_\_\_\_\_ DEPTH \_\_\_\_\_ FEET, BOTTOM AREA \_\_\_\_\_ SQ. FT.

SEEPAGE PITS \_\_\_\_\_ ABSORBENT SIDE-WALL AREA \_\_\_\_\_ SQ. FT.

SEPTIC TANK CAPACITY 750 GALLONS

FOR GARBAGE GRINDER, INCREASE DISPOSAL AREA 22% & TANK CAPACITY 50%.

OTHER Dry well - 300 sq. ft. sidewall area below the inlet with the

inlet no deeper than 2 ft. below grade.

Place the dry well 225 ft. to 245 ft. from the front lot line and 75 ft.

to 95 ft. from the left side of the lot as seen when facing the lot from

Jerrys Drive.

PLANS APPROVED BY Raymond Hodges DATE 7/21/65

FILL SEPTIC TANK AND DISTRIBUTION BOX WITH WATER BEFORE CALLING FOR AN INSPECTION. COVER NO WORK UNTIL INSPECTED AND APPROVED.

NEITHER THE HOWARD COUNTY COMMISSIONERS NOR THE HEALTH DEPARTMENT IS RESPONSIBLE FOR THE SUCCESSFUL OPERATION OF ANY SYSTEM.

A 10157

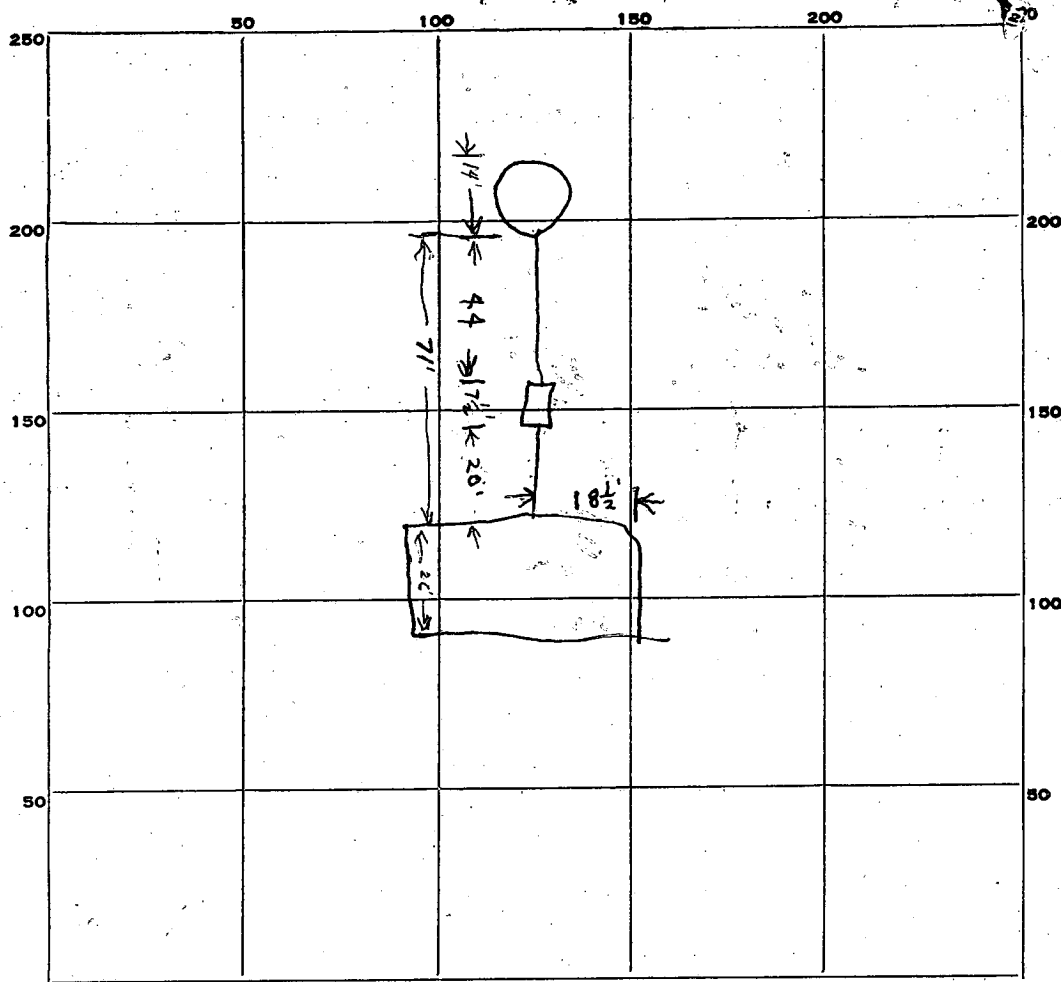

INDICATE NORTH. - NAME ADJOINING ROADWAY AS BASE LINE.

JERRY'S DR.

PERMIT CARD

SEPTIC TANK, LEVEL

CLEANOUTS

*tank just below surface*

DISTRIBUTION BOX, LEVEL \_\_\_\_\_

TILE FIELD, DEPTH \_\_\_\_\_ FT. TRENCH WIDTH \_\_\_\_\_ FT.

GRAVEL DEPTH \_\_\_\_\_ IN. TOTAL LENGTH \_\_\_\_\_ FT.

NUMBER OF TRENCHES \_\_\_\_\_ TOTAL BOTTOM AREA \_\_\_\_\_

SEEPAGE PITS, INSIDE DIAMETER 14 FT. DEPTH BELOW INLET 7 FT.

ABSORBENT AREA 307 SQ. FT.

REMARKS

*6/24/66 - not ready - JHK  
will call*

DATE SYSTEM APPROVED

*6-29-66.*

INSPECTOR

*F. Frommelt*

# APPLICATION

A 10157

SEWAGE DISPOSAL TESTING

P \_\_\_\_\_

MARYLAND STATE DEPARTMENT OF HEALTH

HOWARD COUNTY 750 Gallon Tank

ELLICOTT CITY

Dry Well - 300 sqft sidewall

DISTRICT 5

area below the inlet with the inlet  
no deeper than 2 ft below grade

DATE 5/10/65

Place the dry well 225 ft to 245 ft from  
the front lot line and 75 ft to 95 ft  
from the left side of the lot as seen

TO: THE COUNTY HEALTH OFFICER  
ELLICOTT CITY, MARYLAND

when facing the lot from Jerry's Drive

I, HEREBY, APPLY FOR THE NECESSARY TESTS IN ORDER TO CONSTRUCT (OR RECONSTRUCT) A SEWAGE DISPOSAL SYSTEM.

PROPERTY OWNER Frances Zalner

ADDRESS 1427 Kirkwood Rd.

PHONE \_\_\_\_\_

PROPERTY LOCATION:

SUBDIVISION Bassler Subdivision

LOT NO. 12 Blk. B

ROAD AND DESCRIPTION Jerry's Drive off Owen Brown Rd.

OCCUPANT \_\_\_\_\_

PHONE \_\_\_\_\_

PERSON TO CONSTRUCT SYSTEM \_\_\_\_\_

ADDRESS \_\_\_\_\_

PHONE \_\_\_\_\_

SIZE OF LOT 1.48 acres

TYPE BLDG. \_\_\_\_\_

3  
NUMBER OF BEDROOMS

IF NOT SINGLE RESIDENCE DESCRIBE \_\_\_\_\_

SIGNATURE OF APPLICANT Frank A. Spivek

APPROVED BY Raymond Hodge

FOR \_\_\_\_\_

(KIND OF SYSTEM)

DATE 21 July 65

REJECTED BY \_\_\_\_\_

FOR \_\_\_\_\_

(KIND OF SYSTEM)

DATE \_\_\_\_\_

HOLD PENDING FURTHER TESTS \_\_\_\_\_

DATE \_\_\_\_\_

REASONS FOR REJECTION OR HOLDING \_\_\_\_\_

# THIS IS NOT A PERMIT

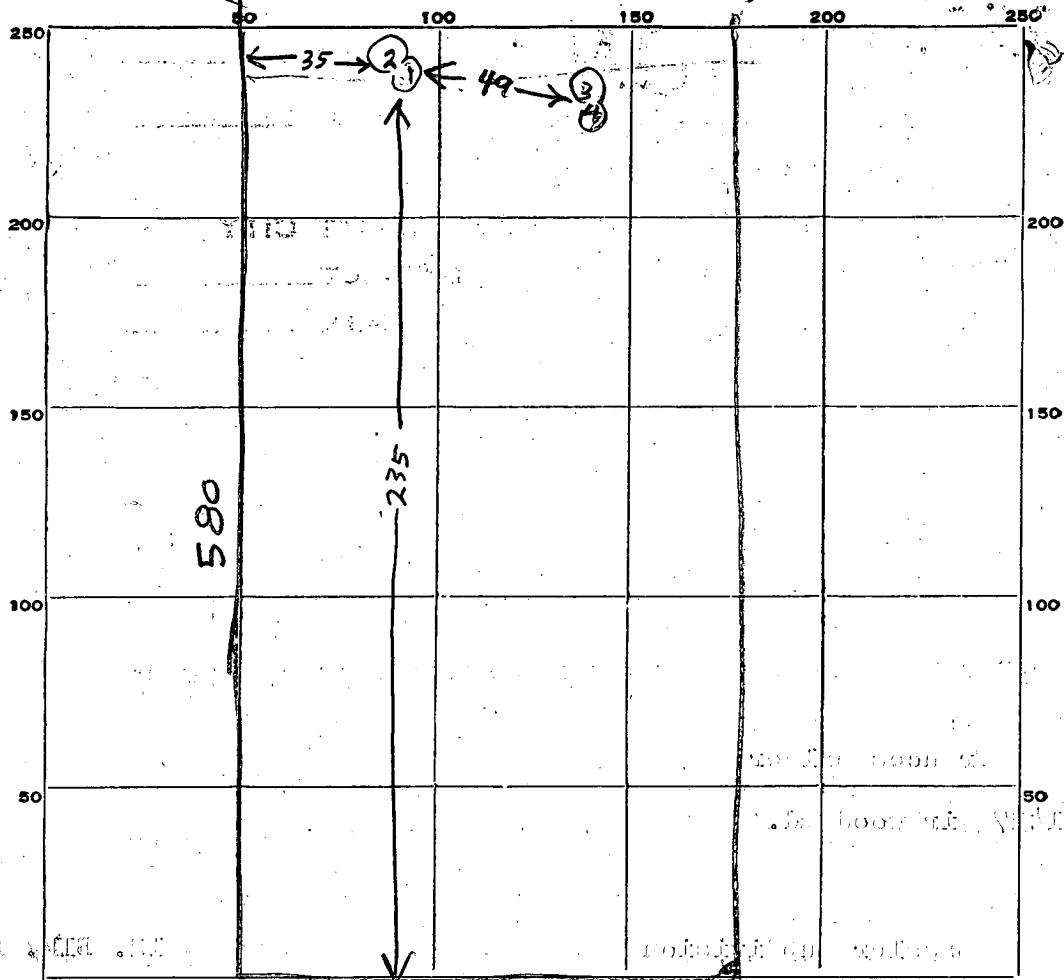

B) 1/2  
7/20

INDICATE NORTH. NAME ADJOINING ROADWAY AS BASE LINE. JERRY'S DRIVE TO OWEN BROWN RD

DATE	TEST NO.	DEPTH	PRE-WET		TEST - 1" DROP		TIME
			START	STOP	START	STOP	
2/11/65	1	8 1/2	113	117	117	132	15
7/4/65	2	5	117	126	126	151	25
11/11	3	8 1/2	122	124	124	130	6
11/11	4	4 1/2	125	126	126	129	3

SOIL AUGER FINDING

TESTED BY Raymond Dodge

REMARKS Hook to set 125 to 150 ft from front lot line



DEPARTMENT OF  
WATER RESOURCES

APPLICATION MUST BE SUBMITTED AND PERMIT RECEIVED BEFORE DRILLING IS STARTED.

State Office Building  
ANNAPOLIS, MARYLAND 21401

A 10157 208

APPLICATION FOR PERMIT TO DRILL WELL

40, 659

Owner Mr. Dave Shoemaker

G. Edgar Harrison's Corp  
Driller Number 208

Street or R. F. D. 4 Ritchie Highway

Street or R. F. D.  
Post Office Falls Road, Lockeyville, Md.

Post Office Pasadena, Maryland

Date May 20, 1966

Quantity of Water to be Produced 5 G.P.M.

Location of Well  
Subdivision Bassler Subdivision

Total Quantity Needed For Use 500 G.P.D.

Section \_\_\_\_\_ Lot 12

Use for Water Domestic

County Howard

Approximate Depth of Well (feet) 150

Nearest Town Ellicott City

Method of Drilling to be used Cable Tool or Rotary

Distance from Town 3 Miles

Direction from Town S. W.

Is this a Replacement Well? XXX - No

Description of Location of Well

(This information should be definite enough to permit locating well on a county map).

If YES, indicate date abandoned well is to be sealed: \_\_\_\_\_

Near what road Jenny's Road

and by whom: \_\_\_\_\_

On which side of road East

(North, East, South, West)

PERMIT TO DRILL WELL  
(Not To Be Filled In By Driller)

Distance from road 85 ft.

Draw a sketch below showing location of well in relation to nearby towns, roads and streams with north in the direction of the arrow, and give distance from well to nearest road junction or stream crossing shown on the sketch.

Well Permit No. HO-66-W-331

Samples of Cuttings Required by Department:  Yes  No  
Owner Requires Permit to Appropriate Water:  Yes  No  
Owner Has Permit to Appropriate Water:  Yes  No

Appropriation Permit No. \_\_\_\_\_

The applicant is herewith granted a permit to drill this well subject to the conditions stipulated:

Baul W. McKee Director 5-25-66 Date

**THIS PERMIT IS NOT TRANSFERABLE**  
WITHOUT WRITTEN PERMISSION FROM THE DEPARTMENT  
Special conditions that must be observed: \_\_\_\_\_

Health Department Approval of Application

Howard County Department of Health

or  State Department of Health

Approved by Palmer F. Wine

Title Director

Date 5/24/66

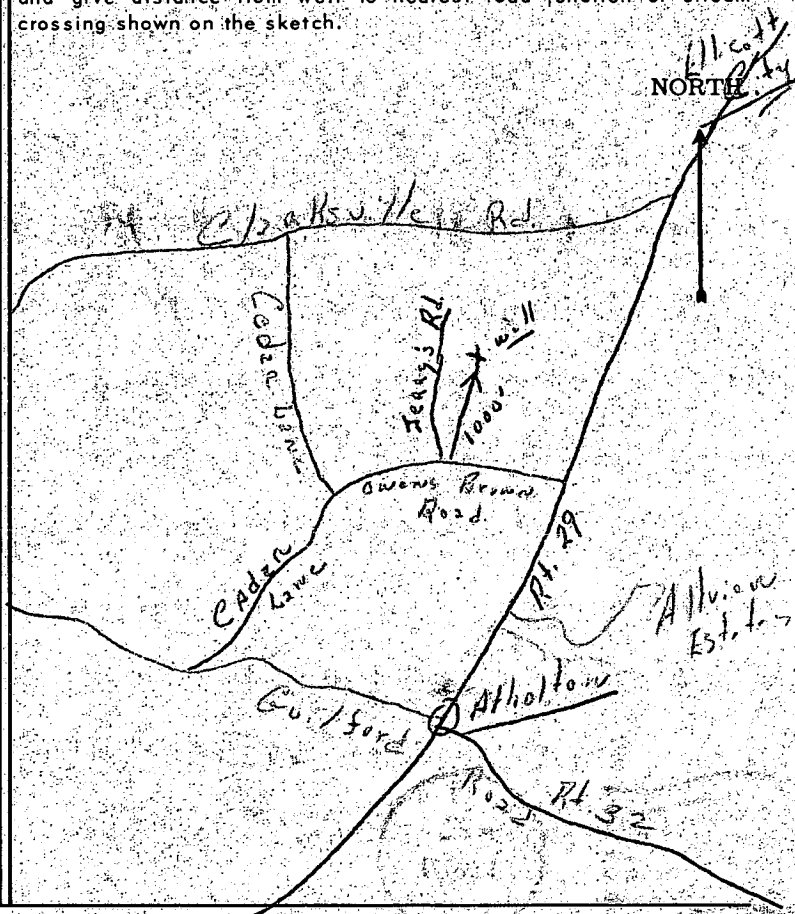

THIS REPORT  
MUST BE SUBMITTED  
WITHIN 30 DAYS  
AFTER COMPLETION  
OF THE WELL

WELL COMPLETION REPORT

WELL DESCRIPTION

WELL LOG

State the kind of formations penetrated, their color, their depth, their thickness, and if water-bearing

Sand & Clay  
Sandrock  
Dark Gray Rock

FEET  
from to  
0-40'  
40-95'  
95-125'

CASING AND SCREEN RECORD

State the kind and size and position of casing, liner, shoe, screen, and other accessories (if no casing used, give diameter of well).

Black Steel

DIAM. (inches) FEET  
6 1/4" from to  
43'6"

Permit Number HO-66-W-331  
Owner Dave Shoemaker  
Address Paradene, Md.  
Subdivision Bassler Sub.  
Section \_\_\_\_\_ Lot 12

PUMPING TEST

Hours Pumped 4  
Type of Pump Used Boiler  
Pumping Rate \_\_\_\_\_  
Gallons per Minute 6

WATER LEVEL

Distance from land surface to water:  
Before Pumping 17 Ft.  
When Pumping 68 Ft.

APPEARANCE OF WATER

Clear yes Cloudy no  
Taste ok  
Odor none

Height of Casing Above Land Surface 1 Ft.

PUMP INSTALLED

Type \_\_\_\_\_  
Capacity \_\_\_\_\_  
Gallons per Minute \_\_\_\_\_  
Gallons per Hour \_\_\_\_\_  
Pump Column Length \_\_\_\_\_ Ft.

LOCATION OF WELL ON LOT

Show permanent structures such as building(s), septic tank, and/or other landmarks and indicate not less than 2 distances (measurements) to well.

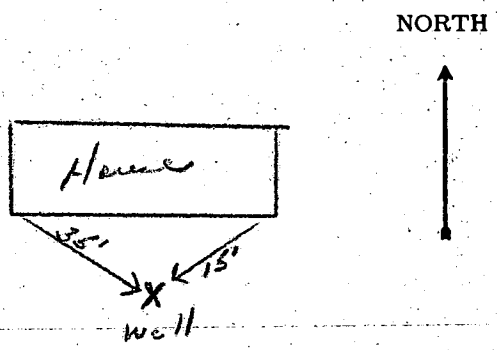

Date Well \_\_\_\_\_  
Was Completed 7-1-66

Well Driller Robert Brown  
Signature G. Edgar Harr Sons' Corp.

REGION ON A 03432

AREA \_\_\_\_\_ RATING \_\_\_\_\_

ACKNOWLEDGMENT AND CONTROLS	DATE

Howard County Department of Health  
 BUREAU OF ENVIRONMENTAL HEALTH  
 RECORD OF INVESTIGATION

DISPOSITION	DATE

SEALOCK (LOT 12)

LOCATION NOAH SEALOCK ZIP \_\_\_\_\_

OWNER  OCCUPANT  ADDRESS 6025 JERRY'S DR PHONE \_\_\_\_\_

COMPLAINANT NEED NEW WELL ADDRESS COLUMBIA MD PHONE 9978728

REASON FOR INVESTIGATION WELL ABOUT DRY (>15 years)  
JOE MAYNE DRILLER

RECEIVED BY \_\_\_\_\_ DATE \_\_\_\_\_ ASSIGNED TO \_\_\_\_\_ DATE \_\_\_\_\_

DATE OF INVESTIGATION \_\_\_\_\_ TIME \_\_\_\_\_ WEATHER \_\_\_\_\_

REPORT WILL PLACE STAKES SHOWING S.T., EXISTING PIT  
& NEW PROPOSED SITE WELL

Sepic area

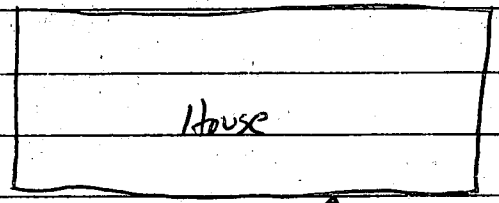

Jerry's Dr.

DATE SUBMITTED \_\_\_\_\_ SANITARIAN \_\_\_\_\_



B 1 5034

SEQUENCE NO. (OEP USE ONLY)

STATE OF MARYLAND PERMIT TO DRILL WELL

OEP PERMIT NUMBER

40-81-1759

fill in this form completely

please print or type

Date Received

8 13

OWNER INFORMATION

15 Last Name 34 Owner First Name

36 Street or RFD 55

57 Town 70 State 72 Zip 76

DRILLER INFORMATION

Driller's Name 77 License No. 80

Firm Name

Address

Signature Date

B 3

LOCATION OF WELL

8 COUNTY 21

23 SUBDIVISION 42

SECTION 44 46 LOT 48 50

52 NEAREST TOWN 71

MILES FROM TOWN (enter 0 if in town) 73 76 77 78

B 4

DIRECTION OF WELL FROM TOWN (CIRCLE BOX)

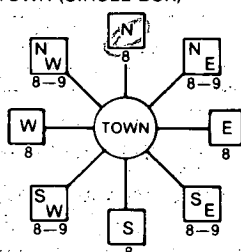

11 NEAR WHAT ROAD 30

ON WHICH SIDE OF ROAD (CIRCLE APPROPRIATE BOX)



34 DISTANCE FROM ROAD 37 ENTER FT or MI 38 39

B 2

WELL INFORMATION

APPROX. PUMPING RATE (GAL. PER MIN.) 8 12

AVERAGE DAILY QUANTITY NEEDED (GAL. PER DAY) 14 20

USE FOR WATER (CIRCLE APPROPRIATE BOX)

- HOME (SINGLE OR DOUBLE HOUSEHOLD UNIT ONLY)
FARMING (LIVESTOCK WATERING & AGRICULTURAL IRRIGATION)
INDUSTRIAL, COMMERCIAL, STATE AND FEDERAL GOV. OTHER (REQUIRES APPROPRIATION PERMIT)
PUBLIC OR PRIVATE WATER COMPANY (REQUIRES APPROPRIATION PERMIT AND STATE HEALTH DEPARTMENT APPROVAL)
TEST, OBSERVATION, MONITORING (MAY REQUIRE APPROPRIATION PERMIT)

NOT TO BE FILLED IN BY DRILLER HEALTH DEPARTMENT APPROVAL

COUNTY NAME SIGNATURE DATE ISSUED

CO-SIGNATURE EXP. DATE

NORTH GRID EAST GRID

APPROXIMATE DEPTH OF WELL FEET

APPROXIMATE DIAMETER OF WELL INCH

METHOD OF DRILLING (circle one)

- BORED (or Augered) JETTED Jetted & DRIVEN
AIR-ROTARY AIR-PERCussion ROTARY (Hydraulic Rotary)
CABLE REVERSE-ROTARY DRIVE-POINT
other

REPLACEMENT OR DEEPEMED WELLS (CIRCLE APPROPRIATE BOX)

- THIS WELL WILL NOT REPLACE AN EXISTING WELL
THIS WELL WILL REPLACE A WELL THAT WILL BE ABANDONED AND SEALED
THIS WELL WILL REPLACE A WELL THAT WILL BE USED AS A STANDBY
THIS WELL WILL DEEPEM AN EXISTING WELL
PERMIT NUMBER OF WELL TO BE REPLACED OR DEEPEMED (IF AVAILABLE)

Not to be filled in by driller (OEP USE ONLY)

APPROP. PERMIT NUMBER

FORCE PERMIT No.

SPECIAL CONDITIONS

SHOW MAJOR FEATURES OF BOX & LOCATE WELL WITH AN X

SOURCES OF DRILLING WATER

- 1.
2.
3.

WRITE THE BOX NUMBER FROM THE MAP HERE



DRAW A SKETCH BELOW SHOWING LOCATION OF WELL IN RELATION TO NEARBY TOWNS AND ROADS AND GIVE DISTANCE FROM WELL TO NEAREST ROAD JUNCTION

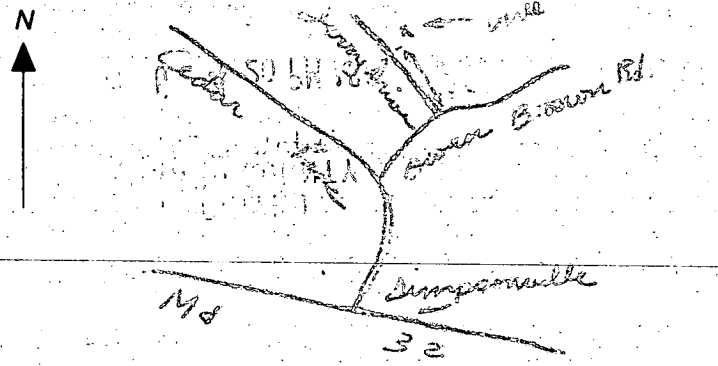

will mail copy of completion report. Completion Date 12-2-86 confirmed