

1/16/87 AS LATE AS POSSIBLE
ASAP
Lost

05-346851

Approved
1/16/87
RH

PERMIT

P 38679

SEWAGE DISPOSAL SYSTEM

A REPAIR

MARYLAND STATE DEPARTMENT OF HEALTH

HOWARD COUNTY
BUREAU OF ENVIRONMENTAL HEALTH
992-2330

ELLICOTT CITY

DISTRICT _____

INDEXED

DATE 1/10/87

Jack Fyock IS PERMITTED TO INSTALL _____ ALTER X

ADDRESS _____ PHONE 988-9270

SUBDIVISION _____ ROAD 11505
11515-John Hopkins Rd LOT _____

PROPERTY OWNER Niel B. Jefferson

ADDRESS 11515 Johns Hopkins Road
11505

IF GARBAGE GRINDER IS USED INCREASE SEPTIC TANK CAPACITY BY 50% AND ABSORPTION AREA BY 22%.

GARBAGE GRINDER? YES _____ NO ✓

SEPTIC TANK CAPACITY _____ GALLONS NUMBER OF BEDROOMS 3

REPAIR - CALL FOR INSPECTION WHEN GROUND IS OPENED UP SO SANITARIAN CAN RECOMMEND REPAIR.

375 SOFT ONE SIDE WALL AREA
12 FT DEEP OFF STONE 47 FT LONG
INLET 4 FT BELOW GRADE
PLACE TRENCH IN FRONT YARD OFF
OLD DRY WELL 1/6/86 RH

PLANS APPROVED BY C. Williams DATE 1/06/87

COVER NO WORK UNTIL INSPECTED AND APPROVED.

NEITHER THE HOWARD COUNTY COUNCIL NOR THE HEALTH DEPARTMENT IS RESPONSIBLE FOR THE SUCCESSFUL OPERATION OF ANY SYSTEM.

NOTE: IF TRENCH IS USED CALL FOR INSPECTION BEFORE AND AFTER PLACING GRAVEL IN TRENCH.

NOTE: NO DRY WELL SHALL EXCEED 15 FOOT IN DIAMETER. NO ABSORPTION TRENCH TO EXCEED 100 FEET IN LENGTH.

NOTE: ALL PIPE FROM HOUSE TO SEPTIC TANK MUST BE CAST IRON OR SCHEDULE 40 PVC OR ABS.

PERMIT VOID AFTER THREE YEARS.

NOTE: INSTALL STAND PIPE ON SEPTIC TANK AND DRY WELL. STAND PIPES MUST BE 6 INCHES IN DIAMETER. CAST IRON, CONCRETE OR TERRA COTTA. OR PVC OR ABS ACCEPTED. IF TOP OF SEPTIC TANK IS DEEPER THAN 3 FEET MANHOLE TO GRADE REQUIRED.

***INSTALLER IS RESPONSIBLE FOR OBTAINING FINAL APROVAL ON THIS PERMIT**

*CALL 992-2330 FOR INSPECTION OF SEPTIC SYSTEMS.

EH - 2-1082

P
38679

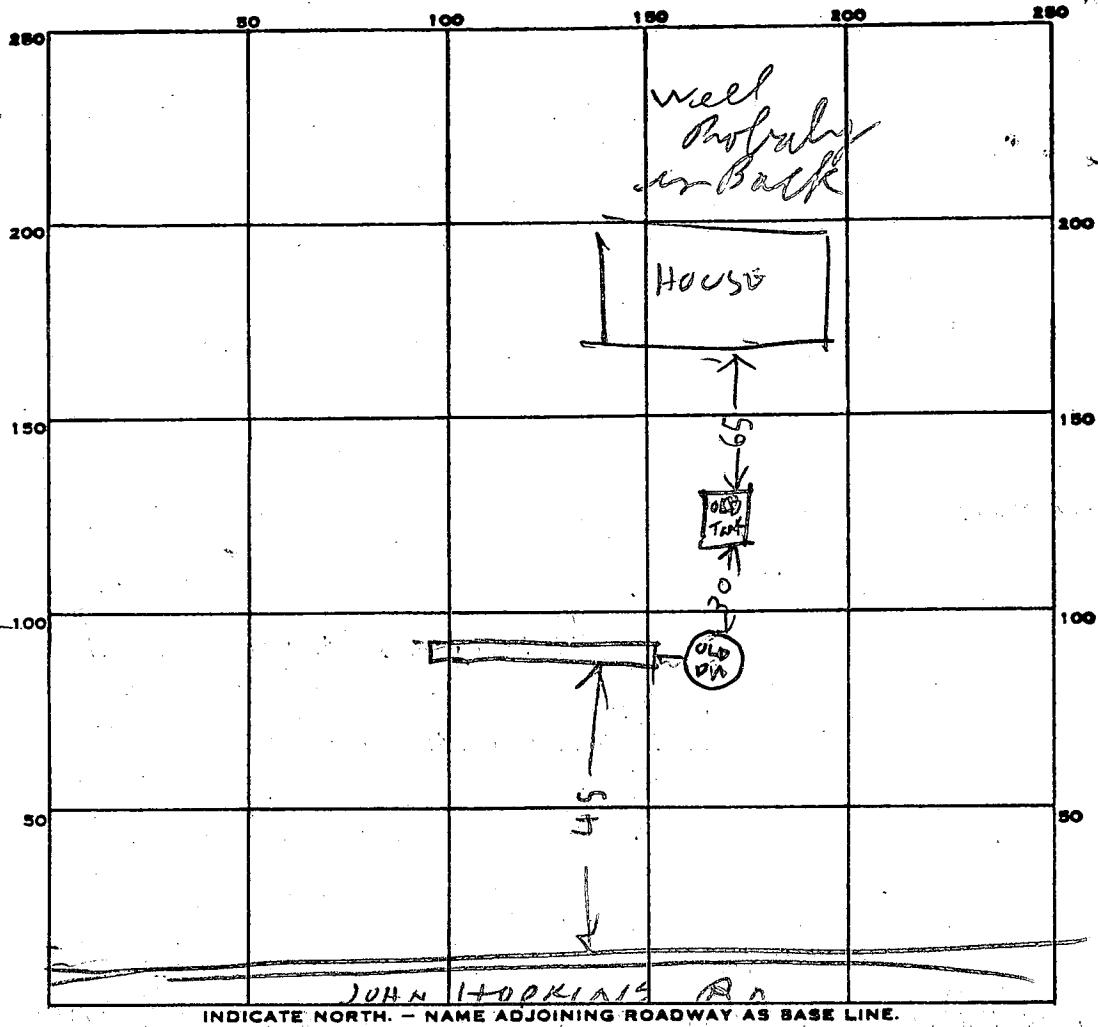

PERMIT CARD _____

SEPTIC TANK, LEVEL _____

CLEANOUTS _____

DISTRIBUTION BOX, LEVEL _____

TILE FIELD, DEPTH 12 FT. TRENCH WIDTH 2 FT.

GRAVEL DEPTH 8 FT IN. TOTAL LENGTH 53 FT.

NUMBER OF TRENCHES 1 TOTAL BOTTOM AREA _____

SEEPAGE PITS, INSIDE DIAMETER _____ FT. DEPTH BELOW INLET _____ FT.

ABSORBENT AREA _____ SQ. FT.

REMARKS 1/6/86 DRY WELL INLET 4 FT BELOW GROUND

1/6/86 HALF OF STONE IN DRY WELL

BEST TO BE ADDED

DATE SYSTEM APPROVED 1/6/87

INSPECTOR Raymond Rodgers