

\*\*\*\*\*  
 WATER WELL ABANDONMENT-SEALING REPORT FORM  
 \*\*\*\*\*

SUBMIT COPIES OF COMPLETED FORM TO:

- \* COUNTY ENVIRONMENTAL AGENCY (contact MDE, WMA if address needed)
- \* WELL OWNER
- \* MDE, WATER MANAGEMENT ADMINISTRATION, WELL PROGRAM

OK  
~~6/13/2023~~  
 6/13/2023 (RR)

DATE WELL ABANDONED: June 7 2023 (month/day/year)

\* PERMIT-NUMBER OF ABANDONED WELL (if any) \_\_\_\_\_

\* PERMIT NUMBER OF REPLACEMENT WELL: \_\_\_\_\_

\* PERSON ABANDONING WELL: Michael Ison WELL DRILLER'S LICENSE NUMBER: 1162

CIRCLE MWD / MSD / MGD

\* OWNER'S NAME: ESC Keryer Pond LC

SITE LOCATION MAP

\* WELL LOCATION:  
 COUNTY: HOWARD  
 NEAREST TOWN: ELNICOTT CITY  
 TAX MAP 31 BLOCK 21 PARCEL 497  
 SUBDIVISION: \_\_\_\_\_  
 SECTION: \_\_\_\_\_ LOT: \_\_\_\_\_  
 STREET ADDRESS: 5263 Keryer Road

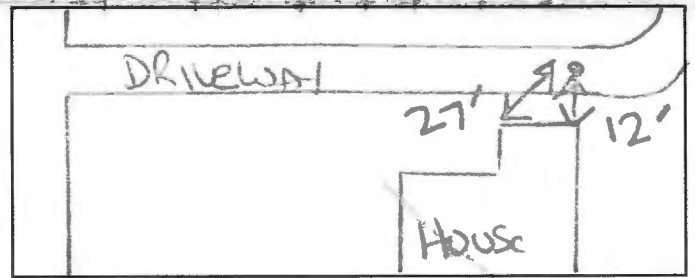

LATITUDE 39.225735

LONGITUDE 76.778981

LOG OF SEALING MATERIAL

MATERIAL	FEET	
	FROM	TO
Crushed stone	18	5
Cement	5	2

VOLUME OF MATERIAL USED

20 tons Stone 1500lbs cement

- \* TYPE OF WELL BEING ABANDONED:  
 DRILLED  JETTED  
 BORED  HAND DUG  
 OTHER (specify) \_\_\_\_\_

- \* USE CODE:  
 DOMESTIC  MUNICIPAL/PUBLIC  
 IRRIGATION  INDUSTRIAL  
 TEST/OBSERVATION  GEOTHERMAL

- \* TYPE OF CASING:  
 STEEL  PLASTIC  
 CONCRETE  OTHER (specify) \_\_\_\_\_

SIZE OF CASING: 36 INCHES IN DIAMETER

DEPTH OF WELL: 18 FEET DEEP

WAS ANY CASING REMOVED?  YES  NO  
 If yes, length removed, in feet: \_\_\_\_\_

WAS CASING RIPPED OR PERFORATED?  YES  NO

SIGNATURE-MASTER WELL DRILLER OR SUPERVISING SANITARIAN LICENSE# \_\_\_\_\_

1162

MWD / MSD / MGD  
 CIRCLE ONE

6/8/23  
 DATE

Pursuant to § 10-624 of the State Govt. Article of the Maryland Code, personal info requested on this form is used in processing this form pursuant to COMAR 26.04.04. Failure to provide the info may result in this form not being processed. You have the right to inspect, amend, or correct this form. The Maryland Department of the Environment is subject to the Maryland Public Information Act. This form may be made available on the Internet via MDE's website and is subject to inspection or copying, in whole or in part, by the public and other governmental agencies, if not protected by federal or State Law.