

5-28-63

PERMIT

P 06395

A 01343

SEWAGE DISPOSAL SYSTEM

MARYLAND STATE DEPARTMENT OF HEALTH

HOWARD COUNTY

ELLICOTT CITY

DISTRICT 5

DATE 3-11-63

INDEXED

INDEXED

Wm. Reed

IS PERMITTED TO INSTALL ALTER

ADDRESS _____ PHONE _____

A SEWAGE DISPOSAL SYSTEM LOCATED AT 11865 Line Kelp Rd. - across road from
Buddy's store - 2000 ft. from Rt 216 on left

SUBDIVISION _____ ROAD _____ LOT _____

PROPERTY OWNER William Reed

ADDRESS 420 Homan Ave - Laurel

SPECIFICATIONS

DRAIN FIELD DEPTH _____ FEET, BOTTOM AREA 154 SQ. FT. for each bed-room

SEEPAGE PITS _____ ABSORBENT SIDE-WALL AREA _____ SQ. FT.

SEPTIC TANK CAPACITY 750 GALLONS

FOR GARBAGE GRINDER, INCREASE DISPOSAL AREA 22% & TANK CAPACITY 50%.

OTHER * Not less than 300 sq ft bottom area in system

Place the tile field about 160 to 180 ft. from the side line of the lot, or the east of Rt 216 and 25 to 55 ft. from Line Kelp Rd.

PLANS APPROVED BY Raymond Hodges DATE 3-5-59

FILL SEPTIC TANK AND DISTRIBUTION BOX WITH WATER BEFORE CALLING FOR AN INSPECTION. COVER NO WORK UNTIL INSPECTED AND APPROVED.

NEITHER THE HOWARD COUNTY COMMISSIONERS NOR THE HEALTH DEPARTMENT IS RESPONSIBLE FOR THE SUCCESSFUL OPERATION OF ANY SYSTEM.

A 01343

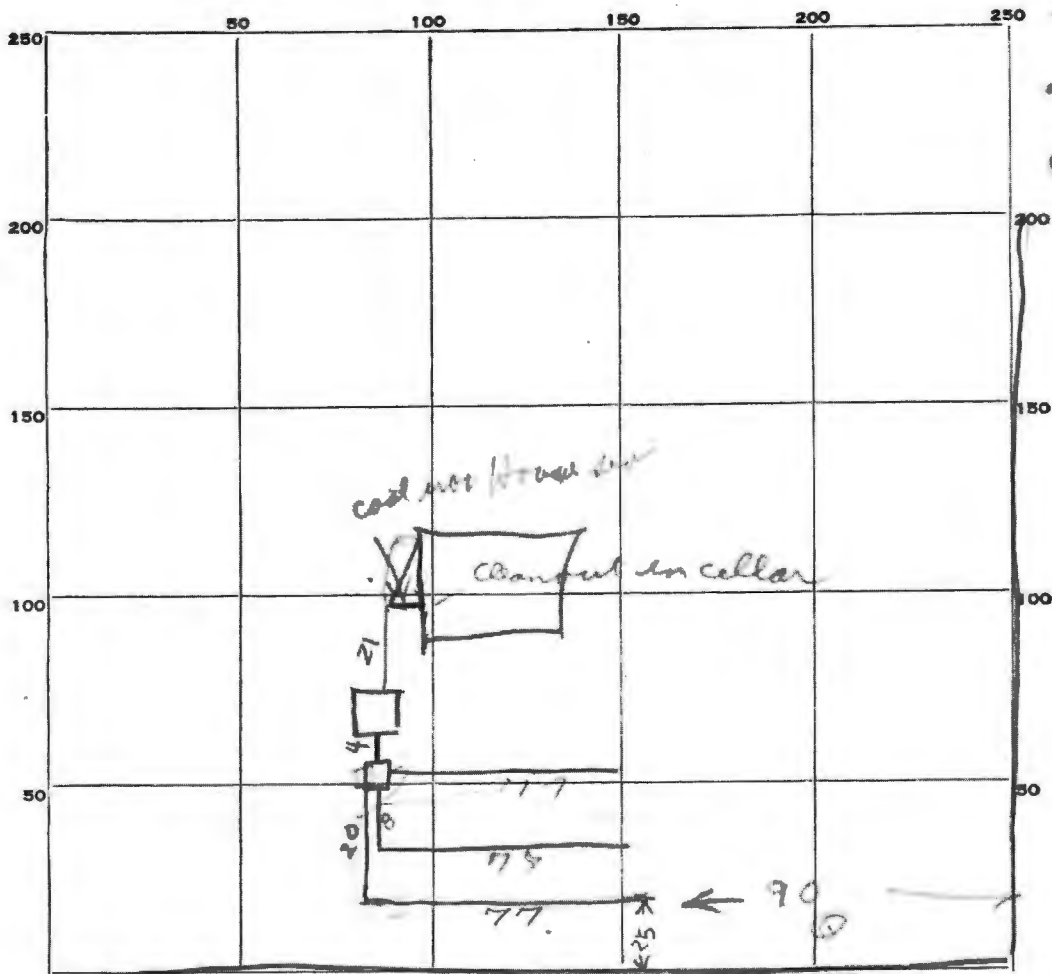

INDICATE NORTH. - NAME ADJOINING ROADWAY AS BASE LINE.

LIME KILN RD

PERMIT CARD Yes

SEPTIC TANK, LEVEL OK 750

No clearcut
No inlet tree

CLEANOUTS NO

DISTRIBUTION BOX, LEVEL OK

TILE FIELD, DEPTH 2-5 FT. TRENCH WIDTH 2 FT.

GRAVEL DEPTH 12 IN. TOTAL LENGTH 231 FT.

NUMBER OF TRENCHES 3 TOTAL BOTTOM AREA 462

SEEPAGE PITS, INSIDE DIAMETER _____ FT. DEPTH BELOW INLET _____ FT.

ABSORBENT AREA _____ SQ. FT.

REMARKS

28 May 63 3 bedrooms - 3 x 154 = 462 sq ft required
OK to cover tile field but septic tank must be re-inspected
for cleanout. Would tree (3) house sewer R/W

DATE SYSTEM APPROVED 13 June 63

INSPECTOR Raymond Hodge

9/23/87 11 AM
5/4/88
5/11/88

PERMIT

P 33832

A Repair

SEWAGE DISPOSAL SYSTEM

MARYLAND STATE DEPARTMENT OF HEALTH

HOWARD COUNTY
BUREAU OF ENVIRONMENTAL HEALTH
992-2330

ELLICOTT CITY
DISTRICT 5th

DATE 4/27/84

p1/2

Mr. William Reed IS PERMITTED TO INSTALL _____ ALTER X

ADDRESS 11865 Lime Kiln Road, Fulton, Md. 20759 PHONE 725-2375

SUBDIVISION _____ ROAD 11865 Lime Kiln Road LOT _____

PROPERTY OWNER Mr. William Reed

ADDRESS same as above (Access From MAUCKS MEAT MKT.)

IF GARBAGE GRINDER IS USED INCREASE SEPTIC TANK CAPACITY BY 50% AND ABSORPTION AREA BY 22%.

GARBAGE GRINDER? YES _____ NO _____

SEPTIC TANK CAPACITY _____ GALLONS NUMBER OF BEDROOMS _____

REPAIR - Call for an appointment when ground is opened up and Sanitarian will recommend the repair system.

5-4-88 Repair up hill Hoping to add capacity for future addition

MAINTAIN SHALLOW TRENCH w/18" OF STONE - INLET	WATER TABLE ON LOW SIDE PREVENTS ^{MAJOR} EXPANSION.
3-4" MAX w/18" STONE REPLACE DIST. BOX, CHECK	NO PROBLEM WITH EXISTING SYSTEM.
OUTLET BAFEL FOR FUNCTION PLACE DB CLOSE TO	EXPANSION LIMITED TO (BR ONLY)
Lime Kiln Rd. + RUN TRENCHES ON CONTOUR TOWARD LEFT OF LOT	ANY FURTHER EXPANSION WOULD REQUIRE
INSTALL ISOLE OF TRENCH w/ 9" CENT. TO CONT SEPARATION.	ADDITION TO SEPTIC AND TRENCH IS NOT ADEQUATE ROOM FOR REQ REPLACEMENT SYSTEMS

PLANS APPROVED BY S. Skinner DATE 4/27/84

COVER NO WORK UNTIL INSPECTED AND APPROVED.

NEITHER THE HOWARD COUNTY COUNCIL NOR THE HEALTH DEPARTMENT IS RESPONSIBLE FOR THE SUCCESSFUL OPERATION OF ANY SYSTEM.

NOTE: IF TRENCH IS USED CALL FOR INSPECTION BEFORE AND AFTER PLACING GRAVEL IN TRENCH.

NOTE: NO DRY WELL SHALL EXCEED 15 FOOT IN DIAMETER. NO ABSORPTION TRENCH TO EXCEED 100 FEET IN LENGTH.

NOTE: ALL PIPE FROM HOUSE TO SEPTIC TANK MUST BE CAST IRON OR SCHEDULE 40 PVC OR ABS.

PERMIT VOID AFTER THREE YEARS.

NOTE: INSTALL STAND PIPE ON SEPTIC TANK AND DRY WELL. STAND PIPES MUST BE 6 INCHES IN DIAMETER CAST IRON, CONCRETE OR TERRA COTTA. OR PVC OR ABS ACCEPTED IF TOP OF SEPTIC TANK IS DEEPER THAN 3 FEET MANHOLE TO GRADE REQUIRED

BLDG. PERMIT SIGNED AND RETURNED 12/14/87
 BLDG. PERMIT SIGNED AND RETURNED 10/5/83
Serial # 15361-dca
Serial # 14904
Garage Storage

A 33832

*INSTALLER IS RESPONSIBLE FOR OBTAINING FINAL APROVAL ON THIS PERMIT

*CALL 992-2330 FOR INSPECTION OF SEPTIC SYSTEMS.

P 33832
 REED
 11865 LIMEKILL RD

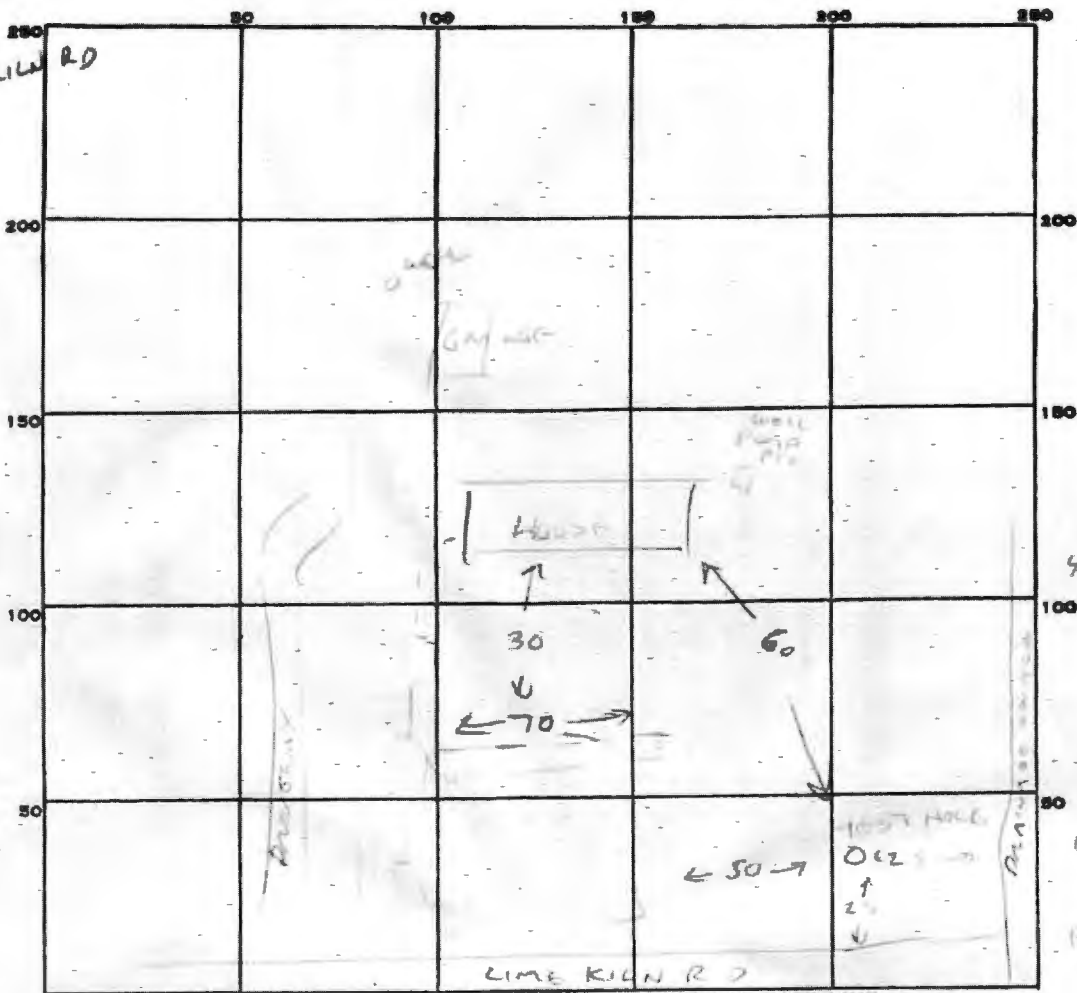

INDICATE NORTH. - NAME ADJOINING ROADWAY AS BASE LINE.

PERMIT CARD _____

SEPTIC TANK, LEVEL _____

CLEANOUTS _____

DISTRIBUTION BOX, LEVEL _____

TILE FIELD, DEPTH _____ FT. TRENCH WIDTH _____ FT.

GRAVEL DEPTH _____ IN. TOTAL LENGTH _____ FT.

NUMBER OF TRENCHES _____ TOTAL BOTTOM AREA _____

SEEPAGE PITS, INSIDE DIAMETER _____ FT. DEPTH BELOW INLET _____ FT.

ABSORBENT AREA _____ SQ. FT.

REMARKS 9/23/87 TEST HOLE WGT AT 6', CLAY TO 5' - FAILED.

NO ROOM TO INCREASE SEPTIC AREA ANY WHERE ON PROPERTY.

SYSTEM IS FUNCTIONING OK AT THIS TIME.

ADEQUATE A/C REMAINS FOR 2 REPAIR SYSTEMS.

1 BR. CONVERSION OK - ADDITIONAL BEDROOMS CAN BE ACCOMMODATED.

*SYSTEM LATER REPAIRED (5/11/89) - SAME PERMIT, SEE ATTACHED. C. Williams

DATE SYSTEM APPROVED _____

INSPECTOR _____

PERMIT

SEWAGE DISPOSAL SYSTEM

MARYLAND STATE DEPARTMENT OF HEALTH*

P 33832

A _____

DISTRICT 526

DATE 4/27/84

COMPLETE BUT NOT

DATE SYSTEM APPROVED 5/1/84

INSPECTOR (W)

HOWARD COUNTY
BUREAU OF ENVIRONMENTAL HEALTH
461-9933

05-364412

p2/2
INDEXED

WM, REED

IS PERMITTED TO INSTALL _____ ALTER

ADDRESS _____ PHONE _____

SUBDIVISION _____ ROAD _____ LOT _____

PROPERTY OWNER William REED

ADDRESS 11865 LINE KILN RD.

IF GARBAGE GRINDER IS USED INCREASE SEPTIC TANK CAPACITY BY 50% AND ABSORPTION AREA BY 22%

GARBAGE GRINDER? YES _____ NO _____

SEPTIC TANK CAPACITY _____ GALLONS NUMBER OF BEDROOMS _____

VER. SHALLOW SYSTEM, SEASONAL HIGH WATER TABLE

SEE ATTACHED FOR ADDITIONAL BACKGROUND.

PLANS APPROVED BY S. ABEL DATE 5/4/88

COVER NO WORK UNTIL INSPECTED AND APPROVED

NEITHER THE HOWARD COUNTY COUNCIL NOR THE HEALTH DEPARTMENT IS RESPONSIBLE FOR THE SUCCESSFUL OPERATION OF ANY SYSTEM

NOTE: CLEANOUT REQUIRED EVERY 70 FEET OF SEWER LINE AND/OR AT 90° SWEEPS IN LINES FROM HOUSE TO DRAIN FIELDS

NOTE: ALL PARTS OF SEPTIC SYSTEMS (IE TANK DISTRIBUTION BOX TRENCHES) TO BE 100 FEET FROM WELL (UNLESS OTHERWISE SPECIFICALLY AUTHORIZED)

NOTE: IF DEEP TRENCHES ARE USED CALL FOR INSPECTION BEFORE AND AFTER PLACING GRAVEL IN TRENCHES

NOTE: NO DRY WELL SHALL EXCEED 15 FOOT IN DIAMETER NO ABSORPTION TRENCH TO EXCEED 100 FEET IN LENGTH

NOTE: ALL PIPE FROM HOUSE TO SEPTIC TANK MUST BE CAST IRON OR SCHEDULE 40 PVC OR ABS

PERMIT VOID AFTER TWO YEARS

NOTE: INSTALL STAND PIPE ON SEPTIC TANK AND DRY WELL. STAND PIPES MUST BE 6 INCHES IN DIAMETER. CAST IRON CONCRETE OR TERRA COTTA OR PVC OR ABS ACCEPTED IF TOP OF SEPTIC TANK IS DEEPER THAN 3 FEET. MANHOLE TO GRADE REQUIRED

NOTE: DISTRIBUTION BOXES MUST HAVE BAFFLES

*INSTALLER IS RESPONSIBLE FOR OBTAINING FINAL APPROVAL ON THIS PERMIT

*CALL 461-9933 FOR INSPECTION OF SEPTIC SYSTEMS.

EH - 2-1186

DUKIT SINGH AND
KAMALJIT KAUR
11859 LIME KILN ROAD
TAX MAP 46, GRID 1, PARCEL 183
15902/152

REMOVED. EX. WELL
MAY BE IN HOUSE AND
IS REQUIRED TO BE
SEALED AND
ABANDONED

50
11859
TAX MAP 4

LIME KILN ROAD

N 89°34'46" W 45.72

EX. WELL
NO. 15, 0244

APPROX. LOCATION
EX. TRENCHES
INSTALLED 1968
P33832

EX. HSE
#11859
T.B.R.

SHED
T.B.R.

EX. FIT WELL
- SEALED

EX. SEPTIC TA

UNITS OF FIELD-CLIN
TOPOGRAPHY

DENSE BAMBOO

DENSE BAMBOO

*Projected
P tank
location*

*Well
location
by survey is
not very accurate*

APPROX. LOCATION EX.
DRILLED WELL IN PIT

*Observed
well
location*

UNITS OF FIELD-CLIN
TOPOGRAPHY

APPROX. LOCATION
EX. TRENCH
INSTALLED 1990
K57400

THOMAS W. ATWELL
8030 HUNTERBROOK LANE
TAX MAP 46, GRID 2, PARCEL 201
741576

FUTURE
WELL

GgB

FUTURE
WELL