

HOWARD COUNTY HEALTH DEPARTMENT

JOYCE M. BOYD, M.D., M.P.H.
COUNTY HEALTH OFFICER



Bureau of Environmental Health
3525 Ellicott Mills Drive
Ellicott City, Maryland 21043

Director - 461-9956
Water & Sewerage, Permits - 461-9933
Community Environmental Health - 461-9944
Technical Services - 461-9955

October 5, 1987

Mr. William Reed
11865 Lime Kiln Road
Fulton, Maryland 20759

RE: Percolation Testing-Repair
Proposed Addition to
Septic System
11865 Lime Kiln Road

Dear Mr. Reed:

Percolation testing conducted September 23, 1987 on the above referenced property revealed conditions not suitable for expansion of the sewage disposal area. A heavy clay layer 5-6' deep with a water table immediately underlying prohibit extension of the septic system into any area lower on the property than the existing system.

Any repairs or additions to the septic system would have to be accomplished on the limited area of higher ground on the property. This circumstance would be cause to deny any building permit application involving expansion of the current dwelling. It is possible that a request to convert existing facilities would be honored. A favorable decision in that regard would be possible only if the conversion did not involve an increase in the number of bedrooms on kitchen facilities in the dwelling. An increase in either would likely be rejected because of the potential for increasing occupancy and hence wastewater discharge in an area of limited wastewater disposal capacity.

If you have any questions relative to this matter, please call me at 461-9933.

Respectfully,

A handwritten signature in cursive script that reads "Craig Williams".

Craig Williams, Director
Water and Sewerage Program

CW:JR

P.S. Building Permit Application Serial Number 14904 was signed on October 5, 1987 *CW,*

11855 & 11859 Lime Kiln Rd.

(3)

AP

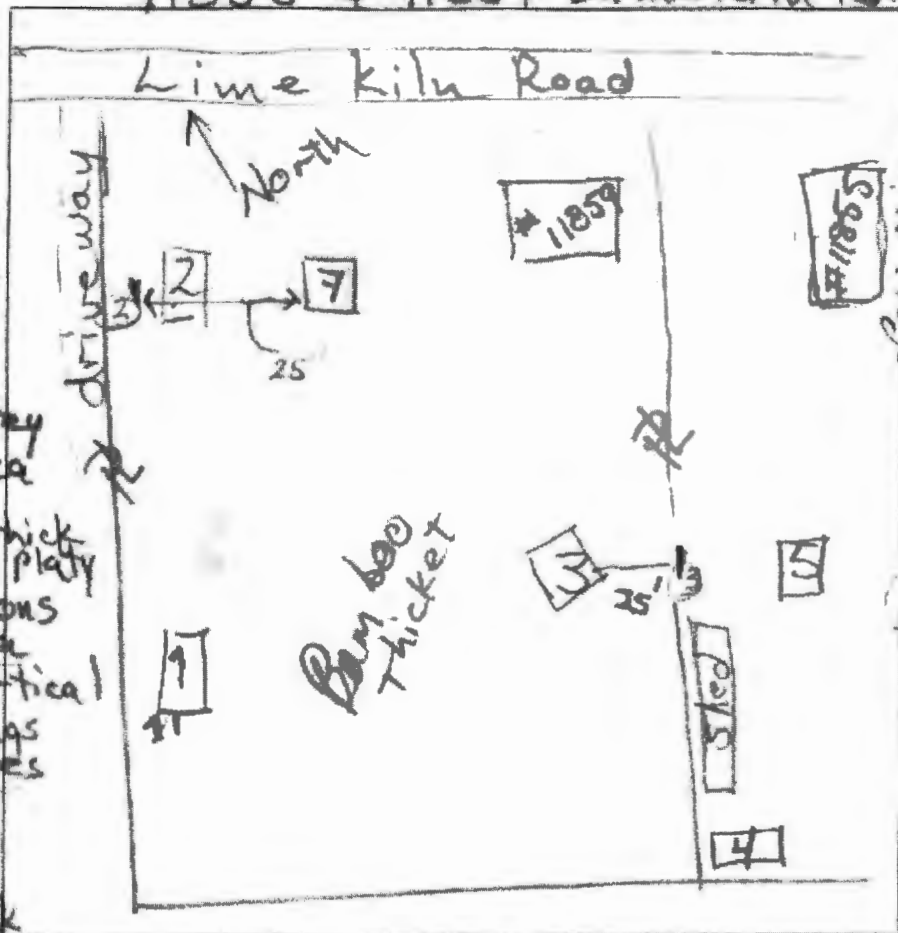

1
dk brn L
3 v f sbk
pale brn L
2 f sbk
red-yel L
3 m sbk
few mica
2
white and gray
sl, many mica
3.5
yel-red sl, thick
many fine platy
white striations
many mica
14
white coatings
on ped faces

2
dk brn L, 2 v f sbk
dk brn & brn L
2 f sbk

4
yel brn L
coarse prismatic
red-yel
& yel-brn
L & sl, dense
23 p (pale yellow)

5.5
red-yel & white
sl thick platy
many mica

9
yel-red sl
many mica
water seeps
yel-red sl
moist, sticky

DATE	TEST #	DEPTH	START	BREAK 1" DROP	STOP 2" DROP	TIME OF 2ND INCH	P/F/H
8/26/15	1	5.7/105	2:04	2:06	2:09	3	P
8/26/15	2	4.2/89	2:56	3:46			F
8/26/15	3	6.5/105	3:20	3:27	3:35	8	P
8/26/15	7	105	Visual	3'-6.5' sidewall	1.2 gpd/G2		P
* Observed water table in other locations and collapse of shell at #1 may indicate presence of saturated soils at location #1 approx. 28' - 5.8' - 14' - 11'							

dk brn L
3 v f sbk
dk brn & brn
L, 2 f sbk
dk, brn, brn
& yel-red
coarse
14
prismatic
yel-red L
coarse prismatic
25
red-yel sl
v. coarse prismatic
brn clay skins
on ped faces
dense, coarse
mica
5
red-yel ls
thick platy
many mica
thick white
coatings on
ped faces
6
yel-red
ls, thick platy
many mica
thick white
coatings on
ped faces
11
water seep

2
dk, gray-brn
to dk, brn L
brn & red-yel L
coarse prismatic
red-yel & brn
sl, coarse prismatic
28
red-yel & white
sl, thick platy
many mica
5.8
yel-red ls
thick platy
many mica
11
water seep

REMARKS Location 7 added; Location 3 moved.
SANITARIAN R Bricker BACKHOE Dan OTHERS Steve Forney
TEST HOLES USED IN SDA MAM Sediment Control Co. AVG. PERC TIME SQ. FT/HR
TRENCH WIDTH INLET DEPTH MAX. BOT DEPTH EFFECTIVE SW

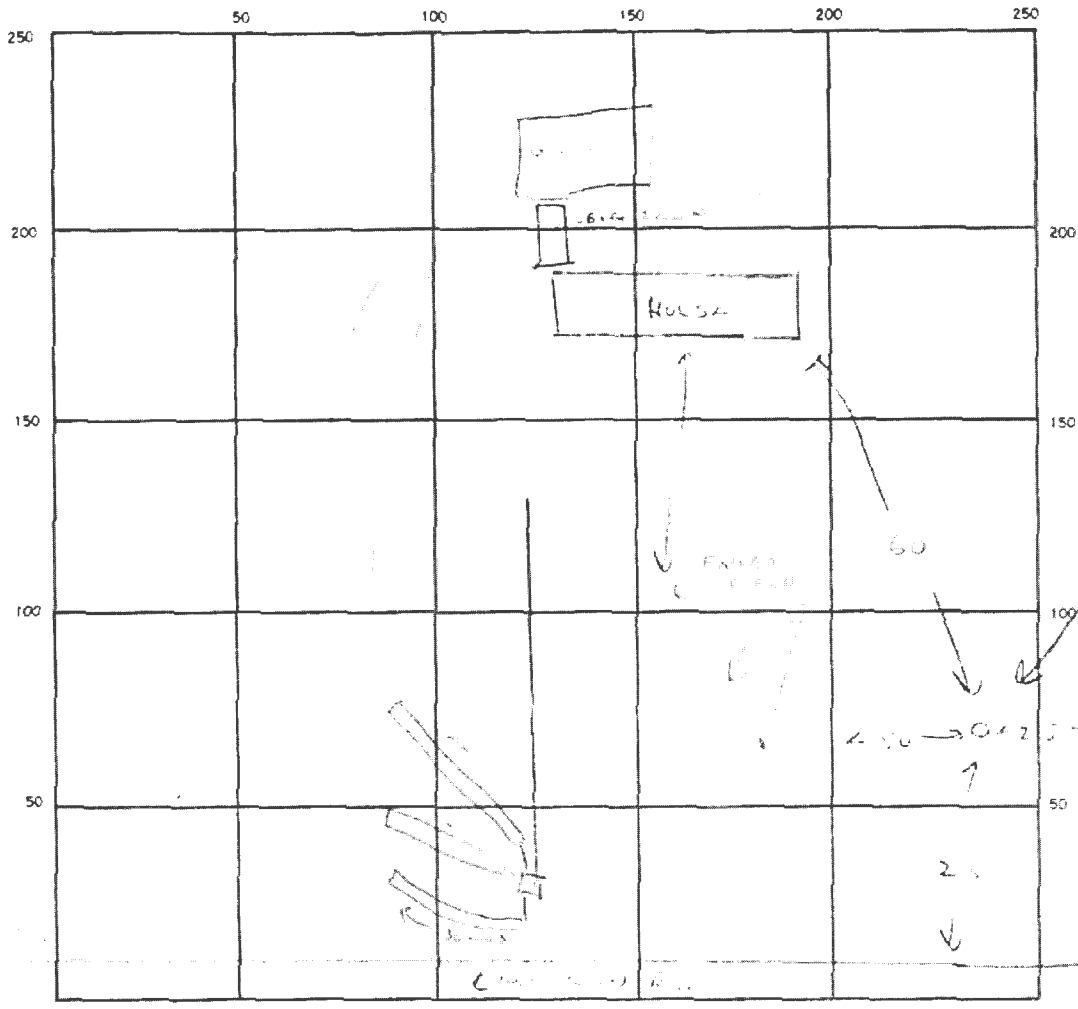

INDICATE NORTH — NAME ADJOINING ROADWAY AS BASE LINE

SEPTIC TANK. LEVEL _____ CLEANOUTS _____

DISTRIBUTION BOX. LEVEL _____

DRAIN FIELD/TILE FIELD. DEPTH _____ FT. TRENCH WIDTH _____ FT INLET DEPTH _____ FT

EFFECTIVE GRAVEL DEPTH _____ FT. TOTAL LENGTH _____ FT

NUMBER OF TRENCHES _____ ONE SIDEWALL/BOTTOM AREA _____ SQ FT.

DRYWELL INSIDE DIAMETER _____ FT. EFFECTIVE DEPTH BELOW INLET _____ FT

ABSORBENT AREA _____ SQ FT.

REMARKS 5/1/22 REPAIRS TO SEPTIC TANK AND DRAIN FIELD

TO REPAIR SEPTIC TANK AND DRAIN FIELD, THE EXISTING TRENCHES WERE OPENED UP AND THE GRAVEL WAS REPLACED WITH NEW GRAVEL.

THE SEPTIC TANK WAS FOUND TO BE IN GOOD CONDITION AND NO REPAIRS WERE NEEDED.

THE DRAIN FIELD WAS FOUND TO BE IN GOOD CONDITION AND NO REPAIRS WERE NEEDED.

NO REPAIRS WERE NEEDED TO THE SEPTIC TANK OR DRAIN FIELD.

NO REPAIRS WERE NEEDED TO THE SEPTIC TANK OR DRAIN FIELD.

1.2150 ACRES

WILLIAM REED
MARTHA REED

N

173.87

131.11

DAIVEWAY

40'-0"

24'-0"

GARAGE

40'-0"

27'-0"

GARAGE

12'-0"

12'-0"

12'-0"

HOUSE

23'-0"

40'-0"

57'-0"

50'-0"

229.8

270.7

~~DRAIN FIELDS
REQUIRED BY
HOWARD COUNTY~~

DIAGRAM
WILLIAM REED
INCORRECT
11/10/88

PLANNED 2006
1500 sq ft / 1987

P 3300 sq ft
BORN DRIVEWAY
1988

LIME KILN ROAD 30'

PLOT PLAN