

## Oswald, Hank

---

**From:** Oswald, Hank  
**Sent:** Wednesday, March 16, 2022 3:37 PM  
**To:** Tony Fertitta  
**Subject:** RE: Perc Cert Plan\_5237 Kalmia Drive  
**Attachments:** [Untitled].pdf

Hi Tony:

I reviewed the revised perc cert plan (#2 revision), and I have the following comments:

- 1.) Add note: well was field located etc. (Per last set of comments).
- 2.) Add note: septic tank and trenches were field located etc. (Per last set of comments) I believe the trenches were field located and staked by Freedom Septic.
- 3.) Remove replacement trench on plan and show on OSDS plan.
- 4.) Add note: An approved OSDS Plan will be required to show replacement systems meeting setbacks, and the installation of new system must be installed prior to building permit approval.

Attached are the septic specs.

Thanks,

Hank

**From:** Tony Fertitta <tonyf@fcc-eng.com>  
**Sent:** Wednesday, March 16, 2022 12:59 PM  
**To:** Oswald, Hank <hoswald@howardcountymd.gov>  
**Subject:** RE: Perc Cert Plan\_5237 Kalmia Drive

[Note: This email originated from outside of the organization. Please only click on links or attachments if you know the sender.]

Good afternoon Hank

Could you please send me the septic spec. I just sent in the perc cert.

Thanks

Tony

**From:** Oswald, Hank <hoswald@howardcountymd.gov>  
**Sent:** Thursday, March 3, 2022 8:41 AM  
**To:** Tony Fertitta <tonyf@fcc-eng.com>  
**Subject:** Perc Cert Plan\_5237 Kalmia Drive

Hi Tony:

Good morning. The perc cert plan for 5237 Kalmia Drive has been reviewed with the following comments:

1. Add well field location note to plan.
2. Add septic tank and trench field location note to plan.

3. Label any part of the septic system to be abandoned.
4. Add note: An approved OSDS Plan will be required to show replacement systems meeting setbacks, and the installation of new system must be installed prior to building permit. approval.

Please let me know if you have any questions.

Thanks,

Hank

Hank Oswald, L.E.H.S.  
Howard County Health Department  
Well & Septic Program  
410.313.1786  
[hoswald@howardcountymd.gov](mailto:hoswald@howardcountymd.gov)

## Oswald, Hank

---

**From:** Oswald, Hank  
**Sent:** Thursday, March 3, 2022 8:41 AM  
**To:** Tony Fertitta (tonyf@fcc-eng.com)  
**Subject:** Perc Cert Plan\_5237 Kalmia Drive

Hi Tony:

Good morning. The perc cert plan for 5237 Kalmia Drive has been reviewed with the following comments:

1. Add well field location note to plan.
2. Add septic tank and trench field location note to plan.
3. Label any part of the septic system to be abandoned.
4. Add note: An approved OSDS Plan will be required to show replacement systems meeting setbacks, and the installation of new system must be installed prior to building permit. approval.

Please let me know if you have any questions.

Thanks,

Hank

Hank Oswald, L.E.H.S.  
Howard County Health Department  
Well & Septic Program  
410.313.1786  
hoswald@howardcountymd.gov

Sen)

Septic

Spec

---

**LEGEND**

- - - - - EXISTING 2' CONTOURS
- - - - - EXISTING 10' CONTOURS
- - - - - EXISTING TREE LINE
- GL82  
HL22  
SOIL LINES AND TYPES
- ⊙ DENOTES EXISTING WELL
- DENOTES PASSED PERC
- DENOTES 1500 Sq.Ft. ALTERNATE WELL SITE
- ▨ DENOTES APPROVED PERC AREA
- ▩ DENOTES APPROVED PERC AREA TO BE ABANDONED

**SOILS LEGEND**

SOIL	NAME	CLASS	'K' VALUE
GgB	Glenn loam, 3 to 8 percent slopes	B	.37
MaC	Manor loam, 8 to 15 percent slopes	B	.32

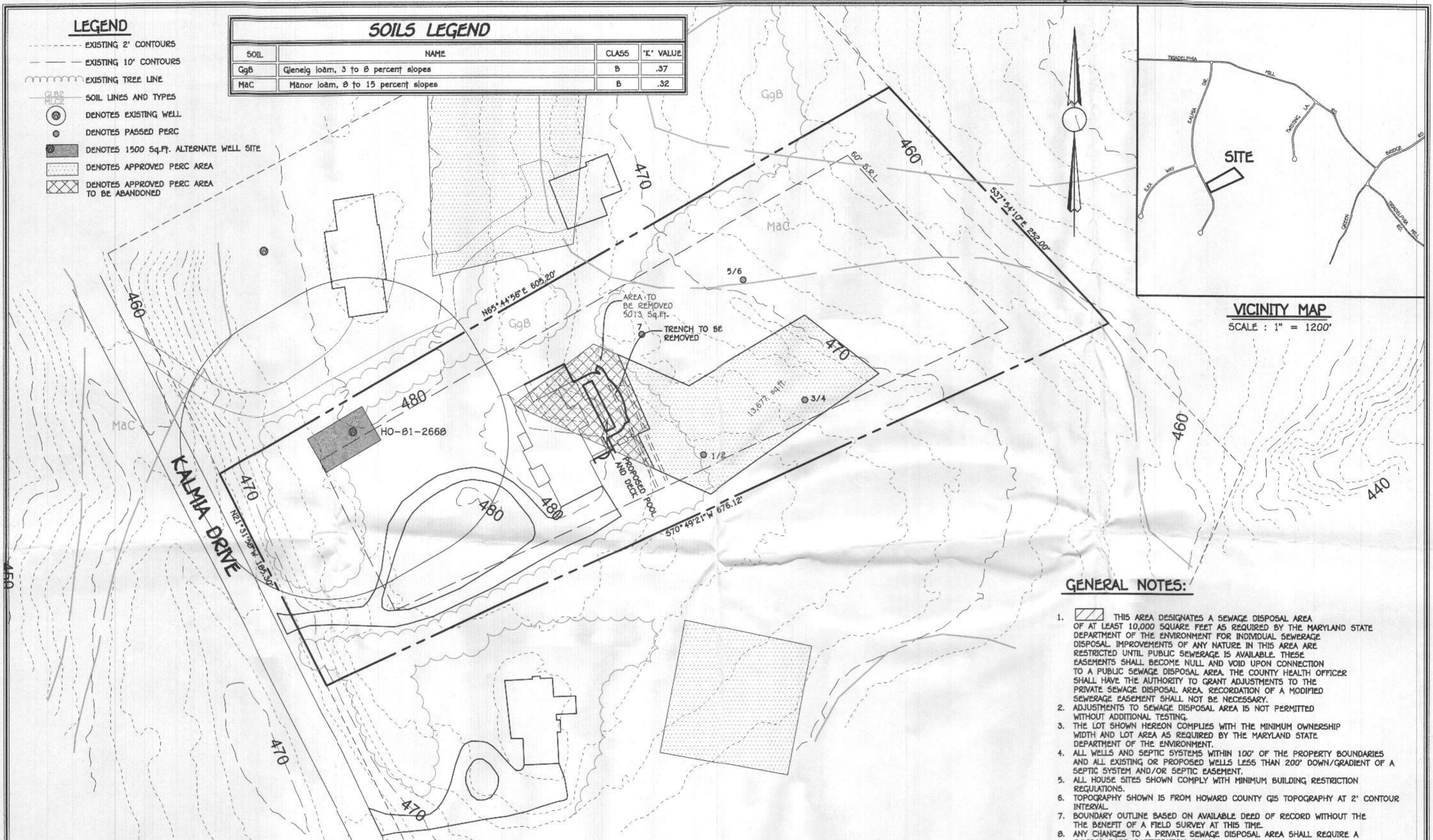

**GENERAL NOTES:**

1. THIS AREA DESIGNATES A SEWAGE DISPOSAL AREA OF AT LEAST 10,000 SQUARE FEET AS REQUIRED BY THE MARYLAND STATE DEPARTMENT OF THE ENVIRONMENT FOR INDIVIDUAL SEWERAGE DISPOSAL IMPROVEMENTS OF ANY NATURE IN THIS AREA ARE RESTRICTED UNTIL PUBLIC SEWERAGE IS AVAILABLE. THESE EASEMENTS SHALL BECOME NULL AND VOID UPON CONNECTION TO A PUBLIC SEWAGE DISPOSAL AREA. THE COUNTY HEALTH OFFICER SHALL HAVE THE AUTHORITY TO GRANT ADJUSTMENTS TO THE PRIVATE SEWAGE DISPOSAL AREA. RECORDATION OF A MODIFIED SEWERAGE EASEMENT SHALL NOT BE NECESSARY.
2. ADJUSTMENTS TO SEWAGE DISPOSAL AREA IS NOT PERMITTED WITHOUT ADDITIONAL TESTING.
3. THE LOT SHOWN HEREON COMPLIES WITH THE MINIMUM OWNERSHIP WIDTH AND LOT AREA AS REQUIRED BY THE MARYLAND STATE DEPARTMENT OF THE ENVIRONMENT.
4. ALL WELLS AND SEPTIC SYSTEMS WITHIN 100' OF THE PROPERTY BOUNDARIES AND ALL EXISTING OR PROPOSED WELLS LESS THAN 200' DOWN/GRADIENT OF A SEPTIC SYSTEM AND/OR SEPTIC EASEMENT.
5. ALL HOUSE SITES SHOWN COMPLY WITH MINIMUM BUILDING RESTRICTION REGULATIONS.
6. TOPOGRAPHY SHOWN IS FROM HOWARD COUNTY Q15 TOPOGRAPHY AT 2' CONTOUR INTERVAL.
7. BOUNDARY OUTLINE BASED ON AVAILABLE DEED OF RECORD WITHOUT THE THE BENEFIT OF A FIELD SURVEY AT THIS TIME.
8. ANY CHANGES TO A PRIVATE SEWAGE DISPOSAL AREA SHALL REQUIRE A REVISED PERC CERTIFICATION PLAN
9. PLAT REFERENCE 4170.
10. AN APPROVED OSDS PLAN WILL BE REQUIRED TO SHOW REPLACEMENT SYSTEMS MEETING SETBACKS, AND THE INSTALLATION OF NEW SYSTEM MUST BE INSTALLED PRIOR TO BUILDING APPROVAL.
11. THE WELL HO-01-2668 HAS BEEN FIELD LOCATED AND IS ACCURATELY SHOWN.
12. THE SEPTIC TANK AND TRENCHES HAVE BEEN FIELD LOCATED AND IS ACCURATELY SHOWN.

**PERC CERTIFICATION**  
 I certify that the locations shown hereon are based on field locations done under my direct supervision and are correct to the best of my professional knowledge and belief.

*Frank J. Manalansan II*  
 Signature of Professional Land Surveyor  
 Frank J. Manalansan II, Professional Land Surveyor No. 21476 Expires 07/14/23

5/18/22  
 Date

APPROVED FOR PRIVATE WATER AND PRIVATE SEWERAGE SYSTEMS,  
 HOWARD COUNTY HEALTH DEPARTMENT.

*Frank J. Manalansan II*  
 COUNTY HEALTH OFFICER

3/23/22  
 DATE

**PERC CERTIFICATION PLAT  
 5237 KALMIA DRIVE**

TAX MAP #27    GRID: 17    PARCEL: 127    LOT 10  
 5TH ELECTION DISTRICT    HOWARD COUNTY, MARYLAND  
 SCALE: 1"=50'    DATE: MARCH 14, 2022

**LEGEND**

- - - - - EXISTING 2' CONTOURS
- - - - - EXISTING 10' CONTOURS
- - - - - EXISTING TREE LINE
- GLB2  
MLC2  
SOIL LINES AND TYPES
- ⊙ DENOTES EXISTING WELL
- DENOTES PASSED PERC
- DENOTES 1500 Sq.Ft. ALTERNATE WELL SITE
- ▨ DENOTES APPROVED PERC AREA
- ▩ DENOTES APPROVED PERC AREA TO BE ABANDONED

**SOILS LEGEND**

SOIL	NAME	CLASS	'K' VALUE
GgB	Glenelig loam, 3 to 6 percent slopes	B	.37
MaC	Manor loam, 0 to 15 percent slopes	B	.32

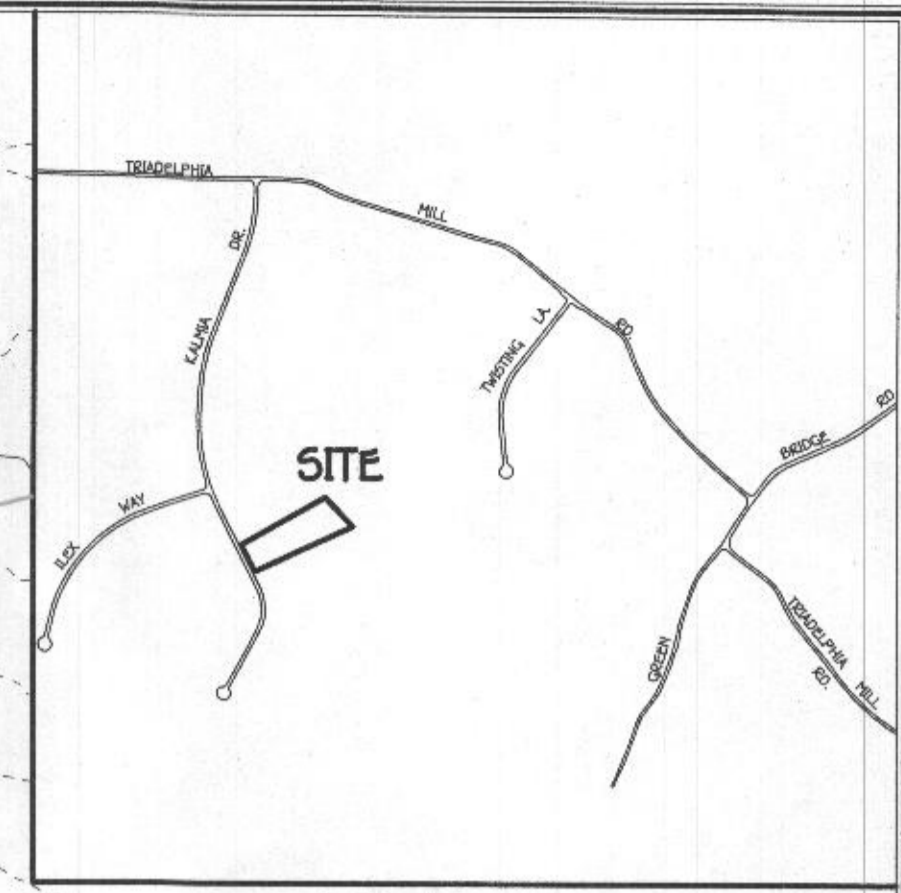

**VICINITY MAP**  
SCALE: 1" = 1200'

**GENERAL NOTES:**

1. ▨ THIS AREA DESIGNATES A SEWAGE DISPOSAL AREA OF AT LEAST 10,000 SQUARE FEET AS REQUIRED BY THE MARYLAND STATE DEPARTMENT OF THE ENVIRONMENT FOR INDIVIDUAL SEWERAGE DISPOSAL IMPROVEMENTS OF ANY NATURE IN THIS AREA ARE RESTRICTED UNTIL PUBLIC SEWERAGE IS AVAILABLE. THESE EASEMENTS SHALL BECOME NULL AND VOID UPON CONNECTION TO A PUBLIC SEWAGE DISPOSAL AREA. THE COUNTY HEALTH OFFICER SHALL HAVE THE AUTHORITY TO GRANT ADJUSTMENTS TO THE PRIVATE SEWAGE DISPOSAL AREA. RECORDATION OF A MODIFIED SEWERAGE EASEMENT SHALL NOT BE NECESSARY.
2. ADJUSTMENTS TO SEWAGE DISPOSAL AREA IS NOT PERMITTED WITHOUT ADDITIONAL TESTING.
3. THE LOT SHOWN HEREON COMPLIES WITH THE MINIMUM OWNERSHIP WIDTH AND LOT AREA AS REQUIRED BY THE MARYLAND STATE DEPARTMENT OF THE ENVIRONMENT.
4. ALL WELLS AND SEPTIC SYSTEMS WITHIN 100' OF THE PROPERTY BOUNDARIES AND ALL EXISTING OR PROPOSED WELLS LESS THAN 200' DOWN/GRADIENT OF A SEPTIC SYSTEM AND/OR SEPTIC EASEMENT.
5. ALL HOUSE SITES SHOWN COMPLY WITH MINIMUM BUILDING RESTRICTION REGULATIONS.
6. TOPOGRAPHY SHOWN IS FROM HOWARD COUNTY Q15 TOPOGRAPHY AT 2' CONTOUR INTERVAL.
7. BOUNDARY OUTLINE BASED ON AVAILABLE DEED OF RECORD WITHOUT THE BENEFIT OF A FIELD SURVEY AT THIS TIME.
8. ANY CHANGES TO A PRIVATE SEWAGE DISPOSAL AREA SHALL REQUIRE A REVISED PERC CERTIFICATION PLAN.
9. PLAT REFERENCE 4170.
10. AN APPROVED OSDS PLAN WILL BE REQUIRED TO SHOW REPLACEMENT SYSTEMS MEETING SETBACKS, AND THE INSTALLATION OF NEW SYSTEM MUST BE INSTALLED PRIOR TO BUILDING APPROVAL.
11. THE WELL HO-01-2668 HAS BEEN FIELD LOCATED AND IS ACCURATELY SHOWN.
12. THE SEPTIC TANK AND TRENCHES HAVE BEEN FIELD LOCATED AND IS ACCURATELY SHOWN.

PERC CERTIFICATION  
I certify that the locations shown hereon are based on field locations done under my direct supervision and are correct to the best of my professional knowledge and belief.

*Frank J. Manlansan II* 3/10/22  
Signature of Professional Land Surveyor No. 21476 Expires 07/14/23 Date

APPROVED FOR PRIVATE WATER AND PRIVATE SEWERAGE SYSTEMS,  
HOWARD COUNTY HEALTH DEPARTMENT.

*Michael J. ...* 3/23/22  
COUNTY HEALTH OFFICER n.o. 92 DATE

**PERC CERTIFICATION PLAT**  
**5237 KALMIA DRIVE**

TAX MAP #27 GRID: 17 PARCEL: 127 LOT 10  
5TH ELECTION DISTRICT HOWARD COUNTY, MARYLAND  
SCALE: 1"=50' DATE: MARCH 14, 2022

**FISHER, COLLINS & CARTER, INC.**  
CIVIL ENGINEERING CONSULTANTS & LAND SURVEYORS  
CENTENNIAL SQUARE OFFICE PARK - 10272 BALTIMORE NATIONAL PIKE  
ELLSWORTH CITY, MARYLAND 21042  
(410) 461 - 2955

**LEGEND**

- - - EXISTING 2' CONTOURS
- - - EXISTING 10' CONTOURS
- - - EXISTING TREE LINE
- CLAS PERC SOIL LINES AND TYPES
- ⊙ DENOTES EXISTING WELL
- DENOTES PASSED PERC
- DENOTES 1500 Sq.Ft. ALTERNATE WELL SITE
- ▨ DENOTES APPROVED PERC AREA
- ▩ DENOTES APPROVED PERC AREA TO BE ABANDONED

**SOILS LEGEND**

SOIL	NAME	CLASS	'K' VALUE
GgB	Glenelg loam, 3 to 8 percent slopes	B	.37
MaC	Manor loam, 8 to 15 percent slopes	B	.32

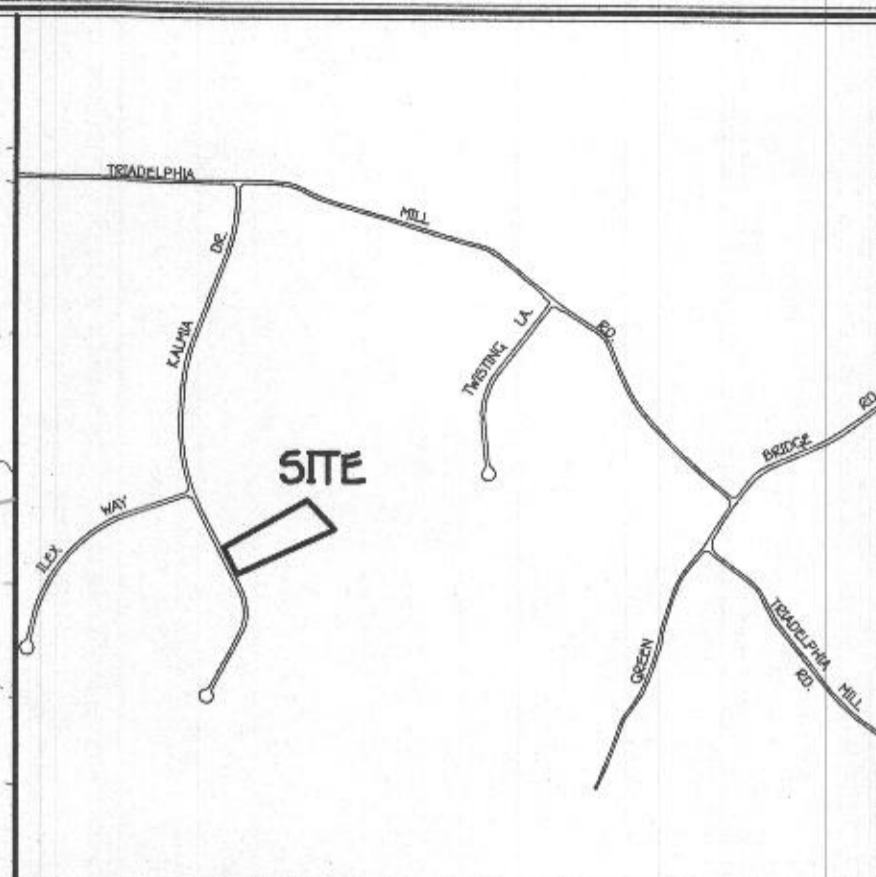

**VICINITY MAP**  
SCALE: 1" = 1200'

**GENERAL NOTES:**

1. ▨ THIS AREA DESIGNATES A SEWAGE DISPOSAL AREA OF AT LEAST 10,000 SQUARE FEET AS REQUIRED BY THE MARYLAND STATE DEPARTMENT OF THE ENVIRONMENT FOR INDIVIDUAL SEWERAGE DISPOSAL IMPROVEMENTS OF ANY NATURE IN THIS AREA ARE RESTRICTED UNTIL PUBLIC SEWERAGE IS AVAILABLE. THESE EASEMENTS SHALL BECOME NULL AND VOID UPON CONNECTION TO A PUBLIC SEWAGE DISPOSAL AREA. THE COUNTY HEALTH OFFICER SHALL HAVE THE AUTHORITY TO GRANT ADJUSTMENTS TO THE PRIVATE SEWAGE DISPOSAL AREA. RECORDATION OF A MODIFIED SEWERAGE EASEMENT SHALL NOT BE NECESSARY.
2. ADJUSTMENTS TO SEWAGE DISPOSAL AREA IS NOT PERMITTED WITHOUT ADDITIONAL TESTING.
3. THE LOT SHOWN HEREON COMPLIES WITH THE MINIMUM OWNERSHIP WIDTH AND LOT AREA AS REQUIRED BY THE MARYLAND STATE DEPARTMENT OF THE ENVIRONMENT.
4. ALL WELLS AND SEPTIC SYSTEMS WITHIN 100' OF THE PROPERTY BOUNDARIES AND ALL EXISTING OR PROPOSED WELLS LESS THAN 200' DOWN/GRADIENT OF A SEPTIC SYSTEM AND/OR SEPTIC EASEMENT.
5. ALL HOUSE SITES SHOWN COMPLY WITH MINIMUM BUILDING RESTRICTION REGULATIONS.
6. TOPOGRAPHY SHOWN IS FROM HOWARD COUNTY GIS TOPOGRAPHY AT 2' CONTOUR INTERVAL.
7. BOUNDARY OUTLINE BASED ON AVAILABLE DEED OF RECORD WITHOUT THE THE BENEFIT OF A FIELD SURVEY AT THIS TIME.
8. ANY CHANGES TO A PRIVATE SEWAGE DISPOSAL AREA SHALL REQUIRE A REVISED PERC CERTIFICATION PLAN
9. PLAT REFERENCE 4170.

**PERC CERTIFICATION**  
I certify that the locations shown hereon are based on field locations done under my direct supervision and are correct to the best of my professional knowledge and belief.

*Frank J. Manalansan II*  
Signature of Professional Land Surveyor No. 21476 Expires 07/14/23

3/15/22  
Date

APPROVED FOR PRIVATE WATER AND PRIVATE SEWERAGE SYSTEMS,  
HOWARD COUNTY HEALTH DEPARTMENT.

COUNTY HEALTH OFFICER \_\_\_\_\_ DATE \_\_\_\_\_

**PERC CERTIFICATION PLAT**  
**5237 KALMIA DRIVE**

TAX MAP #27      GRID: 17      PARCEL: 127  
5TH ELECTION DISTRICT      HOWARD COUNTY, MARYLAND  
SCALE: 1" = 50'      DATE: MARCH 14, 2022

**LEGEND**

- - - - - EXISTING 2' CONTOURS
- - - - - EXISTING 10' CONTOURS
- - - - - EXISTING TREE LINE
- CLAS  
MLCS SOIL LINES AND TYPES
- ⊙ DENOTES EXISTING WELL
- DENOTES PASSED PERC
- DENOTES 1500 Sq.Ft. ALTERNATE WELL SITE
- ▨ DENOTES APPROVED PERC AREA
- ▩ DENOTES APPROVED PERC AREA TO BE ABANDONED

**SOILS LEGEND**

SOIL	NAME	CLASS	'K' VALUE
GgB	Glenelg loam, 3 to 8 percent slopes	B	.37
MaC	Manor loam, 0 to 15 percent slopes	B	.32

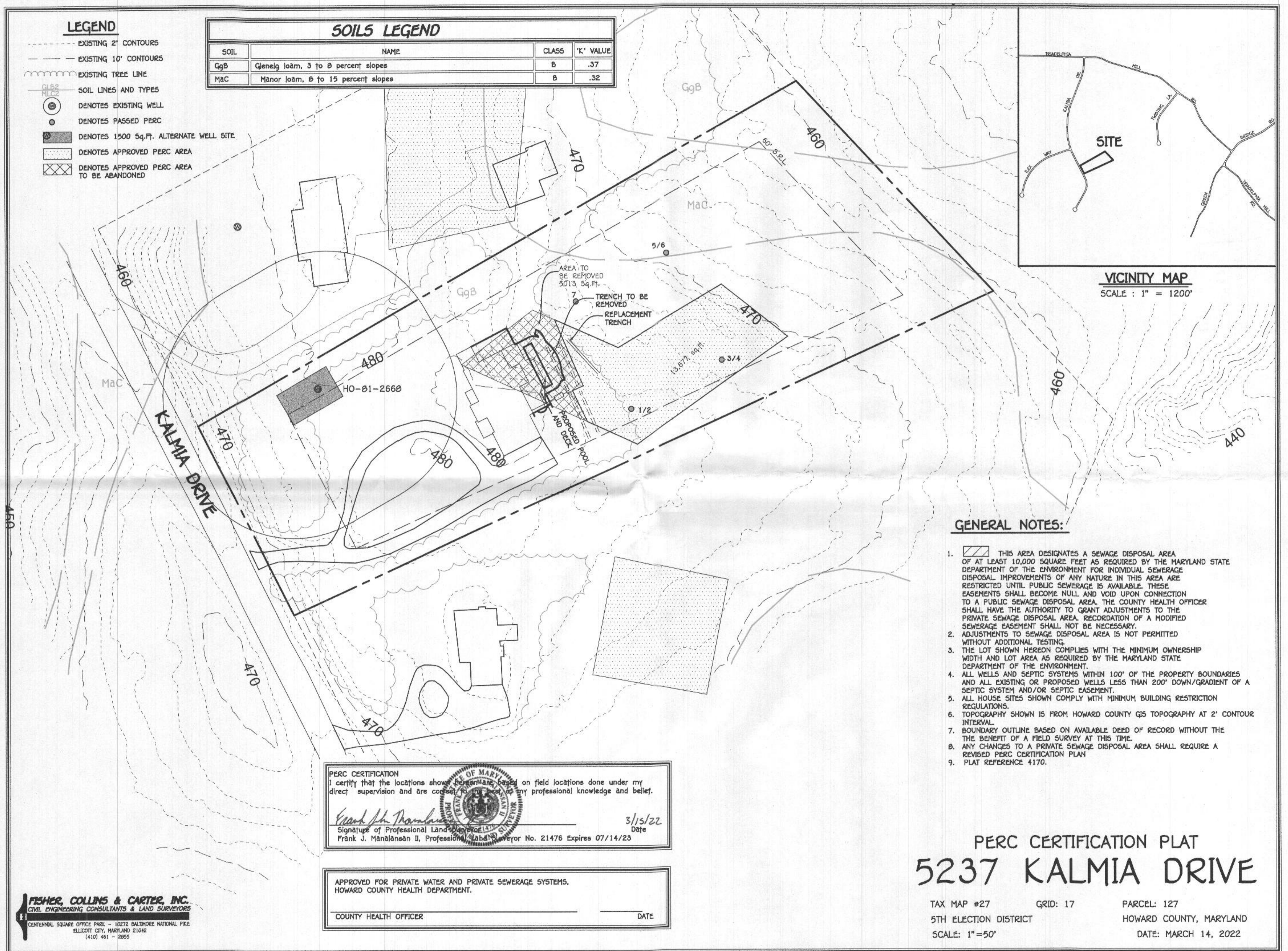

**GENERAL NOTES:**

1. ▨ THIS AREA DESIGNATES A SEWAGE DISPOSAL AREA OF AT LEAST 10,000 SQUARE FEET AS REQUIRED BY THE MARYLAND STATE DEPARTMENT OF THE ENVIRONMENT FOR INDIVIDUAL SEWERAGE DISPOSAL IMPROVEMENTS OF ANY NATURE IN THIS AREA ARE RESTRICTED UNTIL PUBLIC SEWERAGE IS AVAILABLE. THESE EASEMENTS SHALL BECOME NULL AND VOID UPON CONNECTION TO A PUBLIC SEWAGE DISPOSAL AREA. THE COUNTY HEALTH OFFICER SHALL HAVE THE AUTHORITY TO GRANT ADJUSTMENTS TO THE PRIVATE SEWAGE DISPOSAL AREA. RECORDATION OF A MODIFIED SEWERAGE EASEMENT SHALL NOT BE NECESSARY.
2. ADJUSTMENTS TO SEWAGE DISPOSAL AREA IS NOT PERMITTED WITHOUT ADDITIONAL TESTING.
3. THE LOT SHOWN HEREON COMPLIES WITH THE MINIMUM OWNERSHIP WIDTH AND LOT AREA AS REQUIRED BY THE MARYLAND STATE DEPARTMENT OF THE ENVIRONMENT.
4. ALL WELLS AND SEPTIC SYSTEMS WITHIN 100' OF THE PROPERTY BOUNDARIES AND ALL EXISTING OR PROPOSED WELLS LESS THAN 200' DOWN/GRADIENT OF A SEPTIC SYSTEM AND/OR SEPTIC EASEMENT.
5. ALL HOUSE SITES SHOWN COMPLY WITH MINIMUM BUILDING RESTRICTION REGULATIONS.
6. TOPOGRAPHY SHOWN IS FROM HOWARD COUNTY GIS TOPOGRAPHY AT 2' CONTOUR INTERVAL.
7. BOUNDARY OUTLINE BASED ON AVAILABLE DEED OF RECORD WITHOUT THE THE BENEFIT OF A FIELD SURVEY AT THIS TIME.
8. ANY CHANGES TO A PRIVATE SEWAGE DISPOSAL AREA SHALL REQUIRE A REVISED PERC CERTIFICATION PLAN
9. PLAT REFERENCE 4170.

PERC CERTIFICATION  
 I certify that the locations shown hereon are based on field locations done under my direct supervision and are correct to the best of my professional knowledge and belief.

*Frank J. Manalasan II*  
 Signature of Professional Land Surveyor  
 Frank J. Manalasan II, Professional Land Surveyor No. 21476 Expires 07/14/23

3/15/22  
 Date

APPROVED FOR PRIVATE WATER AND PRIVATE SEWERAGE SYSTEMS,  
 HOWARD COUNTY HEALTH DEPARTMENT.

\_\_\_\_\_  
 COUNTY HEALTH OFFICER

\_\_\_\_\_  
 DATE

**PERC CERTIFICATION PLAT  
 5237 KALMIA DRIVE**

TAX MAP #27      GRID: 17      PARCEL: 127  
 5TH ELECTION DISTRICT      HOWARD COUNTY, MARYLAND  
 SCALE: 1"=50'      DATE: MARCH 14, 2022

**FISHER, COLLINS & CARTER, INC.**  
 CIVIL ENGINEERING CONSULTANTS & LAND SURVEYORS  
 CENTENNIAL SQUARE OFFICE PARK - 10272 BALTIMORE NATIONAL PIKE  
 ELLICOTT CITY, MARYLAND 21042  
 (410) 461 - 2855

**LEGEND**

- - - - - EXISTING 2' CONTOURS
- - - - - EXISTING 10' CONTOURS
- - - - - EXISTING TREE LINE
- GLB2  
MLC2 SOIL LINES AND TYPES
- ⊙ DENOTES EXISTING WELL
- DENOTES PASSED PERC
- DENOTES 1500 Sq.Ft. ALTERNATE WELL SITE
- ▨ DENOTES APPROVED PERC AREA
- ▩ DENOTES APPROVED PERC AREA TO BE ABANDONED

**SOILS LEGEND**

SOIL	NAME	CLASS	'K' VALUE
GgB	Glenelg loam, 3 to 8 percent slopes	B	.37
MaC	Manor loam, 8 to 15 percent slopes	B	.32

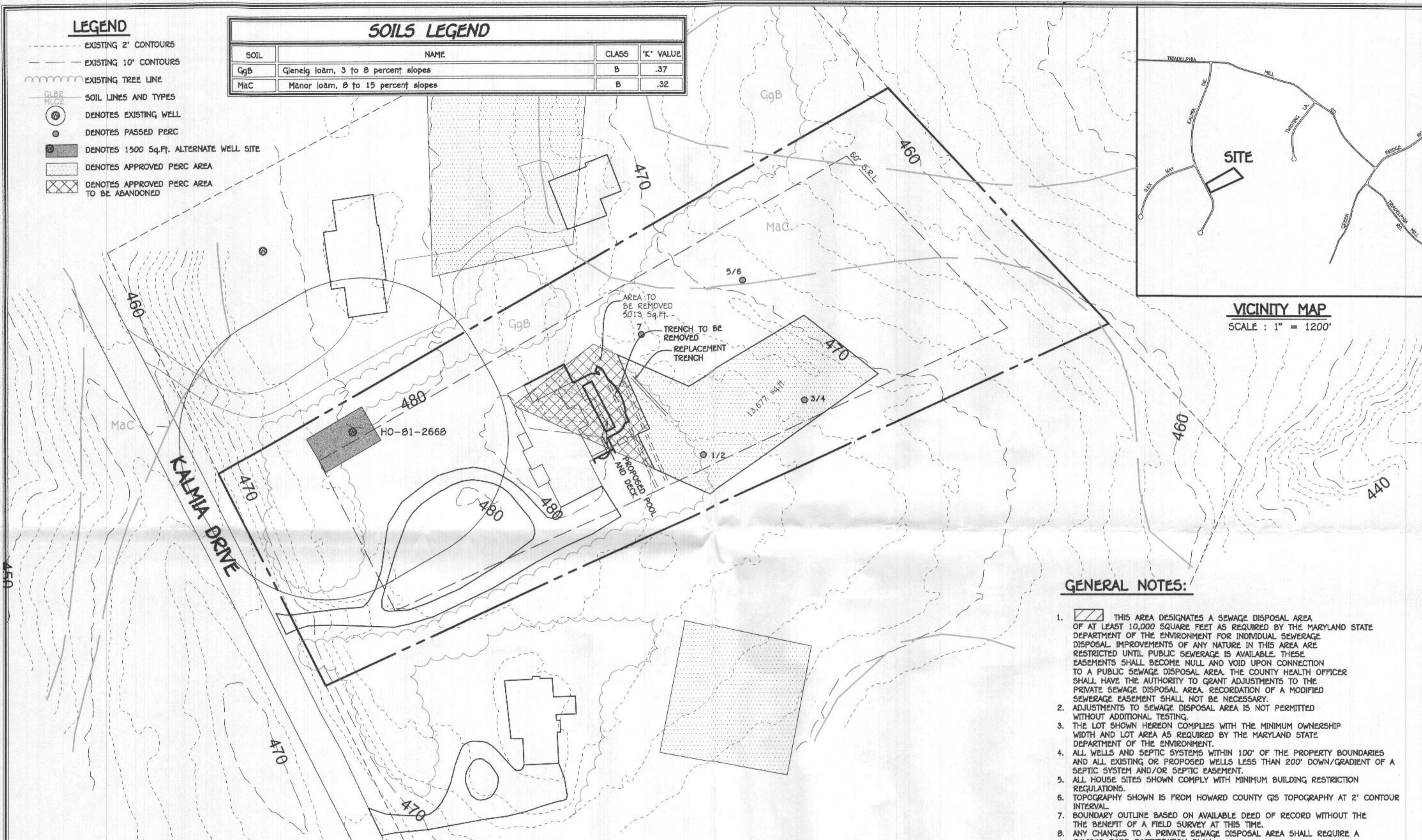

**GENERAL NOTES:**

1. THIS AREA DESIGNATES A SEWAGE DISPOSAL AREA OF AT LEAST 10,000 SQUARE FEET AS REQUIRED BY THE MARYLAND STATE DEPARTMENT OF THE ENVIRONMENT FOR INDIVIDUAL SEWERAGE DISPOSAL IMPROVEMENTS OF ANY NATURE IN THIS AREA ARE RESTRICTED UNTIL PUBLIC SEWERAGE IS AVAILABLE. THESE EASEMENTS SHALL BECOME NULL AND VOID UPON CONNECTION TO A PUBLIC SEWAGE DISPOSAL AREA. THE COUNTY HEALTH OFFICER SHALL HAVE THE AUTHORITY TO GRANT ADJUSTMENTS TO THE PRIVATE SEWAGE DISPOSAL AREA. RECORDATION OF A MODIFIED SEWERAGE EASEMENT SHALL NOT BE NECESSARY.
2. ADJUSTMENTS TO SEWAGE DISPOSAL AREA IS NOT PERMITTED WITHOUT ADDITIONAL TESTING.
3. THE LOT SHOWN HEREON COMPLIES WITH THE MINIMUM OWNERSHIP WIDTH AND LOT AREA AS REQUIRED BY THE MARYLAND STATE DEPARTMENT OF THE ENVIRONMENT.
4. ALL WELLS AND SEPTIC SYSTEMS WITHIN 100' OF THE PROPERTY BOUNDARIES AND ALL EXISTING OR PROPOSED WELLS LESS THAN 200' DOWN/GRADIENT OF A SEPTIC SYSTEM AND/OR SEPTIC EASEMENT.
5. ALL HOUSE SITES SHOWN COMPLY WITH MINIMUM BUILDING RESTRICTION REGULATIONS.
6. TOPOGRAPHY SHOWN IS FROM HOWARD COUNTY GIS TOPOGRAPHY AT 2' CONTOUR INTERVAL.
7. BOUNDARY OUTLINE BASED ON AVAILABLE DEED OF RECORD WITHOUT THE THE BENEFIT OF A FIELD SURVEY AT THIS TIME.
8. ANY CHANGES TO A PRIVATE SEWAGE DISPOSAL AREA SHALL REQUIRE A REVISED PERC CERTIFICATION PLAN
9. PLAT REFERENCE 4170.

PERC CERTIFICATION  
 I certify that the locations shown hereon are based on field locations done under my direct supervision and are correct to the best of my professional knowledge and belief.

*Frank J. Manalansan II*  
 Signature of Professional Land Surveyor  
 Frank J. Manalansan II, Professional Land Surveyor No. 21476 Expires 07/14/23

3/15/22  
 Date

APPROVED FOR PRIVATE WATER AND PRIVATE SEWERAGE SYSTEMS,  
 HOWARD COUNTY HEALTH DEPARTMENT.

COUNTY HEALTH OFFICER \_\_\_\_\_ DATE \_\_\_\_\_

**PERC CERTIFICATION PLAT  
 5237 KALMIA DRIVE**

TAX MAP #27      GRID: 17      PARCEL: 127  
 5TH ELECTION DISTRICT      HOWARD COUNTY, MARYLAND  
 SCALE: 1"=50'      DATE: MARCH 14, 2022

**LEGEND**

- - - - - EXISTING 2' CONTOURS
- - - - - EXISTING 10' CONTOURS
- - - - - EXISTING TREE LINE
- SOIL LINES AND TYPES
- DENOTES EXISTING WELL
- DENOTES PASSED PERC
- DENOTES 1500 Sq.Ft. ALTERNATE WELL SITE
- ▨ DENOTES APPROVED PERC AREA
- ▩ DENOTES APPROVED PERC AREA TO BE ABANDONED

**SOILS LEGEND**

SOIL	NAME	CLASS	'K' VALUE
GgB	Glenn loam, 3 to 8 percent slopes	B	.37
MaC	Manor loam, 8 to 15 percent slopes	B	.32

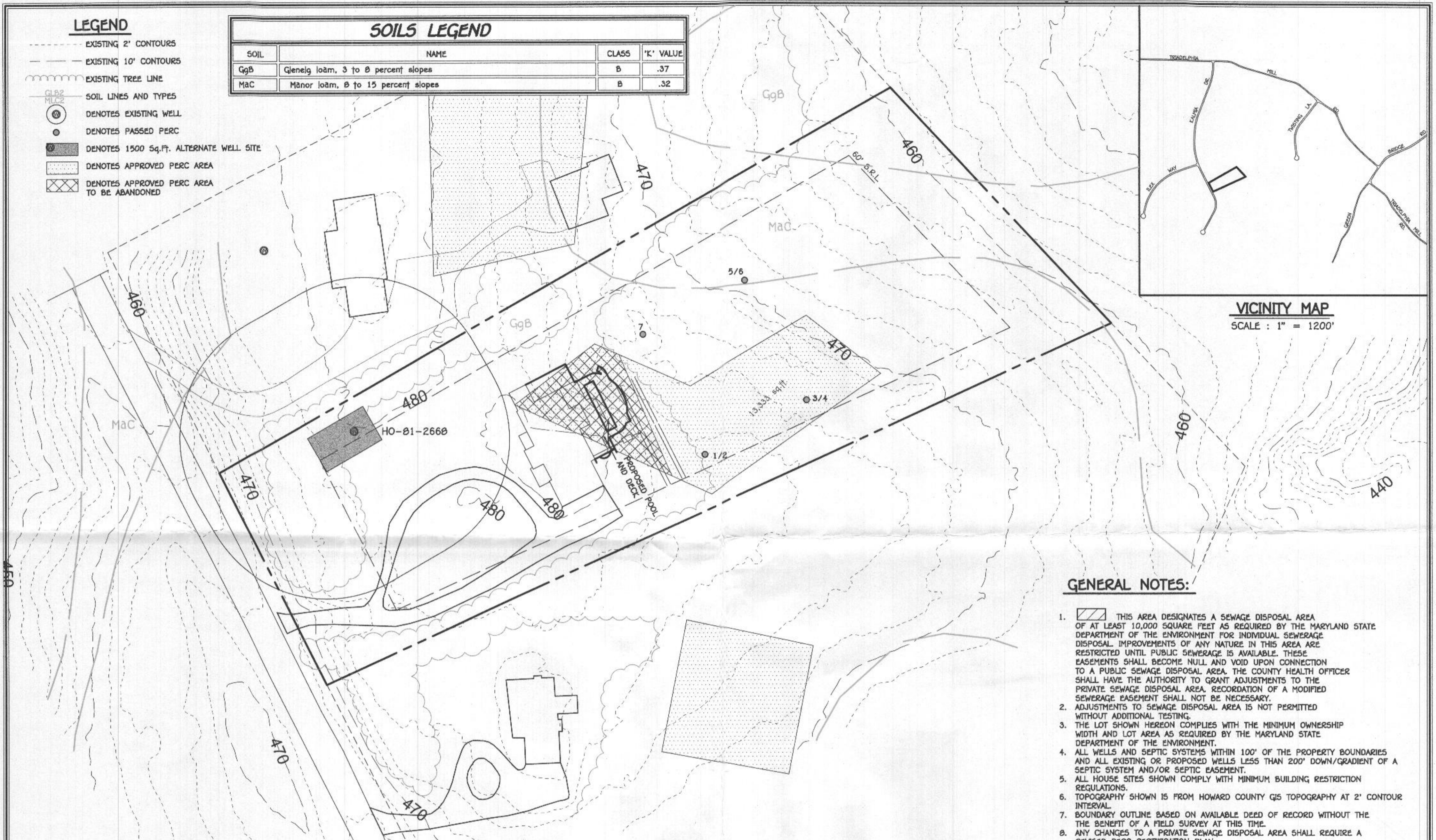

**VICINITY MAP**  
SCALE : 1" = 1200'

**GENERAL NOTES:**

1. ▨ THIS AREA DESIGNATES A SEWAGE DISPOSAL AREA OF AT LEAST 10,000 SQUARE FEET AS REQUIRED BY THE MARYLAND STATE DEPARTMENT OF THE ENVIRONMENT FOR INDIVIDUAL SEWERAGE DISPOSAL IMPROVEMENTS OF ANY NATURE IN THIS AREA ARE RESTRICTED UNTIL PUBLIC SEWERAGE IS AVAILABLE. THESE EASEMENTS SHALL BECOME NULL AND VOID UPON CONNECTION TO A PUBLIC SEWAGE DISPOSAL AREA. THE COUNTY HEALTH OFFICER SHALL HAVE THE AUTHORITY TO GRANT ADJUSTMENTS TO THE PRIVATE SEWAGE DISPOSAL AREA. RECORDATION OF A MODIFIED SEWERAGE EASEMENT SHALL NOT BE NECESSARY.
2. ADJUSTMENTS TO SEWAGE DISPOSAL AREA IS NOT PERMITTED WITHOUT ADDITIONAL TESTING.
3. THE LOT SHOWN HEREON COMPLIES WITH THE MINIMUM OWNERSHIP WIDTH AND LOT AREA AS REQUIRED BY THE MARYLAND STATE DEPARTMENT OF THE ENVIRONMENT.
4. ALL WELLS AND SEPTIC SYSTEMS WITHIN 100' OF THE PROPERTY BOUNDARIES AND ALL EXISTING OR PROPOSED WELLS LESS THAN 200' DOWN/GRADIENT OF A SEPTIC SYSTEM AND/OR SEPTIC EASEMENT.
5. ALL HOUSE SITES SHOWN COMPLY WITH MINIMUM BUILDING RESTRICTION REGULATIONS.
6. TOPOGRAPHY SHOWN IS FROM HOWARD COUNTY GIS TOPOGRAPHY AT 2' CONTOUR INTERVAL.
7. BOUNDARY OUTLINE BASED ON AVAILABLE DEED OF RECORD WITHOUT THE THE BENEFIT OF A FIELD SURVEY AT THIS TIME.
8. ANY CHANGES TO A PRIVATE SEWAGE DISPOSAL AREA SHALL REQUIRE A REVISED PERC CERTIFICATION PLAN
9. PLAT REFERENCE 4170.

PERC CERTIFICATION  
I certify that the locations shown hereon are based on field locations done under my direct supervision and are correct to the best of my professional knowledge and belief.

*Frank J. Manalansan II*  
Signature of Professional Land Surveyor  
Frank J. Manalansan II, Professional Land Surveyor No. 21476 Expires 07/14/23

3/1/22  
Date

APPROVED FOR PRIVATE WATER AND PRIVATE SEWERAGE SYSTEMS,  
HOWARD COUNTY HEALTH DEPARTMENT.

\_\_\_\_\_  
COUNTY HEALTH OFFICER

\_\_\_\_\_  
DATE

**PERC CERTIFICATION PLAT**  
**5237 KALMIA DRIVE**

TAX MAP #27      GRID: 17      PARCEL: 127  
5TH ELECTION DISTRICT      HOWARD COUNTY, MARYLAND  
SCALE: 1"=50'      DATE: FEBRUARY 20, 2022