

Recorded
4/5/73
9:30

3/27/73 - Plot
4-1x1/2
100 ft. apart
on 10,000 ft.

APPLICATION

A 18144

P _____

SEWAGE DISPOSAL TESTING

STATE OF MARYLAND - DEPARTMENT OF HEALTH AND MENTAL HYGIENE

DISTRICT 5

DATE 3/27/73

HOWARD COUNTY HEALTH DEPARTMENT
ENVIRONMENTAL HEALTH SERVICES
P. O. BOX 476, ELLICOTT CITY, MARYLAND 21043
TELEPHONE: 465-5000, EXT. 356

TO: THE COUNTY HEALTH OFFICER
ELLICOTT CITY, MARYLAND

I, HEREBY, APPLY FOR THE NECESSARY TEST IN ORDER TO CONSTRUCT (OR RECONSTRUCT) A SEWAGE DISPOSAL SYSTEM.

PROPERTY OWNER // Donald L. Simpson

ADDRESS 11300 Johns Hopkins Road, Clarksville, Md. PHONE 725-2847

PROPERTY LOCATION:

SUBDIVISION _____ LOT NO. _____

ROAD AND DESCRIPTION Johns Hopkins Road - approx. 2800 ft. in off Sanner Road

SIZE OF LOT approx. 85 acres TYPE BLDG. 3

NUMBER OF BEDROOMS
(Single Fmly. Dwllg.)

IF NOT SINGLE RESIDENCE DESCRIBE _____

THE SYSTEM INSTALLED UNDER THIS APPLICATION IS ACCEPTABLE ONLY UNTIL PUBLIC FACILITIES BECOME AVAILABLE.

SIGNATURE OF APPLICANT Donald L. Simpson

APPROVED BY _____ FOR _____ DATE _____
(KIND OF SYSTEM)

REJECTED BY _____ FOR _____ DATE _____
(KIND OF SYSTEM)

HOLD PENDING FURTHER TESTS _____ DATE _____

REASONS FOR REJECTION OR HOLDING _____

THIS IS NOT A PERMIT

INDICATE NORTH. - NAME ADJOINING ROADWAY AS BASE LINE.

DATE	TEST NO.	DEPTH	PRE-WET		TEST - 1" DROP		TIME
			START	STOP	START	STOP	

REMARKS _____

TYPE OF SOIL _____

TESTED BY _____ ALSO PRESENT: _____

APPLICATION

A 182.44

SEWAGE DISPOSAL TESTING

P _____

STATE OF MARYLAND - DEPARTMENT OF HEALTH AND MENTAL HYGIENE

HOWARD COUNTY HEALTH DEPARTMENT
ENVIRONMENTAL HEALTH SERVICES
P. O. BOX 476, ELLICOTT CITY, MARYLAND 21043
TELEPHONE: 465-5000, EXT. 356

DISTRICT 5

DATE 3/27/73

TO: THE COUNTY HEALTH OFFICER
ELLICOTT CITY, MARYLAND

I, HEREBY, APPLY FOR THE NECESSARY TEST IN ORDER TO CONSTRUCT (OR RECONSTRUCT) A SEWAGE DISPOSAL SYSTEM.

PROPERTY OWNER // Donald L. Simpson

ADDRESS 11300 Johns Hopkins Road, Clarksville, Md. PHONE 725-2847

PROPERTY LOCATION:

SUBDIVISION _____ LOT NO. _____

ROAD AND DESCRIPTION Johns Hopkins Road - approx. 2800 ft. in off Sanner Road

SIZE OF LOT approx. 35 acres TYPE BLDG. 3

NUMBER OF BEDROOMS
(single only, dwlg.)

IF NOT SINGLE RESIDENCE DESCRIBE _____

THE SYSTEM INSTALLED UNDER THIS APPLICATION IS ACCEPTABLE ONLY UNTIL PUBLIC FACILITIES BECOME AVAILABLE.

SIGNATURE OF APPLICANT Donald L. Simpson

APPROVED BY _____ FOR _____ DATE _____
(KIND OF SYSTEM)

REJECTED BY _____ FOR _____ DATE _____
(KIND OF SYSTEM)

HOLD PENDING FURTHER TESTS _____ DATE _____

REASONS FOR REJECTION OR HOLDING _____

THIS IS NOT A PERMIT

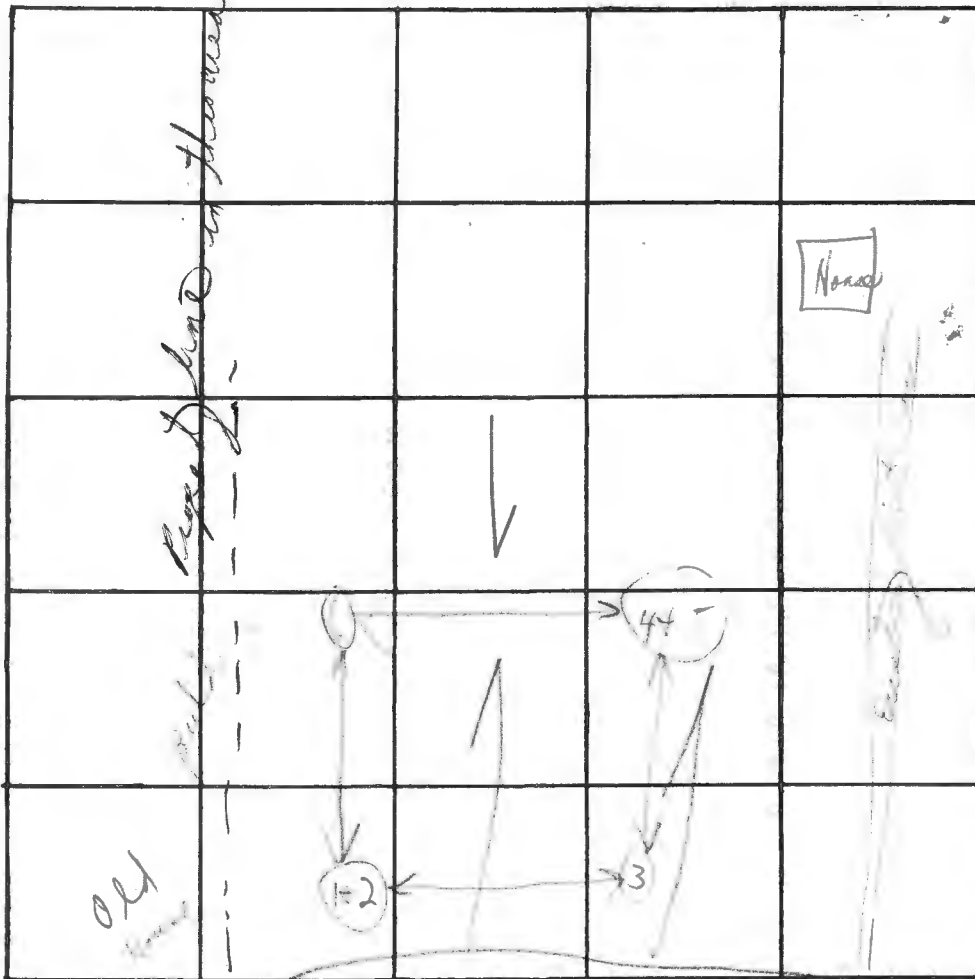

INDICATE NORTH. - NAME ADJOINING ROADWAY AS BASE LINE.

John Hopkins Rd

DATE	TEST NO.	DEPTH	PRE-WET		TEST - 1" DROP		TIME
			START	STOP	START	STOP	
9/5/72	1	-1	10:24	10:29	10:29	10:41	12 min
	2	11'	10:25	10:30	10:30	10:40	10 min
	3	10 1/2'	Visual hole moisture				similar 1+2
	4	4' S	10:33	10:51	10:51	11:18	27 min
	5	11' D	10:32	10:48	10:48	11:16	28 min
	6	10 1/2'	Visual hole moisture				similar to 4+5

similar 1+2
similar to 4+5

(Use 4+5)

REMARKS

Center of pole corn field
Mesa + sand

TYPE OF SOIL

TESTED BY

B. Street

ALSO PRESENT:

Fyock + Co