

A/P

8029

283K Brown
Sch Red 0.8

Red Brown
Sch
5-10%
Ry 2'

Red Brown
yellow
Sh 8'

Red Brown
yellow
5-10% Ry
med. Sh 13'

Rock
rope @ 8'
m left
side

8027

Brown Grey
Red Sch 0.8

Red Brown
Sch 5-10% Ry 2'

Red Brown
Mech Mica
Platy Sheets
of Soil
Medium
Sh 8'

Red Brown
yellow
F Sh 13'

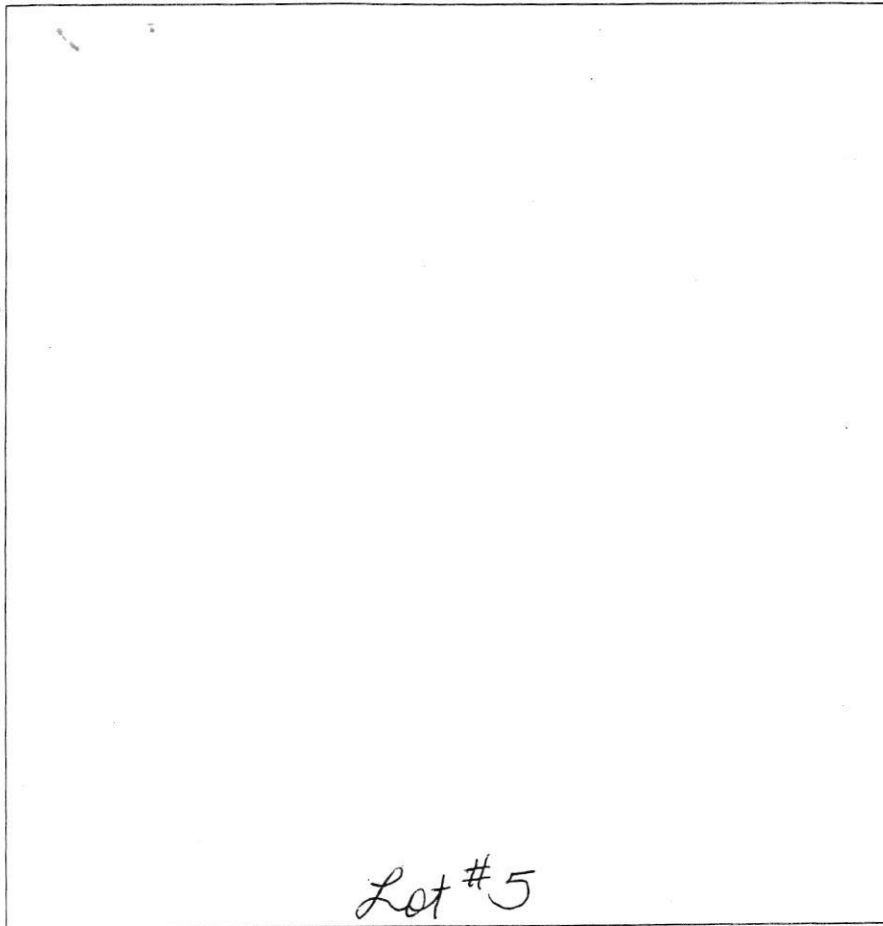

Lot #5

DATE	TEST #	DEPTH	START	BREAK 1" DROP	STOP 2" DROP	TIME OF 2ND INCH	P/F/H
2-20-13	8029	3/13	11:34	11:37	11:41	5min	P
2-20-13	8027	13	Usual Pass				P

REMARKS

SANITARIAN DBernard BACKHOE Chuck OTHERS Jeremy

TEST HOLES USED IN SDA _____ AVG. PERC TIME _____ SQ. FT/BR _____

TRENCH WIDTH _____ INLET DEPTH _____ MAX. BOT DEPTH _____ EFFECTIVE SW _____

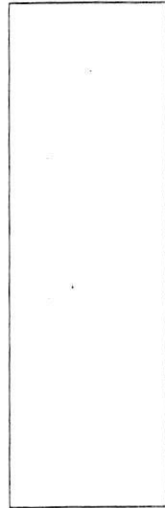

A/P _____

8016
 dk brn
 2
 25' gritty
 sel / cbbk
 yellow
 sl saprolite
 5'
 yellow
 gritty ls / sl
 lmsbk
 8'
 yellow
 15 15%
 HB rx
 10'

8016-A
 1' brn l
 cbbk
 1' org sel
 lmsbk
 3' org brn
 sl saprolite
 4.5'
 yellow / org
 cl / fbbk
 ~8.5'
 yellow
 ls
 20% rx
 12'
 ↓

8028
 2'-3' yellow
 bl sl
 5' yellow
 sel / fbbk
 yellow
 sl saprolite
 ↓
 14' yellow
 15 15% rx

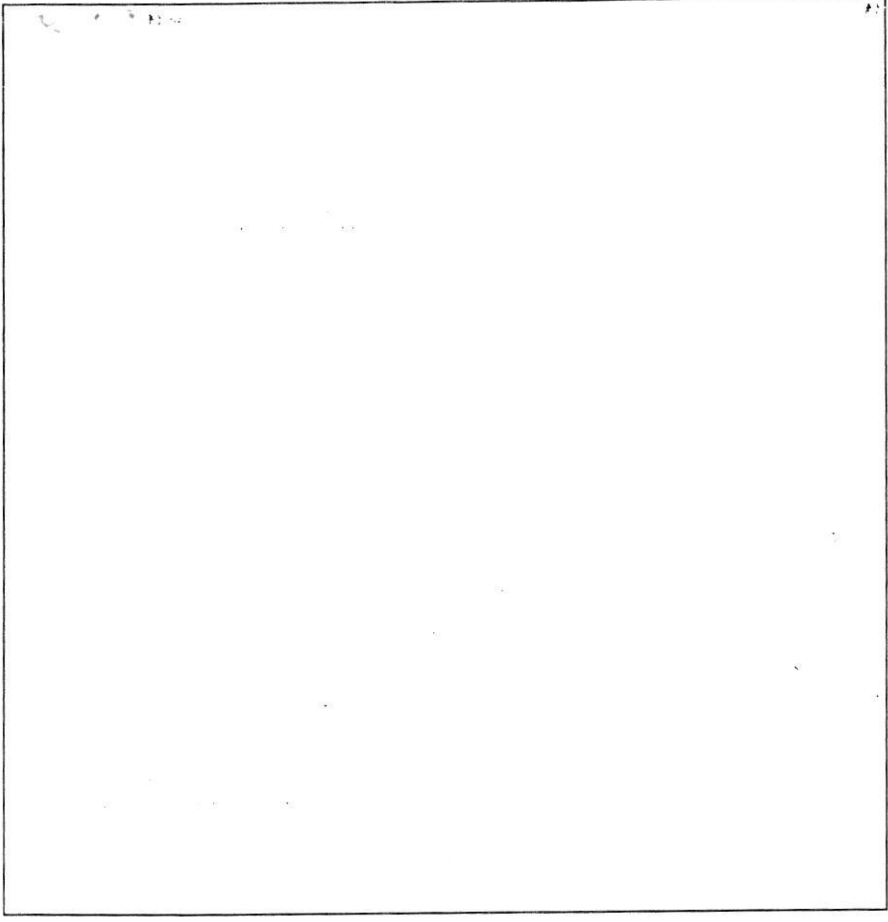

8025
 brn l 8"
 org brn
 sel / cbbk 3.5'
 yellow
 sl lmsbk
 10% stones 5.5'
 yellow
 fbbk 15%
 rx f. saprolite
 yellow
 ch sl ↓
 stony
 beige ls 12'
 8026
 1' root mass brn l
 3' yellow brn sel
 fbbk
 brn bl
 saprolite 5'
 brn f. l
 saprolite
 & 15% rx 9.5'
 brn
 micaceous
 ls 12'

DATE	TEST #	DEPTH	START	BREAK 1" DROP	STOP 2" DROP	TIME OF 2ND INCH	P/F/H
2/20/13	8016	4' / 10'	9:40:00	9:40:50	9:41:44	< 2	
	repair		9:42:28	9:43:26	9:44:37	1:10	F
2/20/13	8016A	4' / 12'	10:09:45	10:11:45	10:14:26	3	P
	8028	5' / 14'	11:45:20	12:08	1:36	28	P
	8025	4.5' / 12'	11:58	12:03	12:08	5	P
	8026	4.5' / 12'	1:16	1:20	1:24	4	P

REMARKS 8025, 8026, 8028 dug per plan. Lot 4 & Lot 5
 SANITARIAN WJ/HJS BACKHOE Chuck OTHERS Jeremy
 TEST HOLES USED IN SDA _____ AVG. PERC TIME _____ SQ. FT/BR _____
 TRENCH WIDTH _____ INLET DEPTH _____ MAX. BOT DEPTH _____ EFFECTIVE SW _____