

Approved RAC
6/3/2022
HD-

Record Detail * (This section is required.)

Permit Type	Permit Number	Opened Date
Building/Residential/Misc/Pool Spa	B22001505	04/22/2022
Description of Work		
SFD/ INSTALL in-ground 900 sq. ft. concrete pool, 3.5 to 6.5' foot depth with filter cartridge to be filled by truck. With automatic pool safety cover and fence TO CODE		

[check spelling](#)

Address * (This section is required.)

Search Reset Clear Get Parcel & Owner

Street #	Street Name	Street Type	
15313	LEONDINA	DR	
Unit Type	Unit #	X Coordinate	Y Coordinate
--Select--		-77.04853	39.26964
City	State	Zip Code	Primary
GLENWOOD	MD	21738	Yes

Parcel * (This section is required.)

Search Reset Clear Get Address & Owner

GIS ID *	Parcel	Parcel Area	Land Value	Improved Value	Exemption Value	Plan Area
895881	225	1.24	207400	1228800	1021400	RURAL
Legal Description						
IMPSLOT 20 1.246 A[]15313 LEONDINA DR[]VINEYARDS @ CATTAIL CREE						

[check spelling](#)

Block	Lot	Census Tract	Council Dist	Inspection Dist	Supervisor Dist	Map #	DAP Zone
	20	605601	5				
Plan Area	State Tax Id		Subdivision Name				
	1404366069		VINEYARDS AT CATTAIL CRE				
Section	Area		Tax Map				
			21				
Grid	Zoning District		ADC Map				
21-8	RC-DEO		4812-C7				
SDP No.	Final Plan No.		WP File No.				
	F-00-068						
Record Plat No.	WS Contract No.		FDP No.		Primary		
14835					Yes		
Owner Occupied	Year Built		Historic District				
<input type="radio"/> Yes <input type="radio"/> No	2008		<input type="radio"/> Yes <input checked="" type="radio"/> No				
Historic District Registry No.	Stat Area		Flood Plain				
	4-08		<input type="radio"/> Yes <input checked="" type="radio"/> No				
Building No							

Owner * (This section is required.)

Search Reset Clear

Name *

SHARIFF ZAIGHAM H

Address Line 1

15313 LEONDINA DR

Address Line 2

Address Line 3

Mail City

GLENWOOD

Mail State

MD

Mail Zip Code

21738

Phone

410-686-2701

Primary

Yes

E-mail

Cell Number

Fax Number

Professionals (This section is not required.)

Search Reset Clear

License # *

Business Name

08010071753 HERITAGE ELITE LLC
 License Type * MHIC Ind
 Primary No
 First Name MICHAEL Middle Name RAYMOND Last Name SHAFFERY
 Address Line 1 8335 PULASKI HWY
 Address Line 2
 City BALTIMORE State MD ZIP Code 21237-0000
 Phone 1 4108086988 Phone 2 Fax 4437037152
 E-mail MIKE@ELITEPOOLS.COM

Applicant (This section is not required.)

Search As Owner As Lic. Prof As Contact

Type * Applicant
 Relationship --Select--
 Primary Yes
 First Name Scott MI Last Name Swenson
 Full Name Scott Swenson
 Organization Name Elite Pools
 Street Address 8335 Pulaski Highway
 Address Line 2
 City Baltimore State MD Zip Code 21237
 Phone 410-494-7946 Cell Fax
 E-mail scott@elitepools.com

Addtl Info

Est Construction Cost * 45000
 Housing Units * 0
 Number of Buildings * 0
 Public Owned No
 Construction Type --Select--

POOL INFORMATION

MISCELLANEOUS POOL INFORMATION

Capital Project-No Fee * Yes No
 Capital Project Number
 Fee Exempt * Yes No
 Water Supply * Private Sewage Disposal * Private
 Existing Use --Select-- Type of Pool or Spa * In Ground Pool
 Pool Safety Device * Automatic Pool Cover Electrical Permit Number
 Expiration Date 10/24/2022

PAYMENT INFORMATION

Check 1 Payee 1 SAP Doc No SAP Entered

Related Records

Showing 1-2 of 2

Permit Number	Record Type Alias	Status	Number	Street Name	Opened Date	Description
B22001505	Residential Pool or Spa Permit	Incomplete	15313	LEONDINA	04/22/2022	SFD/INSTALL In-ground 900 sq. ft. concrete pool, 3.5 to

Submit Cancel

Elite Pools

400 EAST FRANK STREET, SUITE 400
BALTIMORE, MARYLAND 2102
410-434-7346 OFFICE
800-333-3333 SALES
WWW.ELITEPOOLS.COM

SHARIFF RESIDENCE

15313 LEONIDINA DRIVE

NO.	REVISIONS	DATE
1	REVISIONS	5/13/21
2	REVISIONS	4/13/21
3	REVISIONS	

REVISED POOL
FOR PERMIT

DATE 02/04/2021

SCALE 3/4"=1'-0"

SHEET
L1

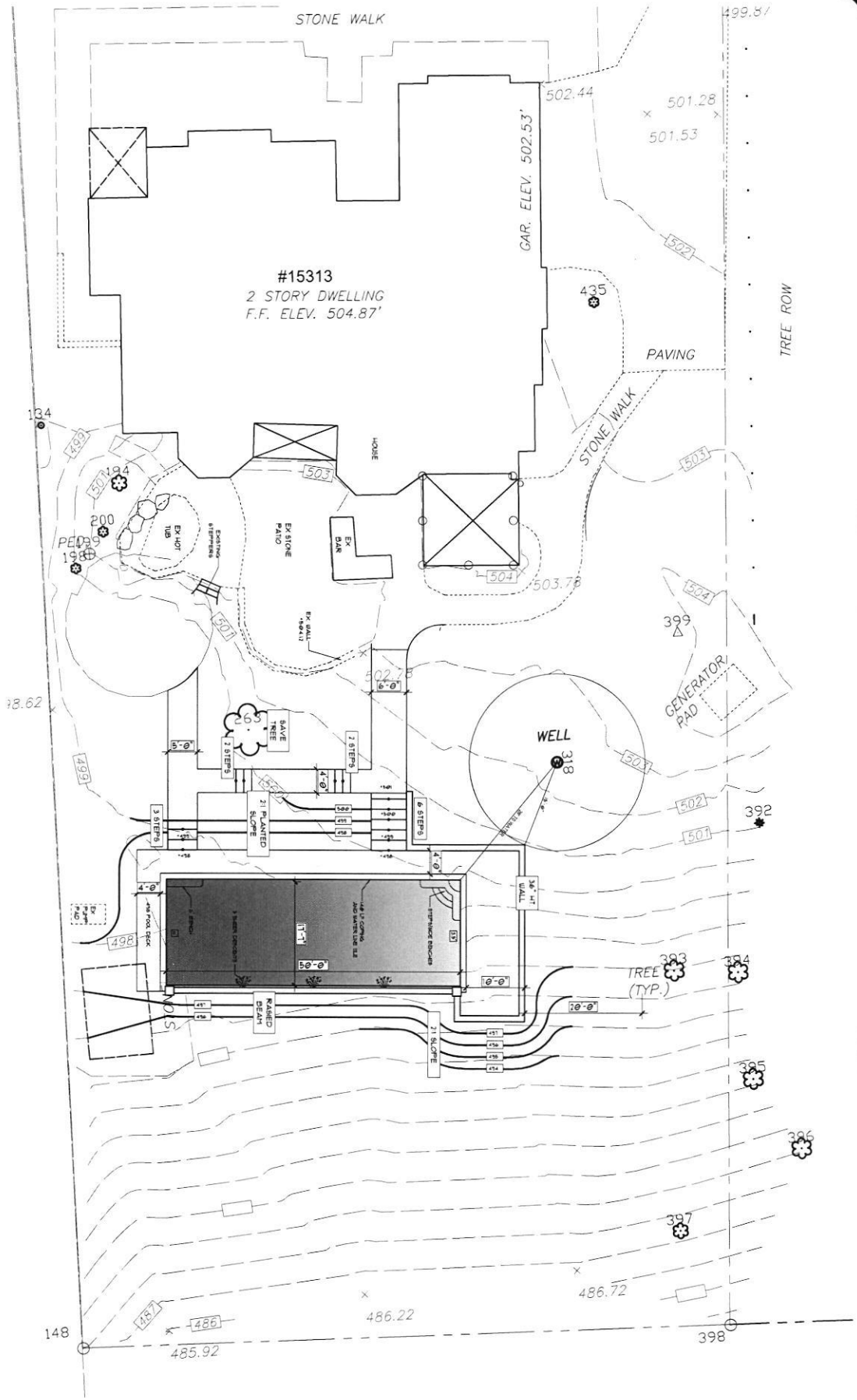

GRID NORTH
 MARYLAND COORDINATE SYSTEM NAD83(2011)
 VERTICAL DATUM NAVD83
 PER TOPCON LITE OPS NETWORK

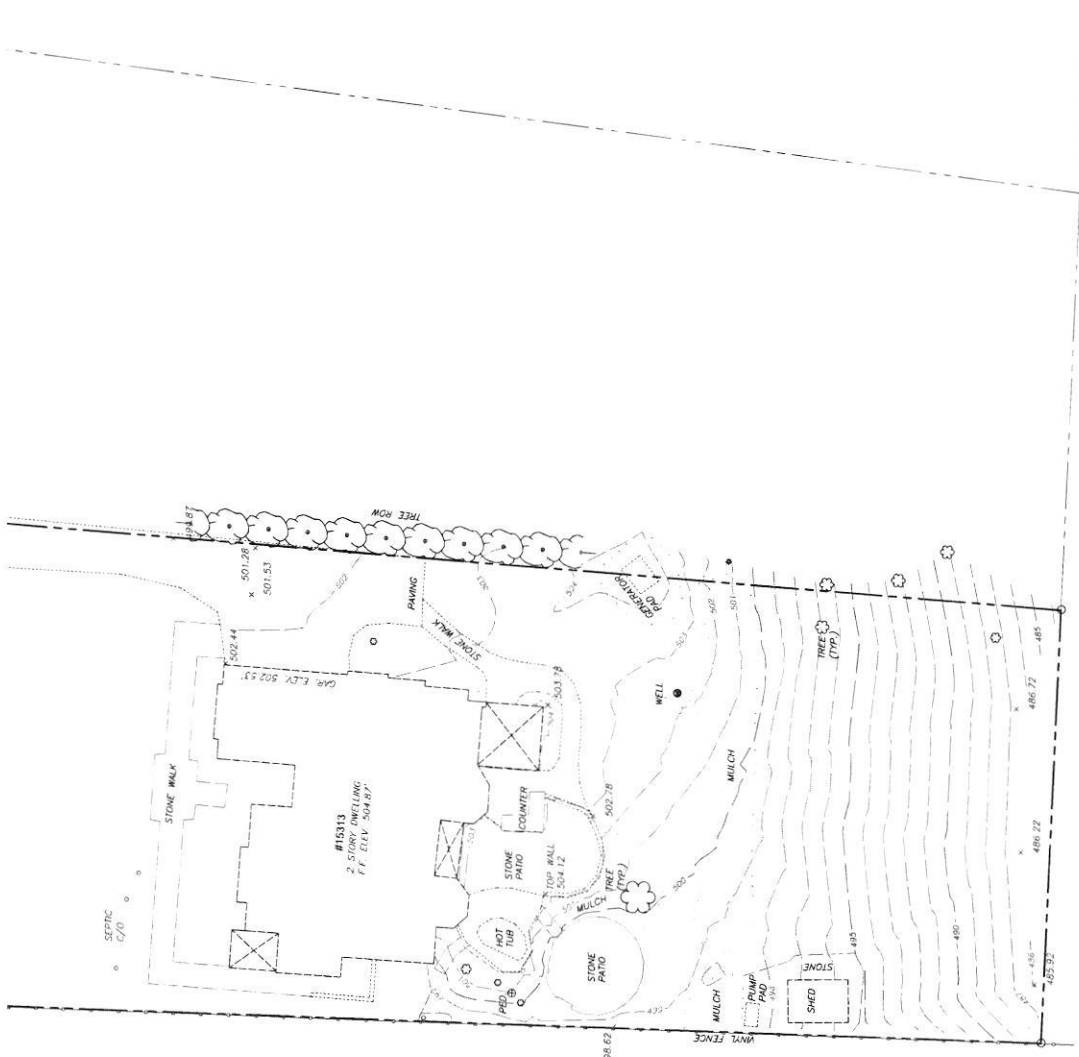

TOPOGRAPHIC SURVEY
 #15313 LEONDINA DRIVE

4TH ELECTION DISTRICT
 HOWARD COUNTY, MARYLAND
 DRAWN BY: JRB
 DATE: FEB. 18, 2022
 CHECKED BY: JRB
 JOB NO.: 22021



GRAPHIC SCALE
 1" = 20'



02/18/2022

JOHN N. BECHER
 PROFESSIONAL LAND SURVEYOR #14687
 STATE OF MARYLAND
 I HEREBY CERTIFY TO MY BEST KNOWLEDGE AND BELIEF THAT THIS SURVEY MADE ON THE
 GROUND UNDER MY DIRECT SUPERVISION FEBRUARY 18, 2022 IS IN ACCORDANCE WITH THE
 REQUIREMENTS SET FORTH IN CHAPTER 6 REGULATION 0.12 OF THE MINIMUM STANDARDS OF
 PRACTICE FOR PROFESSIONAL LAND SURVEYORS IN THE STATE OF MARYLAND
 NO INVESTIGATION OF UNDERGROUND UTILITIES WAS PERFORMED FOR THIS SURVEY
 OWNER/CONTRACTOR TO VERIFY ALL UTILITIES PRIOR TO CONSTRUCTION

SITE INSPECTION SHEET

OWNER: Zack Shariff PHONE #: 410-686-2701
ADDRESS: 15313 Leondina Dr. CONTRACTOR: Heritage Elite LLC
Glenwood, MD, 21738 WELL TAG #: HO-95-0095
SUBDIVISION: Vineyards @ Cattail Creek LOT: 20 COUNTY #: 04 366069
PROPOSAL: Install 900 sqft inground pool (concrete)

LOCATION DIAGRAM

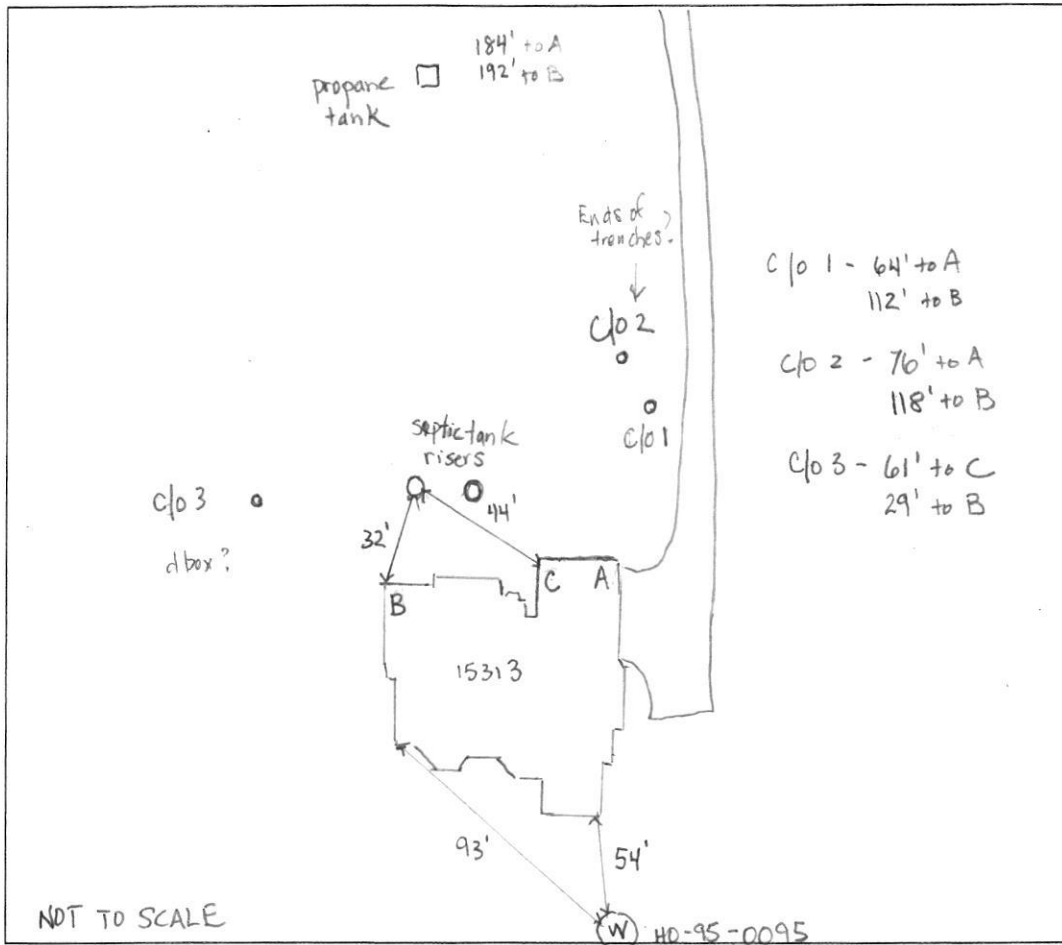

COMMENTS: SDA looks ok, well satisfactory, 2 piece tight cap w/ conduit tight and in place w/ tag #. Well already GRS located. RAE

DATE: 5/16/22 INSPECTOR: R. Rappaport

15313 Leonding Drive

5/16/2022

AM

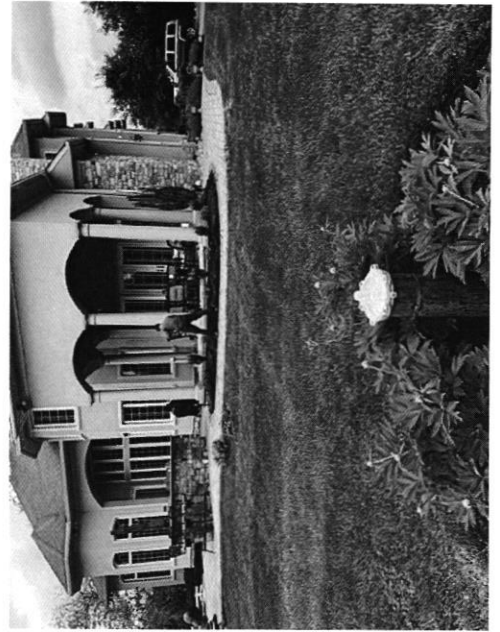
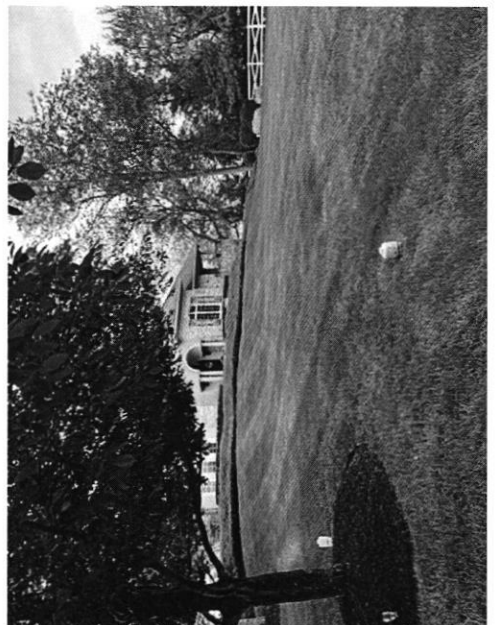
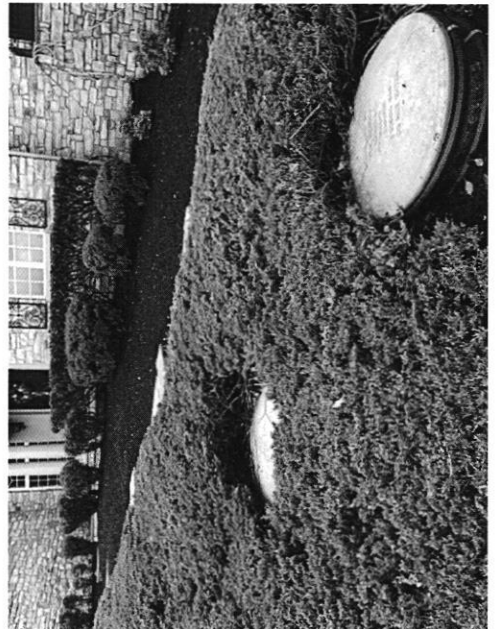
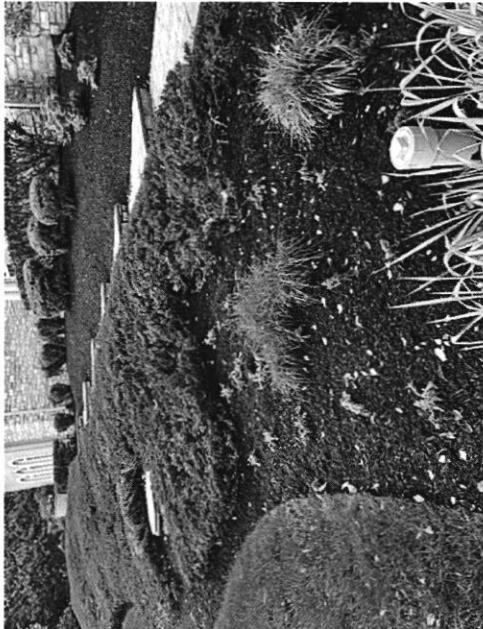

Please

Include
w/ IBP

PDF

(Everything in
Rperclip)



Real Property Data Search ()
 Search Result for HOWARD COUNTY

[View Map](#)

[View GroundRent Redemption](#)

[View GroundRent Registration](#)

Special Tax Recapture: None

Account Identifier: District - 04 Account Number - 366069

Owner Information

Owner Name: SHARIFF ZAIGHAM H Use: RESIDENTIAL
 MAGI LOUANN Principal Residence: YES
 Mailing Address: 15313 LEONDINA DR Deed Reference: /15241/ 00481
 GLENWOOD MD 21738-9662

Location & Structure Information

Premises Address: 15313 S LEONDINA DR Legal Description: LOT 20 1.246 A
 GLENWOOD 21738-0000 15313 LEONDINA DR
 VINEYARDS @ CATTAIL CREE

Map: Grid: Parcel: Neighborhood: Subdivision: Section: Block: Lot: Assessment Year: Plat No: 14835
 0021 0008 0225 4010103.14 1303 20 2020 Plat Ref:

Town: None

Primary Structure Built Above Grade Living Area Finished Basement Area Property Land Area County Use
 2008 5,487 SF 2700 SF 1.2400 AC 000000

StoriesBasementType Exterior QualityFull/Half BathGarage Last Notice of Major Improvements
 2 YES STANDARD UNITSTUCCO/6 4 full/ 2 half 1 Attached

Value Information

	Base Value	Value As of 01/01/2020	Phase-in Assessments	
			As of 07/01/2021	As of 07/01/2022
Land:	289,900	207,400		
Improvements	860,100	1,021,400		
Total:	1,150,000	1,228,800	1,202,533	1,228,800
Preferential Land:	0	0		

Transfer Information

Seller: SHARIFF ZAIGHAM H	Date: 09/25/2013	Price: \$0
Type: NON-ARMS LENGTH OTHER	Deed1: /15241/ 00481	Deed2:
Seller: MANNARELLI MARIO F SR	Date: 07/17/2006	Price: \$675,000
Type: ARMS LENGTH IMPROVED	Deed1: /10125/ 00056	Deed2:
Seller:	Date:	Price:
Type:	Deed1:	Deed2:

Exemption Information

Partial Exempt Assessments:	Class	07/01/2021	07/01/2022
County:	000	0.00	
State:	000	0.00	
Municipal:	000	0.00 0.00	0.00 0.00

Special Tax Recapture: None

Homestead Application Information

Homestead Application Status: Approved 10/28/2014

Homeowners' Tax Credit Application Information

Homeowners' Tax Credit Application Status: No Application Date:

Lot 20, 15313 Leondine Ct. was Lot 13
in 94' ~~width~~, Lot 24 in 96' ~~width~~

Original Test Plan of 1994

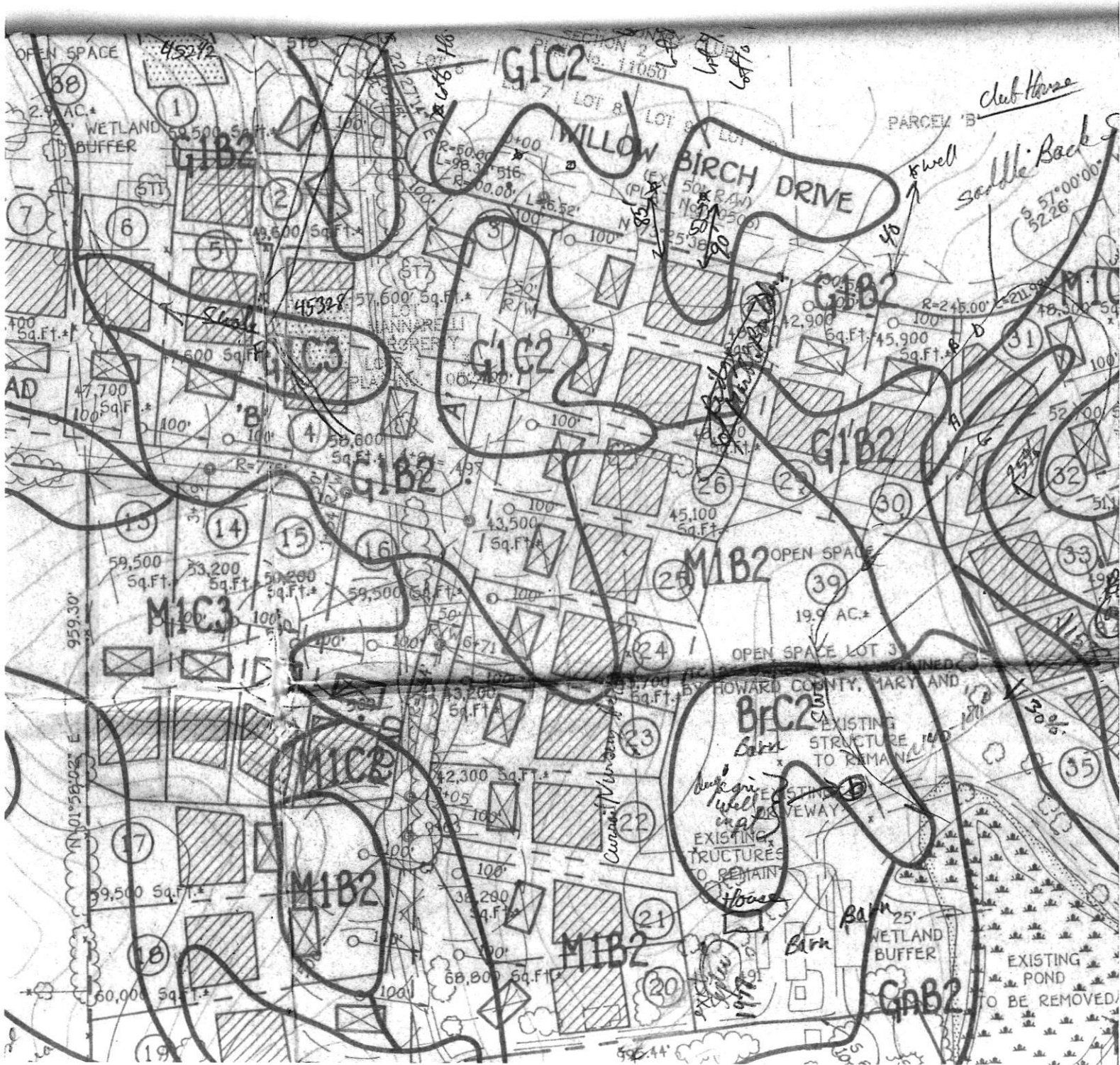

Test Back
near
LOT #11

LOT 16

9/8/94 Note
Good soil 4 1/2" 4'-10"

11	4'-10"	10:10	10:11	10:13	2 min
	10'-10"		LOAM		
12	4'-3"	10:14	10:16	10:26	10 min
	10 1/2'		"LOAM" 95	(590 sandstone)	

More hole due to rock along what

HOWARD COUNTY HEALTH DEPARTMENT
BUREAU OF ENVIRONMENTAL HEALTH
10000 ELLICOTT MILLS DRIVE, ELLICOTT CITY, MARYLAND 21114
PHONE 302-834-3343

I HEREBY APPLY FOR THE NECESSARY TEST PLAT TO APPLY TO THE PERMIT FOR INSTALLATION OF SEWER SERVICE TO THE PROPERTY DESCRIBED BY THIS PERMIT.

Facts
of
lots
13, 14, 15
at 13' on
6' in with
at 11' 6"

Thursday Hole

9/8/94 #13	5'	10:31	10:33	10:35	2+ min
	11'		(LOAM)		
on LOT 15	5'	10:38	10:39	10:41	2+ min
14	10' 4"		(LOAM)		
15	4' 9"	10:48	10:50	10:52	2 min
on LOT 13	10 1/2'		LOAM		
16	4' 8"	12:21	12:23	12:25	2 min
	10'		LOAM		

(Wanted for test hole to be dug 9/8/93)

APPROVED BY _____ DATE _____
DISAPPROVED BY _____ DATE _____
HOLD PENDING FURTHER TESTS _____
READY FOR REJECTION OR HOLDING _____
PROBATION TEST PLAT/RELIQUARY PLAT _____ DATE _____
SITE DEVELOPMENT PLAN/FINAL PLAT - TIME _____ DATE _____

THIS IS NOT A PERMIT

102250

In Excel

COUNTY # 28773
SOIL PROFILE

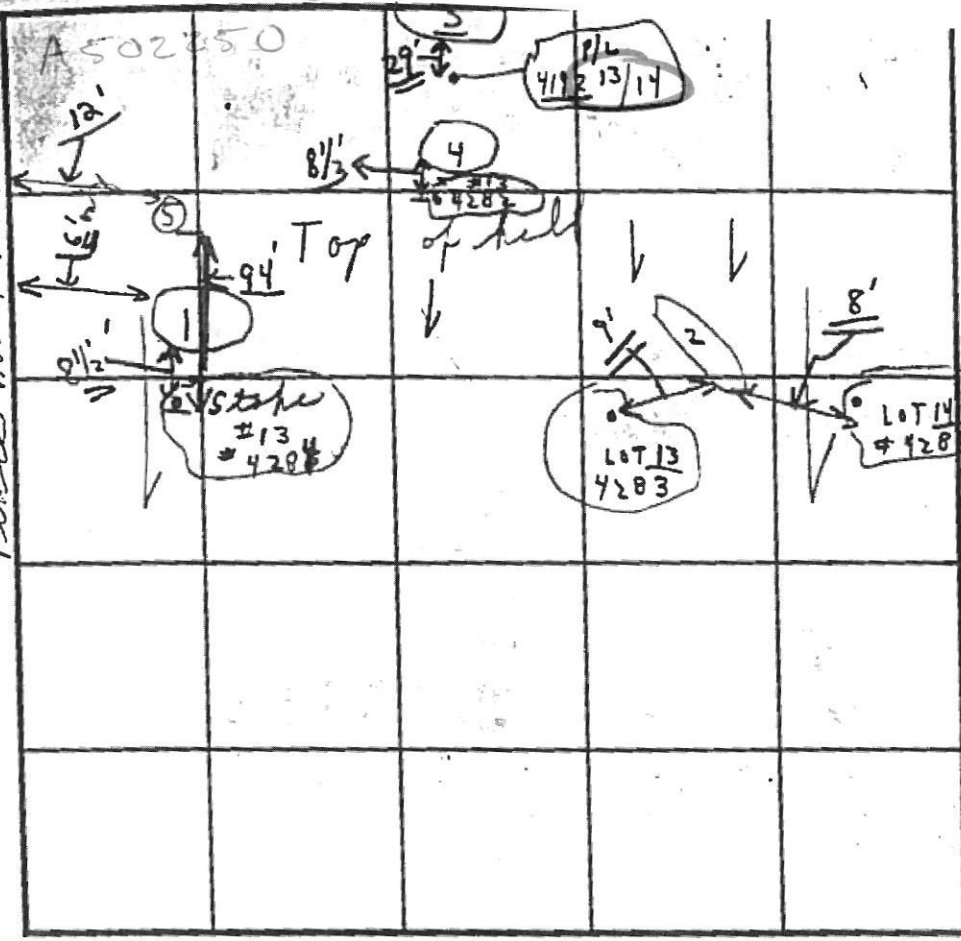

SOIL PROFILE

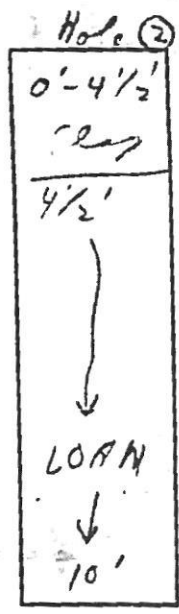
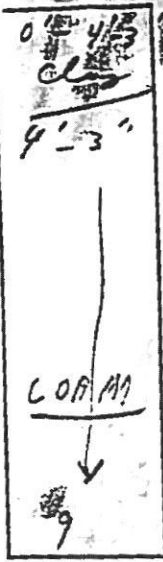
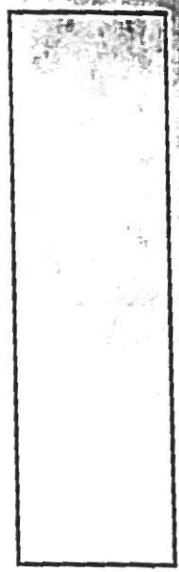

INDICATE NORTH - NAME ADJOINING ROADWAY AS BASE LINE.

DATE	TEST NO.	DEPTH	PRE-WET		TEST - 1" DROP		TIME
			START	STOP	START	STOP	
9/17/94	(1)	4' 3"	1:32	1:33	1:33	1:35	2 m
Wed	4284	9'		LOAM			=
(P.M.)	(2)	4 1/2'	1:27	1:29	1:29	1:31	2 m
	# 4283 4280	10'		LOAM			
	(3)	4 1/2'	2:19	2:20	2:20	2:22	2 m
	4192	10'		(LOAM)			=
	(4)	4 1/2'	2:25	2:26	2:26	2:28	2 m
	4282	9 1/2'		25% LOAM		30% ROCK	
	(5)	4 1/2'	3:21	3:22	3:22	3:24	1 1/2 m
		10'		LOAM			

REMARKS Tests in open Tests near stake

TYPE OF SOIL LOAM

TESTED BY *CB* ALSO PRESENT *Mark King*

TRENCH DESIGN DATA: AVERAGE PERCOLATION TIME _____ TRENCH WIDTH _____

INLET DEPTH _____ MAXIMUM BOTTOM DEPTH _____ SQ. FT./BEDROOM _____

shallow system 1/2" backflow preventer

APPLICATION

PERCOLATION TESTING

A 50225P

P _____

HOWARD COUNTY HEALTH DEPARTMENT
BUREAU OF ENVIRONMENTAL HEALTH
3525-H ELLICOTT MILLS DRIVE/ELLICOTT CITY, MARYLAND 21043
TELEPHONE: 313-2640

DISTRICT _____

DATE _____

TO: THE COUNTY HEALTH OFFICER
ELLICOTT CITY, MARYLAND

I HEREBY APPLY FOR THE NECESSARY TEST PRIOR TO APPLICATION FOR PERMIT TO CONSTRUCT (OR RECONSTRUCT) A SEWAGE DISPOSAL SYSTEM.

PROPERTY OWNER Mario Manorell

ADDRESS C/O Land Design + Development
1205 Hickory Ridge Rd PHONE 741-2100

AGENT OR PROSPECTIVE BUYER Mara Reich

ADDRESS _____ PHONE _____

PROPERTY LOCATION:

SUBDIVISION Vineyards at Cattail Creek LOT NO. 1483 (21)
~~13, 14, 15, 16~~

ROAD AND DESCRIPTION Route 97

TAX MAP 21 PARCEL # 2, 132, 220 + 211

SIZE OF LOT 1 + acres TYPE BLDG. SFD
(SINGLE FAMILY DWELLING OR COMMERCIAL)

THE SYSTEM INSTALLED UNDER THIS APPLICATION IS ACCEPTABLE ONLY UNTIL PUBLIC FACILITIES BECOME AVAILABLE. I FULLY UNDERSTAND THE FEE CONNECTED WITH THE FILING OF THIS PERC TEST APPLICATION IS NON-REFUNDABLE UNDER ANY CIRCUMSTANCES. I ALSO AGREE TO COMPLY WITH ALL M.O.S.H.A. REQUIREMENTS IN TESTING THIS LOT. Mara Reich
(SIGNATURE OF APPLICANT)

APPROVED BY _____ FOR _____ DATE _____

DISAPPROVED BY _____ FOR _____ DATE _____

HOLD PENDING FURTHER TESTS _____

REASONS FOR REJECTION OR HOLDING _____

PERCOLATION TEST PLAT/PRELIMINARY PLAT - TITLE OR I.D. # Vineyards at cc SP-96-11 DATE 2-28-96

SITE DEVELOPMENT PLAN/FINAL PLAT - TITLE OR I.D. # _____ DATE _____

THIS IS NOT A PERMIT

C1 6683

(MDE USE ONLY)

STATE OF MARYLAND WELL COMPLETION REPORT FILL IN THIS FORM COMPLETELY PLEASE TYPE

THIS REPORT MUST BE SUBMITTED WITHIN 45 DAYS AFTER WELL IS COMPLETED.

COUNTY NUMBER 13 A50225-C

1 2 3 6 (THIS NUMBER IS TO BE PUNCHED IN COLS. 3-6 ON ALL CARDS)

ST/CO USE ONLY

DATE RECEIVED

MM OCT 19 13

DATE WELL COMPLETED

MM 10 05 DD 7 YY 05

Depth of Well

22 300 26 (TO NEAREST FOOT)

PERMIT NO. FROM "PERMIT TO DRILL WELL" HO-95-0095

OWNER Mannarelli Mario STREET OR RFD 15313 Leondina Drive TOWN Glenwood SUBDIVISION Vineyards at Cattail Creek SECTION LOT 20

WELL LOG

Not required for driven wells

STATE THE KIND OF FORMATIONS PENETRATED, THEIR COLOR, DEPTH, THICKNESS AND IF WATER BEARING

Table with columns: DESCRIPTION, FEET (FROM, TO), check if water bearing. Rows include Brown shale, Gray Limestone, Dryholes (Cement, Rock cuttings).

GROUTING RECORD

WELL HAS BEEN GROUTED (Y) NO (N) TYPE OF GROUTING MATERIAL (Cement, Bentonite Clay) NO. OF BAGS, NO. OF POUNDS, GALLONS OF WATER, DEPTH OF GROUT SEAL

CASING RECORD

MAIN CASING TYPE (ST, PL, CO, OT) Nominal diameter top (main) casing, Total depth of main casing

OTHER CASING (if used)

Table for OTHER CASING with columns: diameter inch, depth (feet) from, to

SCREEN RECORD

screen type or open hole (ST, BR, HO, PL, OT) insert appropriate code below

DEPTH (nearest ft.)

Table for DEPTH with columns: 1-21, 23-36, 38-51, SLOT SIZE 1-3, DIAMETER OF SCREEN

GRAVEL PACK IF WELL DRILLED WAS FLOWING WELL INSERT F IN BOX 68

MDE USE ONLY (NOT TO BE FILLED IN BY DRILLER) T (E.R.O.S.) W Q

TELESCOPE CASING LOG INDICATOR OTHER DATA

C 3

PUMPING TEST

HOURS PUMPED (nearest hour) 03 PUMPING RATE (gal. per min.) 20 METHOD USED TO MEASURE PUMPING RATE 1946 WATER LEVEL (distance from land surface) BEFORE PUMPING 54 WHEN PUMPING 62 TYPE OF PUMP USED (for test) S submersible

PUMP INSTALLED

DRILLER INSTALLED PUMP YES (NO) IF DRILLER INSTALLS PUMP, THIS SECTION MUST BE COMPLETED FOR ALL WELLS. TYPE OF PUMP INSTALLED PLACE (A,C,J,P,R,S,T,O) IN BOX 29. CAPACITY: GALLONS PER MINUTE (to nearest gallon) 31 35 PUMP HORSE POWER 37 41 PUMP COLUMN LENGTH (nearest ft.) 43 47 CASING HEIGHT (circle appropriate box and enter casing height) (+) above LAND SURFACE (-) below 02 (nearest foot)

LOCATION OF WELL ON LOT

SHOW PERMANENT STRUCTURE SUCH AS BUILDING, SEPTIC TANKS, AND /OR LANDMARKS AND INDICATE NOT LESS THAN TWO DISTANCES (MEASUREMENTS TO WELL)

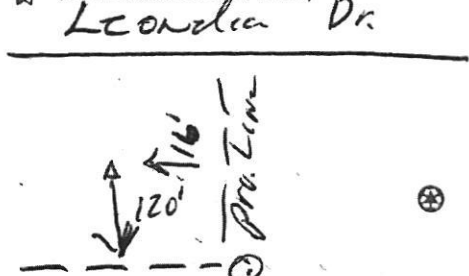

B 1 0739

SEQUENCE NO. (MDE USE ONLY)

STATE OF MARYLAND APPLICATION FOR PERMIT TO DRILL WELL

STATE PERMIT NUMBER

HO-95-0095

523127 please type

fill in this form completely

Date Received (APA) PAID 8/15
OWNER INFORMATION
manwarelli Mario
2929 Summit Circle
Ellicott City MD 21043

LOCATION OF WELL
Howard
Vineyards at Cattail Creek
Glenwood
MILES FROM TOWN 4

DRILLER INFORMATION
Allen Compton MSD009
Fogles Well Drilling
580 Obrecht rd.
8-8-05

15313
Leonidina Dr.
200 FT
TAX MAP: 21 BLK: 8 PARCEL 225

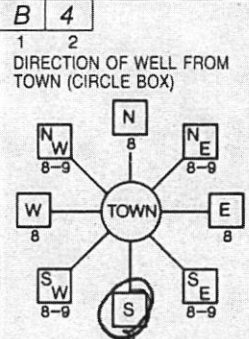

WELL INFORMATION
APPROX. PUMPING RATE 5
AVERAGE DAILY QUANTITY NEEDED 500

NOT TO BE FILLED IN BY DRILLER
HOWARD HEALTH DEPARTMENT APPROVAL
Howard 13 A50225-0
STATE SIGNATURE
DATE ISSUED 8/29/2005
CO SIGNATURE Brian Baber 8/29/2006
NORTH GRID 523 000 EAST GRID 786 000

USE FOR WATER (CIRCLE APPROPRIATE BOX)
D DOMESTIC POTABLE SUPPLY & RESIDENTIAL IRRIGATION
F FARMING (LIVESTOCK WATERING & AGRICULTURAL IRRIGATION)
I INDUSTRIAL, COMMERCIAL, DEWATERING
P PUBLIC WATER SUPPLY WELL
T TEST, OBSERVATION, MONITORING
G GEO-THERMAL

APPROXIMATE DEPTH OF WELL 300 FEET
APPROXIMATE DIAMETER OF WELL 6 INCH

SHOW MAJOR FEATURES OF BOX & LOCATE WELL WITH AN X
SOURCES OF DRILLING WATER
WRITE THE BOX NUMBER FROM THE MAP HERE
E 7806
N 5203

METHOD OF DRILLING (circle one)
BORED (or Augered) JETTED Jetted & DRIVEN
AIR-ROTARY AIR-PERCussion ROTARY (Hydraulic Rotary)
CABLE REVerse-ROTary DRive-POINT
other

REPLACEMENT OR DEEPEMED WELLS (CIRCLE APPROPRIATE BOX)
N THIS WELL WILL NOT REPLACE AN EXISTING WELL
Y THIS WELL WILL REPLACE A WELL THAT WILL BE ABANDONED AND SEALED
S THIS WELL WILL REPLACE A WELL THAT WILL BE USED AS A STANDBY-CONTACT LOCAL APPROVING AUTHORITY FOR POLICY ON STANDBY WELLS
D THIS WELL WILL DEEPEAN AN EXISTING WELL
PERMIT NUMBER OF WELL TO BE REPLACED OR DEEPEMED (IF AVAILABLE)

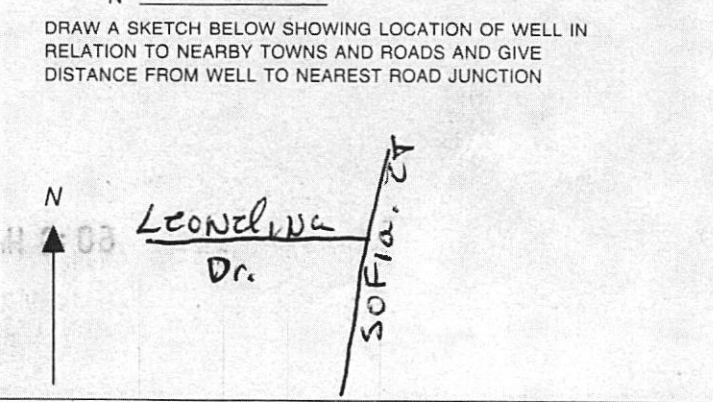

Not to be filled in by driller (MDE OR COUNTY USE ONLY)
APPROX. PERMIT NUMBER HO 95G020
PERMIT No. HO 95-0095

SPECIAL CONDITIONS
NOTE - APPROVING AUTHORITIES SHOULD USE SEPARATE SHEET IF NEEDED