

(THIS NUMBER IS TO BE PUNCHED IN COLS. 3-6 ON ALL CARDS) FILL IN THIS FORM COMPLETELY PLEASE TYPE
 COUNTY NUMBER
 ST/CO USE ONLY DATE Received MM DD YY 04 20 18 DATE WELL COMPLETED MM DD YY 04 17 18 Depth of Well 22 225 26 (TO NEAREST FOOT) PERMIT NO. FROM "PERMIT TO DRILL WELL" 4/27/18 OK HO-17-0265

OWNER CASASCO JENNIFER
 WELL SITE ADDRESS 3395 JENNINGS CHAPLE RD TOWN LISBON MD 21793
 SUBDIVISION CASASCO PROD SECTION LOT PAR-9F

WELL LOG
 Not required for driven wells

STATE THE KIND OF FORMATIONS PENETRATED, THEIR COLOR, DEPTH, THICKNESS AND IF WATER BEARING

DESCRIPTION (Use additional sheets if needed)	FEET		check if water bearing
	FROM	TO	
BROWN SHALE	0	98	
BLUE ROCK	98	225	✓
			130'
			210'

GROUTING RECORD YES NO
 WELL HAS BEEN GROUTED (Circle Appropriate Box) Y N
 TYPE OF GROUTING MATERIAL (Circle one)
 CEMENT CM BENTONITE CLAY BC
 NO. OF BAGS 24 NO. OF POUNDS 2250
 GALLONS OF WATER 144
 DEPTH OF GROUT SEAL (to nearest foot)
 from 0 ft. to 120 ft.
 (enter 0 if from surface)

CASING RECORD
 casing types insert appropriate code below
 ST STEEL CO CONCRETE
 PL PLASTIC OT OTHER
 MAIN CASING TYPE PL Nominal diameter top (main) casing (nearest inch)! 6" Total depth of main casing (nearest foot) 120
 60 61 63 64 66 70

OTHER CASING (if used)
 diameter inch depth (feet) from to
 E A C H I N G

SCREEN RECORD
 screen type or open hole insert appropriate code below
 ST STEEL BR BRASS HO OPEN HOLE
 PL PLASTIC OT OTHER

C 2 DEPTH (nearest ft.)
 1 H-O 120 225
 E A C H S C R E E N
 8 9 11 15 17 21 23 24 26 30 32 36 38 39 41 45 47 51
 SLOT SIZE 1 2 3
 DIAMETER OF SCREEN (NEAREST INCH)
 56 60
 from to

GRAVEL PACK IF WELL DRILLED WAS FLOWING WELL INSERT F IN BOX 68 68
MDE USE ONLY (NOT TO BE FILLED IN BY DRILLER)
 T (E.R.O.S.) W Q
 70 72 74 75 76
 TELESCOPE CASING LOG INDICATOR OTHER DATA

C 3 **PUMPING TEST**
 HOURS PUMPED (nearest hour) 3
 8 9
 PUMPING RATE (gal. per min.) 12
 11 15
 METHOD USED TO MEASURE PUMPING RATE SUB
 WATER LEVEL (distance from land surface)
 BEFORE PUMPING 45 ft.
 17 20
 WHEN PUMPING 76 ft.
 22 25
 TYPE OF PUMP USED (for test)
 A air P piston T turbine
 C centrifugal R rotary O other (describe below)
 J jet S submersible

PUMP INSTALLED
 DRILLER INSTALLED PUMP (CIRCLE) (YES or NO) YES NO
 IF DRILLER INSTALLS PUMP, THIS SECTION MUST BE COMPLETED FOR ALL WELLS.
 TYPE OF PUMP INSTALLED PLACE (A,C,J,P,R,S,T,O) IN BOX 29 29
 CAPACITY: GALLONS PER MINUTE (to nearest gallon) 31 35
 PUMP HORSE POWER 37 41
 PUMP COLUMN LENGTH (nearest ft.) 43 47
 CASING HEIGHT (circle appropriate box and enter casing height)
 + above } LAND SURFACE
 - below } (nearest foot)
 49 50 51

LATITUDE 39.279600
 LONGITUDE 77.084310
 (DEFAULT COORD. WGS 84)
 Pursuant to §10-624 of the State Govt. Article of the Maryland Code personal info. requested on this form is used in processing this form pursuant to COMAR 26.04.04. Failure to provide the info. may result in this form not being processed. You have the right to inspect, amend, or correct this form. The Maryland Department of the Environment is subject to the Maryland Public Information Act. This form may be made available on the Internet via MDE's website and is subject to inspection or copying, in whole or in part, by the public and other governmental agencies, if not protected by federal or state law.

NUMBER OF UNSUCCESSFUL WELLS: 0
 WELL HYDROFRACTURED YES NO Y N
 CIRCLE APPROPRIATE LETTER
 A A WELL WAS ABANDONED AND SEALED WHEN THIS WELL WAS COMPLETED
 E ELECTRIC LOG OBTAINED
 P TEST WELL CONVERTED TO PRODUCTION WELL
 I HEREBY CERTIFY THAT THIS WELL HAS BEEN CONSTRUCTED IN ACCORDANCE WITH COMAR 26.04.04 "WELL CONSTRUCTION" AND IN CONFORMANCE WITH ALL CONDITIONS STATED IN THE ABOVE CAPTIONED PERMIT, AND THAT THE INFORMATION PRESENTED HEREIN IS ACCURATE AND COMPLETE TO THE BEST OF MY KNOWLEDGE.
 DRILLERS LIC. NO. 1 M SD043 1
 DRILLERS SIGNATURE Wayne Hanley
 (MUST MATCH SIGNATURE ON APPLICATION)
 LIC. NO. 1 D 1
 SITE SUPERVISOR (sign. of driller or journeyman responsible for sitework if different from permittee)

B 1 26576

SEQUENCE NO. (MDE USE ONLY)

STATE OF MARYLAND APPLICATION FOR PERMIT TO DRILL WELL please type

STATE PERMIT NUMBER

HO - 17 - 0265 fill in this form completely

Date Received (APA) 03/09/18

OWNER INFORMATION

CASASCO JENNIFER 3365 JENNING'S CHAPLE RD LISBON MD 21793

B 3 LOCATION OF WELL

HOWARD COUNTY SQUARE WOODS Casasco Property LISBON NEAREST TOWN

DRILLER INFORMATION

WAYNE HARLEY MS D 043 4019 BAPTIST RD TANLEYTOWN MD 21787 Wayne Harley 3-9-18

B 4 SOURCES OF DRILLING WATER

1. WELL 3395 3365 JENNING'S CHAPLE ON WHICH SIDE OF ROAD DISTANCE FROM ROAD ENTER FT OR MI TAX MAP: 20 BLK: 5 PARCEL 94

B 2 WELL INFORMATION

APPROX. PUMPING RATE (GAL. PER MIN.) 3 APPROX. PUMPING RATE (GAL. PER MIN.) 650 AVERAGE DAILY QUANTITY NEEDED (GAL. PER DAY) 14 20

NOT TO BE FILLED IN BY DRILLER HEALTH DEPARTMENT APPROVAL

USE FOR WATER (CIRCLE APPROPRIATE BOX)

- DOMESTIC POTABLE SUPPLY & RESIDENTIAL IRRIGATION FARMING (LIVESTOCK WATERING & AGRICULTURAL IRRIGATION) INDUSTRIAL, COMMERCIAL, DEWATERING PUBLIC WATER SUPPLY WELL TEST, OBSERVATION, MONITORING OPEN LOOP GEOTHERMAL CLOSED LOOP GEOTHERMAL

Howard COUNTY NAME 13 COUNTY NO. STATE SIGNATURE DATE ISSUED 3/14/18 CO SIGNATURE DNI EXP. DATE 3/14/19

DON: 4/11/18 (SC) DOG: 4/14/18 (SC) DOY: 4/17/18 (SC)

PROPOSED LOCATION OF WELL ON LOT SHOW PERMANENT STRUCTURES SUCH AS BUILDINGS, SEPTIC SYSTEM, ROADS AND/OR LANDMARKS AND INDICATE NOT LESS THAN TWO DISTANCE MEASUREMENTS TO WELL

APPROXIMATE DEPTH OF WELL 300 FEET

APPROXIMATE DIAMETER OF WELL 6 NEAREST INCH

METHOD OF DRILLING (circle one)

- BORED (or Augered) JETTED Jetted & DRIVEN AIR-ROTary AIR-PERCussion ROTARY (Hydraulic Rotary) CABLE REVerse-ROTary Drive-POINT other

4/11 -driller not yet on site 4/17 -12 gpm -45' static -70' meas. pt. -started pumping 9 am -collected Na, Cl, TDS samples @ 12 pm

REPLACEMENT OR DEEPEMED WELLS (CIRCLE APPROPRIATE BOX)

- THIS WELL WILL NOT REPLACE AN EXISTING WELL THIS WELL WILL REPLACE A WELL THAT WILL BE ABANDONED AND SEALED THIS WELL WILL REPLACE A WELL THAT WILL BE USED AS A STANDBY-CONTACT LOCAL APPROVING AUTHORITY FOR POLICY ON STANDBY WELLS THIS WELL WILL DEEPEM AN EXISTING WELL PERMIT NUMBER OF WELL TO BE REPLACED OR DEEPEMED (IF AVAILABLE) 41 52



Not to be filled in by driller (MDE OR COUNTY USE ONLY)

APPROX. PERMIT NUMBER G

PERMIT No. HO - 17 - 0265

SPECIAL CONDITIONS

NOTE: APPROVING AUTHORITIES SHOULD USE SEPARATE SHEET IF NEEDED-

SEE ATTACHED MEMO.

Maura J. Rossman, M.D., Health Officer

Information Form for the Installation of the Well Pump, Pitless Adapter, and Supply Piping

NOTE: The installer is responsible for requesting an inspection prior to 9 am on the day of the desired inspection. No work is to be covered until approved by the Health Department. All installations must comply with the National Standard Plumbing Code (NSPC, as amended locally) and COMAR 26.04.04 (MD Well Construction Regulations). Submission of a complete form is required prior to Use and Occupancy approval.

Company Name: OneSeapeake Geosystems inc Telephone #: 410-789-5020
 Address: 6720 Fort Smallwood Rd, 21226
Baltimore, MD

Must circle one: Licensed Plumber / Licensed Well Driller / Licensed Well Pump Installer

License # and name of individual responsible for the field installation:
 Name (Print): Ed Gross License# MWD 580

*A licensed individual must perform the actual installation. Apprentices must be under the supervision of a licensed journeyman or master plumber, pump installer or well driller. Licenses may be subjected to field verification. Unlicensed individuals may be reported to the appropriate licensing agency.

Name of Property Owner: Jack Schiner Telephone #: _____
 Subdivision: Jacure woods Lot #: 4 Well Tag #: HO-17-0265
 Site Address: 3395 Jennings Chapel Rd

Submersible Pump Data
 Make: FE
 Model #: 1050754
 Pump Capacity 10 gpm
 Well Yield: 12 gpm
 Depth of well encountered at time of pump installation: 225 (feet)
 If pump capacity exceeds well yield, a low water cut off switch is required by NSPC 1990 Section 17.8.4

Pitless Adapter
 Make: SS +
 Model#: Merril Manufacturing
 GPM Depth: 36" (36" min)
 GPM NSF/WSC approved: yes

Well Cap and Electric Conduit
 Two piece watertight cap: yes
 Screened, vented well cap: yes
 Cap secured to casing: yes
 Conduit min 18" B.G.: yes
 Conduit secured to well cap: yes

Must circle one: torque arrestors / Cable guards / Other acceptable method used
 Safety rope, if used, attached to brass rope adapter or other acceptable method inside of well casing yes

Piping to house
 Type: HDPE
 PSI: 166 (160 psi min)
 Depth of supply line: 4' (36" min)

House Connection
 PVC sleeve to undisturbed soil at wall penetration: yes
 Length of sleeve(5' minimum from foundation): 6'
 Sleeve sealed properly: yes

The water supply line is required to be at least ten feet from the septic tank, pump chamber, sewage piping, distribution box, drainfields, and sewage reserve area. If this cannot be accomplished, contact this office for approval prior to installation.

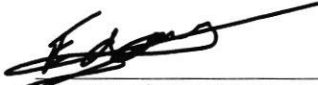

 Signature of company representative responsible for installation

11/17/21

 date

For Health Department Use Only – Not to be completed by Installer

Date Insp. Requested: _____ Date Insp. Approved: _____ Inspector: _____
 Inspection Data: Pitless adapter watertight & water supply line at least 36" below grade _____
 Two piece cap installed and attached to casing securely _____
 Elec. conduit extends at least 18" below grade/attached to cap properly _____
 Safety rope not outside of well cap/casing _____
 Correct well tag attached properly and casing 8" above finished grade _____
 Water supply line sleeved adequately at house connection _____
 Adequate grout observed below pitless adapter _____

(Revised form 10/24/2018)

INTERIM CERTIFICATE OF POTABILITY

Expiration Date – MAY 18, 2022

November 18, 2021

Homeowner
3395 Jennings Chapel Road
Woodbine, MD 21797

**RE: Casasco Property, Lot 4
3395 Jennings Chapel Road
Building Permit: B20004121
Well Permit: HO-17-0265**

Dear Homeowner:

This is to advise you that the septic system installation and water well construction for the above referenced property have been inspected and approved. Final approval of the septic system was granted on **6/23/2021**. Final approval of the well line connection to the dwelling was granted on **8/31/2021**. The well construction was completed on **4/17/2018**. Water samples were collected on **11/8/2021**.

The water sample results indicate that the water samples submitted for testing were free of coliform and fecal coliform bacteria at the time of sampling and are bacteriologically safe for drinking. This certifies that the initial sampling requirements of COMAR 26.04.04 "Well Regulations" have been met for the water supply system installed under well permit HO-17-0265. Although the submitted sample results are in compliance with COMAR standards, the Health Department does not guarantee water supplies.

This Interim Certificate of Potability will expire **six months** from the date of issuance. Submission of a second bacteriological test indicating the water is free of coliform and fecal coliform bacteria is required prior to the expiration date, after which time a Final Certificate of Potability will be issued. **Failure to submit an additional sample and obtain a Final Certificate of Potability will result in a Notice of Violation and is punishable as a misdemeanor under the *Annotated Code of Maryland, Environment Article, 9-1311*, subject to a fine of up to \$500 or imprisonment not to exceed three months.**

Please contact (410) 313-1773 to schedule a final water sample appointment or contact a Maryland certified water laboratory to schedule a water sample. A list of laboratories certified by the state of Maryland may be found at the following website:
<http://www.mde.state.md.us/assets/document/WSP-Labs-2010apr16.pdf>



Bureau of Environmental Health
8930 Stanford Blvd | Columbia, MD 21045
410.313.2640 - Voice/Relay
410.313.2648 - Fax
1.866.313.6300 - Toll Free

Maura J. Rossman, M.D., Health Officer

In closing, please refer to our "[Homeowner Fact Sheet](#)" which illustrates a better understanding for your Onsite Sewage Disposal System. You will also find a link to Maryland Department of the Environment's website which describes in further detail operation and maintenance of your septic system.

Approving Authority,

A handwritten signature in black ink, appearing to read 'Kevin M. Wolf', is written over a light blue horizontal line.

Kevin M. Wolf, LEHS, R.S./REHS, Supervisor
Groundwater Management Section
Well & Septic Program

cc: Howard County Dept. of Inspections, Licenses, and Permits
Community Hygiene Program
File

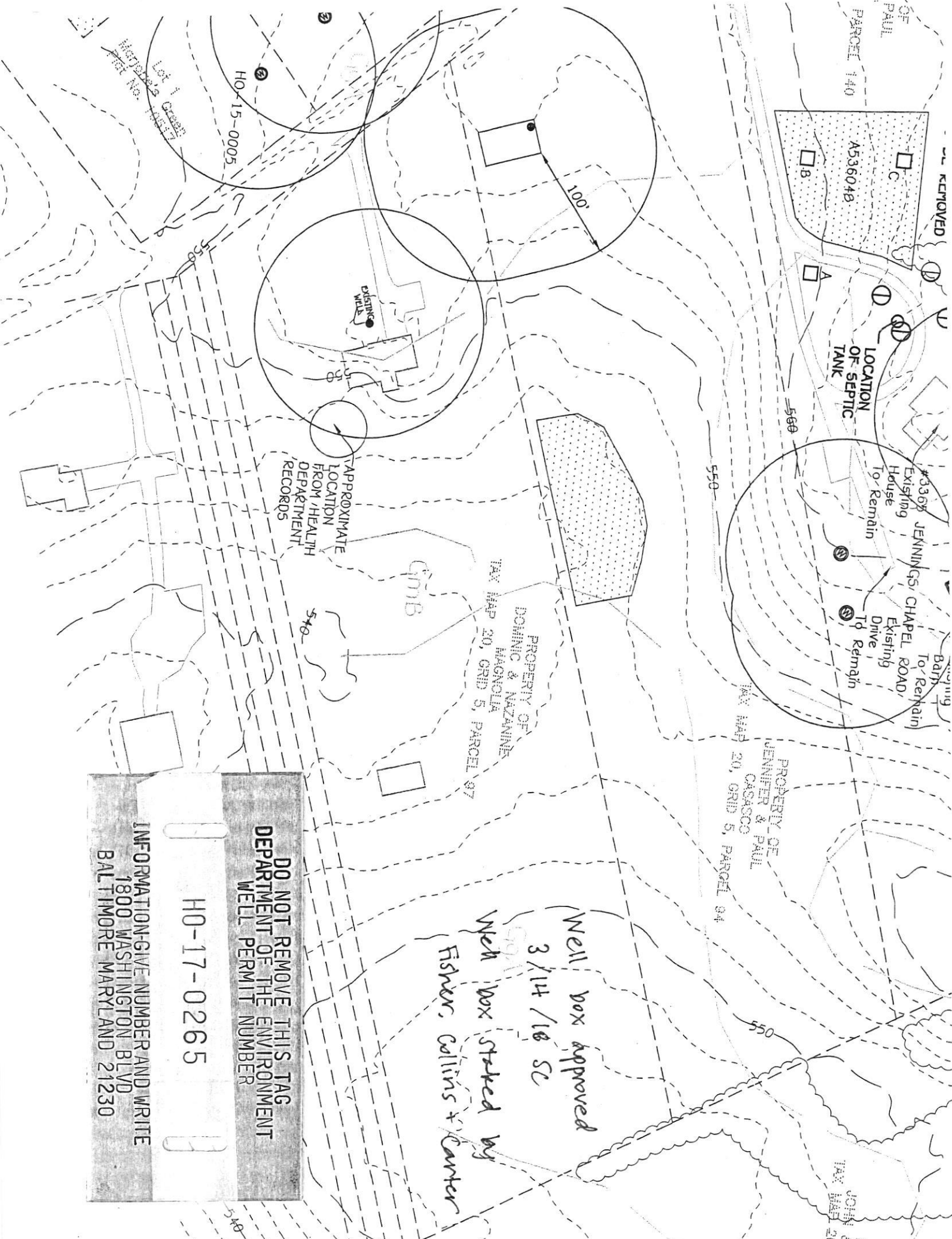

Well box approved
 3/14/16 SC
 Well box staked by
 Fisher, Collins + Carter

DO NOT REMOVE THIS TAG
DEPARTMENT OF THE ENVIRONMENT
WELL PERMIT NUMBER
 H0-17-0265

INFORMATION-GIVE NUMBER AND WRITE
 1800 WASHINGTON BLVD
 BALTIMORE MARYLAND 21230

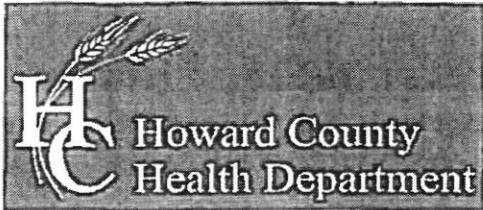

Bureau of Environmental Health

8930 Stanford Boulevard, Columbia, MD 21045

Main: 410 313-2640 | Fax: 410-313-2648

TDD 410-313-2323 | Toll Free 1-866-313-6300

www.hchealth.org

Facebook: www.facebook.com/hocohealth

Twitter: HowardCoHealthDep

Maura J. Rossman, M.D., Health Officer

TO ALL INTERESTED PARTIES

When submitting a well permit application for a proposed well, please indicate one of the following:

Well Site Location:

<u>JENNIFER AND PAUL CASASCO</u>	<u>PARCEL</u> <u>94</u>	<u>JENNINGS CHAPEL RD</u>
Subdivision/Property Name	Lot #	Road Name

- The well site, as shown on the attached well site plan, has been staked by

BRUCE COLLINS & COMPANY, INC.
(professional land surveyor or company employing professional land surveyors)

on 2/14/18
(date)

- The well driller, builder or property owner will call the Health Department to schedule a time to meet in the field to verify the proposed well site location.

This sheet, along with two copies of an acceptable well site plan, must be attached to the green well permit application.



Maura J. Rossman, M.D., Health Officer

MEMORANDUM

TO: Wayne Harley (MSD 043)

FROM: Sarah Collins, L.E.H.S. SEC
Howard County Health Department
Well and Septic Program

DATE: March 14, 2018

RE: **Well permits for 3351, 3355, and 3395 Jennings Chapel Road**
HO-17-0263 (Square Woods, Lot 1)
HO-17-0264 (Square Woods, Lot 2)
HO-17-0265 (Casasco Property, Parcel 94)

Please be aware of the following special conditions for the well permits at 3351, 3355, and 3395 Jennings Chapel Road:

1. All drilling, grouting, and yield test activities must be called into our office at least one day prior. You may only work at these sites during the operating hours of the Health Department: Monday-Friday, 8am-5pm. Please call 410-313-1331 to schedule inspections. If the Health Department does not have the opportunity to inspect every day that you are working, the wells may not be approved and a Notice of Violation may be issued.
2. Due to the placement of an upgradient septic area, the well on Lot 2 must have 50' of steel casing or 10' into competent bedrock, whichever is deeper. This is a requirement of Maryland Department of the Environment.
3. Based on the proximity of the future wells to the road, the Health Department is requiring sodium, chloride, and total dissolved solids (TDS) samples to be collected during the yield test for the wells at Square Woods, Lot 1, and Casasco Property, Parcel 94. Either the Health Department or a private water testing lab may collect these samples.

Feel free to contact me at 410-313-6287 or SCollins@howardcountymd.gov with any questions.

Cc: Jennifer Casasco
Tony Fertita – Fisher, Collins & Carter (tonyf@fcc-eng.com)
File

Maura J. Rossman, M.D., Health Officer

May 7, 2018

Jennifer Casasco
3365 Jennings Chapel Road
Woodbine, MD 21797

Re: Water samples from 3395 Jennings Chapel Road
Casasco Property Parcel 94, well #HO-17-0265

Dear Homeowner,

The Health Department received results from the testing for sodium and chloride from the well on your property.

Elevated sodium levels in drinking water may affect individuals on low-salt diets. The action level for sodium is 20 milligrams per liter (mg/L); **sodium from the well measured 6.23 mg/L.**

Chloride and TDS are both considered secondary contaminants, meaning high concentrations may affect taste, color, odor, or corrosive properties of water but present no risk to health. The secondary maximum contaminant level for chloride is 250 mg/L; **chloride from the well measured 15 mg/L.** The secondary maximum contaminant level for TDS is 500 mg/L; **TDS from the well measured 109 mg/L.**

Feel free contact me at the number or email below with any questions regarding the results of water sampling.

Sincerely,



Sarah Collins, L.E.H.S.
Howard County Health Department
Well & Septic Program
SCollins@howardcountymd.gov
410-313-6287

Cc: Community Hygiene Program
File

Send Report To: Bert Nixon

State of Maryland
DHMH - Laboratories Administration

Division of Environmental Sciences
TRACE METALS LABORATORY

1770 Ashland Avenue
Baltimore, Maryland 21205

Lab No. Date Received



E18003735001

Received: 04/18/2018

Metals

HO-17-0265

LABORATORY ANALYSIS REQUEST

Do not write above this line

Please Print

Sample ID No: HO-17-0265 Site Name: Casasco Prop. / Square Woods - Par 94 County: Howard

Sample Source: 3395 Jennings Chapel Rd. Woodbine Collector: S. Collins
Street Town or City Name

Date Collected: 4/17/2018 Time Collected: 12 a.m./(p.m.) Phone #: 410-313-6287

Sample Preserved By: Field ESRL WMRL Central Lab
Preservative Used: HNO₃ _____ mL pH: <2, SHS, 4/18/18

Sample Type: Drinking Water Landfill Source (Raw Water) Liquid
Data Category: Community Stream Distribution (Treated) Solid
Code Non-Community Sediment Other _____
HF Private

Specify Program: SDWA NPDES CWA RCRA Consumer Products Other _____

Type of Sample Preparation: Total Metals Total Metals TCLP Dissolved Metals
(field preparation required)

Remarks: Sample collected during yield test.

✓	Element	Lab Use	✓	Element	Lab Use	✓	Element	Lab Use
	Antimony (Sb)			Aluminum (Al)			Uranium (U)	
	Arsenic (As)			Calcium (Ca)			Vanadium (V)	
	Barium (Ba)			Cobalt (Co)			Zinc (Zn)	
	Beryllium (Be)			Copper (Cu)				
	Cadmium (Cd)			Iron (Fe)				
	Chromium (Cr)			Lead (Pb)	<u>SHS</u>			
	Mercury (Hg)			Magnesium (Mg)				
	Nickel (Ni)			Manganese (Mn)				
	Selenium (Se)			Molybdenum (Mo)				
✓	Sodium (Na)	<u>SHS</u>		Potassium (K)				
	Thallium (Tl)			Silver (Ag)				

Lab Supervisor: _____

Date Reported: ____/____/____

•Phone: (443) 681 - 4596

•Fax: (443) 681 - 4507



State of Maryland
 Department of Health
 Laboratories Administration
 Division of Environmental Sciences
TRACE METALS LABORATORY
 1770 Ashland Avenue, Baltimore, Maryland 21205
 Robert Myers, Ph.D., Director



Certificate of Analysis

HOWARD CO ENVIRONMENTAL HLTH
 8930 STANFORD BLVD
 COLUMBIA, MD 21045

Lab Project No: E18003735 Date Coll.: 04/17/2018 Date Received: 04/18/2018 Submitted By: Collins

Field ID: HO-17-0265
 Lab No.: E18003735001

<u>Method</u>	<u>Element</u>	<u>Result</u>	<u>Units</u>	<u>Date Analyzed</u>
EPA 200.7	Sodium	6.23	ppm	04/20/2018

Comments:

Approved by: <u>Yungtao Choi</u>	Approval date: <u>04/24/2018</u>
----------------------------------	----------------------------------

**The following methods are included in our A2LA Scope of Accreditation: EPA 200.7, EPA 200.8, EPA 245.1.

This document contains confidential health information that is privileged, confidential and exempt from disclosure under law. If you have received this information in error, please call (410) 767-6944 and arrange for return or destruction.



State of Maryland
Department of Health
Laboratories Administration
Division of Environmental Sciences
INORGANICS ANALYTICAL LABORATORY
1770 Ashland Avenue, Baltimore, Maryland 21205
Robert Myers, Ph.D., Director



Certificate of Analysis

HOWARD CO ENVIRONMENTAL HLTH
8930 STANFORD BLVD
COLUMBIA, MD 21045

Lab Project NoE18003732 Date Coll. 04/17/2018 Date Received 04/18/2018 Submitted By: S. Collins

Field ID: HO-17-0265
Lab No.: E18003732001

<u>Analyte</u>	<u>Method</u>	<u>Result</u>	<u>Units</u>	<u>Date Analyzed</u>
Chloride	SM 4500-Cl E	15	mg/L	04/24/2018
Total Dissolved Solids	SM 2540C	109	mg/L	04/20/2018

Comments:

Approved by:

Approval date: 04/26/2018

*The following methods are included in our A2LA Scope of Accreditation: EPA150.1, EPA 353.2, EPA 375.2, SM4500F C, SM 4500-CN G & QCM-CN, QCM-CN.

This document contains confidential health information that is privileged, confidential and exempt from disclosure under law. If you have received this information in error, please call (410) 767-6190 and arrange for return or destruction.

ENVIRO-CHEM LABORATORIES, INC.

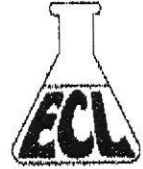

47 Loveton Circle, Suite K • Sparks, Maryland 21152

410-472-1112

FINAL REPORT OF ANALYSIS

JMB Homes
5580 Ten Estates Dr.
Woodbine, MD 21797

Report Date: 11/10/2021
Report Number: 211110172718
Use and Occupancy
PERMIT #:

LAB#- E068607-01 SAMPLE ID- 3395 Jennings Chapel Rd WELL # HO 17-0265
LOCATION- Pressure Tank SAMPLER- S Shelley #2018 SS
DATE SAMPLED- 11/08/2021 TIME SAMPLED- 13:10 CHLORINE- <0.05 mg/L
DATE RECEIVED- 11/08/2021 TIME RECEIVED- 15:00
DELIVERED BY- Stephen Shelley RECEIVED BY- Ginny Shelley
COMMENTS- Secure wall, 2 piece PVC cap and casing. Sediment Filter

COMMENTS-

ANALYSIS	METHOD	ANALYSIS DATE/TIME	BY	RESULT	DATA FLAG
Microbiology by Enviro-Chem					
Total Coliform	SM 9223B	11/08/21 15:15	VPS	Absent	PASS
E. Coli	SM 9223B	11/08/21 15:15	VPS	Absent	PASS

Based on coliform bacteriological standards, at the time of sampling this water was **SAFE** for drinking water purposes.

Wet Chemistry by Enviro-Chem

Nitrate (as N)	EPA 300.0	11/08/21 18:29	FRD	4.91	mg/L	PASS
pH	SM4500-H+B	11/08/21 15:50	FRD	6.1	SU	
Sand	EPA 160.5	11/08/21 16:35	SES	< 0.5	ml/L/Hr	
Turbidity	EPA 180.1	11/08/21 15:50	FRD	< 0.2	NTU	

Stephen Shelley
Laboratory Director

Certifications

State of Maryland Laboratory #192