



HOWARD COUNTY HEALTH DEPARTMENT

66352

P5

DATE
8/22/19

Received From

J + A Construction

PHONE #

301-607-8486

For

Septic Permit

5911 Maple Leaf Way

CASH

CHECK

NO.

12814

Three Hundred Ninety Six

Dollars

\$ 396 | 00

Received By

Shelley Priddy

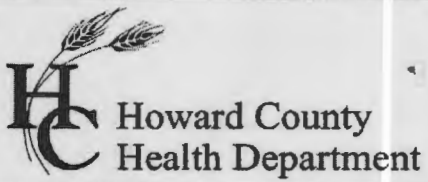

Bureau of Environmental Health
 8930 Stanford Boulevard, Columbia, MD 21045
 Main: 410-313-2640 | Fax: 410-313-2648
 TDD 410-313-2323 | Toll Free 1-866-313-6300
www.hchealth.org
 Facebook: www.facebook.com/hocohealth

Maura J. Rossman, M.D., Health Officer

RECEIPT DATE: 8/22/19 **ONSITE SEWAGE DISPOSAL SYSTEM** P 564352

APPROVAL DATE: _____ **PERMIT: CONSTRUCTION** A _____

PROPERTY ADDRESS: 2911 MAPLE LEAF WAY, ELLICOTT CITY, MD 21042

SUBDIVISION: MAPLE VIEW LOT: 1 TAX ID: 03-598697

CONTRACTOR: J+A Construction EMAIL: _____

CONTRACTOR ADDRESS: 7991 Bennett Branch Rd, Mt Airy, MD 21771 PHONE: 410-635-2484

PROPERTY OWNER: SRIDHAR & ANITHA BANALA EMAIL: banalas@yahoo.com

OWNER ADDRESS: 10717 HILLINGDON ROAD, WOODSTOCK, MD 21163 PHONE: (443)829-8905

SEPTIC TANK SIZE (GALLONS): 2000 TANK MANUFACTURER: BABYLON

PUMP MODEL: n.a. PUMP SIZE: n.a. PUMP TANK CAPACITY: n.a.

DISTRIBUTION SYSTEM: GRAVITY PRESSURE DOSED BEDROOMS: 5 APPLICATION RATE: 1.2

TRENCHES:	LINEAR FEET REQUIRED: <u>130</u>	INLET DEPTH: <u>3.0</u>
	TRENCH WIDTH: <u>3</u>	MAXIMUM BOTTOM DEPTH: <u>6.0</u>
	MINIMUM SPACE BETWEEN TRENCHES: <u>10</u>	EFFECTIVE AREA BEGINNING DEPTH: <u>4.0</u>
LOCATION:	PER APPROVED SITE PLAN. SEWAGE DISPOSAL AREA AND TANK LOCATIONS MUST BE STAKED BY LICENSED SURVEYOR PRIOR TO PRE-CONSTRUCTION INSPECTION.	
NOTES:	<u>4 x 34' TRENCH.</u>	

ISSUED BY: R BRICKER ISSUE DATE: 8/22/19 EXPIRATION DATE: 8/22/20

- NOTE: CONTRACTOR MUST SCHEDULE A PRE-CONSTRUCTION INSPECTION PRIOR TO BEGINNING ANY INSTALLATION
- NOTE: CONTRACTOR MUST SCHEDULE AN INSPECTION AND GAIN APPROVAL OF ALL COMPONENTS PRIOR TO COVERING
- NOTE: STONE MUST BE APPROVED BY HEALTH DEPARTMENT AND GRAVEL TICKET MUST BE AVAILABLE FOR REVIEW.
- NOTE: WATERTIGHT TANKS REQUIRED
- NOTE: ALL PARTS OF SEPTIC SYSTEM SHALL BE AT LEAST 100 FEET DOWNGRADIENT FROM ANY WATER WELL
- NOTE: MANHOLE RISERS REQUIRED ON ALL SEPTIC TANKS AND PUMP CHAMBERS
- NOTE: AN ELECTRICAL PERMIT IS REQUIRED FOR INSTALLATION OF ANY ELECTRICAL COMPONENTS OF THE SYSTEM
 - ELECTRICAL PERMIT ISSUED E n.a.
- NOTE: MDE RECOMMENDS SEPTIC TANKS, BAT, AND OTHER PRETREATMENT UNITS BE PUMPED AT A FREQUENCY ADEQUATE TO ENSURE THAT SOLIDS ARE NOT DISCHARGED TO THE DISPOSAL AREA

NEITHER THE HOWARD COUNTY COUNCIL NOR THE HEALTH DEPARTMENT IS RESPONSIBLE FOR THE SUCCESSFUL OPERATION OF ANY SYSTEM.

**PERMITTEE RESPONSIBLE FOR OBTAINING FINAL APPROVAL ON THIS PERMIT.
 CALL 410-313-1771 TO SCHEDULE INSPECTIONS.**

NOT TO SCALE

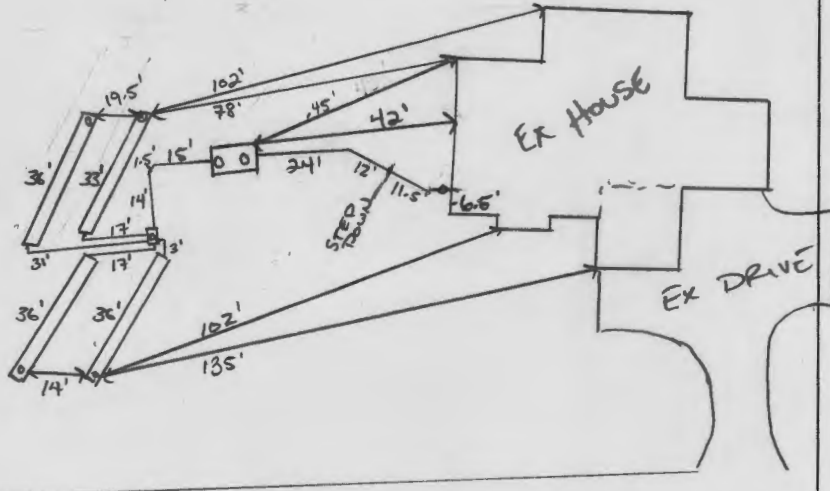

TRENCH/DRAINFIELD DATA

WIDTH	INLET	BOTTOM
3	3	6
NUMBER OF TRENCHES		4
TOTAL LENGTH		141 F
ABSORPTION AREA		423
DISTRIBUTION BOX LEVEL		SPEED
DISTRIBUTION BOX BAFFLE		YES
DISTRIBUTION BOX PORT		YES

SEPTIC TANK DATA

SEPTIC TANK I LEVEL	YES
MANUFACTURER	BABYLON
CAPACITY	2000 GAL
SEAM LOC	TOP
TANK LID DEPTH	2'
BAFFLES	YES
BAFFLE FILTER	NO
MANHOLE LOC	FRONT/BACK
6" PORT LOC	-
WATERTIGHT TEST	-
SLOTTED	YES
DATE ON LID	07/15/2019

PUMP/SEPTIC TANK LEVEL

MANUFACTURER	
CAPACITY	GAL
SEAM LOC	
TANK LID DEPTH	
BAFFLES	
BAFFLE FILTER	
MANHOLE LOC	
6" PORT LOC	
WATERTIGHT TEST	
SLOTTED	
DATE ON LID	

ROAD NAME
MAPLE LEAF WAY

PRE-CONSTRUCTION:

08/27/2019 RESCHEDULE LAYOUT. STAKE SDA AND TRENCHES. (A)
 08/30/2019 LAID OUT 4 TRENCHES 34' EA. SDA + TANKS
 STAKED. OK TO START. (A)

INSTALLATION:

09/03/2019 SHC AND SEWER LINE INSTALLED TO
 TANK; SET. (A) 9/5/2019 THREE UPPER TRENCHES, D BOX SET. (A)
 9/6/2019 LOWER TRENCH COMPLETE. D BOX TO T1 WAS BACK FLOWING
 INTO BOX. BOX WAS RAISED. CONTRACTOR TO BED BOX AND LIGHT WEIGHT
 PVC TO TRENCH (A)

FINAL INSPECTOR

DATE OF APPROVAL

09/09/2019