

Real Property Data Search (w4)

Search Result for HOWARD COUNTY

View Map		View GroundRent Redemption				View GroundRent Registration				
Tax Exempt:		Special Tax Recapture:								
Exempt Class:		NONE								
Account Identifier:		District - 03 Account Number - 307697								
Owner Information										
Owner Name:		MORAR JOHN F JARVIS MORAR MAUREEN T/E				Use:		RESIDENTIAL		NO
Mailing Address:		53 HILLSIDE VIEW RD MAHOPAC NY 10541-2522				Principal Residence:				
						Deed Reference:		/02277/ 00378		
Location & Structure Information										
Premises Address:		MARRIOTTSVILLE RD MARRIOTTSVILLE 21104-0000				Legal Description:		5.000 AR MARRIOTTSVILLE RD		
Map:	Grid:	Parcel:	Sub District:	Subdivision:	Section:	Block:	Lot:	Assessment Year:	Plat No:	Plat Ref:
0010	0003	0048		0002				2019		
Special Tax Areas:						Town:		NONE		
						Ad Valorem:		100		
						Tax Class:				
Primary Structure Built		Above Grade Living Area		Finished Basement Area		Property Land Area		County Use		
						5.0000 AC				
Stories	Basement	Type	Exterior	Full/Half Bath	Garage	Last Major Renovation				
Value Information										
		Base Value		Value		Phase-in Assessments				
				As of		As of		As of		
				01/01/2019		07/01/2019		07/01/2020		
Land:		37,500		37,500						
Improvements		1,700		1,700						
Total:		39,200		39,200		39,200		39,200		
Preferential Land:		0						0		
Transfer Information										
Seller: MORAR CHARLES B		Date: 01/14/1991				Price: \$0				
Type:		Deed1: /02277/ 00378				Deed2:				
Seller:		Date:				Price:				
Type:		Deed1:				Deed2:				
Seller:		Date:				Price:				
Type:		Deed1:				Deed2:				
Exemption Information										
Partial Exempt Assessments:		Class		07/01/2019		07/01/2020				
County:		000		0.00						
State:		000		0.00						
Municipal:		000		0.00 0.00		0.00 0.00				
Tax Exempt:		Special Tax Recapture:								
Exempt Class:		NONE								
Homestead Application Information										
Homestead Application Status: No Application										

Homeowners' Tax Credit Application Information

Homeowners' Tax Credit Application Status: No Application **Date:**

1. This screen allows you to search the Real Property database and display property records.
2. Click **here** for a glossary of terms.
3. Deleted accounts can only be selected by Property Account Identifier.
4. The following pages are for information purpose only. The data is not to be used for legal reports or documents. While we have confidence in the accuracy of these records, the Department makes no warranties, expressed or implied, regarding the information.



No search results.

7/19/94
10:00

PERMIT

SEWAGE DISPOSAL SYSTEM

DEPARTMENT OF HEALTH AND MENTAL HYGIENE

P _____

A REPAIR

DISTRICT _____

DATE _____

HOWARD COUNTY HEALTH DEPARTMENT

BUREAU OF ENVIRONMENTAL HEALTH

~~461-9933~~ 313-2640

DATE SYSTEM APPROVED _____

INSPECTOR _____

Jack Fyock Septic Service

IS PERMITTED TO INSTALL _____ ALTER X

ADDRESS _____ PHONE 988-9270

SUBDIVISION _____ LOT _____ ROAD 888 Marriottsville Road

PROPERTY OWNER _____ Charles Morar MAIL: 2121 Carroll Dale Rd

ADDRESS _____ 888 Marriottsville Road
Marriottsville, Maryland 21104 Sykesville, MD

SEPTIC TANK CAPACITY _____ GALLONS

NUMBER OF BEDROOMS _____

_____ SQUARE FEET PER BEDROOM

LINEAR FEET OF TRENCH REQUIRED _____

REPAIR - PURPOSE - NO SYSTEM APPARENTLY SERVES HOUSE

Call for inspection when ground is opened so sanitarian can recommend repair. 07/18/94

PUMP SYSTEM REQUIRED

PLANS APPROVED BY _____ DATE _____

COVER NO WORK UNTIL INSPECTED AND APPROVED

NEITHER THE HOWARD COUNTY COUNCIL NOR THE HEALTH DEPARTMENT IS RESPONSIBLE FOR THE SUCCESSFUL OPERATION OF ANY SYSTEM

NOTE: CLEANOUT REQUIRED EVERY 70 FEET OF SEWER LINE AND/OR AT 90° SWEEPS IN LINES FROM HOUSE TO DRAIN FIELDS, 90° ELBOWS NOT ACCEPTABLE.

NOTE: ALL PARTS OF SEPTIC SYSTEMS (I.E. TANK, DISTRIBUTION BOX TRENCHES) TO BE 100 FEET FROM WELL (UNLESS OTHERWISE SPECIFICALLY AUTHORIZED)

NOTE: IF DEEP TRENCH(ES) ARE USED CALL FOR INSPECTION BEFORE AND AFTER PLACING GRAVEL IN TRENCH(ES)

NOTE: NO DRY WELL SHALL EXCEED 15 FOOT IN DIAMETER NO ABSORPTION TRENCH TO EXCEED 100 FEET IN LENGTH

NOTE: ALL PIPE FROM HOUSE TO SEPTIC TANK MUST BE CAST IRON OR SCHEDULE 35/40 PVC OR ABS

PERMIT VOID AFTER TWO YEARS

NOTE: INSTALL STAND PIPE ON SEPTIC TANK AND DRY WELL STAND PIPES MUST BE 6 INCHES IN DIAMETER CAST IRON. CONCRETE OR TERRA COTTA OR PVA OR ABS ACCEPTED. IF TOP OF SEPTIC TANK IS DEEPER THAN 3 FEET. MANHOLE TO GRADE REQUIRED.

NOTE: DISTRIBUTION BOXES MUST HAVE BAFFLES

***INSTALLER IS RESPONSIBLE FOR OBTAINING FINAL APPROVAL ON THIS PERMIT**

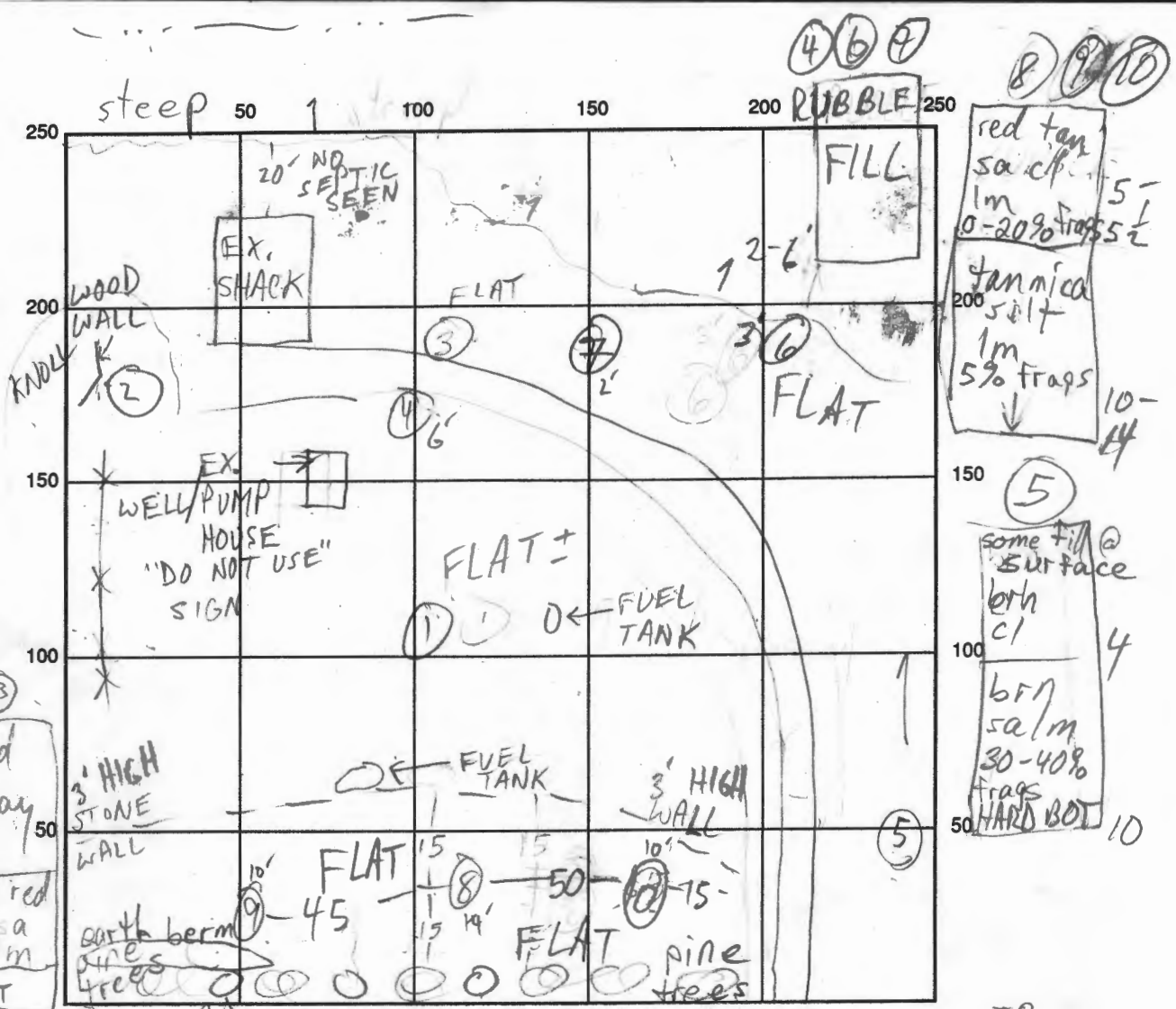
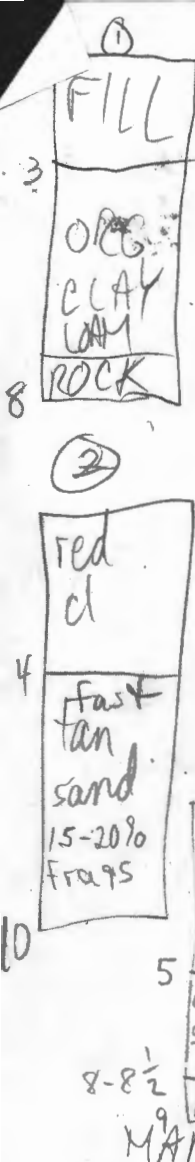

SEPTIC TANK LEVEL _____ CLEANOUTS _____

DISTRIBUTION BOX LEVEL _____

DRAIN FIELD/TITLE DEPTH _____ FT. TRENCH WIDTH _____ FT. INLET DEPTH _____ FT.

EFFECTIVE GRAVEL DEPTH _____ FT. TOTAL LENGTH _____ FT.

NUMBER OF TRENCHES _____ ONE SIDEWALL/BOTTOM AREA _____ SQ. FT.

DRYWALL INSIDE DIAMETER _____ FT. EFFECTIVE DEPTH BELOW INLET _____ FT.

ABSORBENT AREA _____ SQ. FT.

REMARKS: 7/19/94 3000 EST'D (8)-(9)-(10), ONLY AREA AVAIL. MR

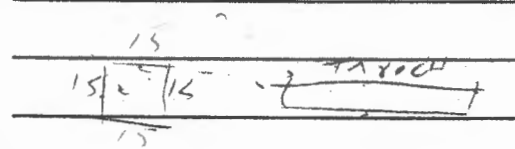

DATE SYSTEM APPROVED _____ INSPECTOR _____

4.9 5/ STONE



HOWARD COUNTY HEALTH DEPARTMENT

Joyce M. Boyd, M.D., County Health Officer
July 28, 1994

Mr. Charles Morar
2121 Carroll Dale Road
Sykesville, MD 21784

RE: Septic System Repair Testing
888 Marriottsville Road

Dear Mr. Morar,

Repair percolation testing conducted July 19, 1994 indicated limited satisfactory soil conditions. Fill soil and rubble fill were encountered in many locations tested, but satisfactory soils were found in a limited number of other locations in a confined area. This area is between the stone wall and the pine trees, and is likely to be the only available area with suitable soils. The minimum area usually desired is 10,000 square feet, but since this area comprises only about 3,000 square feet, precise septic system installation is critical.

Because this area is substantially higher than the existing house, a pumped septic system would be required. Additionally, because there is no existing legitimate septic system or potable water supply, this situation has numerous complications outside the realm of normal lot development.

Therefore, it is suggested that a conference be scheduled to discuss these concerns. Please call this office at 313-2640 to schedule an appointment for this conference, or if you have any other questions.

Very Truly Yours,

Mark E. Rifkin
Mark E. Rifkin
Sanitarian

MR

cc: Mr. Jack Fyock

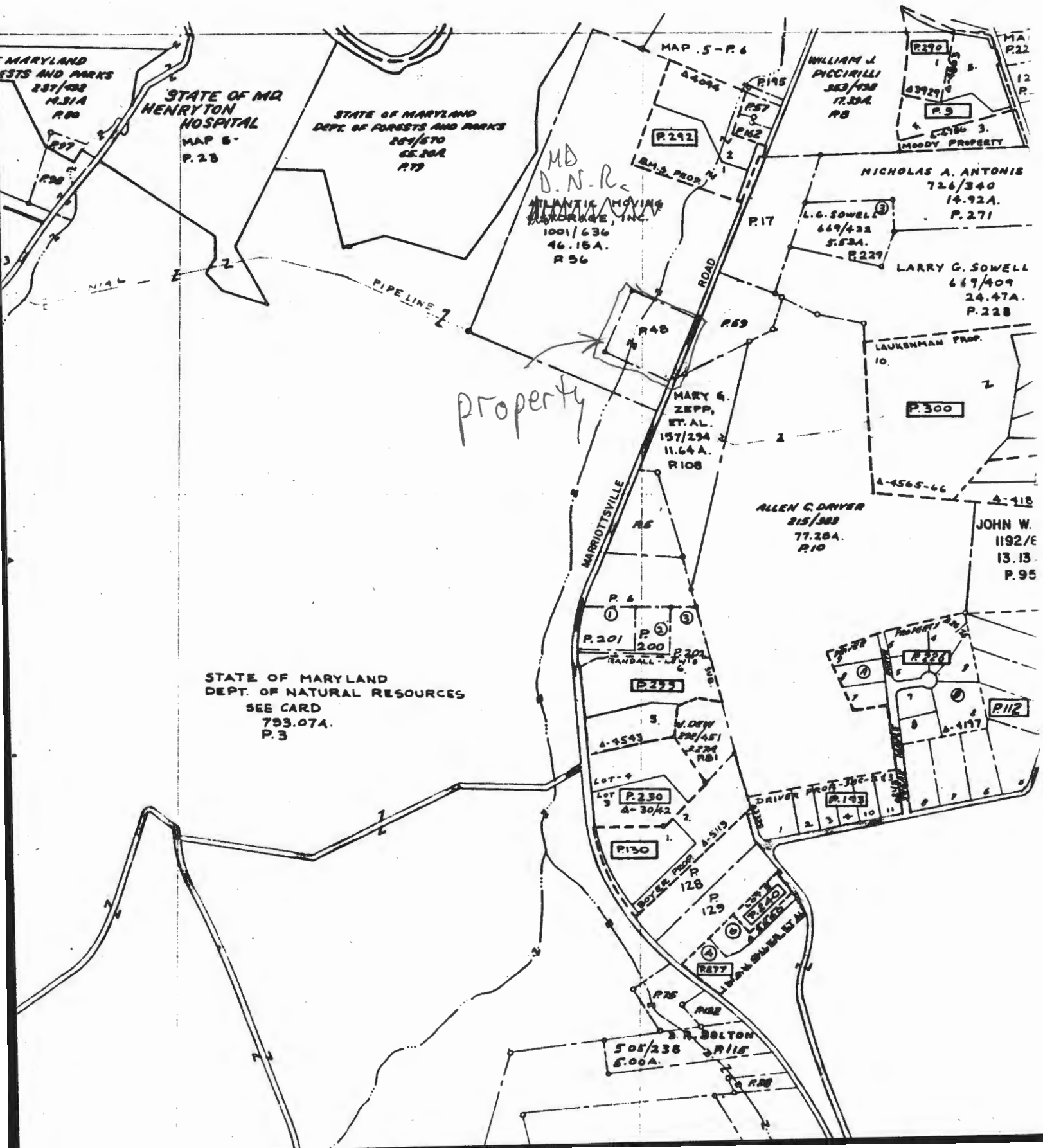

property

No record of
upgrading system
r

MARK - 6/27/97
YOU MAY
WANT TO FOLLOW
UP ON THIS
ONE

file //

ALM