

## Real Property Data Search ( w4)

Search Result for HOWARD COUNTY

View Map		View GroundRent Redemption			View GroundRent Registration				
<b>Tax Exempt:</b>		<b>Special Tax Recapture:</b>							
<b>Exempt Class:</b>		NONE							
<b>Account Identifier:</b>		<b>District - 03 Account Number - 296709</b>							
Owner Information									
<b>Owner Name:</b>		STATE OF MARYLAND			<b>Use:</b>		EXEMPT		
					<b>Principal Residence:</b>		NO		
<b>Mailing Address:</b>		301 W PRESTON ST BALTIMORE MD 21201-2305			<b>Deed Reference:</b>		/01036/ 00680		
Location & Structure Information									
<b>Premises Address:</b>		MARRIOTTSVILLE RD MARRIOTTSVILLE 21104-0000			<b>Legal Description:</b>		PARCEL A 144.197 ACR MARRIOTTSVILLE RD		
<b>Map:</b>	<b>Grid:</b>	<b>Parcel:</b>	<b>Sub District:</b>	<b>Subdivision:</b>	<b>Section:</b>	<b>Block:</b>	<b>Lot:</b>	<b>Assessment Year:</b>	<b>Plat No:</b>
0010	0005	0187		0003				2019	<b>Plat Ref:</b>
<b>Special Tax Areas:</b>					<b>Town:</b>		NONE		
					<b>Ad Valorem:</b>		103		
					<b>Tax Class:</b>				
<b>Primary Structure Built</b>		<b>Above Grade Living Area</b>		<b>Finished Basement Area</b>		<b>Property Land Area</b>		<b>County Use</b>	
						144.1900 AC			
<b>Stories</b>	<b>Basement</b>	<b>Type</b>	<b>Exterior</b>	<b>Full/Half Bath</b>	<b>Garage</b>	<b>Last Major Renovation</b>			
Value Information									
		<b>Base Value</b>		<b>Value</b>		<b>Phase-in Assessments</b>			
				As of		As of		As of	
				01/01/2019		07/01/2019		07/01/2020	
<b>Land:</b>		44,100		44,100					
<b>Improvements</b>		0		0					
<b>Total:</b>		44,100		44,100		44,100		44,100	
<b>Preferential Land:</b>		0						0	
Transfer Information									
<b>Seller:</b> STEINER ERICH E & <b>Type:</b> ARMS LENGTH IMPROVED				<b>Date:</b> 01/09/1981 <b>Deed1:</b> /01036/ 00680		<b>Price:</b> \$396,550 <b>Deed2:</b>			
<b>Seller:</b>				<b>Date:</b>		<b>Price:</b>			
<b>Type:</b>				<b>Deed1:</b>		<b>Deed2:</b>			
<b>Seller:</b>				<b>Date:</b>		<b>Price:</b>			
<b>Type:</b>				<b>Deed1:</b>		<b>Deed2:</b>			
Exemption Information									
<b>Partial Exempt Assessments:</b>		<b>Class</b>			07/01/2019		07/01/2020		
<b>County:</b>		350			44,100.00		44,100.00		
<b>State:</b>		350			44,100.00		44,100.00		
<b>Municipal:</b>		350			0.00 0.00		0.00 0.00		
<b>Tax Exempt:</b>		<b>Special Tax Recapture:</b>							
<b>Exempt Class:</b>		NONE							
Homestead Application Information									

**Homestead Application Status:** No Application

Homeowners' Tax Credit Application Information

---

**Homeowners' Tax Credit Application Status:** No Application      **Date:**

---

1. This screen allows you to search the Real Property database and display property records.
2. Click **here** for a glossary of terms.
3. Deleted accounts can only be selected by Property Account Identifier.
4. The following pages are for information purpose only. The data is not to be used for legal reports or documents. While we have confidence in the accuracy of these records, the Department makes no warranties, expressed or implied, regarding the information.



1140 DRIVER RD



**MARYLAND DEPARTMENT OF THE ENVIRONMENT**

1800 Washington Boulevard • Baltimore MD 21230

410-537-3000 • 1-800-633-6101

Robert L. Ehrlich, Jr.  
Governor

Kend P. Philbrick  
Secretary

Michael S. Steele  
Lt. Governor

Jonas A. Jacobson  
Deputy Secretary

March 1, 2005

COLONIAL PIPELINE COMPANY  
929 HOODS MILL ROAD  
WOODBINE, MD 21797

RE: State Water Appropriation  
Permit No. HO1983G002(03)  
Revision 03

Dear Permittee:

Enclosed is your State Water Appropriation Permit. The permittee is responsible for complying with all permit conditions. Accordingly, you are advised to carefully read the Permit and become thoroughly familiar with its requirements.

If you have any questions, please contact this office at (410)537-3590.

Sincerely,

MARK T. FILAR  
Water Supply Program

cc: HOWARD COUNTY HEALTH DEPARTMENT

**STATE OF MARYLAND**  
**DEPARTMENT OF THE ENVIRONMENT**  
**WATER MANAGEMENT ADMINISTRATION**

**WATER APPROPRIATION AND USE PERMIT**

PERMIT NUMBER: HO1983G002 (03)

EFFECTIVE DATE: MARCH 1, 2005

EXPIRATION DATE: MARCH 1, 2017

FIRST APPROPRIATION: APRIL 1, 1983

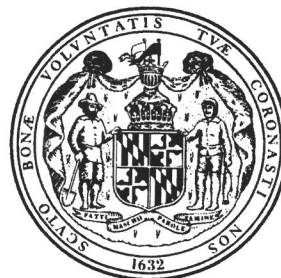

COLONIAL PIPELINE COMPANY

HEREINAFTER REFERRED TO AS THE "PERMITTEE", IS AUTHORIZED BY THE WATER MANAGEMENT ADMINISTRATION, HEREINAFTER REFERRED TO AS THE "ADMINISTRATION" PURSUANT TO THE PROVISIONS OF TITLE 5 OF THE ENVIRONMENT ARTICLE, ANNOTATED CODE OF MARYLAND (1996 REPLACEMENT VOLUME) AS AMENDED, TO APPROPRIATE AND USE WATERS OF THE STATE SUBJECT TO THE FOLLOWING CONDITIONS:

1. ALLOCATION - THE WATER WITHDRAWAL GRANTED BY THIS PERMIT IS LIMITED TO:  
A DAILY AVERAGE OF 100 GALLONS ON A YEARLY BASIS AND  
A DAILY AVERAGE OF 200 GALLONS FOR THE MONTH OF MAXIMUM USE.
2. USE - THE WATER IS TO BE USED FOR BUILDING AND GROUNDS CLEAN UP.
3. SOURCE - THE WATER SHALL BE TAKEN FROM ONE WELL IN THE BALTIMORE GNEISS.
4. LOCATION - THE POINT(S) OF WITHDRAWAL SHALL BE LOCATED AT 1085 DRIVER ROAD, 3.25 MILES NORTH OF MD ROUTE 99, 0.5 MILE EAST OF MARRIOTTSTVILLE ROAD, HOWARD COUNTY, MARYLAND.

CONTINUED ON PAGE 2

5. RIGHT OF ENTRY - THE PERMITTEE SHALL ALLOW AUTHORIZED REPRESENTATIVES OF THE ADMINISTRATION ACCESS TO THE PERMITTEE'S FACILITY TO CONDUCT INSPECTIONS AND EVALUATIONS NECESSARY TO ASSURE COMPLIANCE WITH THE CONDITIONS OF THIS PERMIT. THE PERMITTEE SHALL PROVIDE SUCH ASSISTANCE AS MAY BE NECESSARY TO EFFECTIVELY AND SAFELY CONDUCT SUCH INSPECTIONS AND EVALUATIONS.
6. PERMIT REVIEW - THE PERMITTEE WILL BE QUERIED EVERY THREE YEARS (TRIENNIAL REVIEW) REGARDING WATER USE UNDER THE TERMS AND CONDITIONS OF THIS PERMIT. FAILURE TO RETURN THE TRIENNIAL REVIEW QUERY WILL RESULT IN SUSPENSION OR REVOCATION OF THIS PERMIT.
7. PERMIT RENEWAL - THIS PERMIT WILL EXPIRE ON THE DATE INDICATED ON THE FIRST PAGE OF THIS PERMIT. IN ORDER TO RENEW THE PERMIT THE PERMITTEE SHALL FILE A RENEWAL APPLICATION WITH THE ADMINISTRATION NO LATER THAN 45 DAYS PRIOR TO THE EXPIRATION.
8. PERMIT SUSPENSION OR REVOCATION - THIS PERMIT MAY BE SUSPENDED OR REVOKED BY THE ADMINISTRATION UPON VIOLATION OF THE CONDITIONS OF THIS PERMIT, OR UPON VIOLATION OF ANY REGULATION PROMULGATED PURSUANT TO TITLE 5 OF THE ENVIRONMENT ARTICLE, ANNOTATED CODE OF MARYLAND (1996 REPLACEMENT VOLUME) AS AMENDED.
9. CHANGE OF OPERATIONS - ANY ANTICIPATED CHANGE IN APPROPRIATION WHICH MAY RESULT IN A NEW OR DIFFERENT USE, QUANTITY, SOURCE, OR PLACE OF USE OF WATER SHALL BE REPORTED TO THE ADMINISTRATION BY THE PERMITTEE BY SUBMISSION OF A NEW APPLICATION.
10. ADDITIONAL PERMIT CONDITIONS - THE ADMINISTRATION MAY AT ANYTIME (INCLUDING TRIENNIAL PERMIT REVIEW OR WHEN A CHANGE APPLICATION IS SUBMITTED) REVISE ANY CONDITION OF THIS PERMIT OR ADD ADDITIONAL CONDITIONS CONCERNING THE CHARACTER, AMOUNT, MEANS AND MANNER OF THE APPROPRIATION OR USE, WHICH MAY BE NECESSARY TO PROPERLY PROTECT, CONTROL AND MANAGE THE WATER RESOURCES OF THE STATE. CONDITION REVISIONS AND ADDITIONS WILL BE ACCOMPLISHED BY ISSUANCE OF A REVISED PERMIT.

11. DROUGHT PERIOD EMERGENCY RESTRICTIONS - IF THE DEPARTMENT DETERMINES THAT A DROUGHT PERIOD OR EMERGENCY EXISTS, THE PERMITTEE MAY BE REQUIRED UNDER THE DEPARTMENT'S DIRECTION TO STOP OR REDUCE WATER USE. ANY CESSATION OR REDUCTION OF WATER USE MUST CONTINUE FOR THE DURATION OF THE DROUGHT PERIOD OR EMERGENCY, OR UNTIL THE DEPARTMENT DIRECTS THE PERMITTEE THAT WATER USE UNDER STANDARD PERMIT CONDITIONS MAY BE RESUMED.
12. NON-TRANSFERRABLE - THIS PERMIT IS NON-TRANSFERRABLE. A NEW OWNER MAY ACQUIRE AUTHORIZATION TO CONTINUE THIS APPROPRIATION BY FILING A NEW APPLICATION WITH THE ADMINISTRATION. AUTHORIZATION WILL BE ACCOMPLISHED BY ISSUANCE OF A NEW PERMIT.
13. WATER LEVEL MEASUREMENTS - FOR ALL THE APPLICANT'S WELLS FOUR (4) INCHES IN DIAMETER OR LARGER, PUMPING EQUIPMENT SHALL BE INSTALLED SO THAT WATER LEVELS CAN BE MEASURED DURING PUMPING AND NONPUMPING PERIODS WITHOUT DISMANTLING ANY EQUIPMENT. ANY OPENING FOR TAPE MEASUREMENTS OF WATER LEVELS SHALL HAVE A MINIMUM INSIDE DIAMETER OF 0.5 INCHES AND BE SEALED BY A REMOVABLE CAP OR PLUG. THE PERMITTEE SHALL PROVIDE A TAP FOR TAKING RAW WATER SAMPLES BEFORE WATER ENTERS A TREATMENT FACILITY, PRESSURE TANK, OR STORAGE TANK.
14. PERMIT SUPERSESSION - THIS PERMIT HAS BEEN REVIEWED AND REVISED AND SUPERSEDES THE APPROPRIATION AND USE GRANTED BY THE FOLLOWING PRIOR PERMIT ISSUED TO:  
COLONIAL PIPELINE COMPANY ON APRIL 1, 1993 (HO1983G002(02))

BY AUTHORITY OF THE DIRECTOR  
WATER MANAGEMENT ADMINISTRATION

*John W. Grace* 3/7/05  
John W. Grace, Chief  
SOURCE PROTECTION AND APPROPRIATION DIV

# APPLICATION

SEWAGE DISPOSAL TESTING

A 31380

STATE OF MARYLAND - DEPARTMENT OF HEALTH AND MENTAL HYGIENE

P \_\_\_\_\_

HOWARD COUNTY HEALTH DEPARTMENT 1000 GAL TANK

ENVIRONMENTAL HEALTH SERVICES

TIEFIELD - 360 SQ FT

DISTRICT 3RD

P. O. BOX 473 ELLICOTT CITY, MARYLAND 21043  
TELEPHONE: 992-2330

DATE MAY 14, 1981

*5/26/81 9:30 A.M.*

BOTTOM AREA

DITCH TO BE 2 FT TO 4 FT DEEP BELOW ORIGINAL GRADE 3 FT WIDE, 120 FT LONG WITH A DISTRIBUTION BOX: FILL THE DITCH WITH 1-1 1/2 FT OF STONE

INSTALL THE DITCH BETWEEN PERC HOLE (4) LOCATED 75 FT FROM THE BACK LOT LINE & 112 FT FROM THE RIGHT SIDE OF THE LOT AS SEEN

TO: THE COUNTY HEALTH OFFICER  
ELLICOTT CITY, MARYLAND

I HEREBY APPLY FOR THE NECESSARY TEST IN ORDER TO CONSTRUCT (OR RECONSTRUCT) A SEWAGE DISPOSAL SYSTEM.

PROPERTY OWNER

COLONIAL PIPE LINE (LEASEE)

ADDRESS

P.O. Box 14525 RICHMOND VIRGINIA 23221

PHONE

(804) 285-2086

PROPERTY LOCATION:

WHEN FACING THE LOT FROM DRIVER RD AND PERC HOLE # 3 LOCATED 26 FT FROM THE BACK LOTLINE

SUBDIVISION

AND 17 FT FROM THE RIGHT SIDE OF THE LOT

ROAD AND DESCRIPTION

7000<sup>th</sup> NORTHEAST FROM INTERSECTION OF MARRIOTTVILLE ROAD AND DRIVER ROAD AS SEEN WHEN FACING THE LOT FROM DRIVER RD

SIZE OF LOT

1.0 AC. ±

TYPE BLDG.

SUB STATION

(NUMBER OF BEDROOMS)

THE SYSTEM INSTALLED UNDER THIS APPLICATION IS ACCEPTABLE ONLY UNTIL PUBLIC FACILITIES BECOME AVAILABLE. I FULLY UNDERSTAND THE FEE CONNECTED WITH THE FILING OF THIS PERC TEST APPLICATION IS NON-REFUNDABLE UNDER ANY CIRCUMSTANCES. I ALSO AGREE TO COMPLY

WITH ALL M.O.S.H.A. REQUIREMENTS IN TESTING THIS LOT.

Charles J. Crow

(SIGNATURE OF APPLICANT)

APPROVED BY

Raymond P. Pender

FOR

Tale Field

DATE

6/4/81

REJECTED BY

FOR

DATE

HOLD PENDING FURTHER TESTS

DATE

REASONS FOR REJECTION OR HOLDING

5/21/81 FS REVIEWED PERCS & DECIDED 2 MORE

HOLES NEEDED AT 5/26/81 - 2 HOLES DUG LOOK OK

FOR REVIEW (ROCK) 6/1/81 PLAT OK But Hold for Review with FS (rock)

# THIS IS NOT A PERMIT



Prel.

# APPLICATION

SEWAGE DISPOSAL TESTING

STATE OF MARYLAND - DEPARTMENT OF HEALTH AND MENTAL HYGIENE

HOWARD COUNTY HEALTH DEPARTMENT  
ENVIRONMENTAL HEALTH SERVICES  
P. O. BOX 473 ELLICOTT CITY, MARYLAND 21043  
TELEPHONE: 992-2330

A 31380  
P \_\_\_\_\_  
DISTRICT 3<sup>RD</sup>  
DATE MAY 14, 1981

TO: THE COUNTY HEALTH OFFICER  
ELLICOTT CITY, MARYLAND

I, HEREBY, APPLY FOR THE NECESSARY TEST IN ORDER TO CONSTRUCT (OR RECONSTRUCT) A SEWAGE DISPOSAL SYSTEM.

PROPERTY OWNER COLONIAL PIPE LINE (LEASEE)  
ADDRESS P.O. BOX 14525 RICHMOND VIRGINIA 23221 PHONE (804) 285-2086

PROPERTY LOCATION:

SUBDIVISION \_\_\_\_\_ LOT NO. \_\_\_\_\_

ROAD AND DESCRIPTION 7000 ± NORTHEAST FROM INTERSECTION OF MARRIOTTSVILLE ROAD AND DRIVER ROAD

SIZE OF LOT 1.0 AC. ± TYPE BLDG. SUB STATION  
(NUMBER OF BEDROOMS)

THE SYSTEM INSTALLED UNDER THIS APPLICATION IS ACCEPTABLE ONLY UNTIL PUBLIC FACILITIES BECOME AVAILABLE. I FULLY UNDERSTAND THE FEE CONNECTED WITH THE FILING OF THIS PERC TEST APPLICATION IS NON-REFUNDABLE UNDER ANY CIRCUMSTANCES. I ALSO AGREE TO COMPLY

WITH ALL M.O.S.H.A. REQUIREMENTS IN TESTING THIS LOT. Charles J. Cross  
(SIGNATURE OF APPLICANT)

APPROVED BY \_\_\_\_\_ FOR \_\_\_\_\_ DATE \_\_\_\_\_

REJECTED BY \_\_\_\_\_ FOR \_\_\_\_\_ DATE \_\_\_\_\_

HOLD PENDING FURTHER TESTS \_\_\_\_\_ DATE \_\_\_\_\_

REASONS FOR REJECTION OR HOLDING \_\_\_\_\_  
\_\_\_\_\_  
\_\_\_\_\_

## THIS IS NOT A PERMIT

SOIL PROFILE

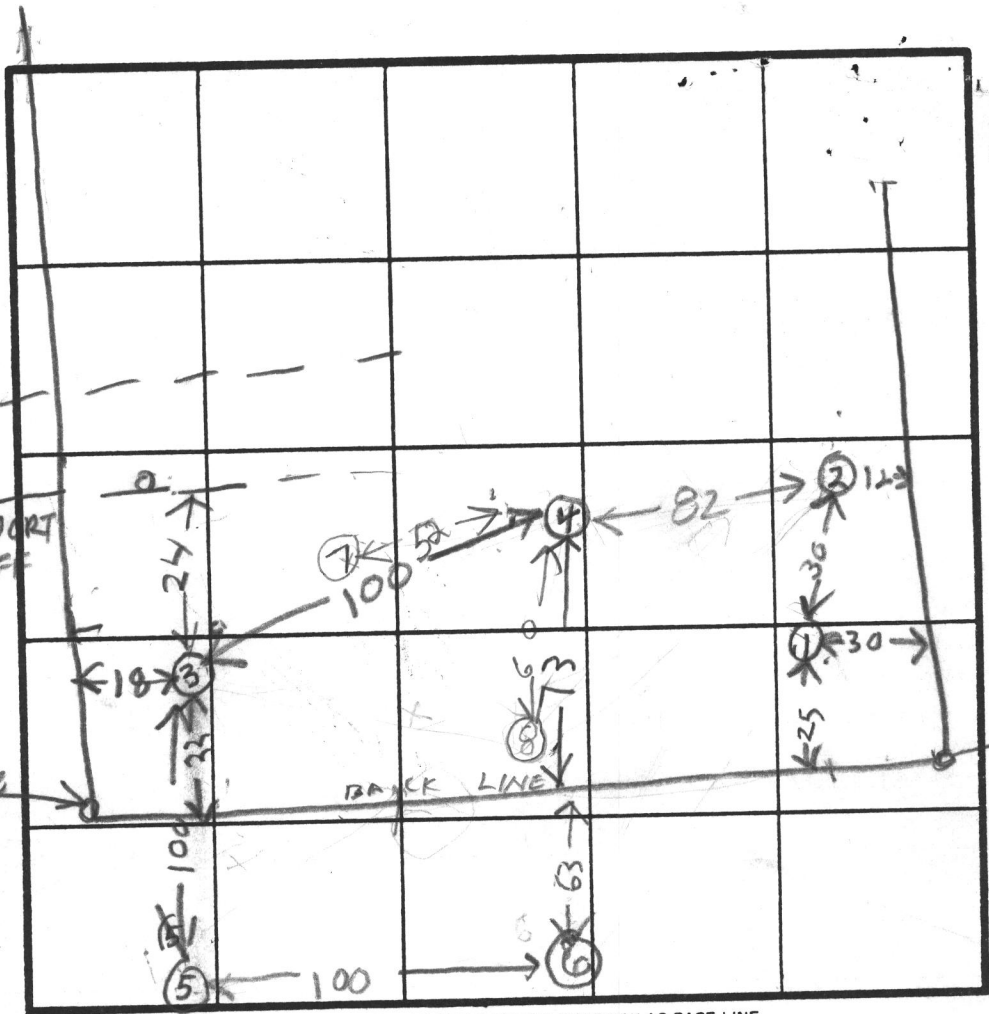
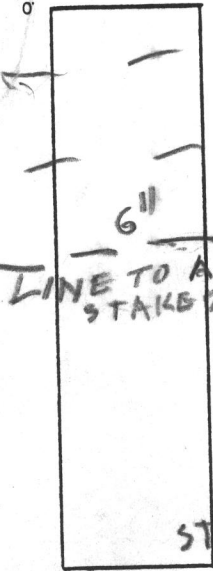

SEE PLAT

X = PROPOSED NEW PERC HOLES

INDICATE NORTH - NAME ADJOINING ROADWAY AS BASE LINE.

DATE	TEST NO.	DEPTH	PRE-WET		TEST - 1" DROP		TIME
			START	STOP	START	STOP	
5/20/81	1V	5	ALL SAND ROCK BOTTOM				
	2V	10	TOP 3 FT CLAY SAND ROCK BOTTOM				
	3V	13	ALL SAND ROCK BOTTOM				
	3S	3	221	222	222	225	3
	3D	7	228	229	229	230	1
	4V	11	ALL SAND ROCK BOTTOM		DANGER CAVE IN		
	4S	3	251	253	253	300	7
	5V	9 1/2	SAND WITH BOULDERS ROCK BOTTOM				
	6V	8	ALL SAND ROCK BOTTOM				
5/26/81	7S	3	1108	1109	1109	1112	3
	7V	12	ALL SAND				
	8S	2	1117	1118	1118	1120	2
5/26/81	8V	12	ALL SAND				

REMARKS: 5/26/81 LATE START BACK HOLE STALLED

TYPE OF SOIL: B. HODGES

ALSO PRESENT: BRIP OF FYBOK CO, ANTHONY OF CROVO CO

EH-12-1079

B 1 1161 SEQUENCE NO. (OEP USE ONLY) 4/22/83 STATE OF MARYLAND PERMIT TO DRILL WELL (THIS NUMBER IS TO BE PUNCHED IN COLS. 3-6 ON ALL CARDS) (3hr) 12:30 P.E. 2:00 Grant please print or type

OEP PERMIT NUMBER 40-81-0056 fill in this form completely

Date Received 032283 OWNER INFORMATION COLONIAL PIPELINE CO. 929 Hoods MILL RD Woodbine Md 21797

B 3 LOCATION OF WELL HOWARD COUNTY Taxmap 10 parcel 187 SECTION 44 LOT 48 50 MARYLIOTT SUBCE NEAREST TOWN MILES FROM TOWN 2 MI

DRILLER INFORMATION Stanley W. Dollinger Jr. 308 STAN'S Well Drilling INC. PO Box 2035 West, Md 21157 3/22/83

B 4 DIRECTION OF WELL FROM TOWN (CIRCLE BOX) Driver Rd. NEAR WHAT ROAD ON WHICH SIDE OF ROAD (CIRCLE APPROPRIATE BOX) DISTANCE FROM ROAD 600 ENTER FT or MI

B 2 WELL INFORMATION APPROX. PUMPING RATE (GAL. PER MIN.) 5 AVERAGE DAILY QUANTITY NEEDED (GAL. PER DAY) 500

USE FOR WATER (CIRCLE APPROPRIATE BOX) D HOME (SINGLE OR DOUBLE HOUSEHOLD UNIT ONLY) F FARMING (LIVESTOCK WATERING & AGRICULTURAL IRRIGATION) I INDUSTRIAL, COMMERCIAL, STATE AND FEDERAL GOV. OTHER (REQUIRES APPROPRIATION PERMIT) P PUBLIC OR PRIVATE WATER COMPANY (REQUIRES APPROPRIATION PERMIT AND STATE HEALTH DEPARTMENT APPROVAL) T TEST, OBSERVATION, MONITORING (MAY REQUIRE APPROPRIATION PERMIT)

NOT TO BE FILLED IN BY DRILLER HEALTH DEPARTMENT APPROVAL HOWARD COUNTY NAME A31380 COUNTY NO. OEP SIGNATURE DATE ISSUED 04/14/83 Frank Sherrin 10/14/83 EXP. DATE NORTH GRID 549 0 0 0 EAST GRID 0830 0 0 0

APPROXIMATE DEPTH OF WELL 165 FEET APPROXIMATE DIAMETER OF WELL 6 INCH NEAREST

SHOW MAJOR FEATURES OF BOX & LOCATE WELL WITH AN X SOURCES OF DRILLING WATER 1. WELL 2. 3. WRITE THE BOX NUMBER FROM THE MAP HERE 830 0 540 9

METHOD OF DRILLING (circle one) BORED (or Augered) JETTED Jetted & DRIVEN AIR-ROtary AIR-PERcussion ROTARY (Hydraulic Rotary) CABLE REVerse-ROtary DRive-POINT other Orange paper

REPLACEMENT OR DEEPEMED WELLS (CIRCLE APPROPRIATE BOX) N THIS WELL WILL NOT REPLACE AN EXISTING WELL Y THIS WELL WILL REPLACE A WELL THAT WILL BE ABANDONED AND SEALED S THIS WELL WILL REPLACE A WELL THAT WILL BE USED AS A STANDBY D THIS WELL WILL DEEPEAN AN EXISTING WELL PERMIT NUMBER OF WELL TO BE REPLACED OR DEEPEMED (IF AVAILABLE)

DRAW A SKETCH BELOW SHOWING LOCATION OF WELL IN RELATION TO NEARBY TOWNS AND ROADS AND GIVE DISTANCE FROM WELL TO NEAREST ROAD JUNCTION MARYLIOTT SUBCE DRIVER RD. 600' X WELL

Not to be filled in by driller (OEP USE ONLY) APPROP. PERMIT NUMBER H083 GAP 002 FORCE FS WRITE INITIALS IN BOX PERMIT No. 40-81-0056

SPECIAL CONDITIONS

4/22/83

- ① LOCATION OR PER PLANE
- ② 34 FT CASING 2 FT OUT OF GROUND
- ③ 32 FT OPEN HOLE
- ④ 7 BAGS
- ⑤ WELL OK

RH



# APPLICATION FOR A PERMIT TO APPROPRIATE AND USE WATERS OF THE STATE

Water Resources Administration  
Water Supply Section  
Tawes Office Building  
Annapolis, Maryland 21401

- Surface Water   
  Groundwater   
  New Application   
  Change in Existing Permit

Number \_\_\_\_\_

### APPLICATION

COLONIAL PIPELINE CO.  
(Owner's Name) 1-795-1390

929 HOODS MILL RD WOODBINE MD.  
(Owner's Address) (Street) (Town) (State) (Zip Code)

### WITHDRAWAL

#### GROUNDWATER

Appropriate and use a yearly average of  
100 GALLON PER YEAR FROM ONE YARD  
\_\_\_\_\_ gallons per day.

[total annual use - 365 days]  
and 50g/day when used  
\_\_\_\_\_ gallons  
[highest total monthly use - days in month]

for the average day of the maximum month, from  
\_\_\_\_\_ well(s) having a diameter of

1  
\_\_\_\_\_ inches, and a depth of

6  
\_\_\_\_\_ ft.

#### SURFACE WATER

Appropriate and use a yearly average of  
\_\_\_\_\_ gallons per

day, and a maximum use of \_\_\_\_\_  
gallons in any one day, from:

\_\_\_\_\_ (name of stream)  
\_\_\_\_\_ (exact location of withdrawal)

### PROJECT LOCATION

1079 DRIVER ROAD  
[Location - be specific]

County HOWARD Subdivision or town MARIOTTVILLE Phone number 795-1390

Name and type of business COLONIAL PIPELINE CO. REFINED PETROLEUM PRODUCTS

**ALL APPLICATIONS MUST INCLUDE A COPY OF A U.S.G.S. TOPOGRAPHIC OR SIMILAR MAP SHOWING PROJECT**

### PURPOSE

- The water will be used for:
- Community Water Supply
  - Non-Potable supply (sanitary uses, not for drinking water)
  - Potable Supply (drinking water, etc.)
  - Cooling Water
  - Irrigation
  - Process Water
  - Other WATER FOR

BUILDING & GROUNDS CLEAN UP  
2 TIMES A YEAR  
[explain]

### WASTEWATER TREATMENT AND DISPOSAL

- Public Sewer \_\_\_\_\_ [name of system]
- Groundwater
  - Subsurface (tilefield, seepage pit, etc.)
  - Spray Irrigation
  - Other, explain \_\_\_\_\_
- Surface Water \_\_\_\_\_ [name of stream]

Discharge Permit # \_\_\_\_\_  
or applied for \_\_\_\_\_

### SIGNATURE

Please sign here Bruce T. Giles  
[signature]  
BRUCE T. GILES, INSPECTOR 3-24-83  
[please print name, title, and date here]

**THIS APPLICATION CANNOT BE  
PROCESSED  
WITHOUT SIGNATURE**

### APPROVAL BY COUNTY HEALTH DEPARTMENT OR DESIGNATED AGENCY

#### THIS SECTION NOT TO BE COMPLETED BY APPLICANT

Is this Project consistent with the County Water and Sewerage Plan and local planning and zoning?  
 YES     NO, explain \_\_\_\_\_

Signature of county representative Fred Shuman Sanitarian, Howard County Health Dept 3/24/83  
[signature] [title] [date]

Sent 3/24/83  
P.M.  
7-5

C1 7695

SEQUENCE NO. (OEP USE ONLY)

STATE OF MARYLAND WELL COMPLETION REPORT

THIS REPORT MUST BE SUBMITTED WITHIN 45 DAYS AFTER WELL IS COMPLETED.

(THIS NUMBER IS TO BE PUNCHED IN COLS. 3-6 ON ALL CARDS)

COUNTY NUMBER A 31380

Date Received (OEP use only)

DATE WELL COMPLETED 042283

Depth of Well 100

PERMIT NO.

FROM "PERMIT TO DRILL WELL" 40-81-0056

OWNER Colonial Pipeline Company last name first name

STREET OR RFD Driver Road

TOWN Marriottsville

SUBDIVISION tax map 10 parcel 187

WELL LOG Not required for driven wells STATE THE KIND OF FORMATIONS PENETRATED, THEIR COLOR, DEPTH, THICKNESS AND IF WATER BEARING

Table with columns: DESCRIPTION, FEET FROM, FEET TO, Check if water bearing. Rows include Top Soil, Brown Shale, Sandstone, Granite, etc.

GROUTING RECORD WELL HAS BEEN GROUTED (Circle Appropriate Box) YES Y NO N

TYPE OF GROUTING MATERIAL CEMENT CM BENTONITE CLAY BC NO. OF BAGS 7 NO. OF POUNDS 638

CASING RECORD casing types insert appropriate code below ST STEEL CO CONCRETE PL PLASTIC OT OTHER

MAIN CASING TYPE ST Nominal diameter top(main)casing (nearest inch) 6 Total depth of main casing (nearest foot) 34

OTHER CASING (if used) diameter inch depth (feet) from to

SCREEN RECORD screen type or openhole insert appropriate code below ST STEEL BR BRASS BRONZE PL PLASTIC HO OPEN HOLE OT OTHER

DEPTH (nearest ft.) 40 31 100

SLOT SIZE DIAMETER OF SCREEN (NEAREST INCH)

GRAVEL PACK IF WELL DRILLED WAS FLOWING WELL CIRCLE BOX F

OEP USE ONLY (NOT TO BE FILLED IN BY DRILLER) T (E.R.O.S.) W Q LOG INDICATOR OTHER DATA

LOT C 3 (seq no)

PUMPING TEST HOURS PUMPED (nearest hour) 3

PUMPING RATE (gal. per min. to nearest gal.) 10 METHOD USED TO MEASURE PUMPING RATE Bucket

WATER LEVEL (distance from land surface) BEFORE PUMPING 30 WHEN PUMPING 36

TYPE OF PUMP USED (for test) A air C centrifugal J jet P piston R rotary S submersible T turbine O other (describe below)

PUMP INSTALLED DRILLER WILL INSTALL PUMP (CIRCLE APPROPRIATE BOX) YES Y NO N

IF DRILLER INSTALLS PUMP, THIS SECTION MUST BE COMPLETED FOR ALL WELLS EXCEPT HOME USE

TYPE OF PUMP (WRITE APPROPRIATE LETTER IN BOX - SEE ABOVE: (A, C, J, P, R, S, T, O))

CAPACITY: GALLONS PER MINUTE (to nearest gallon)

PUMP HORSE POWER

PUMP COLUMN LENGTH (nearest ft.)

CASING HEIGHT (circle appropriate box and enter casing height) above below LAND SURFACE

LOCATION OF WELL ON LOT SHOW PERMANENT STRUCTURE SUCH AS BUILDING, SEPTIC TANKS, AND/OR LANDMARKS AND INDICATE NOT LESS THAN TWO DISTANCES (MEASUREMENTS TO WELL)

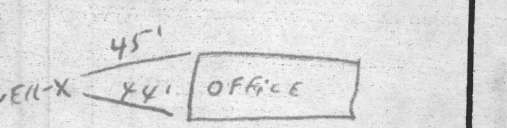

- CIRCLE APPROPRIATE BOX A A WELL WAS ABANDONED AND SEALED WHEN THIS WELL WAS COMPLETED E ELECTRIC LOG OBTAINED P TEST WELL CONVERTED TO PRODUCTION WELL

I HEREBY CERTIFY THAT THIS WELL HAS BEEN CONSTRUCTED IN ACCORDANCE WITH COMAR 10.17.13 "WELL CONSTRUCTION" AND IN CONFORMANCE WITH ALL CONDITIONS STATED IN THE ABOVE CAPTIONED PERMIT...

DRILLERS IDENT. NO. 308

DRILLERS SIGNATURE (Must match signature on application)

SITE SUPERVISOR (sign of driller or journeyman responsible for sitework if different from permittee)



STATE OF MARYLAND  
DEPARTMENT OF HEALTH AND MENTAL HYGIENE  
LABORATORIES ADMINISTRATION  
REPORT OF WATER ANALYSIS

Bottle Number: H9245 Name: COLONIAL PIPELINE CO. County: HOWARD

Source of Sample: PIPELINE STATION DRIVER RD Collector: HODGES  
Street Town or City

Sample Type (Circle): Community Source Non-Community Distribution Private MCL Emergency Recheck Routine

Remarks: MARRIOTTSVILLE NITRATE ONLY  
WELL# HO 81-0056

County: 13 Plant No. [ ] [ ] [ ] Sampling Station: [ ] [ ] [ ] Date Collected: 04 22 83 Time: 02 P M Acid:  Iced:

Field Data: pH\*: [ ] [ ] Chlorine Residual: [ ] [ ] Free: [ ] [ ] Total: [ ] [ ] Specific Conductance: [ ] [ ] [ ] [ ] [ ] [ ]

ANALYSIS	CODE	RESULTS	ANALYSIS	CODE	RESULTS
pH*	011		Arsenic	253	
Alkalinity (Total)	040		Barium	262	
Alkalinity (HCO <sub>3</sub> )	050		Cadmium	273	
Alkalinity (CO <sub>3</sub> )	060		Chromium	283	
pH*, Ca CO <sub>3</sub> SAT.	071		Lead	302	
Alkalinity, Ca CO <sub>3</sub> SAT	080		Mercury	314	
Hardness	110		Selenium	323	
Ammonia-N	143		Silver	333	
<input checked="" type="checkbox"/> Nitrate-Nitrite N	162	<u>0.8</u>	Aluminum	192	
Nitrite N	173		Calcium	231	
MBAS	182		Copper	241	
Chloride	091		Iron	122	
Fluoride	101		Magnesium	241	
Color*	020		Manganese	133	
Turbidity*	031		Nickel	391	
Conductance*, SPEC.	201		Potassium	361	
Silica	210		Sodium	371	
Sulfate	220		Zinc	342	
Total Residue	381				

\* Results reported in units, all others in milligrams per liter (ppm)  
Date Received: APR 6 1983 Date Reported: APR 29 1983 Chemist: Bruce L. Solnick, Ph.D. Lab No.: 13314



RECEIVED  
HEALTH  
ELECT

APR 13 9 35 AM '83

THOMAS C. ANDREWS  
DIRECTOR

STATE OF MARYLAND  
DEPARTMENT OF NATURAL RESOURCES  
**WATER RESOURCES ADMINISTRATION**  
TAWES STATE OFFICE BUILDING  
ANNAPOLIS, MARYLAND 21401  
Water Supply Division  
(301-269-3675)

MEMORANDUM

TO: County Health Department, *HOWARD Co., ENVIRONMENTAL HEALTH*

VIA:

FROM: *MARINA GOPENKO*

DATE: *04/05/83*

Water Appropriation Permit: *H083GAP002*

Issued to: *COLONIAL PEPPER COE COMPANY*

Effective date: *04/12/83*

Please fill-in the well permit number(s) for this project below and return this form to the Water Supply Division at the above address.

Thank you.

Well Permit number(s): (*well TAG NO.*) *H0-81-0056*

Issued date: *4/14/83*

check here if no well permits issued at this time.