

Real Property Data Search (w3)

Search Result for HOWARD COUNTY

View Map		View GroundRent Redemption			View GroundRent Registration				
Tax Exempt:		Special Tax Recapture:							
Exempt Class:		NONE							
Account Identifier:		District - 03 Account Number - 279871							
Owner Information									
Owner Name:		STATE OF MARYLAND DEPT OF NATURAL RESOURCES			Use:		EXEMPT		
Mailing Address:		301 W PRESTON ST RM 1309 BALTIMORE MD 21201-2305			Principal Residence:		NO		
					Deed Reference:		/01583/ 00447		
Location & Structure Information									
Premises Address:		MARRIOTTSVILLE RD MARRIOTTSVILLE 21104-0000			Legal Description:		44.923 MARRIOTTSVILLE RD MARRIOTTSVILLE		
Map:	Grid:	Parcel:	Sub District:	Subdivision:	Section:	Block:	Lot:	Assessment Year:	Plat No:
0010	0003	0056		0002				2019	Plat Ref:
Special Tax Areas:					Town:		NONE		
					Ad Valorem:		103		
					Tax Class:				
Primary Structure Built		Above Grade Living Area		Finished Basement Area		Property Land Area		County Use	
						44.9200 AC			
Stories	Basement	Type	Exterior	Full/Half Bath	Garage	Last Major Renovation			
Value Information									
		Base Value		Value		Phase-in Assessments			
				As of		As of		As of	
				01/01/2019		07/01/2019		07/01/2020	
Land:		490,600		539,400					
Improvements		0		0					
Total:		490,600		539,400		506,867		523,133	
Preferential Land:		0						0	
Transfer Information									
Seller: MELIKER SANDRA J				Date: 12/30/1986		Price: \$94,338			
Type: ARMS LENGTH IMPROVED				Deed1: /01583/ 00447		Deed2:			
Seller: ATLANTIC MOV & STOR INC				Date: 06/29/1984		Price: \$63,000			
Type: ARMS LENGTH IMPROVED				Deed1: /01264/ 00377		Deed2:			
Seller:				Date:		Price:			
Type:				Deed1:		Deed2:			
Exemption Information									
Partial Exempt Assessments:		Class		07/01/2019		07/01/2020			
County:		220		506,867.00		523,133.00			
State:		220		506,867.00		523,133.00			
Municipal:		220		0.00 0.00		0.00 0.00			
Tax Exempt:		Special Tax Recapture:							
Exempt Class:		NONE							
Homestead Application Information									

Homestead Application Status: No Application

Homeowners' Tax Credit Application Information

Homeowners' Tax Credit Application Status: No Application **Date:**

1. This screen allows you to search the Real Property database and display property records.
2. Click **here** for a glossary of terms.
3. Deleted accounts can only be selected by Property Account Identifier.
4. The following pages are for information purpose only. The data is not to be used for legal reports or documents. While we have confidence in the accuracy of these records, the Department makes no warranties, expressed or implied, regarding the information.

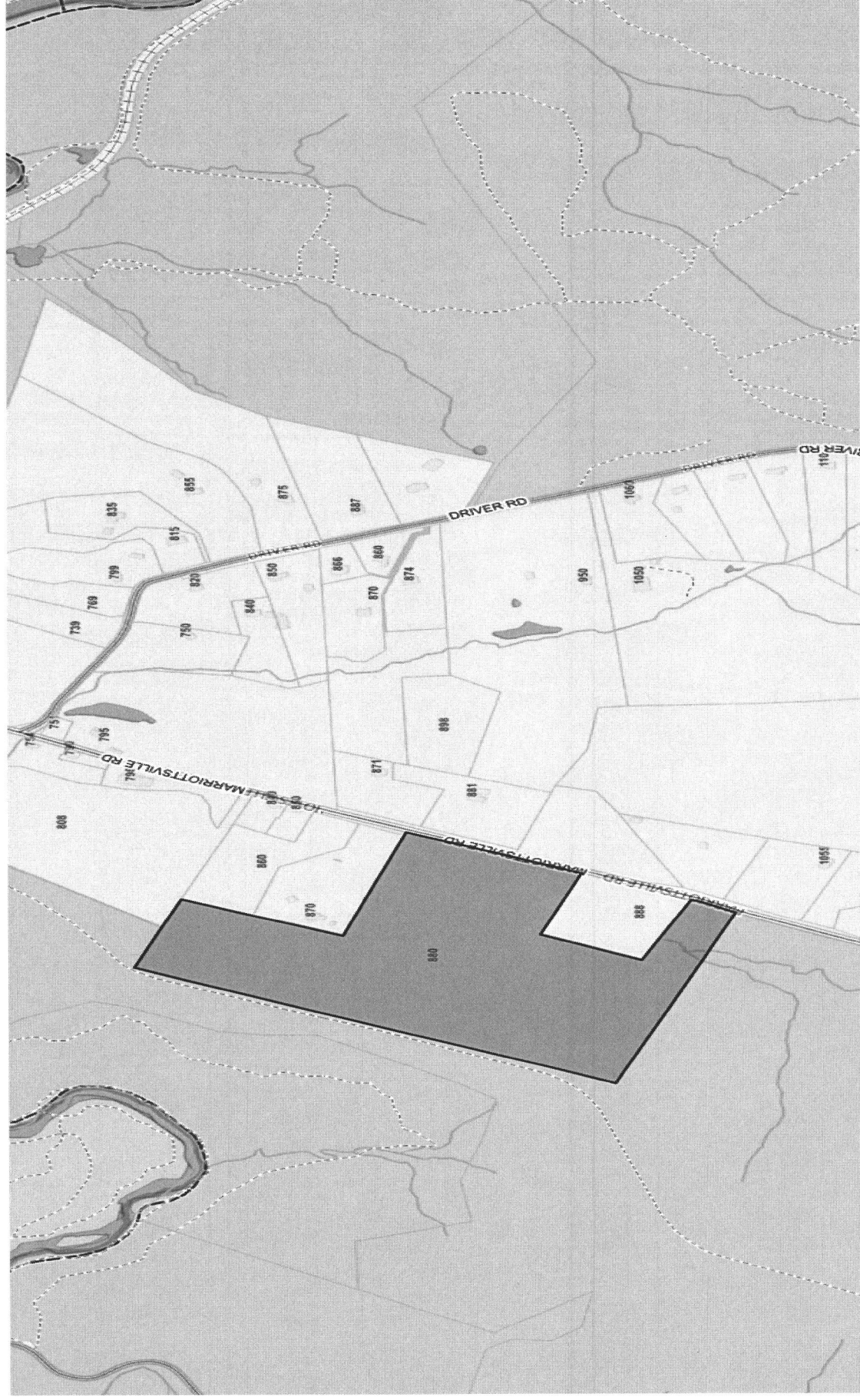

1105 MARRIOTTVILLE RD

APPLICATION

SEWAGE DISPOSAL TESTING

STATE OF MARYLAND - DEPARTMENT OF HEALTH AND MENTAL HYGIENE

A 30556

P _____

HOWARD COUNTY HEALTH DEPARTMENT
ENVIRONMENTAL HEALTH SERVICES
P.O. BOX 476 ELLICOTT, MARYLAND 21043
TELEPHONE: 992-2330

DISTRICT No. 3

DATE March 10, 1980

*4/13/80
9:30 A.M.
4/3/80
9:30 A.M.
3/24/80
9:30 A.M.
Paul
Rain*

TO: THE COUNTY HEALTH OFFICER
ELLICOTT CITY, MARYLAND

I, HEREBY, APPLY FOR THE NECESSARY TEST IN ORDER TO CONSTRUCT (OR RECONSTRUCT) A SEWAGE DISPOSAL SYSTEM.

PROPERTY OWNER Billy M. Smith Incorporated/ Buyer John & Pat Callison
ADDRESS 1002 Wilso Drive (Buyer) PHONE 525-2600 (Buyer)

PROPERTY LOCATION:

SUBDIVISION _____ LOT NO. None

ROAD AND DESCRIPTION Located on Westside Marriottsville Road
approx. 1600 ft. South of Driver Road

SIZE OF LOT 40+ Acres TYPE BLDG. Residential

THE SYSTEM INSTALLED UNDER THIS APPLICATION IS ACCEPTABLE ONLY UNTIL PUBLIC FACILITIES BECOME AVAILABLE.

I FULLY UNDERSTAND THE FEE CONNECTED WITH THE FILING OF THIS PERC TEST APPLICATION IS NON-REFUNDABLE UNDER

ANY CIRCUMSTANCES.

SIGNATURE OF APPLICANT *Charles R. Crocken* Charles R. Crocken/Agent

APPROVED BY _____ FOR _____ DATE _____

REJECTED BY _____ FOR _____ DATE _____

HOLD PENDING FURTHER TESTS _____ DATE _____

REASONS FOR REJECTION OR HOLDING 3/17/80 No show @ site; Rain; 9:15-10:00 C.R.C. 4/3/80 No show

*9:15-9:45 S.K. + C.B.M.
10:00-10:30 office
10:30-12:00 night
1600' to 2nd entrance of River Road from Rt. 99*

THIS IS NOT A PERMIT

None

SOIL PROFILE

BELOW
CLAY
SEE
EACH
HOLE

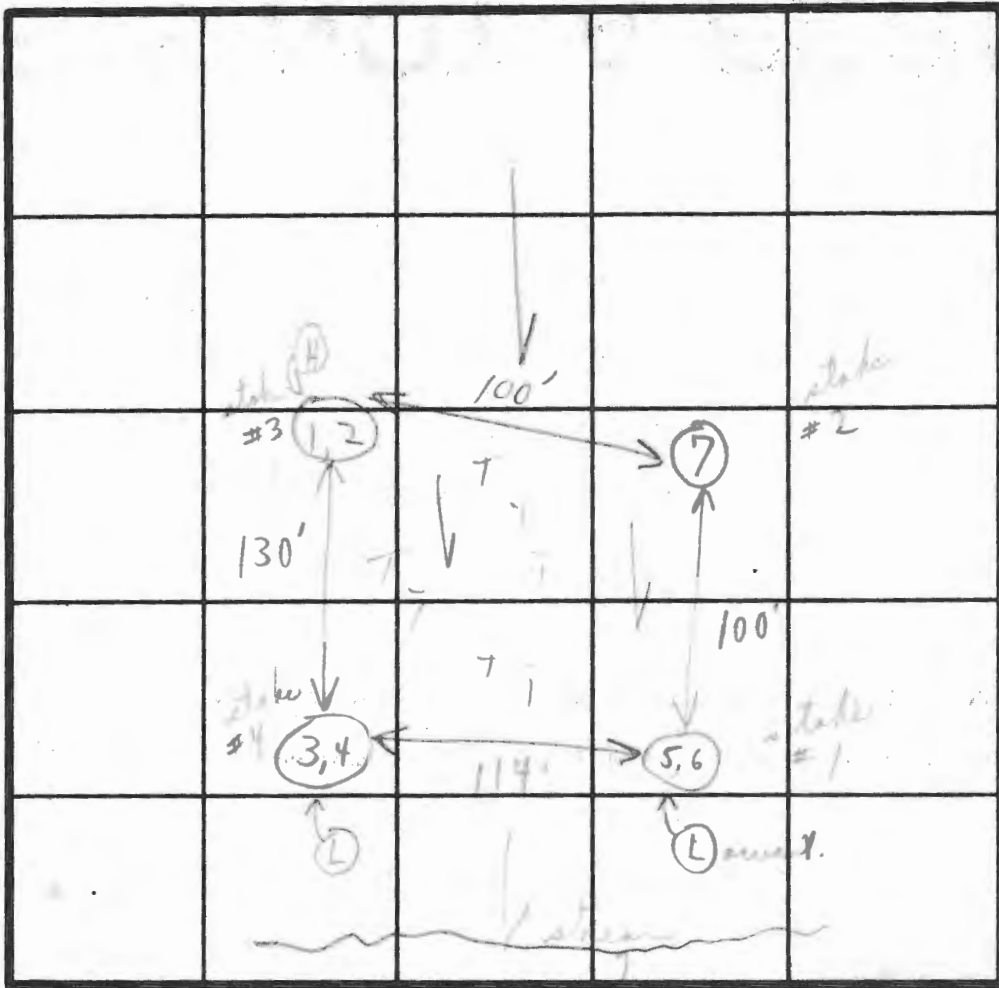

INDICATE NORTH - NAME ADJOINING ROADWAY AS BASE LINE.

MARRIOTTSVILLE RD

DATE	TEST NO.	DEPTH	PRE-WET		TEST - 1" DROP		TIME
			START	STOP	START	STOP	
4/3/80	1	6'	10:50	10:55	10:55	11:01	6
	2	15'	10:50	10:56	10:56	11:07	11
	3	5 1/2'	10:55	10:58	10:58	11:06	8
	4	14 1/2'	10:54	10:58	10:58	11:07	11
	5	5'	11:10	11:14	11:14	11:19	5
	6	13 1/2'	11:10	11:14	11:14	11:24	10
	7	14'	5 1/2' - 14'				

Soil Profile
 1'-6" clay
 6'-15" Mixed clay
 loam
 1-3 1/2" CL
 3 1/2' - 14 1/2' sandy
 1' - 5' clay
 5' - 1' loam

Pure stake
 } = 3
 } = 4
 } = 1
 } = 2

REMARKS

(Wooded lot) Tests per stake

TYPE OF SOIL

TESTED BY

C. B.

ALSO PRESENT

Mrs. Arnold

Tydings - Oheim Associates, Inc.

8370 Court Avenue
 ELLICOTT CITY, MARYLAND 21043

(301) 465-0660

LETTER OF TRANSMITTAL

DATE March 11, 1980	JOB NO. 771
ATTENTION	
RE: Marriottsville Road	

TO Howard County Health Department

GENTLEMEN:

WE ARE SENDING YOU Attached Under separate cover via _____ the following items:

Shop drawings Prints Plans Samples Specifications

Copy of letter Change order _____

COPIES	DATE	NO.	DESCRIPTION
1	3-11-80		Proposed Perc Test area
1	3-11-80		Check for \$100.00
1	3-11-80		Application for Sewage Disposal Testing

THESE ARE TRANSMITTED as checked below:

- For approval Approved as submitted Resubmit _____ copies for approval
- For your use Approved as noted Submit _____ copies for distribution
- As requested Returned for corrections Return _____ corrected prints
- For review and comment _____
- FOR BIDS DUE _____ 19 _____ PRINTS RETURNED AFTER LOAN TO US

REMARKS _____

COPY TO _____

SIGNED: Sandra Sablowski
 Sandra Sablowski

N 29° 37' 55" E

2113.66'

498.00'

S 59° 24' 47" E

45,011 ac.±

1,021.921'

N 1,008.8785 N

* Note: all areas shown have been staked.

prop. Well
158.8'

proposed house

prop. 10,000± for private sewage system

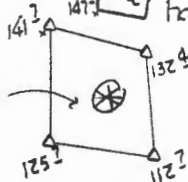

S 29° 52' 00" W - 691.81'

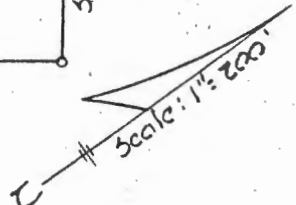

773.72'

S 60° 35' 00" E

S 30° 06' 35" W - 448.38'

S 55° 21' 00" E - 466.09'

N 59° 52' 40" W - 466.09'



S 28° 38' 29" W - 642.83'

S 28° 58' 37" W - 642.83'

123.78'

1600± to Driver Rd.

MARRIOTTVILLE Rd.

OWNER: B.M.S. Inc.,
BUYER: John & Pat Collison
1002 Wilso Dr.
phone: 525-2600

4/3/80 { at this site 9:15

Prepared by: TYDINGS - OHEIM Assoc.
8370 Court Ave.
Ellicott City, Md. 21043

7:45
+ 10:00 - 10:30
John To
Tel: 12:00

To: Office Files of Billy M. Smith
From: C. B. Stecker, Field Sanitarian

Re: *Memo helps & concerning certification of Test hole required for above property*

HOWARD COUNTY HEALTH DEPARTMENT

P. O. BOX 476
ELLICOTT CITY, MARYLAND 21043
TELEPHONE 265-5000

January 19, 1978

MEMORANDUM

TO: All Sanitarians
FROM: Donald W. Monaghan

RE: Perc Test and Field Location of test pits.

If you require test pits to be field located you shall inform the owner and the engineer in the field at time of testing and by mail (3 copies - one for owner, one for engineer and one for our records) that:

1. Approval for lot or lots will not be granted until all perc pits are field located;...
2. Field location of pits must be received by this office within two (2) months after perc tests are completed; and
3. If necessary information is not received within the prescribed time frame this department may require re-perc of the property.

DWM:hs

4/8/80 Memo's for owner &/or engineer for supervisor sent to engineer Tophis. Okin done via secretary C.B.W.

April 28, 1980

Tydings - Oheim Associates
8370 Court Avenue
Ellicott City, Maryland 21043

RE: Plat of 45 acres m/l for
B.M.S. Inc. and/or John
and Pat Collison, Parcel
off Marriottsville Road

Dear Sirs:

Please be advised the Health Department shall not approve the above referenced plat until corrected and/or additional information has been shown.

If the Health Department can be of assistance please call us at 992-2330 between 8:30 and 4:30 Monday through Friday and/or visit us at 3716 Court Place at the previously mentioned schedule.

Very truly yours,

Charles B. Streaker, Sanitarian
Water and Sewerage Program

CBS:hs

P.M. 4/23/80 Call Eng. A.S. DP.
 ? Liber / F. Lis #
 or new measured 466 X 448 C.B.

N 29° 37' 55" E 2113.66'

APPROVED: FOR PRIVATE WATER AND PRIVATE SEWERAGE SYSTEMS, HOWARD COUNTY HEALTH DEPARTMENT

 County, Health Officer

 Date

4/23/80? on slope

Hold need designated 2 parcels

(1) Parcel 45.00±

021.921'

498.00'

559° 24' 47" E

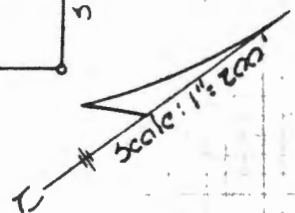

S 29° 25' 00" W 691.81'

prop. well 158.8'

proposed house

10,000 sq ft for private sewage system

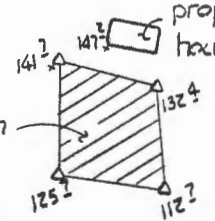

1. This area designates a private sewerage easement of approximately 10,000 sq. ft. as required by the Maryland State Health Department and Mental Hygiene for individual sewage disposal. Improvements of any nature in this area are restricted until public sewage is available and servicing any residential structure constructed on this site. This easement shall become null and void upon connection to a public sewage system.
2. The lots shown hereon comply with the minimum ownership width and lot areas as required by the Maryland State Health Department and Mental Hygiene.
3. Percolation tests have been field located as shown Δ.

S 30° 06' 35" W 448.38'

I hereby certify the percolation tests as shown hereon have been field located.

S 55° 21' 00" E 466.09'



1159° 52' 40" W 466.09'



S 28° 38' 20" W 622.825'

S 28° 58' 37" W 642.83'

S 60° 35' 00" E 773.72'

1600'± to Driver Rd.

MARRIOTTVILLE Rd.

OWNER: B.M.S. Inc.
 BUYER: John & Pat Collison
 1002 Wilson Dr.
 phone: 525-2600

Prepared by: TYDINGS - OHEIM Assoc. 465-0660
 8370 Court Ave.
 Ellicott City, Md. 21043

PERC CERTIFICATION

N 29° 37' 55" E

2113.66'

APPROVED: FOR PRIVATE WATER AND PRIVATE SEWERAGE SYSTEMS, HOWARD COUNTY HEALTH DEPARTMENT

County, Health Officer

Date

45.00±

498.00'

S 59° 24' 47" E

S 02° 19' 21" W

N 58° 48' 00" W

S 30° 06' 35" W - 448.38'

I hereby certify the percolation tests as shown hereon have been field located.

S 55° 21' 00" E - 466.09'



S 34° 39' 00" W

N 59° 52' 40" W - 466.09'

prop. Well
158.8'

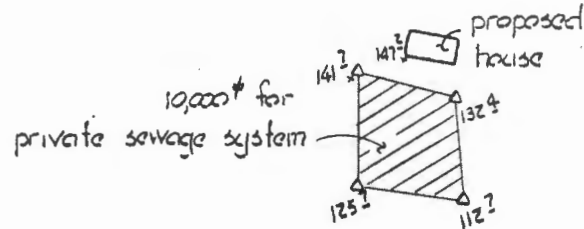

S 28° 38' 29" W

S 28° 58' 37" W - 642.83'

129.78'

S 29° 25' 00" W - 691.81'

773.72'

N 60° 35' 00" E

1600'± to Driver Rd.

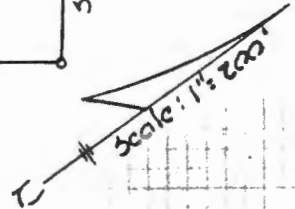

1. This area designates a private sewerage easement of approximately 10,000 sq. ft. as required by the Maryland State Health Department and Mental Hygiene for individual sewage disposal. Improvements of any nature in this area are restricted until public sewage is available and servicing any residential structure constructed on this site. This easement shall become null and void upon connection to a public sewage system.
2. The lots shown hereon comply with the minimum ownership width and lot areas as required by the Maryland State Health Department and Mental Hygiene.
3. Percolation tests have been field located as shown Δ.

OWNER: B.M.S. Inc.,
 BUYER: John & Pat Collison
 1002 Wilson Dr.
 phone: 525-2600

Prepared by: TYDINGS - OHEIM Assoc.
 8370 Court Ave.
 Ellicott City, Md. 21043

MARRIOTTSVILLE Rd.

PERC CERTIFICATION

N 29° 37' 55" E

2113.66'

APPROVED: FOR PRIVATE WATER AND PRIVATE SEWERAGE SYSTEMS, HOWARD COUNTY HEALTH DEPARTMENT

County, Health Officer

Date

45. ac ±

021'921

N 02° 07' 51" W

534° 39' 00" W
200.00'

S 55° 21' 00" E - 466.09'

S 30° 06' 35" W - 448.38'

I hereby certify the percolation tests as shown hereon have been field located.



Prepared by: TYDINGS - OHEIM Assoc.
8370 Court Ave.
Ellicott City, Md. 21043

prop. Well
158.8'

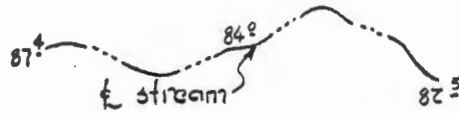
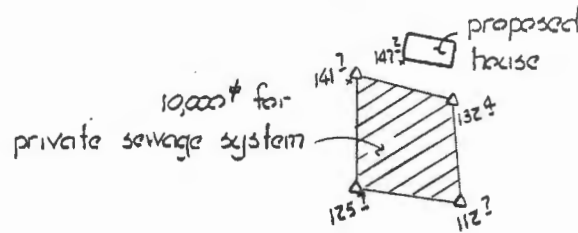

N 59° 52' 40" W - 466.69'

S 28° 58' 37" W - 642.83'

MARRIOTTSVILLE Rd.

PERC CERTIFICATION

S 29° 52' 00" W - 671.81'

773.72'

S 60° 35' 00" E

S 28° 38' 29" W - 628.25'

123.78'

1600'± to Driver Rd.

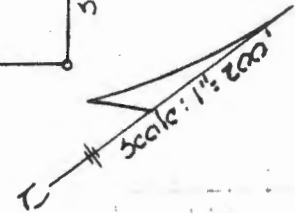

1. This area designates a private sewerage easement of approximately 10,000 sq. ft. as required by the Maryland State Health Department and Mental Hygiene for individual sewage disposal. Improvements of any nature in this area are restricted until public sewage is available and servicing any residential structure constructed on this site. This easement shall become null and void upon connection to a public sewage system.
2. The lots shown hereon comply with the minimum ownership width and lot areas as required by the Maryland State Health Department and Mental Hygiene.
3. Percolation tests have been field located as shown Δ.

OWNER: B.M.S. Inc.
BUYER: John & Pat Collison
1002 Wilson Dr.
phone: 525-2600

To: Engineer ^{1/3} *W. Monaghan*
From: C. G. *W. Monaghan*, Field Sanitarian

Memorandum *relating to* concerning certification of test
water required for above property.

Billy M. Smith, Chief Engineer
1/8/80
request

HOWARD COUNTY HEALTH DEPARTMENT

P. O. BOX 476
ELLICOTT CITY, MARYLAND 21043
TELEPHONE 465-5000

January 19, 1978

MEMORANDUM

TO: All Sanitarians

FROM: Donald N. Monaghan

RE: Perc Test and Field Location of test pits

If you require test pits to be field located you shall inform the owner and the engineer in the field at time of testing and by mail (3 copies - one for owner, one for engineer and one for our records) that:

1. Approval for lot or lots will not be granted until all perc pits are field located;
2. Field location of pits must be received by this office within two (2) months after perc tests are completed; and
3. If necessary information is not received within the prescribed time frame this department may require re-perc of the property.

DMM:hs

APR 10 1980

4/29/80 Per Mrs Reeves

To Mr. Straker
 Date 4/29/80 Time 2:00 P.M.
WHILE YOU WERE OUT
 M. Tom Bitman
 of _____
 Phone 465-0660
 Area Code Number Extension

TELEPHONED	<input checked="" type="checkbox"/>	PLEASE CALL	<input checked="" type="checkbox"/>
CALLED TO SEE YOU	<input type="checkbox"/>	WILL CALL AGAIN	<input type="checkbox"/>
WANTS TO SEE YOU	<input type="checkbox"/>	URGENT	<input type="checkbox"/>
RETURNED YOUR CALL		<input type="checkbox"/>	<input type="checkbox"/>

Message Ref: 45 acres
part of land - B.M.S.
4/29/80 Returned call -
Spoke to Tim Paine - he is
to inform Mr. Bitman
 C.B.D. Operator

To Mr. Straker
 Date 4/29/80 Time 11:05
WHILE YOU WERE OUT
 M. Tom Paine
 of _____
 Phone 465-0660
 Area Code Number Extension

TELEPHONED	<input checked="" type="checkbox"/>	PLEASE CALL	<input checked="" type="checkbox"/>
CALLED TO SEE YOU	<input type="checkbox"/>	WILL CALL AGAIN	<input type="checkbox"/>
WANTS TO SEE YOU	<input type="checkbox"/>	URGENT	<input type="checkbox"/>
RETURNED YOUR CALL		<input type="checkbox"/>	<input type="checkbox"/>

Message P.M. 4/29/80 Called above
asked for Mr.
Paine. Discussed letter
and the situation of 1 acre
of plat not yet being
approved. Hold for further
 C.B.D. Operator

Campbell 09301 4/29/80 Hold for supervisor C.B.D.

Campbell 09301 4/29/80 Hold for further C.B.D.

HD - 147-280
HOWARD COUNTY HEALTH DEPARTMENT
 Bureau of Environmental Health
 Ellicott City, Maryland 21043
 Phone: 992-2330

HD - 147-280
HOWARD COUNTY HEALTH DEPARTMENT
 Bureau of Environmental Health
 Ellicott City, Maryland 21043
 Phone: 992-2330

Date: 4/8/80
 TO: Secretaries
 FROM: C.B.D.

Date: 4/23/80
 TO: File
 FROM: C.B.D.

- Please Note & File
- For Your Information
- Please Note & Return
- Please Handle
- Please answer, Sending me Copy of your letter
- Please Prepare reply for my Signature
- Please Circulate
- Please Comment
- Please See Me

- Please Note & File
- For Your Information
- Please Note & Return
- Please Handle
- Please answer, Sending me Copy of your letter
- Please Prepare reply for my Signature
- Please Circulate
- Please Comment
- Please See Me

REMARKS: For Billy M. Smith Property
Please send

REMARKS:

certified hole memos
To: Tydings-Oheim Assoc.

B.M.S. spoke to Mr. Tydings
Property & spoke to Mr. Tydings
not ok } Write letter
4/23/80 spoke to F.F. about this
see plat.
C.B.D.

(over) 8370 Court Ave.
E.C. Md. 21043
for owners & survivors & 1/2 each C.B.D.

A.S.A.P.