

APPLICATION

SEWAGE DISPOSAL TESTING

MARYLAND STATE DEPARTMENT OF HEALTH

A 01524

P _____

HOWARD COUNTY

ELLICOTT CITY

DISTRICT 2

DATE 8/12/59

25' one 8' x 14' Dry Well located property line and 28' from when property line was determined 750 gal. septic tank.

TO: THE COUNTY HEALTH OFFICER
ELLICOTT CITY, MARYLAND

I, HEREBY, APPLY FOR THE NECESSARY TESTS IN ORDER TO CONSTRUCT (OR RECONSTRUCT) A SEWAGE DISPOSAL SYSTEM.

PROPERTY OWNER Mr. & Mrs. James S. Clark

ADDRESS St John's Lane (800' south of Manordale Rd) PHONE EC 1821

PROPERTY LOCATION:

SUBDIVISION None - Across from Dunloggin LOT NO. —

ROAD AND DESCRIPTION Lot situated on private Road approx 800' South of Manordale Rd
Lot has some footage on St John's Lane

OCCUPANT Proposed home PHONE —

PERSON TO CONSTRUCT SYSTEM Shilling & Co thru Catonsville Plumbing & Heating Co
ADDRESS 5 Hunt Club Road (27) PHONE Catonsville Plumbing Rt 7-2293
Shilling - Elbridge 1927

SIZE OF LOT Approx 3/4 Acre (436 x 189' (-)) TYPE BLDG. 3 Bedrooms
NUMBER OF BEDROOMS

IF NOT SINGLE RESIDENCE DESCRIBE _____

SIGNATURE OF APPLICANT Vanzel Bros, Builders *Writer Vanzel*

APPROVED BY J. H. ... FOR Dry Wells DATE 8-13-59
(KIND OF SYSTEM)

REJECTED BY _____ FOR _____ DATE _____
(KIND OF SYSTEM)

HOLD PENDING FURTHER TESTS _____ DATE _____

REASONS FOR REJECTION OR HOLDING _____

THIS IS NOT A PERMIT

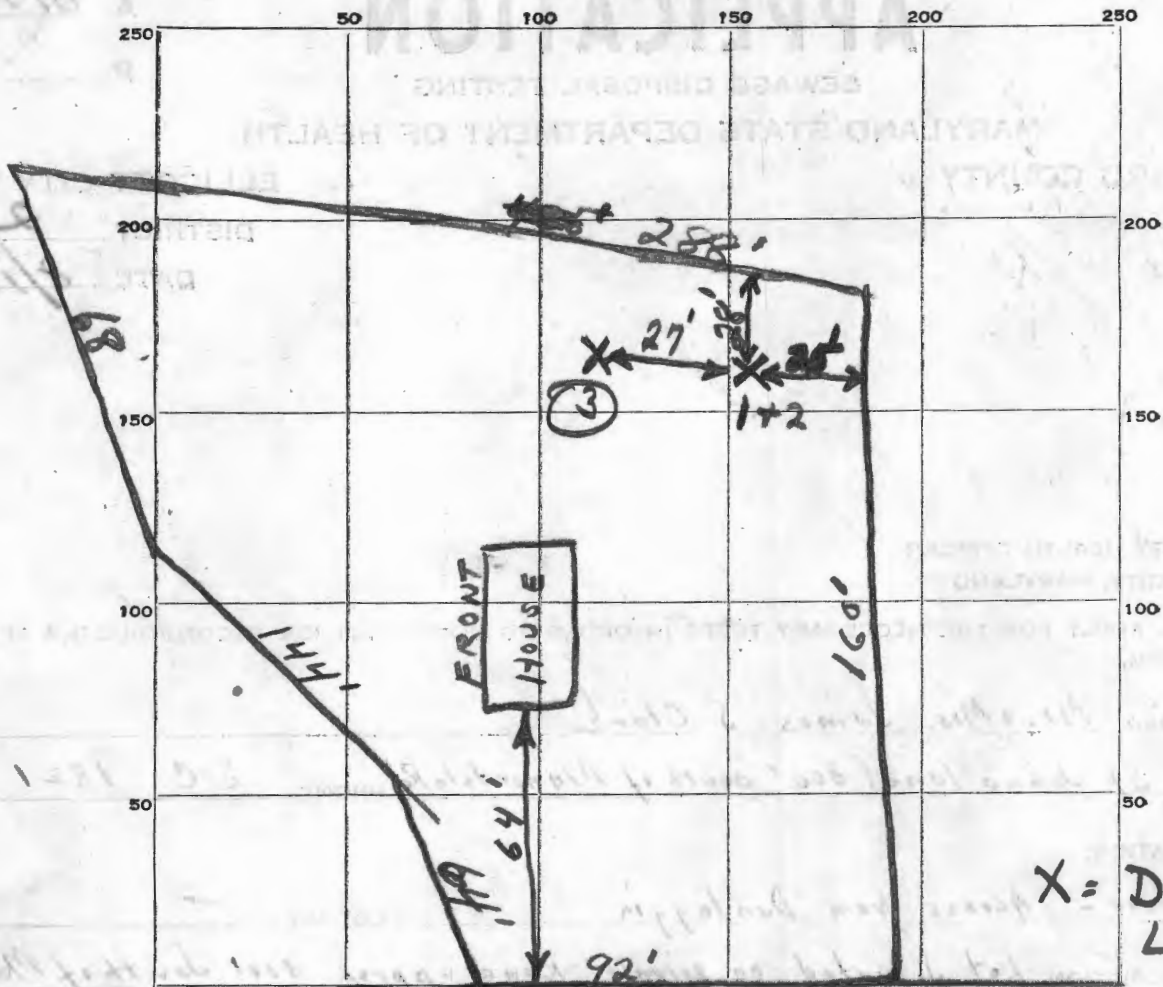

INDICATE NORTH. - NAME ADJOINING ROADWAY AS BASE LINE.

UNPAVED LANE

DATE	TEST NO.	DEPTH	PRE-WET		TEST - 1" DROP		TIME	
			START	STOP	START	STOP		
8-13-59	1	10'	9:42	9:44	9:44	9:54	10 Minutes	
1	2	4'	9:59	1/2 inch			26 min.	
	(3)	Location of additional dry well requested by owner.						

SOIL AUGER FINDING _____

TESTED BY J.H.

REMARKS Good ground starts 4' below grade.

owner wants 2 dry wells although tested for one.

ALSO PRESENT water tank

LOT NO. _____