

Real Property Data Search

Search Result for HOWARD COUNTY

View Map		View GroundRent Redemption			View GroundRent Registration				
Tax Exempt:		Special Tax Recapture:							
Exempt Class:		NONE							
Account Identifier:		District - 04 Account Number - 308743							
Owner Information									
Owner Name:		EZ REACH LLC			Use:		RESIDENTIAL		
Mailing Address:		3051 TERRA MARIA WAY ELLCOTT CITY MD 21042-			Principal Residence:		NO		
					Deed Reference:		/17764/ 00118		
Location & Structure Information									
Premises Address:		1906 LONG CORNER RD MT AIRY 21771-0000			Legal Description:		.412 A 1906 LONG CORNER RD MT AIRY		
Map:	Grid:	Parcel:	Sub District:	Subdivision:	Section:	Block:	Lot:	Assessment Year:	Plat No:
0006	0022	0074		0000				2017	Plat Ref:
Special Tax Areas:				Town:		NONE			
				Ad Valorem:		100			
				Tax Class:					
Primary Structure Built		Above Grade Living Area		Finished Basement Area		Property Land Area		County Use	
1961		1,410 SF		200 SF		17,946 SF			
Stories	Basement	Type	Exterior	Full/Half Bath	Garage	Last Major Renovation			
1 1/2	YES	STANDARD UNIT	SIDING	2 full	1 Detached				
Value Information									
		Base Value		Value		Phase-in Assessments			
				As of		As of		As of	
				01/01/2017		07/01/2018		07/01/2019	
Land:		170,500		170,500					
Improvements		148,600		93,800					
Total:		319,100		264,300		264,300		264,300	
Preferential Land:		0						0	
Transfer Information									
Seller: FEDERAL HOME LOAN MORTGAGE				Date: 08/21/2017			Price: \$165,000		
Type: NON-ARMS LENGTH OTHER				Deed1: /17764/ 00118			Deed2:		
Seller: YARRINGTON JEFFREY S				Date: 03/31/2016			Price: \$170,252		
Type: NON-ARMS LENGTH OTHER				Deed1: /16766/ 00240			Deed2:		
Seller: MYERS HEIDI FORREST				Date: 12/29/2003			Price: \$235,000		
Type: ARMS LENGTH IMPROVED				Deed1: /07946/ 00001			Deed2:		
Exemption Information									
Partial Exempt Assessments:		Class		07/01/2018		07/01/2019			
County:		000		0.00					
State:		000		0.00					



MARYLAND DEPARTMENT OF THE ENVIRONMENT

Oil Control Program, Suite 620, 1800 Washington Blvd., Baltimore MD 21230-1719

410-537-3442 • 410-537-3092 (fax)

1-800-633-6101

Robert L. Ehrlich, Jr.
Governor

Kendl P. Philbrick
Acting Secretary

Michael S. Steele
Lt. Governor

November 12, 2003

NOTICE OF COMPLIANCE

Ms. Heidi Myers
Mr. Charles Barnes
1906 Long Corner Road
Mt. Airy MD 21771

RE: Case No. 2004-0486 HO
Myers/Barnes Residential Property
1906 Long Corner Road, Mt. Airy

Dear Ms. Myers and Mr. Barnes:

The Oil Control Program has completed its review of Case No. 2004-0486-HO for your residential property located at the above-referenced address in Howard County. Based on our review, it has been determined that a 290-gallon underground gasoline storage tank was removed. The Department does not require further corrective action at this property based on the analytical data from soil samples collected from 1906 Long Corner Road and drinking water samples collected from 1906 and 1910 Long Corner Road.

The sampling data indicates that the only dissolved petroleum contaminant detected in water samples was methyl tertiary-butyl ether (MTBE) at a maximum concentration of 2.1 parts per billion (ppb) at 1906 Long Corner Road and 3.3 ppb at 1910 Long Corner Road. MTBE was not detected in soil samples collected from the bottom of the tank excavation. The tank, located downgradient from both drinking water wells, has not been used since. The levels of MTBE detected are below the drinking water health advisory established by the U.S. Environmental Protection Agency of 20-40 ppb. Please refer to the enclosed fact sheet concerning MTBE.

Residual petroleum contamination may remain on site; however, it appears this contamination does not pose a threat to human health or the environment. Future excavation in the area of the removed tank may create exposure pathways. Therefore, if impacted soil is encountered, it must be handled in a manner that will comply with State and local regulations.

Ms. Heidi Myers
Mr. Charles Barnes
Case No. 2004-0486-HO
Page 2

The Myers/Barnes property is now in compliance with Code of Maryland Regulations (COMAR) 26.10.10.02-.03. The Oil Control Program hereby closes its case in reference to this site. However, this notice should not be construed as a waiver of the Department's right to take other enforcement action it deems appropriate with respect to this property. If you have any questions, please contact the Oil Control Program at 410-537-3442.

Sincerely,

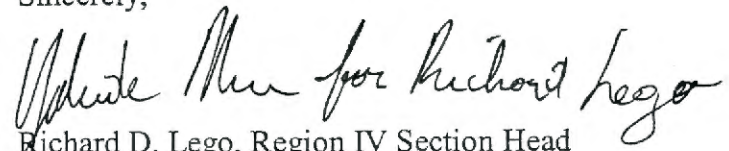
Richard D. Lego, Region IV Section Head
Compliance/Remediation Division
Oil Control Program

IR/nln

Enclosure

cc: Mr. Jimmy Stevens, 1910 Long Corner Road
Mr. Bert Nixon, Howard County
Yolande J.C. Norman
Mr. Mick Butler
Mr. Jonas Jacobson



88-211-1000



MARYLAND DEPARTMENT OF THE ENVIRONMENT

Oil Control Program, Suite 620, 1800 Washington Blvd., Baltimore MD 21230-1719

410-537-3442 • 410-537-3092 (fax)

1-800-633-6101

Robert L. Ehrlich, Jr.
Governor

Kendl P. Philbrick
Acting Secretary

Michael S. Steele
Lt. Governor

November 12, 2003

NOTICE OF COMPLIANCE

Ms. Heidi Myers
Mr. Charles Barnes
1906 Long Corner Road
Mt. Airy MD 21771

1910 LONG CORNER ROAD

RE: Case No. 2004-0486 HO
Myers/Barnes Residential Property
1906 Long Corner Road, Mt. Airy

Dear Ms. Myers and Mr. Barnes:

The Oil Control Program has completed its review of Case No. 2004-0486-HO for your residential property located at the above-referenced address in Howard County. Based on our review, it has been determined that a 290-gallon underground gasoline storage tank was removed. The Department does not require further corrective action at this property based on the analytical data from soil samples collected from 1906 Long Corner Road and drinking water samples collected from 1906 and 1910 Long Corner Road.

The sampling data indicates that the only dissolved petroleum contaminant detected in water samples was methyl tertiary-butyl ether (MTBE) at a maximum concentration of 2.1 parts per billion (ppb) at 1906 Long Corner Road and 3.3 ppb at 1910 Long Corner Road. MTBE was not detected in soil samples collected from the bottom of the tank excavation. The tank, located downgradient from both drinking water wells, has not been used since. The levels of MTBE detected are below the drinking water health advisory established by the U.S. Environmental Protection Agency of 20-40 ppb. Please refer to the enclosed fact sheet concerning MTBE.

Residual petroleum contamination may remain on site; however, it appears this contamination does not pose a threat to human health or the environment. Future excavation in the area of the removed tank may create exposure pathways. Therefore, if impacted soil is encountered, it must be handled in a manner that will comply with State and local regulations.

Ms. Heidi Myers
Mr. Charles Barnes
Case No. 2004-0486-HO
Page 2

The Myers/Barnes property is now in compliance with Code of Maryland Regulations (COMAR) 26.10.10.02-.03. The Oil Control Program hereby closes its case in reference to this site. However, this notice should not be construed as a waiver of the Department's right to take other enforcement action it deems appropriate with respect to this property. If you have any questions, please contact the Oil Control Program at 410-537-3442.

Sincerely,

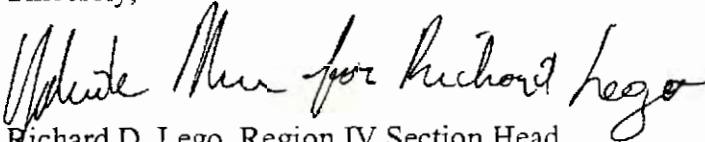
Richard D. Lego, Region IV Section Head
Compliance/Remediation Division
Oil Control Program

IR/nln

Enclosure

cc: Mr. Jimmy Stevens, 1910 Long Corner Road
Mr. Bert Nixon, Howard County
Yolande J.C. Norman
Mr. Mick Butler
Mr. Jonas Jacobson

P 03116 A

LOCATION Washington Blvd. Date 10/26/60 APPLICATION

LOT _____ Hold

APPLICANT _____ Approved

OWNER Ark Trailer Park Rejected

PERMITTEE Ernest Robinson INSTALLATION Hold

Approved DATE 10/31/60

P 30522 A Repair

DATE 2/7/80

LOCATION 8319 Route 1 APPLICATION

LOT _____ HOLD

APPLICANT _____ APPROVED

OWNER Ark Trailer Park REJECTED

PERMITTEE Okler Plumbing + Heating INSTALLATION

HOLD

APPROVED

APPROVED

DATE _____

HD - 11

Installed but no inspections made by this office.

P 23214 A Repair

DATE 5/5/76

LOCATION 8319 Washington Boulevard APPLICATION

LOT _____ HOLD

APPLICANT H. D. Killebrew APPROVED

OWNER " " REJECTED

PERMITTEE " " INSTALLATION

HOLD

APPROVED

APPROVED

DATE 7/1/77

P 30523 A Repair

DATE 2/7/80

LOCATION 8319 Route 1 APPLICATION

LOT _____ HOLD

APPLICANT _____ APPROVED

OWNER Ark Trailer Park REJECTED

PERMITTEE Okler Plumbing + Heating INSTALLATION

HOLD

APPROVED

APPROVED

DATE 2/29/80

HD - 11

P 03116 A
 Date 10/26/60
 LOCATION Washington Blvd. APPLICATION
 LOT _____ Hold
 APPLICANT _____ Approved
 OWNER Ark Trailer Park Rejected
 PERMITTEE Ernest Robinson INSTALLATION
 Hold
 Approved
 10/31/60

P 30522 A Repair
 DATE 2/7/80
 LOCATION 8319 Route 1 APPLICATION
 LOT _____ HOLD
 APPROVED
 REJECTED
 APPLICANT _____ INSTALLATION
 OWNER Ark Trailer Park HOLD
 APPROVED
 PERMITTEE Ohler Plumbing APPROVED
+ Heating DATE _____

HD - 11

Installed but no inspections made by this office.

P 23214 A Repair
 DATE 5/5/76
 LOCATION 8319 Washington APPLICATION
Boulevard HOLD
 APPROVED
 REJECTED
 LOT _____
 APPLICANT H.D. Killebrew INSTALLATION
 OWNER " " HOLD
 APPROVED
 PERMITTEE " " APPROVED
 DATE 7/1/77

P 30523A Repair
 DATE 2/7/80
 LOCATION 8319 Route 1 APPLICATION
 HOLD
 APPROVED
 REJECTED
 LOT _____ INSTALLATION
 APPLICANT _____ HOLD
 OWNER Ark Trailer Park APPROVED
 PERMITTEE Ohler Plumbing APPROVED
+ Heating DATE 2/29/80

HD - 11

get water sample

PERMIT

P 03116

SEWAGE DISPOSAL SYSTEM

A _____

MARYLAND STATE DEPARTMENT OF HEALTH

HOWARD COUNTY

ELLICOTT CITY

INDEXED

DISTRICT 6

DATE 10-26-60

Ernest Robinson IS PERMITTED TO INSTALL ALTER

ADDRESS 2401 Baker St. Baltz PHONE La. 3-5328

A SEWAGE DISPOSAL SYSTEM LOCATED AT Washington Blvd.

SUBDIVISION _____ ROAD _____ LOT _____

PROPERTY OWNER Ark Trailer Park

ADDRESS Washington Blvd. Jessup

SPECIFICATIONS

DRAIN FIELD _____ DEPTH _____ FEET, BOTTOM AREA _____ SQ. FT.

SEEPAGE PITS _____ ABSORBENT SIDE-WALL AREA _____ SQ. FT.

SEPTIC TANK CAPACITY 1000 GALLONS

FOR GARBAGE GRINDER, INCREASE DISPOSAL AREA 22% & TANK CAPACITY 50%.

OTHER 1000 gallon septic tank plus watertight pump chamber of at least 500 gallon capacity. Sewage lift pump to discharge effluent to existing septic tank. The above system to accommodate three trailers only.

PLANS APPROVED BY Palmer F. Wine DATE 10/25/60

FILL SEPTIC TANK AND DISTRIBUTION BOX WITH WATER BEFORE CALLING FOR AN INSPECTION. COVER NO WORK UNTIL INSPECTED AND APPROVED.

NEITHER THE HOWARD COUNTY COMMISSIONERS NOR THE HEALTH DEPARTMENT IS RESPONSIBLE FOR THE SUCCESSFUL OPERATION OF ANY SYSTEM.

A 03116

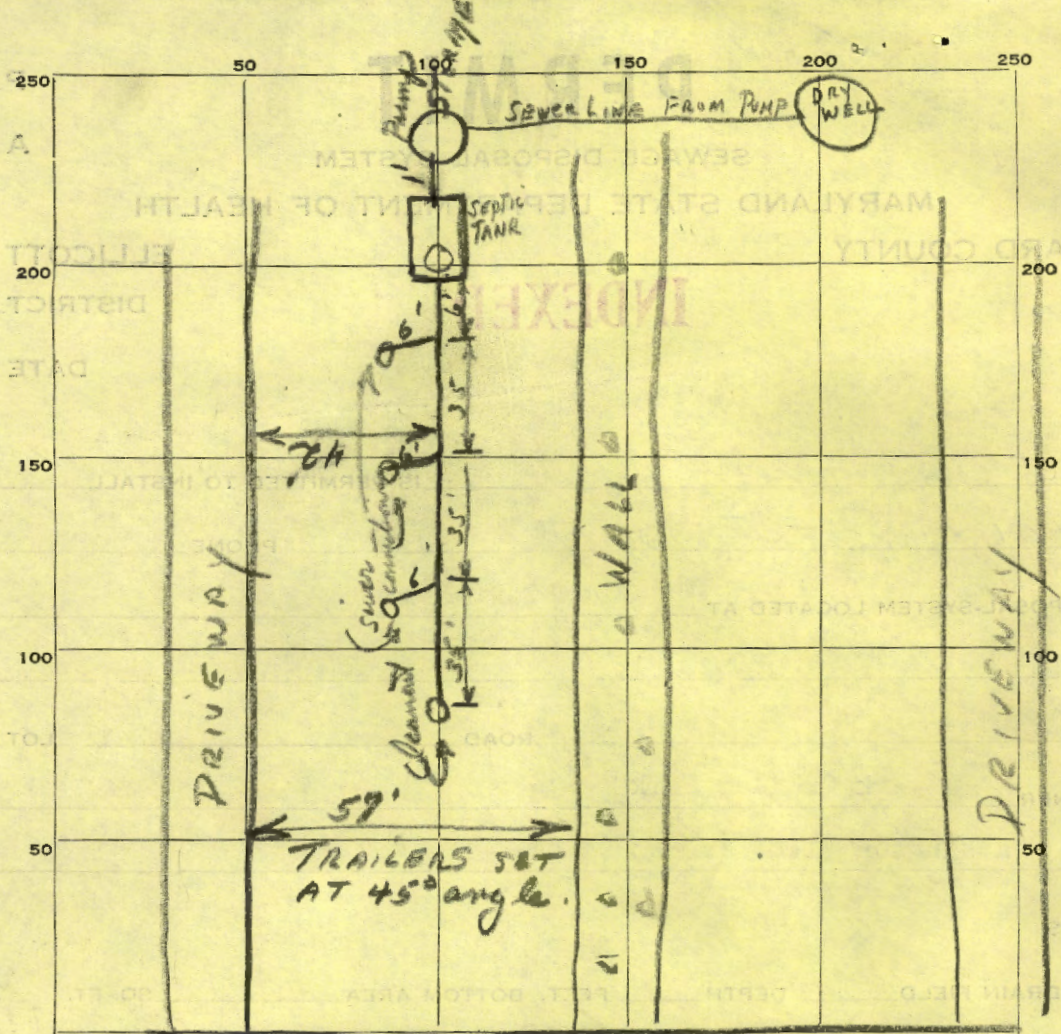

INDICATE NORTH - NAME ADJOINING ROADWAY AS BASE LINE.

U.S. 1

PERMIT CARD _____

SEPTIC TANK, LEVEL OK 1000gal.

CLEANOUTS stand pipe - well rings

DISTRIBUTION BOX, LEVEL _____

TILE FIELD, DEPTH _____ FT. TRENCH WIDTH _____ FT.

GRAVEL DEPTH _____ IN. TOTAL LENGTH _____ FT.

NUMBER OF TRENCHES _____ TOTAL BOTTOM AREA _____

SEEPAGE PITS, INSIDE DIAMETER _____ FT. DEPTH BELOW INLET _____ FT.

ABSORBENT AREA _____ SQ. FT.

REMARKS _____

11-23-60 Sewage pumps not yet installed. IH

DATE SYSTEM APPROVED 10-31-60

INSPECTOR J. Henry

STATE OF MARYLAND

HOWARD COUNTY HEALTH DEPARTMENT
ELLICOTT CITY, MARYLAND

Date 10-26-1960

Name Ernest Robinson

Telephone No. Ho. 3-5328

DETAILED LOCATION OF SITE, DEVELOPMENT,
SECTION, ROAD, LOT NO. & ELECTION DISTRICT (6)
Washington Blvd.
Old Waverly Park

PRIVATE SEWAGE DISPOSAL SYSTEMS

Testing and Inspection \$ _____

Installation Permit \$ 1-

Received Payment Fredricks

03116

TRIPPLICATE

THIS RECEIPT IS NOT
A PERMIT AND IT IS
NOT A WARRANTY OF
PERFORMANCE OF
THE SYSTEM THAT
IS INSTALLED

① HAND-FOLD-BALTIMORE BUSINESS FORMS CO., BALTIMORE, MD.

STATE OF MARYLAND

HOWARD COUNTY HEALTH DEPARTMENT
ELLICOTT CITY, MARYLAND

Date 10-26-1960

Name Ernest Robinson

Telephone No. Ho. 3-5328

DETAILED LOCATION OF SITE, DEVELOPMENT,
SECTION, ROAD, LOT NO. & ELECTION DISTRICT (6)
Washington Blvd.
Old Waverly Park

PRIVATE SEWAGE DISPOSAL SYSTEMS

Testing and Inspection \$ _____

Installation Permit \$ 1-

Received Payment Fredricks

03116

THIS RECEIPT IS NOT
A PERMIT AND IT IS
NOT A WARRANTY OF

6/8/77
Please call + give
approximate time
10-10:30

PERMIT

6/22/77
7/1/77

P 23214

SEWAGE DISPOSAL SYSTEM

MARYLAND STATE DEPARTMENT OF HEALTH

HOWARD COUNTY

ELLICOTT CITY

DISTRICT 065

DATE 5/8/76

Waterloo Sanitation - Mr. Baker

INDEXED

Mrs. H. D. Killebrew

IS PERMITTED TO INSTALL _____ ALTER _____

ADDRESS 8819 Washington Boulevard, 22 Jessup, Maryland

PHONE 20794 PHONE 729-2311 799-1942

A SEWAGE DISPOSAL SYSTEM LOCATED AT _____

SUBDIVISION _____

ROAD 8819 Washington Blvd. LOT _____

PROPERTY OWNER Mrs. H. D. Killebrew

ADDRESS same as above

SPECIFICATIONS SEE BELOW ALSO SEE DIAGRAM ATTACHED

DRAIN FIELD _____ DEPTH _____ FEET, BOTTOM AREA _____ SQ. FT.

SEEPAGE PITS _____ ABSORBENT SIDE-WALL AREA _____ SQ. FT.

SEPTIC TANK CAPACITY _____ GALLONS

FOR GARAGE OWNERS, INCREASE DISPOSAL AREA SEE & TANK CAPACITY FOR

OTHER REPAIR - Call for inspection when ground is opened up re sanitation can

PROPOSED REPAIR SYSTEM: ~~Public~~ area approx. 50' x 100' available

Approx 70' long ditch, 9' deep w @ least 5' stone under diate pipe. At end of ditch, connect to 10' wide, 40' long, 5'-6" deep leaching ditch w @ least 2' of stone under

PLANS APPROVED BY PAUL F. WINE WWZ DATE 5/8/76

FILL SEPTIC TANK AND DISTRIBUTION BOX WITH WATER BEFORE CALLING FOR AN INSPECTION. COVER REPAIRS UNTIL INSPECTED AND APPROVED.

NEITHER THE HOWARD COUNTY COMMISSIONERS NOR THE HEALTH DEPARTMENT IS RESPONSIBLE FOR THE SUCCESSFUL OPERATION OF ANY SYSTEM.

diate pipe, Put Y in diate pipe as it goes fr 70' ditch into leaching ditch. Depths of ditches may vary but depth of stone to be as stated above. Bring old line fr old DW to new diate box, connect wash house line into diate box, then proceed into new ditch w perforated pipe laid nearly level.
INSPECT DITCHES BEFORE INSTALLING STONE.

108814

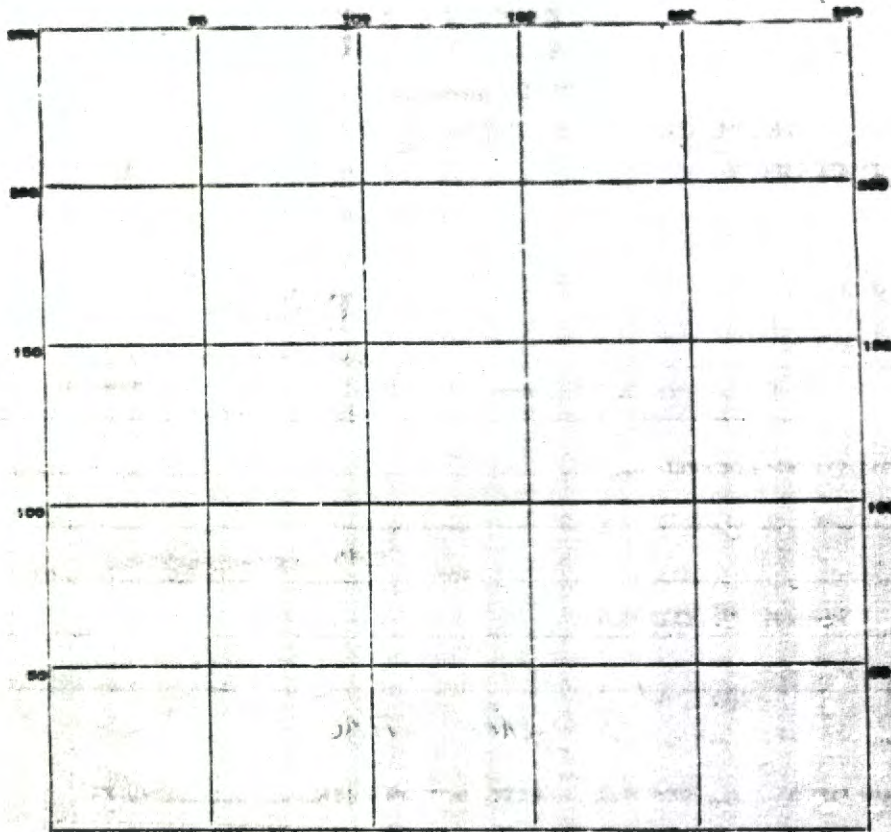

INDICATE NORTH - NAME ADJACENT ROADWAY AS BASE LINE.

PERMIT CARD _____

SEPTIC TANK, LEVEL _____ CLEAN-OUTS _____

DISTRIBUTION BOX, LEVEL _____

TILE FIELD, DEPTH 9 FT. TRENCH WIDTH 2-8 FT.

GRAVEL DEPTH _____ IN. TOTAL LENGTH 67 FT.

NUMBER OF TRENCHES 1 1/2 SIDEWALK
TOTAL BOTTOM AREA _____

SEEPAGE PITS, INSIDE DIAMETER _____ FT. DEPTH BELOW INLET _____ FT.

ABSORBENT AREA _____ SQ. FT.

REMARKS See diagram for notes RDB 16 June 72
11 11 6/17/72 S.S.

DATE SYSTEM APPROVED 7-1-77

INSPECTOR R. Briggs

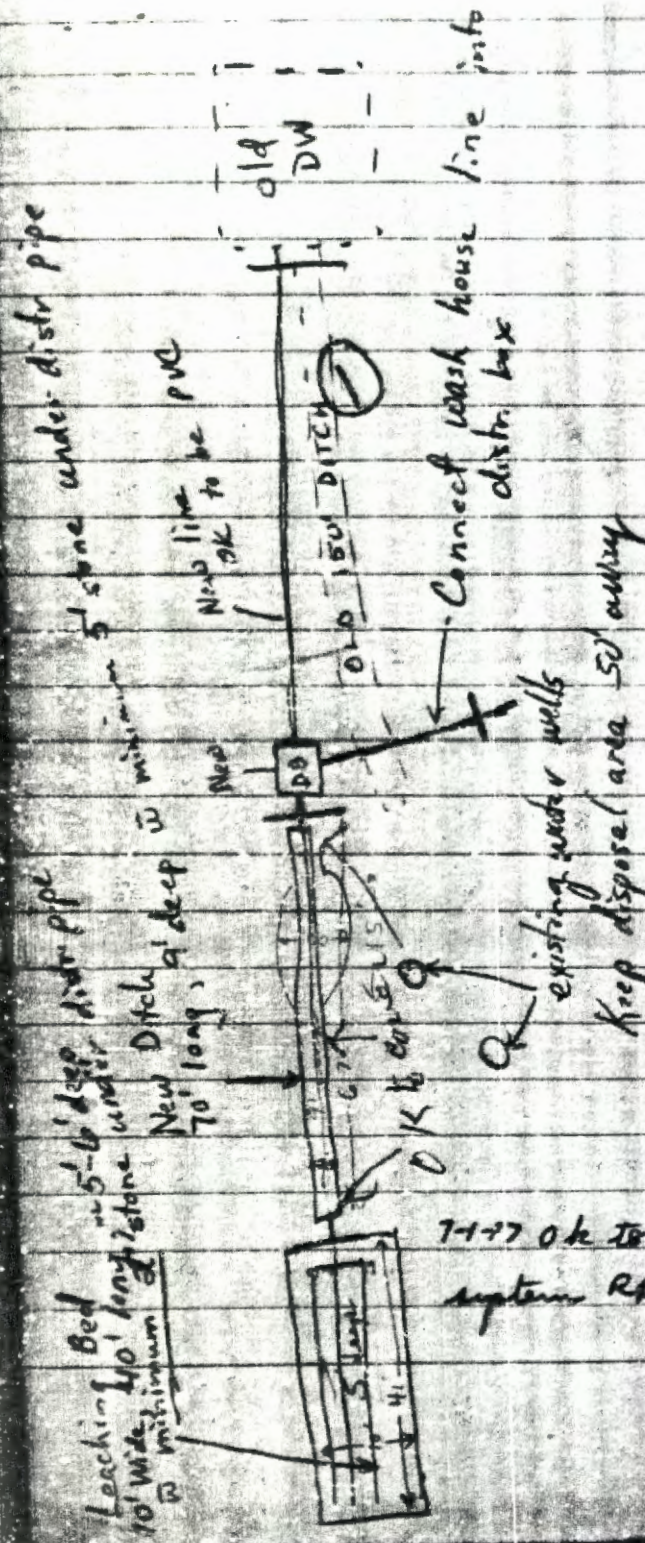

INSPT DITCHES BEFORE INSTALLING STONE

① Cover from DW to just beyond DB and just to the connection to wash house seal pipe to wash house pipe note that pipe may appear to be leaking due to old drain field

6/17/77 Inspecting & laying out 8' wide x 20' long ditch and OK to install gravel pipe in trench. Wash water pipe connected to new pipe connected to D. Box 5/15.

5/21/77 OK to cover trench call for inspt of L.B. before gravel is installed 2/18/77

6/29/77 Leach bed lay 4' x 10' x 5' OK to add gravel & pipe in leach bed call for final inspection after gravel pipe has been installed and before backfilling. S. Schinner Spoke to Harold Killian re: leach bed design & system components.

7-1-77 OK to cover system RAB

1977 Repair

{ Field sheet }
{ 2/27/80 }
G.M.

old
Trailer
Storage

Orange

Green

19x44

Load Way

Ark Trailer Park

Pl. 1

Waited on digger
9:15 to 2
10:15 starting

No overflow
in tent
repaired
small
overflow
near trailer
recovered
specimens

to digger 2/27/80 C. R.
+ from line from
digger tank
to old tent site
of 1977 job
Heavy if
necessary

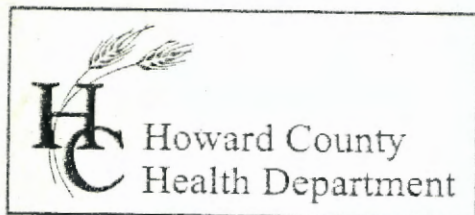

3525 H Ellicott Mills Drive, Ellicott City, MD 21043
(410) 313-2640 Fax (410) 313-2648
TDD (410) 313-2323 Toll Free 1-866-313-6300
website: www.hchealth.org

Penny E. Borenstein, M.D., M.P.H., Health Officer

March 17, 2004

TO: George Beisser, Chief
Public Service and Zoning Administration

FROM: Mark Rifkin *MR*
Well and Septic Program
Aaron Busch *AB*
Community Services Program

RE: File Number: NCU 04-001
Title: Glenn Mullinix

The Health Department has identified significant concerns that should be addressed prior to approval. These issues are listed below:

1. All currently unused storage tanks on the property are to be removed. In order to accomplish this, apply for a building permit, contact MDE to oversee the removals and contact this office after removal.
2. The well on the property must be tested for possible Volatile Organic Compound contamination. This is a requirement regardless of the status of the well as a potable supply.
3. We agree with your proposal to connect to the city water supply; please contact us when this connection is made.
4. Since the existing septic system is believed to date from original building construction, the existing septic system must be inspected and/or replaced. If the system is determined to be unacceptable, repairs or replacement will be necessary.
5. Disclosure of storage locations for all oil and solvents being stored on the property. Holding tanks may need to be utilized as discharge containment.

cc: Glenn A. Mullinix



Howard County

Internal Memorandum

Subject: Nonconforming Use Application 04-001
Glenn A. Mullinix, and Assoc.

To: Department of Recreations and Parks
Department of Inspections, Licenses and Permits
Bureau of Environmental Health
Department of Fire and Rescue Services
Development Engineering Division

From: George L. Beisser, Chief *GB*
Division of Comprehensive Planning and Zoning Administration

Date: February 24, 2004

Attached is the application for the temporary use referenced above as permitted under Section 132 of the Howard County Zoning Regulations. This Section allows approval of a temporary use by the Director of the Department of Planning and Zoning, provided the following determinations are made:

1. The use will not adversely affect vicinal properties.
2. The use does not require significant or permanent changes to the existing topography, vegetation, structures or other features of the site.

A public hearing on the application is scheduled for **April 6, 2004**. Please submit any advisory comments or applicable requirements your agency has on the application **by March 15, 2004**.

If you have any questions, please contact me at extension 2350.

GLB:hg
Attachment

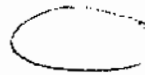

Handing 2000 1/2" dia
footing
built 1950

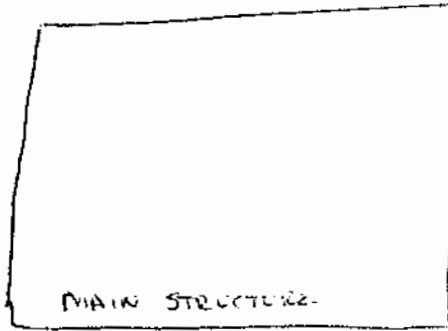

MAIN STRUCTURE

Built 1950

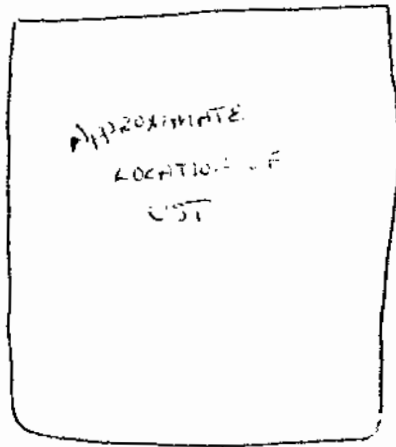

APPROXIMATE
LOCATION OF
CIST

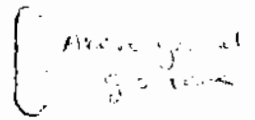

Above ground
gas tank

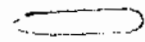

Above ground
gas tank



well



Dumpster

Rt 40

INSPECTED BY

Steven Burok

2/17/04

12/20/67
Hardy

12/20/67 - Approved JHK

PERMIT

SEWAGE DISPOSAL SYSTEM

MARYLAND STATE DEPARTMENT OF HEALTH

HOWARD COUNTY

ELLICOTT CITY

INDEXED

DISTRICT 2

DATE 12/18/67

P 13299
A _____

_____ IS PERMITTED TO INSTALL _____ ALTER X

ADDRESS James Triplett PHONE _____

A SEWAGE DISPOSAL SYSTEM LOCATED AT Hardy Road - Mt. Airy, Md. RD 9-4535

SUBDIVISION _____ ROAD 10390 LOT _____

PROPERTY OWNER Et. 40 - Barth's

ADDRESS Suzanne Dorecy Rego Station - filling station past weight scales - right hand side

SPECIFICATIONS

DRAIN FIELD _____ DEPTH _____ FEET, BOTTOM AREA _____ SQ. FT.

SEEPAGE PITH _____ ABSORBENT SIDE-WALL AREA _____ SQ. FT.

SEPTIC TANK CAPACITY _____ GALLONS

FOR GARBAGE GRINDER, INCREASE DISPOSAL AREA 22% & TANK CAPACITY 80%.

OTHER EXPAIR - Dry well - 300 sq. ft.

PLANS APPROVED BY _____ DATE 12/18/67

FILL SEPTIC TANK AND DISTRIBUTION BOX WITH WATER BEFORE CALLING FOR AN INSPECTION. COVER NO WORK UNTIL INSPECTED AND APPROVED.

NEITHER THE HOWARD COUNTY COMMISSIONERS NOR THE HEALTH DEPARTMENT IS RESPONSIBLE FOR THE SUCCESSFUL OPERATION OF ANY SYSTEM.

NOTIFY THE HEALTH DEPARTMENT 48 HOURS BEFORE EXCAVATIONS ARE TO BE BACK FILLED.

13299

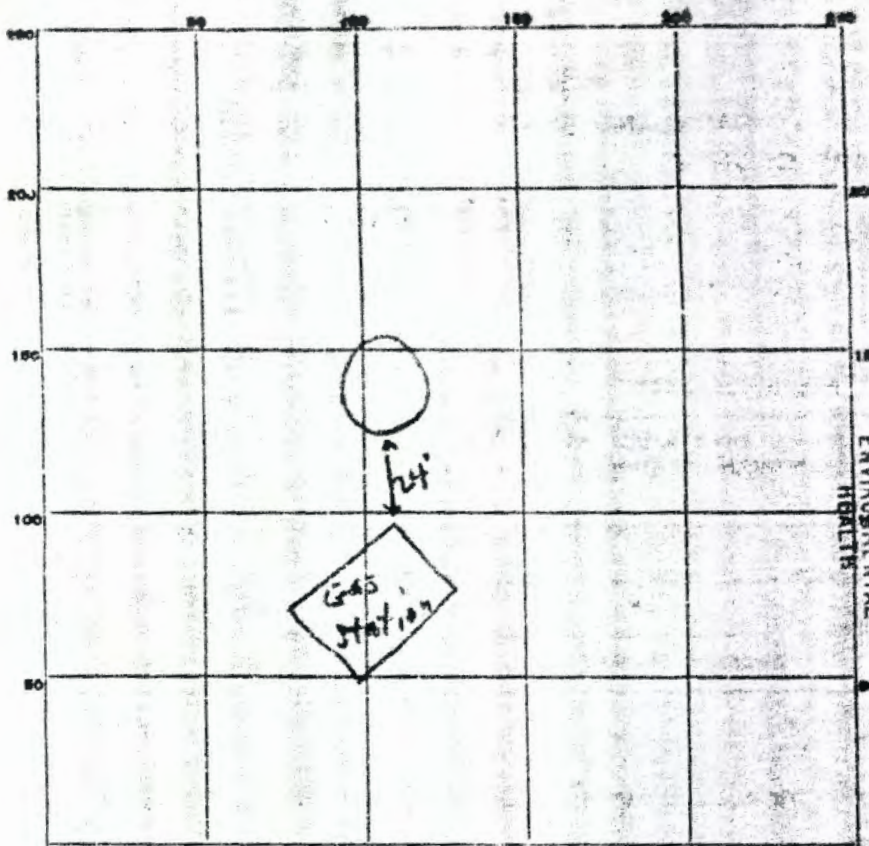

DEC 19 4 17 PM '67

RECEIVED
HOWARD COUNTY
HEALTH DEPT.

DIVISION OF
ENVIRONMENTAL
HEALTH

INDICATE NORTH - NAME ADJOINING ROADWAY AS BASE LINE.

PERMIT CARD OK Rte 40

SEPTIC TANK, LEVEL 2

CLEANOUTS OK

DISTRIBUTION BOX, LEVEL _____

TILE FIELD, DEPTH _____ FT. TRENCH WIDTH _____ FT.

GRAVEL DEPTH _____ IN. TOTAL LENGTH _____ FT.

NUMBER OF TRENCHES _____ TOTAL BOTTOM AREA _____

SEEPAGE PITS, INSIDE DIAMETER 16 FT. DEPTH BELOW INLET 5 FT.

ABSORBENT AREA 401 SQ. FT.

REMARKS _____

DATE SYSTEM APPROVED 12/20/67 INSPECTOR J. H. Kilmore

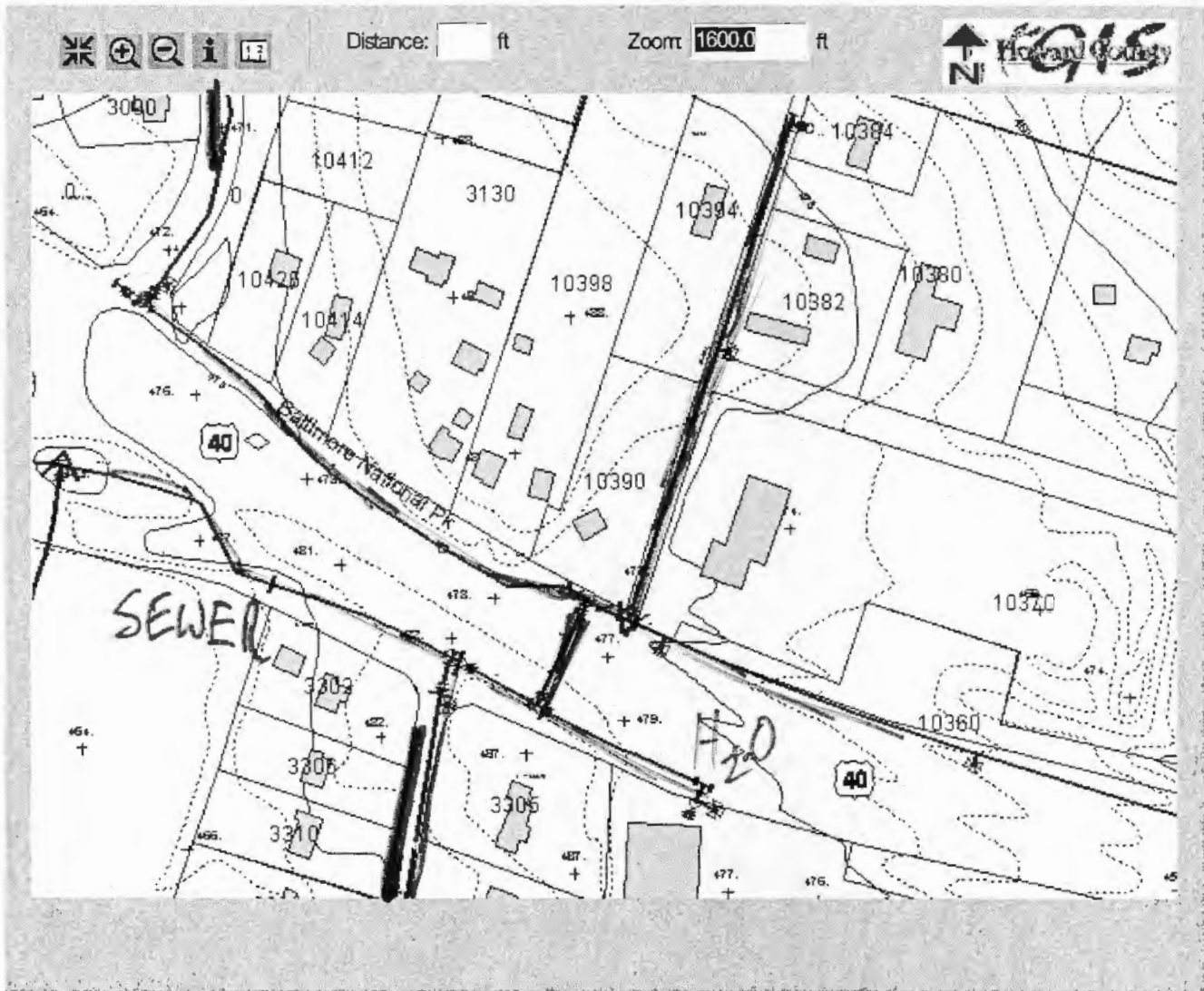
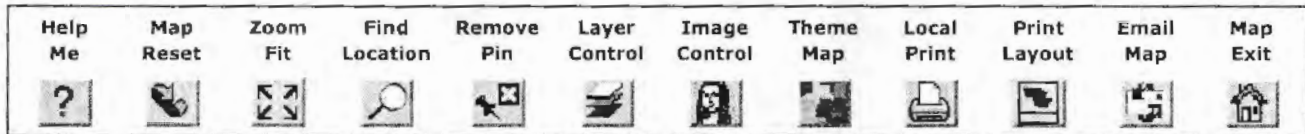

Disclaimer: Howard County, Maryland assumes no responsibility for the accuracy of this map or the information contained herein or derived therefrom. The buyer and/or user assumes all risks and liabilities whatsoever resulting from or arising out of the use of this map. There are no oral agreements or warranties relating to this sale and/or use of this map.

Wednesday, March 17 2004 | 4:05:36 PM | @920

Map Legends

- County Line
- Property Line
- House Driveway
- Contour Lines
- Contour Label 400
- Spot Elev. 401

Property Information

- Property Boundary

Sanitary Sewer

- Pipe
- Manhole
- Plug

Water Lines

*Applied for PUBLIC WATER 11/03 - NOT CONNECTED
BUT NOT SEWER*

Click here for a plain text ADA compliant screen.



Maryland Department of Assessments and Taxation
HOWARD COUNTY
Real Property Data Search

[Go Back](#)
[View Map](#)
[New Search](#)
[Ground Rent](#)

Account Identifier: District - 02 Account Number - 205726

Owner Information

Owner Name: UDOFF NORMAN
UDOFF JOAN B WF
Use: COMMERCIAL
Principal Residence: NO
Mailing Address: 10062 FOX DEN COURT
ELLCOTT CITY MD 21042-2224
Deed Reference: 1) / 1484/ 656
2)

~~BEVERLY MANOR, LOT 18~~

Location & Structure Information

Premises Address
10390 BALTIMORE NATIONAL PIKE
ELLCOTT CITY 21042
Legal Description
.995 A
10390 BALTIMORE NATL PIK
ELLCOTT CITY

Map	Grid	Parcel	Sub District	Subdivision	Section	Block	Lot	Group	Plat No:
24	1	74						80	Plat Ref:

Special Tax Areas
Town Ad Valorem Tax Class A/V, METRO FIRE TAX

Primary Structure Built	Enclosed Area	Property Land Area	County Use
1960	1,148 SF	43,342.00 SF	
Stories	Basement	Type	Exterior

Value Information

	Base Value	Phase-in Assessments		
		Value As Of	As Of	As Of
Land:	198,300	01/01/2004	07/01/2003	07/01/2004
Improvements:	35,500	198,300		
Total:	233,800	32,700	233,800	231,000
Preferential Land:	0	231,000	0	0

Transfer Information

Seller: KRAMER JOHN H
Type: IMPROVED ARMS-LENGTH
Date: 06/19/1986
Deed1: / 1484/ 656
Price: \$145,000
Deed2:
Seller: DORSEY S SNOWDEN & WF
Type: IMPROVED ARMS-LENGTH
Date: 02/24/1982
Deed1: / 1091/ 340
Price: \$120,000
Deed2:
Seller:
Date:
Deed1:
Price:
Deed2:

Exemption Information

Partial Exempt Assessments	Class	07/01/2003	07/01/2004
County	000	0	0
State	000	0	0
Municipal	000	0	0

Tax Exempt: NO
Exempt Class:

Special Tax Recapture:

* NONE *

Information

PremiseNo	10390
PremiseAddress1	10390 BALTIMORE NATIONAL PK
PremiseAddress2	ELLCOTT CITY, MD 21042
AccountID	1402205726
OccupiedBy	N
OwnerName1	UDOFF NORMAN
OwnerName2	UDOFF JOAN B WF
OwnerAddress1	10062 FOX DEN COURT
OwnerAddress2	ELLCOTT CITY MD 21042
LegalDescript1	IMPS .995 A
LegalDescript2	10390 BALTIMORE NATL PIK
DeedLiber	01484
DeedFolio	0656
Subdivision	0000
Plat	
Section	
Block	
Lot	
Map	24
Grid	1
Parcel	74
MapParcelLot	M24P74L
ExemptionClass	NOT EXTRACTED Taxable Property
Acres	0.99
StructureGrade	
ConstructionType	
Stories	
DwellingType	
YearBuilt	1960
BuildingSquareFeet	1148
SalesTransNo	863103
GrantorName	KRAMER JOHN H
GrantorLiber	01091
GrantorFoilo	0340
TransferDate	19860619
SalePrice	145000
LandValue	198300
ImprovementValue	35600
TotalValue	233900



DEPARTMENT OF HEALTH AND MENTAL HYGIENE
OFFICE OF ENVIRONMENTAL PROGRAMS
201 W. PRESTON STREET
BALTIMORE, MARYLAND 21201

Charles R. Buck, Jr., Sc.D.
Secretary

William M. Eichenbaum
Assistant Secretary for
Environmental Programs

Construction Permit

Operating Permit

DHS Facility Permit

AIR MANAGEMENT ADMINISTRATION

PERMIT NO. 13-9-0075

Date Issued May 25, 1982

PERMIT FEE None

In accordance with
Expiration Date 01MAR 19.18.02.93D

LEGAL OWNER & ADDRESS

John H. Kranner
4939 Foundhill Road
Ellicott City, Maryland 21043

SITE

10390 Baltimore National Pike
Ellicott City, Maryland 21043
Howard County

INSTALLATION DESCRIPTION

3 - 8,000 gallon underground gasoline storage tanks with 4" drop tubes and
3" OPV 233V vapor recovery vent valves.

Director, Air Management Administration

Assistant Secretary for Environmental Programs

STATE OF MARYLAND - DEPARTMENT OF HEALTH AND MENTAL HYGIENE

Office of Environmental Programs
Air Management Administration
201 W. Preston Street
Baltimore, Maryland 21201

APPLICATION FOR PROCESSING OR MANUFACTURING EQUIPMENT:

Permit to Construct Registration

G cc80		Do Not Write In This Space															
1. Owner of Installation or Company Name <i>John H. Krummer</i>		Date of Application <i>5-12-82</i>															
Date Rec. Local <i>5-12-82</i>		Date Rec. State <i>MAY 13 1982</i>															
Mail Address <i>4939 Roundhill Rd</i>		Telephone <i>465-8472</i>															
City <i>Ellicott City Md</i>		Zip Code <i>21043</i>															
2A. Premise Name if Different from Above		Acknowledgment Sent Date _____ By _____															
2B. Equipment Location if Different from Above <i>10390 Balto. Nat Pike Ellicott City Md 21043</i>		Reviewed Name _____ Date _____															
Street Address City, Town State Zip Code		Local State <i>JH</i> <i>MAY 14, 1982</i>															
3. Owner, Agent or Authorized Company Official		Returned to Local Jurisdiction Date <i>5-26-82</i> By <i>JH</i>															
Print or Type Name _____ Signature _____		Application Ret'd. Date _____ By _____															
Mailing Address City, Town State Zip Code		Premise Number <table border="1" style="display: inline-table; border-collapse: collapse;"><tr><td style="width: 20px; height: 20px; text-align: center;">1</td><td style="width: 20px; height: 20px; text-align: center;">3</td><td style="width: 20px; height: 20px; text-align: center;">0</td><td style="width: 20px; height: 20px; text-align: center;">1</td><td style="width: 20px; height: 20px; text-align: center;">3</td><td style="width: 20px; height: 20px; text-align: center;">5</td></tr><tr><td style="font-size: 8px;">(1)</td><td style="font-size: 8px;">(2)</td><td style="font-size: 8px;">(3)</td><td style="font-size: 8px;">(4)</td><td style="font-size: 8px;">(5)</td><td style="font-size: 8px;">(6)</td></tr></table>		1	3	0	1	3	5	(1)	(2)	(3)	(4)	(5)	(6)		
1	3	0	1	3	5												
(1)	(2)	(3)	(4)	(5)	(6)												
4A. New Construction Only Begin _____ Date Construction Complete _____		4B. Existing Installation Initial Operation Date: _____ (14-15)															
5. Installer or Contractor (New or Replacement Only)		<table border="1" style="display: inline-table; border-collapse: collapse;"><tr><td style="width: 20px; height: 20px; text-align: center;">9</td><td style="width: 20px; height: 20px; text-align: center;">0</td><td style="width: 20px; height: 20px; text-align: center;">0</td><td style="width: 20px; height: 20px; text-align: center;">7</td><td style="width: 20px; height: 20px; text-align: center;">5</td><td style="width: 20px; height: 20px; text-align: center;">8</td><td style="width: 20px; height: 20px; text-align: center;">2</td></tr><tr><td style="font-size: 8px;">(7)</td><td style="font-size: 8px;">(8)</td><td style="font-size: 8px;">(9)</td><td style="font-size: 8px;">(10)</td><td style="font-size: 8px;">(11)</td><td style="font-size: 8px;">(12)</td><td style="font-size: 8px;">(13)</td></tr></table>		9	0	0	7	5	8	2	(7)	(8)	(9)	(10)	(11)	(12)	(13)
9	0	0	7	5	8	2											
(7)	(8)	(9)	(10)	(11)	(12)	(13)											
Name or Company Title <i>Jack's Motoring Services</i>		Mailing Address City, Town State Zip Code Telephone <i>4862 Ilchester Rd Ellicott City Md 21043 744-9374</i>															
6. Number of Identical Units <i>3</i> (16-18)		7. Number of Units per Stack _____															
8A. Major Activity <i>Gasoline</i>		8B. Type of Installation (Cement Kiln, Aggregate, Dryer, Grey Iron Cupola, etc.) <i>Gasoline Storage Tanks</i> (20-22)															
9. Operating Schedule (for this installation)																	
Continuous Operations <input checked="" type="checkbox"/> 23-1		Batch Process _____ 23-2															
Seasonal Variation In Operations _____		No Variations <input checked="" type="checkbox"/> 35															
Cycle Duration (Hrs.) _____		Winter Percent _____ 36-37															
Shifts Per Day <i>2</i> 24		Spring Percent _____ 38-39															
Days Per Week <i>6</i> 25		Summer Percent _____ 40-41															
Days Per Year <i>310</i> 28-30		Fall Percent _____ 42-43															
10. Annual Fuel(s) Consumed by Each Unit Covered by this Application -- Sulfur Content to Nearest Tenth Percent. Do Not Include Fuels Consumed by Other Equipment or Used to Generate Hot Air or Steam.																	
Oil <i>44-49</i> (gals.)		Sulfur Content _____ Grade <i>50</i>															
Coal <i>57-62</i> (Tons)		Sulfur Content _____ Ash Content _____															
Natural Gas _____		Sulfur Content _____															
LP Gas _____ (Gal.)		Sulfur Content _____															
Coke <i>67-1</i> <i>68-72</i> (Tons)		Sulfur Content _____ Ash Content _____															
Coke Gas <i>73-4</i> <i>74-78</i> (Ft ³)		Sulfur Content _____															
Blast Furnace Gas <i>67-2</i> <i>68-72</i> (Ft ³)		Sulfur Content _____															
Wood <i>67-3</i> <i>68-72</i> (Tons)		Sulfur Content _____															
Other Process By-Product _____		Sulfur Content _____ Ash Content _____															
Specify Type _____		Annual Amount _____ Specify Units _____ 74-78															

H cc I-II Same as G

11. Materials Used in this Installation. Specify all materials used by this installation, identifying chemical composition and rate of input. Include all solvents used. Additional information should be included on supplemental data sheet, if necessary.

	Input Rate (Lbs./Process Hr.)	Annual Use (Tons)
12-13 <u>Estimated Trough put in Gallons of</u>		
14-15 <u>Reg. Unleaded & Super</u>	<u>30,000 per month</u>	<u>360,000</u>
16-17		
18-19		
20-21		
22-23		

12. Materials Produced by this Installation. Specify all materials produced by this installation, identifying chemical composition and output rate. Include all solvents produced. Use AQ-8 if necessary.

	Production Rate (Lbs./Process Hr.)	Annual Production (Tons)
24-25		
26-27		
28-29		

Emission Rates	Other (Specify Type and Units)
Particulate Matter _____ gr/scfd	_____
Oxides of Sulfur _____ lbs/hr. of Operation	_____
Oxides of Nitrogen _____ lbs/hr. of Operation	_____
Carbon Monoxide _____ lbs/hr. of Operation	_____
Hydrocarbons _____ lbs/hr. of Operation (Specify Type—CH ₄ , Alcohol, Ketone, etc.)	_____

13. Stack Information: Not Applicable (55-1)

Number of Stacks _____ Height Above Ground (Ft.) 30-32 Inside Diameter At Top (In.) 33-35 Exit Temperature (°F) _____ Velocity (Ft./Min.) 40-43

14. Emission Control Devices — Gas Cleaning Form AQ-6 Must Be Completed for Each Device Used & Attached to this Application.

None 44 Settling Chamber or Baffles 45 Simple Cyclone 46 Multiple Cyclone 47 Scrubber 48 Venturi Scrubber 49 Electrostatic Precipitator 50 Bag-house 51 After-burner 52

Other VAPOR RECOVERY
Specify Type 53-54

15. Indicate by Block Diagram the Flow of Materials, All Major Equipment and All Points of Discharge to the Atmosphere. Indicate any connection to other installation(s) requiring registration, and all emission control devices. Provide a materials balance for all materials in this process, including waste and discharge materials.

All Three Tanks identical 8000 Steel
Vapor Recovery System OPW

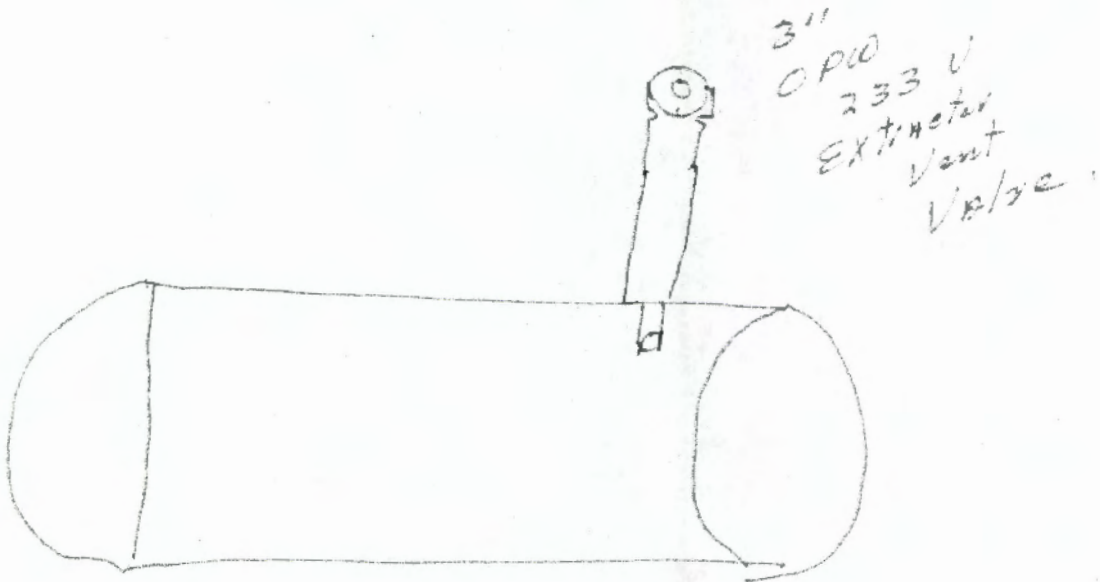
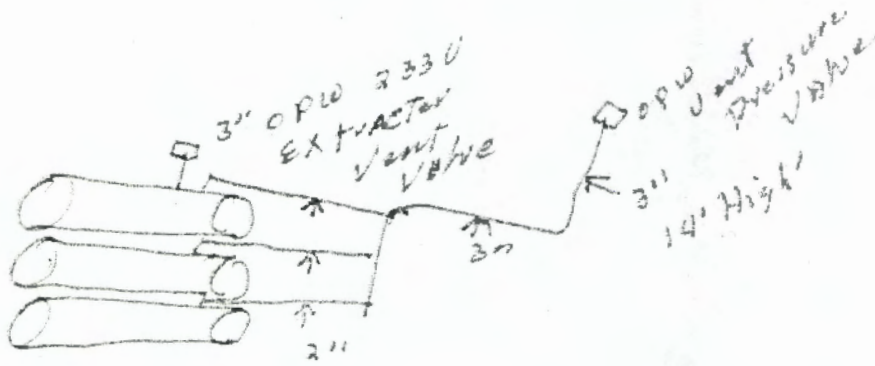

16. Capture Efficiency—Percent of total emission actually input to control device(s).

Particulate Matter	<input type="text" value="56"/>	<input type="text" value="57"/>	Oxides of Sulfur	<input type="text"/>	<input type="text"/>	Oxides of Nitrogen	<input type="text"/>	<input type="text"/>
Carbon Monoxide	<input type="text"/>	<input type="text"/>	Total Hydrocarbons	<input type="text"/>	<input type="text"/>			
	62	63		64	65			

I cc80 I-II Same as G

DO NOT WRITE BELOW THIS LINE

17. Actual Emissions in Pounds Per Operating Day from this Installation:

Particulate Matter	<input type="text"/>	<input type="text"/>	<input type="text"/>	Oxides of Sulfur	<input type="text"/>	<input type="text"/>	<input type="text"/>						
	(12)	(13)	(14)	(15)	(16)	(17)		(18)	(19)	(20)	(21)	(22)	(23)
Oxides of Nitrogen	<input type="text"/>	<input type="text"/>	<input type="text"/>	Carbon Monoxide	<input type="text"/>	<input type="text"/>	<input type="text"/>						
	(24)	(25)	(26)	(27)	(28)	(29)		(30)	(31)	(32)	(33)	(34)	(35)
Total Hydrocarbons	<input type="text"/>	<input type="text"/>	<input type="text" value="3"/>		Carcinogenic Material	<input type="text"/>	<input type="text"/>	Toxic Material	<input type="text"/>				
	(36)	(37)	(38)	(39)	(40)		Yes	No	Yes	No		(42-1)	(42-2)
							(41-1)	(41-2)					

Reactive Hydrocarbons

Aromatics				Aldehydes				Olefins				Paraffins			
<input type="text"/>	<input type="text"/>	<input type="text"/>	<input type="text"/>	<input type="text"/>	<input type="text"/>	<input type="text"/>	<input type="text"/>	<input type="text"/>	<input type="text"/>	<input type="text"/>	<input type="text"/>	<input type="text"/>	<input type="text"/>	<input type="text"/>	<input type="text"/>
(43)	(44)	(45)	(46)	(47)	(48)	(49)	(50)	(51)	(52)	(53)	(54)	(55)	(56)	(57)	(58)
Other _____ Specify _____								<input type="text"/>	<input type="text"/>	<input type="text"/>	<input type="text"/>				
								(59)	(60)	(61)	(62)				

18. Control Efficiency — Percent

				Estimate	Emission Factor	Stack Test	Other		Estimate	Emission Factor	Stack Test	Other	
Particulate Matter	<input type="text"/>	<input type="text"/>	<input type="text"/>	<input type="text"/>	<input type="text"/>	<input type="text"/>							
	(63)	(64)	(65)	(66)	(67-1)	(67-2)	(67-3)	(67-4)					
Sulfur Dioxide	<input type="text"/>			<input type="text"/>	<input type="text"/>	<input type="text"/>	<input type="text"/>	Oxides of Nitrogen	<input type="text"/>	<input type="text"/>			
	(68)	(69)			(70-1)	(70-2)	(70-3)	(70-4)		(71)	(72)	(73-1)	(73-2)
										(73-3)	(73-4)		
Carbon Monoxide	<input type="text"/>			<input type="text"/>	<input type="text"/>	<input type="text"/>	<input type="text"/>	Hydrocarbons	<input type="text"/>	<input type="text"/>			
	(74)	(75)			(76-1)	(76-2)	(76-3)	(76-4)		(77)	(78)	(79-1)	(79-2)
										(79-3)	(79-4)		

1. Calculations Made By CEH

Calculation Sheet Must Accompany This Form

2. Revision By _____ Date _____ By _____ Date _____

_____ Date _____ By _____ Date _____

For DPZ office use only:
Case No. NCU 04-001
Date Filed _____
Date Accepted for Scheduling _____
Hearing Date _____

**NON-CONFORMING USE PETITION
TO THE HOWARD COUNTY DEPARTMENT OF PLANNING AND ZONING**

1. **Petitioner's Name:** Glenn A. Mullinix
Trading as (If Applicable): G.A. Mullinix & ASSO.
Address: 10226 BALT. NATL PIKE SUITE #6 E.C. 21042
Phone No. (W) 410-465-7132 **(H)** 410-461-8017
2. **Counsel for Petitioner:** N/A
Counsel's Address: N/A
Counsel's Phone No.: N/A
3. **Property Identification:**
Address of Subject Property: 10390 BALTIMORE NATIONAL PIKE, E.C. 21042
TAX MAP # 24 GRID 1 LOT 74 LIBR # 324 FOLIO 226
Total Acreage of Property: 60,048 sq. ft.
Property Location:
Election District: _____ **Zoning District:** _____
Tax Map # 24 **Block #** _____ **Parcel/Lot #** 74
Subdivision Name (if applicable): N/A
4. **Petitioner's Interest in Subject Property:**
 OWNER OTHER PETITIONER HAS SALE CONTRACT WITH OWNER
If the Petitioner is not the owner of the subject property, documentation from the owner authorizing the petition must accompany this petition.
5. **Confirmation of Nonconforming Use:**
(a). Describe the magnitude and the extent of the nonconforming use: THE USE BECAME NON CONFORMING AS A RESULT OF REZONING DONE UNDER THE 1977 COMPREHENSIVE REZONING, I WANT TO OFFICIALLY RECORD THE NON-CONFORMING USE

(b). Identify the date that the subject use become nonconforming to the use provisions of the Zoning Regulations: 1977

(c). Describe the documentation included with this petition demonstrating the continuous and uninterrupted use of the site from the specified date: COMPLETE HISTORY FROM 1956 WHEN ORIGINALLY DEVELOPED, NOTARIZED AFFIDAVITS THAT ATTEST TO THE UNINTERRUPTED USE BY LONG TERM NEIGHBORING PROPERTY OWNERS

(d). Describe the documentation included with this petition substantiating the existence of the subject use on the date that the use became nonconforming: SEE ATTACHMENT

(e). Does the nonconforming use involve a structure?

No. Yes. If Yes, describe: A TWO BAY SERVICE STATION BUILDING THAT TOTALS 1206 SQ. FT. IT HAS NOT CHANGED OR BEEN ALTERED SINCE USE BECAME NON-CONFORMING

(f). Any other factors which the Petitioner desires to have considered: RECORDATION OF THE NON-CONFORMING USE WILL ALLOW ME TO FIND A BETTER TENANT AND REFRISH THE SITE WHICH WILL GET RID OF A LONG TERM EYE SORE AND SOURCE OF NUMEROUS ZONING VIOLATIONS WHICH SHOULD HAVE A POSITIVE EFFECT ON THE NEIGHBORHOOD IN GENERAL

GO TO PAGE 3

PLEASE READ CAREFULLY
DATA TO ACCOMPANY PETITION:

6. **Nonconforming Use Plan**

No application for a nonconforming use shall be considered complete unless accompanied by a nonconforming use plan. The submitted plans shall be folded to approximately 8 1/2 x 14 inches. The plan must be drawn to scale and must include the items listed below:

- (a). Courses and distance of outline boundary lines and the size of the property. TITLE INFO INCLD IN PACKAGE
- (b). North arrow.
- (c). Zoning of subject property and adjoining property.
- (d). Scale of plan.
- (e). Existing and proposed uses, structures, natural features and landscaping.
- (f). Location and surface material of existing and proposed parking spaces, driveways, and points of access; number of existing and proposed parking spaces.
- (g). Floor area and height of structures, setback distances from property lines, and other numerical values necessary for the examination of the petition.
- (h). Boundary of area and structures considered to be nonconforming. NOT NEEDED PER ROBERT LACUSIA
- (i). Any other information as may be necessary for full and proper consideration of the petition.

7. **Additional Material, Fees, Posting, and Advertising:**

A). If desired, supplemental pages may be attached to the petition. Eight copies of the petitions, plans and supplemental pages must be submitted.

B). The undersigned agrees to furnish such additional plats, plans, reports or other material as may be required by the Department of Planning and Zoning in connection with the filing of this petition.

The undersigned also agrees to pay all costs in accordance with the current schedule of fees.

The undersigned also agrees to properly post the property at least fifteen (15) days immediately prior to the hearing and to maintain the property posters as required until 15 days immediately after the hearing and submit an affidavit of posting at, or before the time of the hearing.

Go to Page 4

8. Signatures

The undersigned hereby affirms that all of the statements and information contained in, or filed with, this petition are true and correct.

The undersigned has read the instructions on this form, filing herewith all of the required accompanying information.

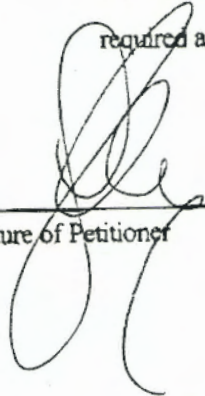

Signature of Petitioner

FEB 11 2004
Date

Signature of Attorney

Date

For DPZ office use only: (Filing fees are \$250.00 plus \$15.00 per poster)

Hearing fee: \$ _____
Poster fee: \$ _____
Total: \$ _____
Receipt No. _____

(Make checks payable to "Director of Finance")

Nonconf. Use Appl./5/6/96

G.A. MULLINIX & ASSOCIATES

10226 Baltimore National Pike

Suite #8

Ellicott City Md. 21042

410-465-7138

410-750-0042 fax

February 11, 2004

Robert Lalush
Howard County Department of Planning & Zoning
3430 Court House Dr.
Ellicott City Md. 21043

Dear Mr. Lalush,

This letter and the attached application/petition and related documentation is in response to George Beisser's letter of January 12th, 2004. I had asked The DPZ to advise me on the status of the Non-Conforming Use of the property known as 10390 Baltimore National Pike, Ellicott City Md. 21042 Tax Map #24 Grid 11lot 74. Currently occupied by Reiter's 40 West Service Center.

I have researched the history of the properties Use since it was originally developed in 1956. At that time it has been confirmed that it was Zoned B-2 under the 1954 zoning in effect at the time, and the Automotive Service Station Use was a permitted use under that regulation. There has never been any deviation from Auto Service usage, However the property became Non-Conforming when it was rezoned as part of the 1977 Comprehensive Zoning Plan. The sale of gasoline was abandon in 1997.

The purpose of this application is to officially confirm & record the Automotive Service / Motor Vehicle Repair Use. The pursuit of this recordation has to do with the pending sale from the Udoff family to myself. It needs to be done for appraisal issues relating to the property value, and to a lesser extent so the use may be continued with a new tenant. Mr. Reiter will not be involved under my ownership, he was given the option but doesn't, at his age he wants to invest in reinventing his business after the site is refurbished. I'm not interested in letting it decay further or letting the current eyesore remain as-is. Long term it is my intention to pursue POR zoning for this site, along with the adjacent properties I own west of this site currently being considered under the on going Rt.40 Study. However I must deal with current situation for the next few years. I have researched and provided an accurate history of the Automotive Service use. I am also providing you with Notarized Affidavits from two of the neighboring property owners that can attest to the entire history. since they have lived on these properties since the Station was built in 1956. I felt this was much more credible than collecting dozens of affidavits from people that could only attest to a portion of the properties history, since the use and history in general is widely known. I'm not asking for a change of use nor is this a request to review a new or previously unknown non-conforming use. I just want to pursue official confirmation & recording of the Non-Conforming Use that became non conforming as a result of the re-zoning that followed the 1977 Comprehensive Zoning Plan.

I am not planning drastic changes to the site for a new tenant. I've attached a scale drawing of the proposed changes. I plan to remove the gas pump islands and repave the existing parking lot as needed. I will then re-stripe the lot to create a conventional parking lot that meets basic current requirements for the existing Auto Service/ Motor Vehicle Repair Use as it relates to the existing structure. It appears that it will take very little work widening side walks and reconfiguring the rest room to comply with ADA standards. Basic Building maintenance, painting, repair of outdoor and indoor lighting that has been long neglected and remodeling of the office area to suit the tenant. Is all I plan to do. This should however have a huge impact on the overall appearance and curb appeal making it a much more viable for a good tenant.

Sincerely,

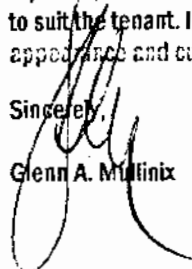
Glenn A. Mullinix



HOWARD COUNTY DEPARTMENT OF PLANNING AND ZONING
3430 Courthouse Drive ■ Ellicott City, Maryland 21043 ■ 410-313-2350

Marsha S. McLaughlin, Director

www.co.ho.md.us
FAX 410-313-3467
TDD 410-313-2323

January 12, 2004

Glenn A. Mullinix
G.A. Mullinix & Associates
10226 Baltimore National Pike, Suite 6
Ellicott City, Maryland 21042

RE: 10390 Baltimore National Pike
Tax Map 24, Grid 1, Parcel 74 (the "Property")

Dear Mr. Mullinix:

This is in response to your letter dated January 6, 2004, in which you request information related to the Property referenced above. In your letter, you explain that the Property was originally developed with a gasoline service station in 1956, and may have been approved with a special exception or equivalent process at that time. You note that the Property is no longer used for gasoline sales, but that it is still in use for a vehicle service business. You ask for information about possible potential commercial uses for the Property, and the status of the original gasoline service station use, because the Property is currently zoned R-20 (Residential: Single).

Based upon a cursory review of the zoning records, it is likely that the Property was zoned B-2 (Business 2) in 1956. In the 1954 Zoning Regulations which would have been in effect at that time, gasoline service stations and motor vehicle repair were both permitted uses, so a special exception should not have been required. If the gasoline service station was established after the adoption of the 1961 Zoning Regulations, there would have been a special exception required. Whether or not there was ever a special exception issued, however, it appears that the Property was rezoned to R-20 with the 1977 Comprehensive Zoning Plan, and any commercial use then legally existing on the Property would have become a nonconforming use.

There is no record that the existing motor vehicle repair use has ever been officially confirmed as a nonconforming use. If it is a nonconforming use, this use may be continued on the Property, but other commercial uses are not permitted under the current R-20 zoning. The gasoline sales use was abandoned and cannot be restored in any way. Extensions and/or enlargements of the motor vehicle repair use are possible, but only through approval by the Hearing Authority. I have attached a copy of the Nonconforming Use regulations, which covers all the issues related to such uses. If you have any questions, please contact Bob Lalush at 410-313-2350.

Sincerely,

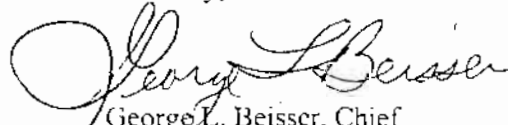
George L. Beisser, Chief
Division of Public Service
and Zoning Administration

GLB/jrl:jl
Attachment
cc: Anthony LaRose

Norman Udoff

P.O. Box 555
Ellicott City Md. 21042

February 11, 2004

To Whom it may concern,

I have entered into a sale agreement with Glenn A. Mullinix for the property known as 10390 Baltimore National Pike, Ellicott City Md. 21042. Mr. Mullinix has my permission to pursue the re-establishment and recordation of the Automotive Service Non Conforming use that has been left in limbo since the Gasoline Sales at the Service Station were abandon in recent years

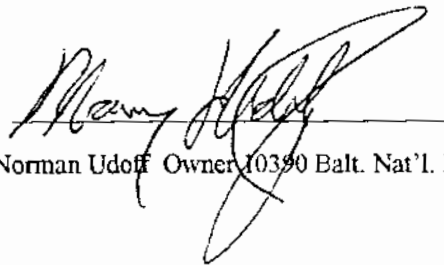
A handwritten signature in black ink, appearing to read "Norman Udoff", written over a horizontal line. The signature is stylized and cursive.

Norman Udoff Owner 10390 Balt. Nat'l. Pike

G. A. MULLINIX & ASSOCIATES

10226 Baltimore National Pike
Suite 6
Ellicott City Md. 21042
410-465-7138
410-750-0042 fax

Automotive Service History For 10390 Baltimore National Pike

I have compiled the following history for the property known as 10390 Baltimore National Pike. Tax Map 24, Grid 1, Parcel 74, currently occupied by Reiters Auto Service. I spoke directly with several of the Exxon operators (Pre- 1980) who are still living. Mr. Richard Barth & Mr. Charles Kimball. I also spoke with all of the neighboring property owners with any long term history. Again Mr. Richard Barth who currently resides behind the property. Mr. Fred Allnutt who's business neighbors the property to the East. Mr. Bill Cornell who lived to the north east of the property from 1979 to 1990 (current Porta home, which was also Mr. Ledbetter's Home 1942-1966, Mr. Richard Barths & Mr. Ledbetter's daughters Home 1966-1977) I am the neighboring property owner for the three properties to the west, but I also spoke with James Sullivan who lives just west of my properties at the corner of Rt. 40 and Pebble Beach Dr. Mr. Sullivan has lived there since the station was built. I have provided notarized statements from both Mr. Richard Barth and Mr. James Sullivan since they have lived next to the station the entire time it has existed. In Mr. Barths case his father-in-law built The Station, and he and his father operated it for the majority of the years it was an Exxon. I am also providing a register of the people I interviewed to establish this history. I have cross referenced statements and used land records to keep the time line as accurate as possible.

Mr. Richard Barth who currently resides on the adjacent property immediately to the north helped me with the early history of the property. Mr. Barths former Father in law Mr. Ledbetter owned most of the property west of Boones La. up to Cemetery La. with Rt. 40 frontage. He started to subdivide and sell parcels off around the time Rt. 40 was established. Mr. Richard Barth grew up on Boones la. Then he married Mr. Ledbetter's daughter and moved into the home Mr. Ledbetter had built northeast of the station when he sold his farm to Carlee Jones around 1942. (This would be the current Porta Home) Mr. Richard Barth later bought the lot behind the station from S. Snowden Dorsey he built a home there in 1977 when he and Mr. Ledbetter's daughter divorced. He resides there to this day.

In 1956 Mr. Ledbetter had the Service Station built on what became 10390 BNP. It was operated for about the first 6 months by a year by a partnership but no one recalls their names. Then Mr. Joseph Barth (Richard Barths Father) leased the property late in 1956. It is believed the station was run as an independent with Esso /Exxon fuels in this early period. Mr. Ledbetter sold the property to S. Snowden Dorsey in 1958 and the Dorsey's entered into a lease agreement with Standard Oil/ Esso-Exxon. The Station was under a master lease to Exxon until it was de-invested in 1980 it was operated by a number of proprietors during that period as a Service Station. Through all of this period (1958 to 1982) the Dorsey Family owned the property. Mr. Joseph Barth remained the proprietor under Exxon (Standard Oil-Esso) and ran it steady until 1971. A Mr. Charles Murry bought the business from him and ran it until September of 1973. Then he sold the business to Mr. Richard Barth (Joseph Barths son) who ran it until 1976. It was then sold to Dave King of King Enterprises who ran it until 1977. In 1977 Charles Kimball of Kimball's Auto Service in Ashton bought the business he was the last Exxon tenant, at that time it was in need of repair. New EPA standards were coming into play and new tanks were required. Exxon and the Dorsey's were apparently in a dispute about making improvements to the Station, this was fueled by the fact that Exxon was collecting three times the rent they were paying to the Dorsey Family. Exxon had tried to buy it and improve it but the Dorsey family would not sell to them and the Dorsey's would not invest in repairs. This standoff according to Mr. Kimball lead to Exxon De-investing the station. Mr. Kimball was not able to work with the Dorsey's either, so the station was abandon by Mr. Kimball in late 1980. The station was vacant for a short time. The Dorsey family apparently decided to sell due to EPA Pressures. John Kramer contracted to buy the property in 1981. The station was sold to Kramer's Auto service in Feb. of 1982. Kramer had owned St. Johns Amoco up until a few years earlier. And was operating his auto service business next door to My Auto Body Shop at 3275 Bethany La. when he contracted to buy the Station I recall the situation drug on for sometime while the status of what was needed to re-open it was sorted out. In Early 1982 Fred Allnutt (JFC Excavation) did the work removing the original tanks and installing what were at the time, modern EPA compliant Tanks & Pumps. This was done in cooperation with Carol Independent Fuel Co. Kramer Started the station as a Citgo Station along with his AAA

towing & service business. This lasted for several years but Kramer ultimately ended up moving his business to Columbia in the Dobbin Auto Service Park in 1984. Kramer leased the station to Ken Spears who was also operating the Citgo at Town and County Blvd. and Rodgers Ave. Mr. Spears stayed there until 1986. Around the time he left Mr. Kramer's creditors foreclosed and the station was auctioned off. Mrs. Udoff bought the station in 1986 and leased it to Reiter's it remained a Citgo station until it was shut down in 1997. Reiter as it turns out has been the station's longest continuing operator having been there from 1986 until the present.

The history shows the station has been used consistently as an Auto Service Station since its construction in 1956 until the present. All of the operators did Auto Service work typical of a Classic Service Station. Many of them also ran towing and road service operations from this location. It appears that the Oil Companies involved made offers to update and rework the station but the Ownership's over the years would never agree to these terms. And weren't interested in improving the property on their own. This has led to a decline in its condition that started to slide in the late seventies to its current state.

In 1997 Due to the volume of gas being pumped there and lack of compliance with mandatory updates related to the volume, the Sale of Gasoline was shut down. The Udoff's would not make a long term commitment to Citgo/ Carol Independent Fuel Co. to have required vapor recovery systems installed on the tanks and pumps as mandated by the state, nor would they have the work done themselves to keep the station compliant. This led to them being shut down. The tanks were pulled in November of 1999. Contrary to Rumors the Tanks were in good condition and not leaking. I spoke with the Howard County Health Dept. and Woody Featherstone of the Maryland Department of the Environment in July of 2003 Mr. Featherstone observed the removal of the tanks. He told me there were only three tanks underground and that they were in fact in good condition the only ground contamination found was the old contamination that had occurred in the Exxon years prior to 1980 and this contamination was of a nature that posed no threat to human health or the environment. The MDA cleared the site in July of 2002 and closed the case.

The purpose of this history is to officially confirm and record the Automotive Service Non Conforming Use. The Automotive Service use has existed at this property since it was originally developed in 1956 when it was apparently correctly zoned for that use and it has been established that use has been continuous to the present day. Since the Gasoline Sales Part of the Service Station Non conforming use was Abandoned, and that was part of the use when it became a Non Conforming Commercial Property as a result of the 1977 Comprehensive Zoning Plan I've been advised by the Office of Planning and Zoning that the Automotive Service Non Conforming use should be officially confirmed and recorded.

I had personnel knowledge of John Kramer's Purchase of the property since his business was next to mine at the time he purchased it in 1981-82. I have also been a business neighbor to the Udoff's since 1986 and knew details of Mrs. Udoff's Purchase and what has gone on at the property over the years that Mr. Reiter has Operated it. The Udoff's originally discussed this sale with me in 1999 when the tanks were pulled. The pending sale prompted me to get involved in the adjacent properties that I have acquired over the past five years.

Others interviewed to establish this history:

William Doubert. Proprietor Pine Orchard Sunoco 1974-1993 Two blocks East of subject property. Can be reached at Turf Valley Pro Shop 410-465-1504

Bill Comell. Owner Bills Towing Lived behind station in Richard Barths old house 1979-1990 (current Porta residence) can be reached at Bills Towing 410-465-3980

Charles Kimball. Former Proprietor of the subject station under Exxon 1977-1980 can be reached at Kimball's Auto Service in Ashton 301-774-4300

James Neubauer. Jim and his father Will were also Exxon dealers two blocks east of the subject property for the entire time it was an Exxon & Citgo Station Jim can be reached at Neubauer's Automotive 410-465-4636

Mark Carroll. Mark worked for Ken Spears at the time he was a Proprietor of Town & County Citgo & 40 West Citgo. (The name of the subject Property at the time). Mark can be reached at Town & County Auto. 410-531-2493

Teresa Stonesifer. Teresa worked at 40 West Citgo for Ken Spears (the subject property) 1984-85 She currently works for Howard County at the weigh station at Alpha Ridge 410-313-5410

Fred Allnut. Fred's Business JFC Excavation has been located next to the subject property on the east side since he developed that property in 1976-77 he can be reached at JFC Excavation 410-461-2266

Malcolm Kane. Pulled title records for the pending settlement help me confirm the timelines people were attesting to for accuracy Mr. Kane can be reached at Lloyd, Kane, Wieder, & Willis, P.A. 410-461-9400

This history was compiled by Glenn A. Mullinix personally over the week of February 2, 2004 and is believed to be accurate.

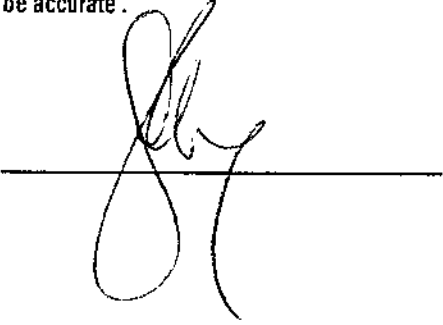
A handwritten signature in black ink, appearing to read "Glenn A. Mullinix", is written over a solid horizontal line. The signature is stylized and cursive.

AFFIDAVIT
To Document the Commercial
Automotive Service Non Conforming Use
at 10390 Baltimore National Pike.
Ellicott City Md. 21042

February 8, 2004

To Whom it My Concern,

I Have reviewed the History Statement Mr. Mullinix has Prepared for the property known as 10390 Baltimore National Pike, Ellicott City Md. 21042 Tax Map 24 Grid 1 Parcel 74. The property currently occupied by Reiter's Auto Service. My former Father in law built the Service Station, and my Father ran the station from 1956 until 1971. Than I myself ran it as an Exxon Station form late 1973 until 1976 . I have also lived in neighborhood or next to the Service Station since it was constructed in 1956.

I can confirm that the history Mr. Mullinix has prepared is an accurate account of the Automotive Service Commercial use that has existed there since it was built. I can also confirm that the Automotive Service Commercial use has also been continuous from the time it opened for business in 1956 to the present day without interruption other than brief transitions between operators when it may have been closed.

Richard Barth

Richard Barth
103 Baltimore National Pike
Ellicott City Md. 21042

Patricia C. Apple

Notary Public

My Commission Expires



9/1/04

AFFIDAVIT
To Document the Commercial
Automotive Service Non Conforming Use
at 10390 Baltimore National Pike.
Ellicott City Md. 21042

February 5, 2004

To Whom it My Concern,

I Have reviewed the History Statement Mr. Mullinx has Prepared for the property known as 10390 Baltimore National Pike, Ellicott City Md. 21042 Tax Map 24 Grid 1 Parcel 74. The property currently occupied by Reiter's Auto Service. Having lived on a neighboring property since the service station was constructed in 1956 I can confirm that the history Mr. Mullinx has prepared is an accurate account of the Automotive Service Commercial use that has existed there since it was built. I can also confirm that the Automotive Service Commercial use has also been continuous from the time it opened for business in 1956 to the present day without interruption other than brief transitions between operators when it may have been closed.

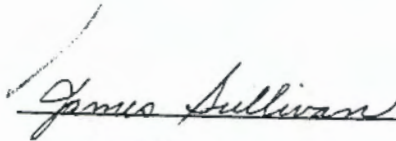

James Sullivan
10426 Baltimore National Pike
Ellicott City Md. 21042





Notary Public State of Md County of Baltimore
Signed in my presence 6 February 2004
my commission expires 06 24 04

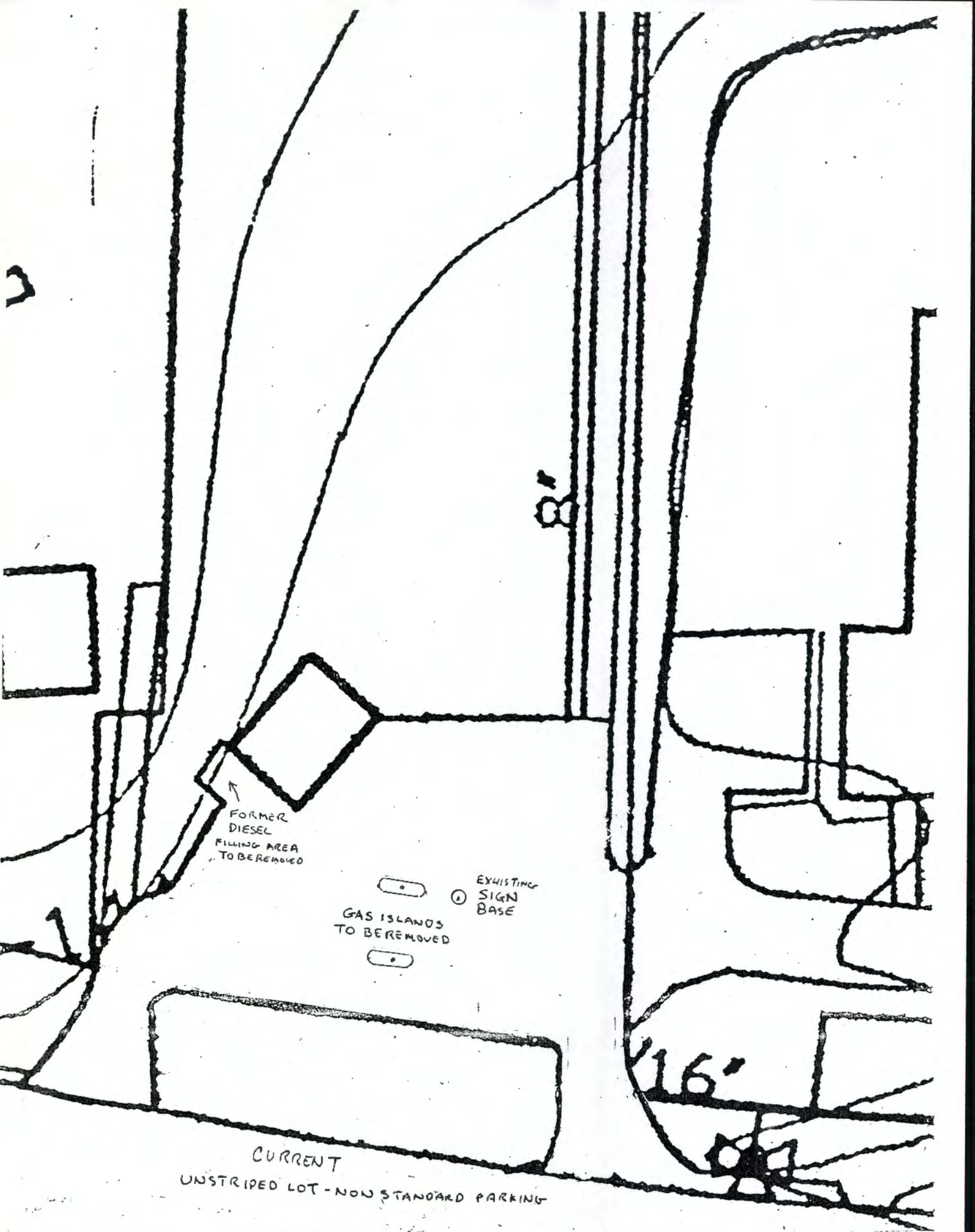

FORMER DIESEL FILLING AREA TO BE REMOVED

GAS ISLANDS TO BE REMOVED

1 EXISTING SIGN BASE

CURRENT UNSTRIPED LOT - NON STANDARD PARKING

16'

P 15092 A 14201

DATE 2/11/70 1/13/69

Location 10881 HARMEL DRIVE Cedar Acres APPLICATION

Harmel Dr.

Hold ()
Approved (✓)
Rejected ()

Lot 8

Applicant Dr. Witt M. Boyer

Owner Melvin E. Anderson

INSTALLATION

Hold ()
Approved (✓)

Permittee Schleicher & Co.

Approved
Date 3/24/70

5/21/70 pm
after 1 pm

PERMIT

P 1000
A 1000

SEWAGE DISPOSAL SYSTEM

MARYLAND STATE DEPARTMENT OF HEALTH

HOWARD COUNTY

ELLICOTT CITY

INDEXED

DISTRICT 5

DATE 2/11/70

Schleicher Plumbing & Heating, Inc. IS PERMITTED TO INSTALL X ALTER

ADDRESS 901 Seagoville Road, Laurel, Md. PHONE 725-9000

A SEWAGE DISPOSAL SYSTEM LOCATED AT _____

SUBDIVISION Cedar Acres ROAD Karnel Dr. LOT 8

PROPERTY OWNER Malvin E. Anders - DeWitte M. Boyer

ADDRESS _____

SPECIFICATIONS = 3 bedrooms

DRAIN FIELD _____ DEPTH _____ FEET, BOTTOM AREA _____ SQ. FT.

SEEPAGE PITS _____ ABSORBENT SIDE-WALL AREA _____ SQ. FT.

SEPTIC TANK CAPACITY 750 GALLONS

FOR GARBAGE GRINDER, INCREASE DISPOSAL AREA 25% & TANK CAPACITY 50%.

OTHER Dry well to be 300 sq. ft. of absorbent sidewall area below the inlet pipe with a maximum depth of 11 ft. dry well to be located 78 ft. from rear lot line and 93 ft. from right side line as lot is even from starting on Karnel Dr., facing lot.

NOTE: ALL PIPE FROM HOUSE TO SEPTIC TANK MUST BE CAST IRON.
PERMIT VOID AFTER THREE YEARS.

PLANS APPROVED BY James T. Wright DATE 2/24/69

FILL SEPTIC TANK AND DISTRIBUTION BOX WITH WATER BEFORE CALLING FOR AN INSPECTION. COVER NO WORK UNTIL INSPECTED AND APPROVED.

NEITHER THE HOWARD COUNTY COMMISSIONERS NOR THE HEALTH DEPARTMENT IS RESPONSIBLE FOR THE SUCCESSFUL OPERATION OF ANY SYSTEM.

NOTIFY THE HEALTH DEPARTMENT 48 HOURS BEFORE EXCAVATIONS ARE TO BE BACK FILLED.

2/17/70

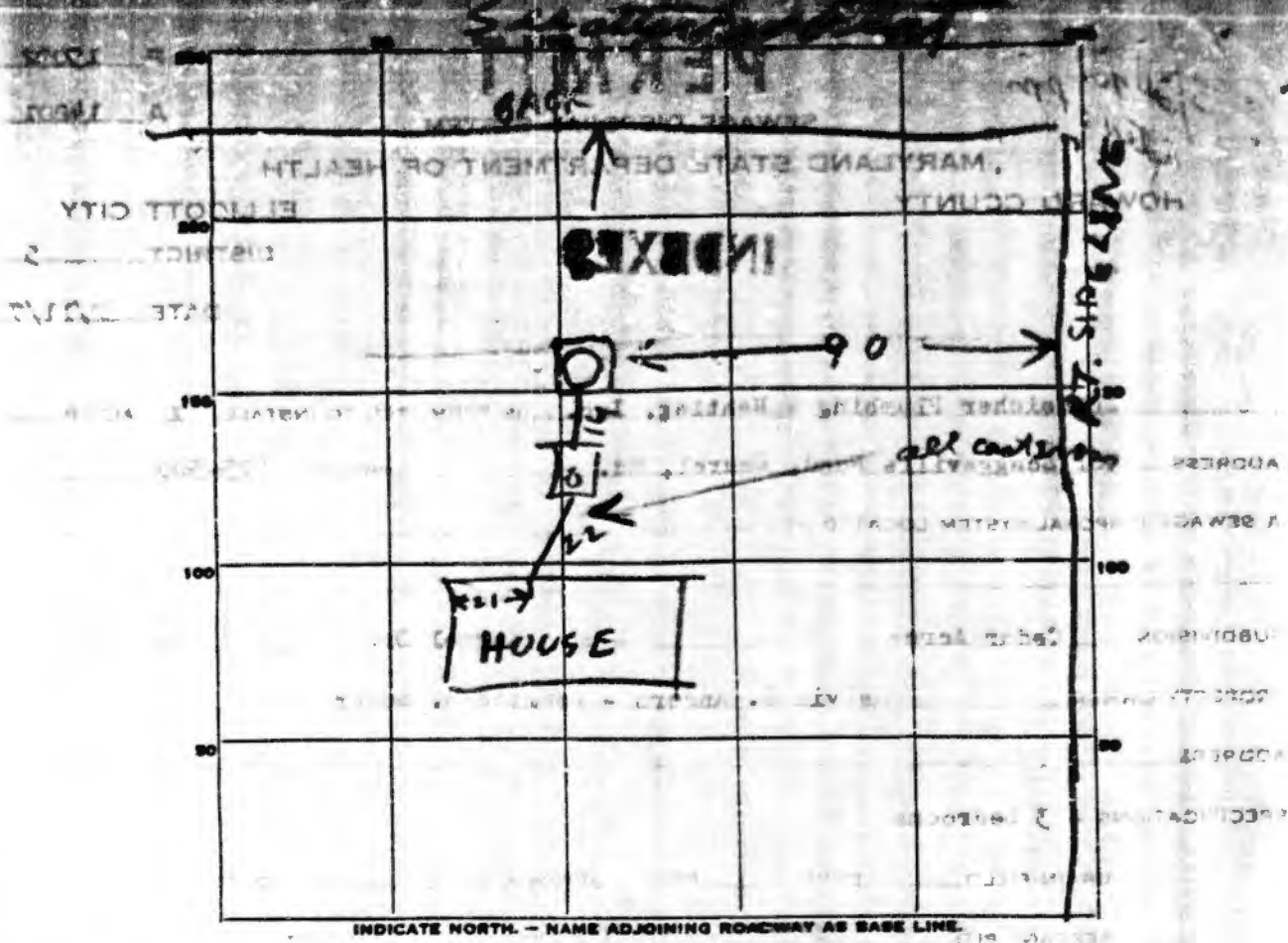

PERMIT CARD

SEPTIC TANK, LEVEL OK 7.50 concrete CLEANOUTS 0 1"
open 2' below grade

DISTRIBUTION BOX, LEVEL _____

TRE FIELD, DEPTH _____ FT. TRENCH WIDTH _____ FT.

GRAVEL DEPTH _____ IN. TOTAL LENGTH _____ FT.

NUMBER OF TRENCHES _____ TOTAL BOTTOM AREA _____

SEEPAGE PITS, INSIDE DIAMETER 9 FT. DEPTH BELOW INLET 9 1/2 FT.

ABSORBENT AREA 391 SQ. FT. counting stone
237 SQ. FT. not counting stone

REMARKS 3/24/70 Daywell installed & 42' deep
Perimeter of Day Well is 42' F
Water Well not yet installed

DATE SYSTEM APPROVED 3/24/70 INSPECTOR Raymond Hodge

Granted 1/14/69-2

APPLICATION

14201
R _____
F _____

SEWAGE DISPOSAL TESTING

MARYLAND STATE DEPARTMENT OF HEALTH

HOWARD COUNTY *Septic tank to be 750 gallons* ELLICOTT CITY

Day well to be 300 sq ft. of asphalt sidewalk
and below the inlet pipe with a max depth
of 11 ft. Day well to be located 78 ft from rear lot line
and 93 ft from Right side line as lot is seen from standing
on Harmel Dr facing lot.

DISTRICT *5d*
DATE *1-13-69*

TO: THE COUNTY HEALTH OFFICER
ELLICOTT CITY, MARYLAND

I, HEREBY, APPLY FOR THE NECESSARY TESTS IN ORDER TO CONSTRUCT (OR RECONSTRUCT) A SEWAGE DISPOSAL SYSTEM.

PROPERTY OWNER *McKivir E. Anders*

ADDRESS *Rt. 4 Harmel Dr.* PHONE *HE-1-5258*
Ellicott City, Md.

PROPERTY LOCATION:

SUBDIVISION *Cedar Bend* LOT NO. *9*

ROAD AND DESCRIPTION *4 1/2 mile down Harmel Dr. then 200 Ft. South*
ON Lot #8

OCCUPANT _____ PHONE _____

PERSON TO CONSTRUCT SYSTEM _____

ADDRESS _____ PHONE _____

SIZE OF LOT *1.26 AC* TYPE BLDG. *(3) Ranch*
NUMBER OF BEDROOMS

IF NOT SINGLE RESIDENCE DESCRIBE _____

SIGNATURE OF APPLICANT *Dwight M. Bayer*

APPROVED BY *James T. Waighe* FOR *Day Well* DATE *1/14/69*
(KIND OF SYSTEM)

REJECTED BY _____ FOR *Day Well* DATE _____
(KIND OF SYSTEM)

HOLD PENDING FURTHER TESTS _____ DATE _____

REASONS FOR REJECTION OR HOLDING _____

THIS IS NOT A PERMIT

father & daughter

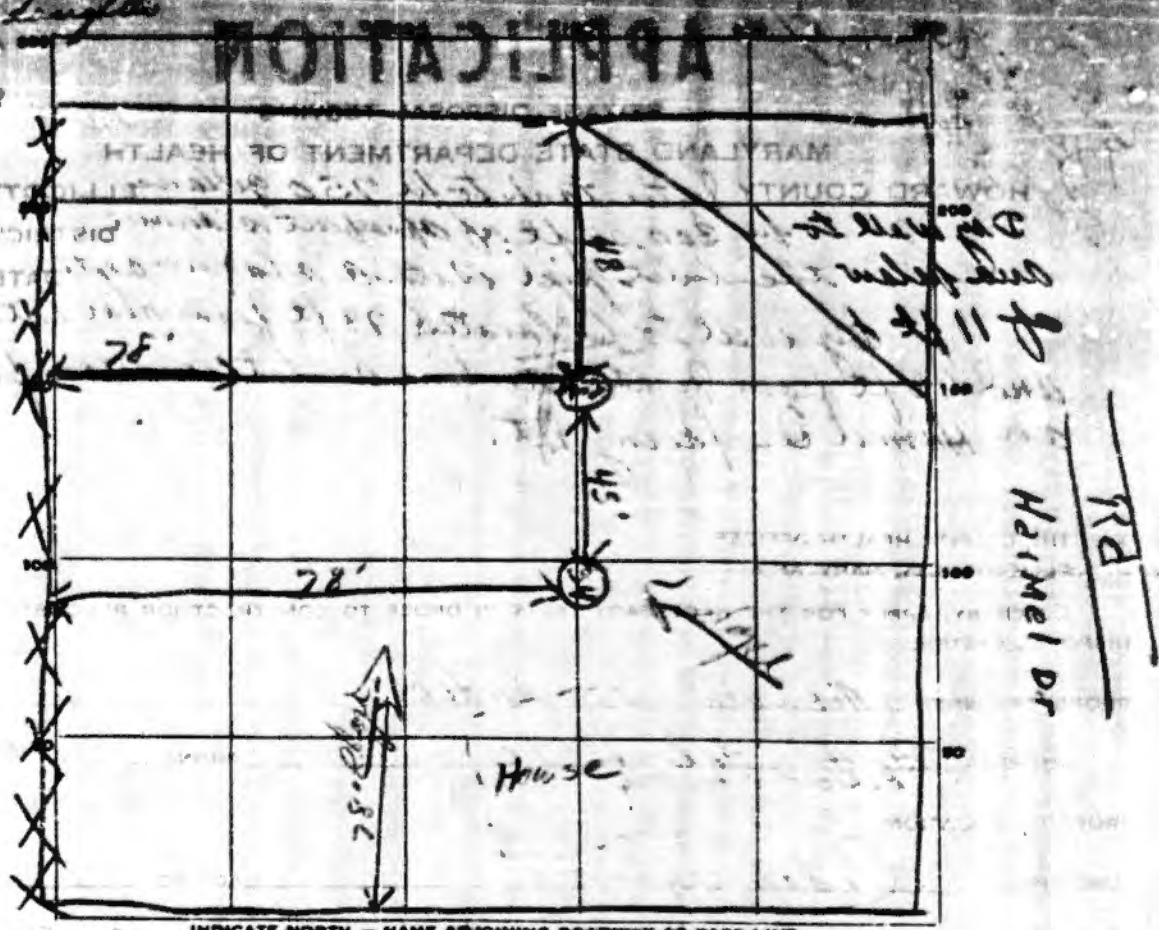

INDICATE NORTH - NAME ADJOINING ROADWAY AS BASE LINE.

DATE	TEST NO.	DEPTH	PRE-WET		TEST - 1" DROP		TIME
			START	STOP	START	STOP	
1/14/69	1	9'	956	957	959	1001	2 min
	2	4'	957	959	958	1003	4 min
	3	9'	1003	1003	1004	1007	3 min
	4	4'	1004	1006	1006	1008	2 min

*11 min for
3 min per*

SOIL AUGER FINDING _____
 TESTED BY 1/14/69
 REMARKS xxx near fence line

Application filed signed by the owner

APPLICATION

A 14201
P _____

Make \$15.00 check payable to
County Health Dept., Suit

SEWAGE DISPOSAL TESTING

MARYLAND STATE DEPARTMENT OF HEALTH

HOWARD COUNTY Septic tank to be 750 gallons ELLICOTT CITY
Dry well to be 300 sq ft of open pit sidewalk DISTRICT 5th
and follow the inlet pipe with a manometer DATE 1-13-69
at 11 ft deep well to be located 78 ft from rear lot line
and 93 ft from right side line as set as seen from standing
on Hammel Dr facing lot.

TO: THE COUNTY HEALTH OFFICER
ELLICOTT CITY, MARYLAND

I, HEREBY, APPLY FOR THE NECESSARY TESTS IN ORDER TO CONSTRUCT OR RECONSTRUCT A SEWAGE DISPOSAL SYSTEM.

PROPERTY OWNER MELVIN E. HINDERS

ADDRESS Rt. 4 HARMEL DR. PHONE KE1-5258
ELLICOTT CITY, MD.

PROPERTY LOCATION:

SUBDIVISION Cedarwood LOT NO. 9

ROAD AND DESCRIPTION 1/8 mile down HARMEL DR, then 200 Ft. South
ON Lot # B

OCCUPANT _____ PHONE _____

PERSON TO CONSTRUCT SYSTEM _____

ADDRESS _____ PHONE _____

SIZE OF LOT 1 ACBE TYPE BLDG (3) Rancher
NUMBER OF BEDROOMS

IF NOT SINGLE RESIDENCE DESCRIBE _____

SIGNATURE OF APPLICANT Dwight M. Boyer

APPROVED BY James T. White FOR Dry Well DATE 1/14/69
NAME OF SYSTEM

REJECTED BY _____ FOR _____ DATE _____
NAME OF SYSTEM

HOLD PENDING FURTHER TESTS _____ DATE _____

REASONS FOR REJECTION OR HOLDING _____

THIS IS NOT A DEMAND

1/14/68

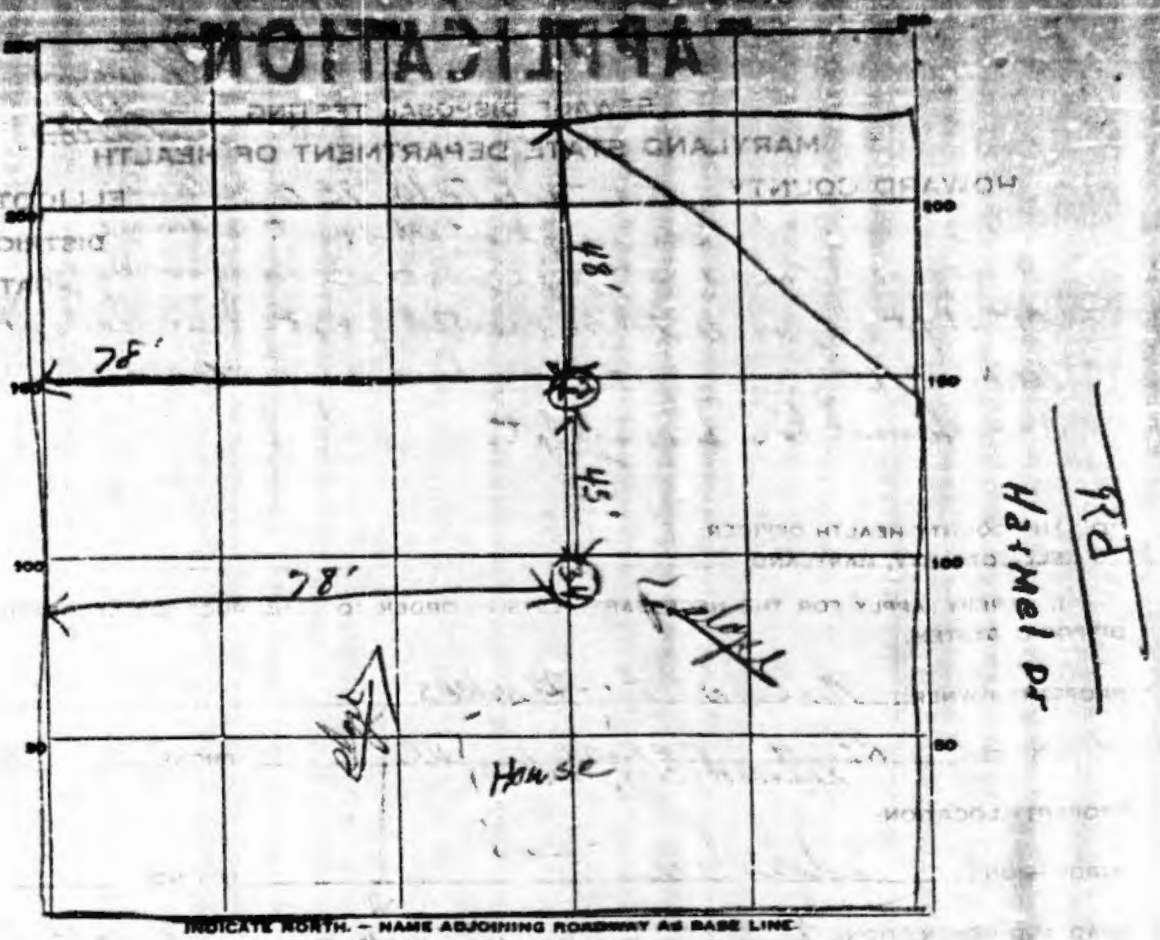

DATE	TEST NO.	DEPTH	PRE-WET		TEST - 1" DROP		TIME
			START	STOP	START	STOP	
1/14/68	1	9'	956	959	959	1001	2 min
	2	4'	957	959	959	1003	4 min
	3 CH-1	9'	1002	1004	1004	1007	3 min
	4	4'	1004	1006	1006	1008	2 min

11 min for
3 min per

SOIL AUGER FINDING _____
 TESTED BY 1/14/68
 REMARKS _____

WELL COMPLETION REPORT

DATE WELL COMPLETED: April 30 1970

DEPTH OF WELL: 40 FT. (TO DEEPEST FOOT)

PERMIT NO. FROM PERMIT TO DRILL WELL: 45-20-01-VK

DRILLERS IDENTIFICATION NO.: 163

OWNER: Boyer

STREET OR RFD: _____

POST OFFICE: Dewitt
Clarksville Maryland

WELL LOG

STATE THE KIND OF FORMATIONS PENETRATED, THEIR COLOR, DEPTH, THICKNESS AND IF WATER BEARING

DESCRIPTION (USE ADDITIONAL SHEETS NECESSARY)	FEET		WATER BEARING
	FROM	TO	
<u>Topsoil</u>	<u>0</u>	<u>3</u>	
<u>Shelly rock</u>	<u>3</u>	<u>10</u>	
<u>Gray rock</u>	<u>10</u>	<u>40</u>	
<u>1 stream water</u>	<u>26</u>		

*Drilled to 20
700. 18 ft
4 bags cement*

GROUTING RECORD

WELL HAS BEEN GROUTED (CIRCLE APPROPRIATE BOX)

YES NO

DEPTH OF GROUT SEAL (TO NEAREST FOOT)

FROM 0 FT. TO 18 FT.

(COVER 0 IF FROM SURFACE)

CASING RECORD

CASING TYPES (CIRCLE APPROPRIATE BOX)

STEEL CONCRETE

PLASTIC OTHER

MAIN CASING TYPE: ST

NOMINAL DIAMETER TOP (MAIN) CASING (NEAREST INCH): 6

TOTAL DEPTH OF MAIN CASING (NEAREST FOOT): 20

OTHER CASING (IF USED)

DIAMETER (NEAREST INCH): _____

DEPTH (NEAREST FOOT): _____

SCREEN RECORD

SCREEN TYPE OR OTHER HOLE (CIRCLE APPROPRIATE BOX)

STEEL BRASS PLASTIC OTHER

PUMPING TEST

HOURS PUMPED (TO NEAREST HOUR): 1

PUMPING RATE (GALLONS PER MINUTE TO NEAREST GALLON): 6

WATER LEVEL (DISTANCE FROM LAND SURFACE) BEFORE PUMPING: 25 FEET

WATER LEVEL (DISTANCE FROM LAND SURFACE) AFTER PUMPING: 25 FEET

TYPE OF PUMP USED (CIRCLE APPROPRIATE BOX)

A AIR B PISTON T TURBINE

C CENTRIFUGAL R ROTARY O OTHER (DESCRIBE BELOW)

J JET E SUBMERSIBLE

Baker

PUMP INSTALLED

TYPE OF PUMP (WRITE APPROPRIATE LETTER IN BOX - SEE ABOVE: A, C, J, P, R, S, T, O)

CAPACITY: GALLONS PER MINUTE (TO NEAREST GALLON): _____

PUMP HORSE POWER: _____

PUMP COLUMN LENGTH (NEAREST FOOT): _____

CASING HEIGHT (CIRCLE APPROPRIATE BOX AND ENTER CASING HEIGHT)

+ ABOVE LAND SURFACE

- BELOW LAND SURFACE

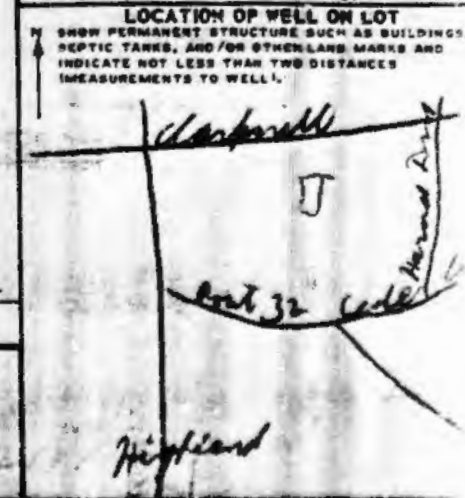

CIRCLE APPROPRIATE BOXES

A WELL WAS ABANDONED AND SEALED WHEN THIS WELL WAS COMPLETED

ELECTRIC LOG OBTAINED

COPY OF ELECTRIC LOG ATTACHED

I HEREBY CERTIFY THAT I HAVE COMPLIED WITH ALL CONDITIONS STATED ON THE ABOVE-CAPTIONED "PERMIT TO DRILL WELL", AND THAT INFORMATION CONTAINED IN THIS REPORT IS TRUE, ACCURATE, AND COMPLETE TO THE BEST OF MY KNOWLEDGE, INFORMATION AND BELIEF.

DRILLERS NAME: Dewey Brown

SIGNATURE: Dewey Brown

SCREEN RECORD

SCREEN TYPE OR OTHER HOLE (CIRCLE APPROPRIATE BOX)

STEEL BRASS PLASTIC OTHER

DEPTH (NEAREST WHOLE FOOT)

FROM _____ TO _____

IF WELL DRILLED WAS A FLOWING WELL CIRCLE BOX

DRILLERS USE ONLY (NOT TO BE FILLED IN BY DRILLER)

TELESCOPE CASING LOG INDICATOR

OTHER DATA AVAILABLE

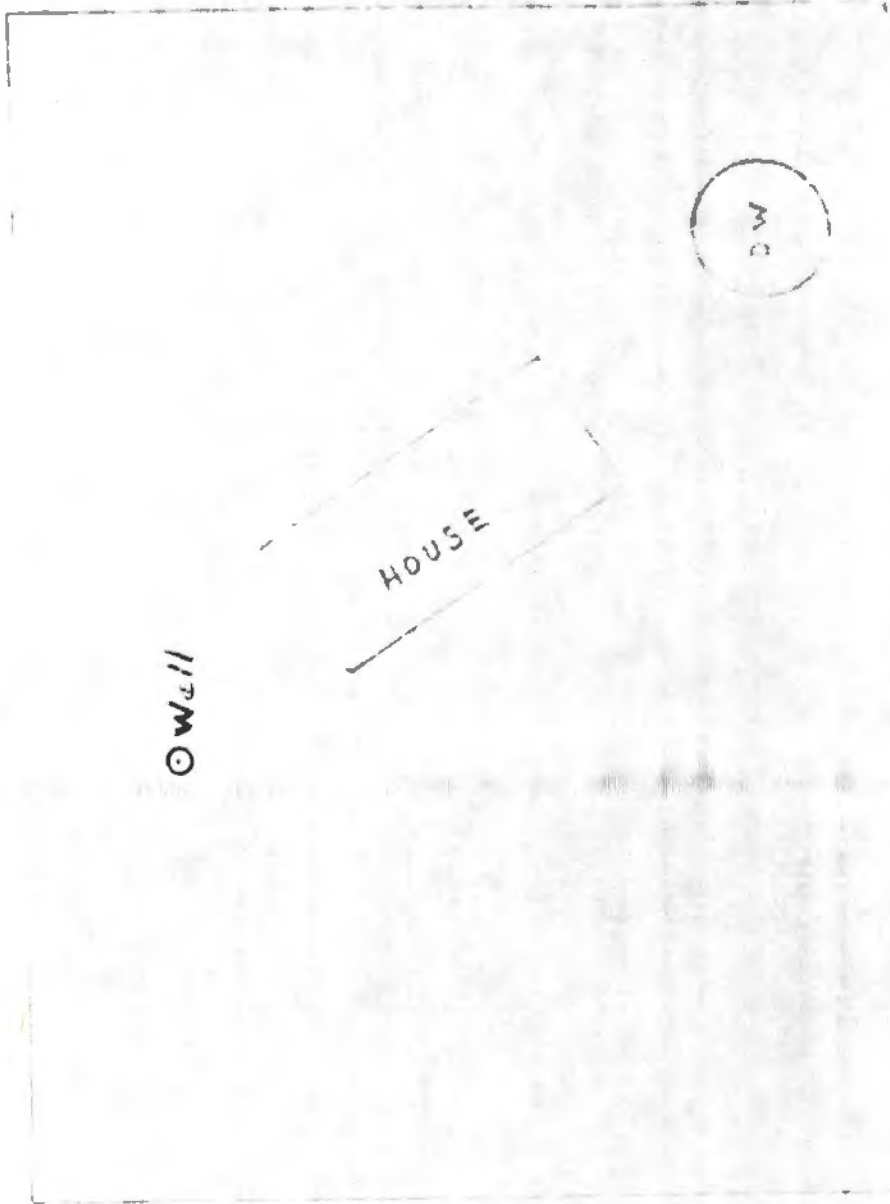

APPROX.
40,000 SQ FT

Well

HOUSE

DW

1 INCH = 30 FT

Preliminary Sketch

PROPOSED LOCATION OF HOUSE AND DRY WELL
FOR DEWITTE M. BOYER

11/28/77
2:00 pm

File

96

FILE Emergency Well Permit DATE REPORTED 10/11/77

PROPERTY OWNER Mr. Boyer

P.O. ADDRESS 10881 Harmel Drive, Columbia, Md. 21044 TELEPHONE 531-6640
(work phone - 792-0454)

DIRECTIONS TO PROPERTY off Cedar Lane near Owen Brown Rd.

Cedar Acre lot 7 Mr. DeWitte (orig. owner)

INFORMANT Mrs. Boyer will be at home after 1:00 P.M. or you can contact mother-in-law, Mrs. Anders at 531-5258. She lives next door so she would be able to let you in to verify that they are without water.

Emergency Well # HO-77-E20 - Ralph Mayne -

CONDITION FOUND 10/11/77 Visited property, spoke to owner Mrs Boyer & Mrs. Anders drilled well in 40 ft. deep. Pump runs 5-10 seconds then shuts off. Plumber a plumber had apparently been here the night before & recommended drilling a new well. Mr. Boyer had same problem w/ well running dry in December of '74 but water level all of a sudden rose, so a new well wasn't dug at that time. F.S. (see attached copy)

10/11/77 T.C. to Mr. Boyer, suggesting he contact a well driller who can drill
ACTION TAKEN as soon as possible, & that well driller contact Health Dept. F.S.

FINAL DISPOSITION 10/27/77 File O.K. to approve emergency well permit when driller contacts Envir. Health. F.S.

8255

(WRA USE ONLY)

STATE OF MARYLAND

WATER RESOURCES ADMINISTRATION

TAWES STATE OFFICE BLDG., ANNAPOLIS, MARYLAND 21401
APPLICATION FOR PERMIT TO DRILL WELL

WRA PERMIT NUMBER

FILL IN THIS FORM COMPLETELY

1 2 3 4 (REQ. NO.) 6
(THIS NUMBER IS TO BE PUNCHED
IN COLS. 3-6 ON ALL CARDS)

DATE RECEIVED (WRA USE ONLY)

OWNER Bayer DeWitte COL 15 LAST NAME FIRST NAME COL. 34
STREET OR RFD 10551 Hazel Dr COL 36 COL. 55
POST OFFICE Columbia, Md. 21044 COL 57 COL. 76

Not on this date

B 1 CONTINUED DRILLER INFORMATION
1 2 3 (SEQ. NO.) 6
DATE Dec. 16 1974 LICENSE NUMBER 273
RALPH MAYNE
FIRST NAME DRILLER LAST NAME
SIGNATURE [Signature]

B 3 LOCATION OF WELL
1 2 3 (SEQ. NO.) 6
COUNTY Howard Co. 21
SUBDIVISION Cedar Hill 42
SECTION 44 C LOT 78 50
NEAREST TOWN Columbia Md 71
MILES FROM TOWN (ENTER 0 IF IN TOWN) 2.2 M I

B 2 WELL INFORMATION
1 2 3 (SEQ. NO.) 6
MAXIMUM PUMPING RATE (GALLONS PER MINUTE) 5 12
AVERAGE DAILY QUANTITY NEEDED (GALLONS PER DAY) 500 20
USE FOR WATER (CIRCLE APPROPRIATE BOX)
 HOME (SINGLE OR DOUBLE HOUSEHOLD UNIT ONLY)
 FARMING, AGRICULTURE, IRRIGATION
 INDUSTRIAL, COMMERCIAL, STATE AND FEDERAL GOVERNMENT.
 MUNICIPAL WATER SUPPLY } MUST HAVE STATE HEALTH DEPT. APPROVAL
 PRIVATE WATER COMPANY
 TEST

B 4 DIRECTION FROM TOWN (CIRCLE APPROPRIATE BOX)
1 2 3 (SEQ. NO.) 6
N NORTH E EAST NE NORTHEAST SE SOUTHEAST
S SOUTH W WEST NW NORTHWEST SW SOUTHWEST
NEAR WHAT ROAD Hazel Dr
ON WHICH SIDE OF ROAD (CIRCLE APPROPRIATE BOX) N S E W
DISTANCE FROM ROAD (ENTER DISTANCE AND CIRCLE APPROPRIATE BOX) 500 FT. M I

APPROXIMATE DEPTH OF WELL 100 FEET
APPROXIMATE DIAMETER OF WELL 6 (NEAREST INCH)

METHOD OF DRILLING USED (CIRCLE APPROPRIATE METHOD)
BORED (OR AUGERED) JETTED DRIVEN
30-37 AIR-ROTARY AIR-PERCUSSION ROTARY (HYDRAULIC ROTARY)
CABLE REVERSE-ROTARY DRIVE-POINT
OTHER (DESCRIBE)

REPLACEMENT OR DEEPEMED WELLS (CIRCLE APPROPRIATE BOX)
 THIS WELL WILL NOT REPLACE AN EXISTING WELL
 THIS WELL WILL REPLACE A WELL THAT WILL BE ABANDONED AND SEALED
 THIS WELL WILL REPLACE A WELL THAT WILL BE USED AS A STANDBY
 THIS WELL WILL DEEPEM AN EXISTING WELL PERMIT NUMBER OF WELL TO BE REPLACED OR DEEPEMED (IF AVAILABLE)

NOT TO BE FILLED IN BY DRILLER (WRA USE ONLY)
APPROPRIATION PERMIT NUMBER [] ENGINEER REVIEW DISTRICT NO. []
FORCE [] WRITE INITIALS IN BOX [] CONDITIONS []

B 4 CONTINUED HEALTH DEPARTMENT APPROVAL
1 2 3 (SEQ. NO.) 6
STATE HEALTH (CIRCLE BOX) COUNTY NAME COUNTY NO.
DATE [] APPROVED BY []

DRAW A SKETCH BELOW SHOWING LOCATION OF WELL IN RELATION TO NEARBY TOWNS, ROADS AND STREAMS WITH NORTH IN THE DIRECTION OF THE ARROW, AND GIVE DISTANCE FROM WELL TO NEAREST ROAD JUNCTION OR STREAM CROSSING SHOWN ON THE SKETCH, ALSO SHOW, BY MEANS OF AN "X", THE WELL LOCATION IN THE BOX BELOW, AND THE BOX NUMBER FROM THE WELL LOCATION MAP.

11/28/77
5 Bags of Cement P.W.D.
20' Well Head
22' Well Case P.W.D.
C.B.D.

B 5 SPECIAL CONDITIONS 8-63 (WRA USE ONLY)

B 1 2072

SEQUENCE NO. (WRA USE ONLY)

STATE OF MARYLAND WATER RESOURCES ADMINISTRATION TAWES STATE OFFICE BLDG., ANNAPOLIS, MARYLAND 21401 APPLICATION FOR PERMIT TO DRILL WELL

WRA PERMIT NUMBER

HO-73-2473 FILL IN THIS FORM COMPLETELY

1 2 3 (SEQ. NO.) 6 (THIS NUMBER IS TO BE PUNCHED IN COLS. 3-6 ON ALL CARDS)

DATE RECEIVED (WRA USE ONLY) 8-13

OWNER: BOYER DEWITTE (COL 18 LAST NAME, FIRST NAME COL. 34) STREET OR RFD: 1089 HARMEL DR. (COL 36) POST OFFICE: Columbia Md. (COL 57)

B 1 CONTINUED DRILLER INFORMATION: DATE: Nov 28 1977 (1 2 3 (SEQ. NO.) 6); LICENSE NUMBER: 223 (77 80); FIRST NAME: Ralph (1 2 3 (SEQ. NO.) 6); DRILLER: MAYNE; LAST NAME: (44 48 48 50); SIGNATURE: Ralph Mayne (52 71)

B 3 LOCATION OF WELL: COUNTY: Howard (1 2 3 (SEQ. NO.) 6); SUBDIVISION: CEDAR ROCKS (8 21); SECTION: Block C (28 42); LOT: D.P. (44 48 48 50); NEAREST TOWN: Columbia (52 71); MILES FROM TOWN: 2 (73 76 77 78)

B 2 WELL INFORMATION: MAXIMUM PUMPING RATE: 5 (GALLONS PER MINUTE) (8 12); AVERAGE DAILY QUANTITY NEEDED: 500 (GALLONS PER DAY) (14 20)

B 4 DIRECTION FROM TOWN: S W (CIRCLE APPROPRIATE BOX); NEAR WHAT ROAD: HARMEL DR. (11); ON WHICH SIDE OF ROAD: W (CIRCLE APPROPRIATE BOX) (52 32 32 32); DISTANCE FROM ROAD: 500 (ENTER DISTANCE AND CIRCLE APPROPRIATE BOX) (34 37 38 39)

USE FOR WATER (CIRCLE APPROPRIATE BOX): D HOME (SINGLE OR DOUBLE HOUSEHOLD UNIT ONLY); F FARMING, AGRICULTURE, IRRIGATION; I INDUSTRIAL, COMMERCIAL, STATE AND FEDERAL GOVERNMENT; M MUNICIPAL WATER SUPPLY; P PRIVATE WATER COMPANY; T TEST; MUST HAVE STATE HEALTH DEPT. APPROVAL

DRAW A SKETCH BELOW SHOWING LOCATION OF WELL IN RELATION TO NEARBY TOWNS, ROADS AND STREAMS WITH NORTH IN THE DIRECTION OF THE ARROW, AND GIVE DISTANCE FROM WELL TO NEAREST ROAD JUNCTION OR STREAM CROSSING SHOWN ON THE SKETCH. ALSO SHOW, BY MEANS OF AN "X", THE WELL LOCATION IN THE BOX BELOW AND THE BOX NUMBER FROM THE WELL LOCATION MAP.

APPROXIMATE DEPTH OF WELL: 150 FEET (24 28)

APPROXIMATE DIAMETER OF WELL: 6 (NEAREST INCH)

METHOD OF DRILLING USED (CIRCLE APPROPRIATE METHOD): BORED (OR AUGERED) JETTED DRIVEN; 30-37 AIR-ROTARY AIR-PERCUSSION ROTARY (HYDRAULIC ROTARY); CABLE REVERSE-ROTARY DRIVE-POINT; OTHER (DESCRIBE)

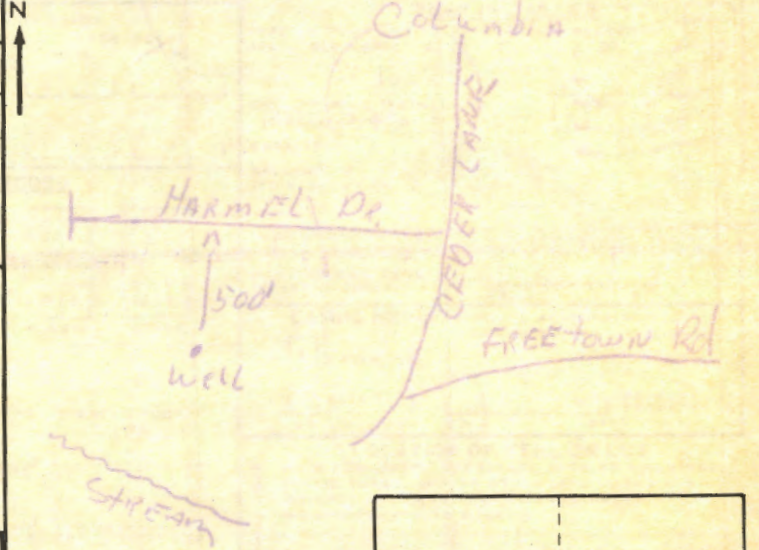

REPLACEMENT OR DEEPEINED WELLS (CIRCLE APPROPRIATE BOX): N THIS WELL WILL NOT REPLACE AN EXISTING WELL; Y THIS WELL WILL REPLACE A WELL THAT WILL BE ABANDONED AND SEALED; S THIS WELL WILL REPLACE A WELL THAT WILL BE USED AS A STANDBY; D THIS WELL WILL DEEPEIN AN EXISTING WELL PERMIT NUMBER OF WELL TO BE REPLACED OR DEEPEINED (IF AVAILABLE) (41 52)

NOT TO BE FILLED IN BY DRILLER (WRA USE ONLY): APPROPRIATION PERMIT NUMBER (54); ENGINEER REVIEW DISTRICT NO. (63); FORCE (57 68); CONDITIONS (70 71 72 73 74 75 76 77 78 79)

BOX NUMBER: E 830, N 490; NORTH COORDINATE: 50 51 52 53 54 55; EAST COORDINATE: 57 58 59 60 61 62 63; ELEVATION AT WELL HEAD (FEET): 0/0 5/0

B 4 CONTINUED HEALTH DEPARTMENT APPROVAL: STATE HEALTH (CIRCLE BOX) S; COUNTY NAME: Howard; COUNTY NO.: 247224; DATE: 12 22 77; APPROVED BY: Palmer F. Wine, Director (43 48)

B 5 SPECIAL CONDITIONS 8-63 (WRA USE ONLY)

C 1 **4349** SEQUENCE NO. (WRA USE ONLY)

1 2 3 (SEQ. NO.) 6
(THIS NUMBER IS TO BE PUNCHED IN COLS. 3-6 ON ALL CARDS)

STATE OF MARYLAND
WATER RESOURCES ADMINISTRATION
 TAWES STATE OFFICE BLDG., ANNAPOLIS, MD. 21401
WELL COMPLETION REPORT

THIS REPORT MUST BE SUBMITTED WITHIN 30 DAYS AFTER WELL COMPLETE

FILL IN THIS FORM COMPLETELY

COUNTY NUMBER W2-284

DATE RECEIVED (WRA USE ONLY) Nov 28, 1977 DEPTH OF WELL 165' PERMIT NO. FROM "PERMIT TO DRILL WELL" 40-29-2980

DATE WELL COMPLETED 15 22 (TO NEAREST FOOT) 26

8-13 15 20 DRILLERS IDENTIFICATION NO. 273

OWNER Boyer LAST NAME DEWITTE FIRST NAME

STREET OR RFD 10881 HARMEL DR. POST OFFICE Columbia Md.

WELL LOG

STATE THE KIND OF FORMATIONS PENETRATED, THEIR COLOR, DEPTH, THICKNESS AND IF WATER BEARING

DESCRIPTION (USE ADDITIONAL SHEETS IF NECESSARY)	FEET		CHECK IF WATER BEARING
	FROM	TO	
Top Soil	0	2	
Sandy	2	11	
Sand Stone	11	25	
Micka	25	40	
Sand Stone	40	45	✓
Micka	45	165	

GROUTING RECORD

WELL HAS BEEN GROUTED (CIRCLE APPROPRIATE BOX) YES NO

TYPE OF GROUTING MATERIAL (CIRCLE BOX):
 CEMENT BENTONITE CLAY

NO. OF BAGS 5 NO. OF POUNDS 300

GALLONS OF WATER 60

DEPTH OF GROUT SEAL (TO NEAREST FOOT)
 FROM 0 FT. TO 21 FT.
 (ENTER 0 IF FROM SURFACE)

PUMPING TEST

HOURS PUMPED (TO NEAREST HOUR) 4

PUMPING RATE (GALLONS PER MINUTE TO NEAREST GALLON) 4

METHOD USED TO MEASURE PUMPING RATE Bucket

WATER LEVEL: (DISTANCE FROM LAND SURFACE)
 BEFORE PUMPING 30 (NEAREST FOOT)
 WHEN PUMPING 165 (NEAREST FOOT)

TYPE OF PUMP USED (CIRCLE APPROPRIATE BOX) (FOR PUMPING TEST)
 AIR PISTON TURBINE
 CENTRIFUGAL ROTARY OTHER (DESCRIBE BELOW)
 JET SUBMERSIBLE

CASING RECORD

INSERT APPROPRIATE CODE BELOW

STEEL CONCRETE
 PLASTIC OTHER

MAIN CASING TYPE ST NOMINAL DIAMETER TOP (MAIN) CASING (NEAREST INCH) 6 TOTAL DEPTH OF MAIN CASING (NEAREST FOOT) 23

OTHER CASING (IF USED)

EACH CASING	DIAMETER (INCH)		DEPTH (FEET)	
	FROM	TO	FROM	TO

PUMP INSTALLED

TYPE OF PUMP (WRITE APPROPRIATE LETTER IN BOX - SEE ABOVE: A, C, J, P, R, S, T, O) 29

DRILLER WILL INSTALL PUMP (CIRCLE APPROPRIATE BOX) YES NO

CAPACITY: GALLONS PER (TO NEAREST GA.)

PUMP HORSE POWER 37 41

PUMP COLUMN LENGTH (NEAREST FOOT) 43 47

SCREEN RECORD

INSERT APPROPRIATE CODE BELOW

STEEL BRASS OR BRONZE OPEN HOLE
 PLASTIC OTHER

CASING HEIGHT (CIRCLE APPROPRIATE BOX AND ENTER CASING HEIGHT)

ABOVE } LAND SURFACE (NEAREST FOOT)
 BELOW }

SCREEN

1 2 3 (SEQ. NO.) 6

EACH SCREEN	DEPTH (NEAREST WHOLE FOOT)	
	FROM	TO
1	<u>21</u>	<u>165</u>
2		
3		

SLOTSIZE 1, 2, 3, 2

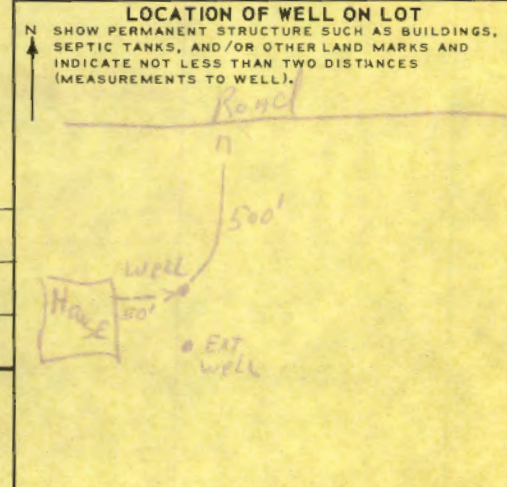

CIRCLE APPROPRIATE BOXES

A WELL WAS ABANDONED AND SEALED WHEN THIS WELL WAS COMPLETED

E ELECTRIC LOG OBTAINED

P TEST WELL CONVERTED TO PRODUCTION WELL

DIAMETER OF SCREEN 56 (NEAREST INCH) FROM 60 TO

GRAVEL PACK

IF WELL DRILLED WAS A FLOWING WELL CIRCLE BOX 68 F

I HEREBY CERTIFY THAT I HAVE COMPLIED WITH ALL CONDITIONS STATED ON THE ABOVE-CAPTIONED "PERMIT TO DRILL WELL", AND THAT INFORMATION CONTAINED IN THIS REPORT IS TRUE, ACCURATE, AND COMPLETE TO THE BEST OF MY KNOWLEDGE, INFORMATION AND BELIEF.

DRILLERS NAME Ralph Mayne

(PLEASE PRINT) Ralph Mayne

SIGNATURE Ralph Mayne

WRA USE ONLY (NOT TO BE FILLED IN BY DRILLER) (E.R.O.S.)

TELESCOPE CASING LOG INDICATOR OTHER DATA AVAILABLE

8389

P. 26334

A. 19025

DATE 6/29/77

LOCATION Old Frederick
Road

LOT _____

APPLICANT Richard E. Boswell

OWNER Richard E. Boswell

PERMITTEE Roland Barth

APPLICATION

HOLD
APPROVED
REJECTED

(+)

INSTALLATION

HOLD
APPROVED

(+)

APPROVED

DATE 8/20/77

PERMIT

SEWAGE DISPOSAL SYSTEM

MARYLAND STATE DEPARTMENT OF HEALTH

HOWARD COUNTY

26334
A 19025

ELLICOTT CITY

DISTRICT 2nd

DATE 6/29/77

INDEXED

Basement IS PERMITTED TO INSTALL ALTER

Address Clarksville Pike Ellicott City, Md. 21043 PHONE 730-8495

SEWAGE DISPOSAL SYSTEM LOCATED AT _____

DIVISION _____ ROAD past Daniels Rd. Old Frederick Rd. - 1/2 mile lot

PROPERTY OWNER Richard Carlo Maxwell

ADDRESS 8502 Route 92, Ellicott City, Md. 445-8754

SPECIFICATIONS 3 bedrooms

DRAIN FIELD _____ DEPTH _____ FEET, BOTTOM AREA _____ SQ. FT.

SEEPAGE RATE _____ ABSORBENT SIDE-WALL AREA _____ SQ. FT.

SEPTIC TANK CAPACITY 1000 GALLONS

FOR GARBAGE GRINDER, INCREASE DISPOSAL AREA 25% & TANK CAPACITY 50%.

OTHER DRY WELL - to have 110 square feet per bedroom (330 square feet) effective absorbent sidewall area below inlet. Inlet no deeper than 3 feet. Maximum depth of dry well to be 11 feet. Locate dry well 25 feet from the 606.50 ft. left side line and approximately 115 feet from the 50.00 ft. front lot line, as seen when facing lot from Old Frederick Rd.

NOTE: ALL PIPE FROM HOUSE TO DISPOSAL AREA MUST BE CAST IRON. PERMIT VOID AFTER THREE YEARS.

NOTE: INSTALL STAND PIPE ON SEPTIC TANK AND DRY WELL. STAND PIPES MUST BE 4 INCHES IN DIAMETER. CAST IRON, CONCRETE OR TERRA COTTA ACCEPTED.

PERMIT APPROVED BY W. W. Zopp DATE 12/3/73

SEPTIC TANK AND DISTRIBUTION BOX WITH WATER BEFORE CALLING FOR AN INSPECTION. COVER NO WORK UNTIL INSPECTED AND APPROVED.

NEITHER THE HOWARD COUNTY COMMISSIONERS NOR THE HEALTH DEPARTMENT IS RESPONSIBLE FOR THE SUCCESSFUL OPERATION OF ANY SYSTEM.

19025

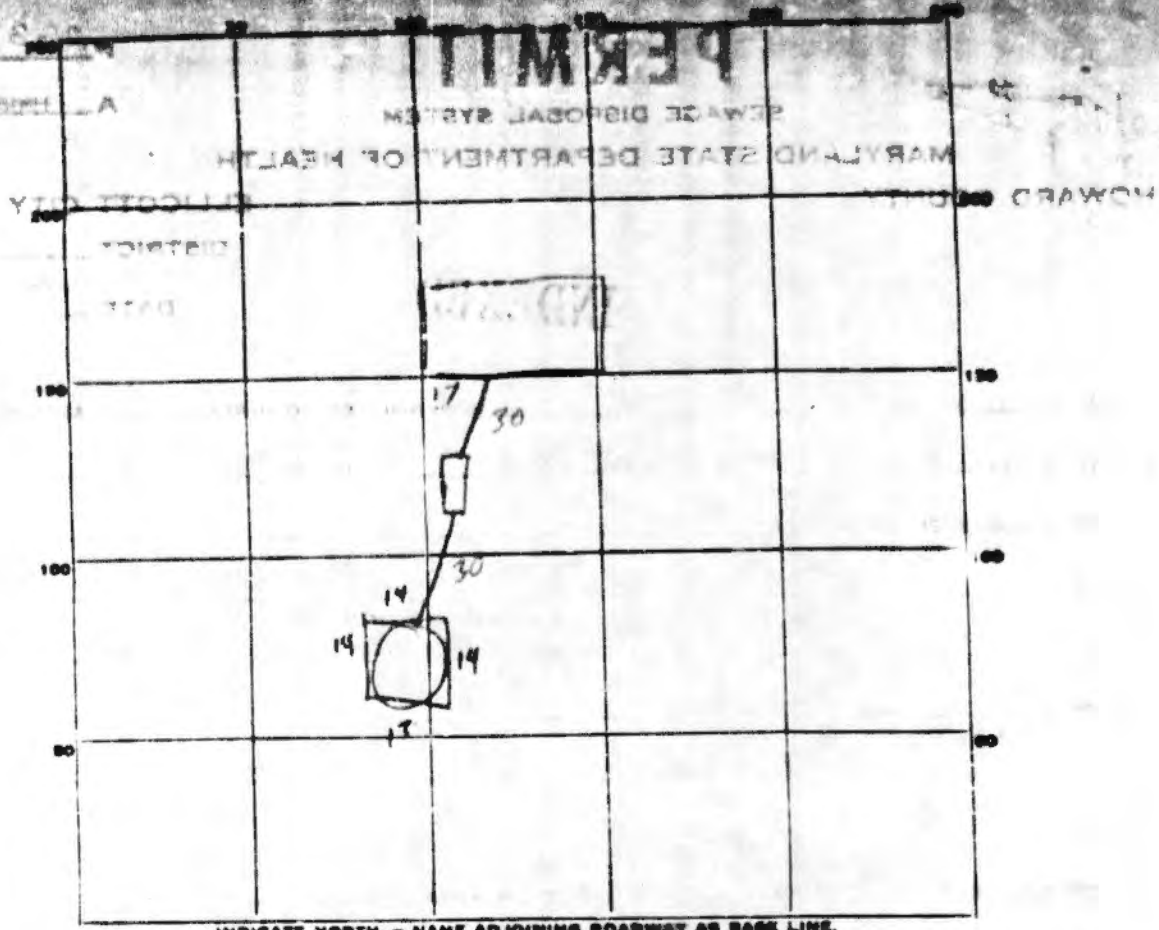

4
55
9/10
44

INDICATE NORTH - NAME ADJOINING ROADWAY AS BASE LINE.

PERMIT CARD _____

SEPTIC TANK, LEVEL 2300

CLEANOUTS DW ST

DISTRIBUTION BOX, LEVEL _____

TILE FIELD, DEPTH _____ FT. TRENCH WIDTH _____ FT.

GRAVEL DEPTH _____ IN. TOTAL LENGTH _____ FT.

NUMBER OF TRENCHES _____ TOTAL BOTTOM AREA _____

SEEPAGE PITS, INSIDE DIAMETER 55 FT. DEPTH BELOW INLET 8 FT.

ABSORBENT AREA 740 SQ. FT.

REMARKS _____

DATE SYSTEM APPROVED 30 Aug 77

INSPECTOR RB

APPLICATION

A 1968

SEWAGE DISPOSAL TESTING

P. _____

STATE OF MARYLAND - DEPARTMENT OF HEALTH AND MENTAL HYGIENE

HOWARD COUNTY HEALTH DEPARTMENT
ENVIRONMENTAL HEALTH SERVICES
P. O. BOX 476, ELLICOTT CITY, MARYLAND 21043
TELEPHONE: 445-8000, EXT. 590

DISTRICT 2

DATE 12/1/73

TO: THE COUNTY HEALTH OFFICER
ELLICOTT CITY, MARYLAND

I, HEREBY, APPLY FOR THE NECESSARY TEST IN ORDER TO CONSTRUCT (OR RECONSTRUCT) A SEWAGE DISPOSAL SYSTEM.

PROPERTY OWNER Richard Earl Beaswell

ADDRESS 8802 Route 99, Ellicott City, Md. PHONE 445-8754

PROPERTY LOCATION:

SUBDIVISION _____ LOT NO. _____

ROAD AND DESCRIPTION Old Frederick Rd. - approx. 1/2 mile west Daniels Road on the East

SIZE OF LOT 2.88 ACRES TYPE BLDG. 1

IF NOT SINGLE RESIDENCE DESCRIBE _____
NUMBER OF BEDROOMS
(Single Family, Dwellg.)

THE SYSTEM INSTALLED UNDER THIS APPLICATION IS ACCEPTABLE ONLY UNTIL PUBLIC FACILITIES BECOME AVAILABLE.

SIGNATURE OF APPLICANT Richard Earl Beaswell

APPROVED BY _____ FOR _____ DATE _____
(KIND OF SYSTEM)

REJECTED BY _____ FOR _____ DATE _____
(KIND OF SYSTEM)

HOLD PENDING FURTHER TESTS _____ DATE _____

REASONS FOR REJECTION OR HOLDING _____

THIS IS NOT A PERMIT

APPLICATION

		see attached	

INDICATE NORTH - NAME ADJOINING ROADWAY AS DASH LINE

DATE	TEST NO.	DEPT:1	PRE-WET		TEST - 1" DROP		TIME	
			START	STOP	START	STOP		
11/01/73	1	2'	11:27	11:23	11:23	11:29	6	
	2	8'	11:22	11:21	11:24	11:26	2	
	3	11'	Vertical, loose sand - 2'					
	4	4 1/2'	Vertical, loose sand					
	5	11 1/2'	12:37	12:36	12:38	12:40	10	
	6	16'	12:36	12:35	12:38	12:44	6	
	7	9'	Vertical, loose sand - 2'					

dug to 11'
 after
 11/1/73

REMARKS _____

TYPE OF SOIL _____ (1+2)

WATER RESOURCES ADMINISTRATION
TANNESS STATE OFFICE BLDG., ANNAPOLIS, MD. 21404
WELL COMPLETION REPORT

FILL IN THIS FORM COMPLETELY

315
THIS WELL IS PUMPED
OR ALL OTHER
IN CASE OF
OR "USE ONLY"
DATE WELL COMPLETED

DEPTH OF WELL

PERMIT NO. FROM "PERMIT TO DRILL WELL"
40-1-1743
20 30 40 50 60 70 80 90

OWNER LAST NAME FIRST NAME
STREET OR RFD POST OFFICE

WELL LOG
STATE THE KIND OF FORMATIONS PENETRATED, THEIR COLOR, DEPTH, THICKNESS AND IF WATER BEARING

DESCRIPTION (USE ADDITIONAL SHEETS IF NECESSARY)	FEET		THICKNESS OF FORMATION
	FROM	TO	
Slab	0	3	
	3	8	
	8	70	
	70	45	

GROUTING RECORD
WELL HAS BEEN GROUTED (CIRCLE APPROPRIATE BOX) Y N

TYPE OF GROUTING MATERIAL (CIRCLE BOX)
CEMENT CM GYPSUM CLAY GC

NO. OF GOOD NO. OF POUNDS

GALLONS OF WATER

DEPTH OF GROUT SEAL (TO NEAREST FOOT)
FROM FT. TO FT.
(ENTER 0 IF FROM SURFACE)

CASING RECORD
INSERT APPROPRIATE CODE BELOW
STEEL ST CONCRETE CC
PLASTIC PL OTHER OT

MAIN CASING TYPE ST NOMINAL DIAMETER (TO NEAREST INCH) 4 TOTAL DEPTH OF MAIN CASING (TO NEAREST FOOT) 91

PUMPING TEST

HOURS PUMPED (TO NEAREST HOUR) 2

PUMPING RATE (GALLONS PER MINUTE TO NEAREST GALLON) 60

METHOD USED TO MEASURE PUMPING RATE Bucket

WATER LEVEL (DISTANCE FROM LAND SURFACE)
BEFORE PUMPING 40 (TO NEAREST FOOT)
WHEN PUMPING 145 (TO NEAREST FOOT)

TYPE OF PUMPED USED (CIRCLE APPROPRIATE BOX)
 AIR P PISTON T TURBINE
 C CENTRIFUGAL R ROTARY O OTHER (DESCRIBE BELOW)
 J JET S SUBMERSIBLE

OTHER CASING (IF USED)
DIAMETER (INCH) DEPTH (FEET)

PUMP INSTALLED
TYPE OF PUMP (WRITE APPROPRIATE LETTER IN BOX - SEE ABOVE: A, C, J, P, R, S, T, O)

DRILLER WILL INSTALL PUMP (CIRCLE APPROPRIATE BOX) Y N

CAPACITY:
GALLONS PER MINUTE (TO NEAREST GALLON)

PUMP HORSE POWER

PUMP TUBING LENGTH (NEAREST FOOT)

SCREEN RECORD
INSERT APPROPRIATE CODE BELOW
STEEL ST BRASS BR WOOD WO
PLASTIC PL OTHER OT

CASING HEIGHT (CIRCLE APPROPRIATE BOX AND ENTER CASING HEIGHT)
 ABOVE LAND SURFACE BELOW (TO NEAREST FOOT)

SCREEN DEPTH (NEAREST WHOLE FOOT)
FROM 40 TO 145

SLOTSIZE 1. 2.

LOCATION OF WELL ON LOT
SHOW PERMANENT STRUCTURE SUCH AS BUILDINGS, SEPTIC TANKS, AND/OR OTHER LAND MARKS AND INDICATE NOT LESS THAN TWO DISTANCES (MEASUREMENTS TO WELL).

CIRCLE APPROPRIATE BOXES

A WELL WAS ABANDONED AND SEALED WHEN THIS WELL WAS COMPLETED

ELECTRIC LOG OBTAINED

TEST WELL CONVERTED TO PRODUCTION WELL

I HEREBY CERTIFY THAT I HAVE COMPLIED WITH ALL CONDITIONS STATED ON THE ABOVE-CAPTIONED "PERMIT TO DRILL WELL", AND THAT INFORMATION CONTAINED IN THIS REPORT IS TRUE, ACCURATE, AND COMPLETE TO THE BEST OF MY KNOWLEDGE, INFORMATION AND BELIEF.

DRILLER'S NAME _____

DATE _____

SIGNATURE _____

DIAMETER OF SCREEN INCHES (INCH)

GRAVEL PACK

IF WELL DRILLED WAS A FLOWING WELL (CIRCLE BOX) F

WRA USE ONLY (NOT TO BE FILLED IN BY DRILLER)
I.E.R.O.S. W O
TELESCOPE LARING LOG INDICATOR OTHER DATA AVAILABLE

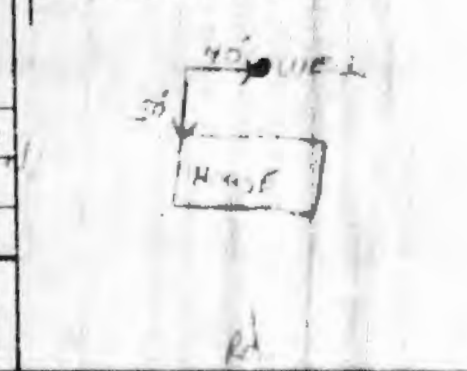

B 1 5846 SEQUENCE NO. (WRA USE ONLY)

STATE OF MARYLAND WATER RESOURCES ADMINISTRATION TAWES STATE OFFICE BLDG., ANNAPOLIS, MARYLAND 21401 APPLICATION FOR PERMIT TO DRILL WELL

WRA PERMIT NUMBER 40-73-246 FILL IN THIS FORM COMPLETELY

DATE RECEIVED (WRA USE ONLY) Deepen well

OWNER COL 15 LAST NAME COL 16 FIRST NAME COL 34 STREET OR RFD COL 35 POST OFFICE COL 57

B 1 CONTINUED DRILLER INFORMATION DATE LICENSE NUMBER FIRST NAME DRILLER LAST NAME SIGNATURE

B 3 LOCATION OF WELL COUNTY SUBDIVISION SECTION NEAREST TOWN MILES FROM TOWN

B 2 WELL INFORMATION MAXIMUM PUMPING RATE (GALLONS PER MINUTE) AVERAGE DAILY QUANTITY NEEDED (GALLONS PER DAY)

B 4 DIRECTION FROM TOWN (CIRCLE APPROPRIATE BOX) NORTH EAST NORTHWEST SOUTH WEST SOUTHWEST

USE FOR WATER (CIRCLE APPROPRIATE BOX) HOME (SINGLE OR DOUBLE HOUSEHOLD UNIT ONLY) FARMING, AGRICULTURE, IRRIGATION

APPROXIMATE DEPTH OF WELL APPROXIMATE DIAMETER OF WELL

METHOD OF DRILLING USED (CIRCLE APPROPRIATE METHOD) BORED (OR AUGERED) JETTED DRIVEN

REPLACEMENT OR DEEPEMED WELLS (CIRCLE APPROPRIATE BOX) THIS WELL WILL NOT REPLACE AN EXISTING WELL

NOT TO BE FILLED IN BY DRILLER (WRA USE ONLY) APPROPRIATION PERMIT NUMBER ENGINEER REVIEW DISTRICT NO.

B 4 CONTINUED HEALTH DEPARTMENT APPROVAL STATE HEALTH COUNTY NAME COUNTY NO. DATE APPROVED BY

Diagram area with sketch showing location of well in relation to nearby towns, roads, and streams. Includes a north arrow and a grid for box numbers.

B 5 SPECIAL CONDITIONS 8-63 (WRA USE ONLY)

FILE Emergency Well DATE REPORTED 3/13/78

PROPERTY OWNER Richard Boswell

P.O. ADDRESS 8389 Old Frederick Road, Ellicott City TELEPHONE _____

DIRECTIONS TO PROPERTY _____

INFORMANT Easterday - Well Driller

Mr. Easterday called this morning to say that this well was not functioning properly and he wanted to deepen well. Old number was HO-73-1926.

*3/13/78 DJO Neill - well observed pitless adaptor,
pump, connections removed. house without water supply.
HO-78-E-3*

CONDITION FOUND _____

ACTION TAKEN _____

FINAL DISPOSITION _____

C 1 **0347** SEQUENCE NO. (WRA USE ONLY)

1 2 3 (SEQ. NO.) 6
 (THIS NUMBER IS TO BE PUNCHED IN COLS. 3-6 ON ALL CARDS)

STATE OF MARYLAND
WATER RESOURCES ADMINISTRATION
 TAWES STATE OFFICE BLDG., ANNAPOLIS, MD. 21401
WELL COMPLETION REPORT

THIS REPORT MUST BE SUBMITTED WITHIN 30 DAYS AFTER WELL COMPLETE

FILL IN THIS FORM COMPLETELY

COUNTY NUMBER

DATE RECEIVED (WRA USE ONLY) 8-13

DATE WELL COMPLETED 9/2/78

DEPTH OF WELL 300 (TO NEAREST FOOT)

PERMIT NO. FROM "PERMIT TO DRILL WELL" 90-73-1126

DRILLERS IDENTIFICATION NO. 42

OWNER BOSWELL RICHARD LAST NAME FIRST NAME

STREET OR RFD 8389 DORCHESTER RD. POST OFFICE ELLICOTT CITY MD.

WELL LOG

STATE THE KIND OF FORMATIONS PENETRATED, THEIR COLOR, DEPTH, THICKNESS AND IF WATER BEARING

DESCRIPTION (USE ADDITIONAL SHEETS IF NECESSARY)	FEET		CHECK IF WATER BEARING
	FROM	TO	
<u>MICA</u>	<u>1-5</u>	<u>300</u>	

GROUTING RECORD

WELL HAS BEEN GROUTED (CIRCLE APPROPRIATE BOX) Y N

TYPE OF GROUTING MATERIAL (CIRCLE BOX)*

CEMENT C M BENTONITE CLAY B C

NO. OF BAGS _____ NO. OF POUNDS _____

GALLONS OF WATER _____

DEPTH OF GROUT SEAL (TO NEAREST FOOT)

FROM _____ FT. TO _____ FT.
 (ENTER 0 IF FROM SURFACE)

CASING RECORD

(INSERT APPROPRIATE CODE BELOW)

STEEL S T CONCRETE C O

PLASTIC P L OTHER O T

MAIN CASING TYPE _____ NOMINAL DIAMETER TOP (MAIN) CASING (NEAREST INCH) _____ TOTAL DEPTH OF MAIN CASING (NEAREST FOOT) _____

OTHER CASING (IF USED)

DIAMETER (INCH) _____ DEPTH (FEET) FROM _____ TO _____

SCREEN RECORD

(INSERT APPROPRIATE CODE BELOW)

STEEL S T BRASS OR BRONZE B R OPEN HOLE H O

PLASTIC P L OTHER O T

DEPTH (NEAREST WHOLE FOOT)

EACH SCREEN	FROM		TO	
	1	2	3	4
1	<u>8</u>	<u>9</u>	<u>11</u>	<u>21</u>
2	<u>23</u>	<u>24</u>	<u>30</u>	<u>36</u>
3	<u>38</u>	<u>39</u>	<u>41</u>	<u>51</u>

SLOT SIZE 1, _____ 2, _____ 3, _____

DIAMETER OF SCREEN 56 (NEAREST INCH) FROM _____ TO _____

GRAVEL PACK _____

IF WELL DRILLED WAS A FLOWING WELL CIRCLE BOX F

WRA USE ONLY (NOT TO BE FILLED IN BY DRILLER)

T (E.R.O.S.) W Q

70 72 74 75 76 OTHER DATA AVAILABLE

PUMPING TEST

HOURS PUMPED (TO NEAREST HOUR) 3

PUMPING RATE (GALLONS PER MINUTE TO NEAREST GALLON) 11 15

METHOD USED TO MEASURE PUMPING RATE BUCKET

WATER LEVEL: (DISTANCE FROM LAND SURFACE)

BEFORE PUMPING 17 (NEAREST FOOT) 20

WHEN PUMPING 22 (NEAREST FOOT) 25

TYPE OF PUMPED USED (CIRCLE APPROPRIATE BOX) (FOR PUMPING TEST)

A AIR P PISTON T TURBINE

C CENTRIFUGAL R ROTARY O OTHER (DESCRIBE BELOW)

J JET S SUBMERSIBLE

PUMP INSTALLED

TYPE OF PUMP (WRITE APPROPRIATE LETTER IN BOX - SEE ABOVE: A, C, J, P, R, S, T, O)

DRILLER WILL INSTALL PUMP (CIRCLE APPROPRIATE BOX) Y N

CAPACITY:

GALLONS PER MINUTE (TO NEAREST GALLON) 31 36

PUMP HORSE POWER 37 41

PUMP COLUMN LENGTH (NEAREST FOOT) 43 47

CASING HEIGHT (CIRCLE APPROPRIATE BOX AND ENTER CASING HEIGHT)

+ ABOVE LAND SURFACE (NEAREST FOOT) 49 50 51

- BELOW

LOCATION OF WELL ON LOT

SHOW PERMANENT STRUCTURE SUCH AS BUILDINGS, SEPTIC TANKS, AND/OR OTHER LAND MARKS AND INDICATE NOT LESS THAN TWO DISTANCES (MEASUREMENTS TO WELL).

CIRCLE APPROPRIATE BOXES

A A WELL WAS ABANDONED AND SEALED WHEN THIS WELL WAS COMPLETED

E ELECTRIC LOG OBTAINED

P TEST WELL CONVERTED TO PRODUCTION WELL

I HEREBY CERTIFY THAT I HAVE COMPLIED WITH ALL CONDITIONS STATED ON THE ABOVE-CAPTIONED "PERMIT TO DRILL WELL", AND THAT INFORMATION CONTAINED IN THIS REPORT IS TRUE, ACCURATE, AND COMPLETE TO THE BEST OF MY KNOWLEDGE, INFORMATION AND BELIEF.

DRILLERS NAME _____

(PLEASE PRINT) _____

SIGNATURE _____

Commercial

Click here for a plain text ADA compliant screen.

Maryland Department of Assessments and Taxation HOWARD COUNTY Real Property Data Search	Go Back View Map New Search
--	---

STR

Account Identifier: District - 04 Account Number - 350103

Owner Information

Owner Name: CATTAIL CREEK COUNTRY CLUB INC SYCAMORE VALLEY PARTNERSHIP Mailing Address: 3600 CATTAIL CREEK DR GLENWOOD MD 21738-9648	Use: COMMERCIAL Principal Residence: NO Deed Reference: 1) / 3224/ 600 2) / 4239/ 402
---	---

Location & Structure Information

Premises Address	Zoning	Legal Description
N CATTAIL CREEK DR GLENWOOD 21738	RCDEO	PAR B 106.972 A CATTAIL CREEK DR CATTAIL CRK CTY CLUB S 2

Map	Grid	Parcel	Sub District	Subdivision	Section	Block	Lot	Group	Plat No:	Plat Ref:	
21	8	211					PAR B	81			11048

Special Tax Areas **Town Ad Valorem Tax Class** NO A/V, NO M/P, RURAL FIRE TAX

Primary Structure Built	Enclosed Area	Property Land Area	County Use
1996	15,468 SF	106.97 AC	

Stories	Basement	Type	Exterior
----------------	-----------------	-------------	-----------------

Value Information

	Base Value	Value As Of	Phase-in Assessments		
		01/01/2002	07/01/2002	07/01/2003	PREFERENTIAL LAND VALUE INCLUDED IN LAND VALUE
Land:	106,700	106,700			
Improvements:	2,912,400	3,400,900			
Total:	3,019,100	3,507,600	3,181,933	3,344,766	
Preferential Land:	106,700	106,700	106,700	106,700	

Transfer Information

Seller:	Date:	Price:
Type:	Deed1:	Deed2:
Seller:	Date:	Price:
Type:	Deed1:	Deed2:
Seller:	Date:	Price:
Type:	Deed1:	Deed2:

Exemption Information

Partial Exempt Assessments	Class	07/01/2002	07/01/2003
County	000	0	0
State	000	0	0
Municipal	000	0	0

Tax Exempt: NO	Special Tax Recapture:
Exempt Class:	AGRICULTURAL TRANSFER TAX COUNTRY CLUB AGREEMENT