

APPLICATION

A 10453

SEWAGE DISPOSAL TESTING

P _____

MARYLAND STATE DEPARTMENT OF HEALTH

HOWARD COUNTY

ELLICOTT CITY

300 sq. ft. 3 bedrooms - 1000 gal. septic tank
DISTRICT 6
DATE 6/30/65

Dry well 12 ft. diameter by 9 ft. deep below the water table 4 ft. from the front property line and 4 ft. off the right side property line as been when laying the lot from Martown road. locate inlet 3 ft. below original grade.

TO: THE COUNTY HEALTH OFFICER
ELLICOTT CITY, MARYLAND

I, HEREBY, APPLY FOR THE NECESSARY TESTS IN ORDER TO CONSTRUCT OR RECONSTRUCT A SEWAGE DISPOSAL SYSTEM.

PROPERTY OWNER Martellini & Brown

ADDRESS RFD #1 - Montgomery Rd., E. C. PHONE PA 5-8888

PROPERTY LOCATION:

SUBDIVISION Wellington Estates LOT NO. 6, Blk. A

ROAD AND DESCRIPTION Martown Rd.

OCCUPANT _____ PHONE _____

PERSON TO CONSTRUCT SYSTEM _____

ADDRESS _____ PHONE _____

SIZE OF LOT 30,000 sq. ft. TYPE BLDG. 3 or 4
NUMBER OF BEDROOMS

IF NOT SINGLE RESIDENCE DESCRIBE _____

SIGNATURE OF APPLICANT /s/ Joseph Martellini

APPROVED BY J. Ferrigan FOR Dry Well DATE 5-4-67
(KIND OF SYSTEM)

REJECTED BY _____ FOR _____ DATE _____
(KIND OF SYSTEM)

HOLD PENDING FURTHER TESTS _____ DATE _____

REASONS FOR REJECTION OR HOLDING _____

THE SYSTEM UNDER THIS PERMIT IS ACCEPTABLE ONLY UNTIL PUBLIC FACILITIES BECOME AVAILABLE

THIS IS NOT A PERMIT

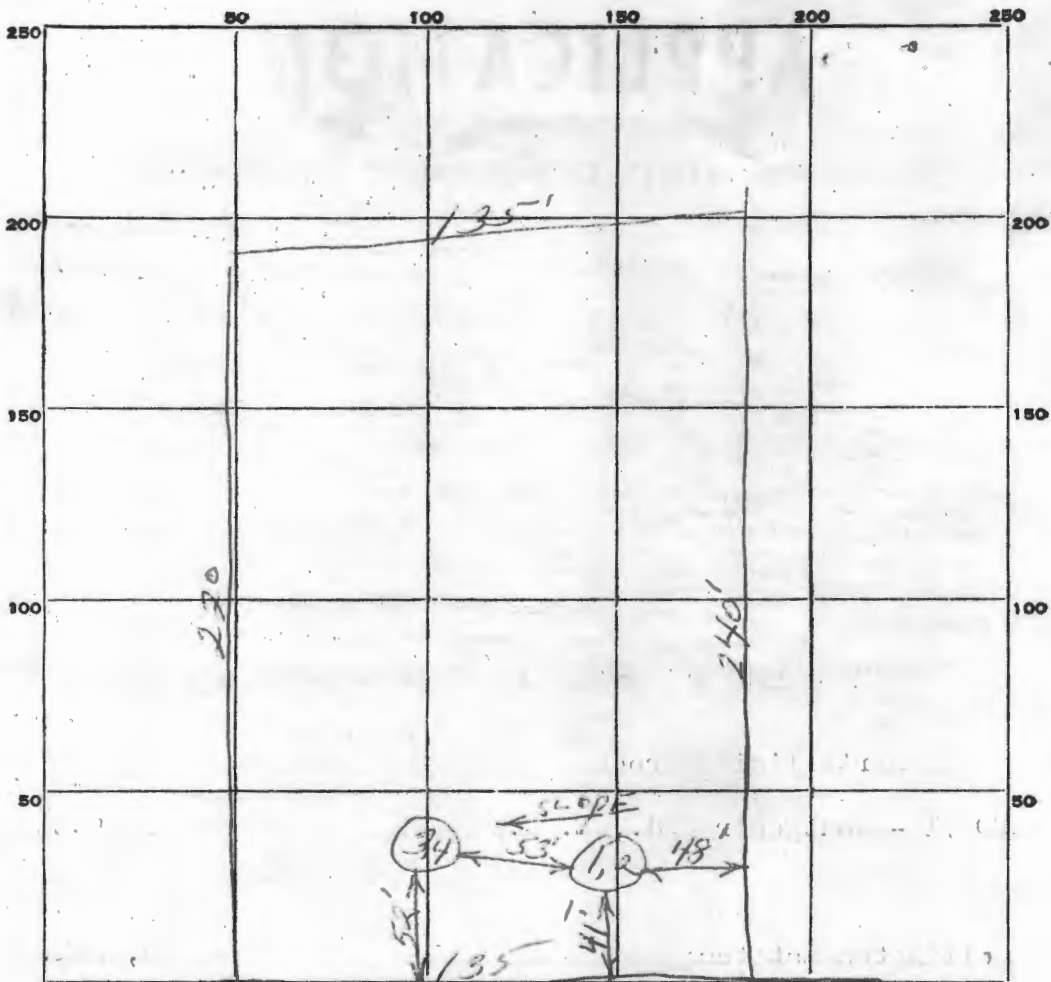

6A

DATE	TEST NO.	DEPTH	PRE-WET		TEST - 1" DROP		TIME
			START	STOP	START	STOP	
7-7-65	1) Same	5 1/2'	10:24	10:25	10:25	10:26	1 Min.
	2) Pit	9'	10:24 1/2	10:25	10:25	10:26	1 Min.
	3) Same	5'	10:29	10:30	10:30	10:30 1/2	1/2 Min.
	4) Pit	8 1/2'	10:30	10:30 1/2	10:30 1/2	10:31	1/2 Min.

av. per.
Time 1 Min

SOIL AUGER FINDING: Use pit 1, 2 for dry well - good soil all way down

TESTED BY: JH & JK

REMARKS: 7-7-65

Real Property Data Search (w3)

Search Result for HOWARD COUNTY

View Map		View GroundRent Redemption				View GroundRent Registration				
Tax Exempt:		Special Tax Recapture:								
Exempt Class:		NONE								
Account Identifier:		District - 06 Account Number - 410766								
Owner Information										
Owner Name:	JOHN DOUGLAS HUNTER TRUSTEE JOHN ELIZA ANNA TRUSTEE				Use:	RESIDENTIAL				
					Principal Residence:	NO				
Mailing Address:	10347 CHAMPIONS WAY LAUREL MD 20723-				Deed Reference:	/18523/ 00063				
Location & Structure Information										
Premises Address:		7998 MARTOWN RD LAUREL 20723-0000			Legal Description:		LOT 6 BL A SEC 2 7998 MARTOWN RD WELLINGTON EST LAUREL			
Map:	Grid:	Parcel:	Sub District:	Subdivision:	Section:	Block:	Lot:	Assessment Year:	Plat No:	12 11
0046	0006	0264		0000			6	2017		Plat Ref:
Special Tax Areas:				Town:		NONE				
				Ad Valorem:		104				
				Tax Class:						
Primary Structure Built		Above Grade Living Area		Finished Basement Area		Property Land Area		County Use		
2004		2,356 SF				31,711 SF				
Stories	Basement	Type	Exterior	Full/Half Bath	Garage	Last Major Renovation				
2	YES	STANDARD UNIT	SIDING	2 full/ 1 half	1 Attached					
Value Information										
		Base Value		Value		Phase-in Assessments				
				As of		As of		As of		
				01/01/2017		07/01/2018		07/01/2019		
Land:		175,700		157,300						
Improvements		286,500		311,400						
Total:		462,200		468,700		466,533		468,700		
Preferential Land:		0						0		
Transfer Information										
Seller: JOHN DOUGLAS HUNTER				Date: 01/18/2019		Price: \$0				
Type: NON-ARMS LENGTH OTHER				Deed1: /18523/ 00063		Deed2:				
Seller: JOHN DOUGLAS H				Date: 01/18/2019		Price: \$0				
Type: NON-ARMS LENGTH OTHER				Deed1: /18523/ 00059		Deed2:				
Seller: JOHN DOUGLAS H				Date: 12/23/2003		Price: \$0				
Type: NON-ARMS LENGTH OTHER				Deed1: /07942/ 00552		Deed2:				
Exemption Information										
Partial Exempt Assessments:		Class		07/01/2018		07/01/2019				
County:		000		0.00						
State:		000		0.00						
Municipal:		000		0.00 0.00		0.00 0.00				
Tax Exempt:		Special Tax Recapture:								