

Bureau of Environmental Health
 8930 Stanford Boulevard, Columbia, MD 21045
 Main: 410-313-2640 | Fax: 410-313-2648
 TDD 410-313-2323 | Toll Free 1-866-313-6300
www.hchealth.org
 Facebook: www.facebook.com/hocohealth

Maura J. Rossman, M.D., Health Officer

RECEIPT DATE: 11-22-17 **ONSITE SEWAGE DISPOSAL SYSTEM**

P 56234

APPROVAL DATE: 1/9/18 **PERMIT: CONSTRUCTION**

A _____

PROPERTY ADDRESS: 11710 Janney Court

SUBDIVISION: Eastern View

LOT: Par A TAX ID: 05-425867

CONTRACTOR: J & A Construction Services

EMAIL: _____

CONTRACTOR ADDRESS: 7991 Bennett Branch Road, Mount Airy, MD 21771

PHONE: 410-635-2484

PROPERTY OWNER: Henry and Cynthia Bell Jr.

EMAIL: cynthiajessicabell@gmail.com

OWNER ADDRESS: 6885 Caravan Court, Columbia, MD 21044

PHONE: 706-536-4509

SEPTIC TANK SIZE (GALLONS): 2000

TANK MANUFACTURER: Mayer Bros Inc.

PUMP MODEL: _____

PUMP SIZE _____

PUMP TANK CAPACITY: _____

DISTRIBUTION SYSTEM: GRAVITY PRESSURE DOSED BEDROOMS: 6 APPLICATION RATE: 0.8

TRENCHES:	LINEAR FEET REQUIRED: <u>187.5</u>	INLET DEPTH: <u>4</u>
	TRENCH WIDTH: <u>3</u>	MAXIMUM BOTTOM DEPTH: <u>7</u>
	MINIMUM SPACE BETWEEN TRENCHES: <u>10</u>	EFFECTIVE AREA BEGINNING DEPTH: <u>4</u>
LOCATION:	PER APPROVED SITE PLAN. SEWAGE DISPOSAL AREA AND TANK LOCATIONS MUST BE STAKED BY LICENSED SURVEYOR PRIOR TO PRE-CONSTRUCTION INSPECTION.	
NOTES:		

ISSUED BY: Robert Bricker

ISSUE DATE: 11-22-17

EXPIRATION DATE: 11-22-18

NOTE: CONTRACTOR MUST SCHEDULE A PRE-CONSTRUCTION INSPECTION PRIOR TO BEGINNING ANY INSTALLATION

NOTE: CONTRACTOR MUST SCHEDULE AN INSPECTION AND GAIN APPROVAL OF ALL COMPONENTS PRIOR TO COVERING

NOTE: STONE MUST BE APPROVED BY HEALTH DEPARTMENT AND GRAVEL TICKET MUST BE AVAILABLE FOR REVIEW.

NOTE: WATERTIGHT TANKS REQUIRED

NOTE: ALL PARTS OF SEPTIC SYSTEM SHALL BE AT LEAST 100 FEET DOWNGRADIENT FROM ANY WATER WELL

NOTE: MANHOLE RISERS REQUIRED ON ALL SEPTIC TANKS AND PUMP CHAMBERS

NOTE: AN ELECTRICAL PERMIT IS REQUIRED FOR INSTALLATION OF ANY ELECTRICAL COMPONENTS OF THE SYSTEM

ELECTRICAL PERMIT ISSUED E _____

NOTE: MDE RECOMMENDS SEPTIC TANKS, BAT, AND OTHER PRETREATMENT UNITS BE PUMPED AT A FREQUENCY ADEQUATE TO ENSURE THAT SOLIDS ARE NOT DISCHARGED TO THE DISPOSAL AREA

NEITHER THE HOWARD COUNTY COUNCIL NOR THE HEALTH DEPARTMENT IS RESPONSIBLE FOR THE SUCCESSFUL OPERATION OF ANY SYSTEM.

PERMITTEE RESPONSIBLE FOR OBTAINING FINAL APPROVAL ON THIS PERMIT.

CALL 410-313-1771 TO SCHEDULE INSPECTIONS.

FOUNDATION DETAIL
SCALE: 1" = 50'

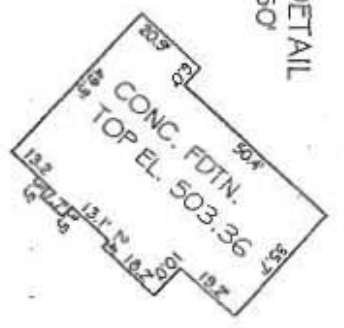

5 84°15'49" E 983.05'
EX. WELL HO941013

N 03°22'53" W 266.91'



*will check
OK' red
1/2/17*

PRIVATE SEWAGE EASEMENT PER
GP-17.90 BY LDE, INC.

A=255.39'
R=350.00'

JANNNEY CT.
50' RW
N 51°03'42.6" W
161.33'

75' BRL

30' BRL

N 60°06'27" E 689.56'

FOUNDATION LOCATION DRAWING
11710 JANNNEY CT.
PRESERVATION PARCEL A
EASTERN VIEW
PLATS #12457-9
5TH ELECTION DIST.
HOWARD COUNTY, MD.
SCALE: 1" = 100' DATE: 9/11/17

- NOTES:
1. ACCURACY OF BUILDING MEASUREMENTS: 0.1'
 2. ACCURACY OF SETBACK DIMENSIONS: 0.1'
 3. ACCURACY OF ELEVATIONS: 0.1'
 4. THE PROPERTY SHOWN HEREON LIES IN ZONE X AS SHOWN ON FLOOD INSURANCE RATE MAP NO. 240270014SD DATED: 11/06/2013
 5. BEARINGS AND DISTANCES SHOWN HEREON ARE FROM RECORDED PLATS #12457-9 AND DO NOT REPRESENT A FIELD-RUN BOUNDARY SURVEY BY SHANABERGER & LANE



THE INFORMATION SHOWN HAS BEEN PREPARED BY THE SURVEYOR AND IS NOT TO BE USED FOR OTHER PURPOSES WITHOUT THE WRITTEN CONSENT OF SHANABERGER & LANE. THE SURVEYOR ASSUMES NO LIABILITY FOR DAMAGES, UNDER NO DIRECT SUPERVISION AND REVIEW BY SHANABERGER & LANE. SEE 09-13-06 OF THE ANNOTATED CODE OF REGULATIONS, TITLE 17, SUBTITLE 09.01, ARTICLE 09.01.01, SECTION 09.01.01.01.

SCOTT SHANABARGER PROFESSIONAL L.S. 10649
LICENSE EXPIRATION DATE 4/2/2018
SHANABERGER & LANE
6726 TOWN AND COUNTRY BLVD., SUITE 201
ELLCOTT CITY, MD. 21043
(410)461-9563 FAX: (410)461-9693 home@shandane.com