



# Building Permit Application

Howard County Maryland  
Department of Inspections, Licenses and Permits  
3430 Court House Drive  
Permits: 410-313-2455  
www.howardcountymd.gov

Date Received: \_\_\_\_\_

Permit No.: \_\_\_\_\_

Building Address: 5040 LINDERA CT  
City: ELLCOTT CITY State: MD Zip Code: 21042  
Suite/Apt. # \_\_\_\_\_ SDP/WP/BA #: \_\_\_\_\_  
Census Tract: \_\_\_\_\_ Subdivision: WALNUT CR #4  
Section: \_\_\_\_\_ Area: \_\_\_\_\_ Lot: 130  
Tax Map: 28 Parcel: 49 Grid: 11  
Zoning: \_\_\_\_\_ Map Coordinates: \_\_\_\_\_ Lot Size: 42,554 SF

Existing Use: SF RES  
Proposed Use: " "  
Estimated Construction Cost: \$ 50,000  
Description of Work: NEW 16'x21' DECK w/  
STEPS + ROOF

Occupant or Tenant: \_\_\_\_\_  
Was tenant space previously occupied?  Yes  No  
Contact Name: \_\_\_\_\_  
Address: \_\_\_\_\_  
City: \_\_\_\_\_ State: \_\_\_\_\_ Zip Code: \_\_\_\_\_  
Phone: \_\_\_\_\_ Fax: \_\_\_\_\_  
Email: \_\_\_\_\_

Property Owner's Name: JEFF + HEIDI HEIGES  
Address: SAME  
City: \_\_\_\_\_ State: \_\_\_\_\_ Zip Code: \_\_\_\_\_  
Phone: 410 370 2867 Fax: \_\_\_\_\_  
Email: \_\_\_\_\_

Applicant's Name & Mailing Address, (if other than stated herein)  
Applicant's Name: \_\_\_\_\_  
Address: \_\_\_\_\_  
City: \_\_\_\_\_ State: \_\_\_\_\_ Zip Code: \_\_\_\_\_  
Phone: \_\_\_\_\_ Fax: \_\_\_\_\_  
Email: \_\_\_\_\_

Contractor Company: RHINE LANDSCAPING  
Contact Person: DAN MURPHY  
Address: PO BOX 1825  
City: SYKESVILLE State: MD Zip Code: 21784  
License No.: MHC # 121739  
Phone: 410 442 2445 Fax: 410 489 4312  
Email: dan@rhinelandscaping.com

Engineer/Architect Company: \_\_\_\_\_  
Responsible Design Prof.: \_\_\_\_\_  
Address: \_\_\_\_\_  
City: \_\_\_\_\_ State: \_\_\_\_\_ Zip Code: \_\_\_\_\_  
Phone: \_\_\_\_\_ Fax: \_\_\_\_\_  
Email: \_\_\_\_\_

Commercial Building Characteristics	Residential Building Characteristics	
Height:	<input checked="" type="checkbox"/> SF Dwelling <input type="checkbox"/> SF Townhouse	
No. of stories:	<b>Depth</b> <b>Width</b>	
Gross area, sq. ft./floor:	1 <sup>st</sup> floor:	
	2 <sup>nd</sup> floor:	
Area of construction (sq. ft.):	Basement:	
	<input type="checkbox"/> Finished Basement	
Use group:	<input type="checkbox"/> Unfinished Basement	
	<input type="checkbox"/> Crawl Space	
<b>Construction type:</b>	<input type="checkbox"/> Slab on Grade	
<input type="checkbox"/> Reinforced Concrete	No. of Bedrooms:	
<input type="checkbox"/> Structural Steel	<b>Multi-family Dwelling</b>	
<input type="checkbox"/> Masonry	No. of efficiency units:	
<input type="checkbox"/> Wood Frame	No. of 1 BR units:	
<input type="checkbox"/> State Certified Modular	No. of 2 BR units:	
	No. of 3 BR units:	
	Other Structure:	
	Dimensions:	
<input checked="" type="checkbox"/> <b>Roadside Tree Project Permit</b>	Footings:	
<input type="checkbox"/> Yes <input type="checkbox"/> No	Roof:	
<b>Roadside Tree Project Permit #</b>	<input type="checkbox"/> State Certified Modular	
	<input type="checkbox"/> Manufactured Home	

Utilities	
<b>Water Supply</b>	
<input type="checkbox"/> Public	
<input checked="" type="checkbox"/> Private	
<b>Sewage Disposal</b>	
<input type="checkbox"/> Public	
<input checked="" type="checkbox"/> Private	
Electric: <input type="checkbox"/> Yes <input type="checkbox"/> No	
Gas: <input type="checkbox"/> Yes <input type="checkbox"/> No	
<b>Heating System</b>	
<input type="checkbox"/> Electric <input type="checkbox"/> Oil	
<input type="checkbox"/> Natural Gas <input type="checkbox"/> Propane Gas	
<input type="checkbox"/> Other:	
<b>Sprinkler System:</b>	
<input type="checkbox"/> Yes <input type="checkbox"/> No	
<b>Grading Permit Number:</b>	
<b>Building Shell Permit Number:</b>	

THE UNDERSIGNED HEREBY CERTIFIES AND AGREES AS FOLLOWS: (1) THAT HE/SHE IS AUTHORIZED TO MAKE THIS APPLICATION; (2) THAT THE INFORMATION IS CORRECT; (3) THAT HE/SHE WILL COMPLY WITH ALL REGULATIONS OF HOWARD COUNTY WHICH ARE APPLICABLE THERETO; (4) THAT HE/SHE WILL PERFORM NO WORK ON THE ABOVE REFERENCED PROPERTY NOT SPECIFICALLY DESCRIBED IN THIS APPLICATION; (5) THAT HE/SHE GRANTS COUNTY OFFICIALS THE RIGHT TO ENTER ONTO THIS PROPERTY FOR THE PURPOSE OF INSPECTING THE WORK PERMITTED AND POSTING NOTICES.

Dan Murphy  
Applicant's Signature  
dan@rhinelandscaping.com  
Email Address  
LANDSCAPE ARCHITECT  
Title/Company

DAN MURPHY  
Print Name  
10-10-17  
Date

Checks Payable to: DIRECTOR OF FINANCE OF HOWARD COUNTY  
\*\*PLEASE WRITE NEATLY & LEGIBLY\*\*  
-FOR OFFICE USE ONLY-

AGENCY	DATE	SIGNATURE OF APPROVAL
State Highways		
Building Officials		
PSZA ( Zoning )		
PSZA ( Engineering )		
Health		<u>[Signature]</u>

Is Sediment Control approval required for issuance?  Yes  No  
 CONTINGENCY CONSTRUCTION START

DPZ SETBACK INFORMATION
Front:
Rear:
Side:
Side St.:
All minimum setbacks met? <input type="checkbox"/> Yes <input type="checkbox"/> No
Is Entrance Permit Required? <input type="checkbox"/> Yes <input type="checkbox"/> No
Historic District? <input type="checkbox"/> Yes <input type="checkbox"/> No
Lot Coverage for New Town Zone:
SDP/Red-line approval date:

Filing Fee	\$
Permit Fee	\$
Tech Fee	\$
Excise Tax	\$
PSFS	\$
Guaranty Fund	\$
Add'l per Fee	\$
Total Fees	\$
Sub- Total Paid	\$
Balance Due	\$
Check	#

Distribution of Copies: White: Building Officials Green: PSZA,Zoning Yellow: PSZA,Engineering Pink: Health Gold: SHA

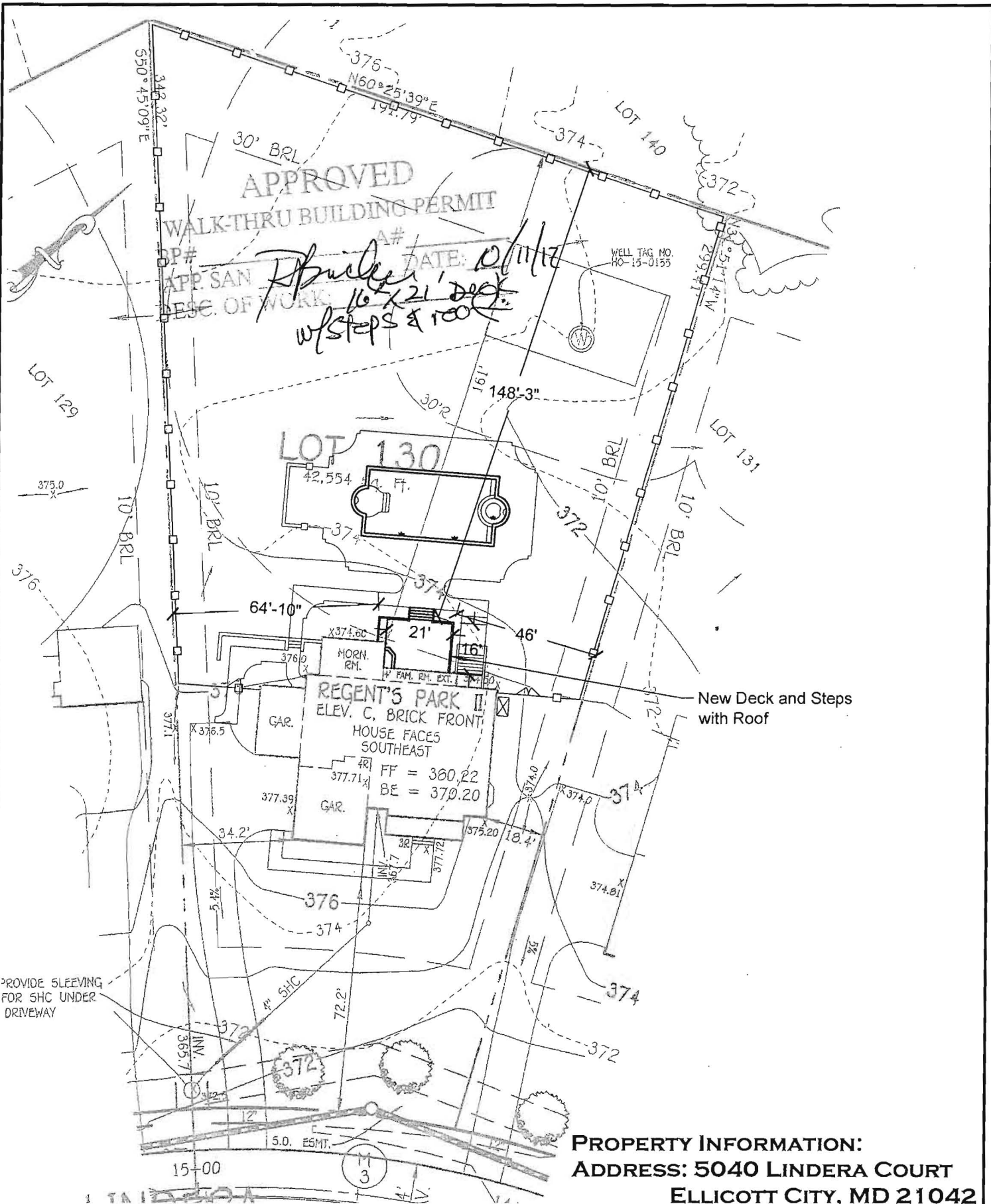

**APPROVED**  
**WALK-THRU BUILDING PERMIT**

*Handwritten:* 16' x 21' Deck w/ steps & roof

**REGENT'S PARK II**  
 ELEV. C, BRICK FRONT  
 HOUSE FACES SOUTHEAST  
 FF = 380.22  
 BE = 370.20

New Deck and Steps with Roof

PROVIDE SLEEVING FOR SHC UNDER DRIVEWAY

**PROPERTY INFORMATION:**  
**ADDRESS: 5040 LINDERA COURT**  
**ELLCOTT CITY, MD 21042**  
**PLAT: 23611-21**  
**DESCRIPTION: WALNUT CREEK 4**  
**PARCEL 49, LOT 130**

**SITE PLAN**  
 SCALE: 1" = 40'-0"  
 OCTOBER 10, 2017