

Bureau of Environmental Health
 8930 Stanford Boulevard, Columbia, MD 21045
 Main: 410-313-2640 | Fax: 410-313-2648
 TOD 410-313-2323 | Toll Free 1-866-313-6300
www.hchealth.org
 Facebook: www.facebook.com/hocohealth

Maura J. Rossman, M.D., Health Officer

RECEIPT DATE: 5/22/17 **ONSITE SEWAGE DISPOSAL SYSTEM** P 560639
 APPROVAL DATE: 6/16/17 **PERMIT: CONSTRUCTION** A _____
 PROPERTY ADDRESS: 3388 JENNINGS CHAPEL ROAD, WOODBINE, MD 21797
 SUBDIVISION: MARJORIE'S GREEN LOT: 3 TAX ID: 04-354656
 CONTRACTOR: _____ EMAIL: _____
 CONTRACTOR ADDRESS: _____ PHONE: _____
 PROPERTY OWNER: DANIEL AND KAREN ELLIS EMAIL: dellis@MitchellBest.com
 OWNER ADDRESS: 14108 BARBARA CIRCLE, COOKSVILLE, MD 21723 PHONE: 240-672-1634
 SEPTIC TANK SIZE (GALLONS): 1500 TANK MANUFACTURER: MAYER BROTHERS, INC.
 PUMP MODEL: N.A. PUMP SIZE N.A. PUMP TANK CAPACITY: N.A.

DISTRIBUTION SYSTEM: GRAVITY PRESSURE DOSED BEDROOMS: 5 APPLICATION RATE: 1.2

TRENCHES:	LINEAR FEET REQUIRED: <u>90</u>	INLET DEPTH: <u>4</u>
	TRENCH WIDTH: <u>3</u>	MAXIMUM BOTTOM DEPTH: <u>8</u>
	MINIMUM SPACE BETWEEN TRENCHES: <u>11</u>	EFFECTIVE AREA BEGINNING DEPTH: <u>4</u>
LOCATION:	PER APPROVED SITE PLAN. SEWAGE DISPOSAL AREA AND TANK LOCATIONS MUST BE STAKED BY LICENSED SURVEYOR PRIOR TO PRE-CONSTRUCTION INSPECTION.	
NOTES:		

ISSUED BY: ROBERT BRICKER ^{H.O.} ISSUE DATE: 5/23/17 EXPIRATION DATE: 5/23/18

- NOTE: CONTRACTOR MUST SCHEDULE A PRE-CONSTRUCTION INSPECTION PRIOR TO BEGINNING ANY INSTALLATION
- NOTE: CONTRACTOR MUST SCHEDULE AN INSPECTION AND GAIN APPROVAL OF ALL COMPONENTS PRIOR TO COVERING
- NOTE: STONE MUST BE APPROVED BY HEALTH DEPARTMENT AND GRAVEL TICKET MUST BE AVAILABLE FOR REVIEW.
- NOTE: WATERTIGHT TANKS REQUIRED
- NOTE: ALL PARTS OF SEPTIC SYSTEM SHALL BE AT LEAST 100 FEET DOWNGRADIENT FROM ANY WATER WELL
- NOTE: MANHOLE RISERS REQUIRED ON ALL SEPTIC TANKS AND PUMP CHAMBERS
- NOTE: AN ELECTRICAL PERMIT IS REQUIRED FOR INSTALLATION OF ANY ELECTRICAL COMPONENTS OF THE SYSTEM
 ELECTRICAL PERMIT ISSUED E N.A.
- NOTE: MDE RECOMMENDS SEPTIC TANKS, BAT, AND OTHER PRETREATMENT UNITS BE PUMPED AT A FREQUENCY ADEQUATE TO ENSURE THAT SOLIDS ARE NOT DISCHARGED TO THE DISPOSAL AREA

**NEITHER THE HOWARD COUNTY COUNCIL NOR THE HEALTH DEPARTMENT IS RESPONSIBLE FOR THE SUCCESSFUL OPERATION OF ANY SYSTEM.
 PERMITTEE RESPONSIBLE FOR OBTAINING FINAL APPROVAL ON THIS PERMIT.
 CALL 410-313-1771 TO SCHEDULE INSPECTIONS.**

NOT TO SCALE

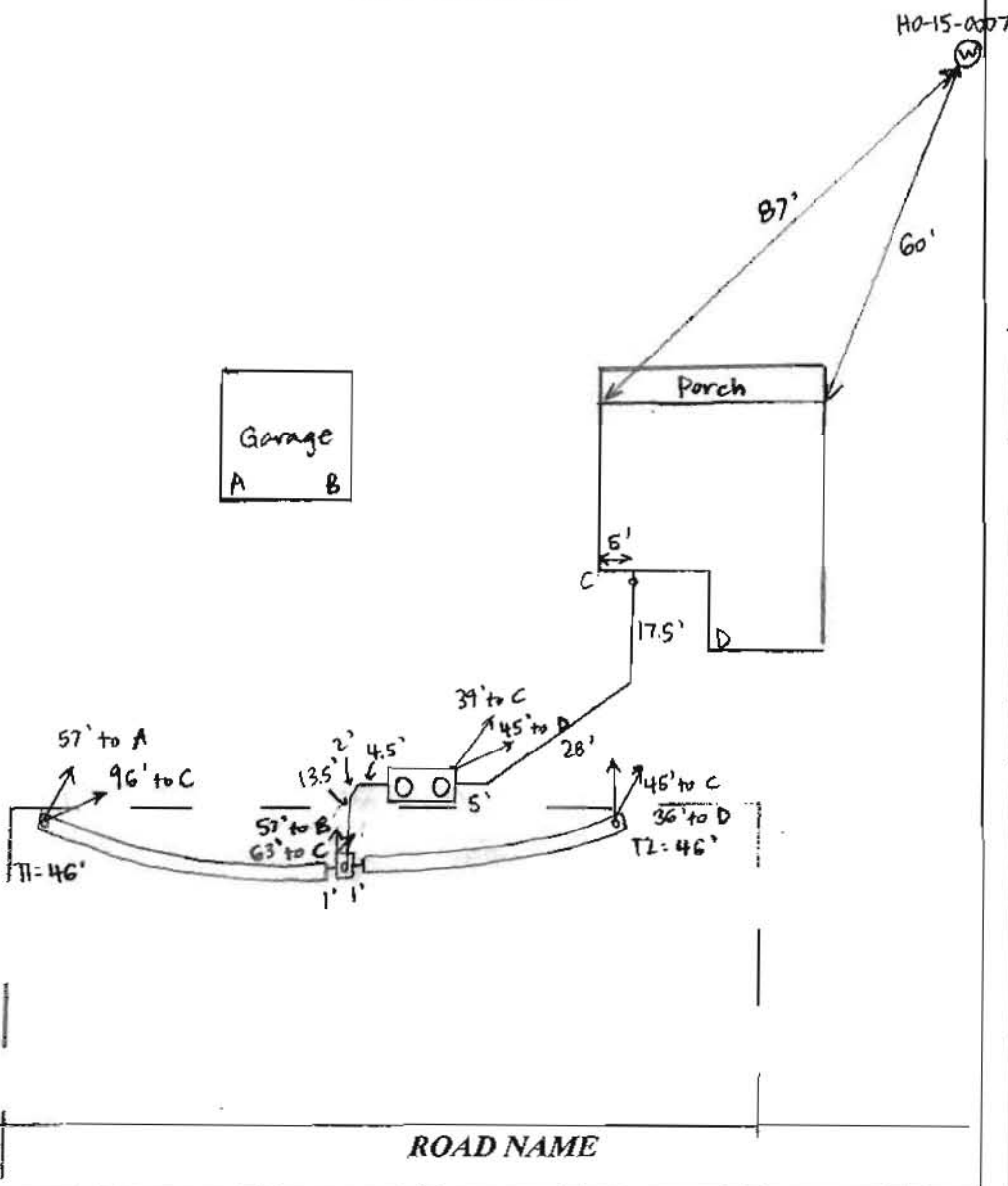

TRENCH/DRAINFIELD DATA

WIDTH	INLET	BOTTOM
3'	4'	8'
NUMBER OF TRENCHES		2
TOTAL LENGTH		92'
ABSORPTION AREA		276' + SIDEWALL
DISTRIBUTION BOX LEVEL		YES
DISTRIBUTION BOX BAFFLE		YES
DISTRIBUTION BOX PORT		YES

SEPTIC TANK DATA

SEPTIC TANK 1 LEVEL	YES
MANUFACTURER	BABYLON
CAPACITY	1500 GAL
SEAM LOC	TDP
TANK LID DEPTH	2-3'
BAFFLES	YES
BAFFLE FILTER	NO
MANHOLE LOC	FRONT + REAR
6" PORT LOC	NONE
WATERTIGHT TEST	NO
SLOTTED	YES
DATE ON LID	5-4-17

~~RUMP/SEPTIC TANK LEVEL~~

MANUFACTURER	_____
CAPACITY	_____ GAL
SEAM LOC	_____
TANK LID DEPTH	_____
BAFFLES	_____
BAFFLE FILTER	_____
MANHOLE LOC	_____
6" PORT LOC	_____
WATERTIGHT TEST	_____
SLOTTED	_____
DATE ON LID	_____

PRE-CONSTRUCTION:

6/13/17 Met Hatfield's on site for layout. SDA corners, tank, and trenches staked. Shot contour and adjusted staked trenches. Install 2 x 45" trenches. Checked fall on hung sewer pipe - will be 2% fall to tank with $\leq 3'$ cover. (SC)

INSTALLATION: 6/15/17 Tank set, house connection made. D-box set and all pipe laid between. Hatfield's about to start digging trenches. (SC) 6/16/17 Trenches complete - left open for inspection. Levelled speed levelers in D-box. (SC)

FINAL INSPECTOR Sarah Collins

DATE OF APPROVAL 6/16/17

Bricker, Robert

From: Bricker, Robert
Sent: Thursday, March 02, 2017 11:09 AM
To: 'Daniel Ellis'
Subject: RE: 3388 Jennings Chapel Road - Lot #3 Marjorie's Green
Attachments: 3388 Jennings Chapel Road_Basement bedroom memo.pdf

Dan,
See attached PDF –concerning rough-in full bath in basement. I have approved a septic system installation plan that proposes a 1500-gallon septic tank (large enough for a five-bedroom SFD) and trench absorption area for a four-bedroom SFD. As of this morning, the Building Permit documents (B17000765) have not arrived at the Health Department.
Robert Bricker, REHS/RS, L.E.H.S.

From: Daniel Ellis [<mailto:dellis@mitchellbest.com>]
Sent: Thursday, February 02, 2017 1:44 PM
To: Bricker, Robert
Cc: Jeremiah Reynolds; rvogel@vogeleng.com
Subject: 3388 Jennings Chapel Road - Lot #3 Marjorie's Green

Robert,
Jeremiah Reynolds from Robert H. Vogel Engineering, Inc. contacted me and informed me that you need the floor plans for the proposed house in order to complete the review of the Septic Installation Plan.
Please see the attached. Let me know if there is any additional information you require.
Thank you,
Dan Ellis
Purchasing Manager

Mitchell & Best Homes
1686 East Gude Drive
Rockville, MD 20850

O: 301.762.9511 ext. 315

C: 240-672-1634

[Mitchell & Best](#) | [Twitter](#) | [Facebook](#) | [YouTube](#)



Mitchell & Best
The Name of Quality for Over 40 Years

Maryland State Grid Meridian

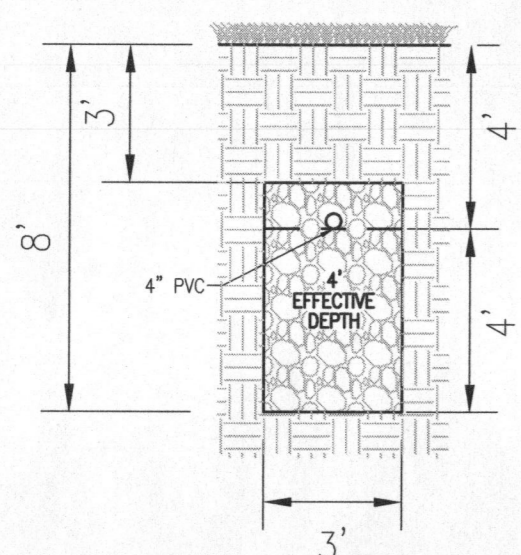

INITIAL SYSTEM AND 1ST REPLACEMENT TRENCH DETAIL
NOT TO SCALE

SYSTEM CALCULATIONS:
INITIAL SYSTEM AND FIRST REPLACEMENT SYSTEM:
5 BEDROOMS AT 750gpd / 1.2 ABSORPTION RATE = 625 SQ. FT.
625 SQ. FT. / 3 (TRENCH WIDTH) x 42 (SIDEWALL REDUCTION) = 88 LINEAR FEET
90 TOTAL LINEAR FEET OF TRENCH ARE PROVIDED WITH THE INITIAL SYSTEM.
90 TOTAL LINEAR FEET OF TRENCH ARE PROVIDED WITH THE FIRST REPLACEMENT SYSTEM.

TRENCH INFO			
TRENCH LENGTH	TRENCH WIDTH	TRENCH DEPTH	EXISTING GROUND
1	45'	563.00'	559.00'
2	45'	563.00'	567.00'

- GENERAL NOTES:**
- ANY CHANGE TO THE LOCATIONS OR DEPTHS TO ANY COMPONENTS MUST BE APPROVED BY THE ENGINEER AND THE HOWARD COUNTY HEALTH DEPARTMENT PRIOR TO INSTALLATION. A REVISED SITE PLAN MAY BE REQUIRED.
 - THE MAXIMUM EARTH COVER OVER THE TANK IS 3 FEET. GREATER EARTH COVER WILL REQUIRE A HEAVY LOAD BEARING TANK.
 - ELECTRICAL WORK FOR THE INSTALLATION MUST BE PERFORMED BY A LICENSED ELECTRICIAN.
 - THE WELL (HO-15-0007) HAS BEEN FIELD LOCATED AND IS ACCURATELY SHOWN.
 - ALL WELLS AND SEPTIC SYSTEMS LOCATED WITHIN 100' OF THE PROPERTY BOUNDARIES AND 200' DOWN GRADIENT OF ANY WELLS AND/OR SEPTIC SYSTEMS HAVE BEEN SHOWN.
 - TOPOGRAPHY SHOWN IS AT TWO-FOOT CONTOUR INTERVALS AND IS BASED ON A FIELD RUN TOPOGRAPHICAL SURVEY PREPARED BY ROBERT H. VOGEL ENGINEERING, INC., DATED DECEMBER 12TH, 2016.
 - ANY CHANGES TO A PRIVATE SEWAGE AREA SHALL REQUIRE A REVISED PERCOLATION CERTIFICATION PLAN.
 - EXISTING WELLS, SEPTIC SYSTEMS, AND SEWAGE DISPOSAL AREAS WITHIN 100' OF THE PROPERTY AND THOSE WELLS WITHIN 200' DOWNGRADIENT OF EXISTING OR PROPOSED SEPTIC SYSTEMS OR SEWAGE DISPOSAL AREAS HAVE BEEN SHOWN USING ALL REASONABLE EFFORTS.
 - THE LOT SHOWN HEREIN COMPLES WITH THE MINIMUM OWNERSHIP, WIDTH, AND LOT AREA AS REQUIRED BY THE MARYLAND STATE DEPARTMENT OF THE ENVIRONMENT.

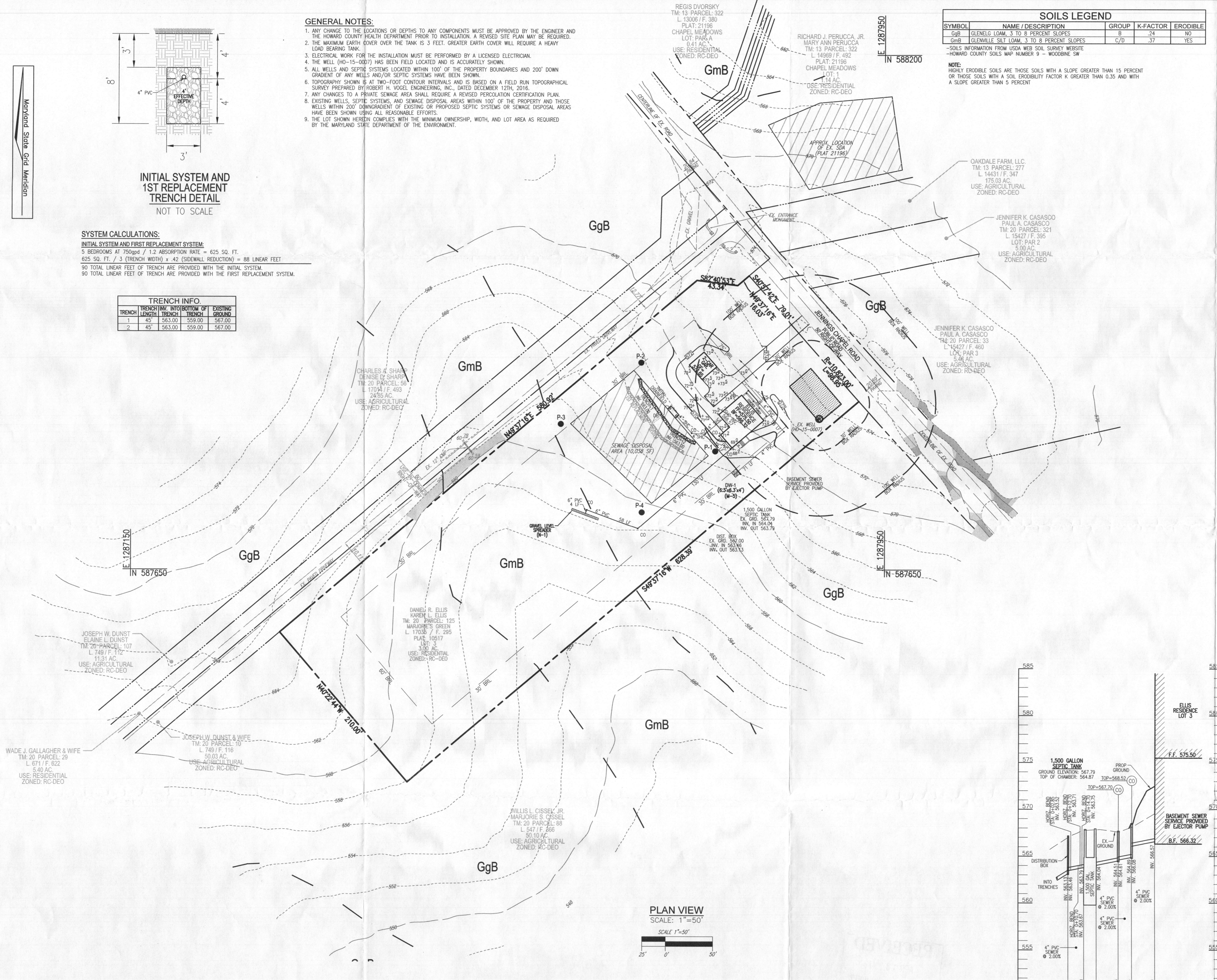

PLAN VIEW
SCALE: 1"=50'
25' 0' 50'

SOILS LEGEND

SYMBOL	NAME / DESCRIPTION	GROUP	K-FACTOR	ERODIBLE
GgB	GLENNVILLE LOAM, 3 TO 8 PERCENT SLOPES	B	.24	NO
GmB	GLENNVILLE SILT LOAM, 3 TO 8 PERCENT SLOPES	C/D	.37	YES

NOTE:
HIGHLY ERODIBLE SOILS ARE THOSE SOILS WITH A SLOPE GREATER THAN 15 PERCENT OR THOSE SOILS WITH A SOIL ERODIBILITY FACTOR K GREATER THAN 0.35 AND WITH A SLOPE GREATER THAN 5 PERCENT.

LEGEND:

- PROPERTY LINE
- RIGHT-OF-WAY LINE
- ADJACENT PROPERTY LINE
- EXISTING 10' CONTOUR
- EXISTING 2' CONTOUR
- EXISTING MODERATE SLOPES (15% TO 24.99% SLOPES)
- SOILS
- EXISTING WELL
- PROPOSED 10' CONTOUR
- PROPOSED 2' CONTOUR
- PASSED PERC. TEST
- APPROVED SEWAGE DISPOSAL AREA (SDA)

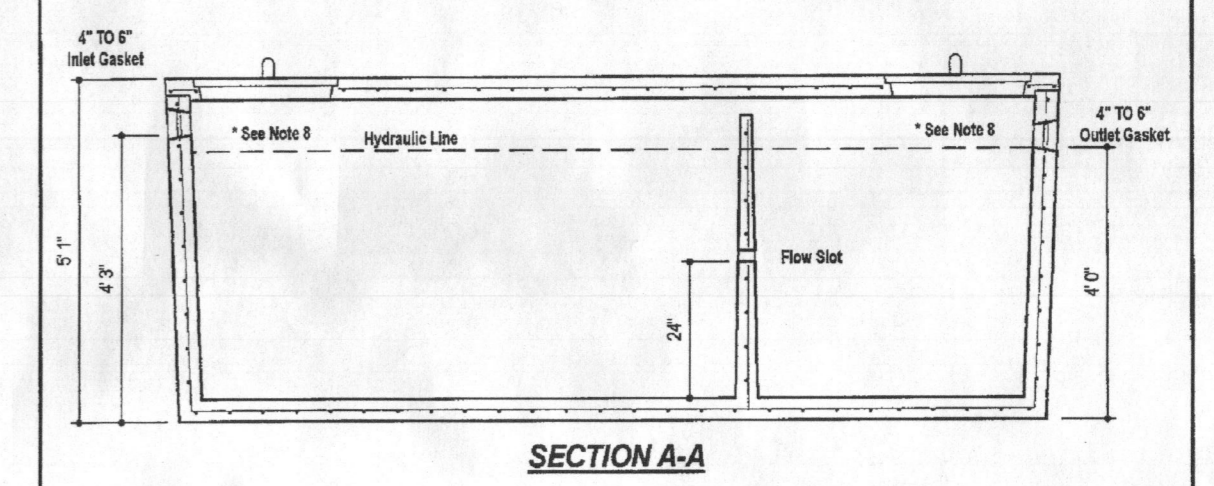
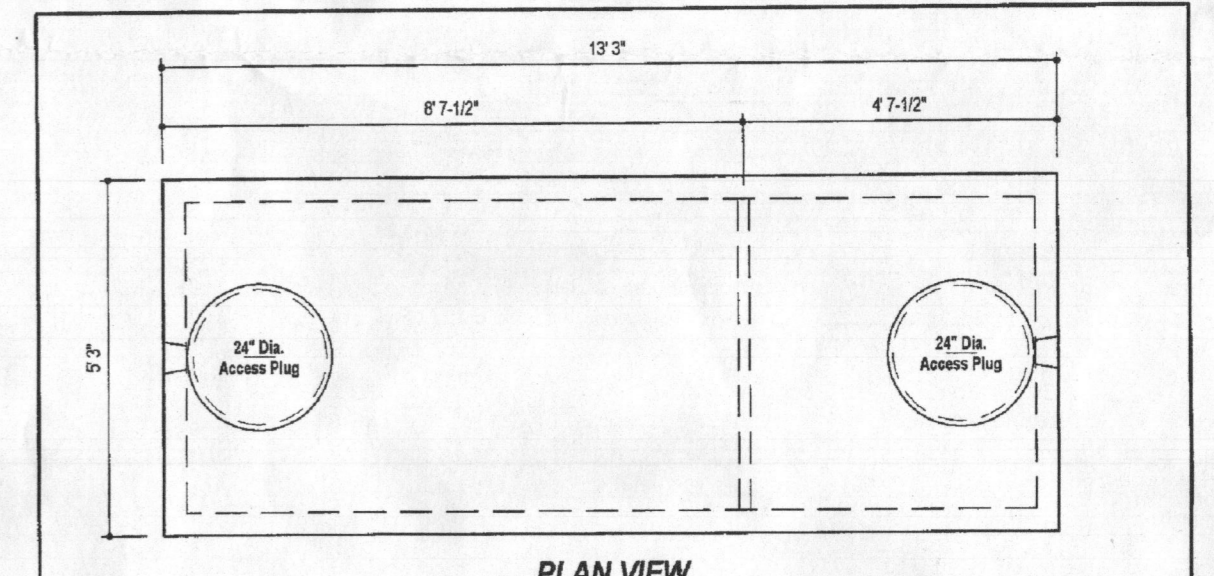
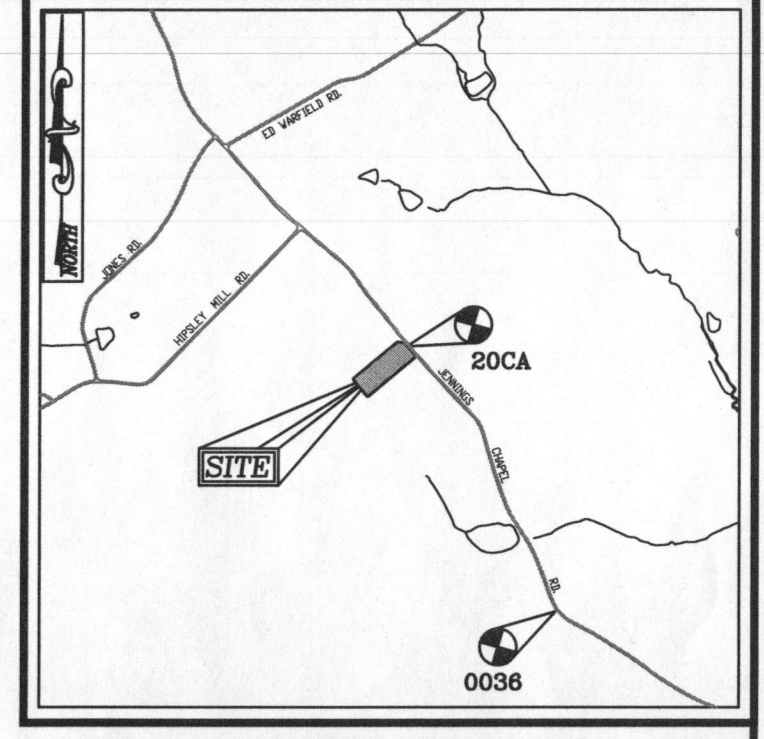

DESIGN DATA & GENERAL NOTES:

- Concrete strength 4000 psi, 8" thick. Density = 150 pcf.
- Concrete Percolation Test per ASTM C 110-05.
- Manufacture & installation per ASTM C 900-05 & C 614-05.
- Manufacture per ASTM A 818, Min. 5/8" steel.
- Top soil inside with heavy pipe mats.
- 4" PVC pipe, 4' long.
- Max 5'-0" of cover.
- Depending on use of tank, Inlet & Outlet baffles may be required by code.

WEIGHT = 16,750 lbs.

1,500 GALLON TANK (Non-Traffic) 2-Compartment

Stock Item

Dwg. No. 1600-02 No Scale Aug. 11, 2008

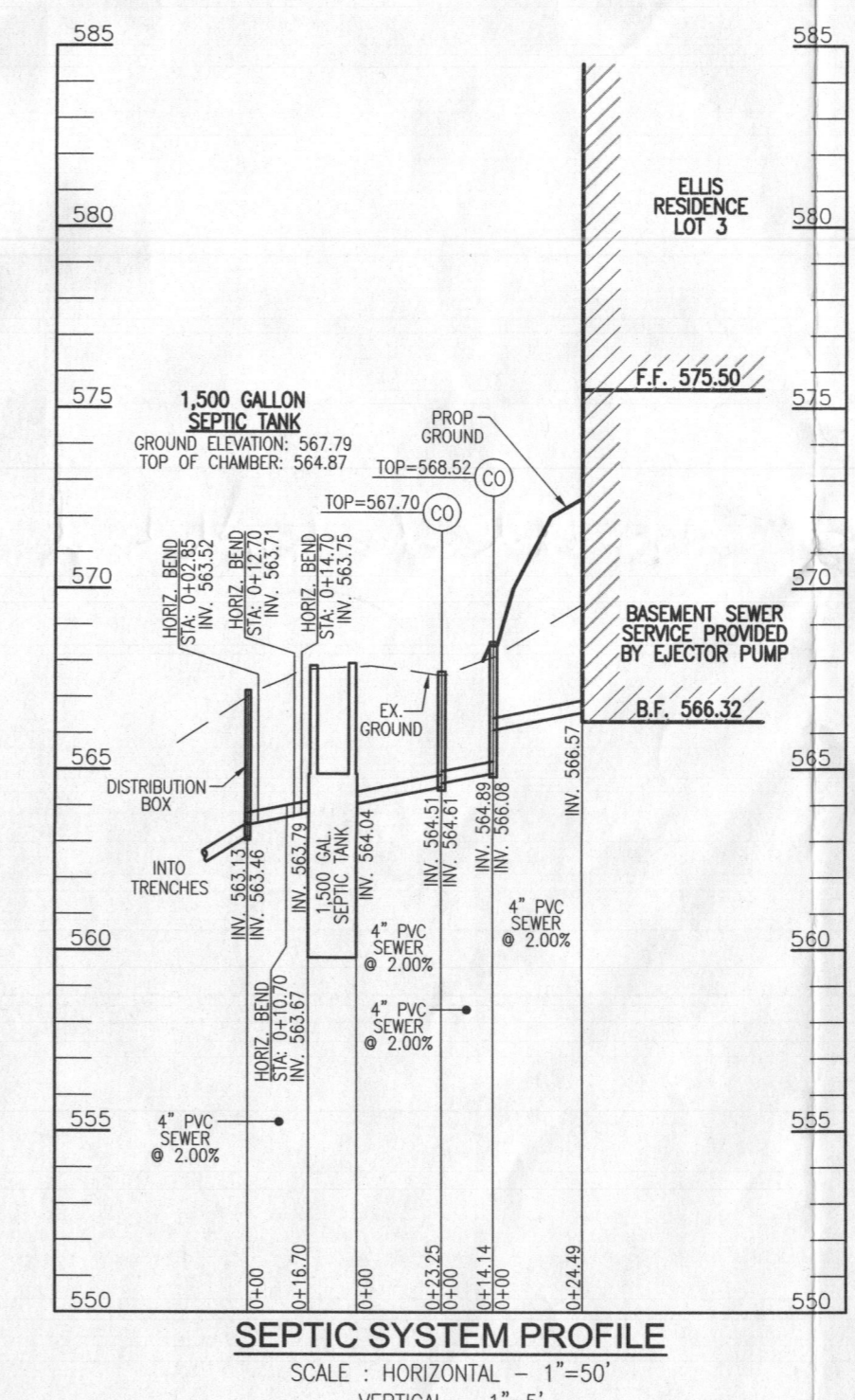

Approved Onsite Sewage Disposal System Plan
Howard County Health Department
3388 Jennings Chapel Rd.
1500-gal Septic Tank
Rhubarb to Gravity drain field for 5 Bedrooms
4/21/2017
OWNER/BUILDER
DANIEL R. ELLIS
KAREN L. ELLIS
14108 BARBARA CIRCLE
COOKSVILLE, MD 21723
(240) 672-1634

ONSITE SEWAGE DISPOSAL SYSTEM DESIGN PLAN

ELLIS PROPERTY
3388 JENNINGS CHAPEL ROAD
WOODBINE, MD 21797
MARJORIE'S GREEN SUBDIVISION; LOT 3

LOT 3
TAX MAP: 20 GRID: 04
4TH ELECTION DISTRICT

PARCEL: 125
ZONE: RC-DEO
HOWARD COUNTY, MARYLAND

ROBERT H. VOGEL ENGINEERING, INC.
ENGINEERS • SURVEYORS • PLANNERS
8407 MAIN STREET
ELICOTT CITY, MD 21043
TEL: 410.461.7666
FAX: 410.461.8961

DESIGN BY: RHV.
DRAWN BY: JMR.
CHECKED BY: RHV.
DATE: APRIL 2017
SCALE: AS SHOWN
W.O. NO.: 16-52

PROFESSIONAL CERTIFICATE
I HEREBY CERTIFY THAT THESE DOCUMENTS WERE PREPARED OR APPROVED BY ME, AND THAT I AM A FULLY LICENSED PROFESSIONAL ENGINEER UNDER THE LAWS OF THE STATE OF MARYLAND, LICENSE NO. 16193 EXPIRATION DATE: 09-27-2019

1 SHEET OF 1

THIS AREA DESIGNATES A PRIVATE SEWAGE AREA OF AT LEAST 10,000 SQUARE FEET AS REQUIRED BY THE MARYLAND STATE DEPARTMENT OF THE ENVIRONMENT FOR INDIVIDUAL SEWAGE DISPOSAL. IMPROVEMENTS OF ANY NATURE IN THIS AREA ARE RESTRICTED UNTIL PUBLIC SEWERAGE IS AVAILABLE. THESE AREAS SHALL BECOME NULL AND VOID UPON CONNECTION TO A PUBLIC SEWERAGE SYSTEM. THE COUNTY HEALTH OFFICER SHALL HAVE THE AUTHORITY TO GRANT ADJUSTMENTS TO THE PRIVATE SEWAGE AREA. RECORDATION OF A MODIFIED SEWAGE AREA SHALL NOT BE NECESSARY.

THIS WALL CHECK DRAWING CONTAINS A HORIZONTAL TOLERANCE IN ACCURACY OF 0.1' AND A VERTICAL TOLERANCE IN ACCURACY OF 0.2'

TM.20 P.56
L.17014 F.493

TM.20 P.107
L.749 F.112

TM.20 P.29
L.671 F.622

TM.20 P.10
L.749 F.116

LOT 1
TM.13 P.322
PLAT 21196

TM.13 P.277
L.14431 F.347

LOT PAR2
TM.20 P.321
L.15427 F.395

LOT PAR3
TM.20 P.33
L.15427 F.460

TM:20 PARCEL:88
L.547 F.366

LOT 3
130,681 SF. OR
3.0000 AC.

TM:20 PARCEL:88
L.547 F.366

N40°22'44"W 210.00'

60' BRL

30' BRL

30' BRL

30' BRL

30' BRL

S49°37'16"W 628.39'

USE-IN-COMMON
RIGHT-OF-WAY
60'

N49°37'16"E 580.92'

S82°40'53"E
45.34'

N49°37'16"E
16.03'

S40°57'42"E
79.01'

R=10,823.00'
L=98.95'

JENNINGS CHAPEL ROAD
PUBLIC ROAD
50' RIGHT-OF-WAY

SEWAGE DISPOSAL
AREA (10,038 SF)

POURED
CONCRETE
FOUNDATION
T/W=573.7'
SLAB=573.3'

20.7
20.7
20.7

POURED
CONCRETE
FOUNDATION
T/W=573.6'
44.5

32.0
17.5
12.5

HO-15-0007

30' WELL
BOX RADIUS

100' WELL
BOX RADIUS

5/23/17 - wall
check okay
u.o.

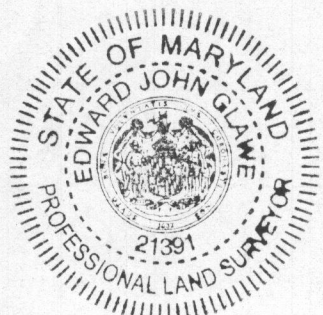
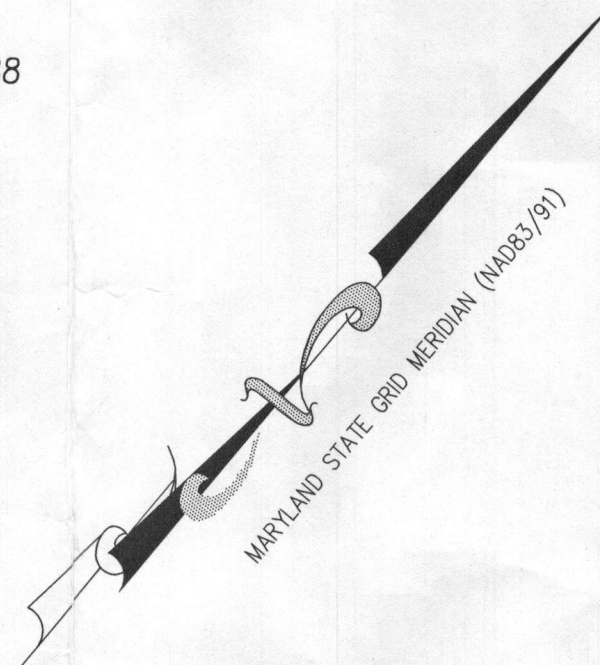

I HEREBY CERTIFY TO THE BEST OF MY KNOWLEDGE, INFORMATION AND BELIEF THAT THE IMPROVEMENTS ARE LOCATED AS SHOWN AND THERE ARE NO ENCROACHMENTS EXCEPT AS SHOWN.

Edward J. Glawe 22 MAY 2017
EDWARD J. GLAWE, PROFESSIONAL LAND SURVEYOR #21391 DATE

PROFESSIONAL CERTIFICATION: I HEREBY CERTIFY THAT THESE DOCUMENTS WERE PREPARED BY ME OR UNDER MY RESPONSIBLE CHARGE, AND THAT I AM A DULY LICENSED PROFESSIONAL LAND SURVEYOR UNDER THE LAWS OF THE STATE OF MARYLAND, LICENSE NO. 21391, EXPIRATION DATE JUNE 4, 2019.

WALL CHECK DRAWING

ELLIS
PROPERTY
3.0000 ACRES

TAX MAP 20, P/O PARCEL 125
3388 JENNINGS CHAPEL ROAD
MARJORIE'S GREEN SUBDIVISION; LOT 3
LIBER 17035, FOLIO 295

FOURTH ELECTION DISTRICT HOWARD COUNTY, MARYLAND
SCALE: 1" = 40' MAY 22, 2017

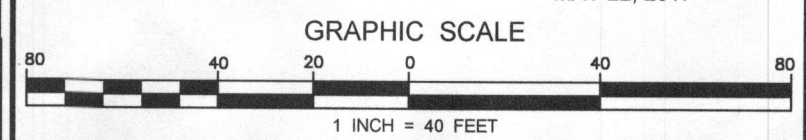

ROBERT H. VOGEL
ENGINEERING, INC.
ENGINEERS • SURVEYORS • PLANNERS
8407 MAIN STREET ELLICOTT CITY, MD 21043 TEL: 410.461.7666 FAX: 410.461.8961

COMPED BY: B.W.J.	SHEET 1 of 1
DRAWN BY: B.W.J.	
CHECKED BY: E.J.G.	
W.O. NO.: 16-52	