



Building Permit Application
 Howard County Maryland
 Department of Inspections, Licenses and Permits
 3430 Court House Drive
 Permits: 410-313-2455
 www.howardcountymd.gov

Date Received: 6-7-17

Permit No.: _____

Building Address: 12990 Linden Church Rd.
 City: Clarksville State: Md. Zip Code: 21029
 Suite/Apt. #: _____ SDP/WP/BA #: _____
 Census Tract: _____ Subdivision: Twelve Hills
 Section: 1 Area: _____ Lot: 4
 Tax Map: _____ Parcel: 66 Grid: _____
 Zoning: _____ Map Coordinates: _____ Lot Size: 3.1A

Property Owner's Name: John & Gail Strieter
 Address: 12990 Linden Church Rd.
 City: Clarksville State: Md Zip Code: 21029
 Phone: 410-531-3601 Fax: _____
 Email: JSTRIEE@comcast.net

Applicant's Name & Mailing Address, (if other than stated herein)

Applicant's Name: _____
 Address: _____
 City: _____ State: _____ Zip Code: _____
 Phone: _____ Fax: _____
 Email: _____

Contractor Company: _____
 Contact Person: _____
 Address: _____
 City: _____ State: _____ Zip Code: _____
 License No.: _____
 Phone: _____ Fax: _____
 Email: _____

Engineer/Architect Company: _____
 Responsible Design Prof.: _____
 Address: _____
 City: _____ State: _____ Zip Code: _____
 Phone: _____ Fax: _____
 Email: _____

Existing Use: _____
 Proposed Use: _____
 Estimated Construction Cost: \$ 14,000.00
 Description of Work: Garage 15' X 30'

Occupant or Tenant: _____
 Was tenant space previously occupied? Yes No
 Contact Name: Same as above
 Address: _____
 City: _____ State: _____ Zip Code: _____
 Phone: _____ Fax: _____
 Email: _____

Commercial Building Characteristics	Residential Building Characteristics
Height: <u>15' 7"</u>	<input type="checkbox"/> SF Dwelling <input type="checkbox"/> SF Townhouse
No. of stories: <u>one</u>	Depth _____ Width _____
Gross area, sq. ft./floor: <u>450</u>	1 st floor: _____
Area of construction (sq. ft.): <u>450</u>	2 nd floor: _____
Use group: _____	Basement: _____
Construction type:	<input type="checkbox"/> Finished Basement
<input type="checkbox"/> Reinforced Concrete	<input type="checkbox"/> Unfinished Basement
<input type="checkbox"/> Structural Steel	<input type="checkbox"/> Crawl Space
<input type="checkbox"/> Masonry	<input type="checkbox"/> Slab on Grade
<input checked="" type="checkbox"/> Wood Frame	No. of Bedrooms: _____
<input type="checkbox"/> State Certified Modular	Multi-family Dwelling
	No. of efficiency units: _____
	No. of 1 BR units: _____
	No. of 2 BR units: _____
	No. of 3 BR units: _____
	Other Structure: _____
	Dimensions: _____
<input checked="" type="checkbox"/> Roadside Tree Project Permit	Footings: _____
<input type="checkbox"/> Yes <input type="checkbox"/> No	Roof: _____
Roadside Tree Project Permit # _____	<input type="checkbox"/> State Certified Modular
	<input type="checkbox"/> Manufactured Home

Utilities	
Water Supply	
<input type="checkbox"/> Public	
<input type="checkbox"/> Private	
Sewage Disposal	
<input type="checkbox"/> Public	
<input type="checkbox"/> Private	
Electric: <input type="checkbox"/> Yes <input type="checkbox"/> No	
Gas: <input type="checkbox"/> Yes <input type="checkbox"/> No	
Heating System	
<input type="checkbox"/> Electric <input type="checkbox"/> Oil	
<input type="checkbox"/> Natural Gas <input type="checkbox"/> Propane Gas	
<input type="checkbox"/> Other:	
Sprinkler System:	
<input type="checkbox"/> Yes <input type="checkbox"/> No	
Grading Permit Number: _____	
Building Shell Permit Number: _____	

THE UNDERSIGNED HEREBY CERTIFIES AND AGREES AS FOLLOWS: (1) THAT HE/SHE IS AUTHORIZED TO MAKE THIS APPLICATION; (2) THAT THE INFORMATION IS CORRECT; (3) THAT HE/SHE WILL COMPLY WITH ALL REGULATIONS OF HOWARD COUNTY WHICH ARE APPLICABLE THERETO; (4) THAT HE/SHE WILL PERFORM NO WORK ON THE ABOVE REFERENCED PROPERTY NOT SPECIFICALLY DESCRIBED IN THIS APPLICATION; (5) THAT HE/SHE GRANTS COUNTY OFFICIALS THE RIGHT TO ENTER ONTO THIS PROPERTY FOR THE PURPOSE OF INSPECTING THE WORK PERMITTED AND POSTING NOTICES.

Applicant's Signature: [Signature]
 Email Address: JSTRIEE@comcast.net
 Title/Company: _____

Print Name: John L. Strieter
 Date: 6-7-2017

Checks Payable to: DIRECTOR OF FINANCE OF HOWARD COUNTY

PLEASE WRITE NEATLY & LEGIBLY

-FOR OFFICE USE ONLY-

AGENCY	DATE	SIGNATURE OF APPROVAL
State Highways		
Building Officials		
PSZA (Zoning)		
PSZA (Engineering)		
Health	<u>6/7/17</u>	<u>[Signature]</u>

Is Sediment Control approval required for issuance? Yes No
 CONTINGENCY CONSTRUCTION START

DPZ SETBACK INFORMATION
Front: _____
Rear: _____
Side: _____
Side St.: _____
All minimum setbacks met? <input type="checkbox"/> Yes <input type="checkbox"/> No
Is Entrance Permit Required? <input type="checkbox"/> Yes <input type="checkbox"/> No
Historic District? <input type="checkbox"/> Yes <input type="checkbox"/> No
Lot Coverage for New Town Zone: _____
SDP/Red-line approval date: _____

Filing Fee	\$
Permit Fee	\$
Tech Fee	\$
Excise Tax	\$
PSFS	\$
Guaranty Fund	\$
Add'l per Fee	\$
Total Fees	\$
Sub-Total Paid	\$
Balance Due	\$
Check	#

Distribution of Copies: White: Building Officials Green: PSZA,Zoning Yellow: PSZA,Engineering Pink: Health Gold: SHA

John + Gail
Strieter

5/31/2017

New Pole Barn /
Garage

12 Hills Rd

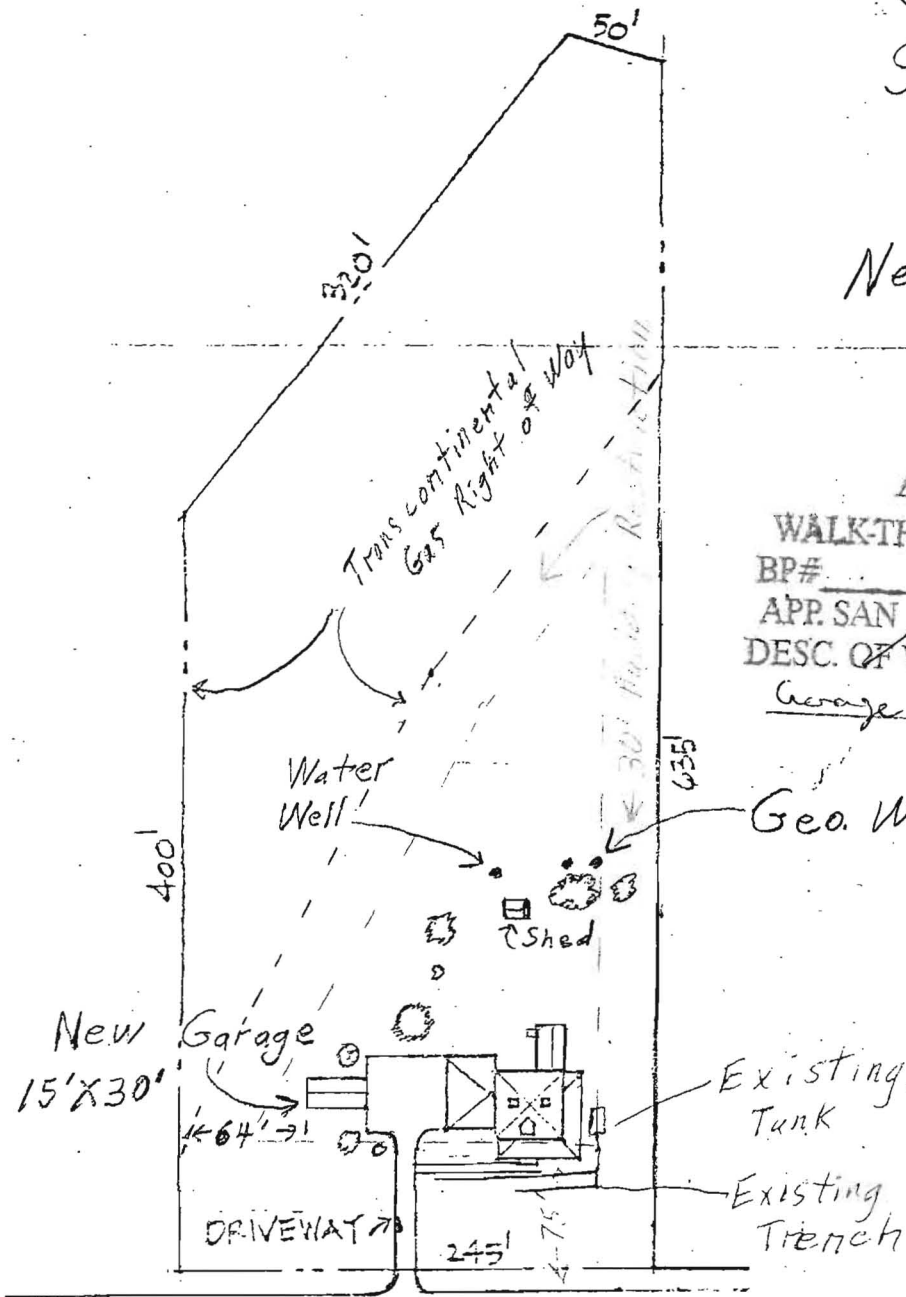

APPROVED
WALK-THRU BUILDING PERMIT
 BP# _____ A# _____
 APP. SAN John Strieter DATE: 6/7/17
 DESC. OF WORK: Ex. Pole Building
Garage, as shown

12990 LINDEN CHURCH RD.

Lot: 4 Parcel: 66 Section: 1 Block: 16
 Zone: R Subdivision: ~~Twelve Hills~~

SITE

NORTH

SCALE : 1" = 100'