

C1 36486

SEQUENCE NO. (MDE USE ONLY)

STATE OF MARYLAND WELL COMPLETION REPORT

THIS REPORT MUST BE SUBMITTED WITHIN 45 DAYS AFTER WELL IS COMPLETED.

(THIS NUMBER IS TO BE PUNCHED IN COLS. 3-6 ON ALL CARDS)

COUNTY NUMBER A520385

ST/CO USE ONLY DATE Received

DATE WELL COMPLETED

Depth of Well

PERMIT NO. FROM "PERMIT TO DRILL WELL"

OWNER Bassley Venture LLC, WELL SITE ADDRESS, TOWN Clarksville, SUBDIVISION Walnut Creek Phase 4 SECTION 4 LOT 126

WELL LOG table with columns for DESCRIPTION, FEET (FROM, TO), and check if water bearing. Includes entries for Sand, Clay, sand, Mica Rock, and Water.

GROUTING RECORD section including GROUTING MATERIAL (CM, BC), NO. OF BAGS (15), NO. OF POUNDS (1170), and DEPTH OF GROUT SEAL.

CASING RECORD section including MAIN CASING TYPE (ST), Nominal diameter (6), and Total depth (40).

OTHER CASING (if used) section with diameter and depth fields.

SCREEN RECORD section including screen type (ST) and slot size (1).

NUMBER OF UNSUCCESSFUL WELLS: 0, WELL HYDROFRACTURED: YES

CIRCLE APPROPRIATE LETTER section with options A, E, P.

I HEREBY CERTIFY THAT THIS WELL HAS BEEN CONSTRUCTED IN ACCORDANCE WITH COMAR 26.04.04 "WELL CONSTRUCTION" AND IN CONFORMANCE WITH ALL CONDITIONS STATED IN THE ABOVE CAPTIONED PERMIT...

DRILLERS LIC. NO. MSD 117, DRILLERS SIGNATURE, LIC. NO. MSD 027, SITE SUPERVISOR

DEPTH (nearest ft.) section with a depth of 160 and a casing height of 38.

GRAVEL PACK, MDE USE ONLY (NOT TO BE FILLED IN BY DRILLER), TELESCOPE CASING, LOG INDICATOR

PUMPING TEST section including HOURS PUMPED (3), PUMPING RATE (20), METHOD USED TO MEASURE PUMPING RATE (Bucket), WATER LEVEL, TYPE OF PUMP USED (S), and PUMP INSTALLED (NO).

PUMP INSTALLED section including DRILLER INSTALLED PUMP (NO), TYPE OF PUMP INSTALLED PLACE (29), CAPACITY: GALLONS PER MINUTE (31-35), PUMP HORSE POWER (37-41), PUMP COLUMN LENGTH (43-47), CASING HEIGHT (+49), LAND SURFACE (2).

LATITUDE 39.23410, LONGITUDE 76.94489, (DEFAULT COORD. WGS 84)

Pursuant to §10-624 of the State Govt. Article of the Maryland Code personal info. requested on this form is used in processing this form pursuant to COMAR 26.04.04. Failure to provide the info. may result in this form not being processed.

<b>B 1</b>	<b>28696</b>	SEQUENCE NO. (MDE USE ONLY)	<b>STATE OF MARYLAND</b> <b>APPLICATION FOR PERMIT TO DRILL WELL</b> please type	STATE PERMIT NUMBER <b>HO-15-0151</b> <small>fill in this form completely</small>
------------	--------------	--------------------------------	--	---

**OWNER INFORMATION**

8 MM DD YY 13  
 15 Last Name **BASSLER** Owner **Venture LLC** First Name **UCC** 34  
 36 Street or RFD **PO Box 482** 55  
 57 Town **Lisbon** 70 State **MD** 72 Zip **21265** 76

**LOCATION OF WELL**

8 COUNTY **Howard** 21  
 23 SUBDIVISION **Walnut Creek Phase 4** 42  
 SECTION **4** LOT **126**  
 44 46 48 50  
 52 NEAREST TOWN **CLARKSVILLE** 71

**DRILLER INFORMATION**

Driller's Name **Ralph MAYNE** 76 License No. **M 5 D 117** 81  
 Firm Name **Ralph MAYNE well DRILLING**  
 Address **17024 Handy Rd Mt Airy MD 21771**  
 Signature **[Signature]** Date **9/18/15**

**SOURCES OF DRILLING WATER**

1. **well**  
 2.  
 3.

11 STREET ADDRESS **Lindora Ct** 30  
 ON WHICH SIDE OF ROAD (CIRCLE APPROPRIATE BOX)  
 NORTH  SOUTH   
 WEST  EAST   
 34 150 37 DISTANCE FROM ROAD **150**  
 ENTER FT OR MI **FT** 38 39  
 TAX MAP: **28** BLK: \_\_\_\_\_ PARCEL **49**

**WELL INFORMATION**

APPROX. PUMPING RATE (GAL. PER MIN.) **5**  
 8 500 12  
 AVERAGE DAILY QUANTITY NEEDED (GAL. PER DAY) **14** 20

**USE FOR WATER (CIRCLE APPROPRIATE BOX)**

DOMESTIC POTABLE SUPPLY & RESIDENTIAL IRRIGATION  
 FARMING (LIVESTOCK WATERING & AGRICULTURAL IRRIGATION)  
 INDUSTRIAL, COMMERCIAL, DEWATERING  
 PUBLIC WATER SUPPLY WELL  
 TEST, OBSERVATION, MONITORING  
 OPEN LOOP GEOTHERMAL  
 CLOSED LOOP GEOTHERMAL

**NOT TO BE FILLED IN BY DRILLER HEALTH DEPARTMENT APPROVAL**

COUNTY NAME **Howard** (13) COUNTY NO. **A520385**  
 STATE SIGNATURE \_\_\_\_\_ INSERT S → \_\_\_\_\_ 41  
 DATE ISSUED **9/25/15** **S.L. C.M.** **9/25/16**  
 43 MM DD YY 48 CO SIGNATURE EXP. DATE

APPROXIMATE DEPTH OF WELL **150** FEET  
 24 28  
 APPROXIMATE DIAMETER OF WELL **6"** NEAREST INCH

PROPOSED LOCATION OF WELL ON LOT  
 SHOW PERMANENT STRUCTURES SUCH AS BUILDINGS, SEPTIC SYSTEM, ROADS AND/OR LANDMARKS AND INDICATE NOT LESS THAN TWO DISTANCE MEASUREMENTS TO WELL

**METHOD OF DRILLING (circle one)**

BORED (or Augered)  JETTED  Jetted & DRIVEN   
 30 AIR-ROTary  AIR-PERCussion  ROTARY (Hydraulic Rotary)   
 37 CABLE  REVerse-ROTary  DRive-POINT   
 other \_\_\_\_\_

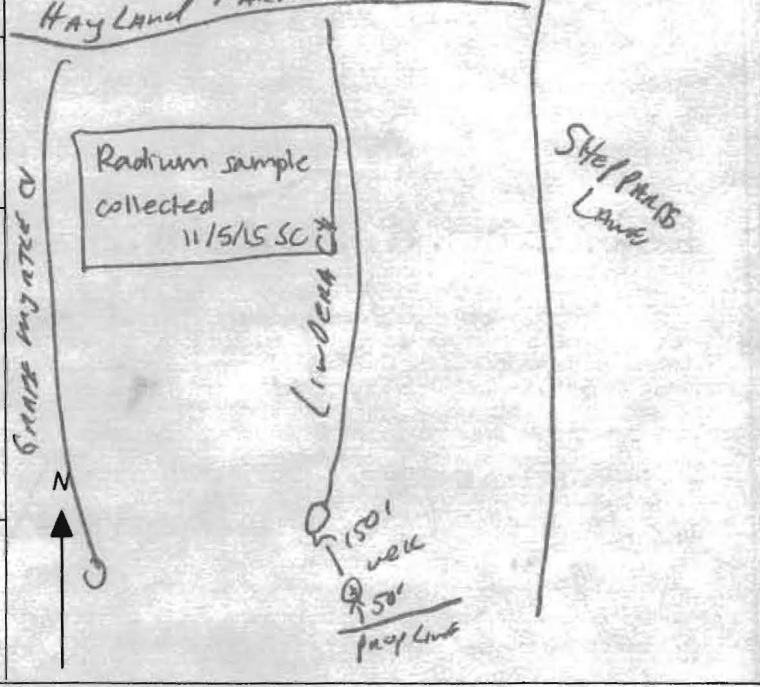

**REPLACEMENT OR DEEPEMED WELLS (CIRCLE APPROPRIATE BOX)**

THIS WELL WILL NOT REPLACE AN EXISTING WELL  
 THIS WELL WILL REPLACE A WELL THAT WILL BE ABANDONED AND SEALED  
 THIS WELL WILL REPLACE A WELL THAT WILL BE USED AS A STANDBY-CONTACT LOCAL APPROVING AUTHORITY FOR POLICY ON STANDBY WELLS  
 THIS WELL WILL DEEPEM AN EXISTING WELL  
 PERMIT NUMBER OF WELL TO BE REPLACED OR DEEPEMED (IF AVAILABLE) 41 \_\_\_\_\_ 52

**Not to be filled in by driller (MDE OR COUNTY USE ONLY)**

APPROX. PERMIT NUMBER **HO2006G020**  
 PERMIT No. **HO-15-0151**  
 70 71 72 73 74 75 76 77 78 79

**SPECIAL CONDITIONS**  
 NOTE: APPROVING AUTHORITIES SHOULD USE SEPARATE SHEET IF NEEDED. Wells must be 100' apart. Radium sample req'd at yield.



HOWARD COUNTY HEALTH DEPARTMENT  
BUREAU OF ENVIRONMENTAL HEALTH  
WELL & SEPTIC PROGRAM  
TEL: (410)313-1771 FAX: (410)313-2648

Information Form for the Installation of the Well Pump, Pitless Adapter, and Supply Piping

NOTE: The installer is responsible for requesting an inspection prior to 9 am on the day of the desired inspection. No work is to be covered until approved by the Health Department. All installations must comply with the National Standard Plumbing Code (NSPC, as amended locally) and COMAR 26.04.04 (MD Well Construction Regulations). Submission of a complete form is required prior to Use and Occupancy approval.

Company Name: Tri-County Pump Service, Inc Telephone #: 301-432-0330  
Address: 6711 Old National Pike  
Boonsboro, Md 21713

(Must circle one) Licensed Plumber Licensed Well Driller Licensed Well Pump Installer  
License # and name of individual responsible for the field installation:  
Name (Print): William G. Smith License # 20135  
\*A licensed individual must perform the actual installation. Apprentices must be under the supervision of a licensed journeyman or master plumber, pump installer or well driller. Licenses may be subjected to field verification. Unlicensed individuals may be reported to the appropriate licensing agency.

Name of Property Owner: Craftmax Homes Telephone #: 703-932-0573  
Subdivision: Walnut Creek Lot #: 126 Well Tag #: HO-15-0151  
Site Address: 5057 Lindera Ct  
Ellicott City, Md 21042

Submersible Pump Data Pitless Adapter Well Cap and Electric Conduit  
Make: Slack Make: American Gravity Two piece watertight cap: Y  
Model #: S9P4#505721 Model #: PT 400 Screened, vented well cap: Y  
Pump Capacity: 7 GPM Depth: 36 (36" min) Cap secured to casing: Y  
Well Yield: 20 GPM NSF/WSC approved: Y Conduit min 18" B.G.: Y  
Depth of well encountered at time of pump installation: 160 (feet) Conduit secured to well cap: Y  
If pump capacity exceeds well yield, a low water cut off switch is required by NSPC 1990 Section 17.8.4  
Torque arrestors, Cable guards, or other acceptable method used- Must circle one  
Safety rope, if used, attached to brass rope adapter or other acceptable method inside of well casing

Piping to house House Connection  
Type: PVC PVC sleeve to undisturbed soil at wall penetration: Yes  
PSI: 200 (160 psi min) Length of sleeve (5' minimum from foundation): 20  
Depth of supply line: 36 (36" min) Sleeve sealed properly: Y

The water supply line is required to be at least ten feet from the septic tank, pump chamber, sewage piping, distribution box, drainfields, and sewage reserve area. If this cannot be accomplished, contact this office for approval prior to installation.

Signature of company representative responsible for installation: William E. Smith date: 3-21-2017

For Health Department Use Only - Not to be completed by Installer

Date Insp. Requested: 3/23/17 Date Insp. Approved: \_\_\_\_\_ Inspector: SC  
Inspection Data: Pitless adapter watertight & water supply line at least 36" below grade ✓  
Two piece cap installed and attached to casing securely ✓  
Elec. conduit extends at least 18" below grade/attached to cap properly ✓  
Safety rope not outside of well cap/casing ✓  
Correct well tag attached properly and casing 8" above finished grade ✓  
Water supply line sleeved adequately at house connection ✓  
Adequate grout observed below pitless adapter ✓

check depth of pipe @ foundation





# Fredericktowne Labs Inc.

ENVIRONMENTAL TESTING

3020 Venture Court • P.O. BOX 245 • Myersville, MD 21173 • 800-332-3340 • FAX 301-293-2366  
 www.fredericktownelabs.com • info@fredericktownelabs.com

## Certificate of Analysis

Acct. No. 3948 - 1822-1

### Field Record

Site visit performed on: Friday, June 09, 2017 11:33 AM  
 by: Steve Wolfe State ID No. 8587SW  
 Affiliation: Tri-County Pump Services  
 Property Owner: Craftmark  
 Property Address: 5057 Lindera Ct.  
 Ellicott City, MD 21042  
 Sample Source: 1st Floor Bath Vanity  
 Treatment Devices Noted: No Treatment Devices —  
 Sample taken after treatment: No  
 Well No.: HO-15-0151  
 Field pH: 7.5  
 Free Res. Cl.: <0.1 mg/l

### Laboratory Report

Sample Received at laboratory: 6/9/2017 1:26 PM

#### Bacteriological results:

<u>Total Colif. (/100ml)</u>	<u>E.coli.(/100ml)</u>	<u>Start</u>		<u>End</u>		<u>Method</u>	<u>Analyst</u>
		<u>Date</u>	<u>Time</u>	<u>Date</u>	<u>Time</u>		
<1	<1	06/09/17	17:05	06/10/17	11:06	9223B	KB

Bacteriological analysis of this sample indicates the water is safe for human consumption and meets federal, state and local requirements. Analysis was performed according to the 20th edition of Standard Methods

#### Inorganic Chemical results:

<u>Parameter</u>	<u>Result</u>	<u>Units</u>	<u>MCL</u>	<u>Date of Analysis</u>	<u>Method</u>	<u>Analyst</u>
Nitrate-Nitrogen	4.1	mg/l	10	6/9/2017	300.0	PH
Sand	<2	mg/l	5	6/9/2017	0.065mmFilter	KB/J
Turbidity	0.1	NTU'	10	6/9/2017	180.1	KB

Reported by: Cristy Phelps 6/12/17  
 Name Date

Fredericktowne Labs, Inc. is a State Certified Water Quality Laboratory  
 Maryland Cert. No. 116 Virginia Cert. No. 00444  
 MDOT WBE Cert. No.: 91-158

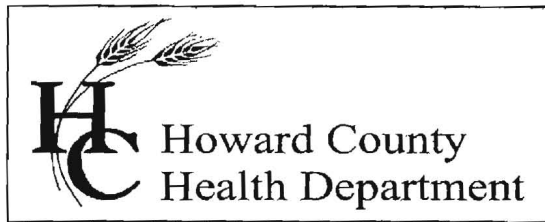

**Bureau of Environmental Health**

8930 Stanford Blvd., Columbia, MD 21046-2147

Main: 410-313-1774 | Fax: 410-313-2648

TDD 410-313-2323 | Toll Free 1-866-313-6300

[www.hchealth.org](http://www.hchealth.org)

Facebook: [www.facebook.com/hocohealth](https://www.facebook.com/hocohealth)

Twitter: HowardCoHealthDep

**Maura J. Rossman, M.D., Health Officer**

**INTERIM CERTIFICATE OF POTABILITY**

**Expiration Date – December 16, 2017**

June 16, 2017

Homeowner  
5057 Lindera Court  
Ellicott City, MD 21042

**RE: Walnut Creek, Lot 126  
5057 Lindera Court  
Building Permit: B16005004  
Well Permit: HO-15-0151**

Dear Homeowner:

This is to advise you that the septic system installation and water well construction for the above referenced property have been inspected and approved. Final approval of the septic system was granted on **6/16/2017**. Final approval of the well line connection to the dwelling was granted on **6/16/2017**. The well construction was completed on **11/5/2015**. Water samples were collected on **6/9/2017**.

The water sample results indicate that the water samples submitted for testing were free of coliform and fecal coliform bacteria at the time of sampling and are bacteriologically safe for drinking.

Gross Alpha and Beta samples were also collected on **11/5/2015**. Results showed a Gross Alpha level of **2.0 ± 0.0 pCi/L** and **Gross Beta** level of **4.0 ± 0.0 pCi/L**. The Gross Alpha was below the maximum contaminant level (MCL) of 15 pCi/L and the Gross Beta was below the target level of 50pCi/L (roughly equivalent to the annual dose rate of 4 millirems per year). At the time of testing and with respect to these parameters, the well water is safe for all uses.

This certifies that the initial sampling requirements of COMAR 26.04.04 "Well Regulations" have been met for the water supply system installed under well permit HO-15-0151. Although the submitted sample results are in compliance with COMAR standards, the Health Department does not guarantee water supplies.

This Interim Certificate of Potability will expire **six months** from the date of issuance. Submission of a second bacteriological test indicating the water is free of coliform and fecal coliform bacteria is required prior to the expiration date, after which time a Final Certificate of Potability will be issued. **Failure to submit an additional sample and obtain a Final Certificate of Potability will result in a Notice of Violation and is punishable as a misdemeanor under the *Annotated Code of Maryland, Environment Article, 9-1311*, subject to a fine of up to \$500 or imprisonment not to exceed three months.**

Please contact (410) 313-1773 to schedule a final water sample appointment or contact a certified water quality laboratory to schedule a water sample. A list of laboratories certified by the state of Maryland may be found at the following website:  
<http://www.mde.state.md.us/assets/document/WSP-Labs-2010apr16.pdf>

Approving Authority,

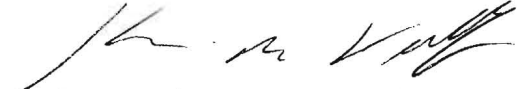

Kevin M Wolf, L.E.H.S., REHS/R.S., Supervisor  
Groundwater Management Section  
Well & Septic Program

cc: Howard County Dept. of Inspections, Licenses, and Permits  
Community Hygiene Program  
File

## Wolf, Kevin

---

**From:** John Pavlik <jpavlik@CraftmarkHomes.com>  
**Sent:** Thursday, June 15, 2017 9:18 AM  
**To:** Wolf, Kevin  
**Subject:** Fwd: U&O Release 5057 Lindera Court

Kevin,

Good morning. I noticed you were not on the email chain to receive this U and O release from Howard County Utilities for 5057 Lindera Court. I also asked that Tri County to include you on the water testing results. Those results I am told were emailed to you yesterday along with the results for 5042 Crape Myrtle Court. I am hoping to call in my building final for tomorrow or Monday worst case scenario for 5057 Lindera Court. Can you please take a look at the documentation and issue the ICOP if everything is good. Thank you for your help.

John Pavlik

Project manager  
Walnut Creek  
Craftmark Homes

Begin forwarded message:

**From:** "Fisher, Mike" <MIFisher@howardcountymd.gov>  
**Date:** June 14, 2017 at 1:48:19 PM EDT  
**To:** "Harris, Leslie" <lharris@howardcountymd.gov>  
**Cc:** "Hart, Amy" <AHart@howardcountymd.gov>, "Rocco, Anthony" <ARocco@howardcountymd.gov>, "Martin, Sharhonda" <smmartin@howardcountymd.gov>, "Williams, Jeffrey" <jewilliams@howardcountymd.gov>, "Bozzell, Duane" <DBozzell@howardcountymd.gov>, "Bernard, Dana" <dbernard@howardcountymd.gov>, "Wolf, Kevin" <KWolf@howardcountymd.gov>, "Collins, Sarah" <SCollins@howardcountymd.gov>, John Pavlik <jpavlik@CraftmarkHomes.com>, "Tuder, Matt" <MTuder@howardcountymd.gov>  
**Subject:** U&O Release 5057 Lindera Court

On the morning of May 24th, Duane Bozzell observed the start-up of a Sewage Grinder Pump at the Walnut Creek Shared Septic System:

Walnut Creek, Contract #4773  
Craftmark Homes, Lot #126  
5057 Lindera Court  
Ellicott City, MD 21042

The Sewage Grinder Pump test was successful; the Bureau of Utilities releases its hold on this property for U&O.

*Thank You,*

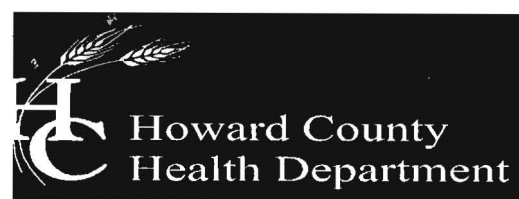

**Bureau of Environmental Health**

8930 Stanford Boulevard, Columbia, MD 21045

Main: 410-313-2640 | Fax: 410-313-2648

TDD 410-313-2323 | Toll Free 1-866-313-6300

[www.hchealth.org](http://www.hchealth.org)

Facebook: [www.facebook.com/hocohealth](https://www.facebook.com/hocohealth)

**Maura Rossman, M.D., Health Officer**

December 29, 2015

**Bassler Venture  
Attn. Tim Feaga  
15950 North Avenue, P.O. Box 482  
Lisbon, Maryland 21765**

**RE: Walnut Creek Lot 126  
Lindera Court  
Well Tag: HO - 15 - 0151**

Dear Mr. Feaga:

A sample was collected during a yield test on November 5, 2015 and submitted to the Department of Health & Mental Hygiene Laboratories to assess the possible presence of **Gross Alpha** and **Gross Beta** in the future well water supply. **Gross Alpha** and **Gross Beta** measure the total alpha and beta particle activity in a water supply. These naturally occurring radioactive nuclides have been demonstrated to be present in a certain type of geologic formation known as the Baltimore Gneiss which exists in your area of development within the County.

Results from this screening revealed a **Gross Alpha** of  $< 2.0 \pm 0.0$  picocuries/liter (pCi/L), while the **Gross Beta** level was  $< 4.0 \pm 0.0$  pCi/L. The **Gross Alpha** result was below its **maximum contaminant level (MCL)** of 15 pCi/L, while the **Gross Beta** level was below its targeted value of 50 pCi/L (roughly equivalent to the **annual dose rate** of 4 millirems/year).

At the time of testing and with respect to these parameters, the future well water supply **meets** EPA regulatory standards. Additional testing **for these parameters** will not be required to secure the future Use & Occupancy. **Please note** that other standard testing parameters (bacteria, nitrate, turbidity and sand) will still be required to help secure Use & Occupancy.

A copy of the test results is enclosed for your information. Please call this office at **410-313-1773** if you have any further questions.

Sincerely,

A handwritten signature in black ink that reads 'Bert Nixon'.

Bert Nixon, Director

Bureau of Environmental Health

✓ Enclosure  
cc: Property file

SEND REPORT TO: Bert Nixon  
 Howard Co Health Dept.  
 Bureau of Environmental Health  
 8930 Stanford Blvd.  
 Columbia, MD 21245

State of Maryland  
 DHMH - Laboratories Administration  
 Division of Environmental Chemistry  
**RADIATION LABORATORY**  
 1770 Ashland Avenue  
 Baltimore, Maryland 21205

Lab No. 0115

**LABORATORY ANALYSIS REQUEST FORM**

Plant/Site Name: Walnut Creek Lot 126 County: Howard

Sample Source: Lindera Ct. Location: HO-15-0151

(Well no., lab sink, sample tap, etc.)

Radon-222 Bottle A \_\_\_\_\_ Radon-222 Field Blank Bottle A \_\_\_\_\_  
 Bottle B \_\_\_\_\_ Bottle B \_\_\_\_\_

County  1  2  3 Plant No.

CHECK (one per Box)

Type	Service	Point of Collection	Testing
Drinking Water <input checked="" type="checkbox"/>	Community <input type="checkbox"/>	Source (Raw) <input type="checkbox"/>	Emergency <input type="checkbox"/>
Landfill <input type="checkbox"/>	Non-Community <input type="checkbox"/>	Distribution (treated) <input type="checkbox"/>	Routine <input checked="" type="checkbox"/>
Stream <input type="checkbox"/>	Private <input checked="" type="checkbox"/>	MCL <input type="checkbox"/>	Recheck <input type="checkbox"/>
Other _____ <input type="checkbox"/>	Other _____ <input type="checkbox"/>		Special <input type="checkbox"/>

Submitters Code:   Federal Project: 5

Collector: S. Collins Telephone No.: 410-313-6237

Date Collected: 11/5/15 Time Collected: 9:45 a.m. \_\_\_\_\_ p.m.

Field pH: \_\_\_\_\_ Field Chlorine: \_\_\_\_\_

Nitric Acid Preserved: Yes  No  Iced: Yes  No

Remarks: Sample taken during yield

<input checked="" type="checkbox"/>	TEST	EPA Code	Lab No.	Method No.	Results (pCi/L)	Date Analyzed	Analyst	Date Reported
<input checked="" type="checkbox"/>	Gross Alpha	4000	0782	EPA 900.0	<2.0	11/6/15	JJ	11/10/15
<input checked="" type="checkbox"/>	Gross Beta	4100	0782	EPA 900.0	<4.0	11/6/15	JJ	11/10/15
<input type="checkbox"/>	Radium-226	4020						
<input type="checkbox"/>	Radium-228	4030						
<input type="checkbox"/>	Total Uranium	4006						
<input type="checkbox"/>	Radon-222 (Bottle A)	4004						
<input type="checkbox"/>	Radon-222 (Bottle B)	4004						
<input type="checkbox"/>	Radon Field Blank A	4004						
<input type="checkbox"/>	Radon Field Blank B	4004						
<input type="checkbox"/>	Tritium							
<input type="checkbox"/>								
<input type="checkbox"/>								

Date Received: 11/06/15 Received By: Jim Ji  
 Data Release Signature: Deborah Miller-Jack Date: 11-10-15

Lab Use Only	Yes	No	N/A
Sample Intact upon arrival?	<input checked="" type="checkbox"/>		
Sample pH <2.0?	<input checked="" type="checkbox"/>		
Received within holding time?	<input checked="" type="checkbox"/>		

•Tel. No.: (443) 681-3766 •Fax No.: (443) 681-4507

SEND REPORT TO: Bert Nixon  
 Howard Co. Health Dept.  
 Bureau of Environmental Health  
 6930 Stanford Blvd.  
 Columbia MD 21045

State of Maryland  
 DHMH - Laboratories Administration  
 Division of Environmental Chemistry  
**RADIATION LABORATORY**  
 1770 Ashland Avenue  
 Baltimore, Maryland 21205  
**LABORATORY ANALYSIS REQUEST FORM**

Lab No.  
 E000781-5#

Plant/Site Name: Field Blank County: Howard

Sample Source: dH<sub>2</sub>O Location: HCHD Lab

(Well no., lab sink, sample tap, etc.)

Radon-222 Bottle A \_\_\_\_\_ Radon-222 Field Blank Bottle A \_\_\_\_\_  
 Bottle B \_\_\_\_\_ Bottle B \_\_\_\_\_

County 113 Plant No. \_\_\_\_\_

CHECK (one per Box)

Type	Service	Point of Collection	Testing
Drinking Water <input checked="" type="checkbox"/>	Community <input type="checkbox"/>	Source (Raw) <input checked="" type="checkbox"/>	Emergency <input type="checkbox"/>
Landfill <input type="checkbox"/>	Non-Community <input type="checkbox"/>	Distribution (treated) <input type="checkbox"/>	Routine <input checked="" type="checkbox"/>
Stream <input type="checkbox"/>	Private <input checked="" type="checkbox"/>	MCL <input type="checkbox"/>	Recheck <input type="checkbox"/>
Other <input type="checkbox"/>	Other <input type="checkbox"/>		Special <input type="checkbox"/>

Submitters Code: \_\_\_\_\_ Federal Project: 5

Collector: S. Collins Telephone No.: 410-313-6287

Date Collected: 11/5/15 Time Collected: 11:30 a.m. \_\_\_\_\_ p.m.

Field pH: \_\_\_\_\_ Field Chlorine: \_\_\_\_\_

Nitric Acid Preserved: Yes  No  Iced: Yes  No

Remarks: \_\_\_\_\_

✓	TEST	EPA Code	Lab No.	Method No.	Results (pCi/L)	Date Analyzed	Analyst	Date Reported
<input checked="" type="checkbox"/>	Gross Alpha	4000	0781	EPA900.0	<2.0	11/6/15	IT	11/10/15
<input checked="" type="checkbox"/>	Gross Beta	4100	0781	EPA900.0	<4.0	11/6/15	IT	11/10/15
<input type="checkbox"/>	Radium-226	4020						
<input type="checkbox"/>	Radium-228	4030						
<input type="checkbox"/>	Total Uranium	4006						
<input type="checkbox"/>	Radon-222 (Bottle A)	4004						
<input type="checkbox"/>	Radon-222 (Bottle B)	4004						
<input type="checkbox"/>	Radon Field Blank A	4004						
<input type="checkbox"/>	Radon Field Blank B	4004						
<input type="checkbox"/>	Tritium							
<input type="checkbox"/>								
<input type="checkbox"/>								

Date Received: 11/05/15 Received By: In Ji

Data Release Signature: Deborah Miller - Juel Date: 11-10-15

Lab Use Only	Yes	No	N/A
Sample Intact upon arrival?	<input checked="" type="checkbox"/>		
Sample pH <2.0?	<input checked="" type="checkbox"/>		
Received within holding time?	<input checked="" type="checkbox"/>		

•Tel. No.: (443) 681-3766 •Fax No.: (443) 681-4507

ORIG SENT 11/23

# Invoice

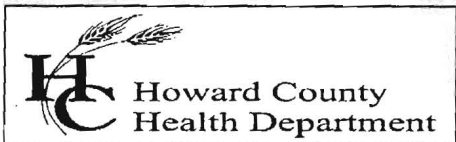

Bureau of Environmental Health  
Attn: Bert Nixon, Director

DATE: NOVEMBER 23, 2015  
DATES OF SERVICE: NOV. 4, & 5, 2015  
INVOICE #: 2015-011

8930 Stanford Boulevard, Columbia, MD 21045  
Phone 410-313-2640 Fax 410-313-2648  
www.hchealth.org

**BILL TO** Basslers Venture  
Attn: Tim Feaga  
15950 North Ave P.O. Box 482  
Lisbon, MD 21765

**COMMENTS** Payment due upon receipt. Letter and results will be released upon receipt of payment.

DATE	DESCRIPTION	BALANCE	AMOUNT
11/04/15	Gross alpha/beta testing performed for Walnut Creek, Lots 128 & 129 HO - 15 - 0153 HO - 15 - 0154		\$90.00
11/05/15	Gross alpha/beta testing performed for Walnut Creek, Lot 126 HO - 15 - 0151		\$45.00
			<b>AMOUNT DUE</b>
			\$135.00

Please detach and return with payment.

REMITTANCE	
Invoice #	2015-011
Site Information	Walnut Creek Lots 126, 128, & 129
Amount Due	\$135.00

*Receipt # 57498*  
*Pd 12/23/15*

Make Checks Payable to: **Director of Finance** Mail Payments to: **Bureau of Env. Health**

I:\2004\04001\dwg\PHASE FOUR FINALS\04001 Phase Four FINAL WELL MAPS.dwg, 9/1/2015 2:44:32 PM, 1:1

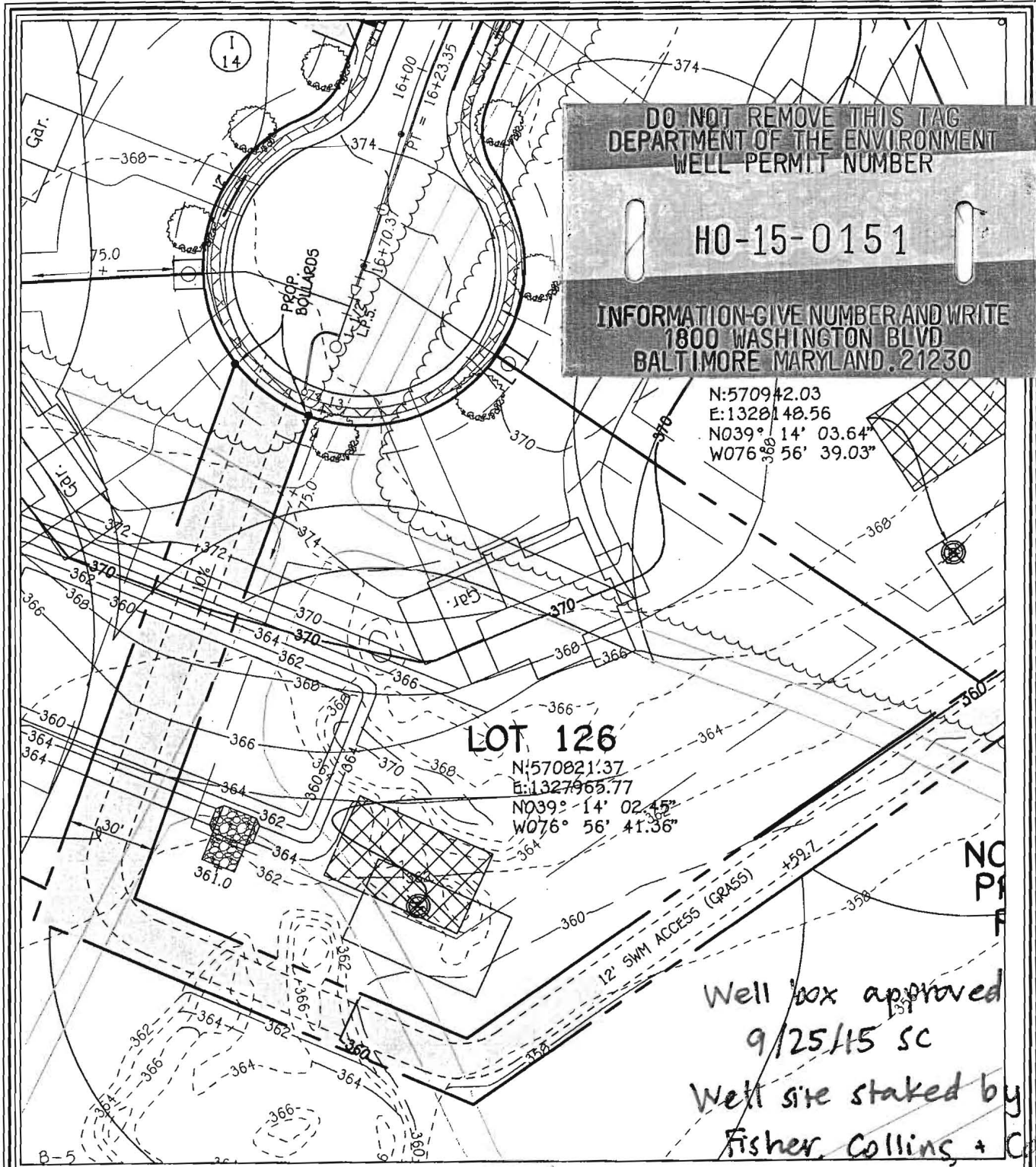

**DO NOT REMOVE THIS TAG**  
**DEPARTMENT OF THE ENVIRONMENT**  
**WELL PERMIT NUMBER**

**H0-15-0151**

**INFORMATION-GIVE NUMBER AND WRITE**  
**1800 WASHINGTON BLVD**  
**BALTIMORE MARYLAND. 21230**

N:570942.03  
 E:1328148.56  
 N039°14'03.64"  
 W076°56'39.03"

**LOT 126**

N:570821.37  
 E:1327965.77  
 N039°14'02.45"  
 W076°56'41.36"

*Well box approved  
 9/25/15 SC  
 Well site staked by  
 Fisher, Collins + Carter*

**WELL LOCATION INFORMATION:**  
 NORTHING = 570821.37    EASTING = 1327965.77  
 LATITUDE = N 39°14'02"    LONGITUDE = W 76°56'41"

**LOT 126 WELL MAP**  
**WALNUT CREEK**  
**PHASE FOUR**

Lots 23 - 68, Non-Buildable Preservation Parcels  
 'C', 'G', 'I', 'K', 'L' And 'M', Buildable Bulk Parcels 'E' And 'H'  
 & Non-Buildable Parcel 'J'  
 ZONED: RC-DEO & RR-DEO

TAX MAP No. 28    GRID Nos. 4, 5, 10-12, 17, AND 18    PARCEL No. 49  
 FIFTH ELECTION DISTRICT    HOWARD COUNTY, MARYLAND  
 DATE: SEPTEMBER 1, 2015    SCALE: 1"=50'

**FISHER, COLLINS & CARTER, INC.**  
 CIVIL ENGINEERING CONSULTANTS & LAND SURVEYORS  
 CENTENNIAL SQUARE OFFICE PARK - 10272 BALTIMORE NATIONAL PIKE  
 ELICOTT CITY, MARYLAND 21042  
 (410) 461 - 2855

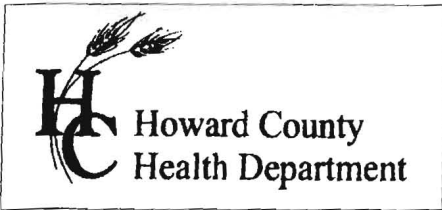

7178 Columbia Gateway Dr., Columbia, MD 21046  
 (410) 313-2640 Fax (410) 313-2648  
 TDD (410) 313-2323 Toll Free 1-866-313-6300  
 website: www.hchealth.org

**Peter L. Bielson, M.D., M.P.H., Health Officer**

**TO ALL INTERESTED PARTIES**

When submitting a well application for a proposed well for new construction, please indicate one of the following:

Well Site Location:

Walnut Creek	126	Lindera Court
<b>Subdivision/Property Name</b>	<b>Lot #</b>	<b>Road Name</b>

The well site has been staked by Fisher, Collins and Carter, Inc.,  
 (professional land surveyor or company employing professional land surveyors)  
 on 09/17/15 (date) and does not require a site inspection.

The well driller, builder or property owner will call the Health Department to schedule a time to meet in the field to verify the proposed well site location.

This sheet, along with two copies of an acceptable well site plan, must be attached to the green well permit application.

**Revised 3/11/07**

