

LAYOUT \_\_\_\_\_ INSP 4 \_\_\_\_\_  
INSP 2 \_\_\_\_\_ INSP 5 \_\_\_\_\_  
INSP 3 \_\_\_\_\_ INSP 6 \_\_\_\_\_

ISSUE DATE: 9/30/05

P 523405

APPROVAL DATE: \_\_\_\_\_

A 49877

# PERMIT

**TAX ID #03326543**

**ON-SITE SEWAGE DISPOSAL SYSTEM  
HOWARD COUNTY HEALTH DEPARTMENT  
BUREAU OF ENVIRONMENTAL HEALTH**

Fyock Septic Service Inc. IS PERMITTED TO INSTALL  ALTER

ADDRESS: P. O. Box 89, Glenelg 21737 PHONE NUMBER: 240-882-4025  
410-531-2939

SUBDIVISION: Wilson Property LOT NUMBER: Manager's House

ADDRESS: 1650 Marriottsville Road PROPERTY OWNER: Scott Wilson

SEPTIC TANK CAPACITY (GALLONS): 1000 OUTLET BAFFLE FILTER REQUIRED

PUMP CHAMBER CAPACITY (GALLONS): 1000 COMPARTMENTED TANK REQUIRED

NUMBER OF BEDROOMS: 3

SQUARE FEET PER BEDROOM: 180

LINEAR FEET OF TRENCH REQUIRED: 180 HOUSE SERVED BY PUBLIC WATER

TRENCHES:	Trench to be 3.0 feet wide. Inlet <u>3.0</u> feet below original grade. Bottom maximum depth 5.5 feet below original grade. Effective area begins at 5.5 feet below original grade. 2.5 feet of stone below distribution pipe.
LOCATION:	Keep the distribution box at the highest elevation in the SDA. Run 2-100' length trenches on contour. If excessive rock is exposed or impermeable clay, run solid pipe through area.
NOTES:	Call for inspection prior to filling trenches with stone & pipe for soil inspection. No basement service proposed. SDA must be staked before calling for layout inspection.

PLANS APPROVED: Kacie Noonan Reviewed by: \_\_\_\_\_ DATE: 9/23/05

NOTES: PERMIT VOID AFTER 2 YEARS  
CONTRACTOR IS RESPONSIBLE FOR SCHEDULING A PRE-CONSTRUCTION INSPECTION FOR ALL INSTALLATIONS  
WATERTIGHT SEPTIC TANKS REQUIRED  
ALL PARTS OF SEPTIC SYSTEM SHALL BE 100 FEET FROM ANY WATER WELL UNLESS SPECIFICALLY AUTHORIZED  
MANHOLE RISERS REQUIRED ON ALL SEPTIC TANKS AND PUMP CHAMBERS UNLESS SPECIFICALLY AUTHORIZED  
CONTRACTOR RESPONSIBLE FOR COMPLIANCE WITH APPLICABLE REGULATIONS, GUIDELINES AND THE TERMS OF THIS PERMIT

**NEITHER THE HOWARD COUNTY COUNCIL NOR THE HEALTH DEPARTMENT IS  
RESPONSIBLE FOR THE SUCCESSFUL OPERATION OF ANY SYSTEM  
PERMITTEE RESPONSIBLE FOR OBTAINING FINAL APPROVAL ON THIS PERMIT  
ALL 410-313-1771 FOR INSPECTION OF SEPTIC SYSTEM**

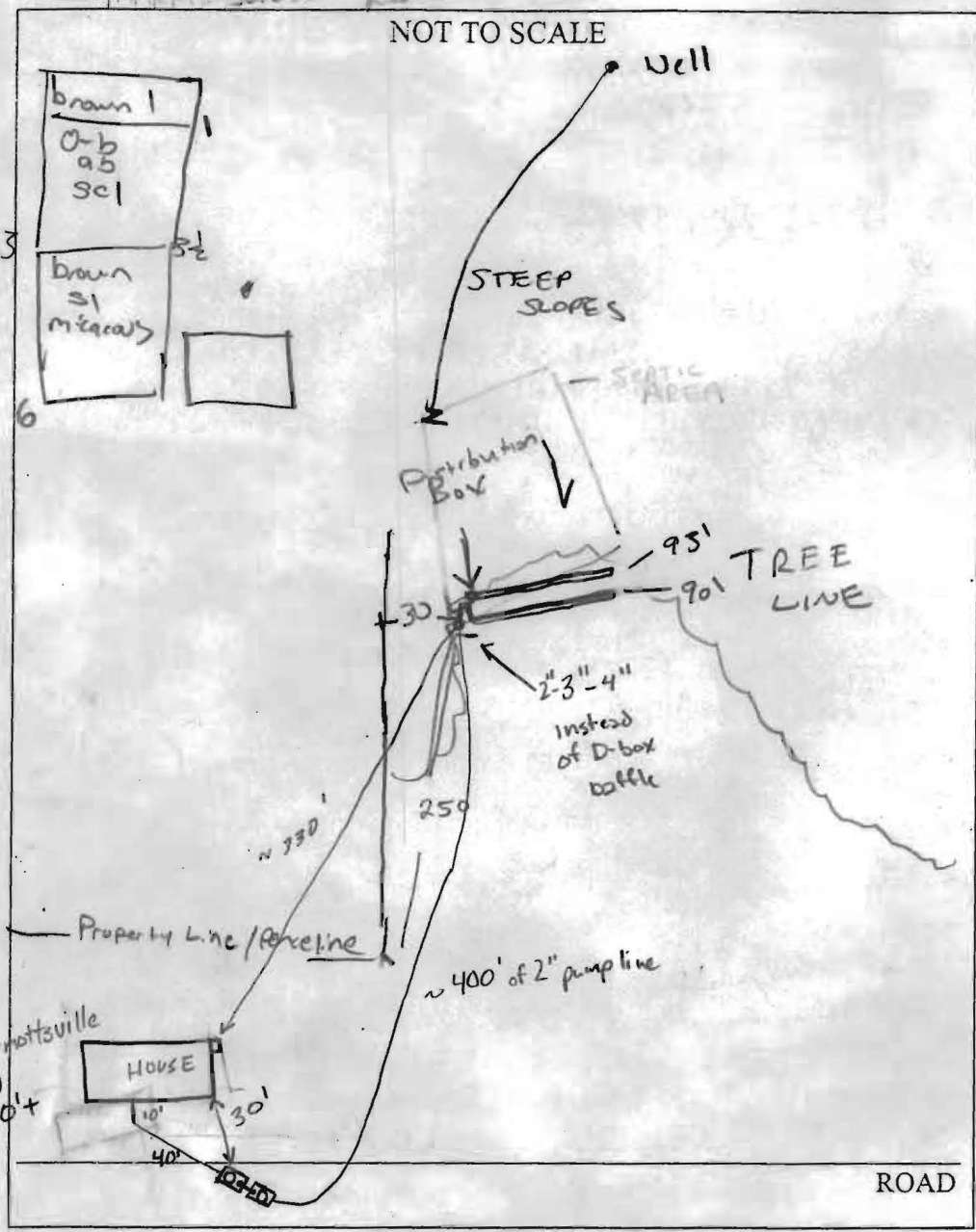

TRENCH/DRAINFIELD DATA		
WIDTH	INLET	BOTTOM
<u>3</u>	<u>3</u>	<u>5.5</u>
NUMBER OF TRENCHES		<u>2</u>
TOTAL LENGTH		<u>93+90 = 183</u>
ABSORPTION AREA		<u>549+SW</u>
DISTRIBUTION BOX LEVEL		<input checked="" type="checkbox"/>
DISTRIBUTION BOX BAFFLE		<input checked="" type="checkbox"/>
DISTRIBUTION BOX PORT		<input checked="" type="checkbox"/>

SEPTIC TANK DATA	
SEPTIC TANK 1 LEVEL	<u>yes</u>
CAPACITY	<u>1500</u> GAL
SEAM LOC	<u>top</u>
TANK LID DEPTH	<u>2'</u>
BAFFLES	<u>Yes</u>
BAFFLE FILTER	<u>No</u>
MANHOLE LOC	<u>Inlet</u>
6" PORT LOC	<u>Outlet</u>
WATERTIGHT TEST	<u>No</u>
SEPTIC TANK 2 LEVEL	<u>Yes</u>
CAPACITY	<u>1000</u> GAL
SEAM LOC	<u>Top</u>
TANK LID DEPTH	<u>1'</u>
BAFFLES	<u>Inlet</u>
BAFFLE FILTER	<u>No</u>
MANHOLE LOC	<u>Center</u>
6" PORT LOC	<u>Inlet</u>
WATERTIGHT TEST	<u>No</u>

PRE-CONSTRUCTION - Tenant House -

2 - 90' trenches  
 INSTALLATION 30' off fence, 250 off corner fence post. (GAC)  
 10/6/05 Trenches installed in lower area of septic easement.  
 O.K to dig well line over weekend & leave 3-4 areas open for inspection. Inlet moved to 3 1/2'. / 10/7/05 Tanks set, could not see baffles (SF) 10/17/05 Baffles in tanks OK to Cover everything  
 Needs Pump and alarm test. BP must be signed to get electricity in house for pump & Alarm. (GAC) Well line is >10' from septic at all points. (GAC)

FINAL INSPECTOR \_\_\_\_\_ DATE OF APPROVAL \_\_\_\_\_

NOT TO SCALE

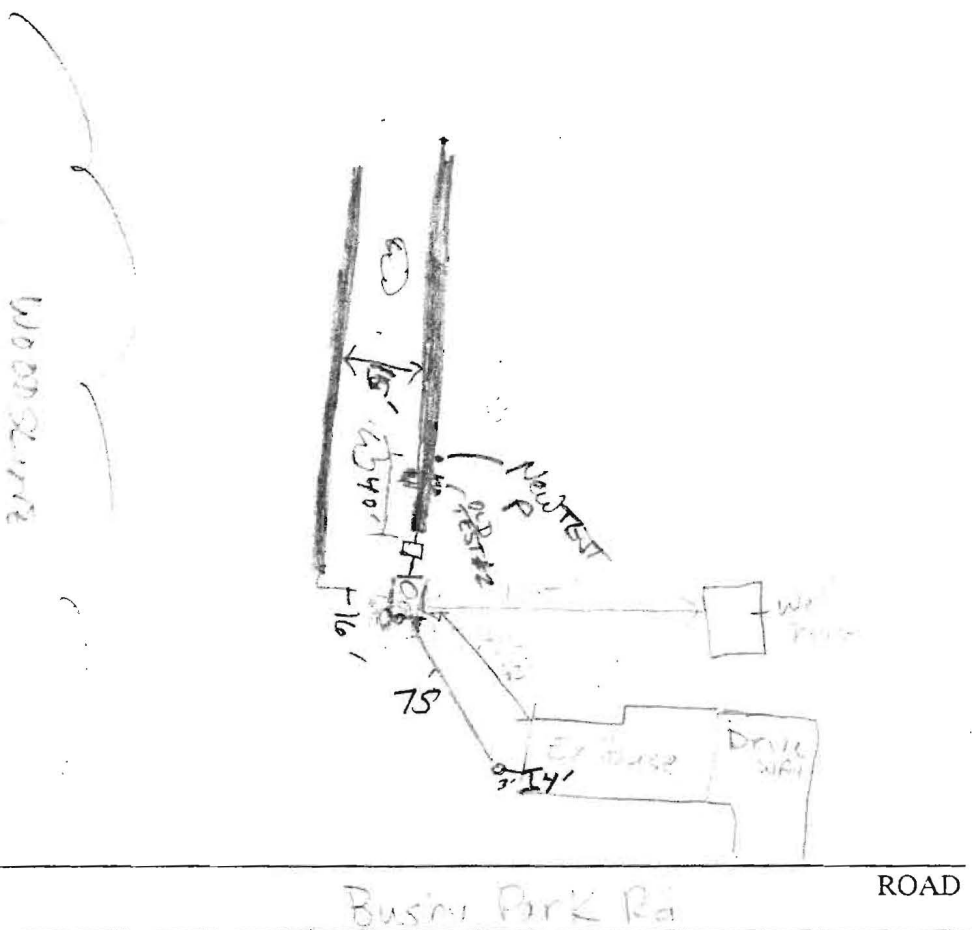

TRENCH/DRAINFIELD DATA		
WIDTH	INLET	BOTTOM
3	2 1/2	4 1/2
NUMBER OF TRENCHES		2
TOTAL LENGTH		200
ABSORPTION AREA _____		
DISTRIBUTION BOX LEVEL		yes
DISTRIBUTION BOX BAFFLE		yes
DISTRIBUTION BOX PORT		No
SEPTIC TANK DATA		
SEPTIC TANK 1 LEVEL		yes
CAPACITY		1250 GAL
SEAM LOC		TOP
TANK LID DEPTH		12"
BAFFLES		yes
BAFFLE FILTER		No
MANHOLE LOC		Middle
6" PORT LOC		front
WATERTIGHT TEST		no
SEPTIC TANK 2 LEVEL		NA
CAPACITY		_____ GAL
SEAM LOC		_____
TANK LID DEPTH		_____
BAFFLES		_____
BAFFLE FILTER		_____
MANHOLE LOC		_____
6" PORT LOC		_____
WATERTIGHT TEST		_____

PRE-CONSTRUCTION <sup>9/14/04</sup> S.T. H<sub>2</sub>O 2' deep. results of compact soil

INSTALLATION <sup>9/15/04</sup> S.T. OVERSIZED for better settling of solids. 2-100' long trenches. Trenches deeper than permitted; 4' buffer from 4 1/2 to 7 1/2 - OK. Pour in gravel & finish. cover prior to rain.

OK. (KN)

FINAL INSPECTOR Kacie Thomas DATE OF APPROVAL 9/15/04