

LAYOUT 12/18/07 INSP 4 _____
INSP 2 12/20/07 INSP 5 _____
INSP 3 _____ INSP 6 _____

ISSUE DATE: _____

P 527938

APPROVAL DATE: 12/21/07

PERMIT

A Upgrade

Logged Into Permit Manager

ON-SITE SEWAGE DISPOSAL SYSTEM HOWARD COUNTY HEALTH DEPARTMENT BUREAU OF ENVIRONMENTAL HEALTH

Thomas Hammer, Jr. IS PERMITTED TO INSTALL ALTER

ADDRESS: 12750 Lime Kiln Rd. PHONE NUMBER: 301 938 3609

SUBDIVISION: Lime Kiln Valley LOT NUMBER: 39

ADDRESS: 12750 Lime Kiln Rd. PROPERTY OWNER: Thomas Hammer, Jr.

SEPTIC TANK CAPACITY (GALLONS): 2000 OUTLET BAFFLE FILTER REQUIRED

PUMP CHAMBER CAPACITY (GALLONS): N/A COMPARTMENTED TANK REQUIRED

NUMBER OF BEDROOMS: 6

SQUARE FEET PER BEDROOM: _____

LINEAR FEET OF TRENCH REQUIRED: 202.5 150 ft. existing

TRENCHES:	Trench to be 2 feet wide. Inlet 3 feet below original grade. Bottom maximum depth 7 feet below original grade. Effective area begins at 3 feet below original grade. 4 feet of stone below distribution pipe.
LOCATION:	Install a second septic tank in series with the existing 1250 gallon tank to total a minimum of 2000 gallons. Add one additional 75 foot length [recommended] (52.5' required) of absorption trench, maintaining at least 9 feet center separation from the lowest existing 75' trench.
NOTES:	Addition of second septic tank allowed to fulfill compartmented tank/total tank size requirement for building permit. Outlet baffle filter required on the second tank in series, due to proximity to drinking water reservoir(s). Call before 9am on the day of work (or earlier) to schedule inspection. HCHD Personnel must be on-site for trench excavations to confirm soils.

PLANS APPROVED: Gabriel A. Creighton DATE: 12/7/2007

- NOTE: PERMIT VOID AFTER 2 YEARS
- NOTE: CONTRACTOR RESPONSIBLE FOR SCHEDULING A PRE-CONSTRUCTION INSPECTION FOR ALL INSTALLATIONS
- NOTE: WATERTIGHT SEPTIC TANKS REQUIRED
- NOTE: ALL PARTS OF SEPTIC SYSTEM SHALL BE 100 FEET FROM ANY WATER WELL
- NOTE: MANHOLE RISERS REQUIRED ON ALL SEPTIC TANKS AND PUMP CHAMBERS UNLESS SPECIFICALLY AUTHORIZED

NEITHER THE HOWARD COUNTY COUNCIL NOR THE HEALTH DEPARTMENT IS RESPONSIBLE FOR THE SUCCESSFUL OPERATION OF ANY SYSTEM PERMITTEE RESPONSIBLE FOR OBTAINING FINAL APPROVAL ON THIS PERMIT CALL 410-313-1771 FOR INSPECTION OF SEPTIC SYSTEM

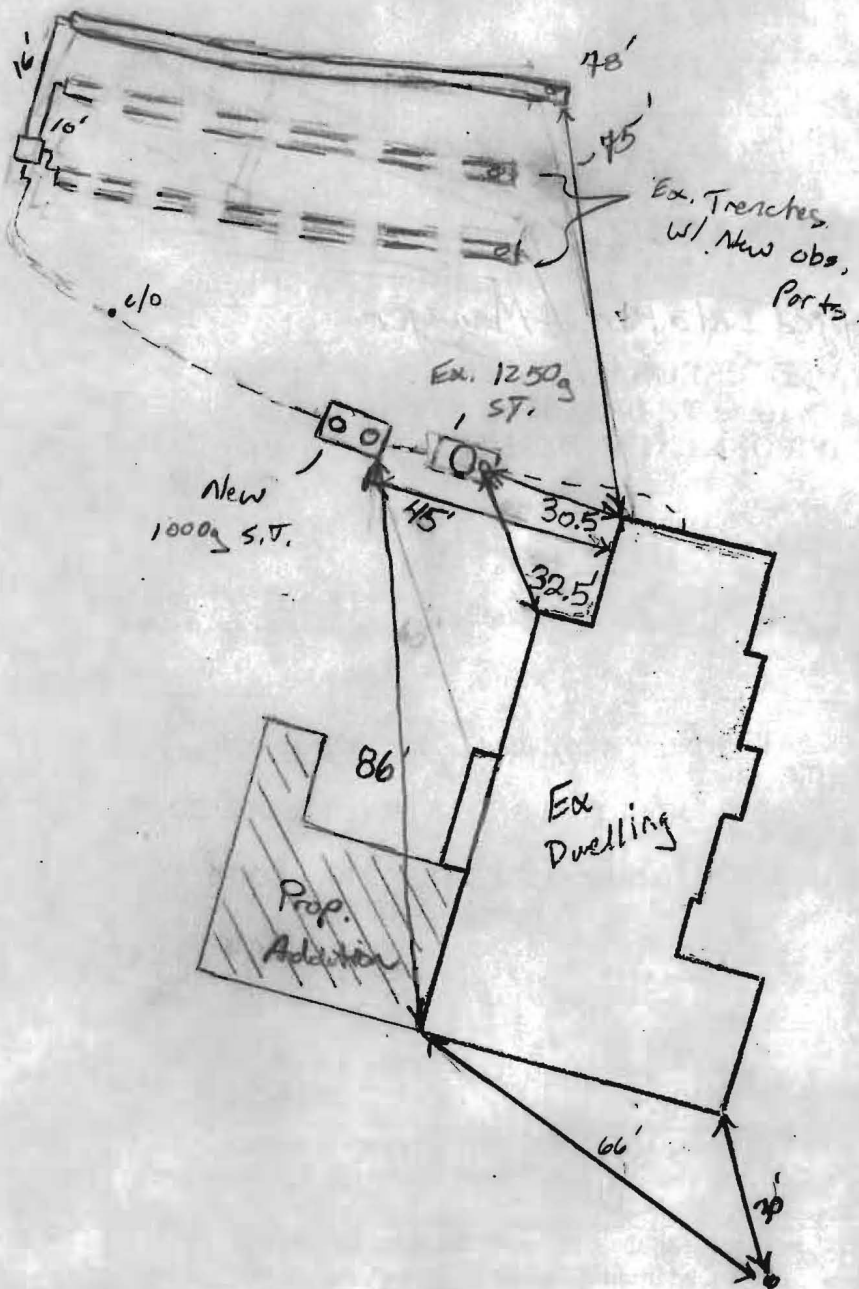

TRENCH/DRAINFIELD DATA		
WIDTH	INLET	BOTTOM
2'	3'	4'
NUMBER OF TRENCHES <u>2 + 1 = 3</u>		
TOTAL LENGTH <u>78'</u>		
ABSORPTION AREA <u>312</u>		
DISTRIBUTION BOX LEVEL <u>Levelers</u>		
DISTRIBUTION BOX BAFFLE <u>Yes</u>		
DISTRIBUTION BOX PORT <u>Yes</u>		

SEPTIC TANK DATA	
EX SEPTIC TANK 1 LEVEL	<u>Yes</u>
CAPACITY	<u>1250</u> GAL
SEAM LOC	<u>Top</u>
TANK LID DEPTH	<u>0-2'</u>
BAFFLES	<u>Yes</u>
BAFFLE FILTER	<u>no</u>
MANHOLE LOC	<u>center</u>
6" PORT LOC	<u>Front</u>
WATERTIGHT TEST	<u>—</u>
SEPTIC TANK 2 LEVEL	<u>Yes</u>
CAPACITY	<u>1000</u> GAL
SEAM LOC	<u>Top</u>
TANK LID DEPTH	<u>1-2'</u>
BAFFLES	<u>Yes</u>
BAFFLE FILTER	<u>outlet</u>
MANHOLE LOC	<u>Front/Rear</u>
6" PORT LOC	<u>none</u>
WATERTIGHT TEST	<u>—</u>

Baystar

PRE-CONSTRUCTION HO-81-1062

12/18/07 Additional work to be set in-line after ex S.T. Located ex. INSTALLATION 2x75' trenches. Contractor to install 75' trench 9' E of E. below ex 2 trenches. New D box to be installed as well. Call for f/v inspections. (KW) 12/20/07 System complete. A 78' trench added. New D box installed. Observation ports installed @ ends of all 3 trenches. D box needs to be leveled. Everything else OK. 12/21/07 Levelers adjusted in dist. box. (BB)

FINAL INSPECTOR B. Baker DATE OF APPROVAL 12/21/07



Potomac Electric Power Company

Real Estate Department
701 Ninth Street, NW
Washington, DC 20068

202 872-2554
202 872-3579 Fax
vdgibson@pepco.com

June 29, 2007

Mr. Thomas Hammer Jr.
12750 Lime Kiln Rd
Highland, MD 20777

Re: Pepco Brighton to High Ridge 500 kV Transmission Line Property H-1919
12750 Lime Kiln Rd, Highland, MD 20777 (75ft Conflict Tree Easement)

Dear Mr. Hammer:

Per your request we have reviewed our existing rights within Liber 2736, Folio 379 a nonexclusive perpetual easement (the Conflict Tree Easement) across your property, located Lot 39, Lime Kiln Valley, Howard County, Maryland and more particularly described as Property H-1919.

Our review has revealed that you are able to build within the 75 foot easement area. However, please keep in mind that Pepco has the absolute right to remove and cut all trees within this area at our sole discretion.

Sincerely,

Vernon D. Gibson

ACCESSORY APARTMENT PERMIT APPLICATION

1. Applicant's Name (please print)

Thomas Hammer Jr

Telephone No 301 938 3609

2. Address of property containing apartment:

12750 Lime Kiln Rd

Highland MD 20777

3. Total floor area of house 5300sqft (include area of accessory apartment but do not include floor area of garages)

4. Floor area of accessory apartment, including one-third of the floor area of any shared storage or utility areas 1500

(Shall not exceed 40% of the net floor area of a dwelling with a net floor area of 2,000 square feet or less. For a dwelling larger than 2,000 square feet of net floor area, the apartment shall occupy no more than one-third of the net floor area, up to a maximum of 1,500 square feet.)

5. Number of parking spaces on-site 5

(A minimum of two spaces must be provided for the principal dwelling and one space for the accessory apartment. All parking must be provided on-site. Street parking may not be used to meet minimum requirement).

6. Number of bedrooms in accessory apartment 2 (may not exceed 2)

7. Square footage/acreage of lot 3.48 Acres

8. Unit to be occupied by property owner: (circle one) main dwelling or apartment.

9. Number of dwelling structures on property 1

10. Number of dwelling units in each structure 2

Thomas HAMMER JR
Property owner's name

Thomas Hammer Jr
Property owner's signature (please print)

Please return this application to:

Department of Planning & Zoning
3430 Courthouse Drive
Ellicott City, MD 21043-4350

07 SEP 20 PM 2:27

For Department of Planning & Zoning Use

Application received September 20, 2007 (date)

Zoning District RR (Rural Residential)

Reviewed by At N Lark

Approved By (circle one) date October 2, 2007 Approval contingent upon PEPCO approval of encroachment into conflict tree easement. ANL