

APPLICATION

REPAIR

PERCOLATION TESTING

TO

SUPPORT

FUTURE

ADDITION

A 517427

P REPAIR

HOWARD COUNTY HEALTH DEPARTMENT
BUREAU OF ENVIRONMENTAL HEALTH
3525-H ELLICOTT MILLS DRIVE/ELLICOTT CITY, MARYLAND 21043
TELEPHONE: 313-2640

DISTRICT _____

DATE 8/20/02

TO: THE COUNTY HEALTH OFFICER
ELLICOTT CITY, MARYLAND

I HEREBY APPLY FOR THE NECESSARY TEST PRIOR TO APPLICATION FOR PERMIT TO CONSTRUCT (OR RECONSTRUCT) A SEWAGE DISPOSAL SYSTEM.

PROPERTY OWNER Yuka Manabe

ADDRESS 6195 Lawyers Hill Rd PHONE 410-379-2092

AGENT OR PROSPECTIVE BUYER _____

ADDRESS _____ PHONE _____

PROPERTY LOCATION:

SUBDIVISION _____ LOT NO. _____

ROAD AND DESCRIPTION 6195 Lawyers Hill Rd

TAX MAP 32 PARCEL # 34

SIZE OF LOT .972 TYPE BLDG. Ex. SFD
(SINGLE FAMILY DWELLING OR COMMERCIAL)

THE SYSTEM INSTALLED UNDER THIS APPLICATION IS ACCEPTABLE ONLY UNTIL PUBLIC FACILITIES BECOME AVAILABLE. I FULLY UNDERSTAND THE FEE CONNECTED WITH THE FILING OF THIS PERC TEST APPLICATION IS NON-REFUNDABLE UNDER ANY CIRCUMSTANCES. I ALSO AGREE TO COMPLY WITH ALL M.O.S.H.A. REQUIREMENTS IN TESTING THIS LOT.

(SIGNATURE OF APPLICANT)

APPROVED BY _____ FOR _____ DATE _____

DISAPPROVED BY _____ FOR _____ DATE _____

HOLD PENDING FURTHER TESTS _____

REASONS FOR REJECTION OR HOLDING _____

PERCOLATION TEST PLAT/PRELIMINARY PLAT - TITLE OR I.D. # _____ DATE _____

SITE DEVELOPMENT PLAN/FINAL PLAT - TITLE OR I.D. # _____ DATE _____

THIS IS NOT A PERMIT

COUNTY #

SOIL PROFILE

0' A
 6" dark brn top soil
 yellow-brn silty
 16" org-brn silty
 28" heavy compacted sand & gravel yellow/red-brn
 5' red-brn gravelly loam 5-10% cobbles clumps of parent material have redox features
 13 1/2"

B

6" dark brn top soil
 red-brn sandy loam to loam
 2' hard gravel sandy clay loam
 3' extremely dense loam
 4' grey reduced gleyed layer
 4' 4" clumps of parent material heavy mottled grey-green w/ purple colors redox features
 7'

SOIL PROFILE

0'



INDICATE NORTH - NAME ADJOINING ROADWAY AS BASE LINE.

DATE	TEST NO.	DEPTH	PRE-WET		TEST - 1" DROP		TIME	
			START	STOP	START	STOP		
9/8/02	A	5' T 13 1/2" V	11:32 am	12:32 pm	← peg pulled 1/2" in 1 hr		NA	Fails
		9' 6" T 13 1/2" V	1:00 pm	1:02 pm	1:02 pm	1:07 pm	5 min	OK
	B	(INSUFFICIENT DEPTH TO REDOX FEATURES)					NA	Fails

REMARKS _____
 TYPE OF SOIL Aura Gravelly Loam
 TESTED BY SRK & JB ALSO PRESENT Ricky = Fogles Yalca
 TRENCH DESIGN DATA: AVERAGE PERCOLATION TIME _____ TRENCH WIDTH _____
 INLET DEPTH _____ MAXIMUM BOTTOM DEPTH _____ SQ. FT./BEDROOM _____

MOUND TEST DATA SHEETS

Property I.D. 6195 Lawyer's Hill Lot # _____ Date 11/3/2009
 Sanitarian RB/RB Landscape Position Side Slope
 % Slope 4% Soil Type _____ Contractor _____

HOLE # ~~B~~ Ci DEPTH OF TEST 15" START TIME 11 am

dk brn loam
2 fskb
yel-brn sil
1 fskb
yel-brn gr sil
1 msbk
yel-brn gr sil
fskb
slightly sticky
20-25% gravel & pebbles
yel-red sil
2 msbk
slightly sticky
10-15% gravel
& pebbles

Hook Gauge Reading	Elapsed Time (min)	Measured Drop	Estimated Rate	% Change
9 16/32	Begin	—		
9 21/32	15	5/32		
9 21/32	15	6/32		
9 16/32	15	6/32		
9 12/32	15	4/32		
9 8/32	15	4/32		
9 5/32	15	3/32		
9 2/32	15	3/32		
8 30/32	15	4/32		

Head, 9.5"
 Inside diameter,
 11.75"
 Total
 2 hrs.

10:48, Begin equilibration

HOLE # Di DEPTH OF TEST 12" START TIME 12:25

dk brn loam
2 fskb
yel-brn gr sil
1 fskb
yel-brn gr sil
slightly sticky
1 msbk
10% gravel
brn cl
2 fskb
brn cl
10% gravel

Hook Gauge Reading	Elapsed Time (min)	Measured Drop	Estimated Rate	% Change
9 16/32	Begin	—		
9 26/32	15	6/32		
9 20/32	15	6/32		
9 14/32	15	6/32		
9 10/32	15	4/32		
9 2/32	30	8/32		
8 30/32	15	4/32		

Head, 6"
 Inside diameter,
 11.75"
 1 1/16"
 1 1/4 hr

12:02, Begin equilibration

280
196.0
1.7

1.8
32.50
130
128
380

30.11
10:57
11:05
32
11
12:08

COUNTY #

SOIL PROFILE

0' A

6" dark brn top soil

16" yellow-brn silty clay

28" org-brn silty clay

5' heavy, compacted sand & gravel yellow/red-brn

13'6" red-brn gravelly loam 5-10% cobbles clumps of parent material have redox features

SOIL PROFILE

0'

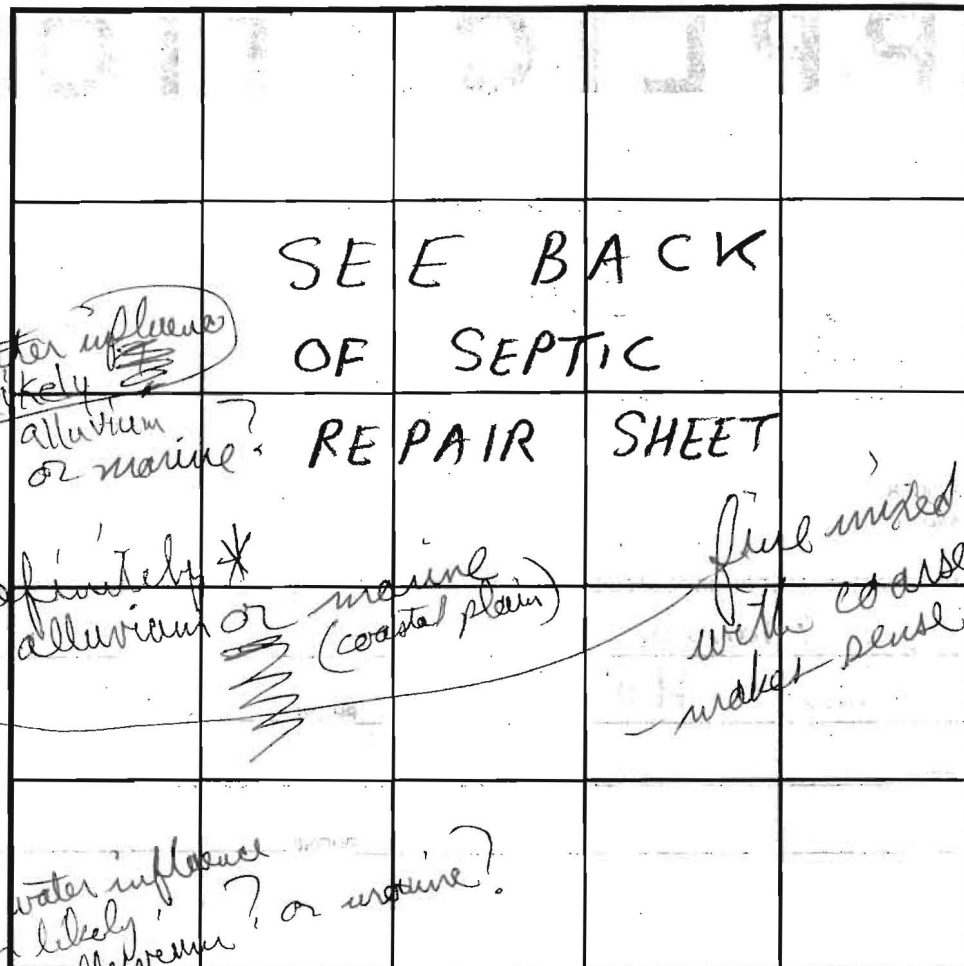

texture? fine over coarse?

B

6" dark brn top soil

2' red-brn sandy loam to 1m

3' hard gravel sandy clay 1m

4' extremely dense 1m

4'6" grey reduced & gleyed layer

clumps of parent material heavy mottled grey-green w/ purple colors redox features

what's below?

INDICATE NORTH - NAME ADJOINING ROADWAY AS BASE LINE.

DATE	TEST NO.	DEPTH	PRE-WET		TEST - 1" DROP		TIME		
			START	STOP	START	STOP			
9/8/02	A	5' T 13'6" V	11:32am	12:32pm	peg pulled 1/2" in 1hr	NA	NA	Fails	
		9'6" T 13'6" V	1:00pm	1:02pm	1:02pm	1:07pm	5min	OK	
	B	(INSUFFICIENT DEPTH TO REDOX FEATURES)						NA	Fails

marine (Coastal Plain)
Alluvial Soils

REMARKS Now Sassafras and Croom

TYPE OF SOIL Aura Gravelly Loam

TESTED BY SRK & JB ALSO PRESENT Richy = Fogles Yuka

TRENCH DESIGN DATA: AVERAGE PERCOLATION TIME _____ TRENCH WIDTH _____

INLET DEPTH _____ MAXIMUM BOTTOM DEPTH _____ SQ. FT./BEDROOM _____



APPLICATION

FOR PERCOLATION TESTING AND SITE EVALUATION

TEST DATE(S) _____ TEST TIME _____ A/P _____

AGENCY REVIEW: _____ DATE _____

DO NOT WRITE ABOVE THIS LINE

I HEREBY APPLY FOR THE NECESSARY TESTING/EVALUATION PRIOR TO ISSUANCE OF SEWAGE DISPOSAL SYSTEM PERMIT(S) TO:

CHECK AS NEEDED:

- CONSTRUCT NEW SEPTIC SYSTEM(S)
- REPAIR/ADD TO AN EXISTING SEPTIC SYSTEM
- REPLACE AN EXISTING SEPTIC SYSTEM

CHECK AS NEEDED:

- NEW STRUCTURE(S)
- ADDITION TO AN EXISTING STRUCTURE
- REPLACE AN EXISTING STRUCTURE

CHECK ONE:

- CREATE NEW LOT(S)
- BUILD ON AN EXISTING LOT IN A SUBDIVISION
- BUILD ON AN EXISTING PARCEL OF RECORD

IS THE PROPERTY WITHIN 2500' OF ANY RESERVOIR?

- YES
- NO

THE TYPE OF STRUCTURE IS:

- RESIDENTIAL WITH _____ PROPOSED BEDROOMS IN THE COMPLETED STRUCTURE (NOTE **UNKNOWN** IF APPROPRIATE)
- COMMERCIAL (PROVIDE DETAIL OF NUMBERS AND TYPES OF EMPLOYEES/ CUSTOMERS ON ACCOMPANYING PLAN)
- INSTITUTIONAL/GOVERNMENT (PROVIDE DETAIL OF NUMBERS AND TYPES OF EMPLOYEES/USERS ON ACCOMPANYING PLAN)

PROPERTY OWNER(S) _____

DAYTIME PHONE _____ CELL _____ FAX _____

MAILING ADDRESS _____
STREET CITY/TOWN STATE ZIP

APPLICANT _____

DAYTIME PHONE _____ CELL _____ FAX _____

MAILING ADDRESS _____
STREET CITY/TOWN STATE ZIP

APPLICANT'S ROLE: DEVELOPER BUILDER BUYER RELATIVE/FRIEND REALTOR CONSULTANT

PROPERTY LOCATION
SUBDIVISION/PROPERTY NAME _____ LOT NO. _____

PROPERTY ADDRESS _____
STREET TOWN/POST OFFICE

FAX MAP PAGE(S) _____ GRID _____ PARCEL(S) _____ PROPOSED LOT SIZE _____

AS APPLICANT, I UNDERSTAND THE FOLLOWING: THE SYSTEM INSTALLED SUBSEQUENT TO THIS APPLICATION IS ACCEPTABLE ONLY UNTIL PUBLIC SEWERAGE IS AVAILABLE. THIS APPLICATION IS COMPLETE WHEN ALL APPLICABLE FEES AND A SUITABLE SITE PLAN HAVE BEEN RECEIVED. I ACCEPT THE RESPONSIBILITY FOR COMPLIANCE WITH ALL M.O.S.H.A. AND "MISS UTILITY" REQUIREMENTS. APPROVAL IS BASED UPON SATISFACTORY REVIEW OF A PERC CERTIFICATION PLAN. TEST RESULTS WILL BE MAILED TO APPLICANT.

SIGNATURE OF APPLICANT _____

HOWARD COUNTY HEALTH DEPARTMENT, BUREAU OF ENVIRONMENTAL HEALTH, WELL AND SEPTIC PROGRAM
 7178 COLUMBIA GATEWAY DRIVE COLUMBIA, MARYLAND 21046 (410) 313-1771 FAX (410) 313-2648
 TDD (410) 313-2323 TOLL FREE 1-877-4MD-DHMH

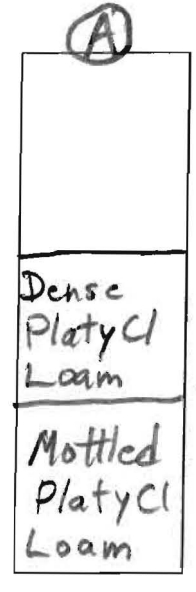
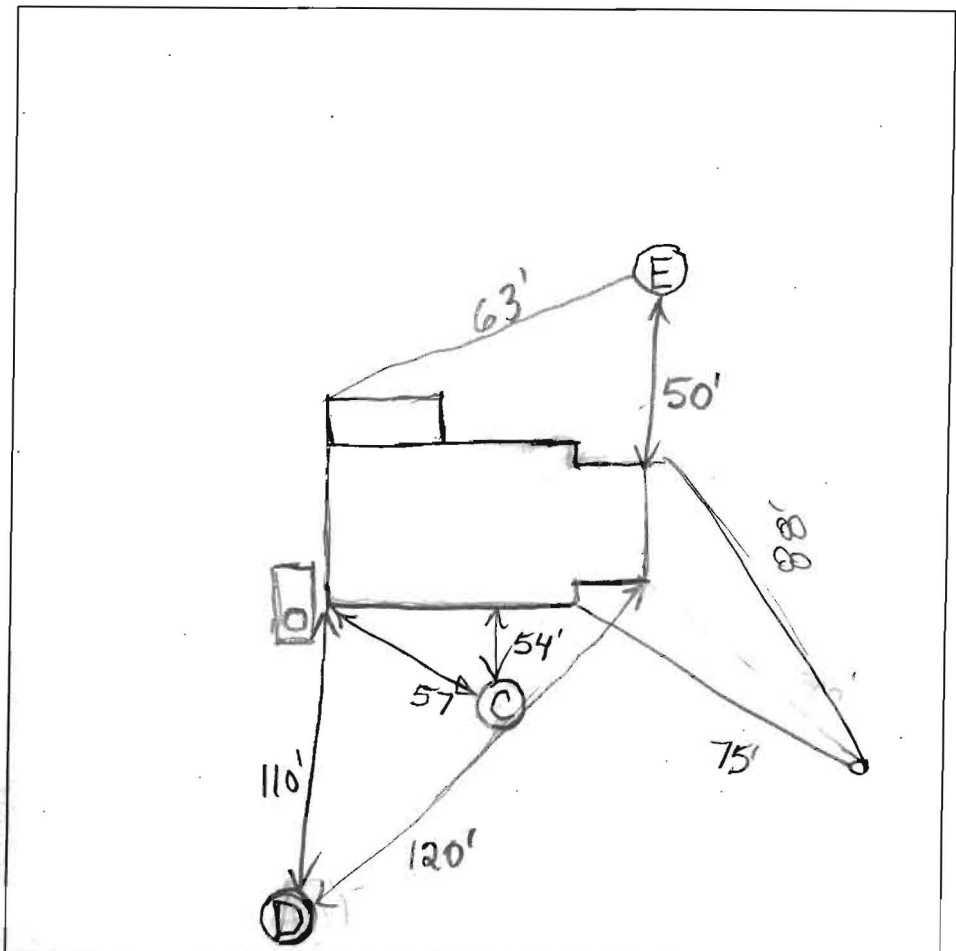
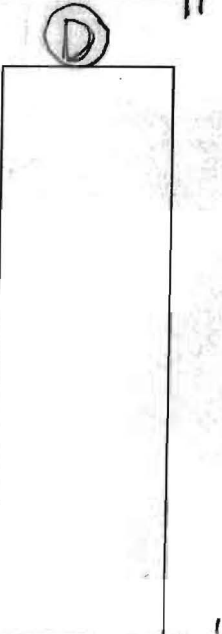
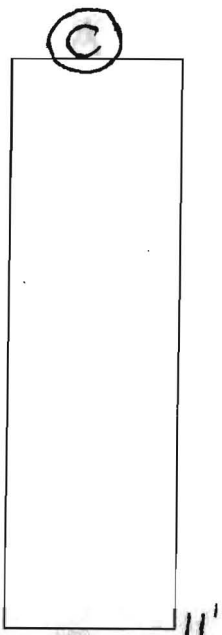

Lawyers Hill Road

DATE	TEST #	DEPTH	START	BREAK 1" DROP	STOP 2" DROP	TIME OF 2ND INCH	P/F/H
11/2/09	A	25"/11"	10:57	11:05	11:29	24	
	D	31"/8.5'	12:08				
	E	15"/7'	1:33	2:03	1/8" - 3/16"	in 30	

dk grey loam
 2" - 4"
 brn varsl
 1" sbk
 To many mica
 11" - 15"
 } Fill
 dk brn loam 1" sbk
 1" - 11"
 brn sel, sticky
 yel-red sel - yel red sl; dm
 slightly sticky
 5.7'
 lt grey & pale brn
 cl 2 mpl to 1 pl
 50% 2.5Y 7/1
 30% 10YR 7/4
 20% 7.5YR 6/8
 f 1d 5YR 4/8

REMARKS: _____

SANITARIAN _____ BACKHOE _____ OTHERS _____

TEST HOLES USED IN SDA _____ AVG. PERC TIME _____ SQ. FT/BR _____

TRENCH WIDTH _____ INLET DEPTH _____ MAX. BOT DEPTH _____ EFFECTIVE SW _____

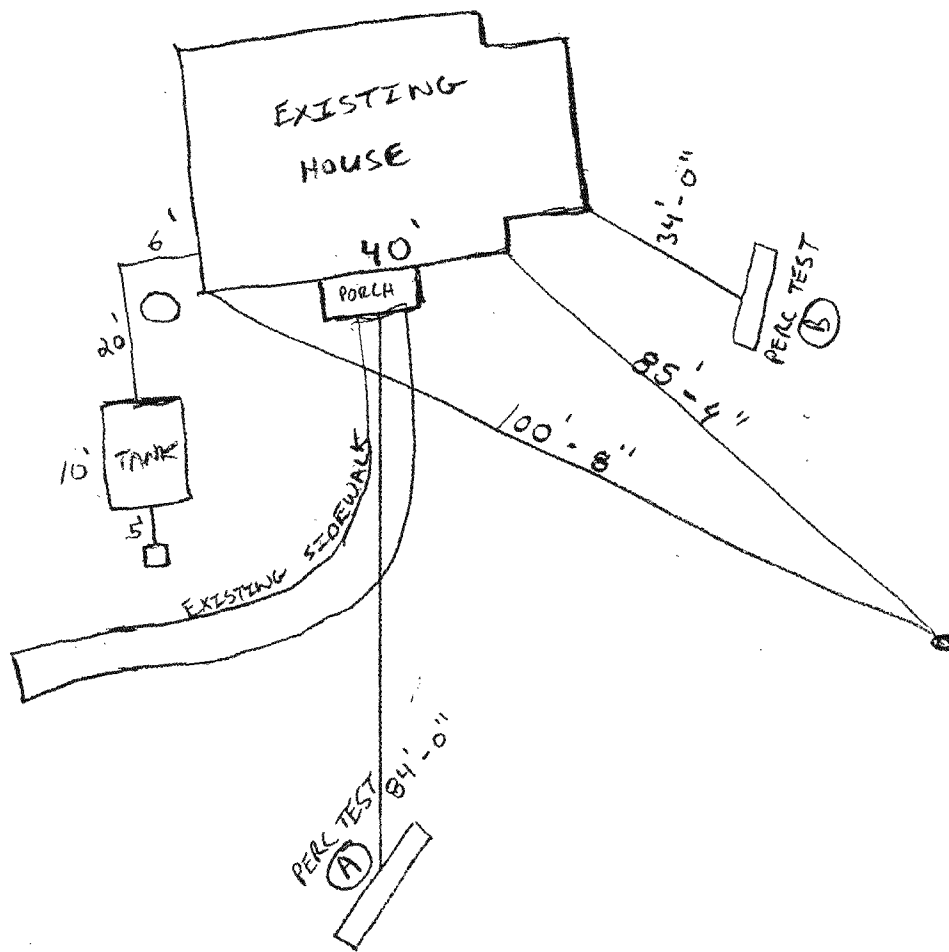

STONE 122.8 CY
190.4 TONS

135.1
202.7