

9/3/02 10:00

PUB. SEWER STATUS VERIFIED BY MLB

ISSUE DATE: 8/20/2002

P 517427

APPROVAL DATE: \_\_\_\_\_

A REPAIR

# PERMIT INDEXED

## ON-SITE SEWAGE DISPOSAL SYSTEM HOWARD COUNTY HEALTH DEPARTMENT BUREAU OF ENVIRONMENTAL HEALTH

01-181718

Yuka Manabe IS PERMITTED TO INSTALL  ALTER

ADDRESS: 6195 Lawyers Hill, Elkridge PHONE NUMBER: 410-379-2092  
*page # → 410 283-4452*

SUBDIVISION: \_\_\_\_\_ LOT NUMBER: \_\_\_\_\_

ADDRESS: 6195 Lawyers Hill PROPERTY OWNER: Yuka Manabe

SEPTIC TANK CAPACITY (GALLONS): 1250

PUMP CHAMBER CAPACITY (GALLONS): NA

NUMBER OF BEDROOMS: 4 (3 existing + 1 proposed)

SQUARE FEET PER BEDROOM: 180

LINEAR FEET OF TRENCH REQUIRED: 200' (3- 67' trenches)

TRENCHES:	Trench to be 3 feet wide. Inlet 4 feet below original grade. Bottom maximum depth $9\frac{1}{2}$ feet below original grade. Effective area begins at $8\frac{1}{2}$ feet below original grade. $5\frac{1}{2}$ feet of stone below distribution pipe.
LOCATION:	Old Tank & Dry well to be properly abandoned. New Tank to be located 10' from proposed addition.
PURPOSE:	In support of future building additions.

PLANS APPROVED: Steven R. Krieg & John Boris DATE: 8/19/2002

- NOTE: PERMIT VOID AFTER 2 YEARS
- NOTE: CONTRACTOR RESPONSIBLE FOR SCHEDULING A PRE-CONSTRUCTION INSPECTION FOR ALL INSTALLATIONS
- NOTE: WATERTIGHT SEPTIC TANKS REQUIRED
- NOTE: ALL PARTS OF SEPTIC SYSTEM SHALL BE 100 FEET FROM ANY WATER WELL
- NOTE: MANHOLE RISERS REQUIRED ON ALL SEPTIC TANKS AND PUMP CHAMBERS

**NEITHER THE HOWARD COUNTY COUNCIL NOR THE HEALTH DEPARTMENT IS RESPONSIBLE FOR THE SUCCESSFUL OPERATION OF ANY SYSTEM PERMITTEE RESPONSIBLE FOR OBTAINING FINAL APPROVAL ON THIS PERMIT CALL 410-313-2640 FOR INSPECTION OF SEPTIC SYSTEM**

PS117427

NOT TO SCALE

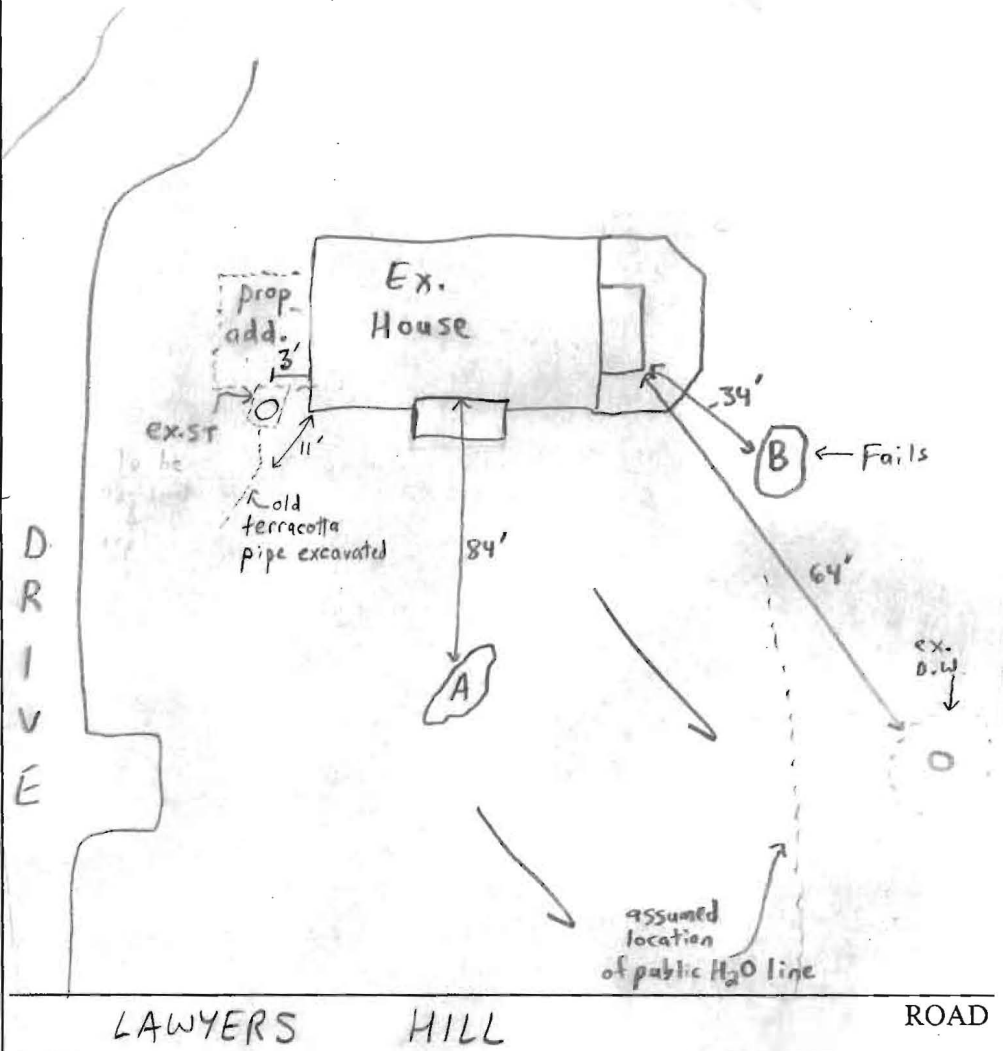

**TRENCH/DRAINFIELD DATA**

WIDTH	INLET	BOTTOM
_____	_____	_____
NUMBER OF TRENCHES _____		
TOTAL LENGTH _____		
ABSORPTION AREA _____		
DISTRIBUTION BOX LEVEL _____		
DISTRIBUTION BOX BAFFLE _____		
DISTRIBUTION BOX PORT _____		

**SEPTIC TANK DATA**

SEPTIC TANK 1 LEVEL \_\_\_\_\_

CAPACITY \_\_\_\_\_ GAL

SEAM LOC \_\_\_\_\_

TANK LID DEPTH \_\_\_\_\_

BAFFLES \_\_\_\_\_

BAFFLE FILTER \_\_\_\_\_

MANHOLE LOC \_\_\_\_\_

6" PORT LOC \_\_\_\_\_

WATERTIGHT TEST \_\_\_\_\_

SEPTIC TANK 2 LEVEL \_\_\_\_\_

CAPACITY \_\_\_\_\_ GAL

SEAM LOC \_\_\_\_\_

TANK LID DEPTH \_\_\_\_\_

BAFFLES \_\_\_\_\_

BAFFLE FILTER \_\_\_\_\_

MANHOLE LOC \_\_\_\_\_

6" PORT LOC \_\_\_\_\_

WATERTIGHT TEST \_\_\_\_\_

PRE-CONSTRUCTION 9/3/02 - EXCAVATED PERC HOLES IN LOCATION (A) & (B) SEE PERC NOTES, INSTALL SYSTEM IN FRONT YARD PER SPECS, OLD S.T. & DRYWELL TO BE PROPERLY ABANDONED, OPEN TRENCH INSP. REQUIRED PRIOR TO PLACING STONE IN TRENCHES - (SRK/JS)

10/7/03 - NO WORK DONE AS OF THIS DATE  
INDEX FILE - (SRK)

FINAL INSPECTOR \_\_\_\_\_ DATE OF APPROVAL \_\_\_\_\_