

# APPLICATION

PERCOLATION TESTING

A 518598-D

P \_\_\_\_\_

HOWARD COUNTY HEALTH DEPARTMENT  
BUREAU OF ENVIRONMENTAL HEALTH  
3525-H ELLICOTT MILLS DRIVE/ELLICOTT CITY, MARYLAND 21043  
TELEPHONE: 313-2840

DISTRICT \_\_\_\_\_

DATE \_\_\_\_\_

TO: THE COUNTY HEALTH OFFICER  
ELLICOTT CITY, MARYLAND

I HEREBY APPLY FOR THE NECESSARY TEST PRIOR TO APPLICATION FOR PERMIT TO CONSTRUCT (OR RECONSTRUCT) A SEWAGE DISPOSAL SYSTEM.

PROPERTY OWNER Richard H Conrey

ADDRESS 1575 Marriottsville Rd Marriottsville PHONE 410-781-7270 w-410-461-5008

AGENT OR PROSPECTIVE BUYER N/A

ADDRESS \_\_\_\_\_ PHONE \_\_\_\_\_

PROPERTY LOCATION:

SUBDIVISION Conrey Farm LOT NO. The Stone House

ROAD AND DESCRIPTION Eastside of Marriottsville Road 2000' North of RT 99

TAX MAP 10 PARCEL # 34

SIZE OF LOT \_\_\_\_\_ TYPE BLDG. existing single family  
(SINGLE FAMILY DWELLING OR COMMERCIAL)

THE SYSTEM INSTALLED UNDER THIS APPLICATION IS ACCEPTABLE ONLY UNTIL PUBLIC FACILITIES BECOME AVAILABLE. I FULLY UNDERSTAND THE

FEE CONNECTED WITH THE FILING OF THIS PERC TEST APPLICATION IS NON-REFUNDABLE UNDER ANY CIRCUMSTANCES. I ALSO AGREE TO

COMPLY WITH ALL M.O.S.H.A. REQUIREMENTS IN TESTING THIS LOT. X Richard H Conrey  
(SIGNATURE OF APPLICANT)

APPROVED BY \_\_\_\_\_ FOR \_\_\_\_\_ DATE \_\_\_\_\_

DISAPPROVED BY \_\_\_\_\_ FOR \_\_\_\_\_ DATE \_\_\_\_\_

HOLD PENDING FURTHER TESTS \_\_\_\_\_

REASONS FOR REJECTION OR HOLDING \_\_\_\_\_

PERCOLATION TEST PLAT/PRELIMINARY PLAT - TITLE OR I.D. # \_\_\_\_\_ DATE \_\_\_\_\_

SITE DEVELOPMENT PLAN/FINAL PLAT - TITLE OR I.D. # \_\_\_\_\_ DATE \_\_\_\_\_

## THIS IS NOT A PERMIT

COUNTY #

SOIL PROFILE

0' 14  
 2  
 5" brn hvysalm  
 tan  
 sand  
 10% Rx  
 10 1/2

N 17 S

2  
 5' 9"  
 8  
 brn orange hvysalm  
 tan sand  
 10-15% Rx  
 15% Rx

15A/16A

2  
 9  
 brn orange hvysalm  
 tan sand  
 10-20% frags  
 NOT HARD

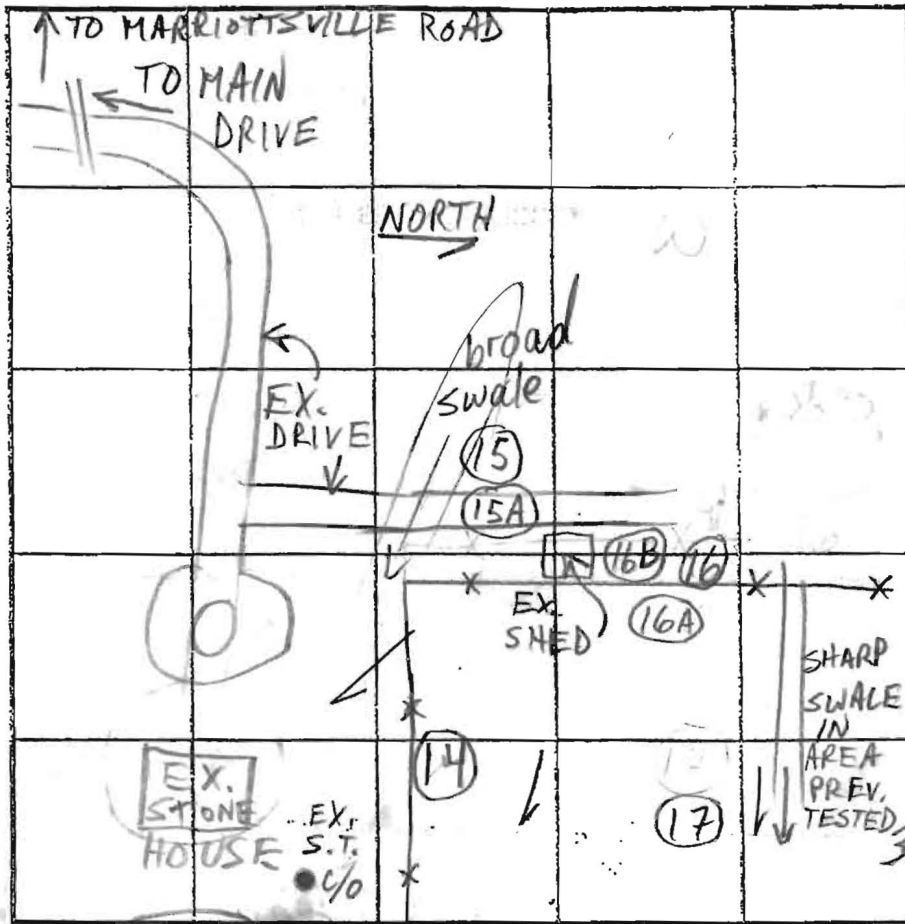

INDICATE NORTH - NAME ADJOINING ROADWAY AS BASE LINE.

SOIL PROFILE

0' 16B  
 3  
 5  
 9  
 WEST 40-50% Rx  
 20-30% Rx  
 EAST

N 16 S  
 9  
 brn orange hvysalm  
 brn tan sand  
 30-40% Rx | 40-60% Rx

DATE	TEST NO.	DEPTH	PRE-WET		TEST - 1" DROP		TIME
			START	STOP	START	STOP	
6/3/03	14 v	10 1/2	OK				
	17 v	8	OK	ON SOUTH SIDE ONLY			
	16A v	9	OK				
	16 v	9	EXCESS ROCK				F
	16B v	9	OK ON SOUTH & EAST ONLY				
	15 v	3	Rx	REFUSAL			F
	15A v	9	OK				

REMARKS AREA FOR 10K LIMITED

TYPE OF SOIL \_\_\_\_\_

TESTED BY M. Riskin - ALSO PRESENT Covey, owner

TRENCH DESIGN DATA: AVERAGE PERCOLATION TIME \_\_\_\_\_ TRENCH WIDTH \_\_\_\_\_

INLET DEPTH \_\_\_\_\_ MAXIMUM BOTTOM DEPTH \_\_\_\_\_ SQ. FT./BEDROOM \_\_\_\_\_

# APPLICATION

PERCOLATION TESTING

A 512653

P \_\_\_\_\_

HOWARD COUNTY HEALTH DEPARTMENT  
BUREAU OF ENVIRONMENTAL HEALTH  
3525-H ELLICOTT MILLS DRIVE/ELLICOTT CITY, MARYLAND 21043  
TELEPHONE: 313-2640

DISTRICT \_\_\_\_\_

DATE 8/6/99

TO: THE COUNTY HEALTH OFFICER  
ELLICOTT CITY, MARYLAND

I HEREBY APPLY FOR THE NECESSARY TEST PRIOR TO APPLICATION FOR PERMIT TO CONSTRUCT (OR RECONSTRUCT) A SEWAGE DISPOSAL SYSTEM.

PROPERTY OWNER Richard Conrey

ADDRESS 1575 Marriottsville Rd. PHONE \_\_\_\_\_

AGENT OR PROSPECTIVE BUYER \_\_\_\_\_

ADDRESS \_\_\_\_\_ PHONE \_\_\_\_\_

PROPERTY LOCATION:

SUBDIVISION Pondarosa farm LOT NO. fl. Stone House

ROAD AND DESCRIPTION Marriottsville Road

TAX MAP 10 PARCEL # 34

SIZE OF LOT \_\_\_\_\_ TYPE BLDG. \_\_\_\_\_  
(SINGLE FAMILY DWELLING OR COMMERCIAL)

THE SYSTEM INSTALLED UNDER THIS APPLICATION IS ACCEPTABLE ONLY UNTIL PUBLIC FACILITIES BECOME AVAILABLE. I FULLY UNDERSTAND THE FEE CONNECTED WITH THE FILING OF THIS PERC TEST APPLICATION IS NON-REFUNDABLE UNDER ANY CIRCUMSTANCES. I ALSO AGREE TO COMPLY WITH ALL M.O.S.H.A. REQUIREMENTS IN TESTING THIS LOT.

(SIGNATURE OF APPLICANT)

APPROVED BY \_\_\_\_\_ FOR \_\_\_\_\_ DATE \_\_\_\_\_

DISAPPROVED BY \_\_\_\_\_ FOR \_\_\_\_\_ DATE \_\_\_\_\_

HOLD PENDING FURTHER TESTS \_\_\_\_\_

REASONS FOR REJECTION OR HOLDING \_\_\_\_\_

PERCOLATION TEST PLAT/PRELIMINARY PLAT - TITLE OR I.D. # \_\_\_\_\_ DATE \_\_\_\_\_

SITE DEVELOPMENT PLAN/FINAL PLAT - TITLE OR I.D. # \_\_\_\_\_ DATE \_\_\_\_\_

# THIS IS NOT A PERMIT

COUNTY #

SOIL PROFILE

0' ①  
 1' topsoil  
 org bn  
 cl/m  
 2.5' 2.5'  
 pale or  
 tan  
 si/m  
 11' 25%+  
 hard  
 rock

②

like ①  
 w/  
 30%  
 hard  
 rock

③

0' ③  
 1' topsoil  
 org bn  
 cl/m  
 3.5' 3.5'  
 pale org  
 bn  
 to  
 tan  
 si/m  
 25-30%  
 hard  
 rock

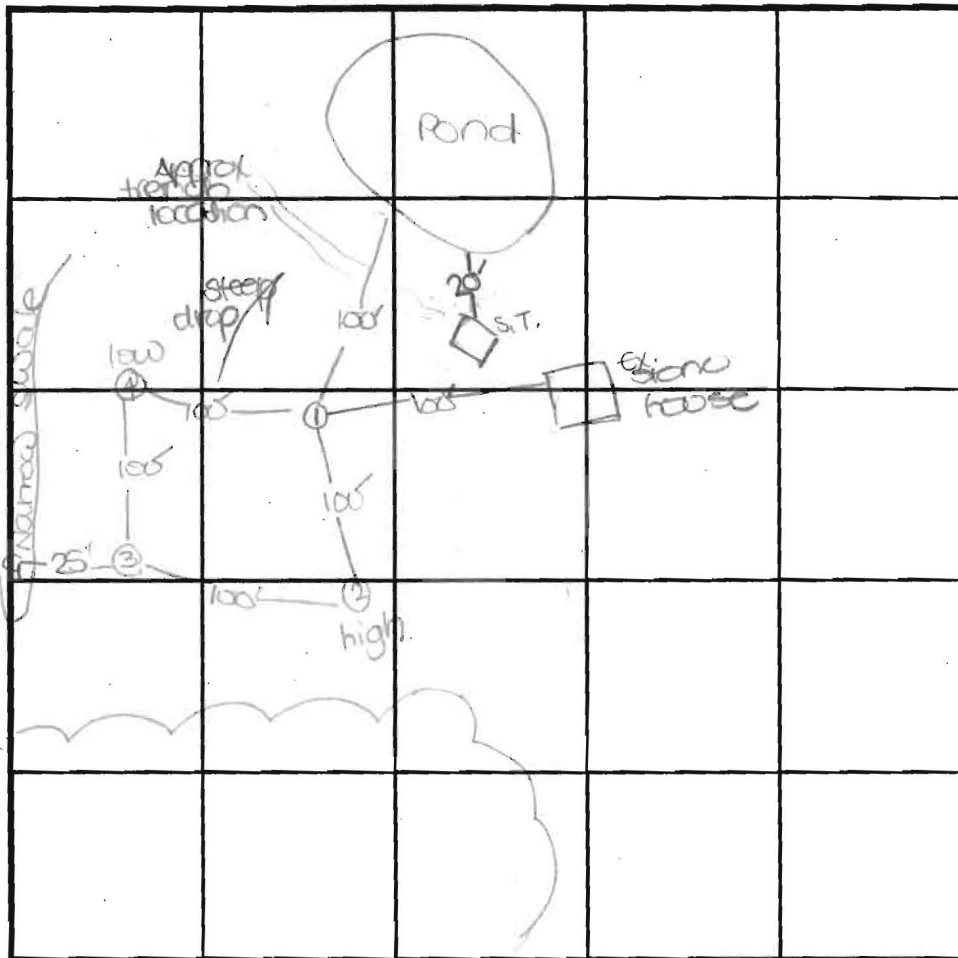

SOIL PROFILE

0' ④  
 1' topsoil  
 org bn  
 cl/m  
 3' 3'  
 pale  
 org tan  
 si/m  
 12' 20%+  
 hard  
 rock

INDICATE NORTH - NAME ADJOINING ROADWAY AS BASE LINE.

Marrichville Road

DATE	TEST NO.	DEPTH	PRE-WET		TEST - 1" DROP		TIME
			START	STOP	START	STOP	
8/30/99	1	2.9'S	11:22	11:25	11:25	11:27.3	3
		11.0'D	visual	- see	profile		OK
	2	2.5'S	11:35	11:36	11:36	11:37.2	2
		12.5'D	visual	- see	profile		OK
	3	13.5'T	visual	- see	profile		OK
	4	12.0'D	visual	- see	profile		OK

REMARKS test holes located in lightly wooded area  
 TYPE OF SOIL house currently served by shared hard disk  
 TESTED BY D. See ALSO PRESENT owner, Mr. Cove  
 TRENCH DESIGN DATA: AVERAGE PERCOLATION TIME 2+ TRENCH WIDTH 3  
 INLET DEPTH 3.0 MAXIMUM BOTTOM DEPTH 5.0 SQ. FT./BEDROOM 180

- DATA TABULATIONS**
1. ZONING DISTRICT: RCDEO
  2. SOILS MAP NO.: 9
  3. NUMBER OF BUILDING SITES: 4
  4. TOTAL AREA OF PLAN: 96.6075AC

SIGNED PC 518598

