

Pa 330
5/18/05



APPLICATION

FOR PERCOLATION TESTING AND SITE EVALUATION

TEST DATE(S) _____ TEST TIME _____

NO 522483

AGENCY REVIEW: _____

DATE 5/18/05

DO NOT WRITE ABOVE THIS LINE

I HEREBY APPLY FOR THE NECESSARY TESTING/EVALUATION PRIOR TO ISSUANCE OF SEWAGE DISPOSAL SYSTEM PERMIT(S) TO:

CHECK AS NEEDED:

- CONSTRUCT NEW SEPTIC SYSTEM(S)
- REPAIR/ADD TO AN EXISTING SEPTIC SYSTEM
- REPLACE AN EXISTING SEPTIC SYSTEM

CHECK AS NEEDED:

- NEW STRUCTURE(S)
- ADDITION TO AN EXISTING STRUCTURE
- REPLACE AN EXISTING STRUCTURE

CHECK ONE:

- CREATE NEW LOT(S)
- BUILD ON AN EXISTING LOT IN A SUBDIVISION
- BUILD ON AN EXISTING PARCEL OF RECORD

IS THE PROPERTY WITHIN 2500' OF ANY RESERVOIR?

- YES
- NO

THE TYPE OF STRUCTURE IS:

- RESIDENTIAL WITH _____ PROPOSED BEDROOMS IN THE COMPLETED STRUCTURE (NOTE UNKNOWN IF APPROPRIATE)
- COMMERCIAL (PROVIDE DETAIL OF NUMBERS AND TYPES OF EMPLOYEES/ CUSTOMERS ON ACCOMPANYING PLAN)
- INSTITUTIONAL/GOVERNMENT (PROVIDE DETAIL OF NUMBERS AND TYPES OF EMPLOYEES/USERS ON ACCOMPANYING PLAN)

PROPERTY OWNER(S) Thompson, Joe

DAYTIME PHONE 410 730-5334 CELL _____ FAX _____

MAILING ADDRESS 4880 Manor Lane Ellicott City MD 21042
STREET CITY/TOWN STATE ZIP

APPLICANT Fyock Septic

DAYTIME PHONE 410-988-9270 CELL 240-882-4025 FAX 410 531-1256

MAILING ADDRESS P.O. Box 89 Gleneta MD 21737
STREET CITY/TOWN STATE ZIP

APPLICANT'S ROLE: DEVELOPER BUILDER BUYER RELATIVE/FRIEND REALTOR CONSULTANT

PROPERTY LOCATION: SUBDIVISION/PROPERTY NAME _____ LOT NO. _____

PROPERTY ADDRESS (Same as above)
STREET TOWN/POST OFFICE

TAX MAP PAGE(S) _____ GRID _____ PARCEL(S) _____ PROPOSED LOT SIZE _____

AS APPLICANT, I UNDERSTAND THE FOLLOWING: THE SYSTEM INSTALLED SUBSEQUENT TO THIS APPLICATION IS ACCEPTABLE ONLY UNTIL PUBLIC SEWERAGE IS AVAILABLE. THIS APPLICATION IS COMPLETE WHEN ALL APPLICABLE FEES AND A SUITABLE SITE PLAN HAVE BEEN RECEIVED. I ACCEPT THE RESPONSIBILITY FOR COMPLIANCE WITH ALL M.O.S.H.A. AND "MISS UTILITY" REQUIREMENTS. APPROVAL IS BASED UPON SATISFACTORY REVIEW OF A PERC CERTIFICATION PLAN.

TEST RESULTS WILL BE MAILED TO APPLICANT. Robert Fyock
SIGNATURE OF APPLICANT

HOWARD COUNTY HEALTH DEPARTMENT, BUREAU OF ENVIRONMENTAL HEALTH, WELL AND SEPTIC PROGRAM
3525-H ELLICOTT MILLS DRIVE, ELLICOTT CITY, MARYLAND 21043-4544 (410) 313-1771 FAX (410) 313-2648
TDD (410) 313-2323 TOLL FREE 1-877-4MD-DHMH

AP _____

Thank
3
Doof

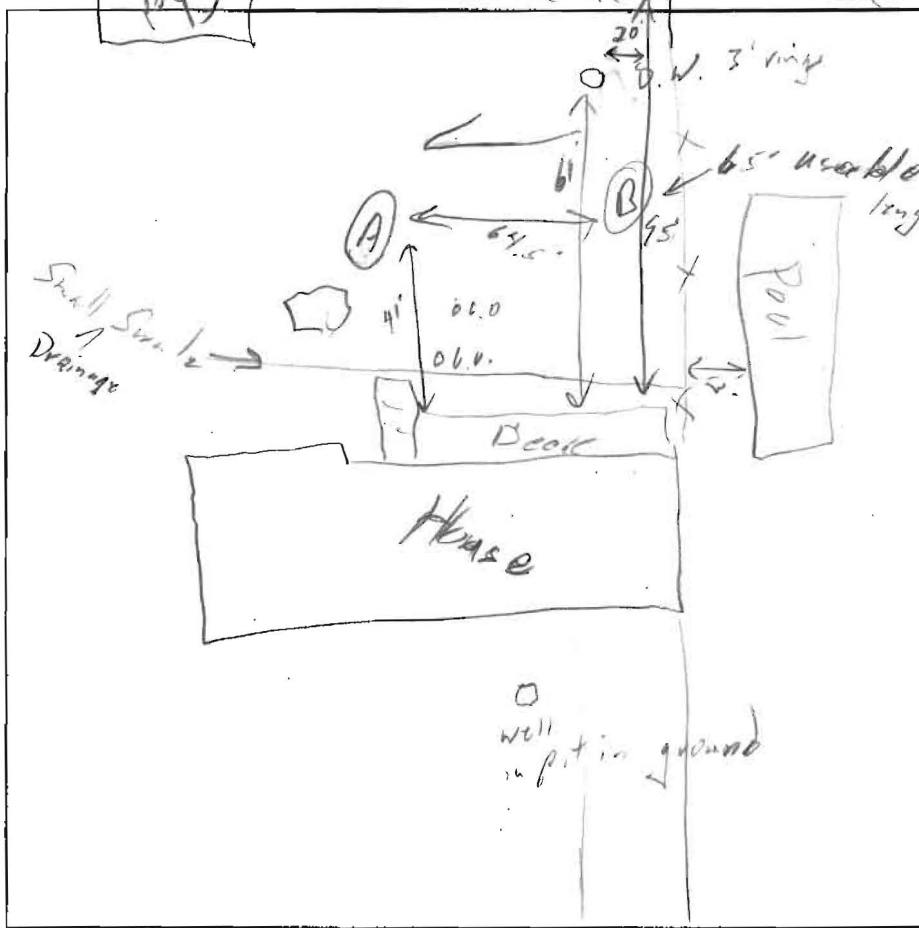

(A)
6" Topsoil
3' Brown Clay Loam
5.6' Pink/Tan Silty Clay Loam
8' Orange gray Silty Loam
13'14' Tan clay-silt Loam
Water

(B)
6" Topsoil
4' Orange clay Silty Loam
8' Orange tan clay Loam
13' Tan Loam
14' Water

DATE	TEST #	DEPTH	START	BREAK 1" DROP	STOP 2" DROP	TIME OF 2nd INCH	PF/H
5/26/05	A	4.5 / 15'	11:30	12:00	No	more	meat
		5.5	12:06	12:31			F
	B	6' / 14'	12:38	12:44	12:57	13	P

REMARKS _____

SANITARIAN SD BACKHOE Rent, Bill OTHERS _____

TEST HOLES USED IN SDA _____ AVG. PERC TIME 13 SQ. FT/BR 210

TRENCH WIDTH 3 INLET DEPTH 5 MAX. BOT DEPTH 9 EFFECTIVE SAW _____

3br - 88' (50 + 30')

4br - 118

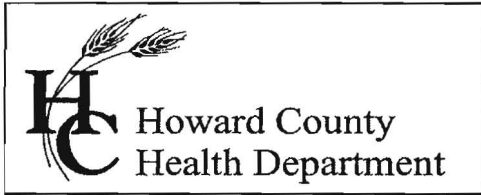

Bureau of Environmental Health
7178 Columbia Gateway Drive, Columbia MD 21046
(410) 313-2640 Fax (410) 313-2648
TDD (410) 313-2323 Toll Free 1-866-313-6300
website: www.hchealth.org

Peter L. Beilenson, M.D., M.P.H., Health Officer

December 10, 2007

Mr. Bharath Korthgere
4880 Manor Lane
Ellicott City, MD 21042

RE: **Variance request**
4880 Manor Lane
Ellicott City, MD 21042

Dear Mr. Bharath:

The Health Department received your letter dated November 22, 2007 requesting a variance to waive the Percolation Certification Plan required for the construction of a detached garage. The *Howard County Code Subtitle 8, Section 3.805* requires a Perc Certification Plan for the construction of a garage. The plan is required to determine if there is adequate area available for on site sewage disposal repair in the future. Due to the size of the property, the failing perc test hole observed on May 25, 2005, and the potential loss of useable area based on the proposed garage your request has been denied.

In order to move forward with the project perc testing must be performed to demonstrate that there is adequate area for future on-site sewage disposal. Once the testing has been performed the Perc Certification Plan must be submitted to illustrate the sewage disposal area.

Any questions regarding this decision may be directed to the Well and Septic Program of the Howard County Health Department.

Respectfully,

Michael J. Davjs, R.S.
Well and Septic Program Manager

c: File