

MARYLAND DEPARTMENT OF THE ENVIRONMENT, WATER MANAGEMENT ADMINISTRATION
2500 BROENING HIGHWAY, BALTIMORE, MARYLAND 21224, (410) 631-3784

WATER WELL ABANDONMENT-SEALING REPORT FORM

SUBMIT COPIES OF COMPLETED FORM TO:

- * COUNTY ENVIRONMENT AGENCY (contact MDE, WMA if address needed)
- * WELL OWNER
- * MDE, WATER MANAGEMENT ADMINISTRATION, WELL PROGRAM

DATE WELL ABANDONED: 9-7-06 (month/day/year)

* PERMIT NUMBER OF ABANDONED WELL (if any) none

* PERMIT NUMBER OF REPLACEMENT WELL Ho - 95 - 0252

* PERSON ABANDONING WELL: Joseph Mayne WELL DRILLERS LICENSE NUMBER: MSD.024
* OWNER'S NAME: Kenneth Daly CIRCLE: MWD/MSD/MGD

* WELL LOCATION:
COUNTY: Howard
NEAREST TOWN: Lusby
TAX MAP 20 BLOCK 3 PARCEL 37
SUBDIVISION: Daly Property
SECTION: _____ LOT: 2
NEAREST ROAD: 3224 Jones Rd Woodbine
21797

SITE LOCATION MAP

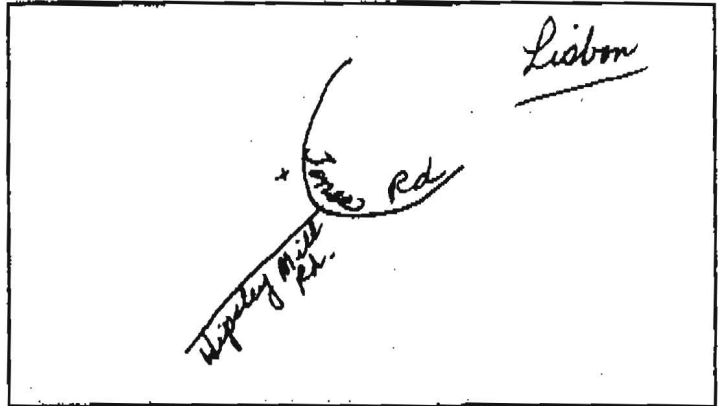

* TYPE OF WELL BEING ABANDONED:
 DRILLED JETTED
 BORED/AUGERED HAND DUG
 OTHER (specify) _____

* USE CODE:
 DOMESTIC MUNICIPAL/PUBLIC
 IRRIGATION INDUSTRIAL
 TEST/OBSERVATION GEOTHERMAL

* TYPE OF CASING:
 STEEL PLASTIC
 CONCRETE OTHER (specify) _____

* SIZE OF CASING: 5-8 INCHES IN DIAMETER

* DEPTH OF WELL: 85 FEET DEEP

* WAS ANY CASING REMOVED? YES NO
if yes, length removed, in feet: _____

* WAS CASING RIPPED OR PERFORATED? YES NO

LOG OF SEALING MATERIAL

MATERIAL	FEET	
	FROM	TO
Cement + gravel mixed	0	85
VOLUME OF MATERIAL USED		

SIGNATURE-MASTER WELL DRILLER OR SUPERVISING SANITARIAN Joseph L Mayne LICENSE # MSD 024 CIRCLE ONE MWD/MSD/MGD DATE 9-7-06

11/9/05 Called Mrs. Barbara Floyd - notified her that existing well does not protect water resource, is in a pit, level with bottom of pit, in house. Needs to drill new well and abandon old prior to recordation of plat. Pre. cert. plat needs to be modified to reflect same. RM

SITE INSPECTION SHEET

OWNER: Daly / Floyd (Annandale Farms) PHONE #: _____
 ADDRESS: 3274 Jones Rd CONTRACTOR: _____
 WELL TAG #: N/A
 SUBDIVISION: Daly / Floyd LOT: _____ COUNTY #: P 516925
 PROPOSAL: _____

LOCATION DIAGRAM

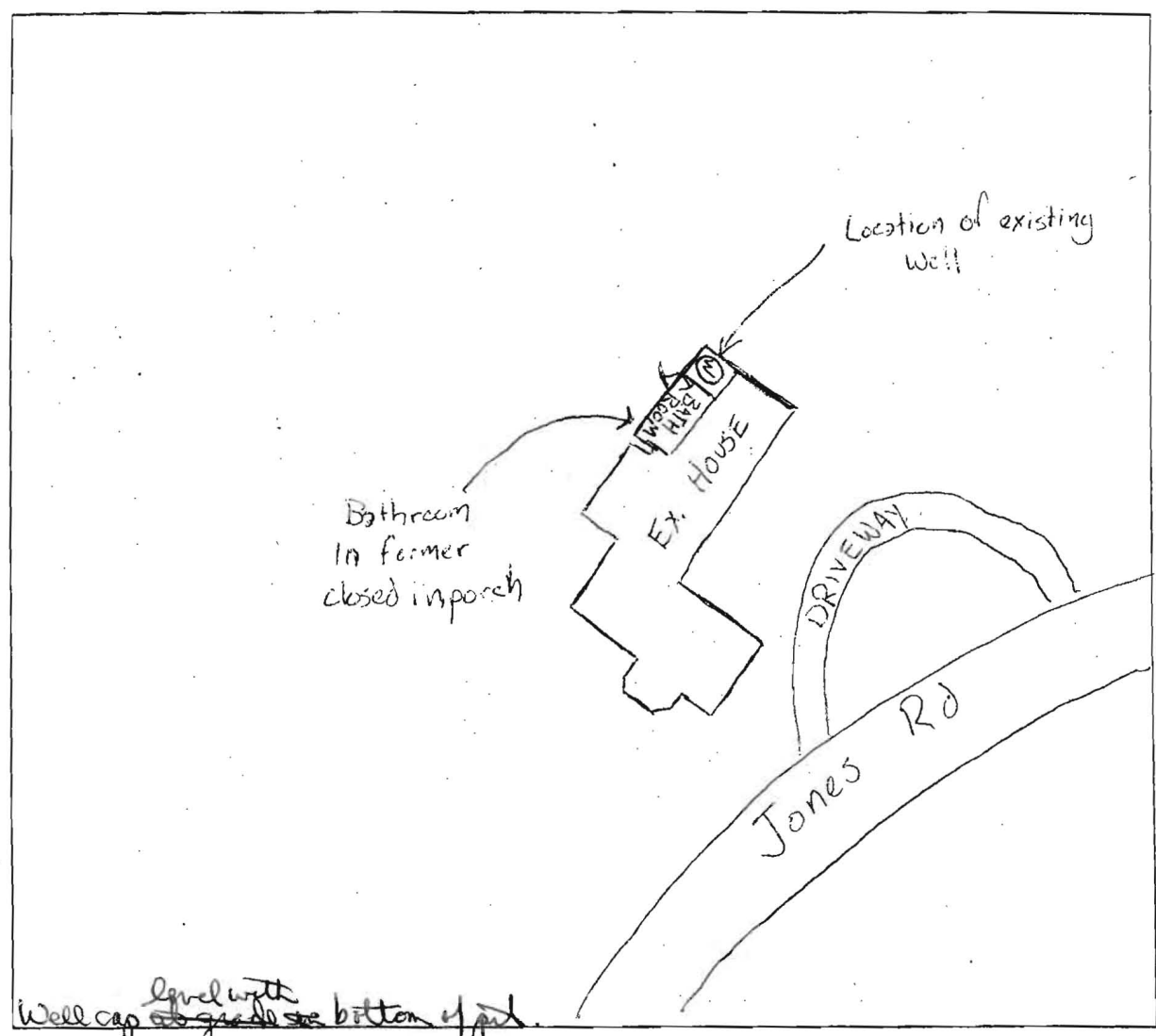

COMMENTS: Well appears to be using a Jet pump (2 hoses)
and is a drilled well 6" in diameter with pumping equipment in a closed
pit ~3 feet deep. Well distance from Main House structure is ~5'
Well is in a closet of a bathroom addition of a former closed in porch.
 DATE: 11/8/05 INSPECTOR: G Creighton