

Bureau of Environmental Health
7178 Columbia Gateway Drive, Columbia, MD 21046-2147
(410) 313-2640 Fax (410) 313-2648
TDD (410) 313-2323 Toll Free 1-866-313-6300
website: www.hchealth.org

Peter L. Beilenson, M.D., M.P.H., Health Officer

December 29th, 2008

Joan Pontius & Filip Braeckman
4879 Manor Lane
Ellicott City, MD 21042

Re: **PERCOLATION TEST RESULTS**
#A530248
4823 (Lot 1) & 4879 (Lot 2)
Manor Lane

Dear Ms. Pontius & Mr. Braeckman,

Percolation testing was conducted at the above referenced property on December 23rd, 2008. Results indicate satisfactory soil conditions for onsite wastewater disposal and adequate septic reserve to support the existing homes on each lot. Limiting factors included dense, clayey soils consisting of less permeable soil material in the upper horizons however. A total of 11 test holes were dug, all passed. Field data collected is shown on the Percolation Test Worksheets enclosed with this letter. Acceptable ranges for recommended inlet and trench bottom depth, and usable sidewall have been provided, and may be confirmed at the time of a future septic installation.

The existing wells currently serving each house are drilled wells below grade and are accessible from inside each house. The construction and location does not meet current county and state regulation. As discussed onsite the condition and use of the wells will be evaluated during review of the Percolation Certification Plan.

Further review of this project is contingent upon submission of a Percolation Certification Plan by a registered surveyor/engineer. If you have any questions regarding this evaluation or requirements for the Percolation Certification Plan, please contact me at (410) 313-6287.

Sincerely,

Heidi Scott
Well & Septic Program
Development Coordination Section

HS
Enclosures
Cc:
Zac Fisch (FSH Assoc. sent via fax)
File

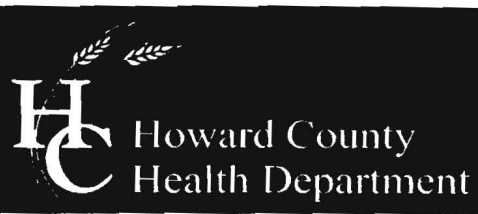

Bureau of Environmental Health
7178 Columbia Gateway Drive, Columbia, MD 21046-2147
(410) 313-2640 Fax (410) 313-2648
TDD (410) 313-2323 Toll Free 1-866-313-6300
website: www.hchealth.org

Peter L. Beilenson, M.D., M.P.H., Health Officer

December 29th, 2008

James T. Truby & Verity A.J. Weston-Truby
4823 Manor Lane
Ellicott City, MD 21042

Re: **PERCOLATION TEST RESULTS**
#A530248
4823 (Lot 1) & 4879 (Lot 2)
Manor Lane

Dear Mr. & Ms. Truby,

Percolation testing was conducted at the above referenced property on December 23rd, 2008. Results indicate satisfactory soil conditions for onsite wastewater disposal and adequate septic reserve to support the existing homes on each lot. Limiting factors included dense, clayey soils consisting of less permeable soil material in the upper horizons however. A total of 11 test holes were dug, all passed. Field data collected is shown on the Percolation Test Worksheets enclosed with this letter. Acceptable ranges for recommended inlet and trench bottom depth, and usable sidewall have been provided, and may be confirmed at the time of a future septic installation.

The existing wells currently serving each house are drilled wells below grade and are accessible from inside each house. The construction and location does not meet current county and state regulation. As discussed onsite the condition and use of the wells will be evaluated during review of the Percolation Certification Plan.

Further review of this project is contingent upon submission of a Percolation Certification Plan by a registered surveyor/engineer. If you have any questions regarding this evaluation or requirements for the Percolation Certification Plan, please contact me at (410) 313-6287.

Sincerely,

A handwritten signature in black ink, appearing to read 'Heidi Scott', written over a horizontal line.

Heidi Scott
Well & Septic Program
Development Coordination Section

HS
Enclosures
Cc:
Zac Fisch (FSH Assoc. sent via fax)
File

AP 530248

Manor Lane

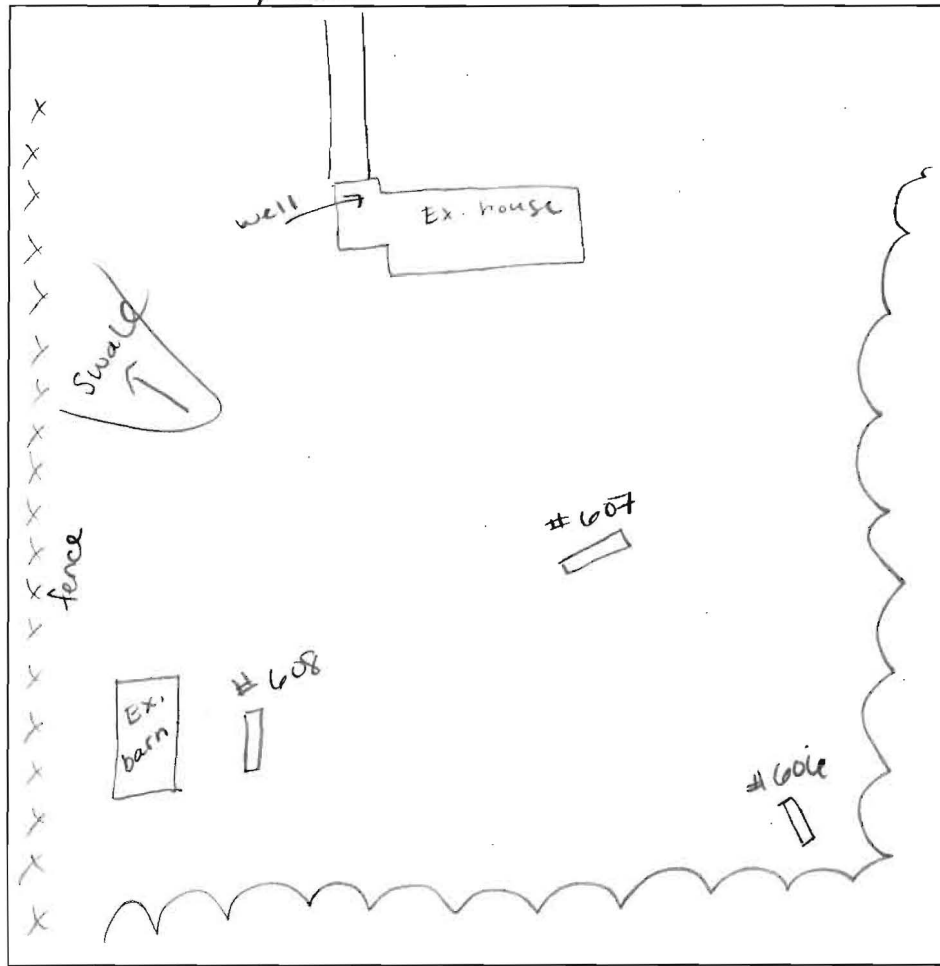

607
 1' brn l sbk
 red brn silt micaceous 2csbk
 4' reddish brn sl micaceous 20% chert dense
 dk brn fs l
 6.5' dk brn fs l saponite
 12'

608
 1' dk brn l sbk
 red lorgy brn gr s l 2csbk
 3.5' red brn micaceous sl
 7' yellowish white ls saponite
 ↓
 20% weakly cemented
 12.5'

606
 1' brn l sbk
 red brn s l 30% chert
 4.5' red brn sl many mica
 ↓
 yellowish white ls saponite (same as 608) 10% quartz chert
 12' Mn coatings

611
 1' brn l sbk
 org yellow brn s l mist s l 2csbk
 2' yellow brn gr s l 20% coarse chert
 5.5' yellowish white ls saponite many mica 10% boulders 30% chert
 12'

609
 1' brn l sbk
 red brn s l 3csbk
 3' brn fs l many mica 25% coarse chert
 6' ch brn sl saponite many mica
 11.8'

612
 8' brn l sbk
 red brn s l sticky
 4' yellow brn fs l many mica 15% chert
 ↓
 brn fs l micaceous saponite Mn coatings
 12'

DATE	TEST #	DEPTH	START	BREAK 1" DROP	STOP 2" DROP	TIME OF 2ND INCH	P/F/H
12/23/08	607	6' 1/2'	9:06	too slow	-	-	
	607	7' 1/2'	9:59	10:18	10:34	16	P
	608	5.5' 1/2'	9:14	9:19	9:28	9	P
	606	12'	visual				P
	609	4' 1/11.8'	9:36	too slow	-	-	
	609	5' 1/11.8'	9:48	10:03	10:10	7	P
	611	4' 1/12'	9:32	9:34	9:36	2	P
	612	5' 1/12'	10:14	10:20	10:27	7	P

#610 not dug (dug between 609 + 610)
 REMARKS Soils moist from heavy rains #607 - EA @ 7'
 SANITARIAN HS BACKHOE Fogles OTHERS Jake, Frank, Jose
 TEST HOLES USED IN SDA 5 AVG. PERC TIME 9.6 SQ. FT/BR
 TRENCH WIDTH 2' INLET DEPTH 4' MAX. BOT DEPTH 8' EFFECTIVE SW 3'

PERCOLATION TEST HOLE ELEVATION CHART	
Number	Elevation
601	472.55
602	466.56
603	470.32
604	472.21
605	462.19
606	462.19
607	464.04
608	464.17
609	461.72
610	461.72
611	461.72
612	459.24

APPROVED FOR PRIVATE WATER AND PRIVATE SEWERAGE SYSTEMS IN ACCORDANCE WITH THE MASTER PLAN OF HOWARD COUNTY

Verity A. J. Weston-Truby
 COUNTY HEALTH OFFICER
 HOWARD COUNTY HEALTH DEPARTMENT

3/19/2009
 DATE

PROFESSIONAL CERTIFICATION

I hereby certify that these documents were prepared or approved by me, and that I am a duly licensed professional License No. #22418, Expiration Date: 07/24/09.

SYMBOL	NAME / DESCRIPTION	SOIL GROUP
General Iron, 3 to 8 percent slopes		B
General Iron, 3 to 8 percent slopes		B
General silt loam, 3 to 8 percent slopes		B
General silt loam, 3 to 8 percent slopes		B
Minor Iron, 8 to 15 percent slopes		B

OWNER

T. JAMES TRUBY & VERITY A. J. WESTON-TRUBY
 9175 Guildford Road, Suite 214
 Columbia, MD 21046
 410.742.4447

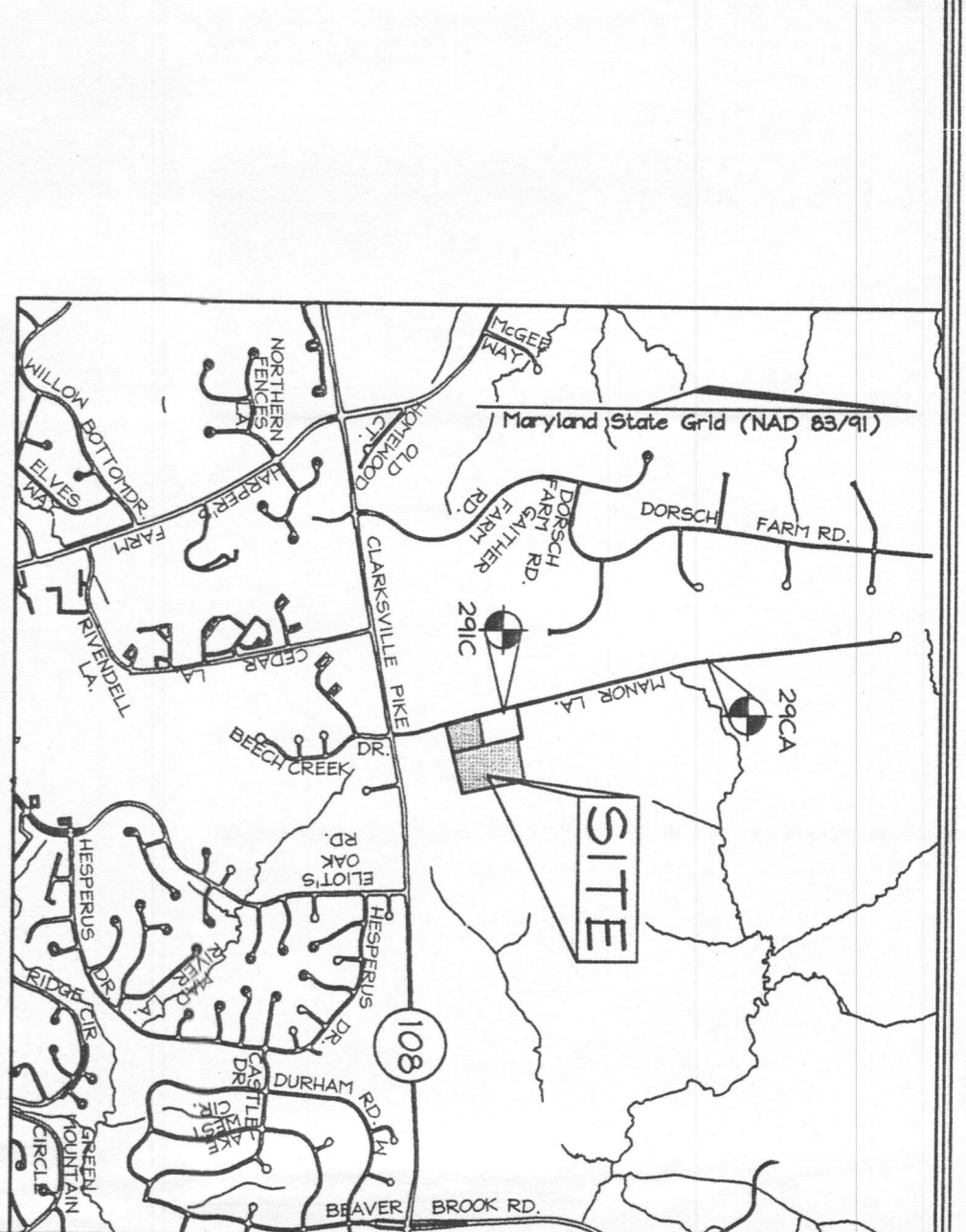

SCALE: 1"=200'

HOWARD COUNTY ADC MAP 14, GRID D2

514.291C N 57.2 57.25 (feet) E 1,344.112 250.6 (feet) NAD83, E1468.066 (feet) NAVD88
 514.291C N 57.4 528.150 (feet) E 1,348.533 74 (feet) NAD83, E1422.828 (feet) NAVD88

LEGEND

Existing Contour: --- 472 --- 470 ---

Existing Spot Elevation: 380.3

Existing Trees to Remain: [Symbol]

Soil Boundary: GDB, MDC, 606

Proposed Septic Easement: [Symbol]

Existing Well: [Symbol]

GENERAL NOTES

- The subject property is zoned RC-DEO per the 02/02/04 Comprehensive Zoning Plan and per the Camp Lide Zoning Amendments effective on 07/28/06.
- Private water percolation test holes shall be installed within this site.
- This area designates a private septic system. A minimum of 10,000 SF of disposal (COTRAC 26.04.03). Improvements of any nature in this area are restricted until public sewerage is available. These encumbrances shall become null and void upon authority to grant adjustment by the County Health Officer shall have the modified sewage easement shall not be necessary. Recordation of a modified sewage easement shall not be necessary.
- All wells and septic fields within 100' of property's boundary have been shown.
- Topography for Percolation Test Holes certified by a Professional Surveyor/Engineer.
- Parcel 10: 4879 Manor Lane
 06/23/94 - Present: Joan Pentus and Philip Brackman
 03/31/94 - Present: L.4637 F. 560
 05/13/50 - 06/23/94: Elizabeth E. Kirkham and Eric M. G. Kirkham L. 217 F. 18
- Parcel 11 Lot 2: 4823 Manor Lane
 04/28/2008 - Present: T. James Truby & Verity A. J. Weston-Truby L11205 F. 224
 10/07/50 - 04/28/2008: William C. Stevens and Joanne P. Stevens Parcel 11: 07/23/50
- The lots shown herein comply with the minimum 10' setback, width and lot area as required by the Howard County Department of the Environment.
- References: F-85-45.
- All wells to be drilled prior to submittal of record plot for signature. It is the developer's responsibility to schedule the well drilling prior to final plot submission. It will not be considered 'government delay' if the well drilling holds up the Health Department signature of the record plot.
- The soils shown on this plan are derived from the Soil Survey Geographic (SSURGO) Database for Maryland, published by the National Resources Conservation Service, Department of Agriculture, Natural Resources Conservation Service.
- All existing structures and site improvements to remain unless otherwise noted.
- Septic fields are located on soil types GDB, MDC as per the soil survey of Howard County.
- All Percolation Test Holes have been field located by FSH Associates.
- Certification of a private sewage easement shall require a Revised Percolation Extension of existing well casings above existing grade on Lots 1 and 2 is required to be performed prior to signature of original record plot.

PERCOLATION CERTIFICATION PLAN

STPB SUBDIVISION

4823 & 4879 MANOR LANE

A-530248

PARCELS 10 & 11
 TAX MAP 29 GRID 11
 2ND ELECTION DISTRICT

HOWARD COUNTY, MARYLAND

FSH Associates

Engineers Planners Surveyors

3333 Howard Lane, Edmonds, MD 21075
 Tel: 410.561.5200 Fax: 410.746.1822
 E-mail: info@fsh.com

DESIGN BY: ZTF
 DRAWN BY: CED
 CHECKED BY: ZTF
 SCALE: 1" = 50'
 DATE: May 11, 2009
 M.C. No.: 9553
 SHEET No.: 1 OF 1

