

ISSUE DATE: 9/18/2001

PERMIT

P. 516032

APPROVAL DATE: 9/25/01

A. REPAIR

ON-SITE SEWAGE DISPOSAL SYSTEM HOWARD COUNTY HEALTH DEPARTMENT BUREAU OF ENVIRONMENTAL HEALTH

05-393000

INDEXED

Covey Construction Company, Inc _____ IS PERMITTED TO INSTALL ALTER

ADDRESS: P.O. Box 254, Woodstock 21163 PHONE NUMBER: 410-750-0398

SUBDIVISION: Dunfretten Estates LOT NUMBER: 19

ADDRESS: 13618 Meadow Glenn PROPERTY OWNER: Gary Gabel

SEPTIC TANK CAPACITY (GALLONS): existing 1250 midream

PUMP CHAMBER CAPACITY (GALLONS): N/A

NUMBER OF BEDROOMS: ex 4 bedroom

SQUARE FEET PER BEDROOM: 210

LINEAR FEET OF TRENCH REQUIRED: 144'± (2-72' trenches)

BLDG PERM
10/31/2001
B00133033
INGROUND BOLD W/ FENCE
6304 B00148684-IG POOL

TRENCHES:	Trench to be <u>3</u> feet wide. Inlet <u>9</u> feet below original grade. Bottom maximum depth <u>6</u> feet below original grade. Effective area begins at <u>4</u> feet below original grade. <u>2</u> feet of stone below distribution pipe.
LOCATION:	
PURPOSE:	Call for inspection when ground is opened so sanitarian can recommend repair. TO DISCONNECT & REPL. 2 EXISTING TRENCHES & MAKE UP SDA LOST W/ POOL INSTALLATION

PLANS APPROVED: Steven R. Krieg DATE: 9/19/01

- NOTE: PERMIT VOID AFTER 2 YEARS
- NOTE: CONTRACTOR RESPONSIBLE FOR SCHEDULING A PRE-CONSTRUCTION INSPECTION FOR ALL INSTALLATIONS
- NOTE: WATERTIGHT SEPTIC TANKS REQUIRED
- NOTE: ALL PARTS OF SEPTIC SYSTEM SHALL BE 100 FEET FROM ANY WATER WELL
- NOTE: MANHOLE RISERS REQUIRED ON ALL SEPTIC TANKS AND PUMP CHAMBERS

NEITHER THE HOWARD COUNTY COUNCIL NOR THE HEALTH DEPARTMENT IS RESPONSIBLE FOR THE SUCCESSFUL OPERATION OF ANY SYSTEM PERMITTEE RESPONSIBLE FOR OBTAINING FINAL APPROVAL ON THIS PERMIT CALL 410-313-2640 FOR INSPECTION OF SEPTIC SYSTEM

BUILDING PERMIT SIGNED AND RETURNED 4-10-02
B00135399- ADD STAIRS TO DECK

P516032

NOT TO SCALE

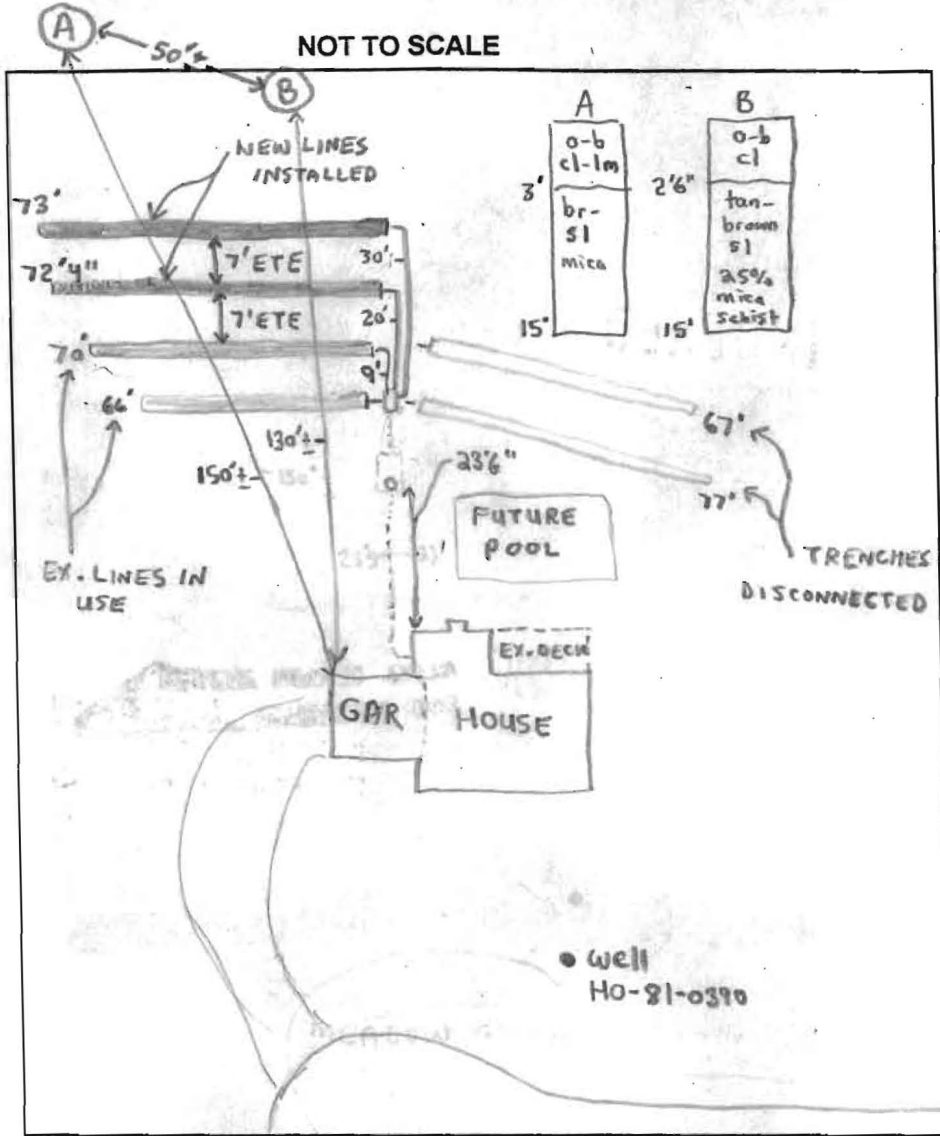

TRENCH DATA

TRENCH WIDTH 3'
 TRENCH INLET DEPTH 4'
 TRENCH BOTTOM DEPTH 6'
 DEPTH OF STONE 2'
 NUMBER OF TRENCHES 4
 TOTAL TRENCH LENGTH 281'
 ABSORBENT AREA 843 ft²
 DISTRIBUTION BOX LEVEL
 BAFFLE IN DISTRIBUTION BOX

SEPTIC TANK DATA

SEPTIC TANK EX 1250TS GALLONS
 MANHOLE RISER NA
 6 INCH INSPECTION PORT on front

PUMP CHAMBER DATA

PUMP CHAMBER GALLONS NA
 MANHOLE RISER NA
 ALARM NA
 PUMP PERFORMANCE TEST NA

PRE-CONSTRUCTION INSPECTION: 9/24/01-DISCONNECT 2-TRENCHES & ADD 2-NEW TRENCHES TO ACCOMMODATE FUTURE POOL, PERC 2-HOLES TO ACCOMMODATE FUTURE REPAIRS, SEE HOLES

INSPECTION COMMENTS: (A) & (B) & REVISED SDA MODIFICATION - (SRK)
9/25/01 - OK TO COVER ALL WORK - (BB) SRK

INSPECTOR Brian Baker (SRK)

DATE SYSTEM APPROVED 9/25/01
 BUILDING DEPARTMENT
 AND RETURNED

