

4/26/99
2:00
4/27/99
1:00

PERMIT

SEWAGE DISPOSAL SYSTEM

DEPARTMENT OF HEALTH AND MENTAL HYGIENE

P 11539

A 31702

DISTRICT _____

DATE 4/26/99

DATE SYSTEM APPROVED 4/27/99

INSPECTOR S.R.K.

HOWARD COUNTY HEALTH DEPARTMENT

BUREAU OF ENVIRONMENTAL HEALTH

~~461-9933~~ X (410) 313-2640

INDEXED

Covey Construction Co., Inc. IS PERMITTED TO INSTALL ALTER

ADDRESS P.O. Box 254 Woodstock, MD 21163 PHONE (410) 750-0398

SUBDIVISION Dunfretten Estates LOT 19 ROAD 13618 Meadow Glenn

PROPERTY OWNER Nu-Homes, Inc. / GARY & Debra Gabel

ADDRESS _____

SEPTIC TANK CAPACITY 1250 GALLONS

NUMBER OF BEDROOMS 4

210 SQUARE FEET PER BEDROOM

LINEAR FEET OF TRENCH REQUIRED 280

TRENCHES - Trench to be 3 feet wide. Inlet 4 feet below original grade. Bottom maximum depth 6 feet below original grade. Effective area begins at 4 feet below original grade. 2 feet of stone below distribution pipe.

LOCATION - Start the trench 210 feet from the front lot line and 105 feet from the right side of the lot as seen when facing the lot from Meadow Glenn. Run the trenches along contour in both directions.

NOTES - No trench to exceed 100 feet in length. Provide 6" - 8" diameter cleanout and cap to grade or above on septic tank.

PLANS APPROVED BY C. Williams/Donna K. Soe OK-C.L. 3/10/99 REVISED _____ DATE 03-04-1999

COVER NO WORK UNTIL INSPECTED AND APPROVED

NEITHER THE HOWARD COUNTY COUNCIL NOR THE HEALTH DEPARTMENT IS RESPONSIBLE FOR THE SUCCESSFUL OPERATION OF ANY SYSTEM

NOTE: CLEANOUT REQUIRED EVERY 70 FEET OF SEWER LINE AND/OR AT 90° SWEEPS IN LINES FROM HOUSE TO DRAIN FIELDS. 90° ELBOWS NOT ACCEPTABLE.

NOTE: ALL PARTS OF SEPTIC SYSTEMS (I.E. TANK, DISTRIBUTION BOX TRENCHES) TO BE 100 FEET FROM WELL (UNLESS OTHERWISE SPECIFICALLY AUTHORIZED)

NOTE: IF DEEP TRENCH(ES) ARE USED CALL FOR INSPECTION BEFORE AND AFTER PLACING GRAVEL IN TRENCH(ES)

NOTE: NO DRY WELL SHALL EXCEED 15 FOOT IN DIAMETER NO ABSORPTION TRENCH TO EXCEED 100 FEET IN LENGTH

NOTE: ALL PIPE FROM HOUSE TO SEPTIC TANK MUST BE CAST IRON OR SCHEDULE 35/40 PVC OR ABS

PERMIT VOID AFTER TWO YEARS

NOTE: INSTALL STAND PIPE ON SEPTIC TANK AND DRY WELL STAND PIPES MUST BE 6 INCHES IN DIAMETER CAST IRON, CONCRETE OR TERRA COTTA OR PVA OR ABS ACCEPTED. IF TOP OF SEPTIC TANK IS DEEPER THAN 3 FEET, MANHOLE TO GRADE REQUIRED. deck

NOTE: DISTRIBUTION BOXES MUST HAVE BAFFLES

*INSTALLER IS RESPONSIBLE FOR OBTAINING FINAL APPROVAL ON THIS PERMIT

A31732

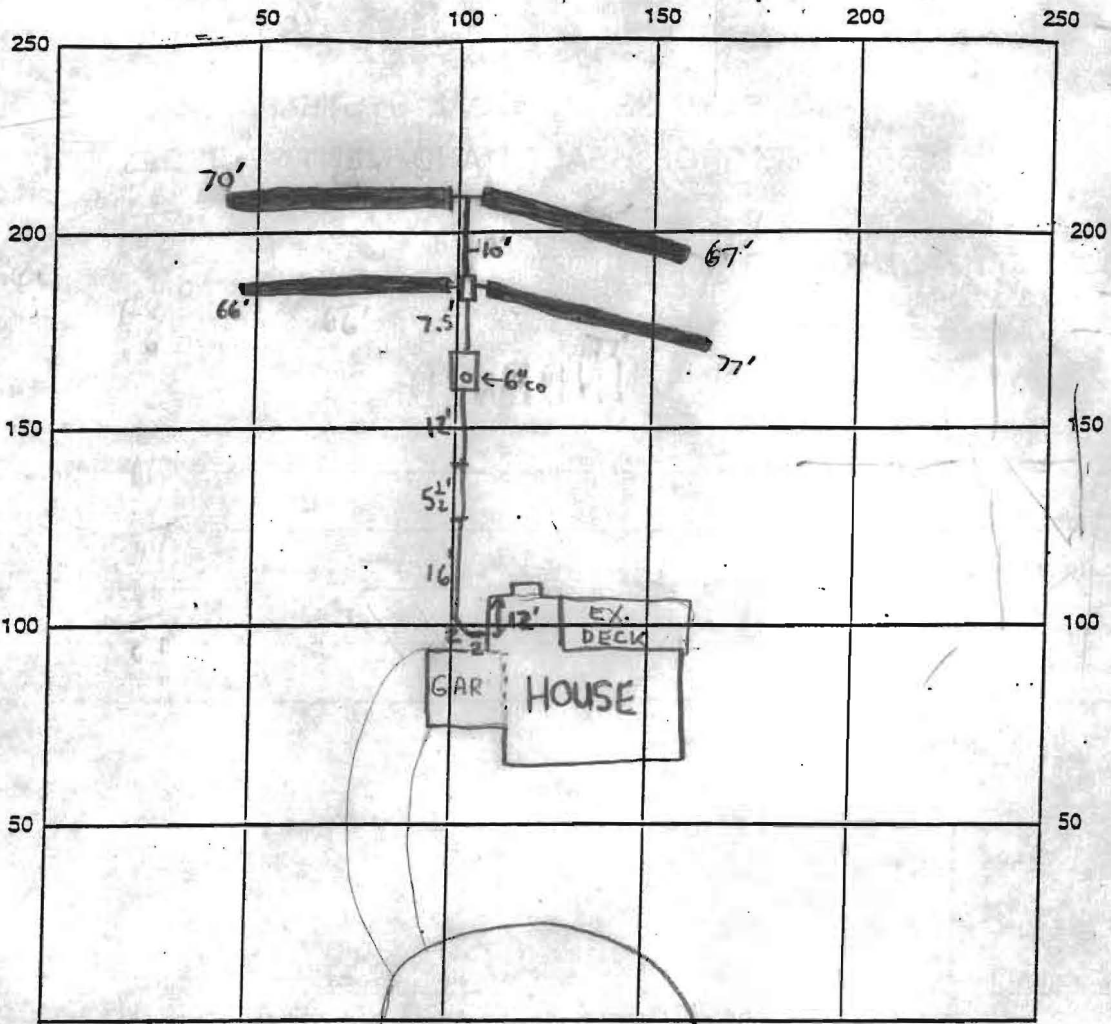

INDICATE NORTH - NAME ADJOINING ROADWAY AS BASE LINE
MEADOW GLENN

SEPTIC TANK LEVEL 1250 midseam CLEANOUTS 1-6" @ tank

DISTRIBUTION BOX LEVEL

DRAIN FIELD/TITLE DEPTH 6 FT. TRENCH WIDTH 3 FT. INLET DEPTH 4 FT.

EFFECTIVE GRAVEL DEPTH 2 FT. TOTAL LENGTH 280 FT.

NUMBER OF TRENCHES 4 ONE-SIDEWALL/BOTTOM AREA 890 SQ. FT.

DRYWALL INSIDE DIAMETER N/A FT. EFFECTIVE DEPTH BELOW INLET N/A FT.

ABSORBENT AREA N/A SQ. FT.

REMARKS: 4/26/99 layout check confirmed - house connection OK.
4/27/99 OK TO COVER ALL WORK - (SRK) DDB

DATE SYSTEM APPROVED 4/27/99 INSPECTOR Steven R. Krieg

GENERAL NOTES

1. TOPO WAS TAKEN FROM PLANS PREPARED BY
2. LENGTH OF TRENCHES TO BE DETERMINED AT TIME OF PERMIT ISSUANCE.
3. DISTURBED AREA: 16,700 S.F.
4. BY COPY OF THIS PLAN THE HO. CO. HEALTH DEPT. ACCEPTS THIS MODIFICATION TO THE RECORDED SEWAGE DISPOSAL EASEMENT.
5. RECORDED PLAT NO. 5403 ON APRIL 15, 1983.

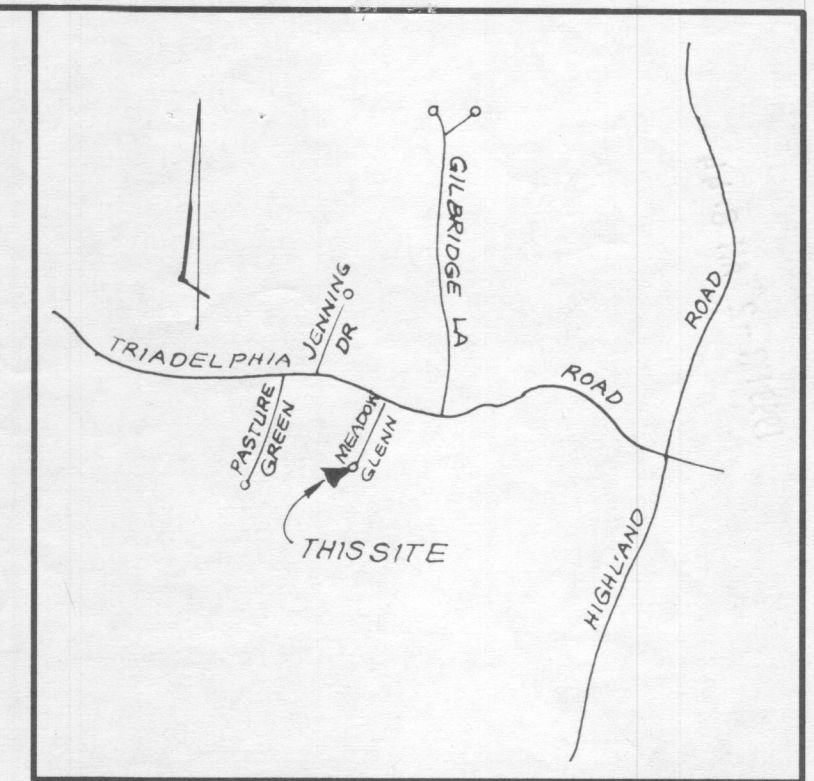

VICINITY MAP
SCALE: 1" = 2000'

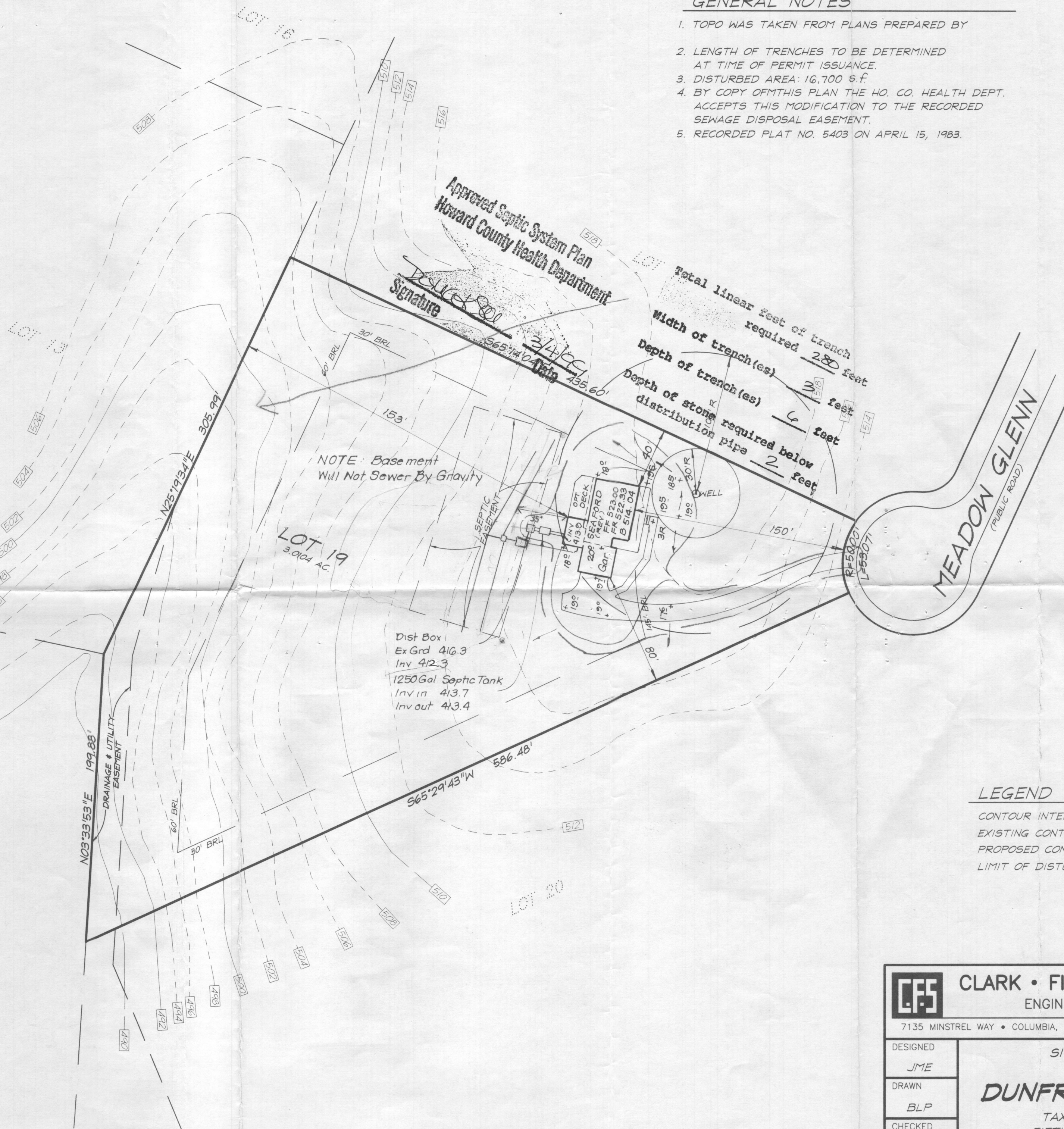

LEGEND

CONTOUR INTERVAL	2 FT.
EXISTING CONTOUR	348
PROPOSED CONTOUR	348
LIMIT OF DISTURBED AREA	

 CLARK • FINEFROCK & SACKETT, INC. ENGINEERS • PLANNERS • SURVEYORS 7135 MINSTREL WAY • COLUMBIA, MD 21045 • (410) 381-7500 BALT. • (301) 621-8100 WASH.		
DESIGNED JME	SITE DEVELOPMENT PLAN LOT 19 DUNFRETTE ESTATES TAX MAP 28 & 34 PARCEL 1 FIFTH (5TH) ELECTION DISTRICT HOWARD COUNTY, MARYLAND	SCALE 1" = 50'
DRAWN BLP		DRAWING 1 of 1
CHECKED JME		JOB NO. 99-029
DATE FEB. 1999		FILE NO. 99-029-X
FOR: NU-HOMES, INC. 10630 Little Patuxent Parkway, Suite 146 Columbia, Maryland 21044		