

LAYOUT 9/1/2009 INSP 4 _____
INSP 2 9/8/2009 INSP 5 _____
INSP 3 9/9/2009 INSP 6 _____

ISSUE DATE: 9/1/2009

PERMIT - Repair

P 531901

APPROVAL DATE: 9/23/09

A Repair

Tax ID # 02210282

ON-SITE SEWAGE DISPOSAL SYSTEM HOWARD COUNTY HEALTH DEPARTMENT BUREAU OF ENVIRONMENTAL HEALTH

Fogler's IS PERMITTED TO INSTALL ALTER

ADDRESS: _____ PHONE NUMBER: 410-795-5670

SUBDIVISION: _____ LOT NUMBER: _____

ADDRESS: 4651 Manor Ln. PROPERTY OWNER: Bill Flanigan

SEPTIC TANK CAPACITY (GALLONS): 1500 OUTLET BAFFLE FILTER REQUIRED

PUMP CHAMBER CAPACITY (GALLONS): 1/2 COMPARTMENTED TANK REQUIRED

NUMBER OF BEDROOMS: 3 APPLICATION RATE: 1.2

SQUARE FOOTAGE OF HOUSE: -3501 3' wide
Inlet @ 2'-3'

LINEAR FEET OF TRENCH REQUIRED: 75 LF Bottom @ 6'

TRENCHES:	Trenches to be feet wide. Inlet feet below original grade. Bottom maximum depth feet below grade. Effective area begins at feet below original grade. Approx. feet of stone below distribution pipe.
LOCATION:	<u>1 x 75</u> trenches will be installed w/ observation pipes at the ends.
NOTES:	Pump and collapse ex. dry well. <u>metal tank.</u>

PLANS APPROVED: Kevin Wolf DATE: 9/1/2009

- NOTE: PERMIT VOID AFTER 2 YEARS
- NOTE: CONTRACTOR RESPONSIBLE FOR SCHEDULING A PRE-CONSTRUCTION INSPECTION FOR ALL INSTALLATIONS
- NOTE: WATERTIGHT SEPTIC TANKS REQUIRED
- NOTE: ALL PARTS OF SEPTIC SYSTEM SHALL BE 100 FEET FROM ANY WATER WELL
- NOTE: MANHOLE RISERS REQUIRED ON ALL SEPTIC TANKS AND PUMP CHAMBERS

NEITHER THE HOWARD COUNTY COUNCIL OR THE HEALTH DEPARTMENT IS RESPONSIBLE FOR THE SUCCESSFUL OPERATION OF ANY SYSTEM PERMITTEE RESPONSIBLE FOR OBTAINING FINAL APPROVAL ON THIS PERMIT CALL 410-313-1771 FOR INSPECTION OF SEPTIC SYSTEM

NOT TO SCALE

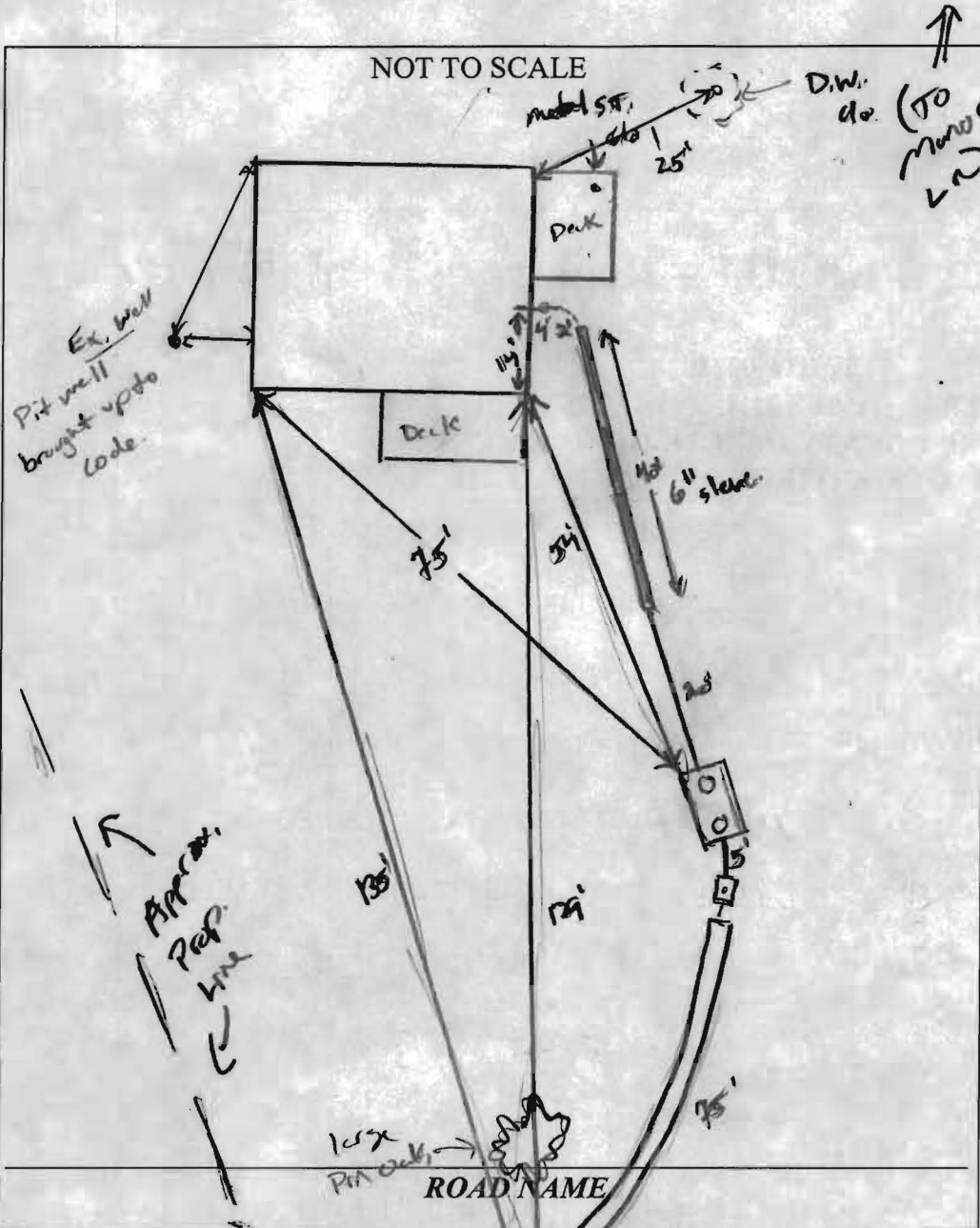

TRENCH/DRAINFIELD DATA		
WIDTH	INLET	BOTTOM
3'	2'	6'
NUMBER OF TRENCHES	1	
TOTAL LENGTH	75	
ABSORPTION AREA	225'±SW	
DISTRIBUTION BOX LEVEL	Yes	
DISTRIBUTION BOX BAFFLE	Yes	
DISTRIBUTION BOX PORT	Yes	

SEPTIC TANK DATA	
SEPTIC TANK 1 LEVEL	Yes
MANUFACTURER	Kubler
CAPACITY	500 GAL
SEAM LOC	Top
TANK LID DEPTH	1'
BAFFLES	Yes
BAFFLE FILTER	
MANHOLE LOC	Front/Rear
6" PORT LOC	None
WATERTIGHT TEST	
SLOTTED	Yes
DATE ON LID	7/19/09
PUMP/SEPTIC TANK LEVEL	
MANUFACTURER	
CAPACITY	
SEAM LOC	
TANK LID DEPTH	
BAFFLES	
BAFFLE FILTER	
MANHOLE LOC	
6" PORT LOC	
WATERTIGHT TEST	
SLOTTED	
DATE ON LID	

PRE-CONSTRUCTION:

9/1/09 Keep new tank out at 100' well radius. Graded shot in field should be able to maintain 3' inlet into trench. Install 12" trench on contour. Call for trap (K)

INSTALLATION: 9/8/09 Contractor had 4" SMC installed up to tank location. 6" sleeve ~40' near house

9/9/09 System installed per installation spec's. Homeowner is to hook up plumbing inside house. Need confirmation that old metal tank and D.W. is pumped & collapsed. Ex. pit well needs to be grouted up for floor (K) 9/23/09 Well and old septic taken care of & verified via phone conversation w/ contractor (K)

FINAL INSPECTOR K. Wolf DATE OF APPROVAL 9/23/09