

APPLICATION

PERCOLATION TESTING

A 42206
P _____

HOWARD COUNTY HEALTH DEPARTMENT
BUREAU OF ENVIRONMENTAL HEALTH
P.O. BOX 476 ELLICOTT CITY, MARYLAND 21043
TELEPHONE 461-9933

DISTRICT Third

DATE Feb. 26, 1988

TO: THE COUNTY HEALTH OFFICER
ELLICOTT CITY, MARYLAND

I, HEREBY, APPLY FOR THE NECESSARY TEST IN ORDER TO CONSTRUCT (OR RECONSTRUCT) A SEWAGE DISPOSAL SYSTEM.

PROPERTY OWNER William W. Aitcheson

ADDRESS 12706 Folly Quarter Rd, Clarksville, Md, 21029 PHONE 301 596 9208

PROSPECTIVE BUYER _____

ADDRESS _____ PHONE _____

PROPERTY LOCATION:

SUBDIVISION Aitcheson Property "Second Discovery" LOT NO. 16

ROAD AND DESCRIPTION West side of Court 'A'

TAX MAP 22 B1k23 PARCEL # 45

SIZE OF LOT 4.17 acres TYPE BLDG Single Family Dwg
(SINGLE FAMILY DWELLING OR COMMERCIAL)

THE SYSTEM INSTALLED UNDER THIS APPLICATION IS ACCEPTABLE ONLY UNTIL PUBLIC FACILITIES BECOME AVAILABLE. I FULLY UNDERSTAND THE

FEE CONNECTED WITH THE FILING OF THIS PERC TEST APPLICATION IS NON-REFUNDABLE UNDER ANY CIRCUMSTANCES. I ALSO AGREE TO COMPLY

WITH ALL M.O.S.H.A. REQUIREMENTS IN TESTING THIS LOT. William W. Aitcheson
(SIGNATURE OF APPLICANT)

APPROVED BY _____ FOR _____ DATE _____

REJECTED BY _____ FOR _____ DATE _____

HOLD PENDING FURTHER TESTS _____ DATE _____

REASONS FOR REJECTION OR HOLDING _____

HD-216

THIS IS NOT A PERMIT

A42206

305'

16

SOIL PROFILE

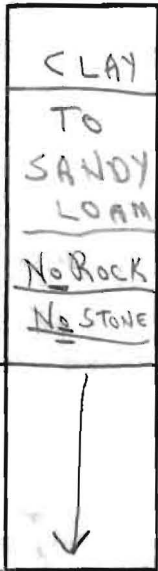

Hole #
①; ②
③
④

Fully ① wooded

5'45"

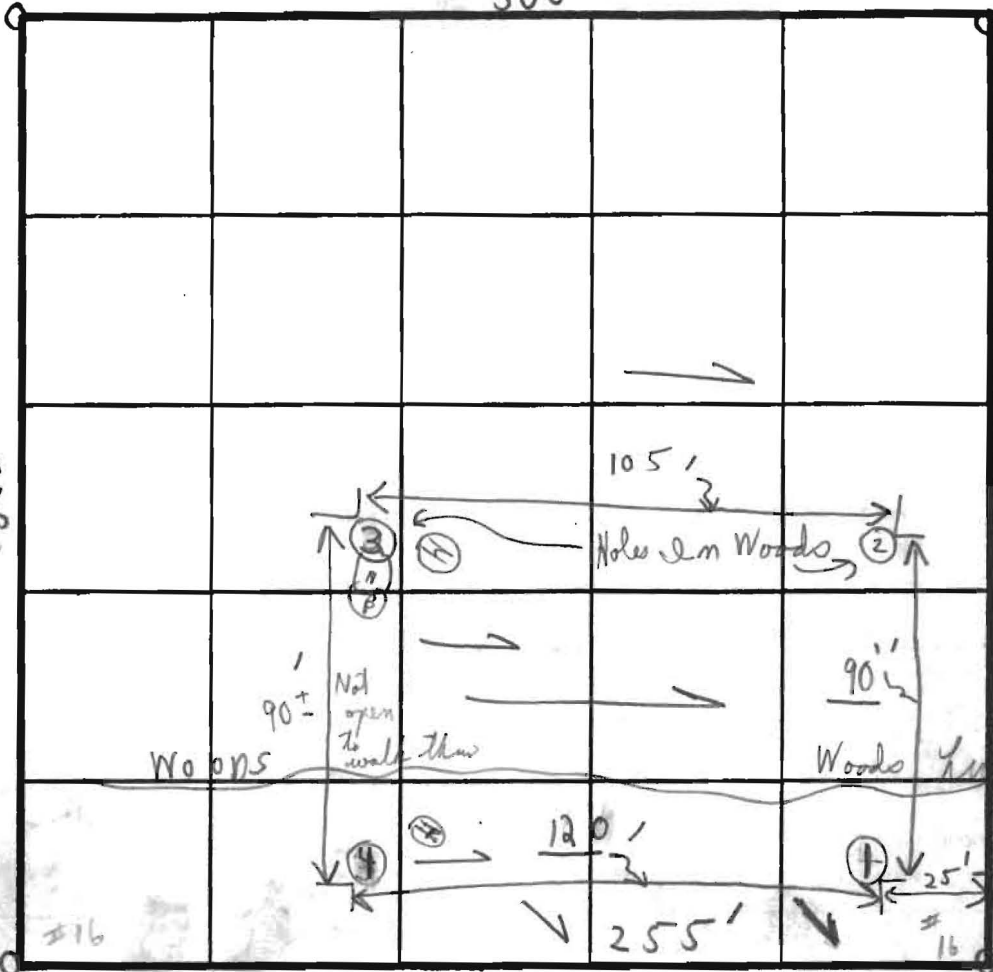

505'

- ① 13 1/2'
- ② 12' 2"
- ③ 10 1/2'
- ④ 12 1/2'

INDICATE NORTH - NAME ADJOINING ROADWAY AS BASE LINE.

COURT "A"

SOIL PROFILE

SOIL PROFILE	DATE	TEST NO.	DEPTH	PRE-WET		TEST - 1" DROP		TIME
				START	STOP	START	STOP	
1" - White loam	8/3/88	1A	6'	10:22	10:31	10:31	10:54	23 min
3rd cut		1B	13 1/2'	:	:	:	:	
1" - Below clay light colored powder loam		2A	5'	10:25	10:29	10:29	10:30	3 min
		2B	12' 2"	:	Visual	:	:	
1" - Below clay powder loam 10 1/2"		3A	4'	10:32	10:35	10:35	10:40	5 min
		B	6 1/2'	10:35	10:37	10:37	10:40	3 min
1" - See above		4	12 1/2'	:	Visual	:	White loam	
				:	:	:	:	
				:	:	:	:	

WLG 2 1/2
BOTTOM 7 1/2
X 10 MIN
200 CW

REMARKS (Tentative to approve) 2 holes in woods Tests per stake
Notes 2 holes in field

TYPE OF SOIL

TESTED BY C. B. D. ALSO PRESENT 2 Fyock's men 1 owner

October 15, seed with 60 lbs. per acre (1.4 lbs./1000 sq.ft.) of Kentucky 31 Tall Fescue. For the period May 1 thru July 31, seed with 60 lbs. Kentucky 31 Tall Fescue per acre and 2 lbs. per acre (.03 lbs./1000 sq.ft.) of weeping lovegrass. During the period of October 15 thru February 28, protect site by: Option (1) 2 tons per acre well anchored straw mulch and seed as soon as possible in the spring. Option (2) Use sod. Option (3) Seed with 60 lbs/acre Kentucky 31 Tall Fescue and mulch with 2 tons/acre well anchored straw.

MULCHING: Apply 1 1/2 to 2 tons per acre (70 to 90 lbs./1000 sq. ft.) of unrattled small grain straw immediately after seeding. Anchor mulch immediately after application using mulch anchoring tool or 218 gallons per acre (5 gal/1000 sq.ft.) of emulsified asphalt on flat areas. On slopes 8 feet or higher, use 348 gallons per acre (8 gal/1000 sq.ft.) for anchoring.

MAINTENANCE: Inspect all seeded areas and make needed repairs, replacements and reseeds.

TEMPORARY SEEDING NOTES

SEEDBED PREPARATION: Loosen upper three inches of soil by raking, discing or other acceptable means before seeding, if not previously loosened.

SOIL AMENDMENTS: Apply 600 lbs. per acre 10-10-10 fertilizer (14 lbs./1000 sq.ft.).

SEEDING: For periods March 1 thru April 30 and from August 15 thru November 15, seed with 2 1/2 bushel per acre of annual rye (3.2 lbs./1000 sq.ft.) For the period May 1 thru August 14, seed with 3 lbs. per acre of weeping lovegrass (.07 lbs./1000 sq.ft.). For the period November 1 thru February 28, protect site by applying 2 tons per acre of well anchored straw mulch and seed as soon as possible in the spring, or use sod.

MULCHING: Apply 1 1/2 to 2 tons per acre (70 to 90 lbs./1000 sq.ft.) of unrattled small grain straw immediately after seeding. Anchor mulch immediately after application using mulch anchoring tool or 218 gallons per acre (5 gal/1000 sq.ft.) of emulsified asphalt on flat areas. On slopes 8 feet or higher, use 348 gallons per acre (8 gal/1000 sq.ft.) for anchoring.

REFER TO THE 1994 MARYLAND STANDARDS AND SPECIFICATIONS FOR SOIL EROSION AND SEDIMENT CONTROL FOR RATE AND METHODS NOT COVERED.

CONTROL for permanent seedings, sod, temporary seeding and mulching (Sec G). Temporary stabilization with mulch alone can only be done when recommended seeding dates do not allow for proper germination and establishment of grasses.

6. All sediment control structures are to remain in place and are to be maintained in operative condition until permission for their removal has been obtained from the Howard County Sediment Control Inspector.

7. SITE ANALYSIS:

Total Area of Site:	3.00 Acres
Area Disturbed:	1.43 Acres
Area to be roofed or paved:	0.45 Acres
Area to be vegetatively stabilized:	0.98 Acres
Total Cut:	533 CY
Total Fill:	32 CY
Offsite Waste/Borrow Area Location:	

8. Any sediment control practice which is disturbed by grading activity for placement of utilities must be repaired on the same day of disturbance.

9. Additional sediment control must be provided, if deemed necessary by the Howard County DPW Sediment Control Inspector.

10. On all sites with disturbed areas in excess of 2 acres, approval of the inspection agency shall be requested upon completion of installation of perimeter erosion and sediment controls, but before proceeding with any other earth disturbance or grading. Other building or grading inspection approvals may not be authorized until this initial approval by the inspection agency is made.

11. Trenches for the construction of utilities shall be backfilled and stabilized within one working day, or is limited to three pipe lengths.

12. The total amount of earth dike = N/A LF

13. The total amount of super silt fence = 211 LF

14. The total amount of silt fence = 265 LF

* It is the responsibility of the contractor to identify the spoil/borrow site and notify and gain approval from the sediment control inspector of the site and it's grading permit number at the time of construction.

CONSTRUCTION SEQUENCE:

- | | NO. OF |
|--|--------|
| 1. Obtain grading permit. | 1 |
| 2. Install tree protection fence. | 1 |
| 3. Install sediment and erosion control devices and stabilize. | 1 |
| 4. Excavate for foundations, rough grade and temporarily stabilize. | 3 |
| 5. Construct structures, sidewalks and driveways. | 8 |
| 6. Final grade, install Erosion Control Matting and stabilize in accordance with standards and specifications. | 1 |
| 7. Upon approval of the sediment control inspector, remove sediment and erosion control devices and stabilize. | 1 |

* Delay construction of houses on lots: _____ N.

