

# APPLICATION

PERCOLATION TESTING

A \_\_\_\_\_

P \_\_\_\_\_

DISTRICT \_\_\_\_\_

DATE \_\_\_\_\_

HOWARD COUNTY HEALTH DEPARTMENT  
BUREAU OF ENVIRONMENTAL HEALTH  
3525-H ELLICOTT MILLS DRIVE/ELLICOTT CITY, MARYLAND 21043  
TELEPHONE: 313-2640

TO: THE COUNTY HEALTH OFFICER  
ELLICOTT CITY, MARYLAND

I HEREBY APPLY FOR THE NECESSARY TEST PRIOR TO APPLICATION FOR PERMIT TO CONSTRUCT (OR RECONSTRUCT) A SEWAGE DISPOSAL SYSTEM.

PROPERTY OWNER \_\_\_\_\_

ADDRESS \_\_\_\_\_ PHONE \_\_\_\_\_

AGENT OR PROSPECTIVE BUYER \_\_\_\_\_

ADDRESS \_\_\_\_\_ PHONE \_\_\_\_\_

PROPERTY LOCATION:

SUBDIVISION \_\_\_\_\_ LOT NO. \_\_\_\_\_

ROAD AND DESCRIPTION \_\_\_\_\_

TAX MAP \_\_\_\_\_ PARCEL # \_\_\_\_\_

SIZE OF LOT \_\_\_\_\_ TYPE BLDG. \_\_\_\_\_  
(SINGLE FAMILY DWELLING OR COMMERCIAL)

THE SYSTEM INSTALLED UNDER THIS APPLICATION IS ACCEPTABLE ONLY UNTIL PUBLIC FACILITIES BECOME AVAILABLE. I FULLY UNDERSTAND THE FEE CONNECTED WITH THE FILING OF THIS PERC TEST APPLICATION IS NON-REFUNDABLE UNDER ANY CIRCUMSTANCES. I ALSO AGREE TO COMPLY WITH ALL M.O.S.H.A. REQUIREMENTS IN TESTING THIS LOT.

\_\_\_\_\_  
(SIGNATURE OF APPLICANT)

APPROVED BY \_\_\_\_\_ FOR \_\_\_\_\_ DATE \_\_\_\_\_

DISAPPROVED BY \_\_\_\_\_ FOR \_\_\_\_\_ DATE \_\_\_\_\_

HOLD PENDING FURTHER TESTS \_\_\_\_\_

REASONS FOR REJECTION OR HOLDING \_\_\_\_\_

PERCOLATION TEST PLAT/PRELIMINARY PLAT - TITLE OR I.D. # \_\_\_\_\_ DATE \_\_\_\_\_

SITE DEVELOPMENT PLAN/FINAL PLAT - TITLE OR I.D. # \_\_\_\_\_ DATE \_\_\_\_\_

# THIS IS NOT A PERMIT

COUNTY #

SOIL PROFILE

0' 24  
brn orge sa cl lm  
1' 2 1/2  
brn orge sa m  
tan lt. brn sand 580 Rx  
10 1/2

25  
brn sa lm  
2' orge tan lt. brn beige sand 5-10% Rx  
6 1/2  
20-250 Rx  
10 1/2

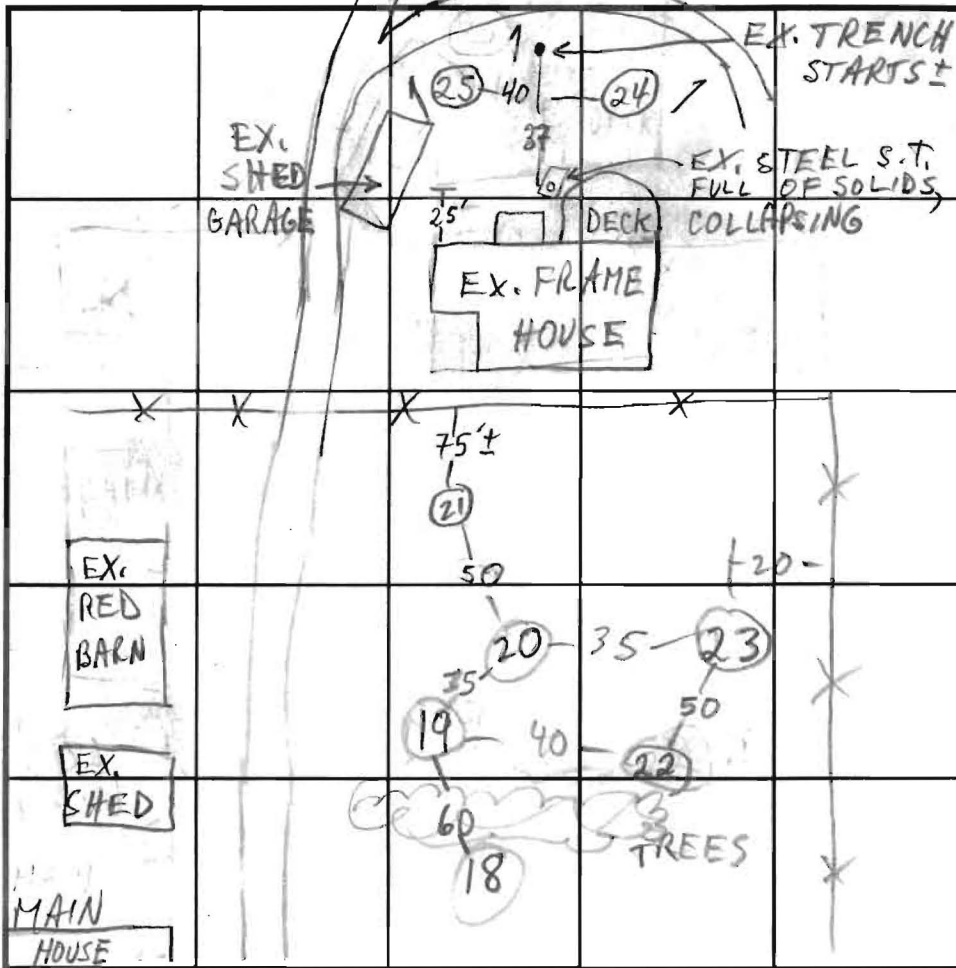

SOIL PROFILE

0'

INDICATE NORTH - NAME ADJOINING ROADWAY AS BASE LINE.

DATE	TEST NO.	DEPTH	PRE-WET		TEST: 1" DROP		TIME
			START	STOP	START	STOP	
10/21/03	24V	10 1/2					OK
	25V	10 1/2					OK
	18				S.M.		F
	19				S.M.		F
	20					S.M.	OK
	21					S.M.	OK
	22					S.M.	OK
	23					S.M.	OK

REMARKS HOLES 24+25 OK FOR SHALLOW SYSTEM

TYPE OF SOIL

TESTED BY M. Ripkin

ALSO PRESENT

TRENCH DESIGN DATA: AVERAGE PERCOLATION TIME 24 + 25 TRENCH WIDTH

INLET DEPTH 1 MAXIMUM BOTTOM DEPTH 3 SQ. FT./BEDROOM 180

# APPLICATION

PERCOLATION TESTING

A 518598C

P \_\_\_\_\_

HOWARD COUNTY HEALTH DEPARTMENT  
BUREAU OF ENVIRONMENTAL HEALTH  
3525-H ELLICOTT MILLS DRIVE/ELLICOTT CITY, MARYLAND 21043  
TELEPHONE: 313-2640

DISTRICT \_\_\_\_\_

DATE \_\_\_\_\_

TO: THE COUNTY HEALTH OFFICER  
ELLICOTT CITY, MARYLAND

I HEREBY APPLY FOR THE NECESSARY TEST PRIOR TO APPLICATION FOR PERMIT TO CONSTRUCT (OR RECONSTRUCT) A SEWAGE DISPOSAL SYSTEM.

PROPERTY OWNER Richard H Conrey

ADDRESS 1575 Marrittville Rd, Marriotsville PHONE 410-781-7270 w 410-461-5008

AGENT OR PROSPECTIVE BUYER N/A

ADDRESS \_\_\_\_\_ PHONE \_\_\_\_\_

PROPERTY LOCATION:

SUBDIVISION Conrey Farm LOT NO. The Large Frame House

ROAD AND DESCRIPTION Eastside of Marriottsville Rd 2000' North of RT 99

TAX MAP 10 PARCEL # 34

SIZE OF LOT \_\_\_\_\_ TYPE BLDG. existing single family  
(SINGLE FAMILY DWELLING OR COMMERCIAL)

THE SYSTEM INSTALLED UNDER THIS APPLICATION IS ACCEPTABLE ONLY UNTIL PUBLIC FACILITIES BECOME AVAILABLE. I FULLY UNDERSTAND THE FEE CONNECTED WITH THE FILING OF THIS PERC TEST APPLICATION IS NON-REFUNDABLE UNDER ANY CIRCUMSTANCES. I ALSO AGREE TO COMPLY WITH ALL M.O.S.H.A. REQUIREMENTS IN TESTING THIS LOT.  Richard H Conrey  
(SIGNATURE OF APPLICANT)

APPROVED BY \_\_\_\_\_ FOR \_\_\_\_\_ DATE \_\_\_\_\_

DISAPPROVED BY \_\_\_\_\_ FOR \_\_\_\_\_ DATE \_\_\_\_\_

HOLD PENDING FURTHER TESTS \_\_\_\_\_

REASONS FOR REJECTION OR HOLDING \_\_\_\_\_

PERCOLATION TEST PLAT/PRELIMINARY PLAT - TITLE OR I.D. # \_\_\_\_\_ DATE \_\_\_\_\_

SITE DEVELOPMENT PLAN/FINAL PLAT - TITLE OR I.D. # \_\_\_\_\_ DATE \_\_\_\_\_

# THIS IS NOT A PERMIT

COUNTY #

SOIL PROFILE NORTH SOUTH

brn  
cl/m  
30-50%  
RX  
HARD  
RX  
HARD

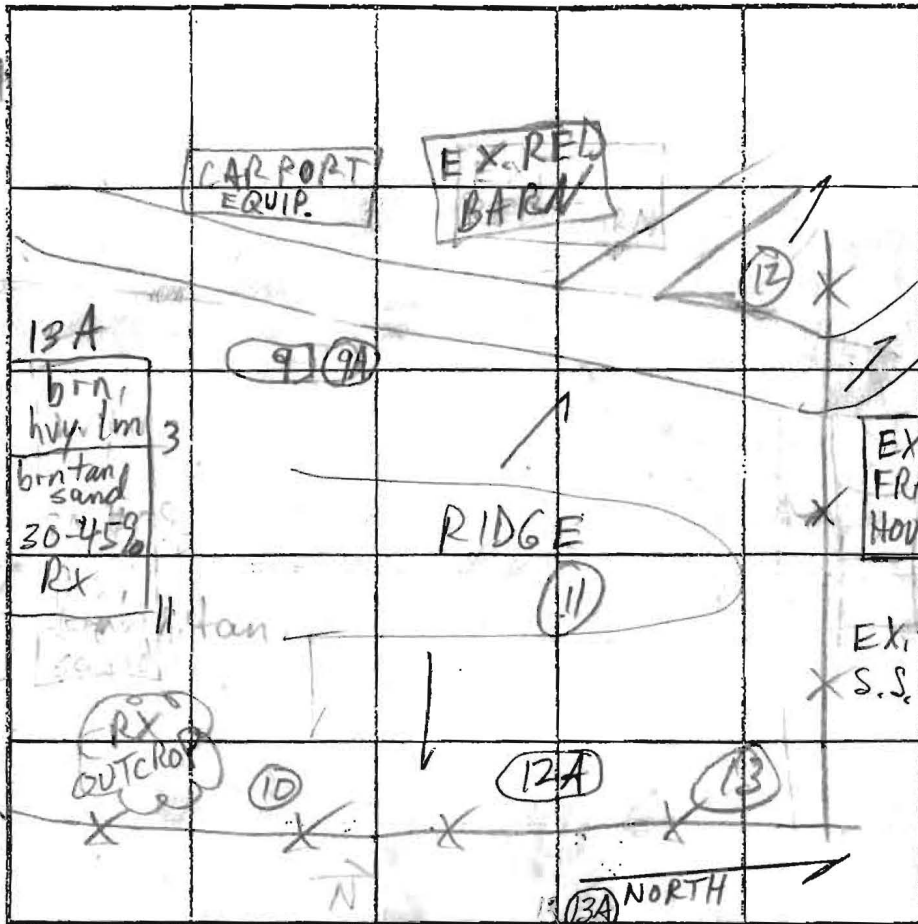

SOIL PROFILE

0'  
12  
9" FILL  
orge brn  
hvysal m  
3  
tan orge  
brn  
sand  
5-10%  
frags.  
12

WEST EAST  
brn  
orge  
hvyl m  
4  
90% orge  
brn  
RX  
5  
salm  
10-30%  
15% RX  
to 9  
HARD @ 9-10'  
ON SOUTH

13  
brn  
hvysal m  
1 1/2 - 2  
tan brn  
beige sand  
10% w/a few  
rock @ 20-25%

INDICATE NORTH - NAME ADJOINING ROADWAY AS BASE LINE.

DATE	TEST NO.	DEPTH	PRE-WET		TEST - 1" DROP		TIME
			START	STOP	START	STOP	
6/3/03	10	7 1/2	12:28	12:30	12:30	12:34	4
	9A	7 1/2	12:56:00	12:58:00	12:58:00	1:00:10	2
	12	12					
	13	12					
	13A	11	NOT TESTED				APPEARS MARGINAL
	11	8 1/2 - 9	40-60% RX			BELOW 4	F
	12A	5	RX @ 5				F
	9	3-7					F

REMARKS ALL HOLES RELOCATED FROM PLAN  
 TYPE OF SOIL SAND MOUND APPEARS TO BE ONLY REMAINING OPTION  
 TESTED BY M. Ritkin - ALSO PRESENT Lovey owner  
 TRENCH DESIGN DATA: AVERAGE PERCOLATION TIME \_\_\_\_\_ TRENCH WIDTH \_\_\_\_\_  
 INLET DEPTH \_\_\_\_\_ MAXIMUM BOTTOM DEPTH \_\_\_\_\_ SQ. FT./BEDROOM \_\_\_\_\_