

9/23/04 Noon

PUB. SEWER STATUS VERIFIED BY _____

ISSUE DATE: 8/2/04

PERMIT

P 520805-A

APPROVAL DATE: _____

A 518598-D

ON-SITE SEWAGE DISPOSAL SYSTEM HOWARD COUNTY HEALTH DEPARTMENT BUREAU OF ENVIRONMENTAL HEALTH

CONCRETE CONSTRUCTION IS PERMITTED TO INSTALL ALTER

ADDRESS: _____ PHONE NUMBER: _____

SUBDIVISION: Conrey Farm LOT NUMBER: 4 "Stone House"

ADDRESS: 1575 Marriottsville Road PROPERTY OWNER: Skip Conrey

SEPTIC TANK CAPACITY (GALLONS): 1000

PUMP CHAMBER CAPACITY (GALLONS): 1000

NUMBER OF BEDROOMS: 3

SQUARE FEET PER BEDROOM: 180

LINEAR FEET OF TRENCH REQUIRED: _____

TRENCHES:	Trench to be 3.0 feet wide. Inlet 2.0 feet below original grade. Bottom maximum depth 4.0 feet below original grade. Effective area begins at 2.0 feet below original grade. 2.0 feet of stone below distribution pipe.
LOCATION:	Place the septic tank and pump pit about 60' from the existing house and 60' from the pond. Run pressure line up to highest part of reserve area and run (2) 55' trenches on contour.
PURPOSE:	Pump and collapse existing septic tank.

PLANS APPROVED: MER DATE: 8/2/04

- NOTE: PERMIT VOID AFTER 2 YEARS
- NOTE: CONTRACTOR RESPONSIBLE FOR SCHEDULING A PRE-CONSTRUCTION INSPECTION FOR ALL INSTALLATIONS
- NOTE: WATERTIGHT SEPTIC TANKS REQUIRED
- NOTE: ALL PARTS OF SEPTIC SYSTEM SHALL BE 100 FEET FROM ANY WATER WELL
- NOTE: MANHOLE RISERS REQUIRED ON ALL SEPTIC TANKS AND PUMP CHAMBERS

NEITHER THE HOWARD COUNTY COUNCIL OR THE HEALTH DEPARTMENT IS RESPONSIBLE FOR THE SUCCESSFUL OPERATION OF ANY SYSTEM PERMITTEE RESPONSIBLE FOR OBTAINING FINAL APPROVAL ON THIS PERMIT CALL 410-313-2640 FOR INSPECTION OF SEPTIC SYSTEM

NOT TO SCALE

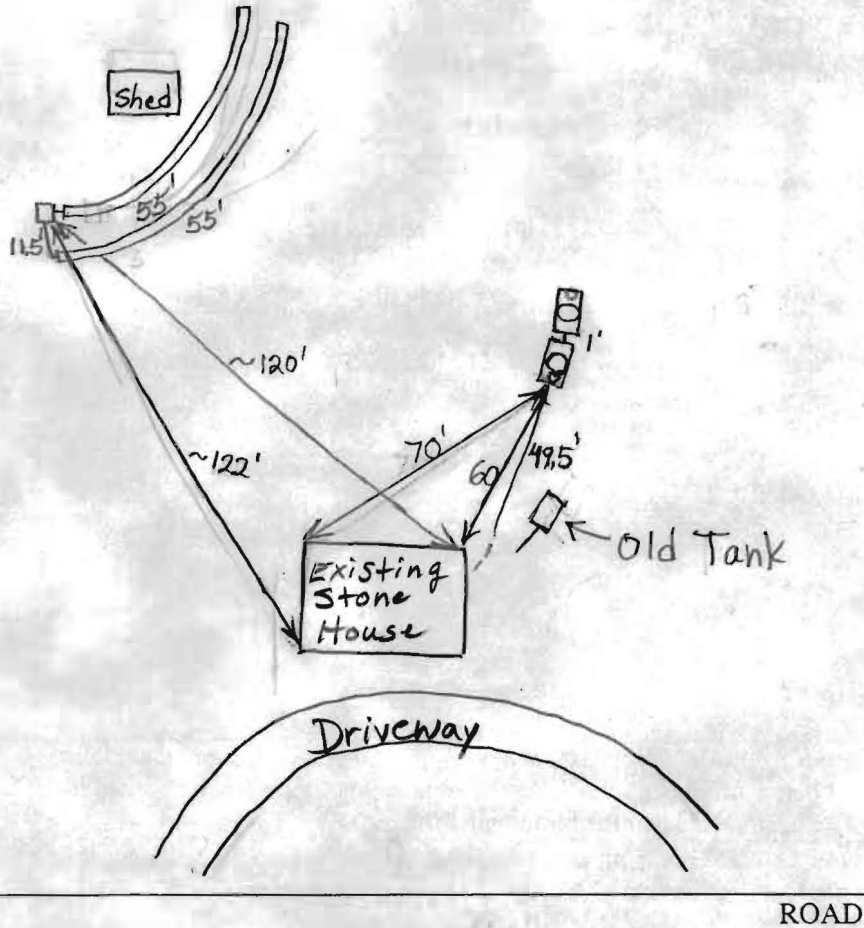

TRENCH/DRAINFIELD DATA		
WIDTH	INLET	BOTTOM
3'	2'	4'
NUMBER OF TRENCHES		2
TOTAL LENGTH		110'
ABSORPTION AREA		330 sq ft + Sidewall
DISTRIBUTION BOX LEVEL		Yes
DISTRIBUTION BOX BAFFLE		E/bow
DISTRIBUTION BOX PORT		No

SEPTIC TANK DATA	
SEPTIC TANK 1 LEVEL	✓
CAPACITY	1000 GAL
SEAM LOC	Top
TANK LID DEPTH	3'
BAFFLES	Yes
BAFFLE FILTER	No
MANHOLE LOC	Middle
6" PORT LOC	Front
WATERTIGHT TEST	No
SEPTIC TANK 2 LEVEL	✓
CAPACITY	1000 GAL
SEAM LOC	Top
TANK LID DEPTH	3.5'
BAFFLES	Front
BAFFLE FILTER	No
MANHOLE LOC	Middle
6" PORT LOC	Rear
WATERTIGHT TEST	No

PRE-CONSTRUCTION 9/23/04 Trenches already dug as per MR's instructions. Tanks set and are too deep. Told installers to grade area to limit fill over tanks. Told installers that they may put alarm outside as long as it can be easily heard inside, else put inside house. House very small. Distribution box placed near test hole 15A. (BB) 10/4/04 Pump and alarm working. Old tank filled in and covered. (BB)

FINAL INSPECTOR B. Baker DATE OF APPROVAL 10/4/04