



HOWARD COUNTY
HEALTH DEPARTMENT
Environmental Health
7178 Columbia Gateway Dr.
Columbia, MD 21046

CERTIFIED MAIL™



7008 0150 0002 5102 9107



Hasler

016H16504100

\$05.320

12/19/2008

Mailed From 21043

US POSTAGE

FIRST NOTICE

12-20-08

SECOND NOTICE

12-26

RETURNED

1-3-09

Perfecto Moreno
826 Long Corner Road
Mt. Airy, MD 21771-3832

UNCLAIMED

UNC

21771+3832



2. Article Number
 (Transfer from service label) **7008 0150 0002 5102 8926**

Perfecto Moreno or
 Hilaria Rodriguez
 826 Long Corner Road
 Mt, Airy, MD 21771-3832

3. Service type

Certified Mail
 Registered
 Insured Mail

Express Mail
 Return Receipt for Merchandise
 C.O.D.

4. Restricted Delivery? (Extra Fee) Yes

1. Article Addressed to:

■ Complete items 1, 2, and 3. Also complete item 4 if Restricted Delivery is desired.
 ■ Print your name and address on the reverse so that we can return the card to you.
 ■ Attach this card to the back of the mailpiece or on the front if space permits.

PRB

COMPLETE THIS SECTION ON DELIVERY

A. Signature *Perfecto Moreno*

B. Received by (Printed Name) *MANASSO MORENO*

C. Print of Delivery *grrz*

D. Is delivery address different from item 1? Yes
 If YES, enter delivery address below: No

SENDER: COMPLETE THIS SECTION

COMPLETE THIS SECTION ON DELIVERY

Bureau of Environmental Health
 7178 Gateway Drive Columbia, MD 21046
 (410) 313-2640 Fax (410) 313-2648
 TDD (410) 313-2323 Toll Free 1-866-313-6300
 website: www.hchealth.org

n, M.D., M.P.H., Health Officer

CE OF VIOLATION

IFIED MAIL: 70080150000251028926
RECEIPT REQUESTED

September 17, 2008

deck over water well
6 Grid 6 Parcel 85

Dear Mr. Levine:

In May 2008, the Howard County Department of Inspections, Licenses, and Permits found that you had constructed a deck at the back of your residence without a permit. Further review of the issue by the Health Department revealed that you had constructed the deck over the existing drinking water well for your property. This is a violation of both Code of Maryland (COMAR) and Howard County Code. You were informed at that time that the deck would have to be removed to a distance of at least 10 feet from the well. More than adequate time has been allowed for this task to be accomplished. A review of records and property conditions reveals that the deck covers the well, as it was constructed.

Construction of the deck violated Howard County Code 3.901(F) which requires submittal of a Site Plan that includes well and septic locations, as well as existing and proposed structures, prior to approval of a Building Permit. Be advised that the deck that you constructed without a permit continues to be in violation of COMAR 26.04.04.05.B.(2)(b) and (e), respectively, that a well "may not be located within or under any building" except one specifically constructed to house the pumping equipment, and the well "shall be located so as to be accessible for cleaning, treatment, repair, testing, inspection, and other such attention as may be necessary". Location of the constructed deck also violates Howard County Code 3.808(C) which requires a setback distance of 10 feet between a deck and a well.

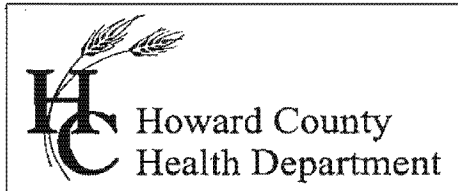

Bureau of Environmental Health
7178 Columbia Gateway Drive, Columbia, MD 21046-2147
(410) 313-2640 Fax (410) 313-2648
TDD (410) 313-2323 Toll Free 1-866-313-6300
website: www.hchealth.org

Peter L. Beilenson, M.D., M.P.H., Health Officer

SECOND NOTICE OF VIOLATION / CIVIL CITATION

**SENT VIA FIRST CLASS MAIL and CERTIFIED MAIL:
RETURN RECEIPT REQUESTED**

December 18, 2008

Perfecto Moreno
826 Long Corner Road
Mount Airy, Maryland 21771

**RE: Civil Citation/Non-permitted construction of a deck over water well
826 Long Corner Road, Tax Map 6 Grid 6 Parcel 85**

Dear Mr. Moreno,

In May 2008, the Howard County Department of Inspections, Licenses, and Permits found that you had constructed a deck at the back of your residence without a permit. Further review by the Health Department revealed that you had constructed the deck over the existing drinking water well for your property. This is a violation of both Code of Maryland (COMAR) and Howard County Code regulations. You were informed at that time that the deck would have to be removed to a distance of at least 10 feet from the well.

On September 22, 2008, you received a formal Notice of Violation (dated September 17, 2008) via Certified Mail (#70080150000251028926). The violations were summarized in that letter, and as follows.

1. Construction of the deck violated Howard County Code 3.901(F) which requires submittal of a Site Plan that includes well and septic locations, as well as existing and proposed structures, prior to approval of a Building Permit (i.e., prior to construction a Howard County review and approval of the Building Permit Application are required).
2. Location of the constructed deck violates Howard County Code 3.808(C) which requires a minimum setback distance of 10 feet between a deck and a well.
3. Be advised that the deck that you constructed is also in violation of COMAR 26.04.04.05.B(2) - paragraphs (b) and (e) respectively; a well "may not be located within or under any building" except one specifically constructed to house the pumping equipment, and the well "shall be located so as to be accessible for cleaning, treatment, repair, testing, inspection, and other such attention as may be necessary".

CERTIFIED MAIL™ RECEIPT
 (Domestic Mail Only; No Insurance Coverage Provided)
 For delivery information visit our website at www.usps.com®
OFFICIAL USE

Postage \$	
Certified Fee	
Return Receipt Fee (Endorsement Required)	
Restricted Delivery Fee (Endorsement Required)	
Total Postage & Fees \$	

Sent To: **Moreno Perfecto**
 Street, Apt. No. or PO Box No. **826 Long Corner Road**
 City, State, ZIP+4 **Mt. Airy, MD 21771**

0110035155
MUNICIPAL INFRACTION/ CITATION
 City of Maryland for **Howard County (Certified & Regular Mail)**
 Agency **Health Department**
 Municipality/State of Maryland
 Defendant's (Last) Name **Moreno Perfecto** First Middle
 Address in Full **826 Long Corner Road**
Mt. Airy **Maryland** **21771**
 State Zip Code
 Height Weight Sex Race Hair Eyes
 Telephone No. Day: Night:

I am hereby charged that the above named defendant on **December 10, 2008** at **2:00 PM** at the back of the residential structure **26 Long Corner Road** in **Howard County, Maryland** instruct and maintain a deck without **Site Plan** **approved** and **Health Department** approval resulting in a **setback violation to property well**. Owner advised **September 17, 2008** **Notice of Violation**, but no remedy has occurred, in violation of **County Code** and continuing.

This citation is based upon an affidavit of (See attached)
 In violation of: Md. Ann. Code COMAR Municipal Ordinance/Public Local Law/Local Code

Document/Article Section Sub Section Paragraph
Howard County Code 3.901(F) & 3.808(c)

I sign my name as a receipt of a copy of this Citation and not as an admission of guilt. I will comply with the requirements set forth in this Citation.
 Defendant's Signature

YOU MUST EITHER ELECT TO STAND TRIAL OR PAY A FINE.
 NOTE: Failure to either pay the fine or request a trial date by the below mentioned date will deem you liable for the fine assessed, the fine may be doubled and a judgment on affidavit entered against you including an Order of Abatement.
 OR: If you request a trial date and then fail to appear in Court, the fine may be doubled and a judgment on affidavit may be entered against you.
 YOU MAY PAY A FINE OF \$ **250** BY **January 7, 2009** AT (Payment Location) **Office of Finance 8930 Stamford Blvd. Columbia MD 21045**
 THIS WILL BE DEEMED AN ADMISSION OF GUILT AND NO TRIAL DATE WILL BE SET. OR
 IF YOU ELECT TO STAND TRIAL, DO NOT FORWARD PAYMENT OF THE FINE, BUT YOU MUST NOTIFY IN WRITING **Director of Finance, 8930 Stamford Blvd. by 1/30/09**
 AND THE DISTRICT COURT WILL NOTIFY YOU OF A TRIAL DATE AND LOCATION.
 IN ADDITION, **Howard County Health Department** IS SEEKING ABATEMENT OF THIS INFRACTION. YOU MAY BE ORDERED TO ABATE THIS INFRACTION OR BE ASSESSED THE COSTS FOR THE ABATEMENT, AS WELL AS A FINE OF UP TO \$1,000, PLUS COURT COSTS. FAILURE TO APPEAR SHALL RESULT IN JUDGMENT ON AFFIDAVIT.

YOU MUST APPEAR IN COURT: A court date will be sent to you by mail.
 YOU MAY ELECT TO STAND TRIAL OR YOU MAY ELECT TO PAY A PRESET FINE OF \$ _____ **to the District Court of Maryland at** _____ **and AVOID TRIAL.** A court date will be sent to you by mail. Payment must be made on or before the scheduled trial date.
AFTER TRIAL the Court may impose a fine up to \$ _____ plus court costs.
FAILURE TO APPEAR OR, IF PERMITTED, PAY THE PRESET FINE LISTED ABOVE, WILL RESULT IN A WARRANT BEING ISSUED FOR YOUR ARREST.

I solemnly affirm under the penalties of perjury, and upon personal knowledge or based on the affidavit, that the contents of this citation are true and that I am competent to testify on these matters. The defendant is not now in the military service, as defined in the Soldier's and Sailor's Civil Relief Act of 1940 with amendments, nor has been in such service within thirty days hereof.

Officer's Signature **Robert Bricker (Robert Bricker)** date **12/18/08**
 Agency **Howard County** Sub-Agency **Bureau of Environmental Health** Phone **410-313-1771**
 DC 28 (Rev. 10/94) DEFENDANT'S COPY



APPLICATION

FOR PERCOLATION TESTING AND SITE EVALUATION

TEST DATE(S) _____ TEST TIME _____

AP 535249

AGENCY REVIEW: _____

DATE 06/10/2011

DO NOT WRITE ABOVE THIS LINE

I HEREBY APPLY FOR THE NECESSARY TESTING/EVALUATION PRIOR TO ISSUANCE OF SEWAGE DISPOSAL SYSTEM PERMIT(S) TO:

CHECK AS NEEDED:

- CONSTRUCT NEW SEPTIC SYSTEM(S)
- REPAIR/ADD TO AN EXISTING SEPTIC SYSTEM
- REPLACE AN EXISTING SEPTIC SYSTEM

CHECK AS NEEDED:

- NEW STRUCTURE(S)
- ADDITION TO AN EXISTING STRUCTURE
- REPLACE AN EXISTING STRUCTURE

CHECK ONE:

- CREATE NEW LOT(S)
- BUILD ON AN EXISTING LOT IN A SUBDIVISION
- BUILD ON AN EXISTING PARCEL OF RECORD

IS THE PROPERTY WITHIN 2500' OF ANY RESERVOIR?

- YES
- NO

THE TYPE OF STRUCTURE IS:

- RESIDENTIAL WITH 4 PROPOSED BEDROOMS IN THE COMPLETED STRUCTURE (NOTE **UNKNOWN** IF APPROPRIATE)
- COMMERCIAL (PROVIDE DETAIL OF NUMBERS AND TYPES OF EMPLOYEES/ CUSTOMERS ON ACCOMPANYING PLAN)
- INSTITUTIONAL/GOVERNMENT (PROVIDE DETAIL OF NUMBERS AND TYPES OF EMPLOYEES/USERS ON ACCOMPANYING PLAN)

PROPERTY OWNER(S) Perfecto Moreno, Hilaria Rodriguez

DAYTIME PHONE _____ CELL _____ FAX _____

MAILING ADDRESS _____
STREET CITY/TOWN STATE ZIP

APPLICANT Steve Hawkins

DAYTIME PHONE 301-829-1853 CELL 301-639-0785 FAX _____

MAILING ADDRESS 718 Robinwood Dr Mt. Airy Md 21271
STREET CITY/TOWN STATE ZIP

APPLICANT'S ROLE: DEVELOPER BUILDER BUYER RELATIVE/FRIEND REALTOR CONSULTANT

PROPERTY LOCATION
SUBDIVISION/PROPERTY NAME _____ LOT NO. _____

PROPERTY ADDRESS 826 Long Corner Rd Mt. Airy Md
STREET TOWN/POST OFFICE

TAX MAP PAGE(S) _____ GRID _____ PARCEL(S) _____ PROPOSED LOT SIZE _____

AS APPLICANT, I UNDERSTAND THE FOLLOWING: THE SYSTEM INSTALLED SUBSEQUENT TO THIS APPLICATION IS ACCEPTABLE ONLY UNTIL PUBLIC SEWERAGE IS AVAILABLE. THIS APPLICATION IS COMPLETE WHEN ALL APPLICABLE FEES AND A SUITABLE SITE PLAN HAVE BEEN RECEIVED. I ACCEPT THE RESPONSIBILITY FOR COMPLIANCE WITH ALL M.O.S.H.A. AND "MISS UTILITY" REQUIREMENTS. APPROVAL IS BASED UPON SATISFACTORY REVIEW OF A PERC CERTIFICATION PLAN.

TEST RESULTS WILL BE MAILED TO APPLICANT.

SIGNATURE OF APPLICANT

HOWARD COUNTY HEALTH DEPARTMENT, BUREAU OF ENVIRONMENTAL HEALTH, WELL AND SEPTIC PROGRAM
7178 COLUMBIA GATEWAY DRIVE COLUMBIA, MARYLAND 21046 (410) 313-2640 FAX (410) 313-2648
TDD (410) 313-2323 TOLL FREE 1-877-4MD-DHMH

(A)

1' bm & 1 csbk

3.5' lt bm scl 1csbk

4' H bm ch se 2msbk

5' yellow bm ch se 30% shale @ 6'

8' vch ls

12'

(B)

1' bm & sbk

4' bm scl 1csbk 25% shale

yellow bm ch scl 20% rx

6' yellow bm chscl 25% rx (shale)

8' ch yellow bm sl

12' yellow bm ch ls

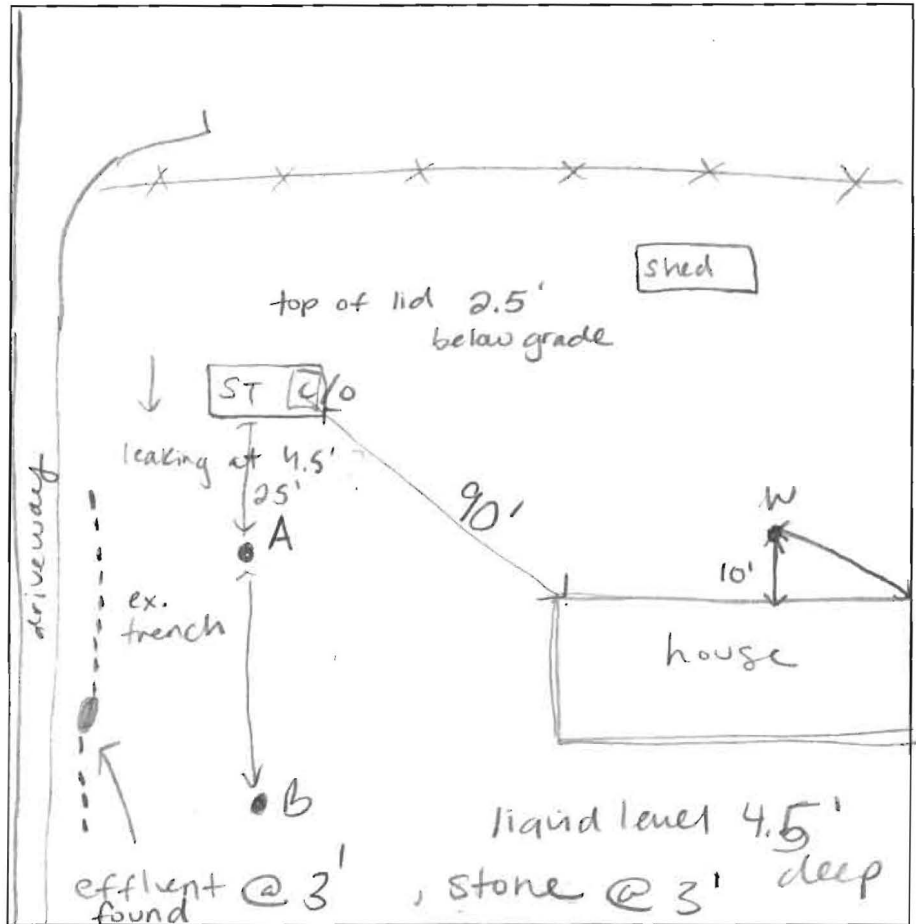

Long Corner Rd.

DATE	TEST #	DEPTH	START	BREAK 1" DROP	STOP 2" DROP	TIME OF 2ND INCH	P/F/H
6-28-11	A	7.5' / 12'	11:24	11:25 ⁵⁵	11:28 ³⁵	~3	P
6-28-11	B	6'4" / 12'	11:52	11:56	11:03	7	P

REMARKS Cinderblock tank need new tank **4 BR**

SANITARIAN poured concrete lid BACKHOE Steve OTHERS realtor

TEST HOLES USED IN SDA 2 AVG. PERC TIME 5 SQ. FT/BR

TRENCH WIDTH 2' INLET DEPTH 4-5' MAX. BOT DEPTH 8' EFFECTIVE SW



Bureau of Environmental Health
 7178 Gateway Drive Columbia, MD 21046
 (410) 313-2640 Fax (410) 313-2648
 TDD (410) 313-2323 Toll Free 1-866-313-6300
 website: www.hchealth.org

Peter L. Beilenson, M.D., M.P.H., Health Officer

NOTICE OF VIOLATION

SENT VIA CERTIFIED MAIL: 70080150000251028926
 RETURN RECEIPT REQUESTED

September 17, 2008

Perfecto Moreno or Hilaria Rodriguez
 826 Long Corner Road
 Mount Airy, Maryland 21771

RE: **Non-permitted construction of a deck over water well**
 826 Long Corner Road, Tax Map 6 Grid 6 Parcel 85

Dear Mr. ~~Levine~~ ^{TUP}:

In May 2008, the Howard County Department of Inspections, Licenses, and Permits found that you had constructed a deck at the back of your residence without a permit. Further review of the issue by the Health Department revealed that you had constructed the deck over the existing drinking water well for your property. This is a violation of both Code of Maryland (COMAR) and Howard County Code. You were informed at that time that the deck would have to be removed to a distance of at least 10 feet from the well. More than adequate time has been allowed for this task to be accomplished. A review of records and property conditions reveals that the deck covers the well, as it was constructed.

Construction of the deck violated Howard County Code 3.901(F) which requires submittal of a Site Plan that includes well and septic locations, as well as existing and proposed structures, prior to approval of a Building Permit. Be advised that the deck that you constructed without a permit continues to be in violation of COMAR 26.04.04.05.B.(2)(b) and (e), respectively, that a well "may not be located within or under any building" except one specifically constructed to house the pumping equipment, and the well "shall be located so as to be accessible for cleaning, treatment, repair, testing, inspection, and other such attention as may be necessary". Location of the constructed deck also violates Howard County Code 3.808(C) which requires a setback distance of 10 feet between a deck and a well.

You must provide evidence that the violation has been remedied within 15 (fifteen) days of receipt of this notice. The deck must be removed from the area of the well to a distance of 10 feet. When the setback condition is met, contact the Health Department 410-313-1771, to schedule an inspection of the well area. Failure to comply will result in the issuance of a civil citation(s). Under Howard County Code, paragraph 12.112, each day this violation is allowed to occur is considered a separate offense.

If you believe that the condition described above is not and could not be a hazard to health, or that the Health Department is not acting in compliance with pertinent laws and regulations, you may request a formal hearing before the Board of Health within 15 (fifteen) days of receipt of this letter. All requests are to be made in writing and directed to the Executive Secretary of the Board of Health at the above address.

If you have any questions regarding this letter, please contact me at the Bureau of Environmental Health, phone 410-313-1771.

Sincerely,



Robert C. Bricker, R.S.
Bureau of Environmental Health
Well and Septic Program

Copy: Executive Secretary, Board of Health
File

U.S. Postal Service™
CERTIFIED MAIL™ RECEIPT

2/18/08

(Domestic Mail Only; No Insurance Coverage Provided)

For delivery information visit our website at www.usps.com

OFFICIAL USE

Postage	\$
Certified Fee	
Return Receipt Fee (Endorsement Required)	
Restricted Delivery Fee (Endorsement Required)	
Total Postage & Fees	\$

Postmark
Here

Sent To

Moreno Perfecto

Street, Apt. No.;
or PO Box No.

826 Long Corner Road

City, State, ZIP+4

Mt. Airy, MD 21771

7008 0150 0002 5102 9107

Acct# 0110035155

0Z33129712

UNIFORM MUNICIPAL INFRACTION/
CIVIL CITATION

District Court of Maryland for Howard County (Certified Regular Mail)
Health Department

County/Municipality/State of Maryland Agency

vs. Mareno Perfecto
Defendant's (Last) Name First Middle

826 Long Corner Road
Current Address in Full

Mt. Airy Maryland 21771
City State Zip Code

DOB Height Weight Sex Race Hair Eyes

Related Citations Telephone No. Day: Night:

It is formally charged that the above named defendant on December 10, 2008 at 2 P.M. at the back of the residential structure at 826 Long Corner Road in Howard County, Maryland did construct and maintain a deck without Site Plan submitted and Health Department approval resulting in setback violation to property well. Owner advised September 17, 2008 Notice of Violation, but no remedy has occurred, in violation of County Code and continuing.

This citation is based upon an affidavit of (See attached)

In violation of: Md. Ann. Code COMAR Municipal Ordinance/Public Local Law/Local Code

Document/Article Section Sub Section Paragraph
Howard County Code 3.901(F) & 3.808(c)

I sign my name as a receipt of a copy of this Citation and not as an admission of guilt. I will comply with the requirements set forth in this Citation.

Defendant's Signature

YOU MUST EITHER ELECT TO STAND TRIAL OR PAY A FINE.
NOTE: Failure to either pay the fine or request a trial date by the below mentioned date will deem you liable for the fine assessed, the fine may be doubled and a judgment on affidavit entered against you including an Order of Abatement.
OR If you request a trial date and then fail to appear in Court, the fine may be doubled and a judgment on affidavit may be entered against you.
YOU MAY PAY A FINE OF \$ 250 BY January 7, 2009 AT (Payment Location) Office of Finance, 8930 Stamford Blvd., Columbia MD 21045
THIS WILL BE DEEMED AN ADMISSION OF GUILT AND NO TRIAL DATE WILL BE SET. OR MD 21045
IF YOU ELECT TO STAND TRIAL DO NOT FORWARD PAYMENT OF THE FINE, BUT YOU MUST NOTIFY IN WRITING Director of Finance, 8930 Stamford Blvd. By 12/31/08
AND THE DISTRICT COURT WILL NOTIFY YOU OF A TRIAL DATE AND LOCATION.
 IN ADDITION, Howard County Health Department IS SEEKING ABATEMENT OF THIS INFRACTION. YOU MAY BE ORDERED TO ABATE THIS INFRACTION OR BE ASSESSED THE COSTS FOR THE ABATEMENT, AS WELL AS A FINE OF UP TO \$1,000, PLUS COURT COSTS. FAILURE TO APPEAR SHALL RESULT IN JUDGMENT ON AFFIDAVIT.

YOU MUST APPEAR IN COURT: A court date will be sent to you by mail.
 YOU MAY ELECT TO STAND TRIAL OR YOU MAY ELECT TO PAY A PRESET FINE OF \$ to the District Court of Maryland at
and **AVOID TRIAL.** A court date will be sent to you by mail. Payment must be made on or before the scheduled trial date.
AFTER TRIAL the Court may impose a fine up to \$ plus court costs.
FAILURE TO APPEAR OR, IF PERMITTED, PAY THE PRESET FINE LISTED ABOVE, WILL RESULT IN A WARRANT BEING ISSUED FOR YOUR ARREST.

I solemnly affirm under the penalties of perjury, and upon personal knowledge or based on the affidavit, that the contents of this citation are true and that I am competent to testify on these matters. The defendant is not now in the military service, as defined in the Soldier's and Sailor's Civil Relief Act of 1940 with amendments, nor has been in such service within thirty days hereof.

Officer's Signature Robert Bricker (Robert Bricker) date 12/18/08

Agency Howard County Bureau of Environmental Health Sub-Agency I.D. No. Phone 410-313-1771

The Notice of Violation allowed 15 days for you to comply with the code. You were provided specific instructions to demonstrate your compliance. A visual observation of your property on December 10, 2008 revealed that the deck remains as observed in May, covering the well. As noted in the September 17, 2008 Notice of Violation, failure to dismantle the deck within 15 days could subject you to additional enforcement including the possibility of a civil citation (Howard County Code, 12.112). The 15-day grace period expired on October 7, 2008. The deck was observed on December 10, 2008, intact as it was observed in May 2008.

Enclosed is a civil citation for \$ 250.00 for failure to comply with the Howard County requirement to submit a Site Plan for the review of the project you propose by county agencies. Please keep in mind that each day this violation is allowed to occur is considered a separate offense which could lead to additional civil citations.

If you have questions regarding this citation, you may contact the Bureau of Environmental Health at (410) 313-1771.

Sincerely,



Robert C. Bricker, R.S.
Bureau of Environmental Health
Well and Septic Program

cc: Department of Inspections, Licenses and Permits (DILP)

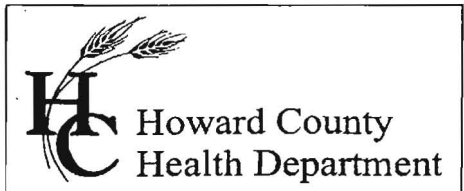

Bureau of Environmental Health
7178 Columbia Gateway Drive, Columbia, MD 21046-2147
(410) 313-2640 Fax (410) 313-2648
TDD (410) 313-2323 Toll Free 1-866-313-6300
website: www.hchealth.org

Peter L. Beilenson, M.D., M.P.H., Health Officer

SECOND NOTICE OF VIOLATION / CIVIL CITATION

**SENT VIA FIRST CLASS MAIL and CERTIFIED MAIL:
RETURN RECEIPT REQUESTED**

December 18, 2008

Perfecto Moreno
826 Long Corner Road
Mount Airy, Maryland 21771

**RE: Civil Citation/Non-permitted construction of a deck over water well
826 Long Corner Road, Tax Map 6 Grid 6 Parcel 85**

Dear Mr. Moreno,

In May 2008, the Howard County Department of Inspections, Licenses, and Permits found that you had constructed a deck at the back of your residence without a permit. Further review by the Health Department revealed that you had constructed the deck over the existing drinking water well for your property. This is a violation of both Code of Maryland (COMAR) and Howard County Code regulations. You were informed at that time that the deck would have to be removed to a distance of at least 10 feet from the well.

On September 22, 2008, you received a formal Notice of Violation (dated September 17, 2008) via Certified Mail (#70080150000251028926). The violations were summarized in that letter, and as follows.

1. Construction of the deck violated Howard County Code 3.901(F) which requires submittal of a Site Plan that includes well and septic locations, as well as existing and proposed structures, prior to approval of a Building Permit (i.e., prior to construction a Howard County review and approval of the Building Permit Application are required).
2. Location of the constructed deck violates Howard County Code 3.808(C) which requires a minimum setback distance of 10 feet between a deck and a well.
3. Be advised that the deck that you constructed is also in violation of COMAR 26.04.04.05.B(2) - paragraphs (b) and (e) respectively; a well "may not be located within or under any building" except one specifically constructed to house the pumping equipment, and the well "shall be located so as to be accessible for cleaning, treatment, repair, testing, inspection, and other such attention as may be necessary".

The Notice of Violation allowed 15 days for you to comply with the code. You were provided specific instructions to demonstrate your compliance. A visual observation of your property on December 10, 2008 revealed that the deck remains as observed in May, covering the well. As noted in the September 17, 2008 Notice of Violation, failure to dismantle the deck within 15 days could subject you to additional enforcement including the possibility of a civil citation (Howard County Code, 12.112). The 15-day grace period expired on October 7, 2008. The deck was observed on December 10, 2008, intact as it was observed in May 2008.

Enclosed is a civil citation for \$ 250.00 for failure to comply with the Howard County requirement to submit a Site Plan for the review of the project you propose by county agencies. Please keep in mind that each day this violation is allowed to occur is considered a separate offense which could lead to additional civil citations.

If you have questions regarding this citation, you may contact the Bureau of Environmental Health at (410) 313-1771.

Sincerely,



Robert C. Bricker, R.S.
Bureau of Environmental Health
Well and Septic Program

cc: Department of Inspections, Licenses and Permits (DILP)



Bureau of Environmental Health
7178 Gateway Drive Columbia, MD 21046
(410) 313-2640 Fax (410) 313-2648
TDD (410) 313-2323 Toll Free 1-866-313-6300
website: www.hchealth.org

Peter L. Beilenson, M.D., M.P.H., Health Officer

NOTICE OF VIOLATION

SENT VIA CERTIFIED MAIL: 70080150000251028926
RETURN RECEIPT REQUESTED

September 17, 2008

Perfecto Moreno or Hilaria Rodriguez
826 Long Corner Road
Mount Airy, Maryland 21771

RE: Non-permitted construction of a deck over water well
826 Long Corner Road, Tax Map 6 Grid 6 Parcel 85

Dear Mr. Levine: *TYPE*

In May 2008, the Howard County Department of Inspections, Licenses, and Permits found that you had constructed a deck at the back of your residence without a permit. Further review of the issue by the Health Department revealed that you had constructed the deck over the existing drinking water well for your property. This is a violation of both Code of Maryland (COMAR) and Howard County Code. You were informed at that time that the deck would have to be removed to a distance of at least 10 feet from the well. More than adequate time has been allowed for this task to be accomplished. A review of records and property conditions reveals that the deck covers the well, as it was constructed.

Construction of the deck violated Howard County Code 3.901(F) which requires submittal of a Site Plan that includes well and septic locations, as well as existing and proposed structures, prior to approval of a Building Permit. Be advised that the deck that you constructed without a permit continues to be in violation of COMAR 26.04.04.05.B.(2)(b) and (e), respectively, that a well "may not be located within or under any building" except one specifically constructed to house the pumping equipment, and the well "shall be located so as to be accessible for cleaning, treatment, repair, testing, inspection, and other such attention as may be necessary". Location of the constructed deck also violates Howard County Code 3.808(C) which requires a setback distance of 10 feet between a deck and a well.

SENDER: COMPLETE THIS SECTION

- Complete items 1, 2, and 3. Also complete item 4 if Restricted Delivery is desired.
- Print your name and address on the reverse so that we can return the card to you.
- Attach this card to the back of the mailpiece or on the front if space permits. **RB**

1. Article Addressed to:

Perfecto Moreno or
 Hilaria Rodriguez
 826 Long Corner Road
 Mt. Airy, MD 21771-3832

2. Article Number

(Transfer from service label)

7008 0150 0002 5102 8926

COMPLETE THIS SECTION ON DELIVERY

A. Signature

X

Vanessa Moreno

 Agent Addressee

B. Received by (Printed Name)

Vanessa Moreno

C. Date of Delivery

9-22

D. Is delivery address different from item 1? Yes

If YES, enter delivery address below:

 No

3. Service Type

 Certified Mail Express Mail Registered Return Receipt for Merchandise Insured Mail C.O.D.

4. Restricted Delivery? (Extra Fee)

 Yes

UNITED STATES POSTAL SERVICE
BALTIMORE MD 212



24 SEP 2008 PM 4 T

First-Class Mail
Postage & Fees Paid
USPS
Permit No. G-10

- Sender: Please print your name, address, and ZIP+4 in this box •

**Howard County Health Department
Bureau of Environmental Health
7178 Columbia Gateway Drive
Columbia, Maryland 21046 - 2132**



U.S. Postal Service™

CERTIFIED MAIL™ RECEIPT

(Domestic Mail Only; No Insurance Coverage Provided)

For delivery information visit our website at www.usps.com

OFFICIAL USE

Postage

\$

Certified Fee

Return Receipt Fee
(Endorsement Required)

Restricted Delivery Fee
(Endorsement Required)

Total Postage & Fees

\$

Postmark
Here

Sent To

MORENO PERFECTO or HILARIA RODRIGUEZ

Street, Apt. No.;

or PO Box No.

826 Long Corner Road

City, State, ZIP+4

Mt. Airy, MD 21771-3832

PS Form 3800, August 2006

See Reverse for Instructions

7008 0150 0002 5102 8926
9268 2015 2000 0510 9000

Certified Mail Provides:

- A mailing receipt
- A unique identifier for your mailpiece
- A record of delivery kept by the Postal Service for two years

Important Reminders:

- Certified Mail may **ONLY** be combined with First-Class Mail® or Priority Mail®.
- Certified Mail is *not* available for any class of international mail.
- **NO INSURANCE COVERAGE IS PROVIDED** with Certified Mail. For valuables, please consider Insured or Registered Mail.
- For an additional fee, a *Return Receipt* may be requested to provide proof of delivery. To obtain Return Receipt service, please complete and attach a Return Receipt (PS Form 3811) to the article and add applicable postage to cover the fee. Endorse mailpiece "Return Receipt Requested". To receive a fee waiver for a duplicate return receipt, a USPS® postmark on your Certified Mail receipt is required.
- For an additional fee, delivery may be restricted to the addressee or addressee's authorized agent. Advise the clerk or mark the mailpiece with the endorsement "*Restricted Delivery*".
- If a postmark on the Certified Mail receipt is desired, please present the article at the post office for postmarking. If a postmark on the Certified Mail receipt is not needed, detach and affix label with postage and mail.

IMPORTANT: Save this receipt and present it when making an inquiry.

PS Form 3800, August 2006 (Reverse) PSN 7530-02-000-9047

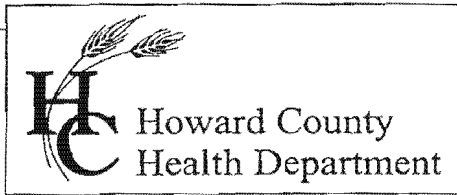

Bureau of Environmental Health
7178 Gateway Drive Columbia, MD 21046
(410) 313-2640 Fax (410) 313-2648
TDD (410) 313-2323 Toll Free 1-866-313-6300
website: www.hchealth.org

Peter L. Beilenson, M.D., M.P.H., Health Officer

NOTICE OF VIOLATION

SENT VIA CERTIFIED MAIL: 70080150000251028926
RETURN RECEIPT REQUESTED

September 17, 2008

Perfecto Moreno or Hilaria Rodriguez
826 Long Corner Road
Mount Airy, Maryland 21771

RE: Non-permitted construction of a deck over water well
826 Long Corner Road, Tax Map 6 Grid 6 Parcel 85

Dear Mr. Levine:

In May 2008, the Howard County Department of Inspections, Licenses, and Permits found that you had constructed a deck at the back of your residence without a permit. Further review of the issue by the Health Department revealed that you had constructed the deck over the existing drinking water well for your property. This is a violation of both Code of Maryland (COMAR) and Howard County Code. You were informed at that time that the deck would have to be removed to a distance of at least 10 feet from the well. More than adequate time has been allowed for this task to be accomplished. A review of records and property conditions reveals that the deck covers the well, as it was constructed.

Construction of the deck violated Howard County Code 3.901(F) which requires submittal of a Site Plan that includes well and septic locations, as well as existing and proposed structures, prior to approval of a Building Permit. Be advised that the deck that you constructed without a permit continues to be in violation of COMAR 26.04.04.05.B.(2)(b) and (e), respectively, that a well "may not be located within or under any building" except one specifically constructed to house the pumping equipment, and the well "shall be located so as to be accessible for cleaning, treatment, repair, testing, inspection, and other such attention as may be necessary". Location of the constructed deck also violates Howard County Code 3.808(C) which requires a setback distance of 10 feet between a deck and a well.

You must provide evidence that the violation has been remedied within 15 (fifteen) days of receipt of this notice. The deck must be removed from the area of the well to a distance of 10 feet. When the setback condition is met, contact the Health Department 410-313-1771, to schedule an inspection of the well area. Failure to comply will result in the issuance of a civil citation(s). Under Howard County Code, paragraph 12.112, each day this violation is allowed to occur is considered a separate offense.

If you believe that the condition described above is not and could not be a hazard to health, or that the Health Department is not acting in compliance with pertinent laws and regulations, you may request a formal hearing before the Board of Health within 15 (fifteen) days of receipt of this letter. All requests are to be made in writing and directed to the Executive Secretary of the Board of Health at the above address.

If you have any questions regarding this letter, please contact me at the Bureau of Environmental Health, phone 410-313-1771.

Sincerely,



Robert C. Bricker, R.S.
Bureau of Environmental Health
Well and Septic Program

Copy: Executive Secretary, Board of Health
File

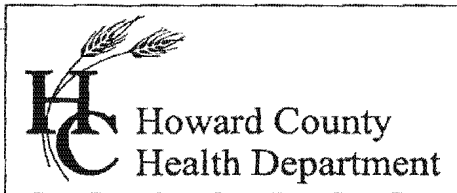

Bureau of Environmental Health
7178 Gateway Drive Columbia, MD 21046
(410) 313-2640 Fax (410) 313-2648
TDD (410) 313-2323 Toll Free 1-866-313-6300
website: www.hchealth.org

Peter L. Beilenson, M.D., M.P.H., Health Officer

May 15, 2009

Perfecto Moreno or Hilaria Rodriguez
826 Long Corner Road
Mount Airy, Maryland 21771

**RE: Required of you, a Request for Variance
826 Long Corner Road, Tax Map 6 Grid 6 Parcel 85**

Dear Mr. Moreno and Ms. Rodriguez:

That you may know, on May 14, 2009, the District Court in Ellicott City (Howard County, Maryland) entered a judgment against you for the sum of \$500 relative to the citation (OZ33129712) filed against you on December 18, 2008. The procedures concerning said citation are complete at this time.

The Health Department acknowledges that you have removed the nonpermitted deck from over the well at your residence. However, the separation distance required is 10 feet, and the distance between the remaining deck and the well has been measured as 7 feet. Be advised that the remaining deck has not been approved by the Health Department.

The following actions are required of you (so that you may avoid another citation):

- 1) You must submit to the Health Department a Request of Variance. This is a simple letter, only 1 or 2 paragraphs. You are requesting a variance from the 10-foot setback requirement between your potable water well and the remaining deck (Howard County Code, Section 3.808.C). You are requesting the setback distance be reduced to 7 feet. You should offer a reason for having the remaining deck. For example, you may cite the location of the sliding glass door, and safety of entering that door, and cite any other reason you used for determining the width of the deck that remains. Address letter to:

Michael Davis
Bureau of Environmental Health
7178 Columbia Gateway Drive
Columbia, MD 21046

- 2) Your written request must be postmarked by May 27, 2009. Alternately you may hand-deliver your request at the Bureau of Environmental Health desk by close of business on May 29, 2009.
- 3) You must include a copy of your site plan with the letter showing the current dimensions of the deck. Label areas properly as "Remaining Deck" and "Removed Deck".

Failure to respond as directed will result in the Health Department issuing another citation for non-compliance with Howard County Code. If you have any questions regarding this letter, please contact me at the Bureau of Environmental Health, phone 410-313-2691.

Sincerely,



Robert Bricker, R.S.
Bureau of Environmental Health
Well and Septic Program

Copy: File

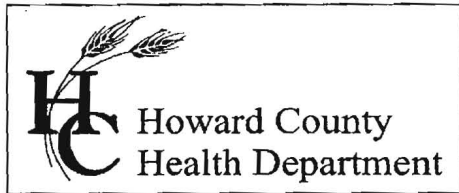

Bureau of Environmental Health
7178 Columbia Gateway Drive, Columbia, MD 21046-2147
(410) 313-2640 Fax (410) 313-2648
TDD (410) 313-2323 Toll Free 1-866-313-6300
website: www.hchealth.org

Peter L. Beilenson, M.D., M.P.H., Health Officer

SECOND NOTICE OF VIOLATION / CIVIL CITATION

**SENT VIA FIRST CLASS MAIL and CERTIFIED MAIL:
RETURN RECEIPT REQUESTED**

December 18, 2008

Perfecto Moreno
826 Long Corner Road
Mount Airy, Maryland 21771

**RE: Civil Citation/Non-permitted construction of a deck over water well
826 Long Corner Road, Tax Map 6 Grid 6 Parcel 85**

Dear Mr. Moreno,

In May 2008, the Howard County Department of Inspections, Licenses, and Permits found that you had constructed a deck at the back of your residence without a permit. Further review by the Health Department revealed that you had constructed the deck over the existing drinking water well for your property. This is a violation of both Code of Maryland (COMAR) and Howard County Code regulations. You were informed at that time that the deck would have to be removed to a distance of at least 10 feet from the well.

On September 22, 2008, you received a formal Notice of Violation (dated September 17, 2008) via Certified Mail (#70080150000251028926). The violations were summarized in that letter, and as follows.

1. Construction of the deck violated Howard County Code 3.901(F) which requires submittal of a Site Plan that includes well and septic locations, as well as existing and proposed structures, prior to approval of a Building Permit (i.e., prior to construction a Howard County review and approval of the Building Permit Application are required).
2. Location of the constructed deck violates Howard County Code 3.808(C) which requires a minimum setback distance of 10 feet between a deck and a well.
3. Be advised that the deck that you constructed is also in violation of COMAR 26.04.04.05.B(2) - paragraphs (b) and (e) respectively; a well "may not be located within or under any building" except one specifically constructed to house the pumping equipment, and the well "shall be located so as to be accessible for cleaning, treatment, repair, testing, inspection, and other such attention as may be necessary".

The Notice of Violation allowed 15 days for you to comply with the code. You were provided specific instructions to demonstrate your compliance. A visual observation of your property on December 10, 2008 revealed that the deck remains as observed in May, covering the well. As noted in the September 17, 2008 Notice of Violation, failure to dismantle the deck within 15 days could subject you to additional enforcement including the possibility of a civil citation (Howard County Code, 12.112). The 15-day grace period expired on October 7, 2008. The deck was observed on December 10, 2008, intact as it was observed in May 2008.

Enclosed is a civil citation for \$ 250.00 for failure to comply with the Howard County requirement to submit a Site Plan for the review of the project you propose by county agencies. Please keep in mind that each day this violation is allowed to occur is considered a separate offense which could lead to additional civil citations.

If you have questions regarding this citation, you may contact the Bureau of Environmental Health at (410) 313-1771.

Sincerely,



Robert C. Bricker, R.S.
Bureau of Environmental Health
Well and Septic Program

cc: Department of Inspections, Licenses and Permits (DILP)

SITE INSPECTION SHEET

OWNER: Perfecto Moreno PHONE #: _____
ADDRESS: 826 Long Corner Rd CONTRACTOR: _____
WELL TAG #: _____
SUBDIVISION: _____ LOT: _____ COUNTY #: _____
PROPOSAL: Distance of well from 'Remaining Deck'

5/7/2009
Robert Bricker
& Heidi Scott

LOCATION DIAGRAM

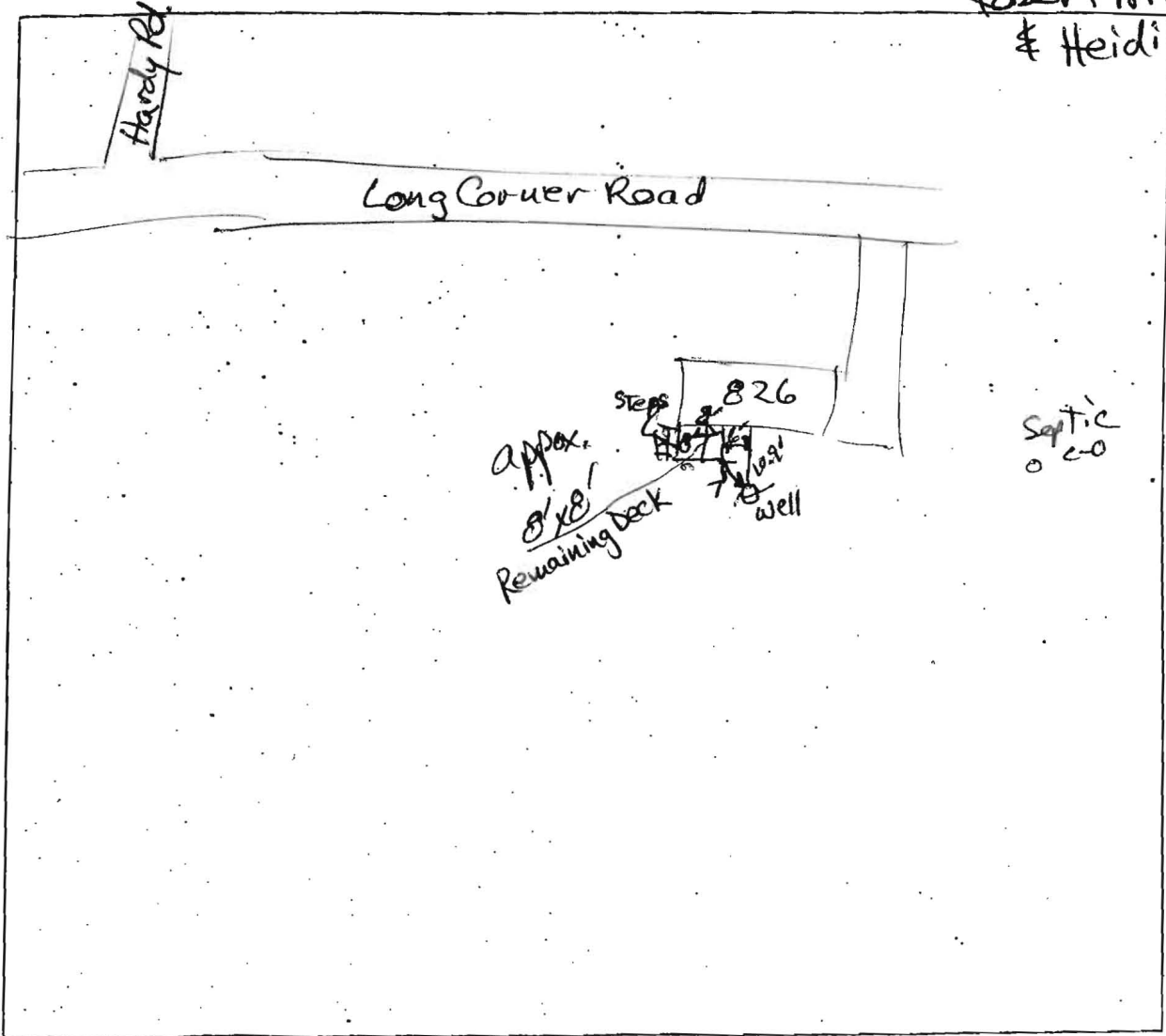

COMMENTS: _____



**HOME LAND
SEPTIC
CONSULTING, LLC**

**HOME LAND SEPTIC CONSULTING LLC
PHONE (443) 995-5385
WWW.MDWELLANDSEPTIC.COM
TIM@MDWELLANDSEPTIC.COM**

Date: April 13, 2011 Name of Evaluator: Eric Garrett Time: 11:00 AM Property Address: 826 Long Corner Road Mt. Airy, MD 21771 Recent Weather Conditions: Light Rain		Ordered By: Patty Smith Phone: (240) 876-3424 Email: Buyer: Keith Sexton Phone: Email:		Occupied: <input checked="" type="checkbox"/> Yes <input type="checkbox"/> No Length of Time Vacant: N/A # of People Living in Home: 8 # of people moving in: 1 Property Age: 1955 System Age: Unknown Last Pump Date: Unknown Recomm'd Pumping Freq: 3 Years	
Liquid level in tank is: <input checked="" type="checkbox"/> Above Normal <input type="checkbox"/> Normal <input type="checkbox"/> Below		Bottom Solids Depth: 24+ Inches			
Maintenance appears: <input type="checkbox"/> Good <input type="checkbox"/> Fair <input checked="" type="checkbox"/> Poor		Depth of tank access: At Grade			
Previous high liquid level: <input checked="" type="checkbox"/> Yes <input type="checkbox"/> No		Effluent Filter present: <input type="checkbox"/> Yes <input checked="" type="checkbox"/> No		Distance to well: >100 Feet	
Were there any impermeable surfaces above the septic system (i.e. driveway)? <input type="checkbox"/> Yes <input checked="" type="checkbox"/> No If yes what:					
Type of System		Type of Tank		Type of Absorption Area	
<input checked="" type="checkbox"/> Septic Tank (1 tank)		<input type="checkbox"/> Metal <input checked="" type="checkbox"/> Concrete <input type="checkbox"/> Plastic		<input checked="" type="checkbox"/> Leaching Field <input type="checkbox"/> Raised Mound	
<input type="checkbox"/> Cesspool <input type="checkbox"/> Aeration System		Tank Size: 1,000 gallons		<input type="checkbox"/> Drywell (Number of:)	
<input type="checkbox"/> Other: _____				<input type="checkbox"/> Other: _____	
System Component		Condition		Comments	
Septic Tank		<input type="checkbox"/> Acceptable <input type="checkbox"/> Unacceptable		The tank was overfull at the start of the evaluation. Maintenance is considered to be poor and foreign objects were found in the tank.	
Pump Present? <input type="checkbox"/> Yes <input checked="" type="checkbox"/> No		<input type="checkbox"/> Acceptable <input type="checkbox"/> Unacceptable			
Absorption System		<input type="checkbox"/> Acceptable <input checked="" type="checkbox"/> Unacceptable		The drainfield was probed and effluent was found to be surfacing as a result of the probing. This indicates that the drainage area is unacceptable and this should be replaced per the County Health Department requirements.	



HOME LAND
SEPTIC
CONSULTING, LLC

HOME LAND SEPTIC CONSULTING LLC
PHONE (443) 995-5385
WWW.MDWELLANDSEPTIC.COM
TIM@MDWELLANDSEPTIC.COM

Sketch of System

Front of the House

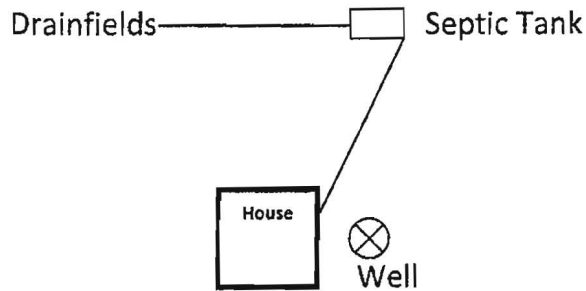

- This is a subjective and visual inspection only, based upon many unknown and unseen factors.
- A 'Satisfactory' evaluation does not mean the system will meet the local approving authority's criteria for determining compliance with state code: COMAR 26.04.02.02 D(4).
- The condition of the Sewage Disposal System is reported as and only as the day of the inspection.
- **This report does not WARRANT nor GUARANTEE** continued functional Sewage Disposal Systems operations.
- If house has been unoccupied this report may not be accurate. Little or no use of the septic system could have allowed problems to temporarily clear themselves.
- If the general ground condition is wet, this report may not be accurate, as ground moisture may cover or hide actual septic effluent on the service.
- In the above cases, it is recommended that the septic system be reevaluated in 2 to 4 months.
- Payment and/or use of this evaluation signifies understanding and acceptances of the above clauses, as well as any noted faults with the system.

Representative's Signature:

Date: 4/13/2011

Amount: \$400

Check Number: 1017

Date Paid: 4/13/2011



Howard County
Internal Memorandum

Subject: *Perfecto Moreno*
Citation No. 0Z33129712

June 22, 2009

TO: Lisa Washington
Division of Customer Service

FROM: Barry Sanders *BS*
Assistant County Solicitor

Enclosed please find Check No. 1736 in the amount of \$500.00 in full and final payment of Citation No. 0Z33129712 issued to Perfecto Moreno by the Howard County Bureau of Environmental Health on December 10, 2008. Judgment in the amount of \$500.00 was entered against Mr. Moreno on May 14, 2009 by the District Court. An Order of Satisfaction has been filed with the court indicating that the outstanding judgment has been paid.

Thank you for your assistance in this matter.

BS:cm
Enclosure
cc: Robert Bricker