



APPLICATION

FOR PERCOLATION TESTING AND SITE EVALUATION

TEST DATE(S) _____ TEST TIME _____ 09 36 035

AGENCY REVIEW: _____ DATE _____

DO NOT WRITE ABOVE THIS LINE

I HEREBY APPLY FOR THE NECESSARY TESTING/EVALUATION PRIOR TO ISSUANCE OF SEWAGE DISPOSAL SYSTEM PERMIT(S) TO:

CHECK AS NEEDED:

- CONSTRUCT NEW SEPTIC SYSTEM(S)
- REPAIR/ADD TO AN EXISTING SEPTIC SYSTEM
- REPLACE AN EXISTING SEPTIC SYSTEM

CHECK AS NEEDED:

- NEW STRUCTURE(S)
- ADDITION TO AN EXISTING STRUCTURE
- REPLACE AN EXISTING STRUCTURE

CHECK ONE:

- CREATE NEW LOT(S)
- BUILD ON AN EXISTING LOT IN A SUBDIVISION
- BUILD ON AN EXISTING PARCEL OF RECORD

IS THE PROPERTY WITHIN 2500' OF ANY RESERVOIR?

- YES
- NO

THE TYPE OF STRUCTURE IS:

- RESIDENTIAL WITH _____ PROPOSED BEDROOMS IN THE COMPLETED STRUCTURE (NOTE *UNKNOWN* IF APPROPRIATE)
- COMMERCIAL (PROVIDE DETAIL OF NUMBERS AND TYPES OF EMPLOYEES/ CUSTOMERS ON ACCOMPANYING PLAN)
- INSTITUTIONAL/GOVERNMENT (PROVIDE DETAIL OF NUMBERS AND TYPES OF EMPLOYEES/USERS ON ACCOMPANYING PLAN)

PROPERTY OWNER(S) Kenneth Haines

DAYTIME PHONE _____ CELL _____ FAX _____

MAILING ADDRESS _____
STREET CITY/TOWN STATE ZIP

APPLICANT 759 Long Corner Road

DAYTIME PHONE _____ CELL _____ FAX _____

MAILING ADDRESS _____
STREET CITY/TOWN STATE ZIP

APPLICANT'S ROLE: DEVELOPER BUILDER BUYER RELATIVE/FRIEND REALTOR CONSULTANT

PROPERTY LOCATION
SUBDIVISION/PROPERTY NAME _____ LOT NO. _____

PROPERTY ADDRESS _____
STREET TOWN/POST OFFICE

TAX MAP PAGE(S) _____ GRID _____ PARCEL(S) _____ PROPOSED LOT SIZE _____

AS APPLICANT, I UNDERSTAND THE FOLLOWING: THE SYSTEM INSTALLED SUBSEQUENT TO THIS APPLICATION IS ACCEPTABLE ONLY UNTIL PUBLIC SEWERAGE IS AVAILABLE. THIS APPLICATION IS COMPLETE WHEN ALL APPLICABLE FEES AND A SUITABLE SITE PLAN HAVE BEEN RECEIVED. I ACCEPT THE RESPONSIBILITY FOR COMPLIANCE WITH ALL M.O.S.H.A. AND "MISS UTILITY" REQUIREMENTS. APPROVAL IS BASED UPON SATISFACTORY REVIEW OF A PERC CERTIFICATION PLAN.

TEST RESULTS WILL BE MAILED TO APPLICANT. _____
SIGNATURE OF APPLICANT

HOWARD COUNTY HEALTH DEPARTMENT, BUREAU OF ENVIRONMENTAL HEALTH, WELL AND SEPTIC PROGRAM
7178 COLUMBIA GATEWAY DRIVE COLUMBIA, MARYLAND 21046 (410) 313-2640 FAX (410) 313-2648
TDD (410) 313-2323 TOLL FREE 1-877-4MD-DHMH

(A)
 Or Br SCl
 2' Loam Turning
 To an Or Br
 Cl Loam, Dense
 Fine SBK
 4.5-5'
 Or Br
 Cl Loam,
 Shale Increasing
 With Depth
 9'
 30-35%
 Shale
 10'
 75% Shale

(B)
 Or Br Cl
 Loam,
 Fine SBK
 3'
 Dense Or
 Br Cl Loam
 4.5-5'
 Or Br
 Cl Loam,
 Shale
 Increasing
 With
 Depth
 10'
 75% Rock

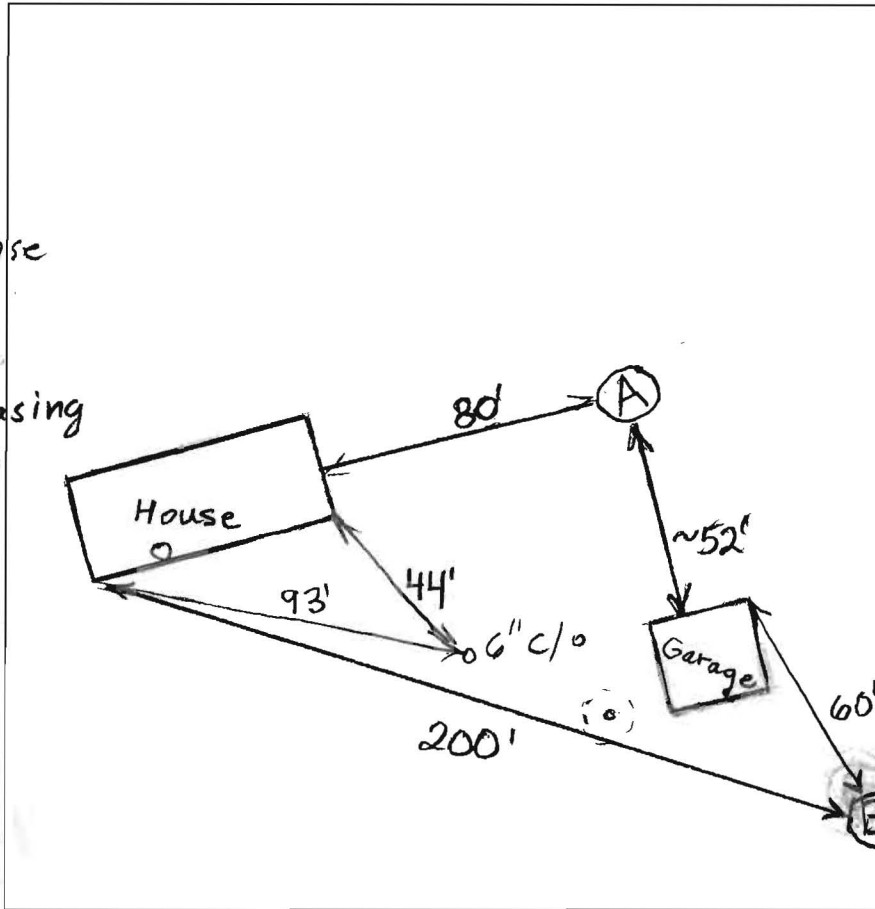

| DATE | TEST # | DEPTH | START | BREAK 1" DROP | STOP 2" DROP | TIME OF 2ND INCH | P/F/H |
|---------|--------|--------|-------|------------------|-----------------|---------------------|-------|
| 12/2/11 | A | 6'/10' | 11:25 | 11:52 | 12:42 | 50 | F |
| | B | 6'/10' | 12:04 | 12:18:30 | 12:54:30 | 36 | H |
| | | | | | | | |
| | | | | | | | |
| | | | | | | | |
| | | | | | | | |
| | | | | | | | |
| | | | | | | | |

REMARKS Soil Very Marginal - Plenty of Repair Room
 SANITARIAN B. Baker BACKHOE W. Hopkins OTHERS Mr. Haines
 TEST HOLES USED IN SDA B AVG. PERC TIME _____ SQ. FT/BR _____
 TRENCH WIDTH _____ INLET DEPTH _____ MAX. BOT DEPTH _____ EFFECTIVE SW _____